

MATCH LINE A-A (SEE SHEET 2)

### LEGEND

- LIMIT OF DISTURBANCE -----
- EXISTING EASEMENT LINE -----
- EXISTING MAJOR CONTOURS -----
- EXISTING MINOR CONTOURS -----
- PROPOSED CONTOURS -----
- EXISTING TREE TO BE SAVED -----
- EDGE OF TREELINE -----
- EDGE OF WETLAND -----
- WETLAND BUFFER (25') -----
- WATERS OF THE UNITED STATES -----
- PROPERTY LINE -----
- EXISTING ROAD EDGE -----
- EXISTING SEWER LINE -----
- STONE TOE PROTECTION -----
- BOULDER CLUSTER -----
- RIFFLE GRADE CONTROL -----
- EXISTING TREE -----
- EXISTING/PROPOSED 100-YR WSE\* -----
- IMPACTS TO EXISTING FCE -----
- AS-BUILT CONTOURS -----

### STONE TOE PROTECTION

FROM STATION	TO STATION	OFFSET*
3+00	3+90	L
3+00	4+46	R
4+22	5+37	L
5+10	6+51	R

\*FACING DOWNSTREAM, MEASURED FROM BASELINE OF CONSTRUCTION

### RIFFLE GRADE CONTROL

FROM STATION	TO STATION
3+00	3+30

### BOULDER CLUSTER

NAME	STATION	OFFSET*
B1	3+49	R
B2	3+70	L
B3	3+85	R

\*FACING DOWNSTREAM, STATION FROM BASELINE OF CONSTRUCTION

NOTE: THE HYDROLOGIC AND HYDRAULIC FLOOD ANALYSES AND FLOOD DELINEATION SHOWN HERE ON WAS BASED ON A 100-YEAR, 24-HOUR RAINFALL AMOUNT OF 8.51 INCHES BASED ON NOAA ATLAS 14 RAINFALL DATA. SUCH A RAINFALL AMOUNT EXCEEDS THE HOWARD COUNTY REQUIREMENT OF 7.2-INCHES. DUE TO THIS, THE FLOODPLAIN ELEVATIONS AND LIMITS EXCEEDED THE HOWARD COUNTY REQUIREMENTS.

\*MINIMAL CHANGES BETWEEN EXISTING AND PROPOSED 100-YR WSE. SEE THE HI TECH DRIVE STREAM HYDROLOGY AND HYDRAULICS REPORT FOR FURTHER INFORMATION.

APPROVED: HOWARD COUNTY DEPT. OF PLANNING AND ZONING

CHIEF, DEVELOPMENT ENGINEERING DIVISION \_\_\_\_\_ DATE \_\_\_\_\_

CHIEF, DIVISION OF LAND DEVELOPMENT \_\_\_\_\_ DATE \_\_\_\_\_

DIRECTOR \_\_\_\_\_ DATE \_\_\_\_\_

PROFESSIONAL CERTIFICATION. I HEREBY CERTIFY THAT THESE DOCUMENTS WERE PREPARED OR APPROVED BY ME, AND THAT I AM A DULY LICENSED PROFESSIONAL ENGINEER UNDER THE LAWS OF THE STATE OF MARYLAND, LICENSE NO. 18470. EXPIRATION DATE: OCTOBER 28, 2011

NO.	REVISIONS DESCRIPTION	DATE

**KCI TECHNOLOGIES**

936 RIDGEBROOK ROAD  
SPARKS, MARYLAND 21152  
TELEPHONE: (410) 316-7800  
FAX: (410) 316-7818  
www.kci.com

**HI-TECH DRIVE  
STREAM RESTORATION**

PATAPSCO VALLEY BUSINESS CENTER  
SECTION 3, AREA 3

HOWARD COUNTY DEPARTMENT OF RECREATION AND PARKS  
STORMWATER MANAGEMENT DIVISION  
6700 COLUMBIANA DRIVE  
COLUMBIANA, MARYLAND 21046  
PARCEL 285 TAX MAP 28 ZONING M-2  
ELECTION DISTRICT 01  
HOWARD COUNTY, MARYLAND

**AS-BUILT  
GRADING  
PLAN**

SCALE: 1" = 20'

DATE: July, 2012

KCI JOB NO.: 01081795.58

CAPITAL PROJECT NO.: D-1122

PERMIT ISSUE:

CONSTRUCTION ISSUE:

SHEET NO.: 1 OF 15

B:\Projects\2010\10-27-10\10-27-10-01\10-27-10-01.dwg

MATCH LINE A-A (SEE SHEET 1)

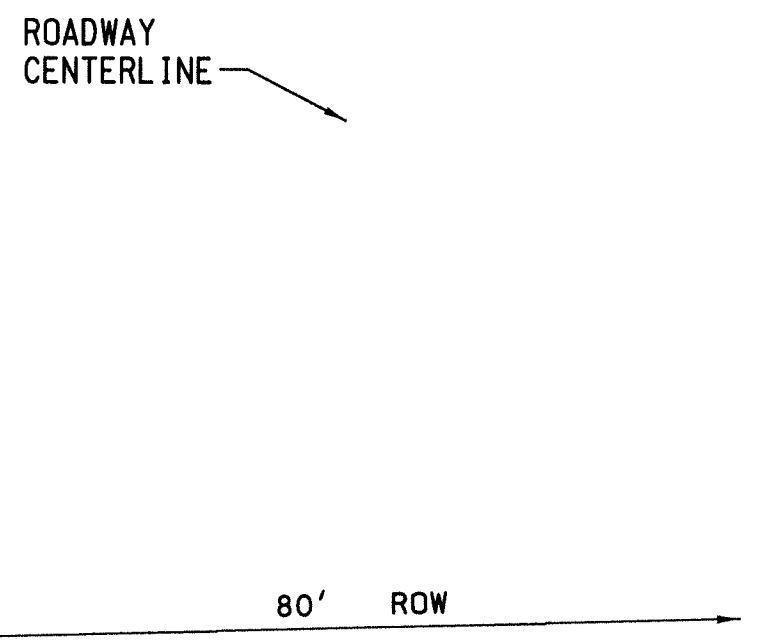
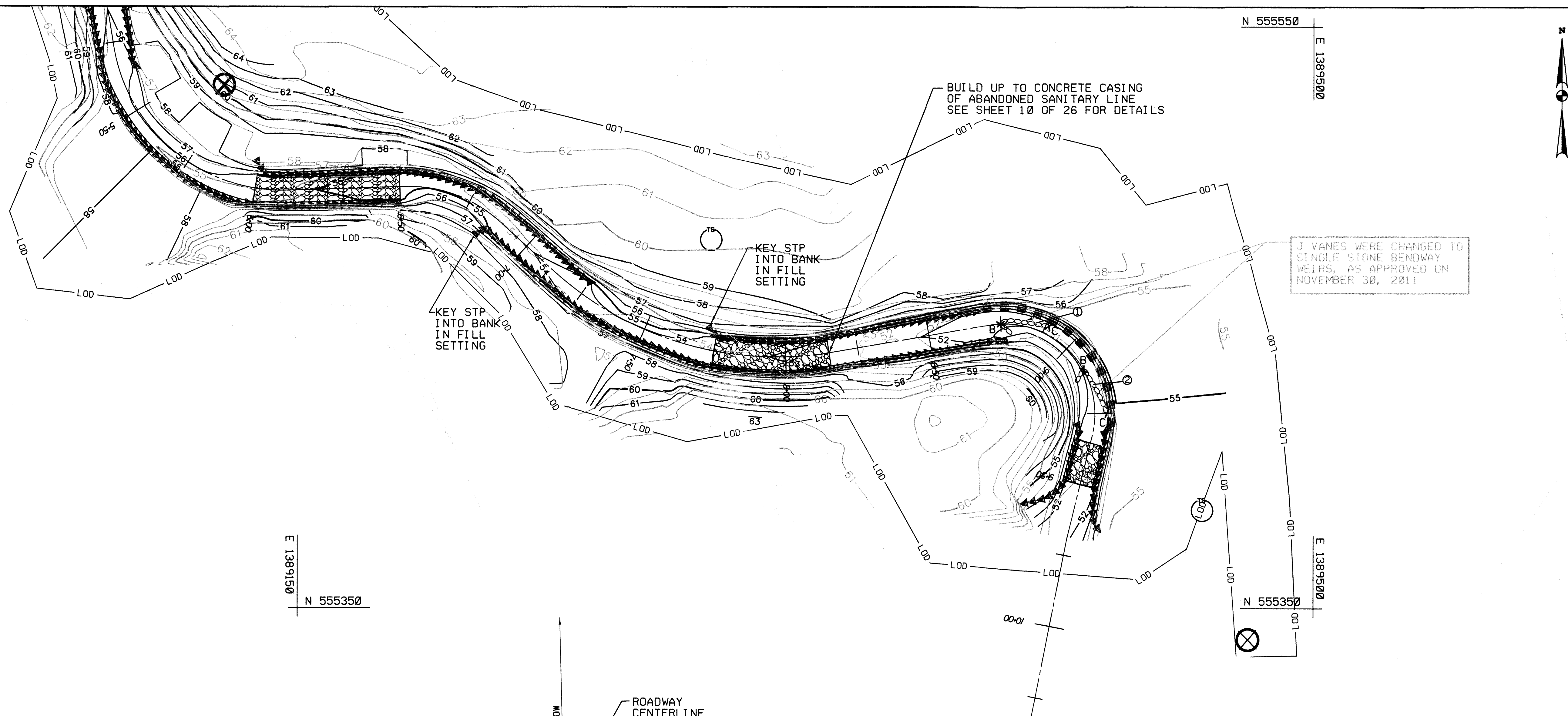

MATCH LINE B-B (SEE SHEET 3)

**LEGEND**

- LIMIT OF DISTURBANCE ----- LOD -----
- EXISTING EASEMENT LINE -----
- EXISTING MAJOR CONTOURS -----
- EXISTING MINOR CONTOURS -----
- PROPOSED CONTOURS -----
- EXISTING TREE TO BE SAVED -----
- EXISTING TREE TO BE REMOVED -----
- EDGE OF TREELINE -----
- EDGE OF WETLAND -----
- WETLAND BUFFER (25') -----
- WATERS OF THE UNITED STATES -----
- PROPERTY LINE -----
- EXISTING ROAD EDGE -----
- EXISTING SEWER LINE -----
- IMBRICATED WALL -----
- STONE TOE PROTECTION -----
- RIFFLE GRADE CONTROL -----
- J VANE -----
- J VANE NUMBER -----
- EXISTING TREE -----
- EXISTING/PROPOSED 100-YR WSE\* -----
- IMPACTS TO EXISTING FCE -----
- AS-BUILT CONTOURS -----

**RIFFLE GRADE CONTROL**

FROM STATION	TO STATION
6+00	6+50
7+75	8+15
9+35	9+50

**IMBRICATED WALL**

FROM STATION	TO STATION	OFFSET*
8+70	9+30	L

\*FACING DOWNSTREAM, MEASURED FROM BASELINE OF CONSTRUCTION

**J VANE**

VANE NO.	POINT C	POINT B	OFFSET*
1	8+90	8+75	L
2	9+25	9+09	L

\*FACING DOWNSTREAM, MEASURED FROM BASELINE OF CONSTRUCTION

**STONE TOE PROTECTION SCHEDULE**

FROM STATION	TO STATION	OFFSET*
4+20	5+37	L
5+10	6+51	R
5+98	7+26	L
6+83	8+78	R
7+72	8+70	L
9+30	9+61	R
9+30	9+65	L

\*FACING DOWNSTREAM, MEASURED FROM BASELINE OF CONSTRUCTION

NOTE: THE HYDROLOGIC AND HYDRAULIC FLOOD ANALYSES AND FLOOD DELINEATION SHOWN HERE ON WAS BASED ON A 100-YEAR, 24-HOUR RAINFALL AMOUNT OF 8.51 INCHES BASED ON NOAA ATLAS 14 RAINFALL DATA. SUCH A RAINFALL AMOUNT EXCEEDS THE HOWARD COUNTY REQUIREMENT OF 7.2-INCHES. DUE TO THIS, THE FLOODPLAIN ELEVATIONS AND LIMITS EXCEEDED THE HOWARD COUNTY REQUIREMENTS.

\*MINIMAL CHANGES BETWEEN EXISTING AND PROPOSED 100-YR WSE. SEE THE HI TECH DRIVE STREAM HYDROLOGY AND HYDRAULICS REPORT FOR FURTHER INFORMATION.

NO.	REVISIONS DESCRIPTION	DATE

936 RIDGEBROOK ROAD  
SPARKS, MARYLAND 21152  
TELEPHONE: (410) 316-7800  
FAX: (410) 316-7818  
WWW.KCI.COM

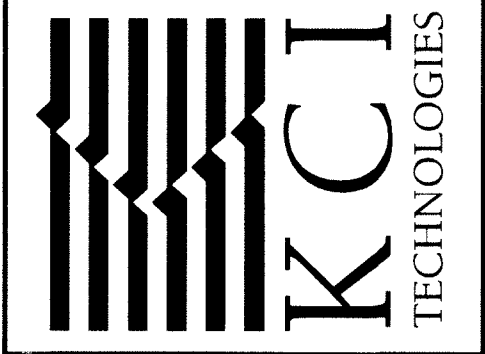

**HI-TECH DRIVE  
STREAM RESTORATION**  
PATAPSCO VALLEY BUSINESS CENTER  
SECTION 3, AREA 3  
HOWARD COUNTY DEPARTMENT OF RECREATION AND PARKS  
STORMWATER MANAGEMENT DIVISION  
1700 COLUMBIA MARSHALL DRIVE  
COLUMBIA, MARYLAND 21046  
PARCEL 285 TAX MAP 38 ZONING M-2  
ELECTION DISTRICT 01  
HOWARD COUNTY, MARYLAND

**AS-BUILT  
GRADING  
PLAN**

SCALE: 1" = 20'  
DATE: July, 2012  
KCI JOB NO.: 01081795.58  
CAPITAL PROJECT NO.: D-1122  
PERMIT ISSUE:  
CONSTRUCTION ISSUE:

PROFESSIONAL CERTIFICATION. I HEREBY CERTIFY THAT THESE DOCUMENTS WERE PREPARED OR APPROVED BY ME, AND THAT I AM A DULY LICENSED PROFESSIONAL ENGINEER UNDER THE LAWS OF THE STATE OF MARYLAND. LICENSE NO. 18478. EXPIRATION DATE: OCTOBER 28, 2011

APPROVED: HOWARD COUNTY DEPT. OF PLANNING AND ZONING  
CHIEF, DEVELOPMENT ENGINEERING DIVISION DATE  
CHIEF, DIVISION OF LAND DEVELOPMENT DATE  
DIRECTOR DATE





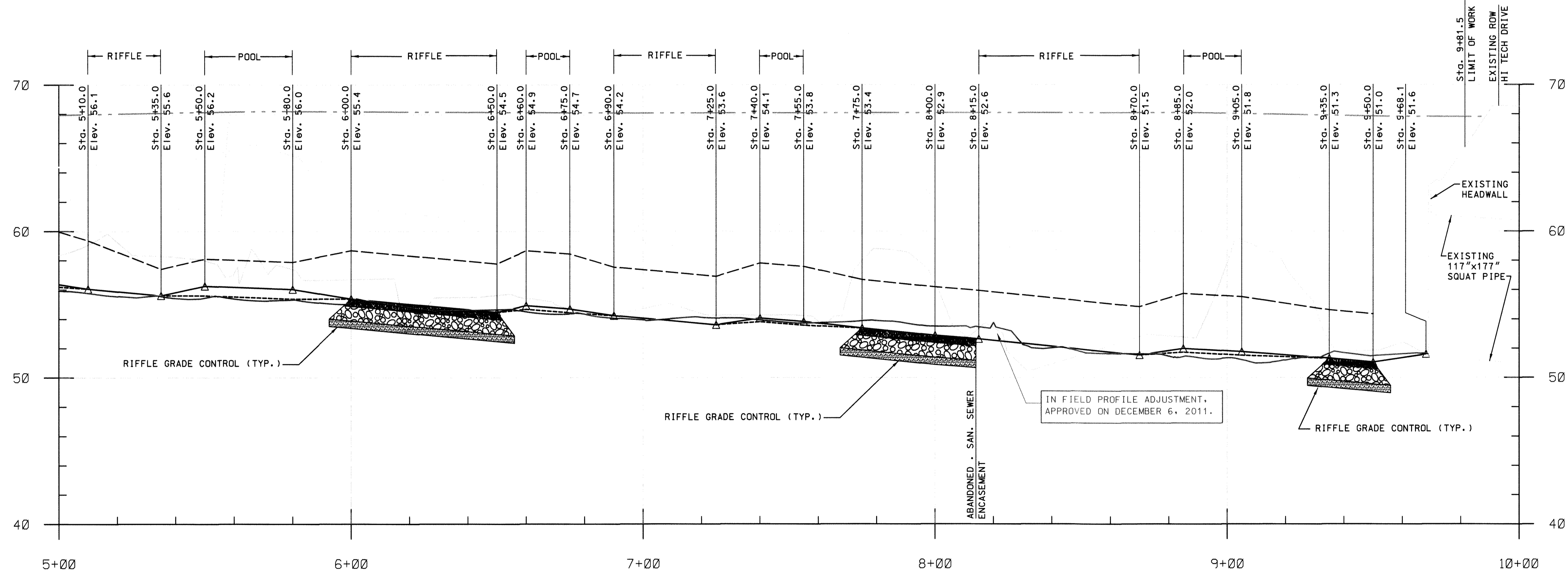
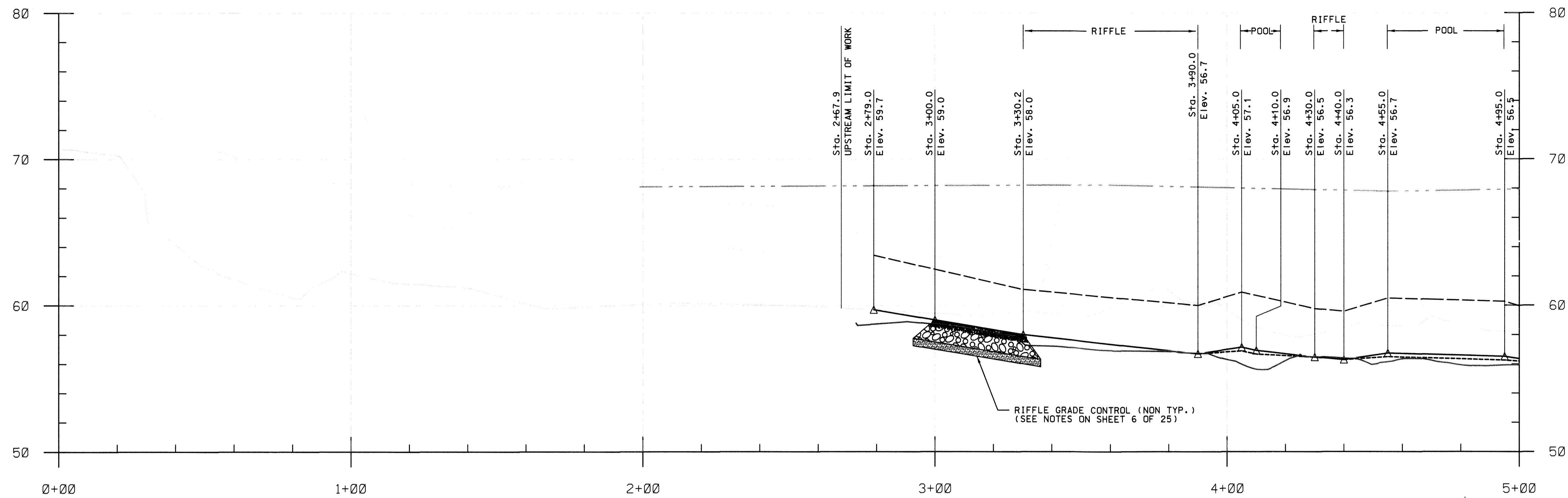

BY: Elizabeth Spencer, Designer, Division: P&Z, Natural Resources, File: M:\2008\01081795.58\Drawings\p\01081795.asst.dgn

APPROVED: HOWARD COUNTY DEPT. OF PLANNING AND ZONING

\_\_\_\_\_  
CHIEF, DEVELOPMENT ENGINEERING DIVISION      DATE

\_\_\_\_\_  
CHIEF, DIVISION OF LAND DEVELOPMENT      DATE

\_\_\_\_\_  
DIRECTOR      DATE

**LEGEND**

EXISTING GROUND      \_\_\_\_\_

PROPOSED GROUND      \_\_\_\_\_

PROPOSED THALWEG      \_\_\_\_\_

PROPOSED TOP OF BANK      \_\_\_\_\_

EXISTING TOP OF BANK RIGHT      \_\_\_\_\_

EXISTING TOP OF BANK LEFT      \_\_\_\_\_

100-YR PROPOSED WATER SURFACE ELEVATION      \_\_\_\_\_

100-YR EXISTING WATER SURFACE ELEVATION      \_\_\_\_\_

AS-BUILT GRADE      \_\_\_\_\_

PROFESSIONAL CERTIFICATION. I HEREBY CERTIFY THAT THESE DOCUMENTS WERE PREPARED OR APPROVED BY ME, AND THAT I AM A DULY LICENSED PROFESSIONAL ENGINEER UNDER THE LAWS OF THE STATE OF MARYLAND, LICENSE NO. 18470. EXPIRATION DATE: OCTOBER 28, 2011

NO.	REVISIONS DESCRIPTION	DATE

936 RIDGEBROOK ROAD  
SPARKS, MARYLAND 21152  
TELEPHONE: (410) 316-7800  
FAX: (410) 316-7818  
www.kci.com

HI-TECH DRIVE  
STREAM RESTORATION  
PATAPSCO VALLEY BUSINESS CENTER  
SECTION 3, AREA 3  
HOWARD COUNTY DEPARTMENT OF RECREATION AND PARKS  
STORMWATER MANAGEMENT DIVISION  
10000 WOODBINE DRIVE  
COLUMBIA, MARYLAND 21046  
PARCEL 285; TAX MAP 38; ZONING M-2  
ELECTION DISTRICT 01  
HOWARD COUNTY, MARYLAND

**AS-BUILT PROFILE**

SCALE: 0 0.25 0.5 1.0 INCHES  
HOR. 1"=20', VERT. 1"=4'

DATE: July, 2012  
KCI JOB NO.: 01081795.58  
CAPITAL PROJECT NO.: D-1122  
PERMIT ISSUE:  
CONSTRUCTION ISSUE:







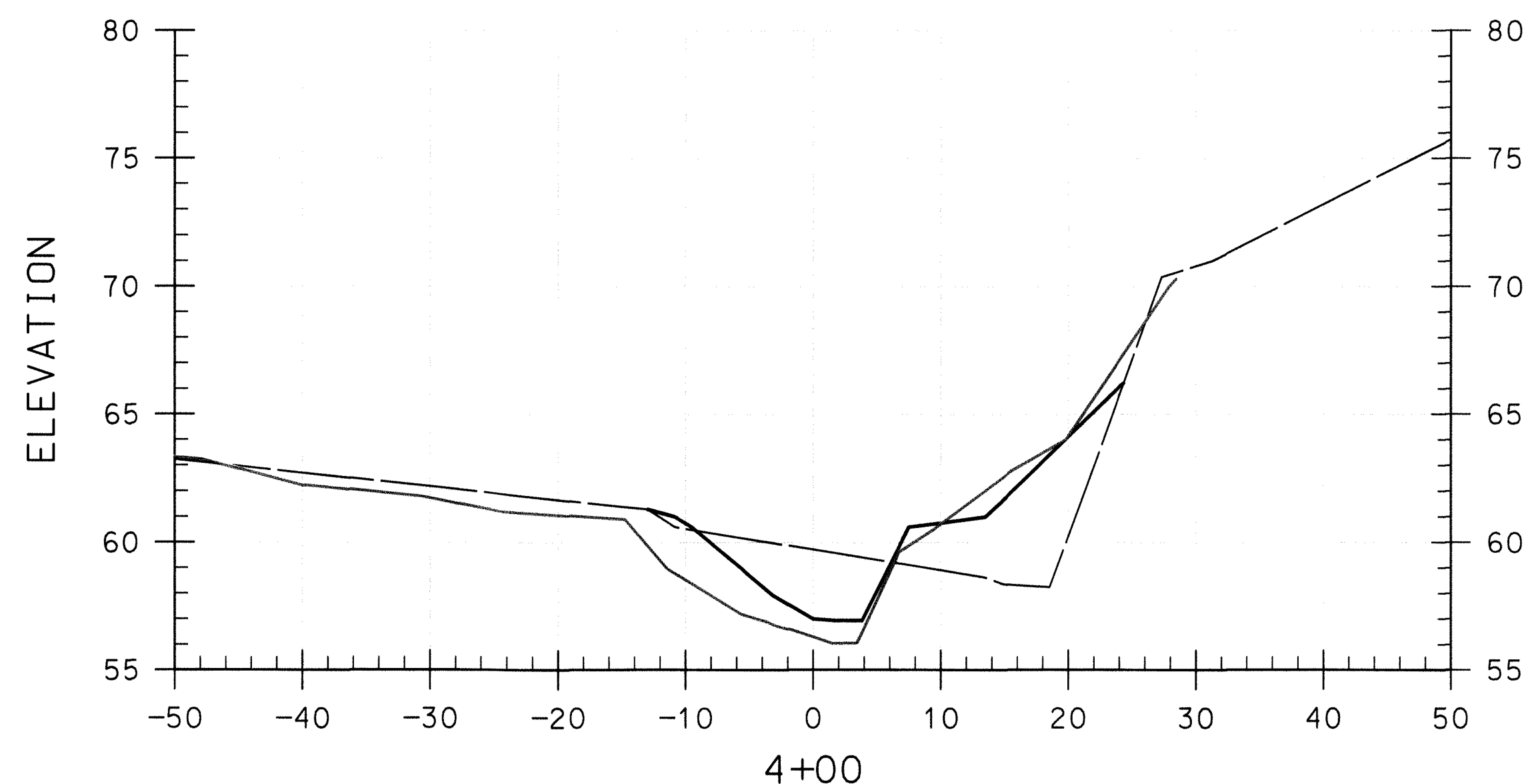
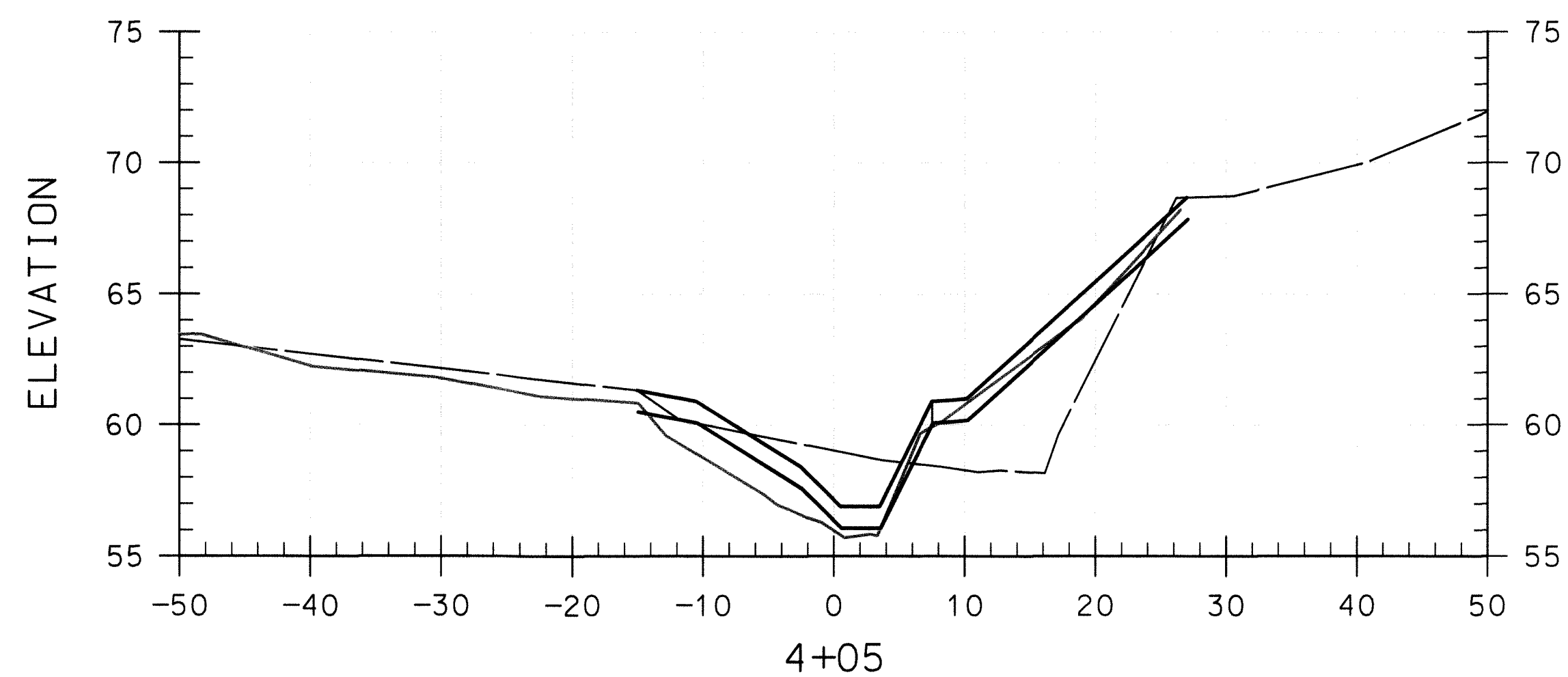
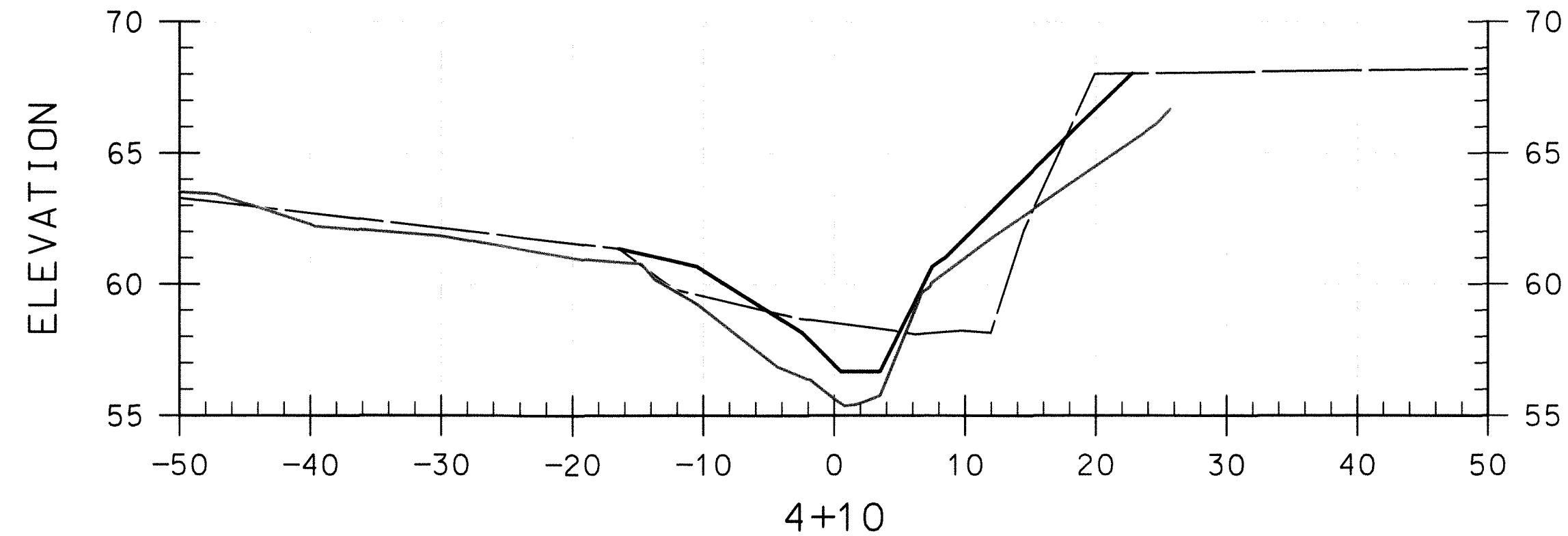
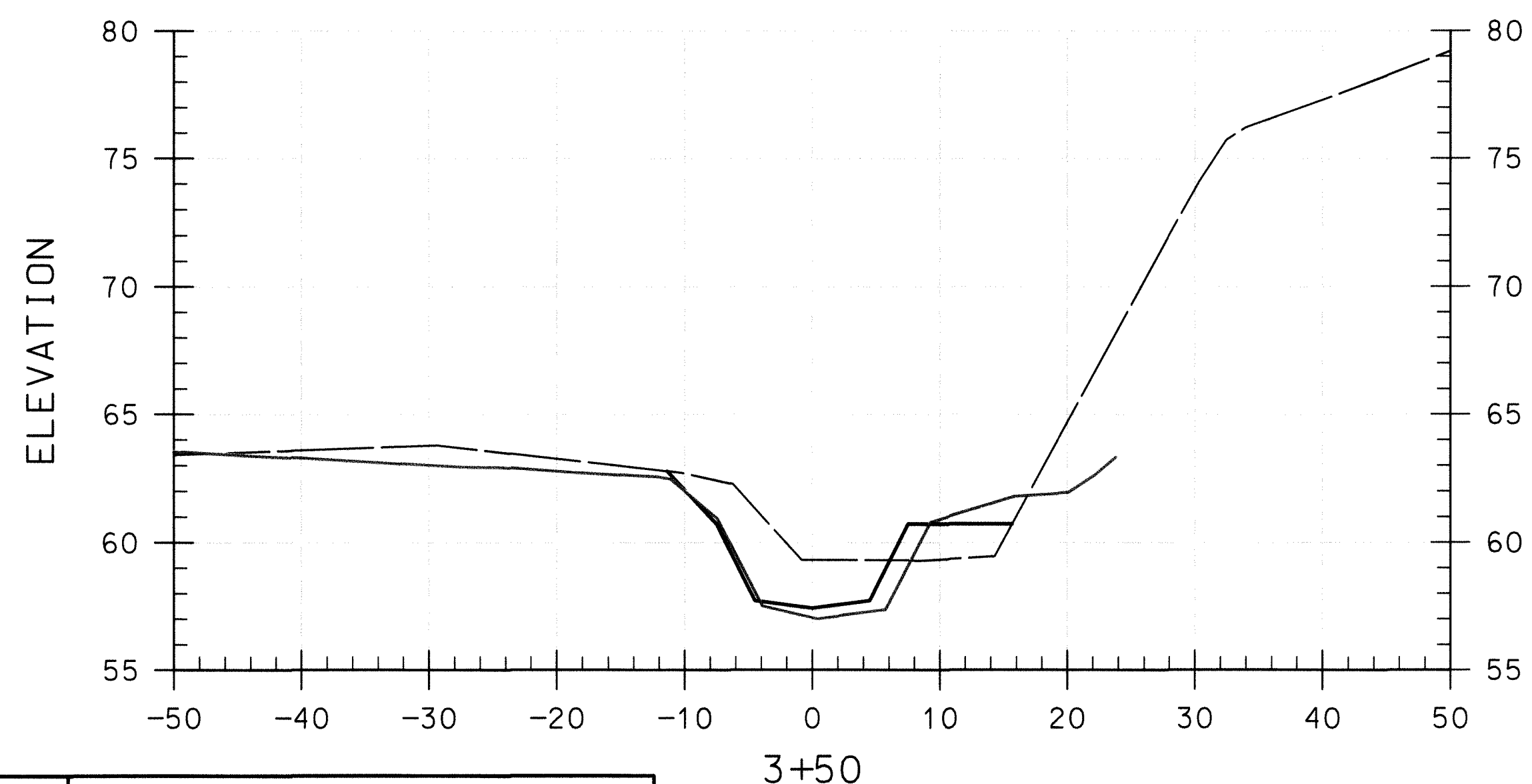
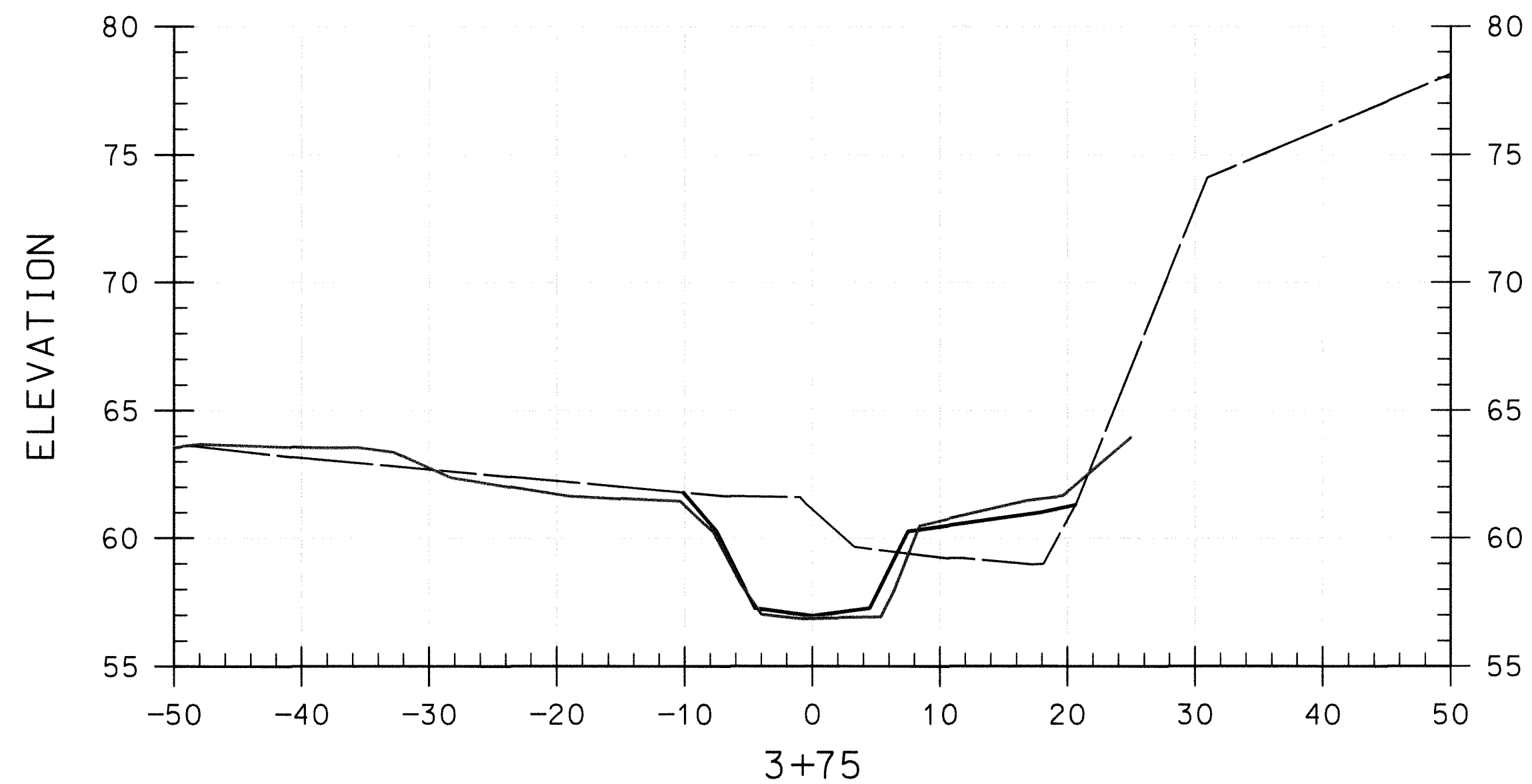
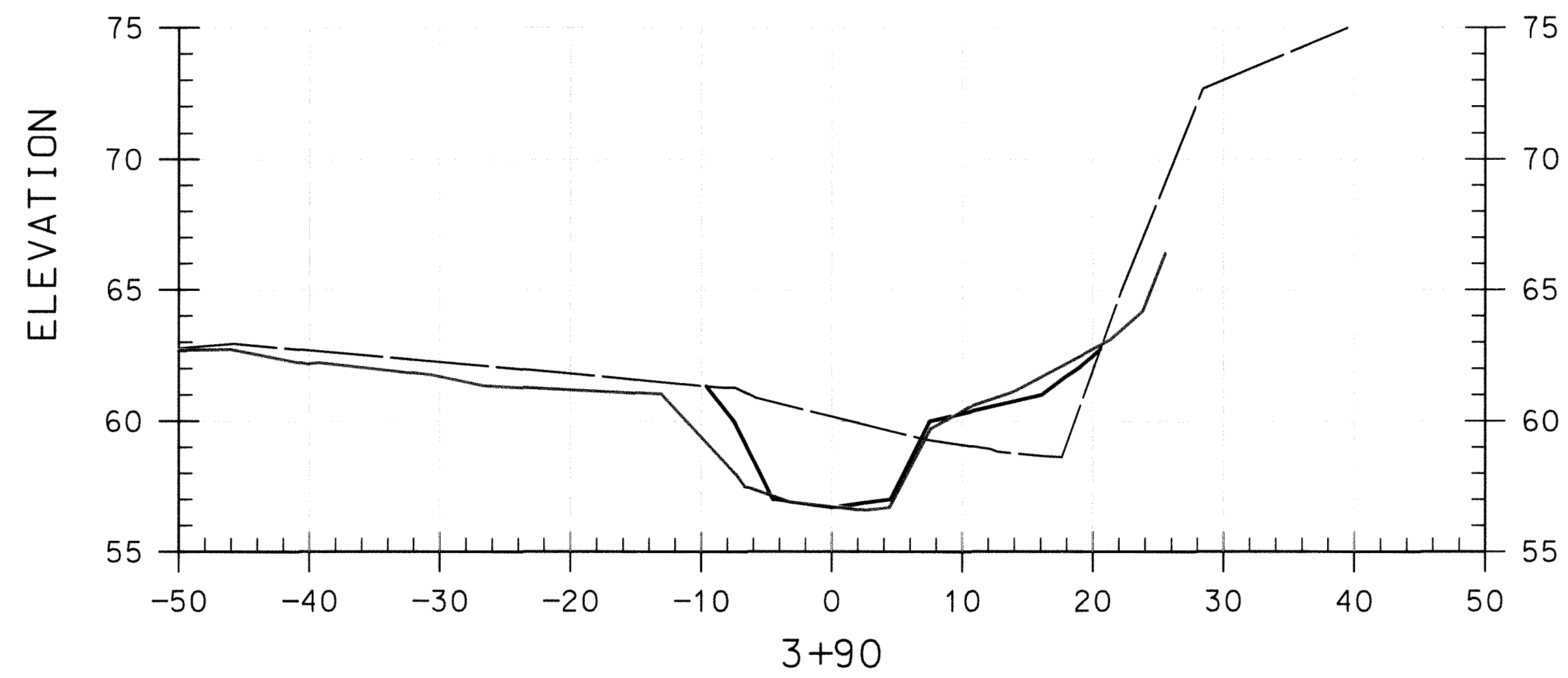

APPROVED: HOWARD COUNTY DEPT. OF PLANNING AND ZONING

\_\_\_\_\_  
CHIEF, DEVELOPMENT ENGINEERING DIVISION      DATE

\_\_\_\_\_  
CHIEF, DIVISION OF LAND DEVELOPMENT      DATE

\_\_\_\_\_  
DIRECTOR      DATE

**LEGEND**

EXISTING GROUND      ————

PROPOSED GRADE      ————

AS BUILT GRADE      ————

PROFESSIONAL CERTIFICATION. I HEREBY CERTIFY THAT THESE DOCUMENTS WERE PREPARED OR APPROVED BY ME, AND THAT I AM A DULY LICENSED PROFESSIONAL ENGINEER UNDER THE LAWS OF THE STATE OF MARYLAND, LICENSE NO. 18470. EXPIRATION DATE: OCTOBER 28, 2011

NO.	REVISIONS DESCRIPTION	DATE

KCIFILE: M:\ 2004 \ 0104-3223.26 \

936 RIDGEBROOK ROAD  
SPARKS, MARYLAND 21152  
TELEPHONE: (410) 316-7800  
Fax: (410) 316-7818  
www.kci.com

**HI-TECH DRIVE  
STREAM RESTORATION**

PATAPSCO VALLEY BUSINESS CENTER  
SECTION 3, AREA 3  
HOWARD COUNTY DEPARTMENT OF RECREATION AND PARKS  
STORMWATER MANAGEMENT DIVISION  
6700 COLUMBIA AVENUE  
COLUMBIA, MARYLAND 21046  
PARCEL 285 TAX MAP 38, ZONING M-2  
ELECTION DISTRICT 01  
HOWARD COUNTY, MARYLAND

**AS-BUILT  
CROSS  
SECTIONS**

SCALE: 0 0.25 0.5 1.0 FEET  
HOR. 1" = 10'  
VERT. 1" = 5'

DATE: July, 2012

KCI JOB NO.: 01-04-3223.26

CAPITAL PROJECT NO.: D - 1122

PERMIT ISSUE:

CONSTRUCTION ISSUE:

SHEET NO.: 7 OF 15

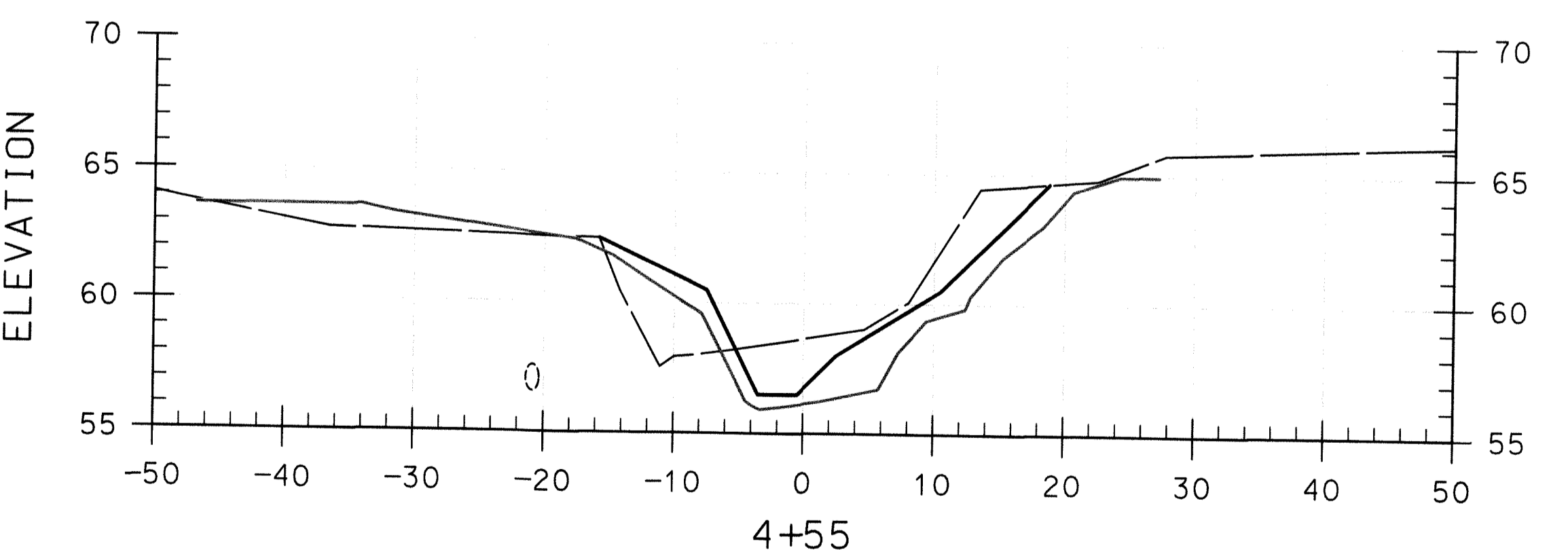
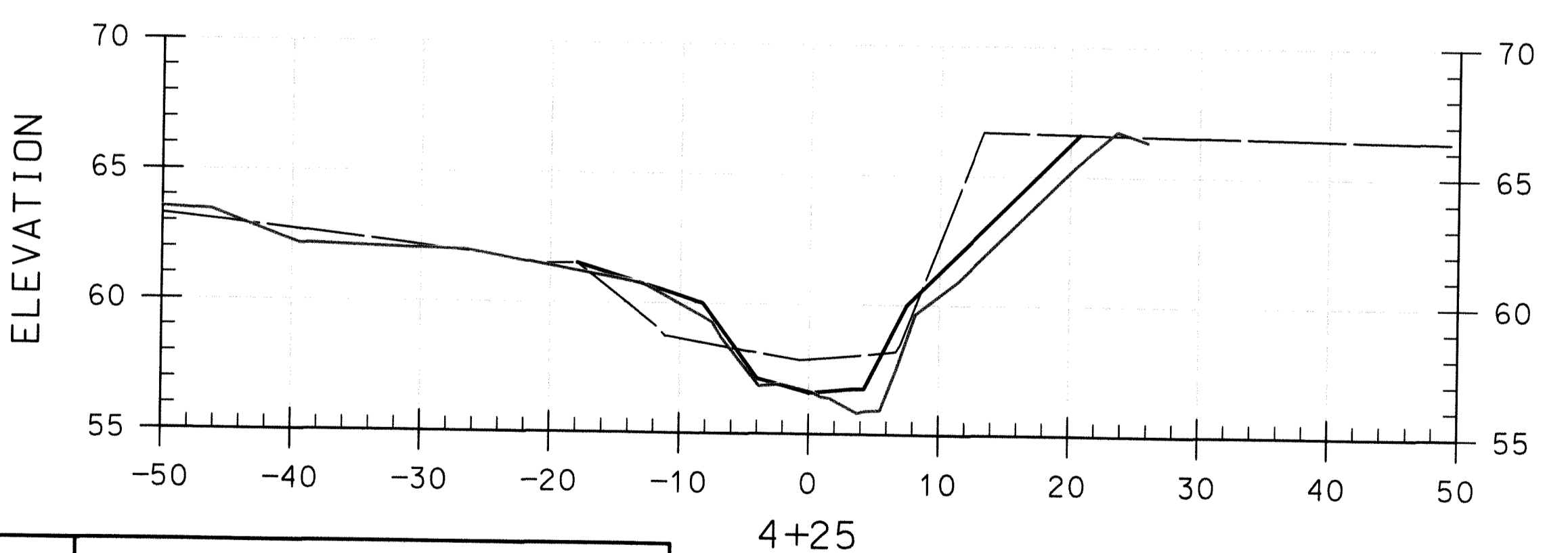
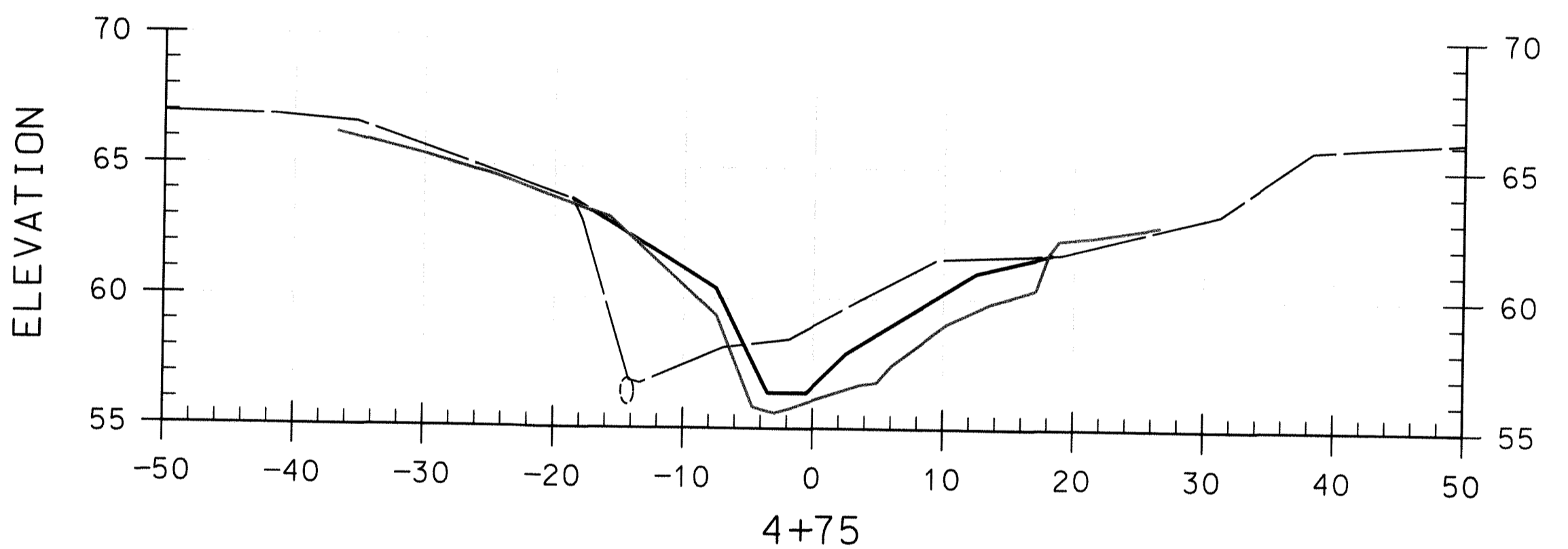
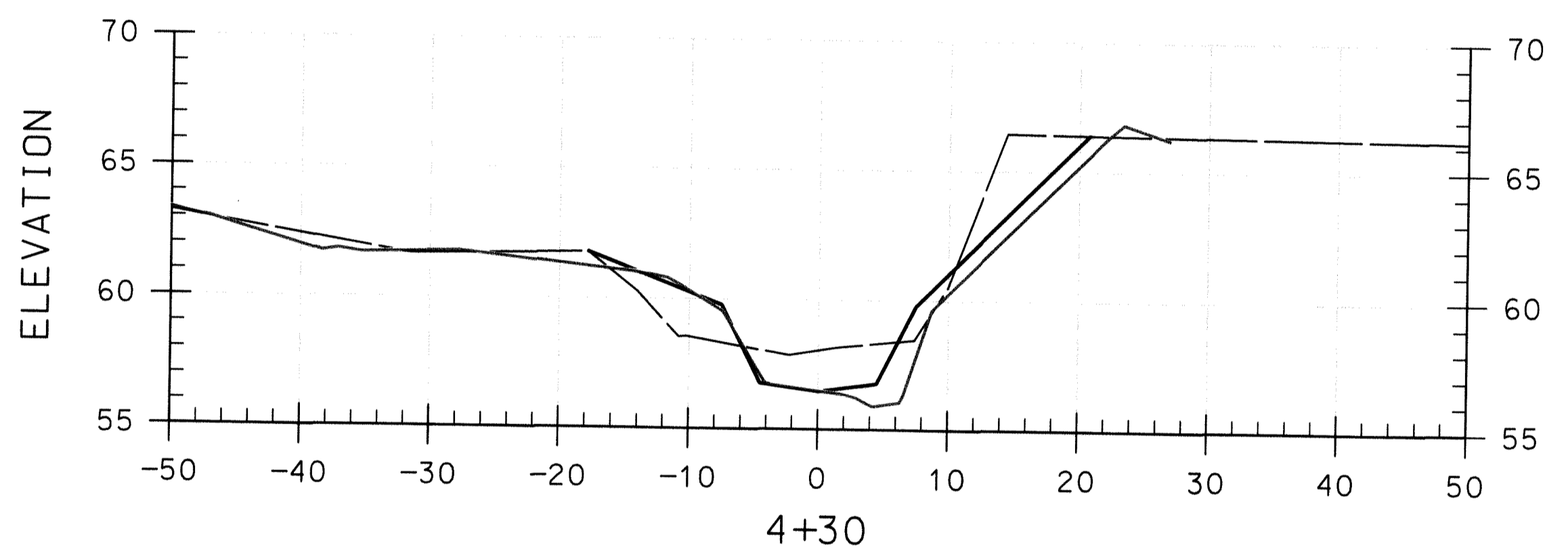
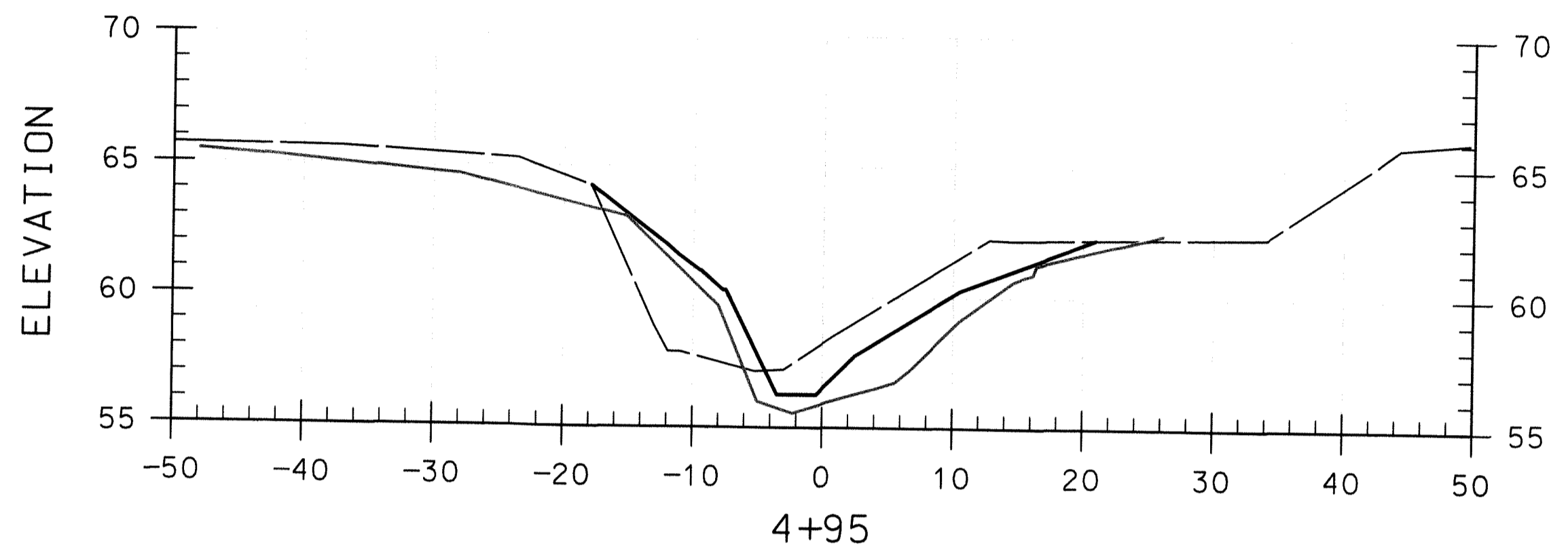
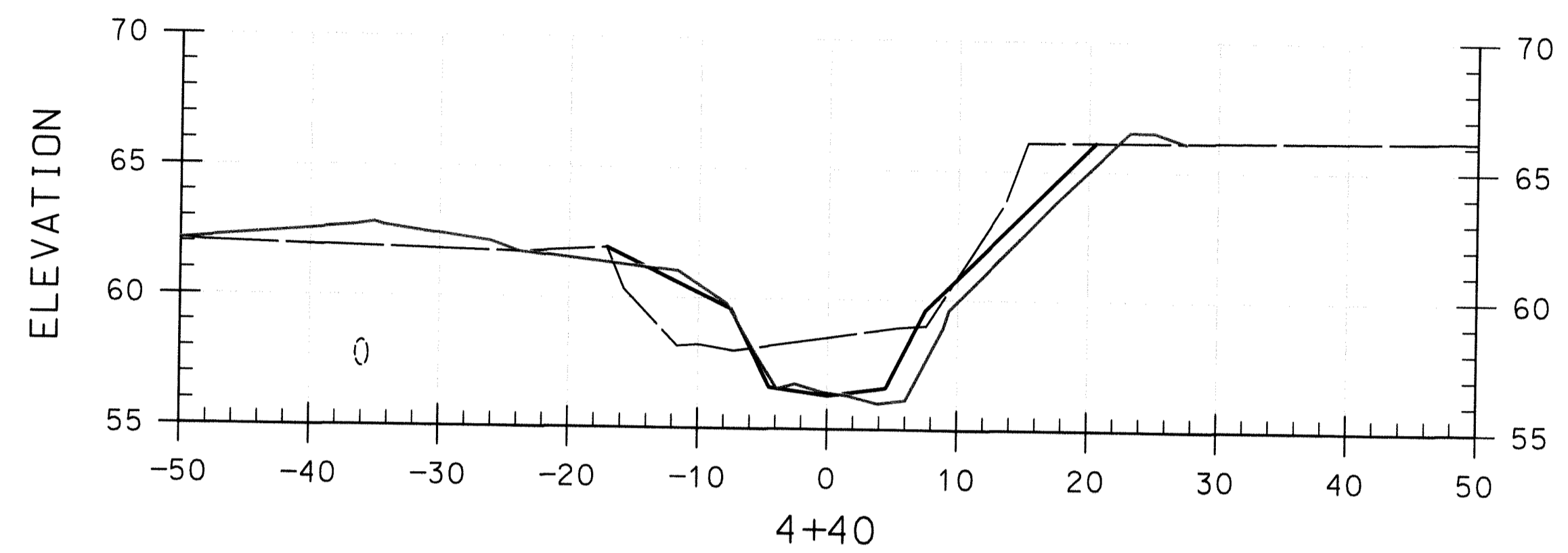
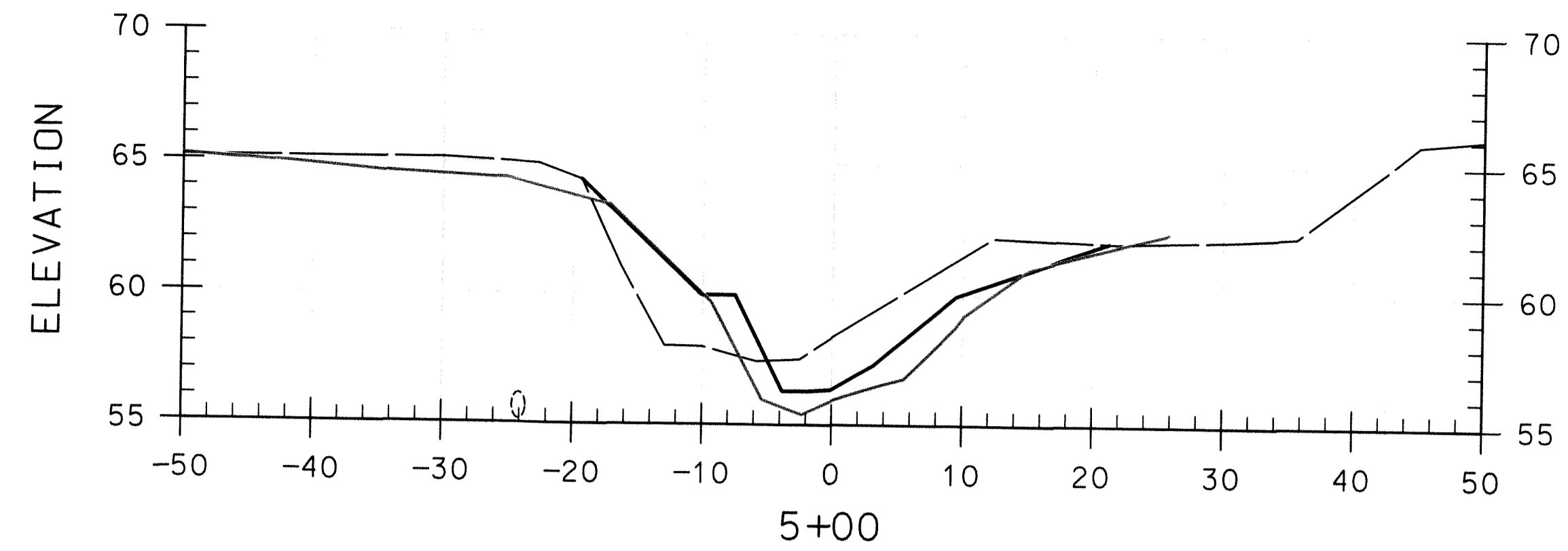
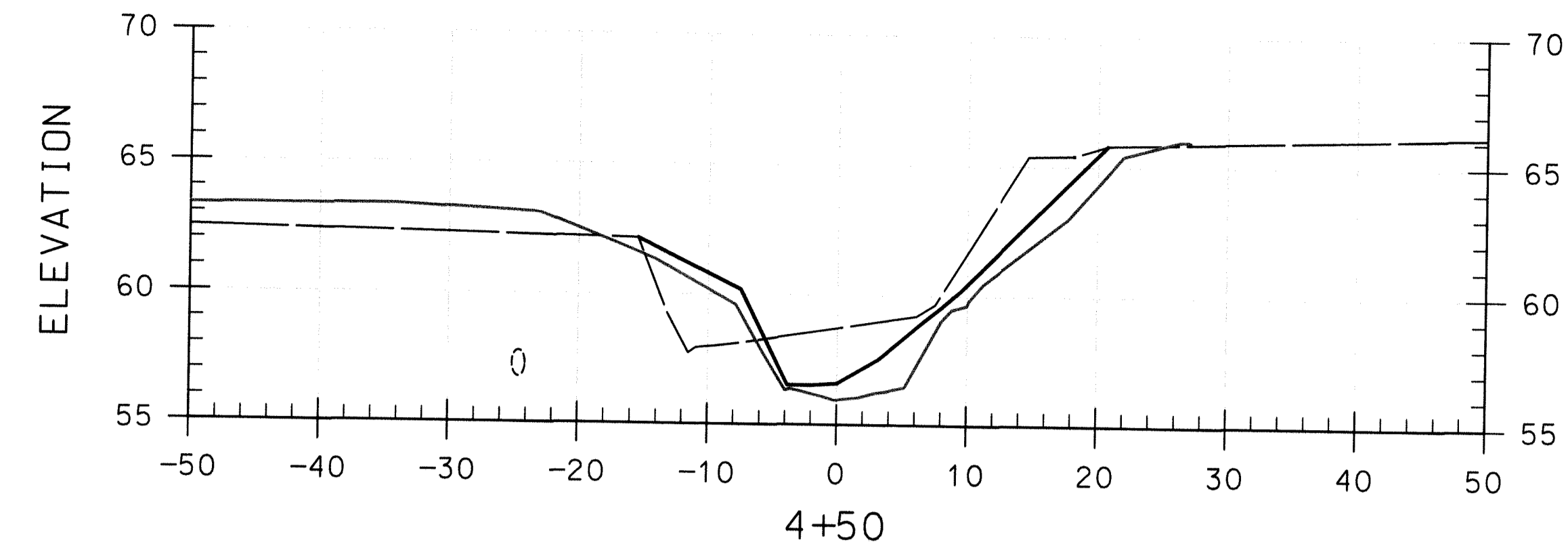

APPROVED: HOWARD COUNTY DEPT. OF PLANNING AND ZONING

CHIEF, DEVELOPMENT ENGINEERING DIVISION DATE

CHIEF, DIVISION OF LAND DEVELOPMENT DATE

DIRECTOR DATE

**LEGEND**  
 EXISTING GROUND \_\_\_\_\_  
 PROPOSED GRADE \_\_\_\_\_  
 AS BUILT GRADE \_\_\_\_\_

PROFESSIONAL CERTIFICATION. I HEREBY CERTIFY THAT THESE DOCUMENTS WERE PREPARED OR APPROVED BY ME, AND THAT I AM A DULY LICENSED PROFESSIONAL ENGINEER UNDER THE LAWS OF THE STATE OF MARYLAND, LICENSE NO. 18470. EXPIRATION DATE: OCTOBER 28, 2011

NO.	REVISIONS DESCRIPTION	DATE

KCI FILE: M\ 2004 \ 01043223.26 \

936 RIDGEBROOK ROAD  
 SPARKS, MARYLAND 21152  
 TELEPHONE: (410) 316-7800  
 FAX: (410) 316-7818  
 www.kci.com



HI-TECH DRIVE  
 STREAM RESTORATION  
 PATAPSCO VALLEY BUSINESS CENTER  
 SECTION 3, AREA 3  
 RECREATION AND PARKS  
 HOWARD COUNTY  
 STORMWATER MANAGEMENT  
 6751 COLUMBIA GATEWAY DRIVE  
 COLUMBIA, MARYLAND 21046  
 PARCEL 285, TAX MAP 38, ZONING M-2  
 ELECTION DISTRICT 01  
 HOWARD COUNTY, MARYLAND

**AS-BUILT  
 CROSS  
 SECTIONS**

SCALE: HORIZ. 1" = 10' VERT. 1" = 5'  
 DATE: July, 2012  
 KCI JOB NO.: 01-043223.26  
 CAPITAL PROJECT NO.: D - 1122  
 PERMIT ISSUE:  
 CONSTRUCTION ISSUE:





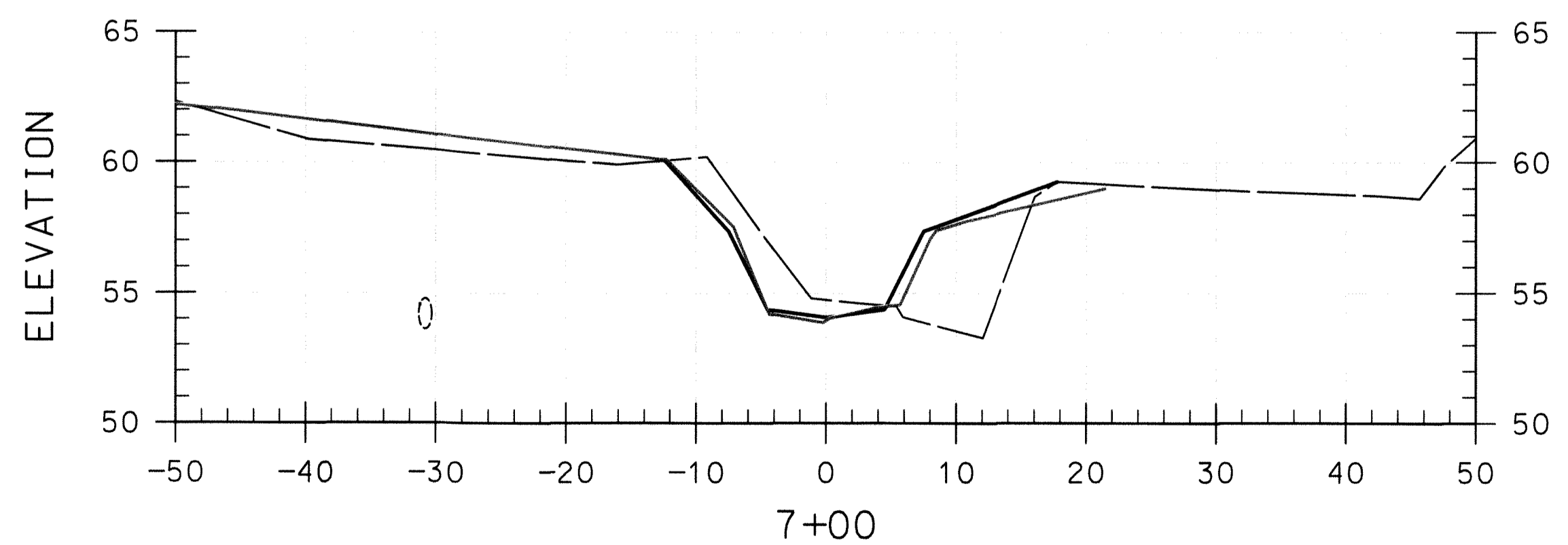
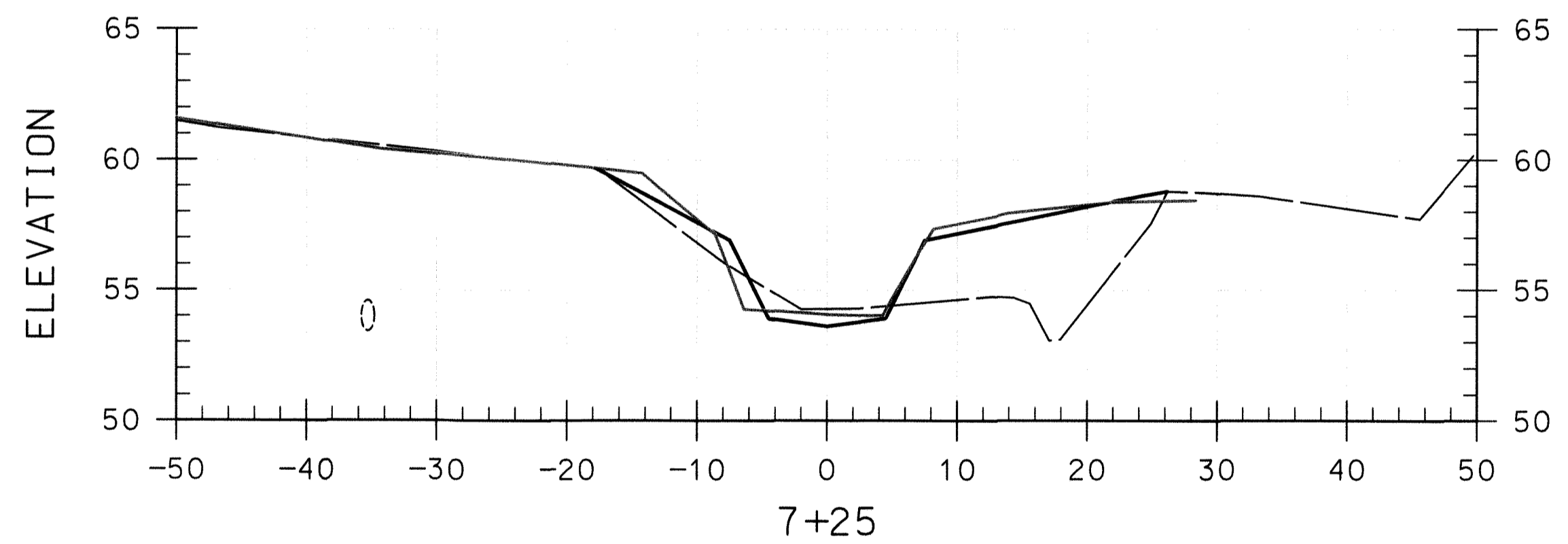
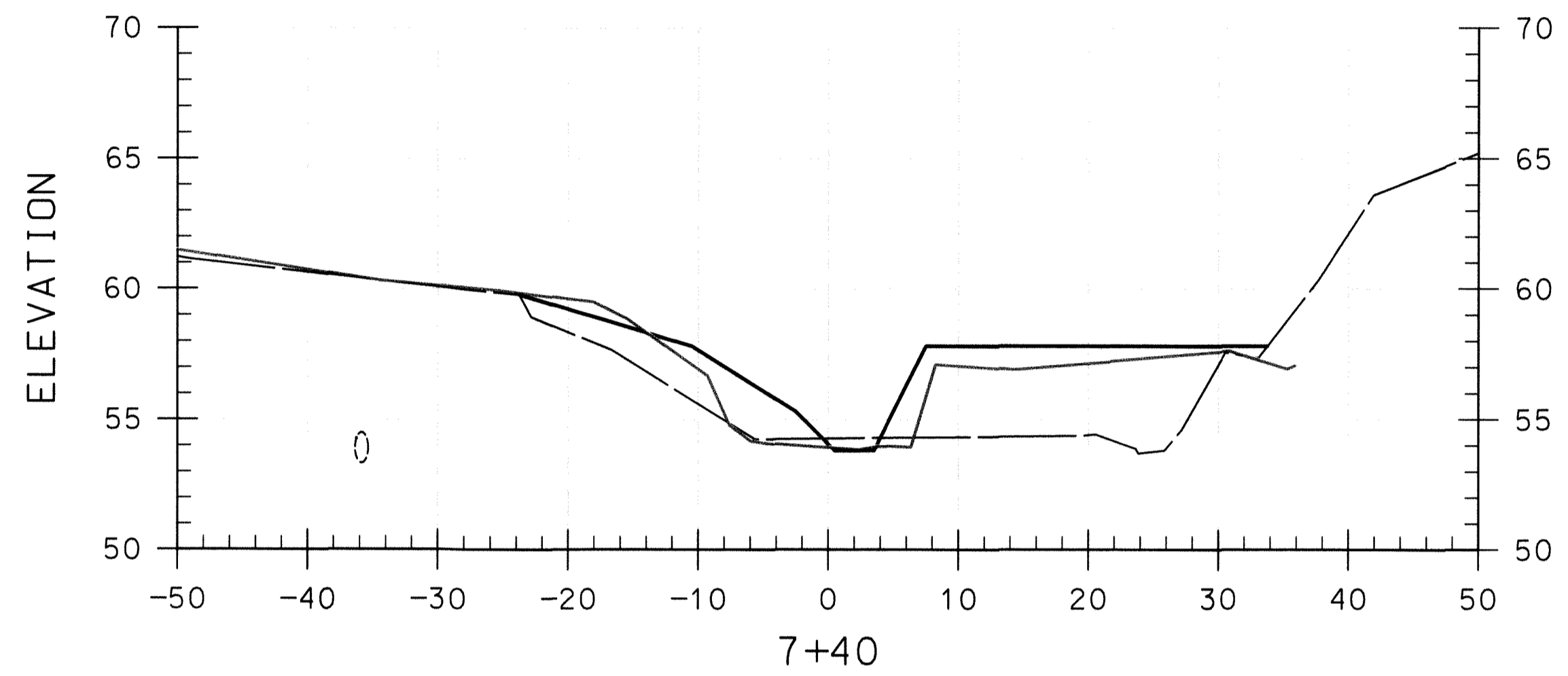
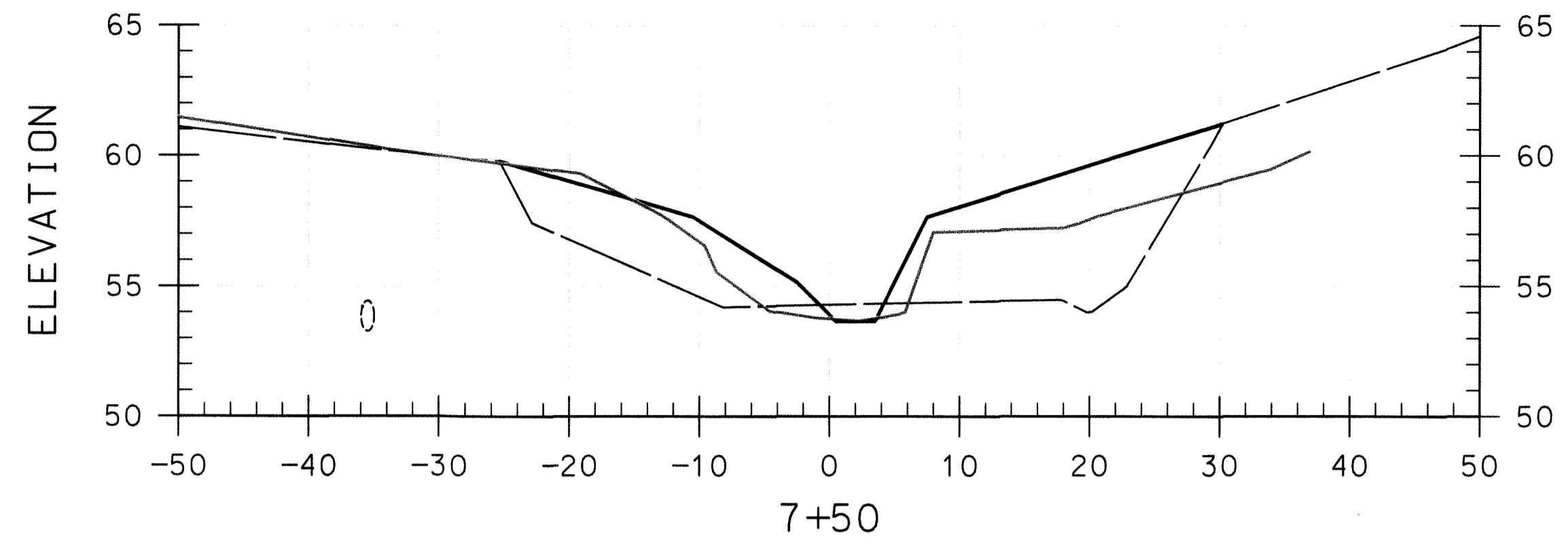
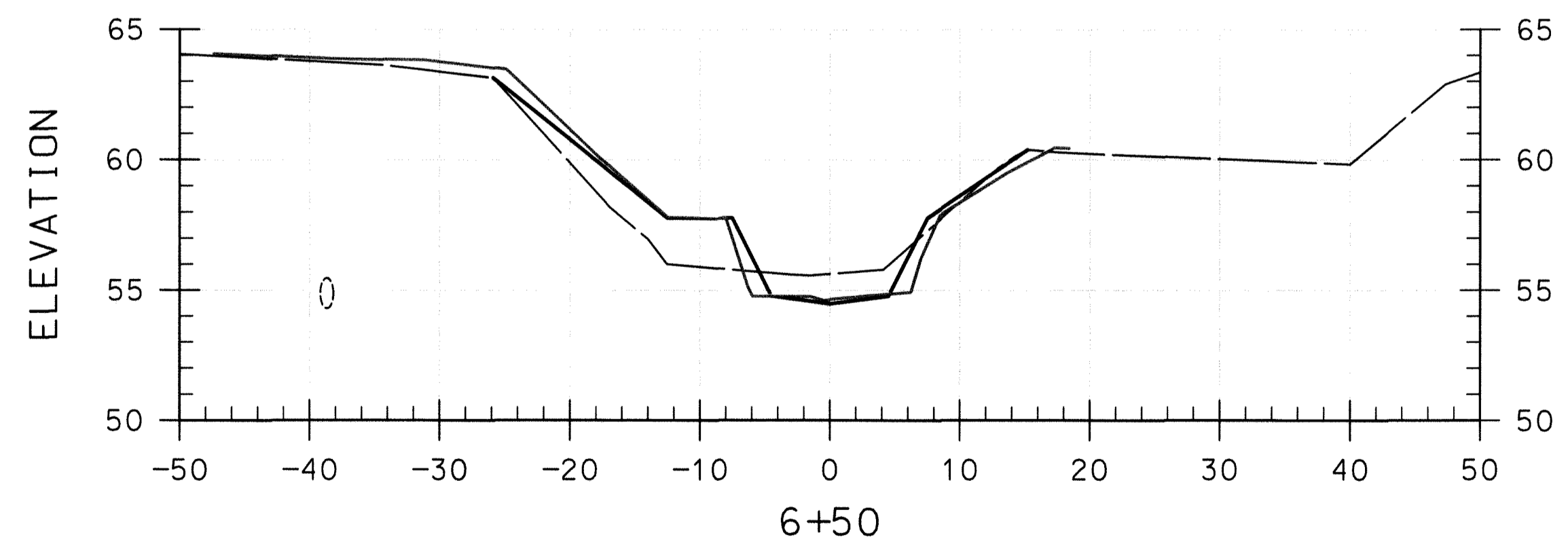
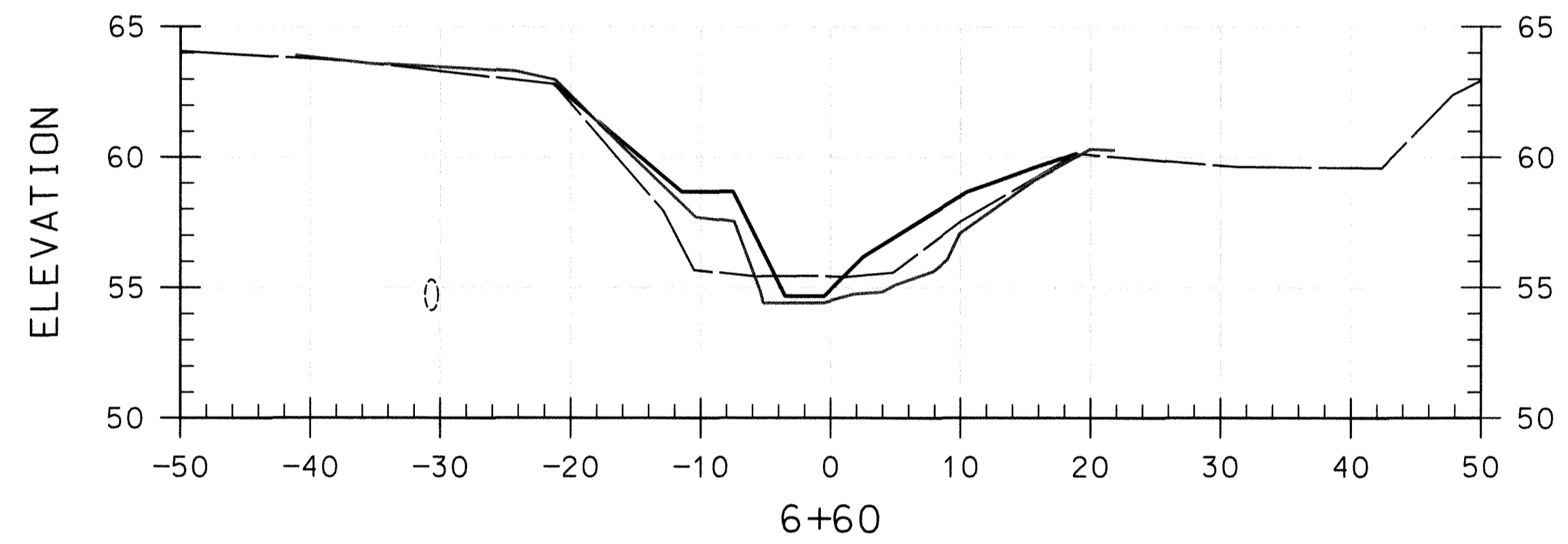
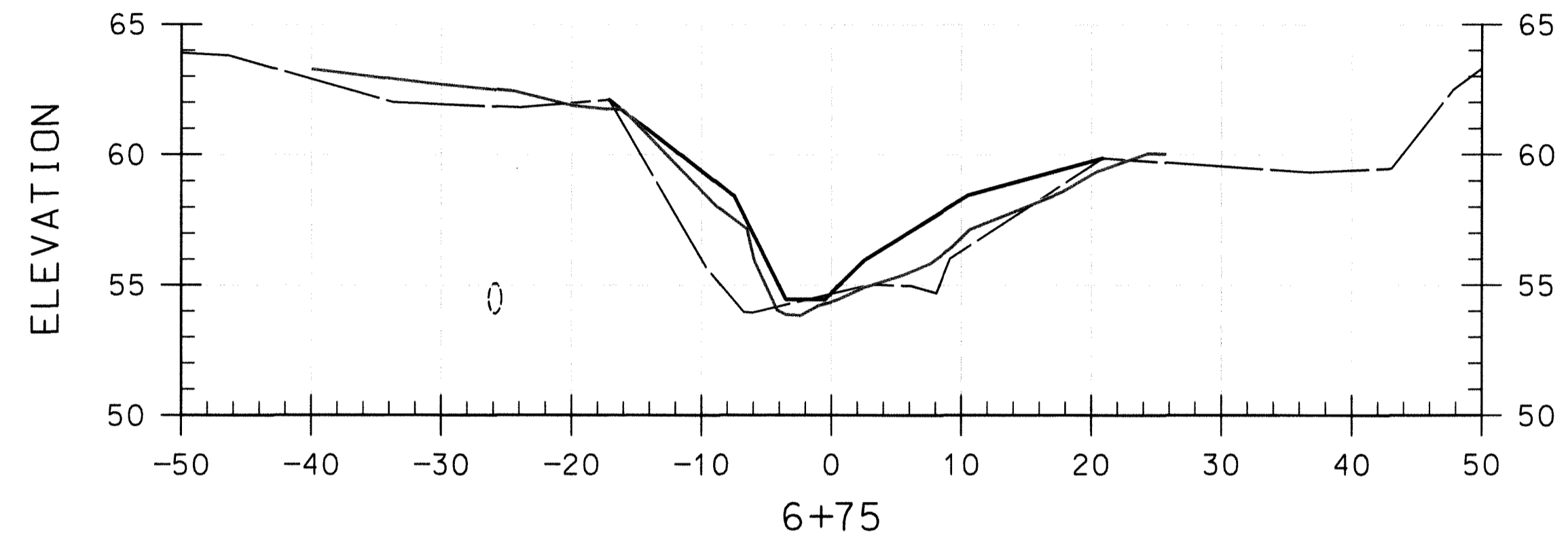
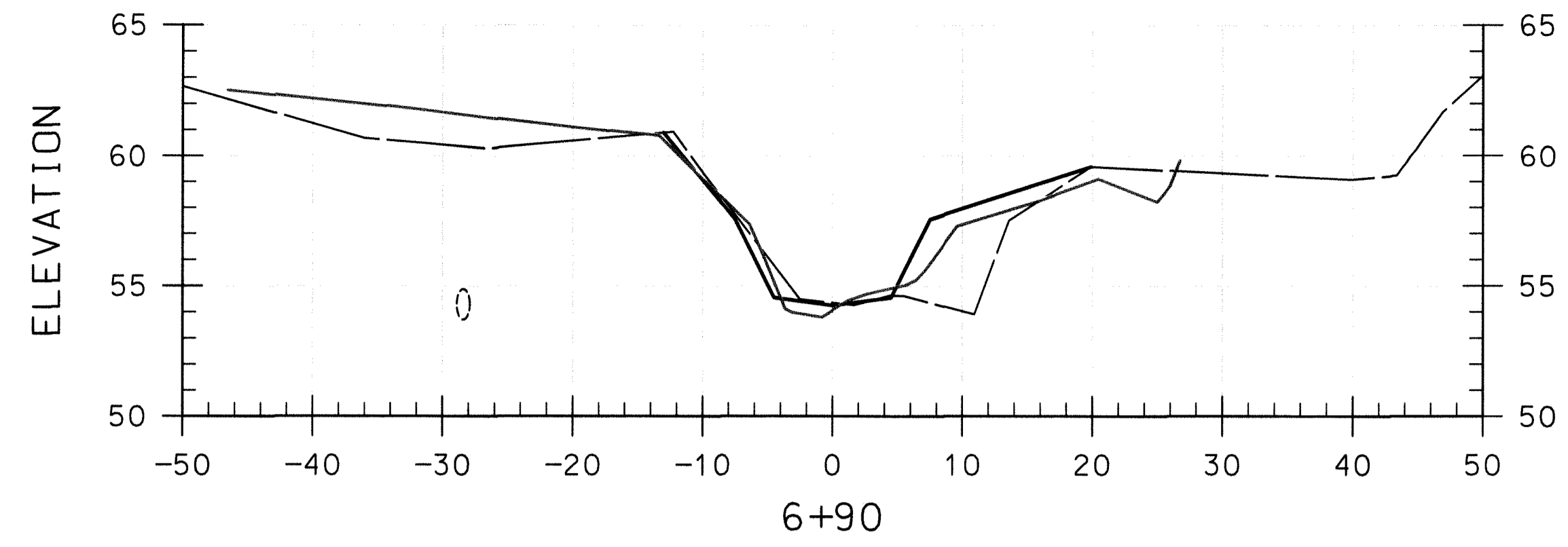

BY: *John P. Finner*, P.E. Division: P050, Natural Res. Emp. FILE: M:\2008\03081755\_38\wmpa\sd0\hrc\_eb\_rev.dgn

PROFESSIONAL CERTIFICATION. I HEREBY CERTIFY THAT THESE DOCUMENTS WERE PREPARED OR APPROVED BY ME, AND THAT I AM A DULY LICENSED PROFESSIONAL ENGINEER UNDER THE LAWS OF THE STATE OF MARYLAND, LICENSE NO. 18470. EXPIRATION DATE: OCTOBER 28, 2011

APPROVED: HOWARD COUNTY DEPT. OF PLANNING AND ZONING

CHIEF, DEVELOPMENT ENGINEERING DIVISION \_\_\_\_\_ DATE \_\_\_\_\_

CHIEF, DIVISION OF LAND DEVELOPMENT \_\_\_\_\_ DATE \_\_\_\_\_

DIRECTOR \_\_\_\_\_ DATE \_\_\_\_\_

**LEGEND**

EXISTING GROUND ————

PROPOSED GRADE ————

AS BUILT GRADE ————

NO.	REVISIONS DESCRIPTION	DATE

KCIFILE: M:\2004\01043223.26 \

936 RIDGEBROOK ROAD  
SPARKS, MARYLAND 21152  
TELEPHONE: (410) 316-7800  
FAX: (410) 316-7818  
www.kci.com

**KCI**  
TECHNOLOGIES



HI-TECH DRIVE  
STREAM RESTORATION  
PATAPSCO VALLEY BUSINESS CENTER  
SECTION 3, AREA 3  
HOWARD COUNTY DEPARTMENT OF RECREATION AND PARKS  
STORMWATER MANAGEMENT DIVISION  
675 COLUMBIA AVENUE, 2ND FLOOR  
PARCEL 285, TAX MAP 38, ZONING M-2  
ELECTION DISTRICT 01  
HOWARD COUNTY, MARYLAND

AS-BUILT  
CROSS  
SECTIONS

SCALE: 0 0.25 0.5 1.0 INCHES  
HOR. 1" = 10'  
VERT. 1" = 5'

DATE: July, 2012

KCI JOB NO.: 01-043223.26

CAPITAL PROJECT NO.: D - 1122

PERMIT ISSUE:

CONSTRUCTION ISSUE:















