

FOR EXTENSION OF MAIN IN OLD WASHINGTON BLVD. SEE PLAN NO. 34017

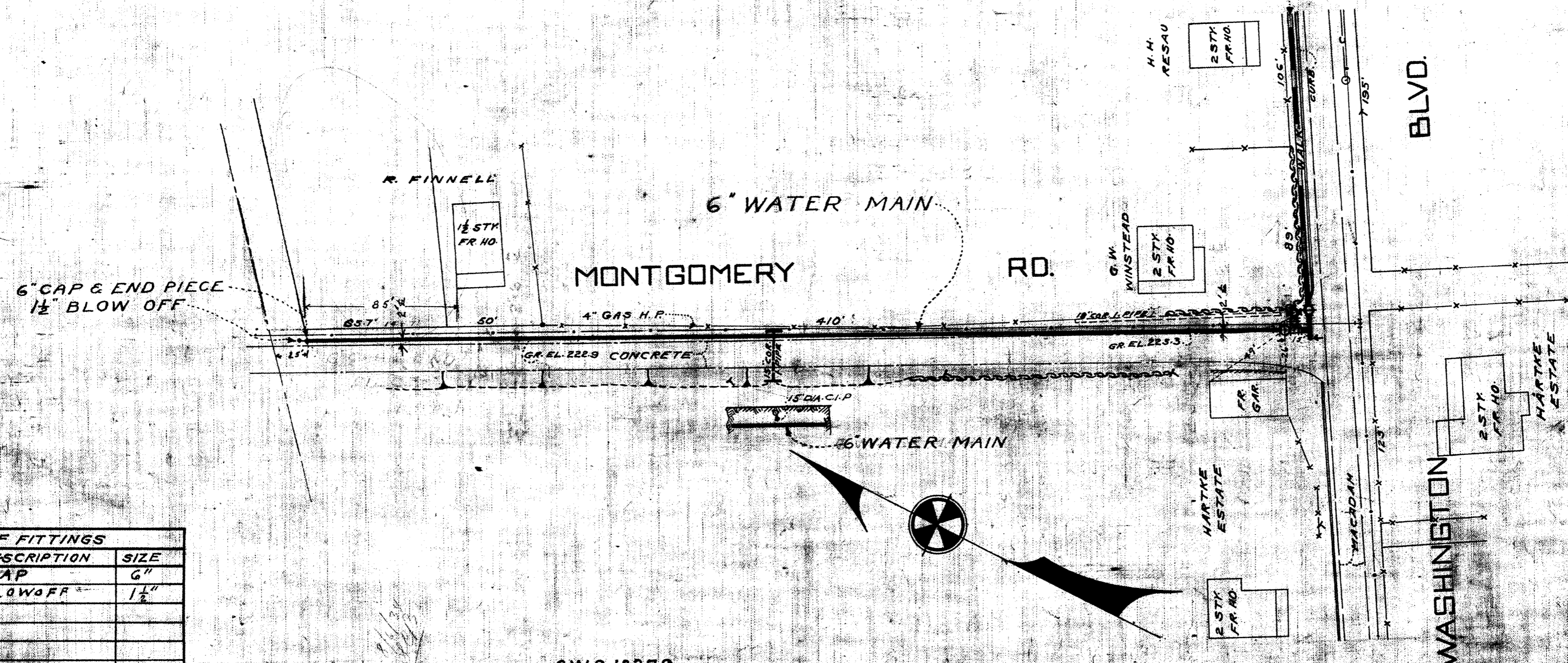

LIST OF FITTINGS

QUANTITY	DESCRIPTION	SIZE
1	CAP	6"
1	BLOW OFF	1 1/2"

C.W.O. 13279

DRAWN BY
TRACED BY
CHECKED
DATE

PLANS PREPARED BY
Robert C. Morris *W. F. Preston*
ELKRIDGE WATER DISTRICT
HOWARD COUNTY MARYLAND

532' OF 6" DIA. CENTRIFUGAL PIPE, CLASS 150

W 105^C 30342

APPROVED BY COUNTY COMMISSIONERS
Wm. H. ...
DATE *March 25*
Harry B. ...

APPROVED FOR CITY OF BALTIMORE
...
DATE
...
WATER ENGINEER CHIEF ENGINEER

PROPOSED WATER IN MONTGOMERY ROAD FROM
OLD WASHINGTON BOULEVARD NORTHERLY
ELKRIDGE MARYLAND

DRAWING NO. 1 OF 1
SCALE: 1" = 50'

JO. 34019 FILE