

LIST OF PIPE FITTINGS

NO.	DESCRIPTION	SIZE
1		8"
1	BLOW	1 1/2"
1	CAPE	8"

230' R.C.I.P.
All Pipe Class 150

STREET GRADE ESTABLISHMENT - SEE LETTER TO WATER ENGINEER DATED MAR. 31, 1953

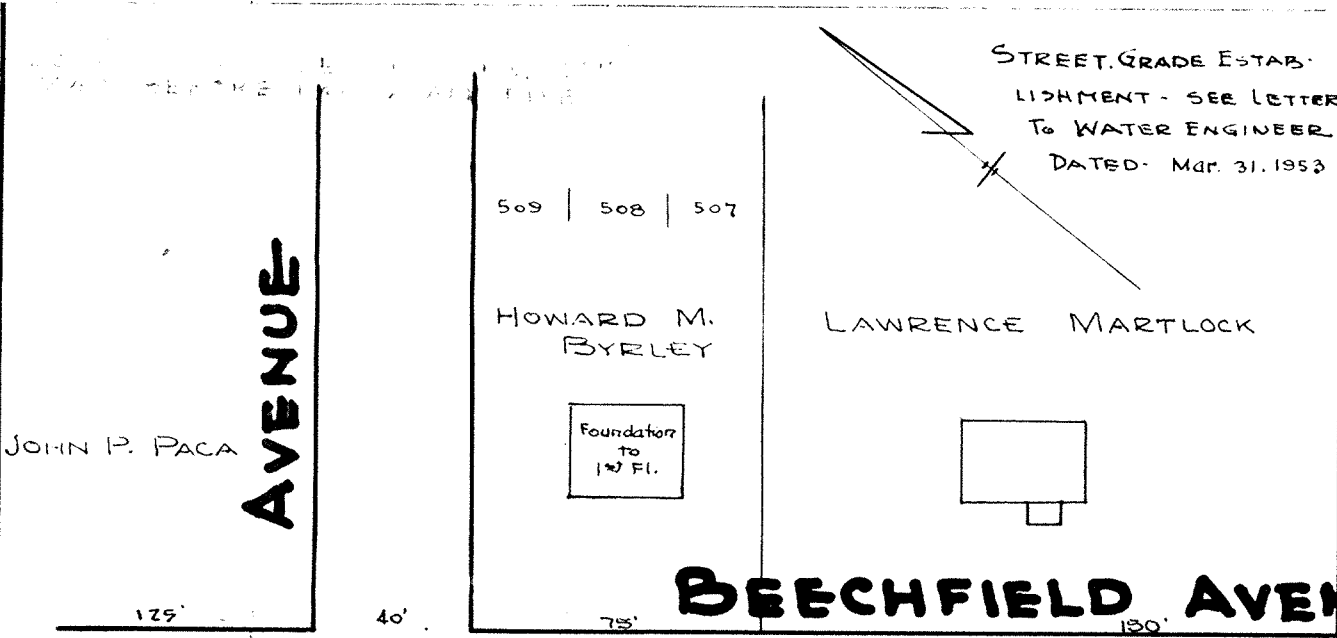

BEECHFIELD AVENUE

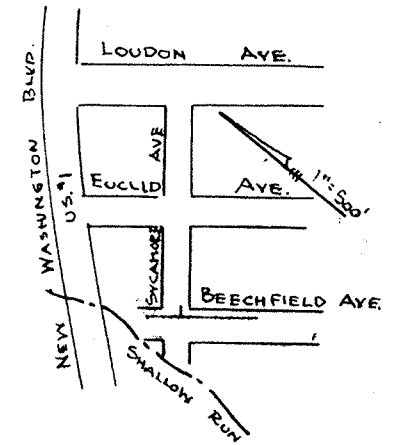

LOCATION MAP

All materials and installations to conform with Baltimore City standards

RIGHT-OF WAY SECURED
DATE: _____ REFERENCE Public Road

PERMIT REQUESTED _____
PERMIT NUMBER _____
GRADE ESTABLISHED _____
PROFILE NUMBER _____

C.W.O. 26162

DRAWN: C.J.
TRACED: E.B.
CHECKED: C.J.
EXAMINED: W.F.

HOWARD COUNTY METROPOLITAN COMMISSION
ELKRIDGE SUB-DISTRICT
MARYLAND

APPROVED BY HOWARD COUNTY METROPOLITAN COMMISSION
DATE: 3/11/53
3/10/53

APPROVED FOR CITY OF BALTIMORE
DATE: 5-1-53
WATER ENGINEER: P. J. Hollansh

PROPOSED 8" WATER MAIN EXTENSION IN BEECHFIELD AVE. FROM A POINT 400' N.W. OF HIGHLAND AVE. TO SYCAMORE AVE.

PREPARED BY WILLIAM M. D. PURDUM CIVIL ENGINEER
2326 N. Charles Street Baltimore 18, Maryland Reg. No. 1992
DRAWING NO. 1 OF 1
SCALE 1" = 50'
DATE FILE