

# BETHANY GLEN ARAH - PHASE II PUBLIC WATER & PUBLIC SEWER PLANS

**LOTS 25-60, 65-116 AND  
OPEN SPACE LOTS 164 THRU 167  
LOCATION OF SITE**

**9891 OLD FREDERICK ROAD - ROUTE 99  
TAX MAP 17, GRID 15, PARCEL 34  
2ND ELECTION DISTRICT  
HOWARD COUNTY, MARYLAND  
CONTRACT No. 24-5236-D**

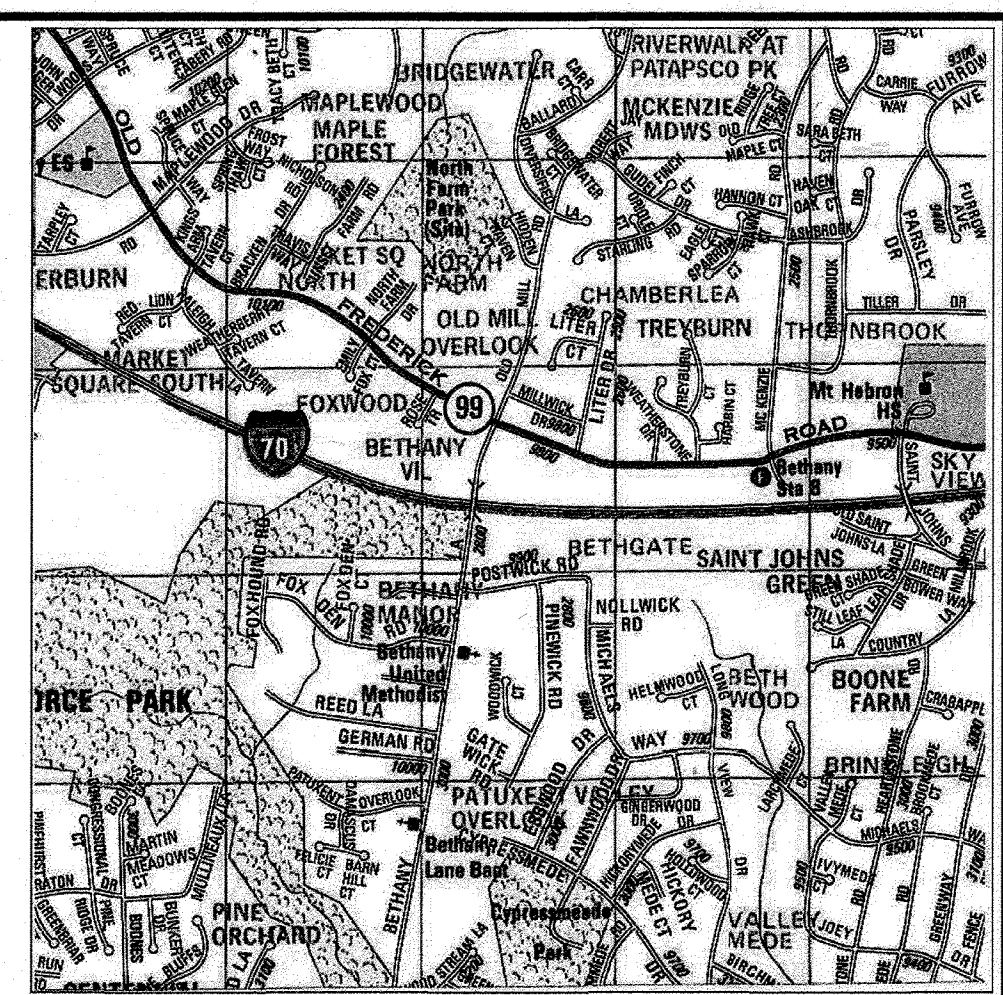

BENCHMARK	
GEODETIC SURVEY CONTROL - 17GB	ELEV. 441.515'
	N 592,856.774
	E 1,353,019.981
GEODETIC SURVEY CONTROL - 17EE	ELEV. 453.949'
	N 593,815.262
	E 1,355,774.821

### GENERAL NOTES

- APPROXIMATE LOCATIONS OF EXISTING MAINS ARE SHOWN. THE CONTRACTOR SHALL TAKE ALL NECESSARY PRECAUTIONS TO PROTECT EXISTING MAINS AND SERVICES AND MAINTAIN UNINTERRUPTED SERVICE. ANY DAMAGE INCURRED SHALL BE REPAIRED IMMEDIATELY TO THE SATISFACTION OF THE ENGINEER AT THE CONTRACTOR'S EXPENSE.
- TOPOGRAPHIC FIELD SURVEYS WERE PERFORMED ON MARCH 04, 2016 BY BOHLER ENGINEERING.
- THE COORDINATES SHOWN HEREON ARE BASED UPON THE HOWARD COUNTY GEODETIC CONTROL WHICH IS BASED UPON THE MARYLAND STATE PLANE COORDINATE SYSTEM. HORIZONTAL AND VERTICAL CONTROL DATUM ARE BASED ON HOWARD COUNTY MONUMENT NOS. 17EE AND 17GB WHICH WERE USED FOR THIS PROJECT.  
HOWARD COUNTY MONUMENT NO. 17EE ELEV. = 453.949'  
HOWARD COUNTY MONUMENT NO. 17GB ELEV. = 441.515'
- ALL PIPE ELEVATIONS SHOWN ARE INVERT ELEVATIONS UNLESS OTHERWISE NOTED ON THE PLANS.
- CLEAR ALL UTILITIES BY A MINIMUM OF 12 INCHES. CLEAR ALL POLES BY 5'-0" MINIMUM OR TUNNEL AS REQUIRED UNLESS OTHERWISE NOTED. THE OWNER HAS CONTACTED THE UTILITY COMPANIES AND HAS MADE ARRANGEMENTS FOR BRACING OF POLES AS SHOWN ON THE DRAWINGS. IN THE EVENT THE CONTRACTOR'S WORK REQUIRES THE BRACING OF ADDITIONAL POLES, ANY COST INCURRED BY THE OWNER FOR THE BRACING OF ADDITIONAL POLES OR DAMAGES SHALL BE DEDUCTED FROM MONIES OWED BY THE CONTRACTOR. THE CONTRACTOR SHALL COORDINATE WITH THE UTILITY COMPANIES TO SCHEDULE THE BRACING OF THE POLES.
- FOR DETAILS NOT SHOWN ON THE DRAWING, AND FOR MATERIALS AND CONSTRUCTION METHODS, USE HOWARD COUNTY DESIGN MANUAL, VOLUME IV, STANDARD SPECIFICATIONS AND DETAILS FOR CONSTRUCTION (LATEST EDITION). THE CONTRACTOR SHALL HAVE A COPY OF VOLUME IV ON THE JOB.
- WHERE TEST PITS HAVE BEEN MADE ON EXISTING UTILITIES, THEY ARE NOTED BY THE SYMBOL AT THE LOCATIONS OF THE TEST PITS. A NOTE ON NOTES CONTAINING THE RESULTS OF THE TEST PIT OR PITS IS INCLUDED ON THE DRAWINGS. EXISTING UTILITIES IN THE VICINITY OF THE PROPOSED WORK FOR WHICH TEST PITS HAVE NOT BEEN DUG SHALL BE LOCATED BY THE CONTRACTOR TWO WEEKS IN ADVANCE OF CONSTRUCTION OPERATIONS AT HIS OWN EXPENSE.
- THE CONTRACTOR SHALL NOTIFY THE FOLLOWING UTILITY COMPANIES OR AGENCIES AT LEAST FIVE WORKING DAYS BEFORE STARTING WORK SHOWN ON THESE PLANS:  
AT & T 1-800-252-1133  
BOE (CONSTRUCTION SERVICES) 410-637-8713  
BOE (EMERGENCY) 410-685-0123  
BUREAU OF UTILITIES 410-313-4900  
COLONIAL PIPELINE COMPANY 410-795-1390  
MISS UTILITY 1-800-257-7777  
STATE HIGHWAY ADMINISTRATION 410-531-5533  
VERIZON 1-800-743-0033
- TREES AND SHRUBS ARE TO BE PROTECTED FROM DAMAGE TO THE MAXIMUM EXTENT. TREES AND SHRUBS LOCATED WITHIN THE CONSTRUCTION STRIP ARE NOT TO BE REMOVED OR DAMAGED BY THE CONTRACTOR.
- THE CONTRACTOR SHALL REMOVE TREES, STUMPS, AND ROOTS ALONG THE LINE OF EXCAVATION. PAYMENT FOR SUCH REMOVAL SHALL BE INCLUDED IN THE UNIT PRICE BID FOR CONSTRUCTION OF THE MAIN.
- THE CONTRACTOR SHALL NOTIFY THE BUREAU OF HIGHWAYS, HOWARD COUNTY, AT (410)313-7450 AT LEAST FIVE WORKING DAYS BEFORE OPEN CUTTING OR BORING/JACKING OF ANY COUNTY ROAD FOR LAYING WATERSEWER MAINS OR HOWARD CONNECTIONS. THE APPROVAL OF THESE DRAWINGS WILL CONSTITUTE COMPLIANCE WITH DPW REQUIREMENTS PER SECTION 18.11(A) OF THE HOWARD COUNTY CODE.
- A WAIVER REQUEST FROM THE HOWARD COUNTY DESIGN MANUAL VOL. II, WATER AND SEWER SECTION 4.3.B.3.B AND 4.5.E FOR LOTS 22, 23, 28, 42 & 43 (NO BASEMENT GRAVITY SERVICE) WILL BE SUBMITTED TO HOWARD COUNTY DEPARTMENT OF PUBLIC WORKS FOR APPROVAL. AS A RESULT OF TOPOGRAPHY CAUSING DEPTHS OF SEWER IN EXCESS OF 20 FEET, BASEMENT SEWER SERVICE CANNOT BE PROVIDED TO THESE PROPOSED LOTS. FOR THESE LOTS, GRAVITY SEWER SERVICE TO BE PROVIDED TO FIRST FLOOR ONLY. BASEMENT SERVICE TO BE PROVIDED BY PRIVATE ON-SITE PUMP. THE APPROVAL AND INSPECTION OF ON-SITE PUMPING UNITS INCLUDES THE DEPARTMENT OF INSPECTION, LICENSE AND PERMIT (DILP).
- REFER TO SHEET 11 FOR STRUCTURE SCHEDULES.
- SEDIMENT CONTROL MEASURES FOR THIS CONTRACT WILL BE IMPLEMENTED IN ACCORDANCE WITH SECTION 308 OF THE SPECIFICATIONS AND AS SHOWN ON F-22-033.
- A WAIVER REQUEST HAS BEEN SUBMITTED PENDING APPROVAL FOR THE FOLLOWING:  
a. ALTERNATIVE PIPE MATERIAL SUBSTITUTION OF C900 TO BE USED IN LIEU OF DIP FOR SEWER DEPTHS MORE THAN 16 FEET.  
b. MINIMUM VERTICAL CLEARANCES OF LESS THAN 1'-0" FROM OTHER UTILITIES OR LESS THAN 2' FROM STREET TO CASING PIPE.
- A WAIVER REQUEST HAS BEEN SUBMITTED PENDING APPROVAL FOR THE FOLLOWING:  
a. MAXIMUM COVER PERMITTED OVER DISTRIBUTION MAINS GREATER THAN 8'-0"

### WATER NOTES

- ALL WATER MAINS TO BE P.V.C. CLASS (DR-14) C900 UNLESS OTHERWISE NOTED.
- TOPS OF ALL WATER MAINS TO HAVE A MINIMUM OF 3'-6" OF COVER UNLESS OTHERWISE NOTED.
- VALVES ADJACENT TO TEES SHALL BE STRAPPED TO TEES.
- ALL FITTINGS SHALL BE BUTTRESSED OR ANCHORED WITH CONCRETE IN ACCORDANCE WITH THE STANDARD DETAILS UNLESS OTHERWISE PROVIDED FOR ON THE DRAWINGS.
- FIRE HYDRANTS SHALL BE SET TO THE BURY LINE ELEVATIONS SHOWN ON THE DRAWINGS. ALL FIRE HYDRANTS SHALL BE RESTRAINED AND BUTTRESSED WITH CONCRETE IN ACCORDANCE WITH THE STANDARD DETAILS. THE SOIL AROUND THE FIRE HYDRANT SHALL BE COMPACTED IN ACCORDANCE WITH SECTION 1000 AND 1005 OF THE STANDARD SPECIFICATIONS.
- THE CONTRACTOR SHALL NOT OPERATE ANY WATER MAIN VALVES ON THE EXISTING WATER SYSTEM.
- TRACER WIRES AND CONTINUITY TEST STATION SHALL BE INSTALLED ON ALL DIP AND PVC WATER MAINS IN ACCORDANCE WITH HOWARD COUNTY DESIGN MANUAL.
- FOR PVC WATER MAINS, ALL RECORDS FOR THE QUALITY CONTROL AND QUALIFICATIONS TEST REQUIREMENTS NOTED IN SECTION 5.1 OF THE AWWA STANDARD C900 FOR PVC PRESSURE PIPE SHALL BE SUBMITTED WITH PIPE MATERIALS CERTIFICATIONS OR SHOP DRAWING PRIOR TO APPROVAL OF THE MATERIAL FOR USE. THE TEST RECORDS SHALL BE FOR THE PIPE TO BE INSTALLED UNDER THIS CONTRACT. ALL PVC PIPE SHALL CONTAIN MARKINGS TO ALLOW CROSS REFERENCING OF THE PIPE SUPPLIED TO THE TEST RECORDS RECEIVED.
- UNLESS OTHERWISE NOTED ON THE PLANS OR IN THE SPECIFICATIONS SACRIFICIAL ANODES SHALL BE ON ALL VALVES AND METALLIC FITTINGS USED WITH PVC WATER MAINS IN ACCORDANCE WITH VOLUME IV, STANDARD SPECIFICATIONS AND DETAILS FOR CONSTRUCTION. SEVENTEEN (17) POUND MAGNESIUM ANODES SHALL BE INSTALLED ON ALL VALVES AND DUCTILE IRON FITTINGS INCLUDING RESTRAINS AND HANGES. TWELVE (12) POUND ZINC ANODES SHALL BE INSTALLED ON ALL STAINLESS STEEL FITTINGS AND SADDLES USED WITH PVC MAINS. ALL TEES USED WITH PVC MAINS SHALL BE DUCTILE IRON.
- PROPER ASSEMBLY OF GASKETED PVC PIPE JOINTS: THE MANUFACTURER'S INSERTION LINE OF GASKETED PVC PIPE JOINTS INDICATES THE MAXIMUM DEPTH OF INSERTION OF THE SPIGOT INTO THE BELL. AFTER ASSEMBLY OF THE JOINT, THE INSERTION LINE SHALL REMAIN VISIBLE. DUAL INSERTION LINES ON GASKETED PVC PIPE INDICATE THE MAXIMUM AND MINIMUM DEPTH OF INSERTION OF THE SPIGOT INTO THE BELL. THE CONTRACTOR SHALL NOT OVER INSERT OR OVER HOME THE SPIGOT INTO THE BELL OF PVC PIPE.
- ALL CHANGES IN HORIZONTAL OR VERTICAL DIRECTION OF PVC WATER PIPE SHALL BE MADE WITH STANDARD BENDS, 5-DEGREE SWEEPS OR HIGH DEFLECTION (HD) COUPLINGS. NO BENDING OF THE PIPE OR DEFLECTING OF PVC PIPE JOINTS IS PERMITTED. WHERE HIGH DEFLECTION COUPLINGS OR 5-DEGREE SWEEPS ARE PERMITTED, THE CONTRACTOR SHALL PROVIDE ONE FULL PIPE LENGTH (20-FOOT LONG) ON EITHER SIDE OF THE HIGH DEFLECTION COUPLINGS OR 5-DEGREE SWEEP. THE CONTRACTOR SHALL USE A VIBRATORY PLATE COMPACTOR OR OTHER APPROVED MEANS TO THOROUGHLY COMPACT THE #57 STONE ON BOTH SIDES OF THE HIGH DEFLECTION COUPLING OR 5-DEGREE SWEEP. TAKING CARE NOT TO USE COMPACTION EQUIPMENT DIRECTLY OVER THE FITTING.
- PVC HIGH DEFLECTION COUPLINGS SHALL BE LIMITED TO A TOTAL DEFLECTION OF 3-DEGREES (1 1/2-DEGREE ON EITHER END OF THE COUPLING), SHALL BE RATED FOR A MINIMUM 200 PSI MEETING THE REQUIREMENTS OF AWWA C900. SHALL HAVE A MINIMUM LAY LENGTH OF 8-INCHES AND SHALL HAVE CENTER STOPS. PVC HIGH DEFLECTION COUPLINGS SHALL BE CERTAINTYPE PVC HIGH DEFLECTION (HD) STOP COUPLINGS OR EQUAL.
- FIVE DEGREE SWEEPS SHALL BE BELL BY SPIGOT, RATED FOR A MINIMUM 225 PSI, DR18 MEETING THE REQUIREMENTS OF AWWA C900 AND SHALL BE MULTI FITTINGS (IFX) BLUE BRUTE DR18 OR EQUAL.
- WHEN PVC HIGH DEFLECTION COUPLINGS OR PVC 5-DEGREE SWEEPS ARE USED TO FACILITATE CHANGES IN HORIZONTAL OR VERTICAL ALIGNMENTS OF AWWA C-900 PVC PIPELINES, THE CONTRACTOR SHALL INSTALL DEVICES FOR THE PREVENTION OF OVER-INSERTION OF THE PVC PIPE SPIGOTS OR PLAN ENDS INTO THE PUSH ON BOTH SIDES OF THE HIGH DEFLECTION COUPLINGS AND 5 DEGREE SWEEPS. BELL STOPS SHALL BE PLACED AT THE PROPER INSERTION LINE FOR THE FITTING. THE BELL STOP SHALL BE MANUFACTURED OF DUCTILE IRON AND INCORPORATE AN EXPANSION OR RETENTION SPRING TO ALLOW FOR PIPE EXPANSION AND CONTRACTION. THE BELL STOPS SHALL BE SERIES 5000 MEGA-STOP, AS MANUFACTURED BY EBAA IRON, INC. OR APPROVED EQUAL.
- EACH DWELLING WILL BE SERVED BY A 1-1/2" DIAMETER WHC, WITH A 1" METER WHICH WILL BE LOCATED AT THE PROPERTY LINE. THE PREFERRED LOCATION OF THE OUTSIDE WATER METER SETTING IS IN A GRASS AREA WITH THE ROAD RIGHT-OF-WAY AND OUTSIDE OF TRAFFIC BEARING AREAS.

### SEWER NOTES:

- ALL SEWER MAINS SHALL BE D.I.P. OR P.V.C. UNLESS OTHERWISE NOTED
- ALL MANHOLES SHALL BE 4'-0" INSIDE DIAMETER UNLESS OTHERWISE NOTED
- FORCE MAINS SHALL BE D.I.P. ONLY
- MANHOLES SHOWN WITH 12" AND 16" WALLS ARE FOR BRICK MANHOLES ONLY
- MANHOLES DESIGNATED "W" IN PLAN AND PROFILE SHALL HAVE WATERTIGHT FRAME AND COVER. STANDARD DETAIL G.5.2 WHERE WATERTIGHT MANHOLE FRAMES AND COVERS ARE USED. SET TOP OF FRAME 1'-6" ABOVE FINISHED GRADE UNLESS OTHERWISE NOTED ON THE DRAWINGS
- HOUSE(S) WITH THE SYMBOL INDICATES THE CELLAR CANNOT BE SERVED

SHEET INDEX	
SHEET TITLE	SHEET NUMBER
TITLE SHEET	1
PUBLIC 8" WATER MAIN & 8" SEWER MAIN PLAN	2-3
PUBLIC 8" WATER MAIN & 8" SEWER MAIN PROFILES	4-7
PUBLIC WATER & SEWER STRUCTURE CHARTS	8

### QUANTITIES TABLE

ITEMS	QUANTITIES ESTIMATED	QUANTITIES	AS-BUILT TYPE	MANUFACTURER / SUPPLIER
1/8 BEND	4			
1/16 BEND	12			
1/32 BEND	15			
1 1/2" WHC	2,560 L.F.			
2" WHC	0			
8" DR 14 C900 PVC WATER (235 PSI)	3,012 L.F.			
8" DR 14 C900 PVC WATER (235 PSI)	126 L.F.			
8" VALVE	18			
6" VALVE	8			
4" VALVE	0			
FIRE HYDRANTS	7			
8"x8" TEE	3			
8"x8" TAPPING SLEEVE	1			
8"x6" TEE	7			
8" 3" HIGH DEFLECTION COUPLING	19			
CLEANOUT	43			
6" SDR 35 PVC SHC	0			
4" SDR 35 PVC SHC	2,285 L.F.			
8" DIP CL 52 (SEWER MAIN)	1,098 L.F.			
8" SDR 35 PVC (SEWER MAIN)	1,464 L.F.			
SEWER MANHOLE (PUBLIC SEWER SYSTEM EXTENSION)	30			
AIR RELEASE VALVE	0			
CAP & BUTTRISS	2			
BLOW-OFF BOX	1			
8" COUPLING	1			
24" STEEL CASING	288 L.F.			
36" STEEL CASING	-			
NAME OF UTILITY CONTRACTOR				
CHECK BOX				
AS-BUILT DATE				
SURVEY AND DRAFTING DIVISION				

### DMV2-24-013

REQUESTING APPROVAL TO WAIVE THE HOWARD COUNTY DESIGN MANUAL VOLUME II - WATER AND SEWER (DMV2) FOR THE PROPOSED PROJECT, ALLOWING AN APPROXIMATELY 780-FOOT LONG, 8-FOOT TALL PRIVACY SCREEN FENCE TO BE PLACED 5 FEET WITHIN THE EXISTING PUBLIC SEWER AND UTILITY EASEMENT FROM CONTRACT NO. 738-S-A, THEREBY WAIVING DMV2 SECTION 4.4.5 WHICH REQUIRES A MINIMUM 10 FEET OF HORIZONTAL CLEARANCE BETWEEN ANY PERMANENT STRUCTURE AND THE EDGE OF THE UTILITY EASEMENT.

JUSTIFICATION FOR THE PROPOSED WAIVER INCLUDES THAT THE PROPOSED FENCE IS REQUIRED FOR THE DEVELOPMENT, TO PROVIDE A PRIVACY BUFFER BETWEEN THE PROPOSED DEVELOPMENT AND EXISTING HOMES ALONG POSTWICK ROAD AND MICHAELS WAY. DMV NOTES THAT IT IS HIGHLY UNCOMMON TO PERMIT PERMANENT STRUCTURES WITHIN EASEMENTS SUCH AS IS PROPOSED. WITHOUT MITIGATION MEASURES THE PROPOSED FENCE WOULD BE APPROXIMATELY 5 FEET HORIZONTAL FROM THE EXISTING 12-INCH SEWER CONSTRUCTED UNDER CONTRACT NO. 738-S-A AND SIGNIFICANTLY IMPACT DPWS ABILITY TO ACCESS AND MAINTAIN THIS SEWER AND ASSOCIATED EASEMENT. IN CONSIDERATION OF THIS AND PREVIOUS CORRESPONDENCE WITH BOHLER, DPW CONDITIONALLY APPROVES THIS WAIVER PROVIDED THE FOLLOWING:

- AN ADDITIONAL 10 FEET WIDTH BE ADDED TO THE EXISTING EASEMENT ON THE SIDE OPPOSITE THE FENCE (TO THE NORTH BETWEEN EXISTING SEWER MH #738A-123A AND #738A-122, AND TO THE EAST BETWEEN MH #738A-122 AND #738A-123). THEREBY CREATING A 30-FOOT WIDE EASEMENT AS SHOWN ON THE EXHIBIT ATTACHED TO THIS WAIVER REQUEST.
- THIS DEVELOPMENT'S HOMEOWNERS ASSOCIATION (HOA) IS SOLELY RESPONSIBLE FOR THE FENCE IN PERPETUITY, INCLUDING ITS REMOVAL AND REPLACEMENT IF NEEDED IN THE FUTURE BY DPW FOR WORK ON THE SEWER, EASEMENT, OR RELATED NEED.

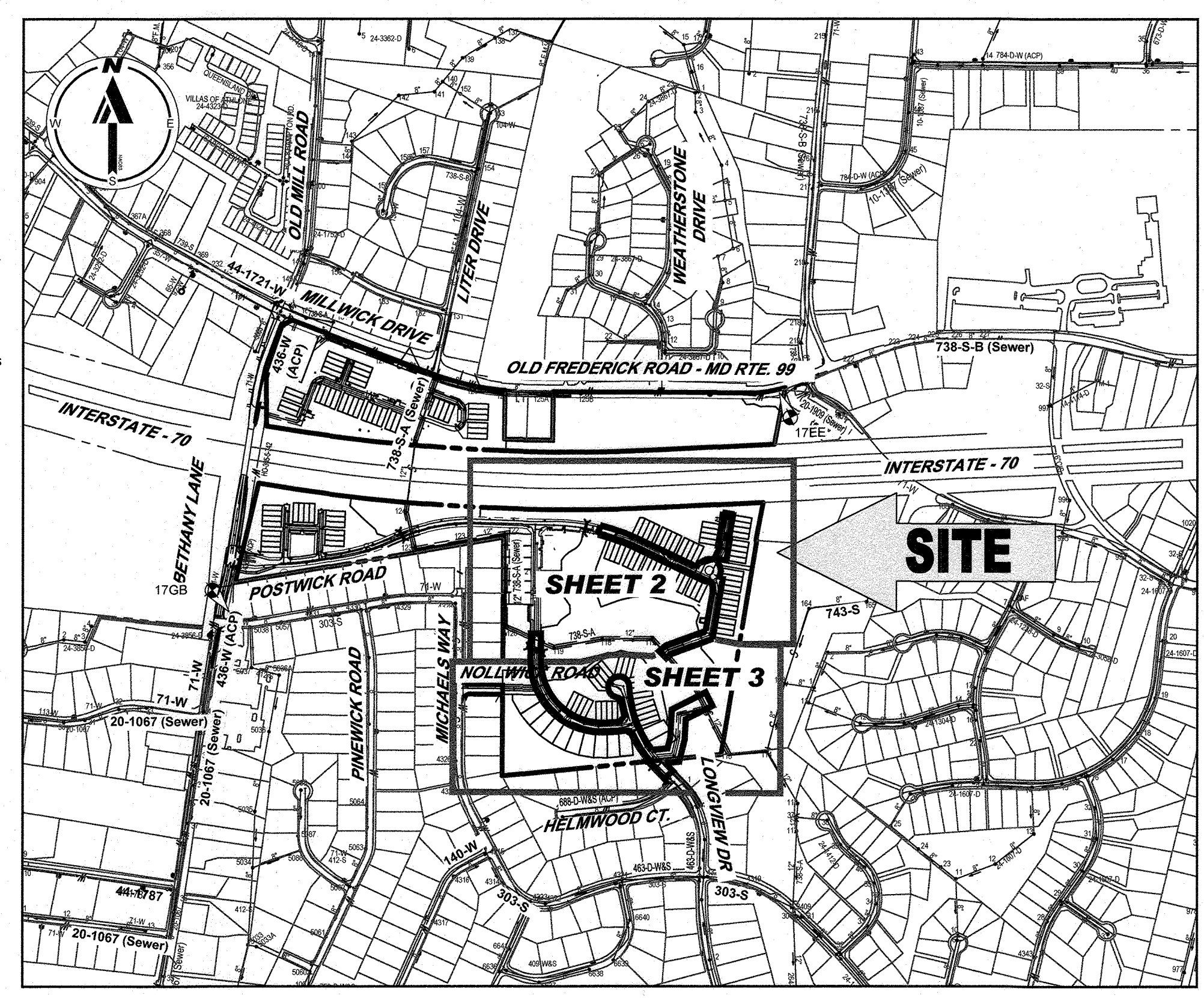

### LOCATION MAP

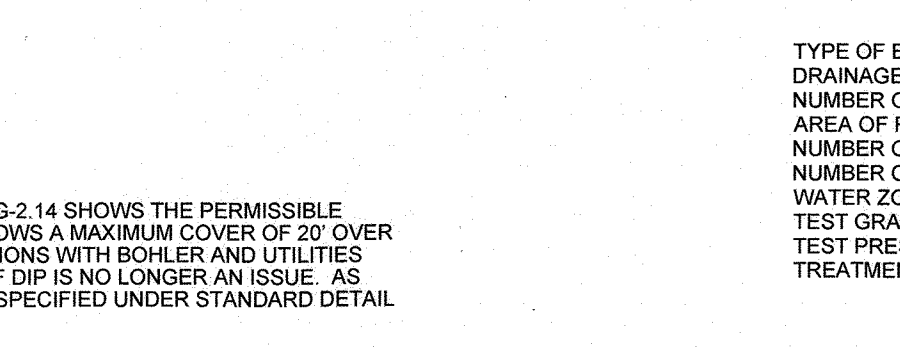

### REFERENCE DRAWINGS

SP-21-002
ECP-21-017
BA-CASE No. 17-018C
F-22-033
SDP-22-021
TYPE OF BUILDING - AGE-RESTRICTED ADULT HOUSING
DRAINAGE AREA - PATUXENT
NUMBER OF LOTS/PARCELS/UNITS: 43
AREA OF RESIDENTIAL LOT/PARCEL: 7.05 AC
NUMBER OF W.H.C.: 43 (PROPOSED)
NUMBER OF S.H.C.: 43 (PROPOSED)
WATER ZONE: 90' W
TEST GRADIENT: 90'
TEST PRESSURE: 254 PSI
TREATMENT PLANT: LITTLE PATUXENT WRP

### SEWER WAIVER NOTES:

DMV2-22-04 - A WAIVER OF DMV2 SECTION 3.3.B.2.B.1, HORIZONTAL ALIGNMENT - LOCATION WHICH LIMITS THE NON-LOOPED LENGTH OF 8-INCH WATER MAIN TO 2,500 LF OR LENGTH REQUIRED TO PROVIDE SERVICE TO 50 UNITS, WHICHEVER IS SHORTER. FROM THE INFORMATION PROVIDED, IT IS UNDERSTOOD THAT THE PROPOSED WATER MAIN IS APPROXIMATELY 1,300 LF LONG AND MEETS THE FIRST CRITERION OF SECTION 3.3.B.2.B.1 OF LESS THAN 2,500 LF. HOWEVER, IT DOES NOT MEET THE SECOND CRITERION BECAUSE IT SERVES MORE THAN 50 UNITS (52 UNITS). IT IS ALSO UNDERSTOOD THAT IF A LOOP IS TO BE PROVIDED, AN ADDITIONAL 950 LF OF PIPE WILL BE REQUIRED, WHICH WILL NOT SERVE ANY PROPERTY, BUT WILL JUST COMPLETE A LOOP. IN ADDITION, THIS 950 LF OF ADDITIONAL LENGTH WILL REQUIRE A STREAM CROSSING INVOLVING IMPACTS TO THE FLOODPLAIN AND STREAM BUFFERS AS WELL AS CUTTING DOWN OF TREES. BASED ON THE INFORMATION PROVIDED, THE WAIVER REQUEST WAS APPROVED SEPT. 13, 2021.

### DMV2-23-011

THE UPDATED SUBMITTAL REQUESTS WAIVER FROM THE DESIGN MANUAL SECTION 3.3.5.5 REQUIREMENT THAT LIMITS MAXIMUM COVER OVER THE DISTRIBUTION MAINS TO 8.0 FEET. FOLLOWING STATIONS HAVE BEEN IDENTIFIED FOR THIS WAIVER REQUEST:

CONTRACT 1 - WATER MAIN C-1 STA 9492 TO STA 11460 - THE MAXIMUM COVER OVER THE MAIN WILL BE ABOUT 12.0'

CONTRACT 1 - WATER MAIN C-1 STA 27496 TO STA 28480 - THE MAXIMUM COVER OVER THE MAIN WILL BE ABOUT 10.0'

THE UPDATED SUBMITTAL ALSO HAS AN ADDED REQUEST, WHICH SEEKS WAIVER FROM DMV2 SECTION 3.3.5.5, WHICH ALSO REQUIRES A MINIMUM COVER OVER DISTRIBUTION COVER OF 3.5'. THE REQUEST IS MADE FOR THE FOLLOWING STATION:

CONTRACT 1 - WATER MAIN C-1 STA 18488 - STA 19436 THE COVER OVER THE MAIN WILL BE ABOUT 2.3'

BASED ON OUR UNDERSTANDING AND THE DISCUSSIONS HELD AT PREVIOUS MEETINGS, FOLLOWING DECISIONS ARE MADE:

- WATER MAIN C-1 STA 9492 TO STA 11460 AND STA 27496 TO STA 28480 - THIS IS A CONNECTION POINT TO THE EXISTING MAIN - BASED ON THE INFORMATION PROVIDED, THIS WAIVER REQUEST IS APPROVED.
- WATER MAIN C-1 STA 18488 TO STA 19436 - THIS IS WAIVER REQUEST IS APPROVED SUBJECT TO FOLLOWING CONDITION:  
PROVIDE A LAYER OF TRAXIAL GEOTEXTILE SIMILAR TO TX130 AS MANUFACTURED BY TENSAR CORPORATION, AS RECOMMENDED BY HILLIS-CARNE ENGINEERING ASSOCIATES IN THEIR LETTER TO BOHLER AND DATED SEPTEMBER 15, 2023. INCLUDE ALL DETAILS FROM THE LETTER REQUIRED FOR CONSTRUCTION ON WATER AND SEWER DRAWINGS.

IN ADDITION TO ABOVE DECISIONS, BELOW POINTS WERE DISCUSSED AND AGREED TO IN PREVIOUS MEETINGS AND SHALL BE PROVIDED AS SPECIFIED:

- FROM STA 10400, THE STANDARD 20" EASEMENT WILL BE WIDENED UP TO THE ROAD RIGHT OF WAY.
- BETWEEN STA 27496 AND STA 28480, FIRE HYDRANTS AND ISOLATION VALVES SHALL BE PROVIDED FOR ISOLATING SECTION OF THE WATER MAIN CROSSING THE CULVERT AND TO PROVIDE TEMPORARY BYPASS WATER.
- WATER MAIN C-1 BETWEEN STA 27496 AND STA 28480 SHALL BE DESIGNED TO PASS OVER THE CULVERT WITH A CLEARANCE OF MINIMUM 6.0 INCHES. THIS CLEARANCE SHALL BE FILLED WITH CONSTRUCTION SAND EXTENDING THREE FEET ALL AROUND OF THE CROSSING BORDERS. NOTE - BOHLER HAS RESPONDED THAT IT IS NOT FEASIBLE TO PROVIDE THE WATER MAIN ABOVE THE BOX CULVERT DUE TO INSUFFICIENT COVER.
- THE STREAM CROSSING PROFILES SHALL BE DESIGNED CORRECTLY IN ACCORDANCE WITH STANDARD DETAILS.
- WHERE MANHOLE DEPTHS EXCEED 20', A 30" EASEMENT SHALL BE PROVIDED.

APPROVED SEPT. 22, 2023.

### DMV2-24-003

IT IS UNDERSTOOD THAT THE HIGHWAY 170 PASSES THROUGH THE PROPERTY TO BE DEVELOPED AND REQUIRES A NOISE WALL TO BE CONSTRUCTED ALONG THE SOUTH PROPERTY LINE OF THE DEVELOPMENT. THE NOISE WALL GENERALLY RUNS IN THE EAST-WEST DIRECTION. THERE IS A 12" SEWER THAT WAS CONSTRUCTED UNDER CONTRACT NO. 738-S-A AND CROSSES THE NOISE WALL IN THE NORTH-SOUTH DIRECTION WITHIN A 20' EASEMENT. TO PROVIDE ACCESS TO THE SEWER MAINTENANCE UPON CONSTRUCTION THE NOISE WALL HAS BEEN DESIGNED TO SPAN OVER THE EASEMENT WITH ANY SUPPORT IN THE EASEMENT AND AS PRACTICAL AS AT 90 DEGREES TO THE EASEMENT. THE WALL CONSISTS OF A SINGLE PANEL AND IS REMOVAL AS SUCH WHEN REQUIRED TO ACCESS THE SEWER IN THIS AREA. BOHLER ALSO PROVIDED A DETAILED DESCRIPTION OF THIS 20' PANEL. ITS REMOVAL AND TEMPORARY STORAGE PROQUIRES THROUGH SUBSEQUENT CORRESPONDENCE.

THE WAIVER REQUEST FOR LOCATION 1 - WAS APPROVED SEPT. 22, 2023 PROVIDED FOLLOWING CONDITION IS MET:

- INCLUDE COMPLETE INSTRUCTION PACKAGE ON THE REMOVAL AND STORAGE OF THE 20' PANEL ON THE WATER AND SEWER DRAWINGS. THE INSTRUCTIONS SHOULD BE:
- INCLUDE STANDARD SIZE DOOR IN THE 20' PANEL IN THE EASEMENT.

THE SECOND LOCATION INCLUDED IN THIS WAIVER REQUEST IS AT THE END OF A PRIVATE ALLEY IN NEIGHBORHOOD Q, NEAR LOT 100. SIMILAR TO LOCATION 1, NOISE WALL IS REQUIRED. HOWEVER, TO MEET THE GRADING REQUIREMENTS OF THE PRIVATE ALLEY AND THE NOISE WALL, A RETAINING WALL IS REQUIRED BETWEEN THE TWO. THE RETAINING WALL WILL BE LOCATED APPROXIMATELY 5.0' BEHIND THE FACE OF THE CURB AT THE END OF THE PRIVATE ADEQUATE SPACE HAS BEEN PROVIDED FOR ROAD MAINTENANCE AND IS REMOVAL AS SUCH WHEN REQUIRED TO ACCESS THE SEWER IN THIS AREA. THE RETAINING WALL DOES NOT HAVE ANY UTILITIES. FURTHERMORE, THE NOISE WALL HAS BEEN DESIGNED TOTALLY INDEPENDENT OF THE RETAINING WALL AND IS NOT IN STRUCTURAL INFLUENCE ZONE OF THE RETAINING WALL.

WAIVER REQUEST FOR LOCATION 2 WAS APPROVED SEPT. 22, 2023.

### DMV2-23-005

IN ADDITION TO DMV2 SECTION 4.3.E.2.B.1, DMV 4 STANDARD DETAIL G-2.14 SHOWS THE PERMISSIBLE DEPTHS OF COVER FOR VARIOUS PIPE MATERIALS. THIS DETAIL ALLOWS A MAXIMUM COVER OF 20' OVER C900 FOR DEPTHS GREATER THAN 20'. DIP IS REQUIRED. IN DISCUSSIONS WITH BOHLER AND UTILITIES UNLIMITED, THE COUNTY HAS BEEN INFORMED THAT AVAILABILITY OF DIP IS NO LONGER AN ISSUE. AS SUCH, THE WAIVER REQUEST IS RECONSIDERED AND PIPE MATERIAL AS SPECIFIED UNDER STANDARD DETAIL G-2.14 SHALL BE PROVIDED.

WAIVER REQUEST 2

A CLEARANCE LESS THAN 1'0" BETWEEN TOP OF THE CASING AND THE BOX CULVERT BOTTOM BETWEEN MANHOLES S-27 AND S-23 IS ACCEPTABLE, WITH THE CONDITION THAT THE GAP BETWEEN TOP OF THE CASING AND THE BOTTOM OF THE BOX CULVERT IS FILLED WITH CONSTRUCTION SAND. THE EXTENT OF THE FILL SHALL BE MINIMUM THREE (3) FEET BEYOND THE OUTER EDGES OF THE PIPE AND CULVERT, IN BOTH DIRECTIONS.

WAIVER REQUEST 2 IS APPROVED, PROVIDED ABOVE CONDITION IS MET AND NOTED ON THE PLANS AND PROFILES.

WAIVER REQUEST 3

BASED ON THE INFORMATION PROVIDED, USE OF 24" CASING AT FIVE STATIONS NOTED EARLIER IS APPROVED.

THIS DEVELOPMENT PLAN IS APPROVED FOR SOIL EROSION AND SEDIMENT CONTROL BY THE HOWARD SOIL CONSERVATION DISTRICT.

*Alvin B. Britton*  
HOWARD SOCD

03/21/24  
DATE

OWNER/DEVELOPER:  
BETHANY GLEN DEVELOPMENT, INC  
5074 DORSEY HALL ROAD, SUITE 205  
ELLICOTT CITY, MD 21042  
CONTACT: JASON VAN KIRK  
PHONE: (410) 720-3021

**BOHLER //**  
901 DULANEY VALLEY ROAD, SUITE 801  
TOWSON, MARYLAND 21284  
Phone: (410) 821-7900  
Fax: (410) 821-7987  
MD@BohlerEng.com

**B.R. ROWE**  
3/19/24  
PROFESSIONAL ENGINEER  
MARYLAND LICENSE NO. 4099  
BETHANY GLEN DEVELOPMENT, INC.  
I, BRADNOR R. ROWE, HEREBY CERTIFY THAT THESE DOCUMENTS WERE PREPARED OR APPROVED BY ME, AND THAT I AM A LICENSED PROFESSIONAL ENGINEER UNDER THE LAWS OF THE STATE OF MARYLAND. LICENSE NO. 4098, EXPIRATION DATE: 7/31/2025

DES	DRN	CK: B.R.R.	DATE: 03/01/24	REV.	DATE	DESCRIPTION	BY

TITLE SHEET	
PARCEL NO.	34
600' SCALE MAP NO.	30
BLOCK NO.	9

**BETHANY GLEN - PHASE II**  
LOTS 25-60, 65-116  
AND OPEN SPACE LOTS 164 THRU 167  
9891 OLD FREDERICK ROAD - RTE. 99, ELLICOTT CITY, MD,  
TAX MAP 17, GRID 15, PARCEL 34  
2ND ELECTION DISTRICT  
HOWARD COUNTY  
CONTRACT NO. 24-5236-D

SCALE AS SHOWN  
SHEET 1 of 8

DEPARTMENT OF PUBLIC WORKS HOWARD COUNTY, MARYLAND

*Jason Van Kirk*  
CHIEF, BUREAU OF UTILITIES  
3/13/2024  
DATE

DEPARTMENT OF PLANNING & ZONING HOWARD COUNTY, MARYLAND

*Jason Van Kirk*  
CHIEF, DEVELOPMENT ENGINEERING DIVISION  
3/13/2024  
DATE

**BOHLER //**  
901 DULANEY VALLEY ROAD, SUITE 801  
TOWSON, MARYLAND 21284  
Phone: (410) 821-7900  
Fax: (410) 821-7987  
MD@BohlerEng.com

**B.R. ROWE**  
3/19/24  
PROFESSIONAL ENGINEER  
MARYLAND LICENSE NO. 4099  
BETHANY GLEN DEVELOPMENT, INC.  
I, BRADNOR R. ROWE, HEREBY CERTIFY THAT THESE DOCUMENTS WERE PREPARED OR APPROVED BY ME, AND THAT I AM A LICENSED PROFESSIONAL ENGINEER UNDER THE LAWS OF THE STATE OF MARYLAND. LICENSE NO. 4098, EXPIRATION DATE: 7/31/2025

DES	DRN	CK: B.R.R.	DATE: 03/01/24	REV.	DATE	DESCRIPTION	BY

TITLE SHEET	
PARCEL NO.	34
600' SCALE MAP NO.	30
BLOCK NO.	9

**BETHANY GLEN - PHASE II**  
LOTS 25-60, 65-116  
AND OPEN SPACE LOTS 164 THRU 167  
9891 OLD FREDERICK ROAD - RTE. 99, ELLICOTT CITY, MD,  
TAX MAP 17, GRID 15, PARCEL 34  
2ND ELECTION DISTRICT  
HOWARD COUNTY  
CONTRACT NO. 24-5236-D

SCALE AS SHOWN  
SHEET 1 of 8











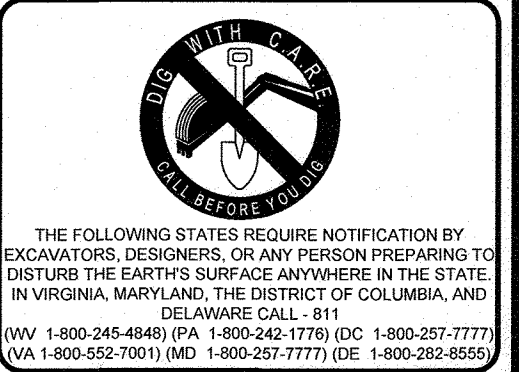
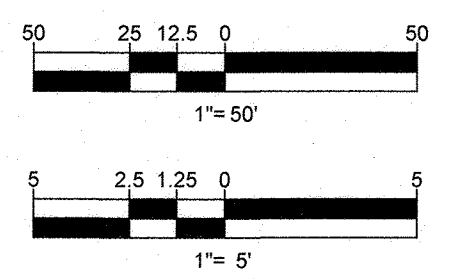
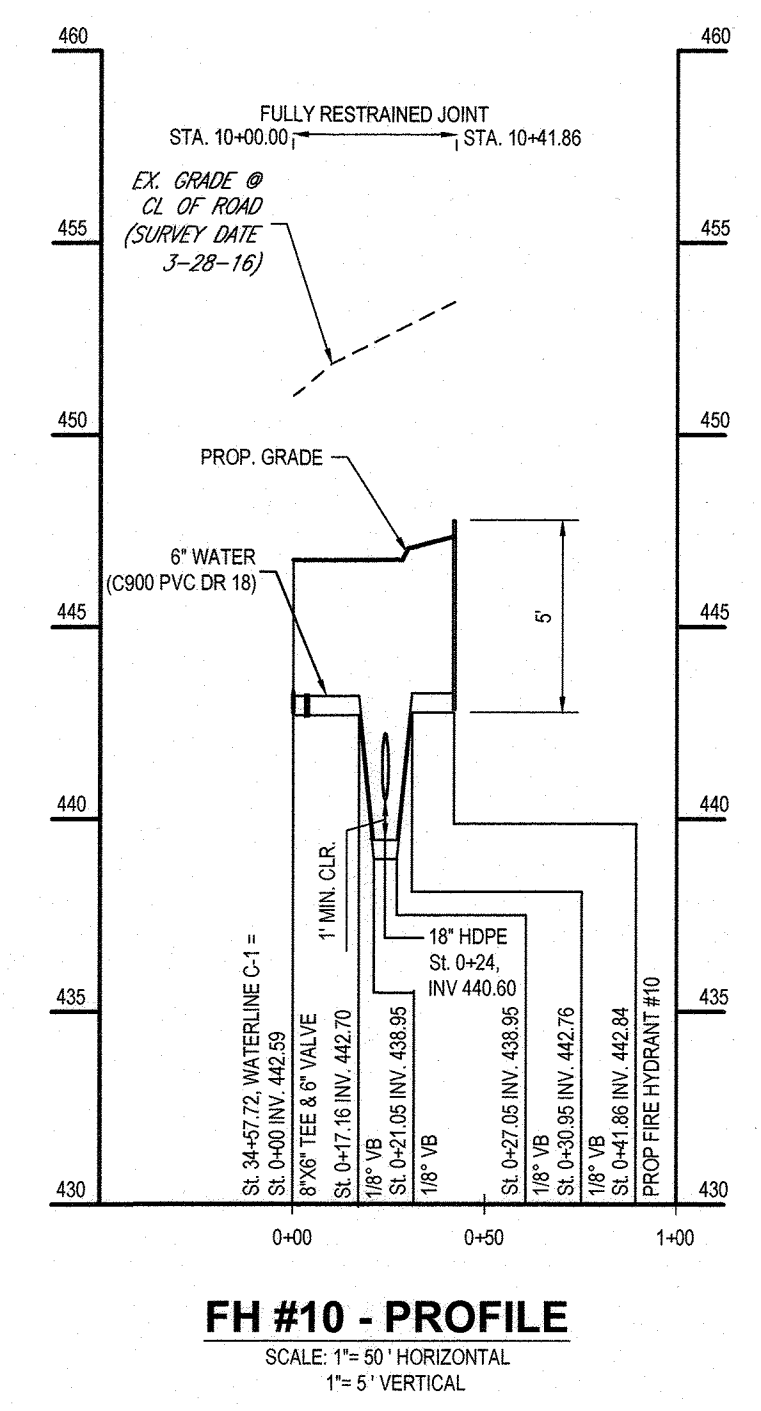
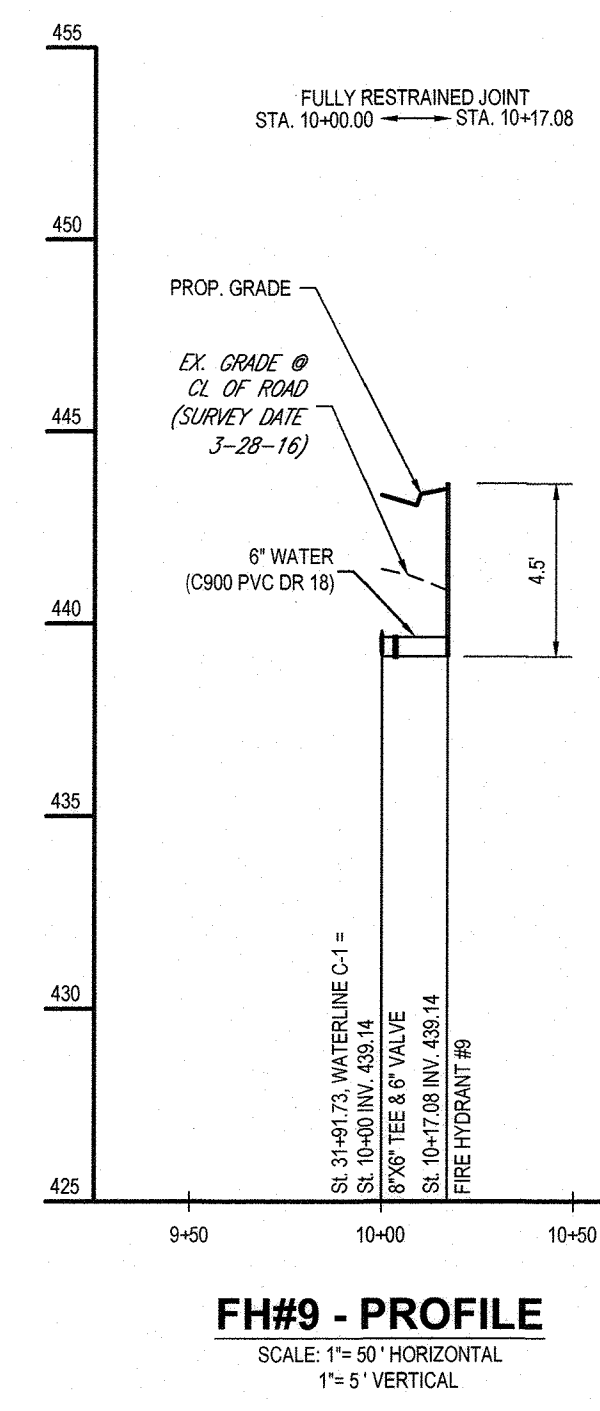
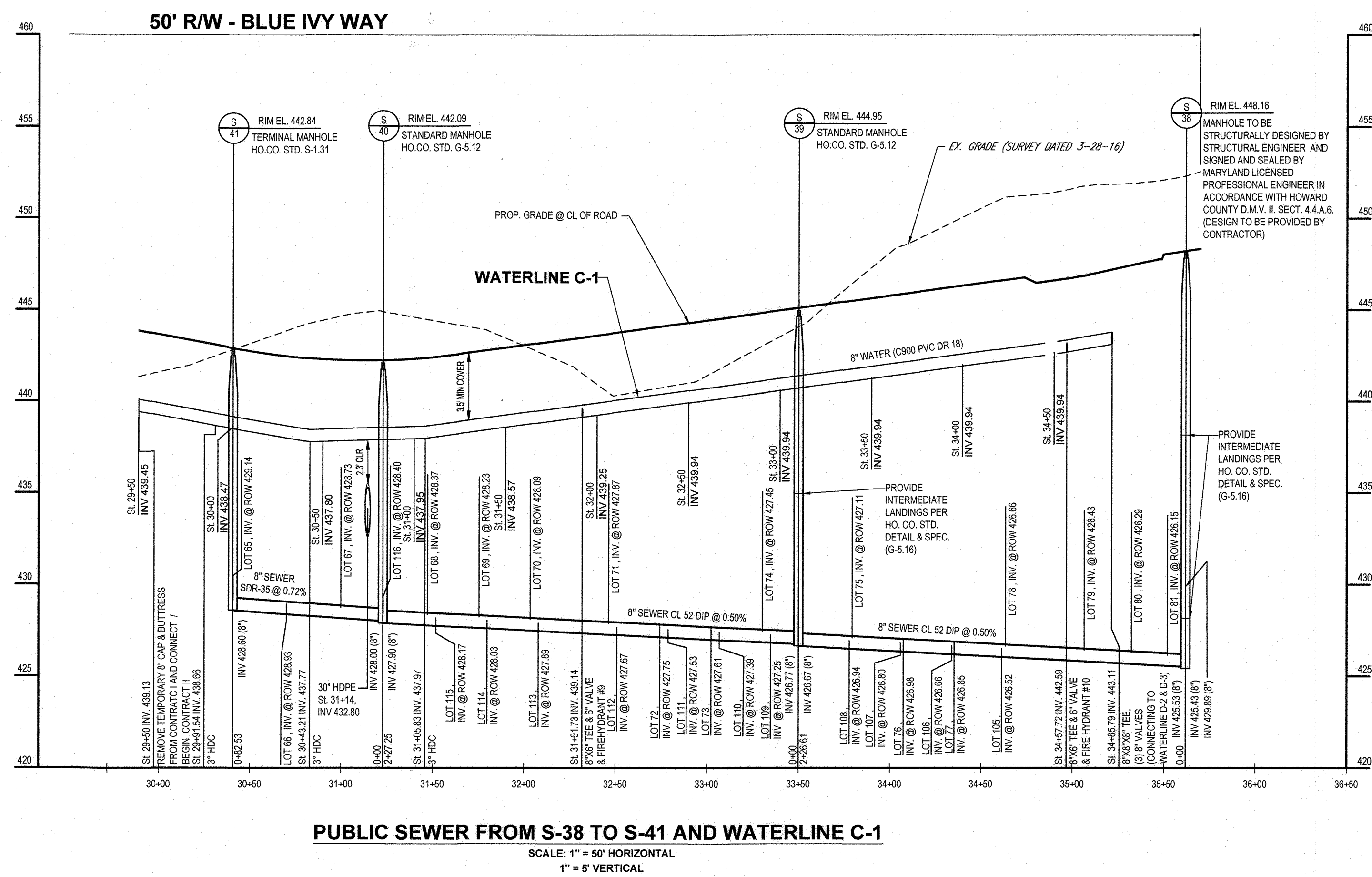

DEPARTMENT OF PUBLIC WORKS HOWARD COUNTY, MARYLAND  
*Tom A. Paul*  
 CHIEF, BUREAU OF UTILITIES  
 DATE: 3/13/2024

DEPARTMENT OF PLANNING & ZONING HOWARD COUNTY, MARYLAND  
*Paul P. Paul*  
 CHIEF, DEVELOPMENT ENGINEERING DIVISION  
 DATE: 4.3.24

**BOHLER //**  
 901 DULANEY VALLEY ROAD, SUITE 801  
 TOWSON, MARYLAND 21284  
 Phone: (410) 821-7900  
 Fax: (410) 821-7987  
 MD@BohlerEng.com

**B.R. ROWE**  
 PROFESSIONAL ENGINEER  
 LICENSE NO. 4099  
 STATE OF MARYLAND  
 DATE: 03/01/24

REV.	DATE	DESCRIPTION	BY

**PUBLIC 8" WATER MAIN & 8" SEWER MAIN PROFILES**  
 PARCEL NO. 34  
 600' SCALE MAP NO. 30 BLOCK NO. 9

**BETHANY GLEN - PHASE II**  
 LOTS 25-60, 65-116  
 AND OPEN SPACE LOTS 164 THRU 167  
 9891 OLD FREDERICK ROAD - RTE. 99, ELLICOTT CITY, MD  
 TAX MAP 17, GRID 15, PARCEL 34  
 2ND ELECTION DISTRICT  
 HOWARD COUNTY  
 CONTRACT NO. 24-5236-D

SCALE: H=1"=50' V=1"=5'  
 SHEET: 4 OF 8





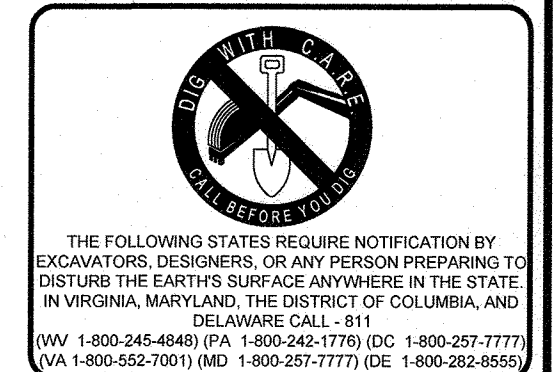
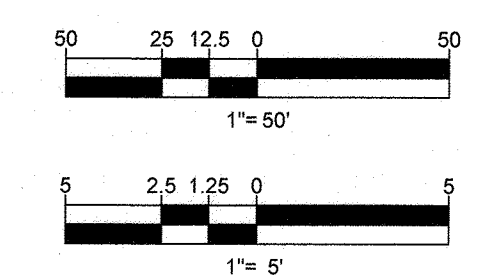
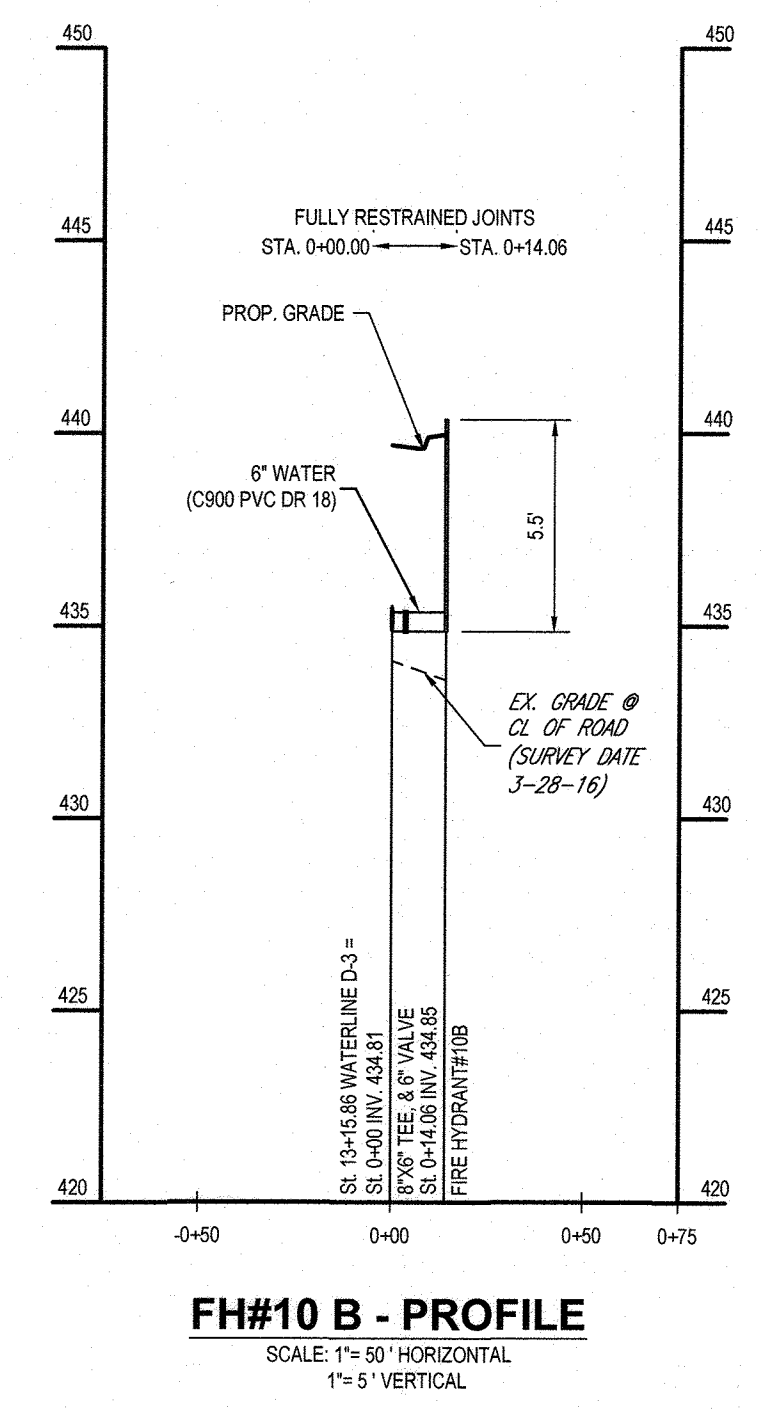
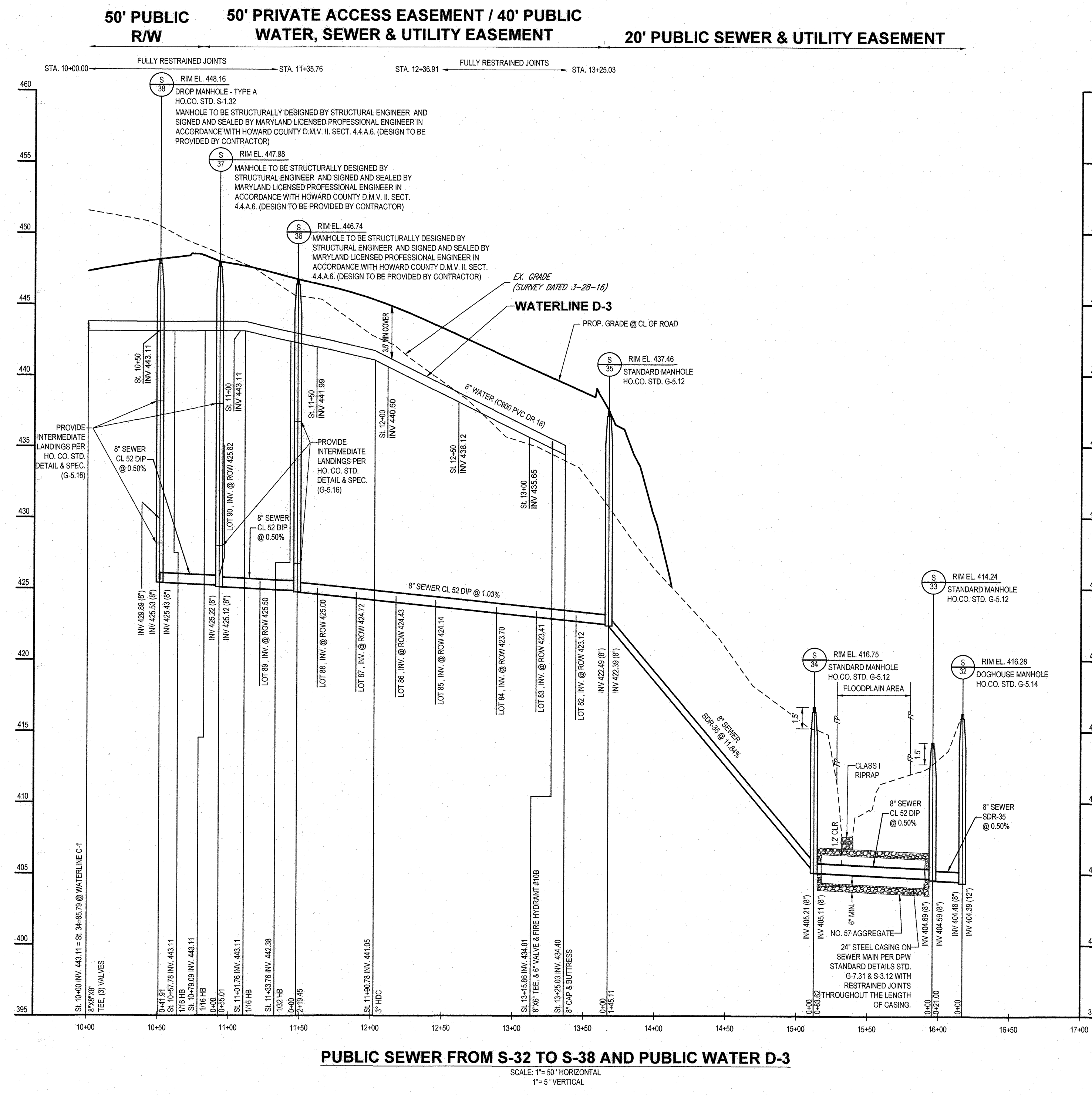

DEPARTMENT OF PUBLIC WORKS HOWARD COUNTY, MARYLAND  
*[Signature]* 3/13/2024  
 CHIEF, BUREAU OF UTILITIES DATE

DEPARTMENT OF PLANNING & ZONING HOWARD COUNTY, MARYLAND  
*[Signature]* 4-3-24  
 CHIEF, DEVELOPMENT ENGINEERING DIVISION DATE

**BOHLER //**  
 901 DULANEY VALLEY ROAD, SUITE 801 TOWSON, MARYLAND 21204  
 Phone: (410) 821-7900 Fax: (410) 821-7987  
 MD@BohlerEng.com

**B.R. ROWE**  
*[Signature]*  
 PROFESSIONAL ENGINEER  
 MARYLAND LICENSE NO. 4099  
 DATE: 03/01/24

DES:	
DRN:	
CK: B.R.R.	
DATE:	03/01/24
REV.	DATE DESCRIPTION

**PUBLIC 8" WATER MAIN & 8" SEWER MAIN PROFILES**  
 PARCEL NO. 34  
 600' SCALE MAP NO. 30 BLOCK NO. 9

**BETHANY GLEN - PHASE II**  
 LOTS 25-60, 65-116 AND OPEN SPACE LOTS 164 THRU 167  
 9891 OLD FREDERICK ROAD - RTE. 99, ELLICOTT CITY, MD  
 TAX MAP 17, GRID 15, PARCEL 34  
 2ND ELECTION DISTRICT  
 HOWARD COUNTY  
 CONTRACT NO.: 24-5236-D

SCALE: H=1"=50' V=1"=5'  
 SHEET: 6 OF 8





