

GENERAL NOTES:

- APPROXIMATE LOCATIONS OF EXISTING MAINS ARE SHOWN. THE CONTRACTOR SHALL TAKE ALL NECESSARY PRECAUTIONS TO PROTECT EXISTING MAINS AND SERVICES AND MAINTAIN UNINTERRUPTED SERVICE. ANY DAMAGE INCURRED SHALL BE REPAIRED IMMEDIATELY TO THE SATISFACTION OF THE ENGINEER AT THE CONTRACTOR'S EXPENSE.
- TOPOGRAPHY FIELD SURVEYS WERE PERFORMED ON MARCH 1998 BY POTOMAC AERIAL SURVEYS.
- HORIZONTAL AND VERTICAL SURVEY CONTROLS:
THE COORDINATES SHOWN ON THE DRAWINGS ARE BASED ON MARYLAND STATE REFERENCE SYSTEM NAD '83/'91 AS PROJECTED BY HOWARD COUNTY GEODETIC CONTROL STATIONS 43B2 AND 43B6.
ALL VERTICAL CONTROLS ARE BASED ON NAVD '88. VERTICAL CONTROLS PROVIDED ON DRAWINGS ARE:
GEODETIC SURVEY CONTROL 43B2 (N 551,654.903/E 1,378,176.941)
BRASS DISC SET ON TOP OF A CONCRETE MONUMENT, GEODETIC SURVEY CONTROL 43B6 (N 550,601.597/E 1,376,866.047)
BRASS DISC SET ON TOP OF A CONCRETE MONUMENT.
- ALL PIPE ELEVATIONS SHOWN ARE INVERT ELEVATIONS UNLESS OTHERWISE NOTED.
- CLEAR ALL UTILITIES BY A MINIMUM OF 12 INCHES. CLEAR ALL POLES BY 5'-0" MINIMUM OR TUNNEL AS REQUIRED UNLESS OTHERWISE NOTED. THE OWNER HAS CONTACTED THE UTILITY COMPANIES AND HAS MADE ARRANGEMENTS FOR BRACING OF POLES AS SHOWN ON DRAWINGS. IN THE EVENT THE CONTRACTOR'S WORK REQUIRES THE BRACING OF ADDITIONAL POLES, ANY COST INCURRED BY THE OWNER FOR BRACING OF ADDITIONAL POLES OR DAMAGES SHALL BE DEDUCTED FROM MONIES OWED THE CONTRACTOR. THE CONTRACTOR SHALL COORDINATE WITH THE UTILITY COMPANIES TO SCHEDULE THE BRACING OF THE POLES.
- FOR DETAILS NOT SHOWN ON THE DRAWINGS, AND FOR MATERIALS AND CONSTRUCTION METHODS USE, HOWARD COUNTY DESIGN MANUAL, VOLUME IV, STANDARD SPECIFICATIONS AND DETAILS FOR CONSTRUCTION (LATEST EDITION). THE CONTRACTOR SHALL HAVE A COPY OF VOLUME IV ON THE JOB.
- WHERE TEST PITS HAVE BEEN MADE ON EXISTING UTILITIES, THEY ARE NOTED BY THE SYMBOL AT THE LOCATIONS OF THE TEST PITS. A NOTE OR NOTES CONTAINING THE RESULTS OF THE TEST PIT OR PITS IS INCLUDED ON THE DRAWINGS. EXISTING UTILITIES IN THE VICINITY OF THE PROPOSED WORK FOR WHICH TEST PITS HAVE NOT BEEN DUG SHALL BE LOCATED BY THE CONTRACTOR TWO WEEKS IN ADVANCE OF CONSTRUCTION OPERATION AT HIS OWN EXPENSE.
- THE CONTRACTOR SHALL NOTIFY THE FOLLOWING UTILITY COMPANIES OR AGENCIES AT LEAST FIVE WORKING DAYS BEFORE STARTING WORK SHOWN ON THESE PLANS:
AT&T 1-800-252-1133
BGE (CONSTRUCTION SERVICES) 410-637-8713
BGE (EMERGENCY) 410-685-0123
BUREAU OF UTILITIES 410-313-4900
COLONIAL PIPELINE CO 410-795-1390
MISS UTILITY 1-800-257-7777
STATE HIGHWAY ADMINISTRATION 410-531-5533
VERIZON 1-800-743-0033
- TREES AND SHRUBS ARE TO BE PROTECTED FROM DAMAGE TO THE MAXIMUM EXTENT. TREES AND SHRUBS LOCATED WITHIN THE CONSTRUCTION STRIP ARE NOT TO BE REMOVED OR DAMAGED BY THE CONTRACTOR.
- THE CONTRACTOR SHALL REMOVE TREES, STUMPS AND ROOTS ALONG THE LINE OF EXCAVATION. PAYMENT FOR SUCH REMOVAL SHALL BE INCLUDED IN THE UNIT PRICE BID FOR THE CONSTRUCTION OF THE MAIN.
- THE CONTRACTOR SHALL NOTIFY THE BUREAU OF HIGHWAY, HOWARD COUNTY, AT (410) 313-7450 AT LEAST FIVE WORKING DAYS BEFORE OPEN CUTTING OR BORING/JACKING OF ANY COUNTY ROAD FOR LAYING WATER/SEWER MAINS OR HOUSE CONNECTIONS. THE APPROVAL OF THESE DRAWINGS WILL CONSTITUTE COMPLIANCE WITH DPW REQUIREMENTS PER SECTION 18.114(g) OF THE HOWARD COUNTY CODE.

PART II - WATER

- ALL WATER MAINS SHALL BE C-900 PVC (DR-14) UNLESS OTHERWISE NOTED.
- TOPS OF ALL WATER MAINS SHALL HAVE A MINIMUM OF 3'-6" OF COVER UNLESS OTHERWISE NOTED.
- VALVES ADJACENT TO TESTS SHALL BE STRAPPED TO TESTS.
- ALL FITTINGS SHALL BE BUTTRESSED OR ANCHORED WITH CONCRETE IN ACCORDANCE WITH STANDARD DETAILS UNLESS OTHERWISE PROVIDED FOR ON THE DRAWINGS.
- FIRE HYDRANTS SHALL BE SET TO THE BURY LINE ELEVATIONS SHOWN ON THE DRAWINGS. ALL FIRE HYDRANTS SHALL BE INSTALLED IN ACCORDANCE WITH STANDARD DETAILS. THE SOIL AROUND THE FIRE HYDRANT SHALL BE COMPACTED IN ACCORDANCE WITH SECTION 1000 AND SECTION 1005 OF THE STANDARD SPECIFICATIONS.
- THE CONTRACTOR SHALL NOT OPERATE ANY VALVES ON THE EXISTING WATER SYSTEM.
- TRACER WIRE AND CONTINUITY TEST STATIONS SHALL BE INSTALLED ON ALL DIP AND PVC WATER MAINS IN ACCORDANCE WITH THE HOWARD COUNTY DESIGN MANUAL.
- FOR PVC WATER MAINS, ALL RECORDS FOR THE QUALITY CONTROL AND QUALIFICATION TEST REQUIREMENTS NOTED IN SECTION 5.1 OF THE AWWA STANDARD C900 FOR PVC PRESSURE PIPE SHALL BE SUBMITTED WITH THE PIPE MATERIAL CERTIFICATIONS OR SHOP DRAWINGS PRIOR TO APPROVAL OF THE MATERIAL FOR USE. THE TEST RECORDS SHALL BE FOR THE PIPE TO BE INSTALLED UNDER THIS CONTRACT. ALL PVC PIPE SHALL CONTAIN MARKINGS TO ALLOW CROSS REFERENCING OF THE PIPE SUPPLIED TO THE REST RECORDS RECEIVED.
- UNLESS OTHERWISE NOTED ON THE PLANS OR IN THE SPECIFICATIONS, SACRIFICIAL ANODES SHALL BE INSTALLED ON ALL VALVES AND METALLIC FITTINGS USED WITH PVC WATER MAINS IN ACCORDANCE WITH VOLUME IV, STANDARD SPECIFICATIONS AND DETAILS FOR CONSTRUCTION. SEVENTEEN (17) POUND MAGNESIUM ANODES SHALL BE INSTALLED ON ALL VALVES AND DUCTILE IRON FITTINGS INCLUDING RESTRAINTS AND HARNESSSES. TWELVE (12) POUND ZINC ANODES SHALL BE INSTALLED ON ALL STAINLESS STEEL FITTINGS AND SADDLES USED WITH PVC MAINS. ALL TESTS USED WITH PVC MAINS SHALL BE DUCTILE IRON.
- PROPER ASSEMBLY OF GASKETED PVC PIPE JOINTS: THE MANUFACTURE'S INSERTION LINE OF GASKETED PVC PIPE JOINTS INDICATES THE MAXIMUM DEPTH OF INSERTION OF THE SPIGOT INTO THE BELL. AFTER ASSEMBLY OF THE JOINT, THE INSERTION LINE SHALL REMAIN VISIBLE. DUAL INSERTION LINES ON GASKETED PVC PIPE INDICATE THE MAXIMUM AND MINIMUM DEPTH OF INSERTION OF THE SPIGOT INTO THE BELL. THE CONTRACTOR SHALL NOT OVER INSERT OR OVER HOME THE SPIGOT INTO THE BELL OF PVC PIPE.
- ALL CHANGES IN HORIZONTAL OR VERTICAL DIRECTION OF PVC WATER PIPE SHALL BE MADE WITH STANDARD BENDS. 5-DEGREE SWEEPS OR HIGH DEFLECTION (HD) COUPLINGS. NO BENDING OF THE PIPE OR DEFLECTING OF PVC PIPE JOINTS IS PERMITTED. WHERE HIGH DEFLECTION COUPLINGS OR 5-DEGREE SWEEPS ARE PERMITTED, THE CONTRACTOR SHALL PROVIDE ONE FULL PIPE LENGTH (20-FOOT LONG) ON EITHER SIDE OF THE HIGH DEFLECTION COUPLING OR 5-DEGREE SWEEP. THE CONTRACTOR SHALL USE A VIBRATORY PLATE COMPACTOR OR OTHER APPROVED MEANS TO THOROUGHLY COMPACT THE #57 STONE ON BOTH SIDES OF THE HIGH DEFLECTION COUPLING OR 5-DEGREE SWEEP, TAKING CARE NOT TO USE COMPACTION EQUIPMENT DIRECTLY OVER THE FITTING. PVC HIGH DEFLECTION COUPLINGS SHALL BE LIMITED TO A TOTAL DEFLECTION OF 3-DEGREES 1-1/2- DEGREE ON EITHER END OF THE COUPLING). SHALL BE RATED FOR A MINIMUM 200 PSI MEETING THE REQUIREMENTS OF AWWA C900. SHALL HAVE A MINIMUM LAY LENGTH OF 9-INCHES AND SHALL HAVE CENTER STOPS. PVC HIGH DEFLECTION COUPLINGS SHALL BE CERTAINTED PVC HIGH DEFLECTION (HD) STOP COUPLINGS OR EQUAL. FIVE DEGREE SWEEPS SHALL BE BELL BY SPIGOT, RATED FOR A MINIMUM 225 PSI, DR18 MEETING THE REQUIREMENTS OF AWWA C900 AND SHALL BE MULTI FITTINGS (IPEX) BLUE BRUTE DR18 OR EQUAL.
- WHEN PVC HIGH DEFLECTION COUPLINGS OR PVC 5-DEGREE SWEEPS ARE USED TO FACILITATE CHANGES IN HORIZONTAL OR VERTICAL ALIGNMENTS OF AWWA C-900 PVC PIPELINES, THE CONTRACTOR SHALL INSTALL DEVICES FOR THE PREVENTION OF OVER-INSERTION OF THE PVC PIPE SPIGOTS OR FLAN ENDS INTO THE PUSH ON BELL JOINT ON BOTH SIDES OF THE HIGH DEFLECTION COUPLINGS AND 5 DEGREE SWEEPS. BELL STOPS SHALL BE PLACED AT THE PROPER INSERTION LINE FOR THE FITTING. THE BELL STOP SHALL BE MANUFACTURED OF DUCTILE IRON AND INCORPORATE AN EXPANSION RETENTION SPRING TO ALLOW FOR PIPE EXPANSION AND CONTRACTION. THE BELL STOPS SHALL BE SERIES 5000 MEGA-STOP, AS MANUFACTURED BY EBAA IRON INC. OR APPROVED EQUAL.

PART III - SEWER

- ALL SEWER MAINS SHALL BE D.I.P. OR P.V.C UNLESS OTHERWISE NOTED.
- ALL MANHOLES SHALL BE 4'-0" INSIDE DIAMETER UNLESS OTHERWISE NOTED.
- FORCE MAINS SHALL BE D.I.P. ONLY.
- MANHOLES SHOWN WITH 12" AND 18" WALLS ARE FOR BRICK MANHOLES ONLY.
- MANHOLES EXCEPTED W.T. IN PLAN AND PROFILE SHALL HAVE WATER TIGHT FRAME AND COVER, STANDARD DETAIL G5.52. WHERE WATER TIGHT MANHOLE FRAMES AND COVERS ARE USED, SET TOP OF FRAME 1'-6" ABOVE FINISHED GRADE UNLESS OTHERWISE NOTED ON THE DRAWINGS.
- HOUSE(S) WITH THE SYMBOL "C.N.S." INDICATES THAT THE CELLAR CANNOT BE SERVED.

THIS DEVELOPMENT IS APPROVED FOR SOIL EROSION AND SEDIMENT CONTROL BY THE HOWARD SOIL CONSERVATION DISTRICT.

Alexandra Bratchi 01/25/2021
SOIL CONSERVATION DISTRICT DATE

SEDIMENT CONTROL MEASURES WILL BE IMPLEMENTED IN ACCORDANCE WITH SECTION 308 OF THE SPECIFICATIONS AND WITH SITE DEVELOPMENT PLAN SDP-20-004

DEPARTMENT OF PUBLIC WORKS
HOWARD COUNTY, MARYLAND
1-13-21
CHIEF, BUREAU OF UTILITIES DATE

DEPARTMENT OF PLANNING & ZONING
HOWARD COUNTY, MARYLAND
2-8-21
CHIEF, DEVELOPMENT ENGINEERING DIVISION DATE

VOGEL ENGINEERING
TIMMONS GROUP
3300 NORTH RIDGE ROAD, SUITE 110, ELLICOTT CITY, MD 21043
P: 410.461.7666 F: 410.461.8961 www.timmons.com

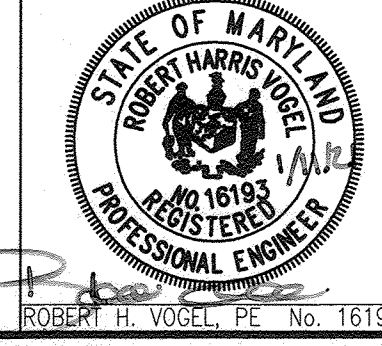

PROFESSIONAL CERTIFICATE
I HEREBY CERTIFY THAT THESE DOCUMENTS WERE PREPARED OR APPROVED BY ME AND THAT I AM A DULY LICENSED PROFESSIONAL ENGINEER UNDER THE LAWS OF THE STATE OF MARYLAND, LICENSE NO. 16193 EXPIRATION DATE: 09-27-2025

DRN: LRC/KG DES: LRC
CHK: RHV
DATE: DECEMBER 2020

WRA / AS BUILT
DATE: 2/16/23

FINAL WATER AND SEWER CONSTRUCTION PLAN
CONTRACT 14-5075-D
COVER SHEET

600' SCALE MAP NO. 43 BLOCK NO. 4

POTTER'S PLACE
(THE OAKS AT WATERS EDGE PHASE III-PARCEL A)

TAX MAP 43 GRID 4
1ST ELECTION DISTRICT

PARCEL 644
HOWARD COUNTY, MARYLAND

SCALE AS SHOWN
SHEET 1 OF 2

POTTER'S PLACE FINAL WATER AND SEWER (THE OAKS AT WATERS EDGE PHASE III-PARCEL A) CONTRACT NO. 14-5075-D

BENCHMARKS			
NO.	NORTHING	EASTING	ELEVATION
43B2	551,655.009	1,378,176.941	209.605'
43B6	550,601.593	1,376,866.047	210.560'

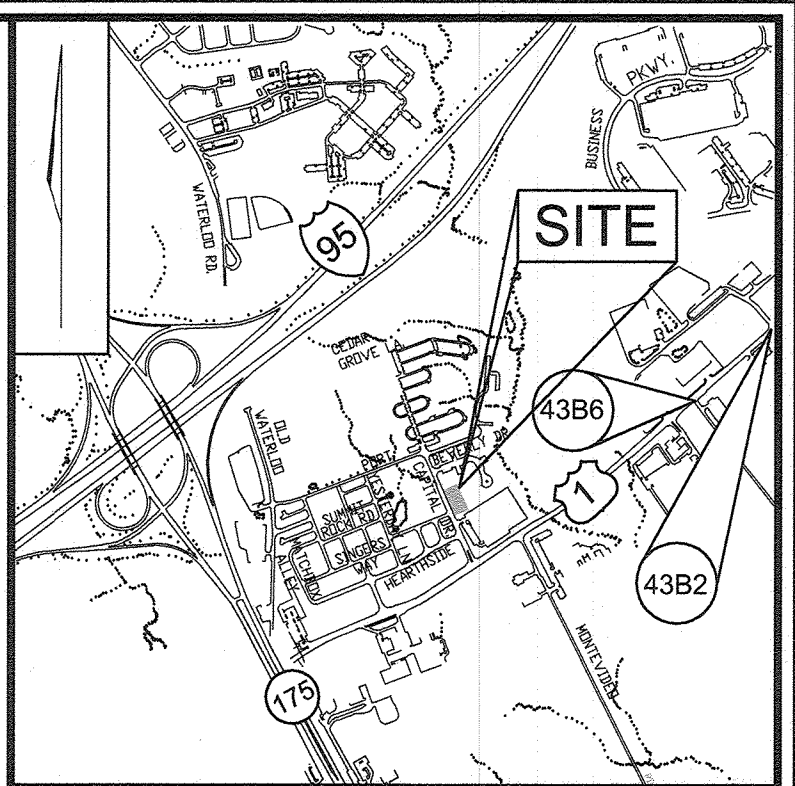

VICINITY MAP
SCALE: 1"=2000'
ADC MAP = PAGE 34 E6

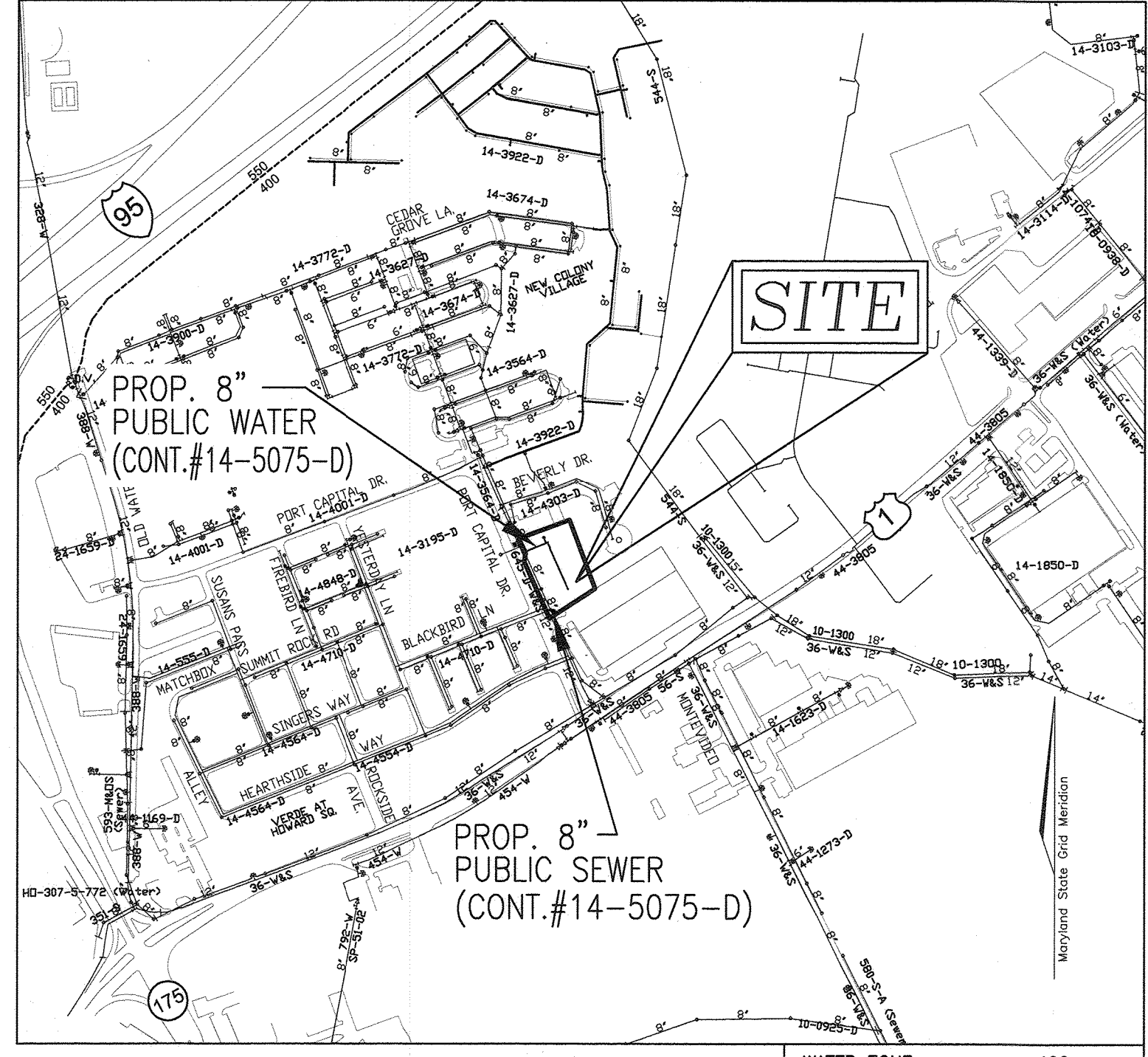

LOCATION PLAN
SCALE: 1"=600'

WATER ZONE:	400
TEST GRADIENT:	677
TEST PRESSURE:	202.46

TYPE OF BUILDING :	RESIDENTIAL
NO. OF APARTMENT BUILDING :	-
NO. OF TOWNHOUSE BUILDING :	26 (STACKED)
NO. OF SINGLE SEWER HOUSE CONNECTIONS :	-
NO. OF TWIN SEWER HOUSE CONNECTIONS :	-
NO. OF SINGLE WATER HOUSE CONNECTIONS :	3
NO. OF TWIN WATER HOUSE CONNECTIONS :	10
SEWER SHED :	PATAPSCO
TREATMENT PLANT :	PATAPSCO RIVER

LEGEND

- EXISTING TREELINE
- PROPOSED TREELINE
- EXISTING WATER MAIN
- PROPOSED WATER MAIN
- FIRE HYDRANT
- PROPOSED VALVE
- PROPOSED TEE
- PROPOSED STORM DRAIN
- EXISTING STORM DRAIN
- EXISTING SEWER
- SEWER MANHOLE
- PRIVATE WATER HOUSE CONNECTION
- PRIVATE SEWER
- PROPOSED SIGN
- PROPOSED LIGHT

QUANTITIES

NAME OF UTILITY CONTRACTOR : GAINES AND COMPANY					
SURVEY AND DRAFTING DIVISION AS-BUILT DATE :					
ITEMS	QUANTITIES ESTIMATED	AS-BUILT			
		QUANTITIES	TYPE	MANUFACTURER/SUPPLIER	
WATER					
8" WATER MAIN (C-900 PVC-DR-14)	326 LF	271	C-900	North American Pipe	
6" WATER MAIN DIP (FH)	17 LF	14	C-900	North American Pipe	
4" WATER MAIN (C-900 PVC-DR-14)	41 LF	40	C-900	North American Pipe	
FIRE HYDRANT	1 EACH	1	A-423	Mueller Company	
12" x 8" TAPPING SLEEVE & W/VLVE	1 EACH	1		Smith Blair	
12" x 4" TAPPING SLEEVE & W/VLVE	1 EACH	1		Smith Blair	
8" x 6" TEE	1 EACH	1	C-153	Tyler/Union	
8" x 4" TEE	2 EACH	2	C-153	Tyler/Union	
8" VALVE	1 EACH	1	C-153	Mueller Company	
6" VALVE	1 EACH	1	C-153	Mueller Company	
4" VALVE	2 EACH	2	C-153	Mueller Company	
8"-1/8" H. BEND	1 EACH	1	C-153	Tyler/Union	
8"-1/16" H. BEND	2 EACH	2	C-153	Tyler/Union	
8"-5" VERT. SWEEP	2 EACH	2	C-153	Tyler/Union	
8" CAP AND BUTTRESS	1 EACH	1	C-153	Tyler/Union	
4" CAP AND BUTTRESS	3 EACH	3	C-153	Tyler/Union	
1" OUTSIDE METER VAULT	13 EACH	12		Horne Concrete	
1-1/2" WHC	239 LF	211	Type - K	Mueller Company	
SEWER					
STANDARD MANHOLE	1 EA	1		Contractors Precast	
8" PVC SEWER	15 LF	15	SDR-35	North American Pipe	

OWNER/DEVELOPER
PORT CAPITAL CENTER OF MARYLAND LLC
PO BOX 416
ELLICOTT CITY, MD 21041
C/O: ARNOLD SAGNER
410-465-2020

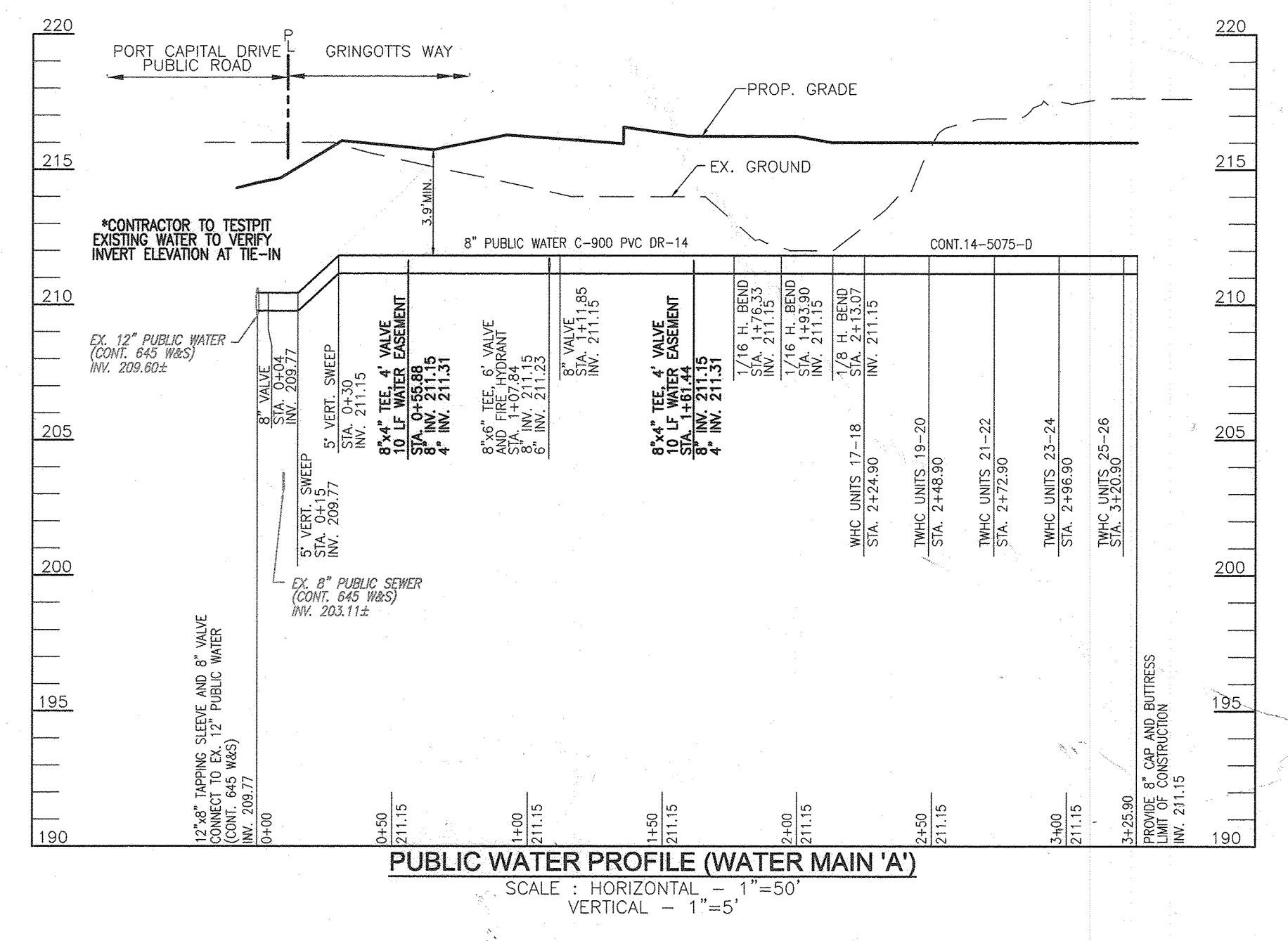
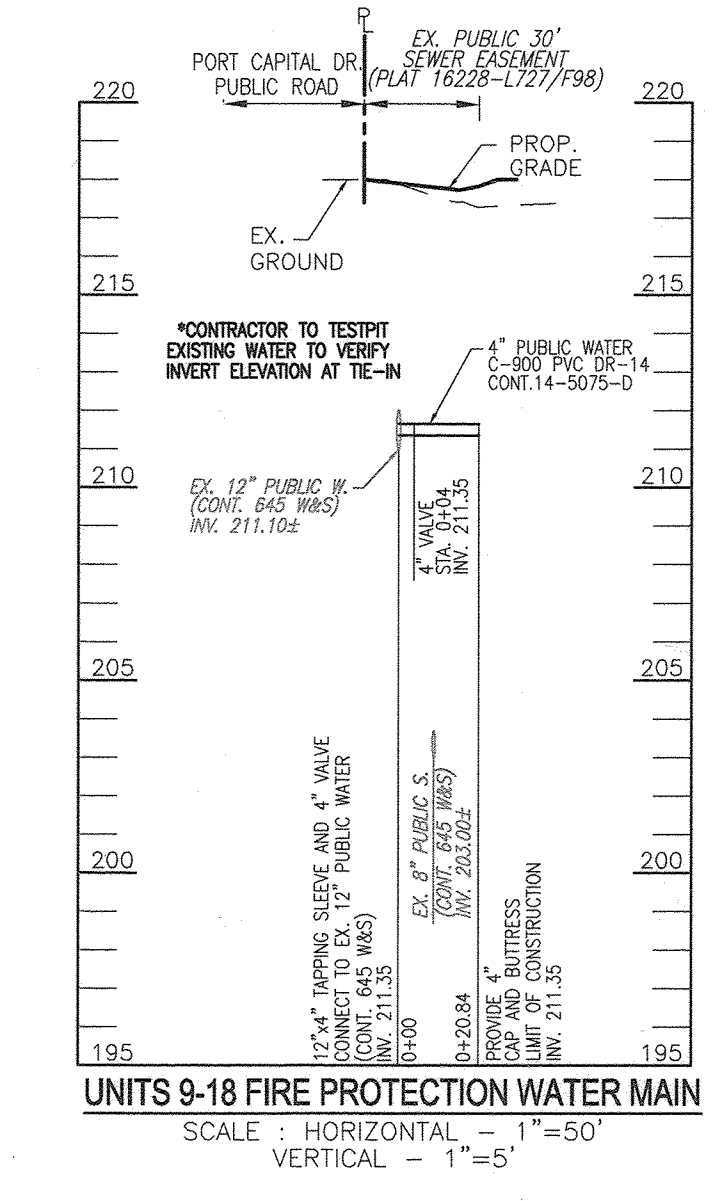
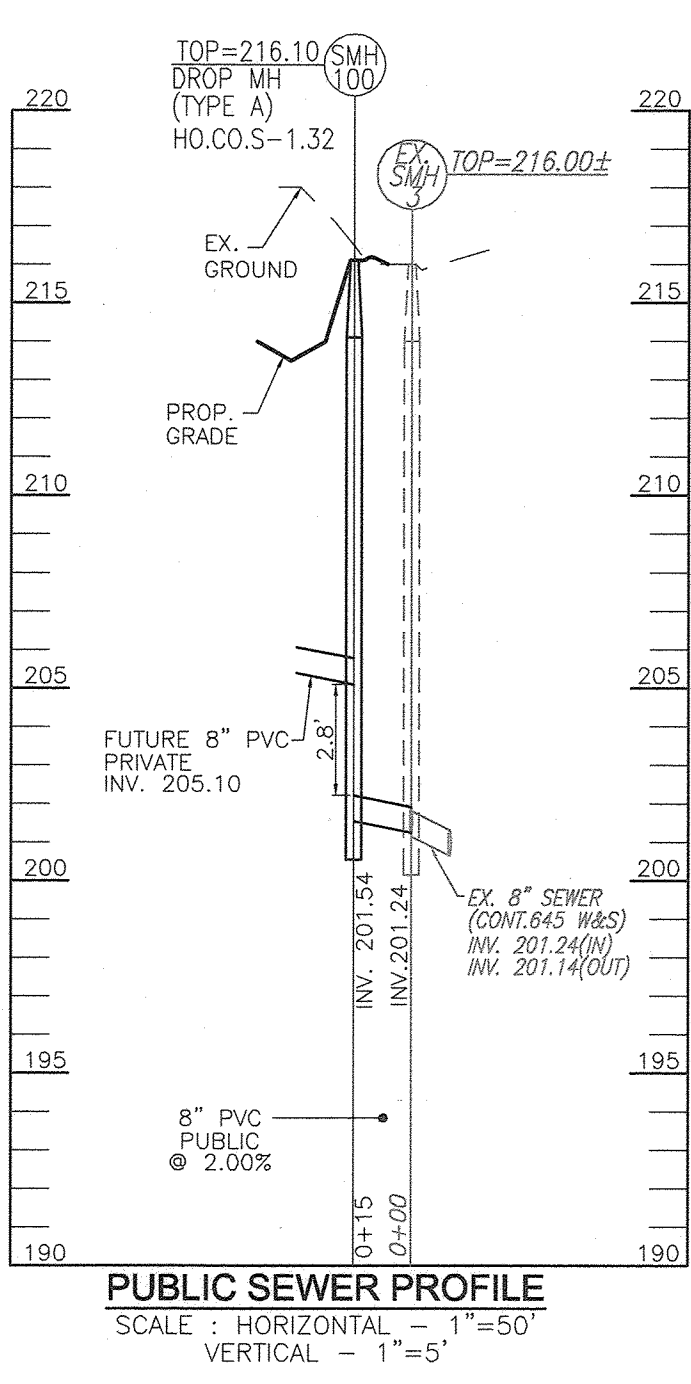
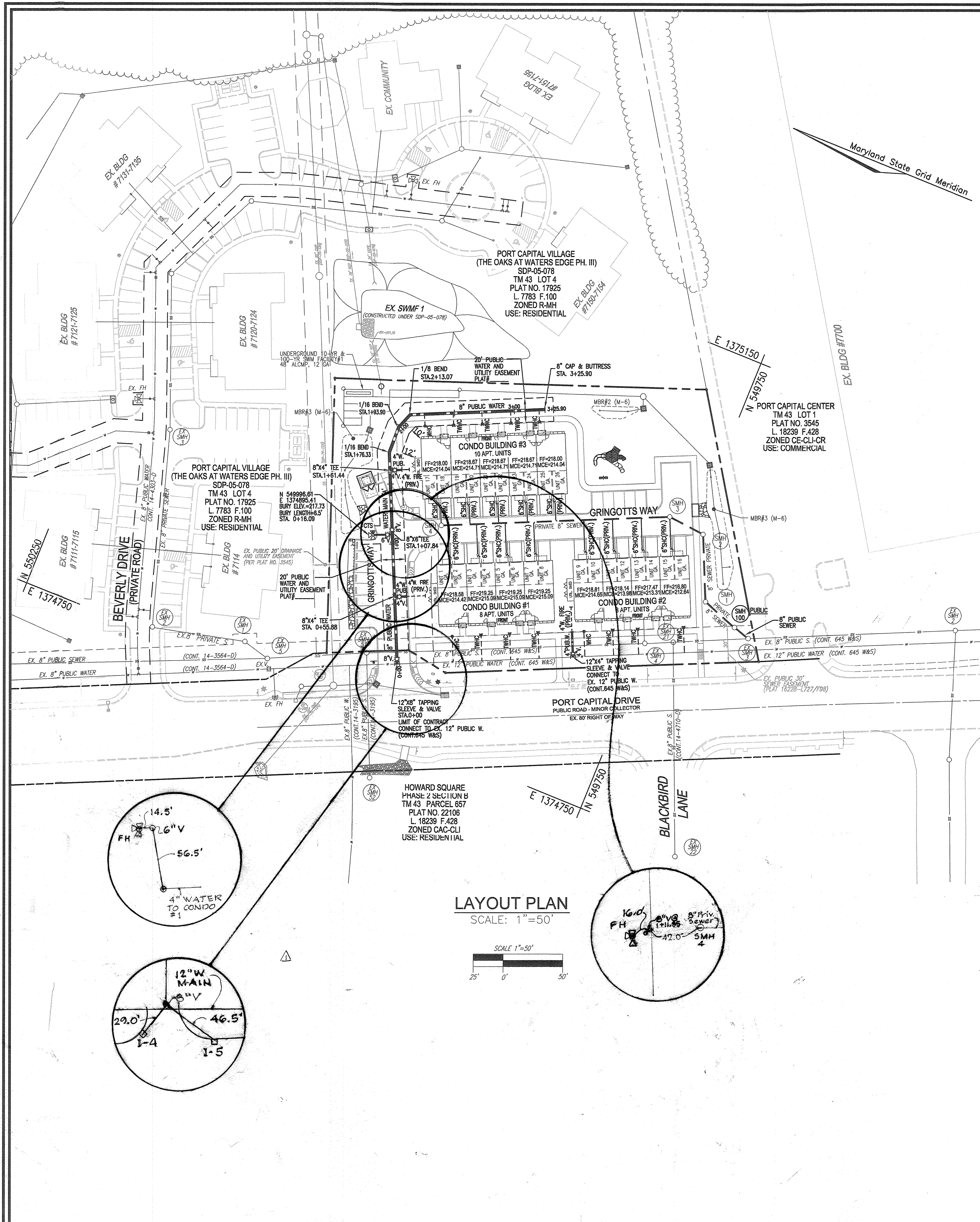

PUBLIC SEWER - MANHOLE LOCATION CHART

MH NO.	TYPE	LOCATION	TOP ELEV.	INV. IN	INV. OUT	REMARKS
SMH-100	STD. PRECAST MANHOLE (G-5.12)	N 549687.66 E 1374937.86	216.10	205.10	201.54	DROP MANHOLE TYPE 'A'
EX. SMH-3	STD. PRECAST MANHOLE (G-5.12)	N 549673.65 E 1374933.55	216.00	201.24 (2)	201.14	

WATER MAIN LOCATION CHART WATER MAIN 'A'

WL STA.	APPURTENANCE	NORTHING	EASTING
WL STA. 0+00	CONNECT TO EX. 12" PUBLIC WATER CONT. 645 W&S	549932.55	1374825.98
WL STA. 0+04.00	8" VALVE	549934.19	1374829.63
WL STA. 0+15.00	5" VERT. SWEEP		
WL STA. 0+30.00	5" VERT. SWEEP		
WL STA. 0+55.88	8"x4" TEE, 4" VALVE	549986.96	1374854.63
WL STA. 1+07.84	8"x6" TEE, 6" VALVE & FIRE HYDRANT	549981.35	1374902.28
WL STA. 1+11.85	8" VALVE	549983.52	1374905.70
WL STA. 1+61.44	8"x4" TEE, 4" VALVE	550003.86	1374950.91
WL STA. 1+76.33	1/16" H BEND	550009.97	1374964.51
WL STA. 1+83.90	1/16" H BEND	550010.25	1374985.95
WL STA. 2+13.07	1/8" H BEND	550005.28	1375000.30
WL STA. 3+25.90	8" CAP AND BUTTRESS	549902.88	1375046.59

UNITS 9-18 FIRE PROTECTION WATER MAIN

WL STA.	APPURTENANCE	NORTHING	EASTING
WL STA. 0+00	CONNECT TO EX. 12" PUBLIC WATER (CONT. 645 W&S)	548803.45	1374864.30
WL STA. 0+04.00	4" VALVE	548804.47	1374866.53
WL STA. 0+20.84	4" CAP AND BUTTRESS	548812.03	1374883.29

NOTES:
1. ALL WATER CONNECTIONS SHALL BE 1-1/2" WITH 1" OUTSIDE OUTSIDE SETTINGS, UNLESS OTHERWISE NOTED. REFER TO HOWARD COUNTY DETAIL W-3.32 FOR TWIN OUTSIDE METER SETTINGS.

WATER HOUSE CONNECTION AS-BUILT TABLE

UNIT	STREET ADDRESS	LOCATION DIMENSION 1	LOCATION DIMENSION 2
BUILDING #1			
1	7738-A PORT CAPITAL DR.	1-5	1-4 76.0
2	7738-B PORT CAPITAL DR.	1-5	1-4 76.0
3	7738-C PORT CAPITAL DR.	1-5	1-4 79.0
4	7738-D PORT CAPITAL DR.	1-5	1-4 79.0
5	7738-E PORT CAPITAL DR.	1-5	73.5 WHC Lot 4 23.0
6	7738-F PORT CAPITAL DR.	1-5	73.5 WHC Lot 4 23.0
7	7732-A PORT CAPITAL DR.	1-5	72.0 WHC Lot 4 47.5
8	7732-B PORT CAPITAL DR.	1-5	72.0 WHC Lot 4 47.5
SPRINKLER ROOM	7730 PORT CAPITAL DR.	FH 1-61.1-1	56.5 I-5 86.0
BUILDING #2			
9	7728-A PORT CAPITAL DR.	Ex. SMH-4	51.0 Ex. SMH-21 74.0
10	7728-B PORT CAPITAL DR.	Ex. SMH-4	51.0 Ex. SMH-21 74.0
11	7726-A PORT CAPITAL DR.	Ex. SMH-4	23.5 Ex. SMH-21 51.0
12	7726-B PORT CAPITAL DR.	Ex. SMH-4	23.5 Ex. SMH-21 51.0
13	7724-A PORT CAPITAL DR.	Ex. SMH-4	13.5 Ex. SMH-21 31.0
14	7724-B PORT CAPITAL DR.	Ex. SMH-4	13.5 Ex. SMH-21 31.0
15	7722-A PORT CAPITAL DR.	Ex. SMH-4	37.0 Ex. SMH-21 16.0
16	7722-B PORT CAPITAL DR.	Ex. SMH-4	37.0 Ex. SMH-21 16.0
SPRINKLER ROOM	7720 PORT CAPITAL DR.	Ex. SMH-4	64.0 Ex. SMH-21 85.5
BUILDING #3			
SPRINKLER ROOM	7799 GRINGOTTS WAY	1-1	39.0 WHC Condo Building #1 104.5
17	7201-A GRINGOTTS WAY	1-1	48.0 SWMF #1 Access MH "A" 37.0
18	7201-B GRINGOTTS WAY	1-1	45.0 SWMF #1 Access MH "A" 37.0
19	7201-C GRINGOTTS WAY	1-1	60.0 SWMF #1 Access MH "A" 30.5
20	7201-D GRINGOTTS WAY	1-1	60.0 SWMF #1 Access MH "A" 30.5
21	7205-A GRINGOTTS WAY	1-1	92.0 SWMF #1 Access MH "A" 39.5
22	7205-B GRINGOTTS WAY	1-1	92.0 SWMF #1 Access MH "A" 39.5
23	7207-A GRINGOTTS WAY	1-2	111.5 SWMF #1 Access MH "A" 89.0
24	7207-B GRINGOTTS WAY	1-2	111.5 SWMF #1 Access MH "A" 89.0
25	7209-A GRINGOTTS WAY	1-3	89.5 SWMF #1 Access MH "A" 78.0
26	7209-B GRINGOTTS WAY	1-3	89.5 SWMF #1 Access MH "A" 78.0

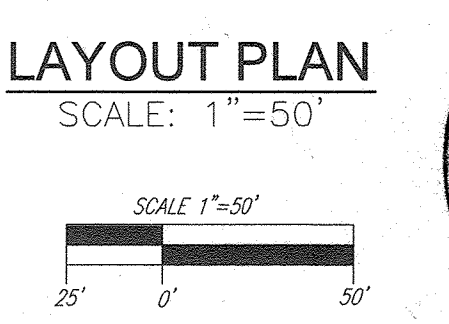

DEPARTMENT OF PUBLIC WORKS HOWARD COUNTY, MARYLAND 	DEPARTMENT OF PLANNING & ZONING HOWARD COUNTY, MARYLAND 	VOGEL ENGINEERING TIMMONS GROUP 3300 NORTH RIDGE ROAD, SUITE 110, ELLICOTT CITY, MD 21043 P: 410.461.7666 F: 410.461.8961 www.timmons.com	PROFESSIONAL CERTIFICATE I HEREBY CERTIFY THAT THESE DOCUMENTS WERE PREPARED OR APPROVED BY ME AND THAT I AM A DULY LICENSED PROFESSIONAL ENGINEER UNDER THE LAWS OF THE STATE OF MARYLAND, LICENSE NO. 16183 EXPIRATION DATE: 09-27-2022 DRN: LRC/KG DES: LRC CHK: RHV DATE: DECEMBER 2020 REPORT H. VOGEL, PE No. 16193	FINAL WATER AND SEWER CONSTRUCTION PLAN CONTRACT 14-5075-D LAYOUT & PROFILES WRA J AS BUILT DATE: 2/17/23 BY: NO. REVISION DATE: 600' SCALE MAP NO. 43 BLOCK NO. 4	POTTER'S PLACE (THE OAKS AT WATERS EDGE PHASE III-PARCEL A) SCALE AS SHOWN SHEET 2 OF 2 TAX MAP 43 GRID 4 1ST ELECTION DISTRICT PARCEL 644 HOWARD COUNTY, MARYLAND
---	--	--	--	--	--