

QUANTITIES				
ITEM	ESTIMATED	QUANTITIES	AS-BUILT	SUPPLIER
6" W. C900 PVC DR-18	650 L.F.	615 L.F.	C 900	BRS
6" W. C900 PVC DR-18	35 L.F.	35 L.F.	C 900	BRS
1-1/2" W.H.C.	95 L.F.	110 L.F.	Copper	BRS
1/16 H.B.	4 EACH	4 Ea.	8" M.J.	BRS
8" X 8" TAPPING SLAVE	2 EACH	2 Ea.	8" X 8"	BRS
8" TAPPING VALVE	2 EACH	2 Ea.	8" X 8" Ford	BRS
8" X 6" F.H. TEE	2 EACH	2 Ea.	8" X 6" HD	BRS
8" VALVE	2 EACH	2 Ea.	Gate	BRS
8" VALVE	2 EACH	2 Ea.	Gate	BRS
FIRE HYDRANT	2 EACH	2 Ea.	Mueller	BRS
CONTINUITY TEST STATION	2 EACH	2 Ea.	Mueller	BRS
8" PLUG & BUTTRESS	2 EACH	2 Ea.	A* DI	BRS
OUTSIDE METER SETTING	1 EACH	1 Ea.	24x30 Concast	BRS

NAME OF UTILITY CONTRACTOR: Cosentino Contracting Co.
 SURVEY & DRAFTING DIVISION AS-BUILT DATE:

BENCHMARK INFORMATION

B.M.#1 - HOWARD COUNTY CONTROL STATION #17A - HORIZONTAL - (NAD '83)
 (LOCATED ALONG THE SOUTH SIDE OF ROUTE 99; OLD FREDERICK ROAD, AT THE INTERSECTION OF OLD FREDERICK ROAD AND WETHERBURN ROAD, APPROX. 9.3' OFF THE PAVING OF OLD FREDERICK ROAD AND APPROX. 14.8' WEST OF THE END OF A WOOD FENCE.)
 N 598,435.302
 E 1,348,615.301
 ELEVATION = 508.401 - VERTICAL - (NAVD '88)

B.M.#2 - HOWARD COUNTY CONTROL STATION #17D - HORIZONTAL - (NAD '83)
 (LOCATED ALONG THE NORTH SIDE OF ROUTE 99; OLD FREDERICK ROAD, APPROX. 10.5' OF THE EDGE OF PAVING AND APPROX. 78.1' WEST OF POWER POLE #27384)
 N 595,410.810
 E 1,351,641.161
 ELEVATION = 481.246 - VERTICAL - (NAVD '88)

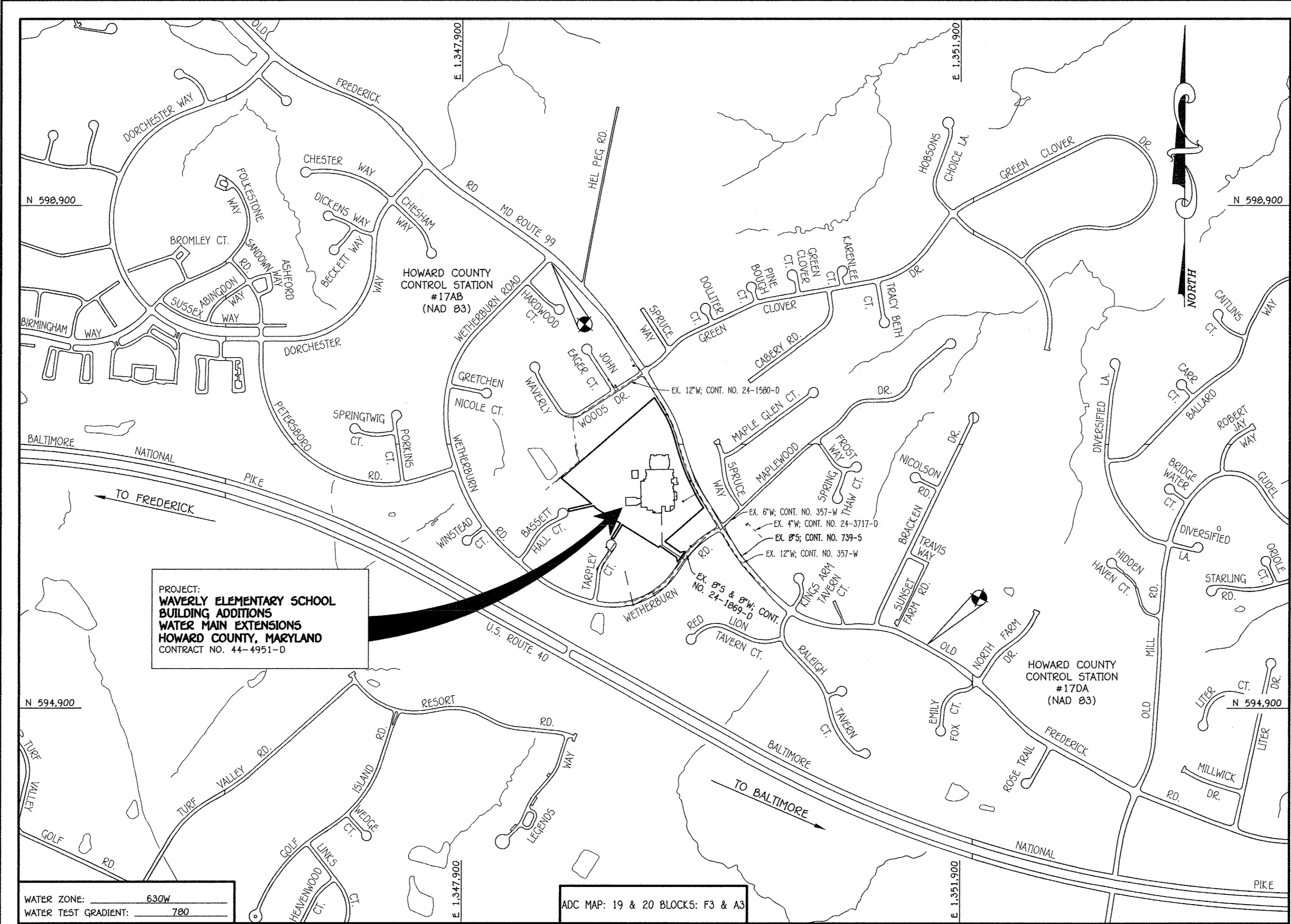

LOCATION MAP
 SCALE: 1" = 600'

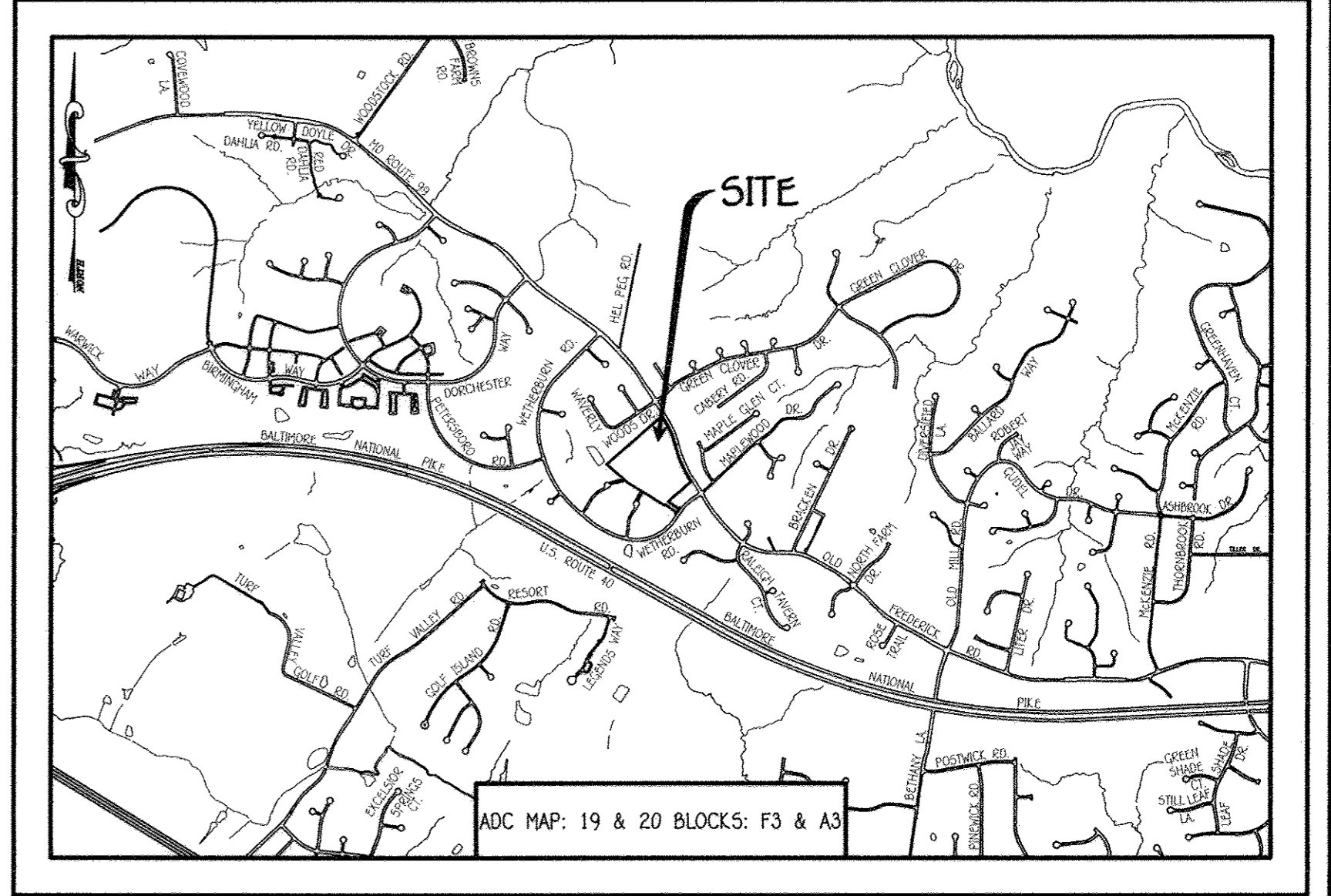

- GENERAL NOTES**
- APPROXIMATE LOCATIONS OF EXISTING MAINS ARE SHOWN. THE CONTRACTOR SHALL TAKE ALL NECESSARY PRECAUTIONS TO PROTECT EXISTING MAINS AND SERVICES AND MAINTAIN UNINTERRUPTED SERVICE. ANY DAMAGE INCURRED SHALL BE REPAIRED IMMEDIATELY TO THE SATISFACTION OF THE ENGINEER AT THE CONTRACTOR'S EXPENSE.
 - TOPOGRAPHIC FIELD SURVEYS WERE PROVIDED ON OR ABOUT AUGUST, 2015 BY FISHER, COLLINS & CARTER, INC.
 - HORIZONTAL AND VERTICAL SURVEY CONTROLS: THE COORDINATES SHOWN ON THE DRAWINGS ARE BASED ON MARYLAND STATE REFERENCE SYSTEM NAD '83/91' AS PROJECTED BY HOWARD COUNTY GEODETIC CONTROL STATIONS NO. 17A & NO. 17D. ALL VERTICAL CONTROLS ARE BASED ON NAVD '88. VERTICAL CONTROLS PROVIDED ON THE DRAWINGS.
 - ALL PIPE ELEVATIONS SHOWN ARE INVERT ELEVATIONS UNLESS OTHERWISE NOTED ON THE PLANS.
 - CLEAR ALL UTILITIES OR OBSTACLES FROM THE WORK AREA. CLEAR ALL POLES BY 5'-0" MINIMUM OR TUNNEL AS REQUIRED UNLESS OTHERWISE NOTED. THE OWNER HAS CONTACTED THE UTILITY COMPANIES AND HAS MADE ARRANGEMENTS FOR BRACING OF POLES AS SHOWN ON THE DRAWINGS. IN THE EVENT THE CONTRACTOR'S WORK REQUIRES BRACING OF ADDITIONAL POLES, ANY COST INCURRED BY THE OWNER FOR THE BRACING OF THE ADDITIONAL POLES OR DAMAGES SHALL BE DEDUCTED FROM MONIES OWED THE CONTRACTOR. THE CONTRACTOR SHALL COORDINATE WITH THE UTILITY COMPANIES TO SCHEDULE THE BRACING OF THE POLES.
 - FOR DETAILS NOT SHOWN ON THE DRAWINGS, AND FOR MATERIALS AND CONSTRUCTION METHODS, USE HOWARD COUNTY DESIGN MANUAL, VOLUME IV, STANDARD SPECIFICATIONS AND DETAILS FOR CONSTRUCTION (LATEST EDITION). THE CONTRACTOR SHALL HAVE A COPY OF VOLUME IV ON THE JOB SITE.
 - WHERE TEST FITS HAVE BEEN MADE ON EXISTING UTILITIES, THEY ARE NOTED BY THE SYMBOL AT THE LOCATIONS OF THE TEST FITS. A NOTE OR NOTES CONTAINING THE RESULTS OF THE TEST PIT OR FITS IS INCLUDED ON THE DRAWINGS. EXISTING UTILITIES IN THE VICINITY OF THE PROPOSED WORK FOR WHICH TEST FITS HAVE NOT BEEN DUG SHALL BE LOCATED BY THE CONTRACTOR TWO WEEKS IN ADVANCE OF CONSTRUCTION OPERATIONS AT HIS OWN EXPENSE.
 - THE CONTRACTOR SHALL NOTIFY THE FOLLOWING UTILITY COMPANIES OR AGENCIES AT LEAST FIVE WORKING DAYS BEFORE STARTING WORK SHOWN ON THESE PLANS:

AT&T	1-800-252-1133
BCE (CONTRACTOR SERVICES)	410-637-8713
BCE (EMERGENCY)	410-699-0123
BUREAU OF UTILITIES	410-319-4900
COLONIAL PIPELINE CO.	410-795-1390
MISS UTILITY	1-800-257-7777
STATE HIGHWAY ADMINISTRATION	410-531-5533
VERIZON	1-800-743-0033 / 410-224-9210
 - TREES AND SHRUBS ARE TO BE PROTECTED FROM DAMAGE TO THE MAXIMUM EXTENT. TREES AND SHRUBS LOCATED WITHIN THE CONSTRUCTION STRIP ARE NOT TO BE REMOVED OR DAMAGED BY THE CONTRACTOR.
 - CONTRACTOR SHALL REMOVE TREES AND SHRUBS ALONG THE LINE OF EXCAVATION. PAYMENT FOR SUCH REMOVAL SHALL BE INCLUDED IN THE UNIT PRICE BID FOR THE CONSTRUCTION OF THE MAIN.
 - THE CONTRACTOR SHALL NOTIFY THE BUREAU OF HIGHWAYS, HOWARD COUNTY, AT (410)-319-7450 AT LEAST FIVE WORKING DAYS BEFORE OPEN CUTTING OR BORING UNDER ANY COUNTY ROAD FOR LAYING WATER/SEWER MAINS OR HOUSE CONNECTIONS. THE APPROVAL OF THESE DRAWINGS WILL CONSTITUTE COMPLIANCE WITH DPW REQUIREMENTS PER SECTION 18.114(f) OF THE HOWARD COUNTY CODE.

- PART B: WATER MAIN GENERAL NOTES**
- ALL WATER MAINS SHALL BE AMMA C900 PVC DR-18.
 - TOP OF ALL WATER MAINS SHALL HAVE A MINIMUM OF 3'-6" OF COVER UNLESS OTHERWISE NOTED.
 - VALVES ADJACENT TO TREES SHALL BE STRAPPED TO TREES.
 - ALL FITTINGS SHALL BE BUTTRESSED OR ANCHORED WITH CONCRETE IN ACCORDANCE WITH STANDARD DETAILS UNLESS OTHERWISE PROVIDED FOR ON THE DRAWINGS.
 - FIRE HYDRANTS SHALL BE SET TO THE BURY LINE ELEVATIONS SHOWN ON THE DRAWINGS. ALL FIRE HYDRANTS SHALL BE INSTALLED IN ACCORDANCE WITH STANDARD DETAILS. THE SOIL AROUND THE FIRE HYDRANT SHALL BE COMPACTED IN ACCORDANCE WITH SECTION 1000 AND SECTION 1005 OF THE STANDARD SPECIFICATIONS.
 - THE CONTRACTOR SHALL NOT OPERATE ANY WATER MAIN VALVES ON THE EXISTING WATER SYSTEM.
 - TRACER WIRE AND CONTINUITY TEST STATIONS SHALL BE INSTALLED ON ALL D.I.P. AND PVC WATER MAINS IN ACCORDANCE WITH HOWARD COUNTY DESIGN MANUAL.
 - FOR PVC WATER MAINS, ALL RECORDS FOR THE QUALITY CONTROL AND QUALIFICATION TEST REQUIREMENTS NOTED IN SECTION 5.1 OF THE AMMA STANDARD C900 FOR PVC PRESSURE PIPE SHALL BE SUBMITTED WITH THE PIPE MATERIAL CERTIFICATIONS OR SHOP DRAWINGS PRIOR TO APPROVAL OF THE MATERIAL FOR USE. THE TEST RECORDS SHALL BE FOR THE PIPE TO BE INSTALLED UNDER THIS CONTRACT. ALL PVC PIPE SHALL CONTAIN MARKINGS TO ALLOW CROSS REFERENCING OF THE PIPE SUPPLIED TO THE TEST RECORDS RECEIVED.
 - UNLESS OTHERWISE NOTED ON THE PLANS OR IN THE SPECIFICATIONS, SEVENTEEN (17) POUND SACRIFICIAL ANODES SHALL BE INSTALLED ON ALL VALVES AND METALLIC FITTINGS USED WITH PVC WATER MAINS IN ACCORDANCE WITH VOLUME IV, STANDARD SPECIFICATIONS AND DETAILS FOR CONSTRUCTION. MAGNESIUM ANODES SHALL BE INSTALLED ON ALL VALVES AND DUCTILE IRON FITTINGS INCLUDING RESTRAINTS AND HARNESSSES. ZINC ANODES SHALL BE INSTALLED ON ALL STAINLESS STEEL FITTINGS AND SADDLES USED WITH PVC MAINS. ALL "TEES" USED WITH PVC MAINS SHALL BE DUCTILE IRON.
 - PROPER ASSEMBLY OF GASKETED PVC PIPE JOINTS: THE MANUFACTURER'S INSERTION LINE OF GASKETED PVC PIPE JOINTS INDICATES THE MAXIMUM DEPTH OF INSERTION OF THE SPIGOT INTO THE BELL. AFTER ASSEMBLY OF THE JOINT, THE INSERTION LINE SHALL REMAIN VISIBLE. DUAL INSERTION LINES ON GASKETED PVC PIPE INDICATE THE MAXIMUM AND MINIMUM DEPTH OF INSERTION OF THE SPIGOT INTO THE BELL. THE CONTRACTOR SHALL NOT OVER INSERT OR PUSH ON BELL JOINT ON BOTH SIDES OF THE HIGH DEFLECTION COUPLINGS AND 5-DEGREE SWEEPS. BELL STOPS SHALL BE PLACED AT THE PROPER INSERTION LINE FOR THE FITTING. THE BELL STOP SHALL BE MANUFACTURED OF DUCTILE IRON AND INCORPORATE AN EXPANSION RETENTION SPRING TO ALLOW FOR PIPE EXPANSION AND CONTRACTION. THE BELL STOPS SHALL BE SERIES 3000 HIGH-STOP, AS MANUFACTURED BY EBARA IRON, INC. OR APPROVED EQUAL.
 - TO ACCOMMODATE A SPRINKLER SYSTEM, ALL RESIDENTIAL DWELLING UNITS SHALL HAVE A 1-1/2" WATER HOUSE CONNECTION WITH A 1" OUTSIDE METER SETTING, STD. DET. W-3.28.

- PART C: SEWER MAIN GENERAL NOTES**
- ALL SEWER MAINS SHALL BE D.I.P. OR P.V.C. UNLESS OTHERWISE NOTED.
 - ALL MANHOLES SHALL BE 41" INSIDE DIAMETER UNLESS OTHERWISE NOTED.
 - FORCE MAINS SHALL BE D.I.P. ONLY.
 - MANHOLES SHOWN WITH 1/2" AND 1/8" WALLS ARE FOR BRICK MANHOLES ONLY.
 - MANHOLES DESIGNATED M.T. IN PLAN AND PROFILE SHALL HAVE WATERIGHT FRAME AND COVER, STANDARD DETAIL G5.52. WHERE WATERIGHT MANHOLE FRAMES AND COVERS ARE USED, SET TOP OF FRAME 1'-6" ABOVE FINISHED GRADE UNLESS OTHERWISE NOTED ON THE DRAWINGS.
 - HOUSE(S) WITH THE SYMBOL "C.N.S." INDICATES THAT CELLAR CANNOT BE SERVED.

OWNER / DEVELOPER
 PREPARED FOR:
 HOWARD COUNTY PUBLIC SCHOOL SYSTEM
 HARRIET TUBMAN BUILDING
 8045 HARRIET TUBMAN LANE
 COLUMBIA, MARYLAND 21044
 ATTENTION: MR. SCOTT WASHINGTON
 410-319-6895

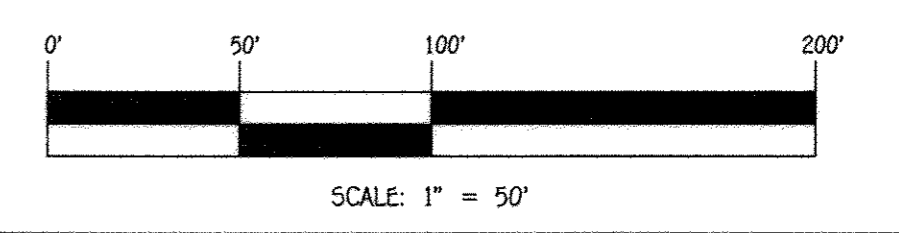

CONTRACT NO. 44-4951-D
 WAVERLY ELEMENTARY SCHOOL
 BUILDING ADDITIONS
 WATER MAIN EXTENSIONS
 HOWARD COUNTY, MARYLAND

CONTRACT NO. 44-4951-D

WAVERLY

ELEMENTARY SCHOOL

BUILDING ADDITIONS

WATER MAIN EXTENSIONS

HOWARD COUNTY, MARYLAND

DEVELOPER'S CERTIFICATION

"I/WE HEREBY CERTIFY THAT ALL DEVELOPMENT AND CONSTRUCTION WILL BE DONE ACCORDING TO THIS PLAN OF DEVELOPMENT AND PLAN FOR EROSION AND SEDIMENT CONTROL AND THAT ALL RESPONSIBLE PERSONNEL INVOLVED IN THE CONSTRUCTION PROJECT WILL HAVE A CERTIFICATE OF ATTENDANCE AT THE DEPARTMENT OF THE ENVIRONMENT APPROVED TRAINING PROGRAM FOR THE CONTROL OF SEDIMENT AND EROSION BEFORE BEGINNING THE PROJECT. I ALSO AUTHORIZE PERIODIC ON-SITE INSPECTION BY THE HOWARD SOIL CONSERVATION DISTRICT OR THEIR AUTHORIZED AGENTS, AS ARE DEEMED NECESSARY."

Paul W. Kriebel, FOR:
HOWARD COUNTY PUBLIC SCHOOL SYSTEM 03-22-16
 SIGNATURE OF DEVELOPER DATE

ENGINEER'S CERTIFICATION

"I HEREBY CERTIFY THAT THIS PLAN FOR EROSION AND SEDIMENT CONTROL REPRESENTS A PRACTICAL AND WORKABLE PLAN BASED ON MY PERSONAL KNOWLEDGE OF THE SITE CONDITIONS AND THAT IT WAS PREPARED IN ACCORDANCE WITH THE REQUIREMENTS OF THE HOWARD SOIL CONSERVATION DISTRICT."

Paul W. Kriebel, FOR:
HOWARD COUNTY PUBLIC SCHOOL SYSTEM 03/22/16
 SIGNATURE OF DEVELOPER DATE

LEGEND	
SYMBOL	DESCRIPTION
---	EX. WATER MAIN
---	EX. SEWER MAIN
○	EX. SEWER MANHOLE
---	EX. SEWER, WATER & UTILITY EASEMENT
○	EX. FIRE HYDRANT
○	EX. VALVE
---	PROP. WATER MAIN
---	PROP. SEWER MAIN
●	PROP. SEWER MANHOLE
---	PROP. SEWER, WATER & UTILITY EASEMENT
---	PROP. W.H.C.
---	PROP. S.H.C.
○	PROP. FIRE HYDRANT
○	PROP. VALVE

SDP-89-146 (REDLINE)

THIS DEVELOPMENT IS APPROVED FOR EROSION AND SEDIMENT CONTROL BY HOWARD SOIL CONSERVATION DISTRICT.

APPROVED:
John R. Roberts 4/12/16
 HOWARD SOIL CONSERVATION DISTRICT DATE

DEPARTMENT OF PUBLIC WORKS
 HOWARD COUNTY, MARYLAND

John C. Coe 3/24/16
 CHIEF, BUREAU OF UTILITIES DATE

DEPARTMENT OF PLANNING AND ZONING
 HOWARD COUNTY, MARYLAND

Chad Edwards 4-26-16
 CHIEF, DEVELOPMENT ENGINEERING DIVISION DATE

I HEREBY CERTIFY THAT THESE DOCUMENTS WERE PREPARED OR APPROVED BY ME, AND THAT I AM A FULLY LICENSED PROFESSIONAL ENGINEER UNDER THE LAWS OF THE STATE OF MARYLAND.
 LICENSE NO. 12245, EXPIRATION DATE 5/7/16/16.

FISHER, COLLINS & CARTER, INC.
 CIVIL ENGINEERING CONSULTANTS & LAND SURVEYORS
 CENTENNIAL SQUARE OFFICE PARK - 10272 BALTIMORE NATIONAL PIKE
 ELICOTT CITY, MARYLAND 21042
 (410) 461-2895

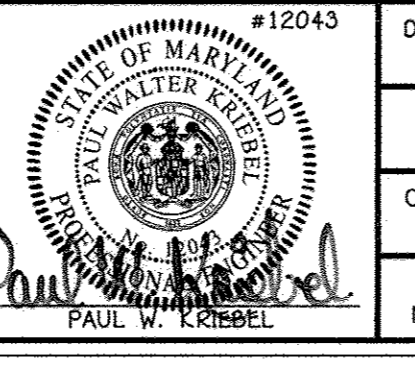

DESIGNED BY:	B.C.R.
DRAWN BY:	B.C.R.
CHECKED BY:	P.W.K.
DATE:	MARCH, 2016
BY NO.	
REVISION	
DATE	

WATER MAIN EXTENSIONS TITLE SHEET

600' SCALE MAP NO. 0017 BLOCK NO. 0007
 F.C.C. WORK ORDER NO. 05116
 FILE NAME: WATER MAIN EXTENSION PLAN

WAVERLY ELEMENTARY SCHOOL BUILDING ADDITIONS WATER MAIN EXTENSIONS
 CONTRACT NO. 44-4951-D
 SECOND ELECTION DISTRICT
 HOWARD COUNTY, MARYLAND

SCALE AS SHOWN
 SHEET 1 OF 3

AS/1/11/16

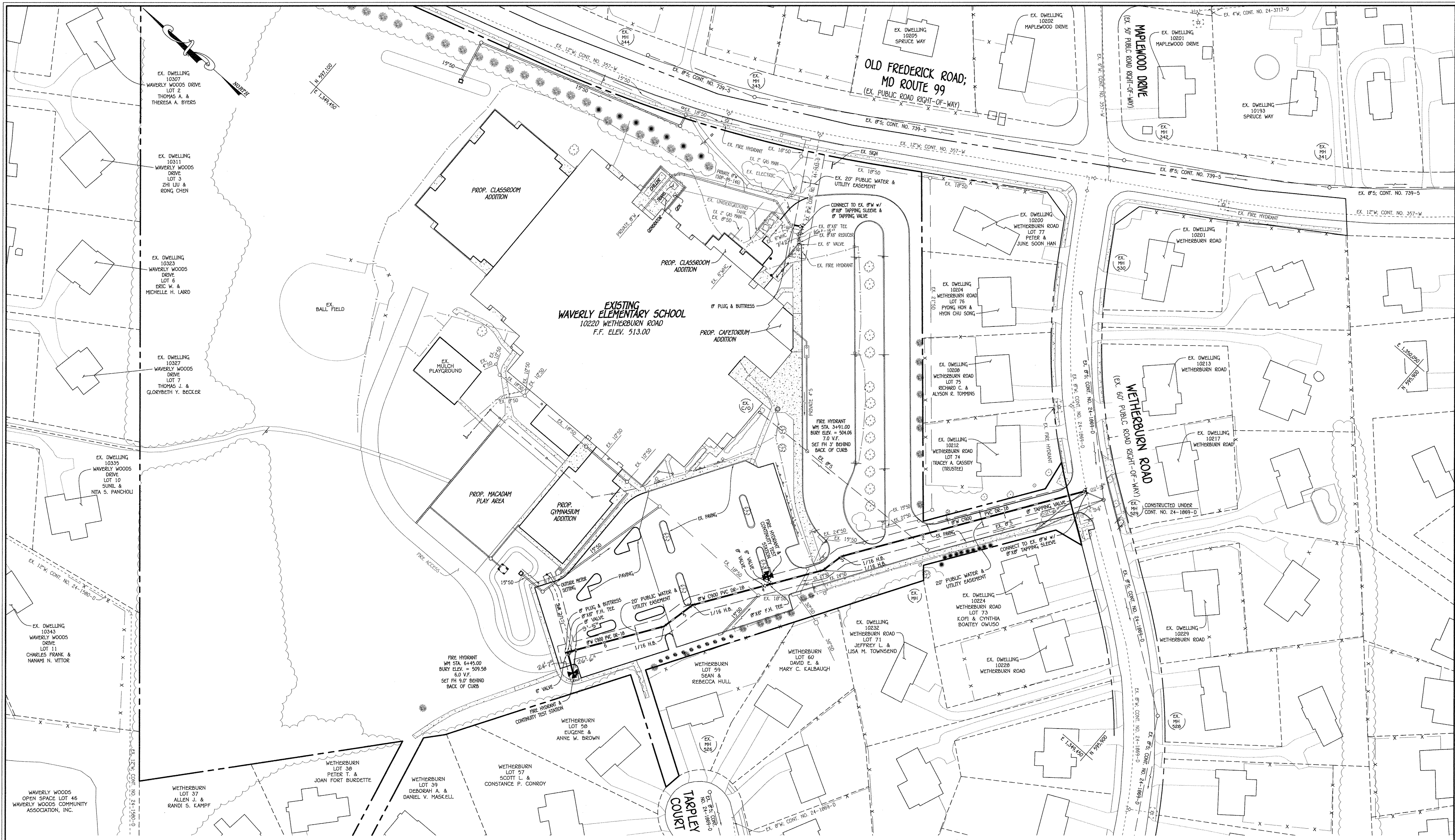

PLAN
SCALE: 1" = 50'

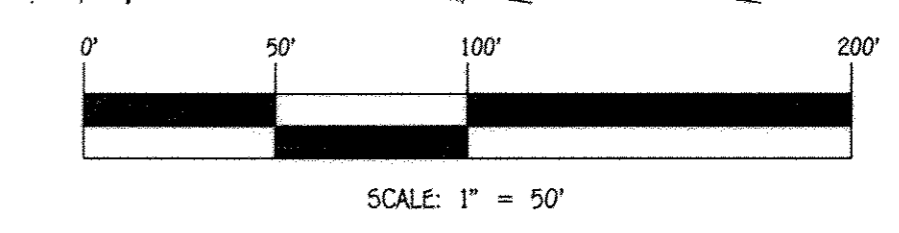

CONTRACT NO. 44-4951-D
WAVERLY ELEMENTARY SCHOOL
BUILDING ADDITIONS
WATER MAIN EXTENSIONS
HOWARD COUNTY, MARYLAND

DEPARTMENT OF PUBLIC WORKS
HOWARD COUNTY, MARYLAND
John C. Green
CHIEF, BUREAU OF UTILITIES
DATE: 3/20/16

DEPARTMENT OF PLANNING AND ZONING
HOWARD COUNTY, MARYLAND
John J. Camp
CHIEF, DEVELOPMENT ENGINEERING DIVISION
DATE: 4-20-16

I HEREBY CERTIFY THAT THESE DOCUMENTS WERE PREPARED OR APPROVED BY ME, AND THAT I AM A DULY LICENSED PROFESSIONAL ENGINEER UNDER THE LAWS OF THE STATE OF MARYLAND.
LICENSE NO. 12243, EXPIRATION DATE: 9/7/16/16.
FISHER, COLLINS & CARTER, INC.
CIVIL ENGINEERING CONSULTANTS & LAND SURVEYORS
CENTRAL SQUARE OFFICE PARK - 10272 BALDORNE NATIONAL FEE
ELICOTT CITY, MARYLAND 21042
(410) 461-2895

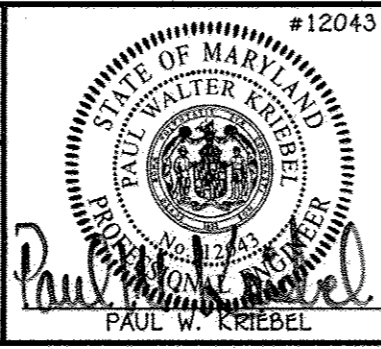

DESIGNED BY:	B.C.R.
DRAWN BY:	B.C.R.
CHECKED BY:	P.W.K.
DATE:	MARCH, 2016
BY NO.	
REVISION	

WATER MAIN EXTENSIONS
PLAN
600' SCALE MAP NO. 0017 BLOCK NO. 0007
F.C.C. WORK ORDER NO. 05116
DATE: FILE NAME: WATER MAIN EXTENSION PLAN

WAVERLY ELEMENTARY SCHOOL
BUILDING ADDITIONS
WATER MAIN EXTENSIONS
CONTRACT NO. 44-4951-D
SECOND ELECTION DISTRICT
HOWARD COUNTY, MARYLAND
SCALE AS SHOWN
SHEET 2 OF 3

John J. Camp

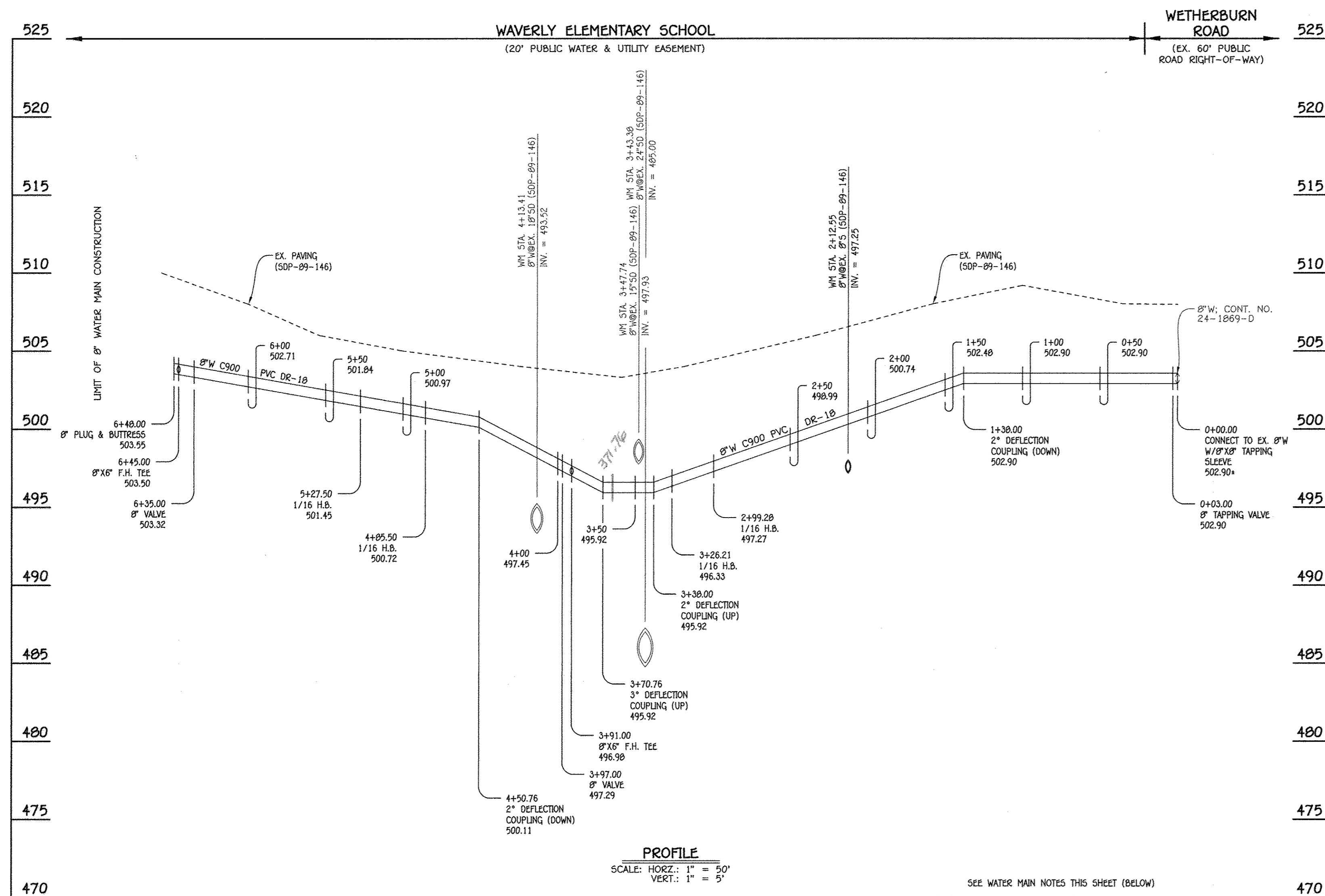

8" WATER MAIN: WAVERLY ELEMENTARY SCHOOL

W.M. STA.	APPURTENANCE	NORTHING	EASTING
8" WATER MAIN: WAVERLY ELEMENTARY SCHOOL			
0+00.00	8"X8" TAPPING SLEEVE	596101.13	1349684.05
0+03.00	8" VALVE	596102.83	1349681.58
2+99.28	1/16 H.B.	596270.44	1349437.26
3+26.21	1/16 H.B.	596276.34	1349410.99
3+91.00	8"X6" F.H. TEE	596312.99	1349357.56
3+97.00	8" VALVE	596316.39	1349352.62
4+85.50	1/16 H.B.	596366.45	1349279.64
5+27.50	1/16 H.B.	596375.65	1349238.66
6+35.00	8" VALVE	596436.47	1349150.02
6+45.00	8"X6" F.H. TEE	596442.13	1349141.77
6+48.00	8" PLUG & BUTTRESS	596443.83	1349139.30

- WATER MAIN NOTES:**
1. ALL WATER MAINS SHALL BE AWWA C900 PVC PIPE; DR-18.
 2. ALL PIPE BEDDING, TRACER WIRE, LOCATING TAPE AND OTHER APPURTENANCES SHALL BE IN ACCORDANCE WITH THE HOWARD COUNTY DESIGN MANUAL, VOLUME IV - WATER AND SEWER STANDARDS FOR AWWA C900 PVC WATER PIPE INSTALLATION.
 3. DEFLECTION COUPLINGS SHALL BE CERTAIN-TEED PVC HIGH DEFLECTION COUPLINGS.
 4. ALL WATER HOUSE CONNECTIONS AND TAPS SHALL BE PERFORMED USING A SADDLE.

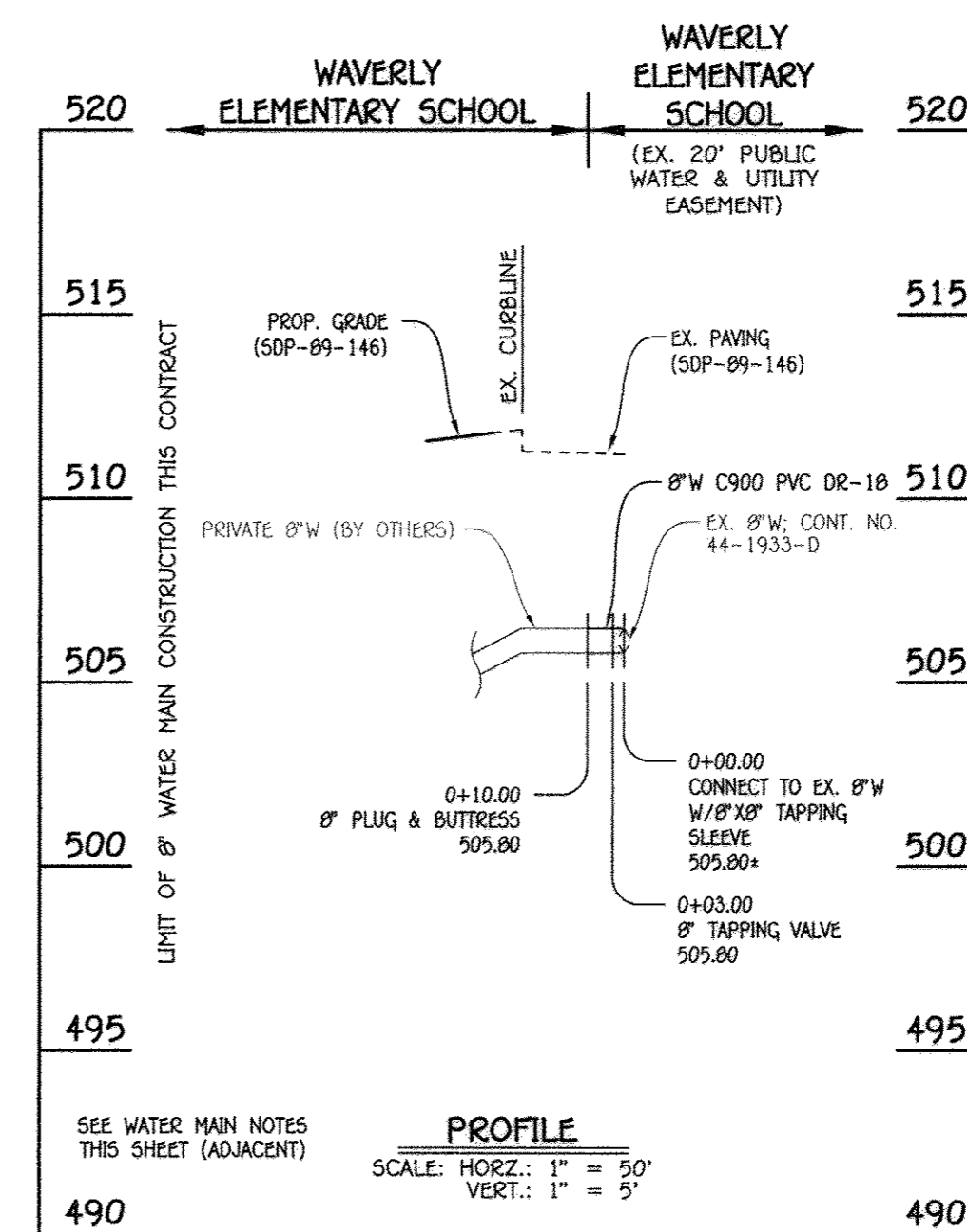

8" WATER MAIN: WAVERLY ELEMENTARY SCHOOL (CHILLER & GENERATOR ENCLOSURE)

WATER MAIN TABULATION CHART			
W.M. STA.	APPURTENANCE	NORTHING	EASTING
8" WATER MAIN: WAVERLY ELEMENTARY SCHOOL (CHILLER & GENERATOR ENCLOSURE)			
0+00.00	8"X8" TAPPING SLEEVE	596557.19	1349700.18
0+03.00	8" TAPPING VALVE	596559.78	1349698.67
0+10.00	8" PLUG & BUTTRESS	596565.82	1349695.14

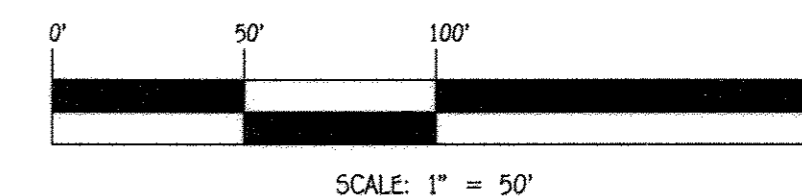

CONTRACT NO. 44-4951-D
 WAVERLY ELEMENTARY SCHOOL
 BUILDING ADDITIONS
 WATER MAIN EXTENSIONS
 HOWARD COUNTY, MARYLAND

DEPARTMENT OF PUBLIC WORKS
 HOWARD COUNTY, MARYLAND
 Chief, Bureau of Utilities

DEPARTMENT OF PLANNING AND ZONING
 HOWARD COUNTY, MARYLAND
 Chief, Development Engineering Division

I HEREBY CERTIFY THAT THESE DOCUMENTS WERE PREPARED OR APPROVED BY ME, AND THAT I AM A DULY LICENSED PROFESSIONAL ENGINEER UNDER THE LAWS OF THE STATE OF MARYLAND.
 LICENSE NO. 12043 EXPIRATION DATE 5/7/16/16.
FISHER, COLLINS & CARTER, INC.
 CIVIL ENGINEERING CONSULTANTS & LAND SURVEYORS
 CENTONAL SQUARE OFFICE PARK - 10272 BALDORNE NATIONAL PIKE
 ELLIOTT CITY, MARYLAND 21042
 (410) 461-2895

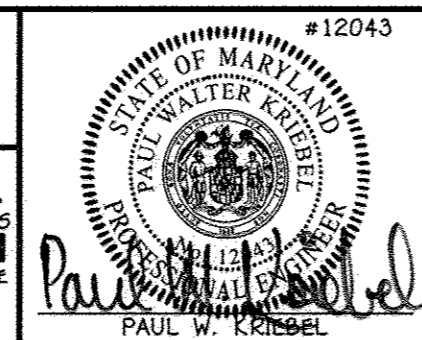

DESIGNED BY: B.C.R.
 DRAWN BY: B.C.R.
 CHECKED BY: P.W.K.
 DATE: MARCH, 2016

**WATER MAIN EXTENSIONS
 PROFILES, CHARTS & NOTES**
 600' SCALE MAP NO. 0017 BLOCK NO. 0007
 F.C.C. WORK ORDER NO. 05118
 FILE NAME: WATER MAIN EXTENSION PLAN

**WAVERLY ELEMENTARY SCHOOL
 BUILDING ADDITIONS**
 WATER MAIN EXTENSIONS
 CONTRACT NO. 44-4951-D
 SECOND ELECTION DISTRICT
 HOWARD COUNTY, MARYLAND

SCALE AS SHOWN
 SHEET 3 OF 3

A-3/Smith