

GENERAL NOTES

PART I

- APPROXIMATE LOCATIONS OF EXISTING MAINS ARE SHOWN. THE CONTRACTOR SHALL TAKE ALL NECESSARY PRECAUTIONS TO PROTECT EXISTING MAINS AND SERVICES AND MAINTAIN UNINTERRUPTED SERVICE. ANY DAMAGE INCURRED SHALL BE REPAIRED IMMEDIATELY TO THE SATISFACTION OF THE ENGINEER AT THE CONTRACTOR'S EXPENSE.
- THE TOPOGRAPHY SHOWN HEREON IS BASED ON AN AERIAL PHOTOGRAMETRIC SURVEY PERFORMED BY WINGS AERIAL MAPPING COMPANY, DATED MARCH, 1995.
- THE PROJECT BOUNDARY SHOWN HEREON IS BASED ON A BOUNDARY SURVEY PERFORMED BY FISHER, COLLINS, & CARTER, INC., DATED SEPTEMBER 21, 1998.
- HORIZONTAL AND VERTICAL SURVEY CONTROLS:
THE COORDINATES SHOWN ON THE DRAWINGS ARE BASED ON MARYLAND STATE REFERENCE SYSTEM NAD '83/91 AS PROJECTED BY HOWARD COUNTY GEODETIC CONTROL STATIONS NO. 3044004R AND 3044005R.
ALL VERTICAL CONTROLS ARE BASED ON (NAVD' 88).
VERTICAL CONTROLS PROVIDED ON THE DRAWINGS ARE:
BENCHMARK NO. 1, COUNTY CONTROL #3044005R
3/4" REBAR 0.6" BELOW SURFACE
N. 578233.92, E. 1473142.33
ELEV. = 374.389
BENCHMARK NO. 2, COUNTY CONTROL #3044004R
3/4" REBAR 0.6" BELOW SURFACE
N. 578128.03, E. 1473460.71
ELEV. = 362.575
- ALL PIPE ELEVATIONS SHOWN ARE INVERT ELEVATIONS UNLESS OTHERWISE NOTED ON THE PLANS.
- CLEAR ALL UTILITIES BY A MINIMUM OF 12 INCHES. CLEAR 14" POLES BY 5'-0" MINIMUM OR TUNNEL AS REQUIRED UNLESS OTHERWISE NOTED. THE OWNER HAS CONTACTED THE UTILITY COMPANIES AND HAS MADE ARRANGEMENTS FOR BRACING OF POLES AS SHOWN ON THE DRAWINGS. IN THE EVENT THE CONTRACTOR'S WORK REQUIRES THE BRACING OF ADDITIONAL POLES, ANY COST INCURRED BY THE OWNER FOR THE BRACING OF ADDITIONAL POLES OR DAMAGES SHALL BE DEDUCTED FROM MONIES OWED THE CONTRACTOR. THE CONTRACTOR SHALL COORDINATE WITH THE UTILITY COMPANIES TO SCHEDULE THE BRACING OF THE POLES.
- FOR DETAILS NOT SHOWN ON THE DRAWING, AND FOR MATERIALS AND CONSTRUCTION METHODS, USE HOWARD COUNTY DESIGN MANUAL, VOLUME IV, STANDARD SPECIFICATIONS AND DETAILS FOR CONSTRUCTION (LATEST EDITION). THE CONTRACTOR SHALL HAVE A COPY OF VOLUME IV ON THE JOB.
- WHERE TEST PITS HAVE BEEN MADE ON EXISTING UTILITIES, THEY ARE NOTED BY THE SYMBOL AT THE LOCATIONS OF THE TEST PITS. A NOTE OR NOTES CONTAINING THE RESULTS OF THE TEST PIT OR PITS IS INCLUDED ON THE DRAWINGS. EXISTING UTILITIES IN THE VICINITY OF THE PROPOSED WORK FOR WHICH TEST PITS HAVE NOT BEEN DUG SHALL BE LOCATED BY THE CONTRACTOR TWO WEEKS IN ADVANCE OF CONSTRUCTION OPERATIONS AT HIS OWN EXPENSE.
- THE CONTRACTOR SHALL NOTIFY THE FOLLOWING UTILITY COMPANIES OR AGENCIES AT LEAST FIVE WORKING DAYS BEFORE STARTING WORK SHOWN ON THESE PLANS:
AT&T 1-800-252-1133
BGE (CONTRACTOR SERVICES) 410-637-8713
BGE (EMERGENCY) 410-685-0123
BUREAU OF UTILITIES 410-313-4900
COLONIAL PIPELINE COMPANY 410-798-1390
MISS UTILITY 1-800-257-7777
STATE HIGHWAY ADMINISTRATION 410-531-5533
VERIZON 1-800-743-0033/410-224-9210
- TREES AND SHRUBS ARE TO BE PROTECTED FROM DAMAGE TO THE MAXIMUM EXTENT. TREES AND SHRUBS LOCATED WITHIN THE CONSTRUCTION STRIP ARE NOT TO BE REMOVED OR DAMAGED BY THE CONTRACTOR.
- THE CONTRACTOR SHALL REMOVE TREES, STUMPS, AND ROOTS ALONG THE LINE OF EXCAVATION. PAYMENT FOR SUCH REMOVAL SHALL BE INCLUDED IN THE UNIT PRICE BID FOR CONSTRUCTION OF THE MAIN.
- THE CONTRACTOR SHALL NOTIFY THE BUREAU OF HIGHWAYS, HOWARD COUNTY, AT (410) 313-7450 AT LEAST FIVE WORKING DAYS BEFORE OPEN CUTTING OR BORING/JACKING OF ANY COUNTY ROAD FOR LAYING WATER/SEWER MAINS OR HOUSE CONNECTIONS. THE APPROVAL OF THESE DRAWINGS WILL CONSTITUTE COMPLIANCE WITH DRW REQUIREMENTS PER SECTION 18.114(a) OF THE HOWARD COUNTY CODE.

PART II - WATER

- ALL WATER MAINS SHALL BE D.I.P. CLASS 54 UNLESS OTHERWISE NOTED.
- TOPS OF ALL WATER MAINS TO HAVE A MINIMUM OF 3'-6" OF COVER UNLESS OTHERWISE NOTED.
- VALVES ADJACENT TO TEES SHALL BE STRAPPED TO TEES.
- ALL FITTINGS SHALL BE BUTTRESSED OR ANCHORED WITH CONCRETE IN ACCORDANCE WITH THE STANDARD DETAILS UNLESS OTHERWISE PROVIDED FOR ON THE DRAWINGS.
- FIRE HYDRANTS SHALL BE SET TO THE BURY LINE ELEVATIONS SHOWN ON THE DRAWINGS. ALL FIRE HYDRANTS SHALL BE INSTALLED IN ACCORDANCE WITH THE STANDARD DETAILS. THE SOIL AROUND THE FIRE HYDRANT SHALL BE COMPACTED IN ACCORDANCE WITH SECTION 1000 AND SECTION 1005 OF THE STANDARD SPECIFICATIONS.
- THE CONTRACTOR SHALL NOT OPERATE ANY WATER MAIN VALVES ON THE EXISTING WATER SYSTEM.
- SPRINKLER SYSTEM FOR SINGLE RESIDENTIAL DWELLING UNITS SHALL HAVE WATER HOUSE CONNECTIONS AND WATER METERS THAT ARE SIZED IN ACCORDANCE WITH THE DESIGN OF THE SPRINKLER SYSTEMS. SPRINKLER SYSTEMS FOR SINGLE RESIDENTIAL DWELLINGS SHALL HAVE A MINIMUM OF 1.5" SERVICE CONNECTION WITH A 1" OUTSIDE METER SETTING.
- TRACER WIRE AND CONTINUITY TEST STATIONS SHALL BE INSTALLED ON ALL DIP AND PVC WATER MAINS IN ACCORDANCE WITH THE HOWARD COUNTY DESIGN MANUAL.

PART III - SEWER

- ALL SEWER MAINS SHALL BE D.I.P. OR P.V.C UNLESS OTHERWISE NOTED.
- ALL MANHOLES SHALL BE 4'-0" INSIDE DIAMETER UNLESS OTHERWISE NOTED.
- FORCE MAINS SHALL BE D.I.P. ONLY.
- MANHOLES SHOWN WITH 12" AND 16" WALLS ARE FOR BRICK MANHOLES ONLY.
- MANHOLES DESIGNATED W/T IN PLAN AND PROFILE SHALL HAVE WATERTIGHT FRAME AND COVER, STANDARD DETAIL C5.52. WHERE WATERTIGHT FRAMES AND COVERS ARE USED, SET TOP OF FRAME 1'-6" ABOVE FINISHED GRADE UNLESS OTHERWISE NOTED ON THE DRAWINGS.
- HOUSE(S) WITH THE SYMBOL "C.N.S." INDICATES THAT CELLAR CANNOT BE SERVED.
- GRAVITY SEWER SERVICE, FIRST FLOOR ONLY FOR UNITS 119-121, AND UNITS 125-133. BASEMENT SEWER SERVICE TO BE PROVIDED BY PRIVATE ON-SITE PUMP WAIVER APPROVED BY THE HOWARD COUNTY DEPARTMENT OF PUBLIC WORKS ON AUGUST 23, 2013.

SEDIMENT CONTROL MEASURES WILL BE IMPLEMENTED IN ACCORDANCE WITH SECTION 308 OF THE SPECIFICATIONS AND WITH FINAL PLAN ~~5-11-097~~ ~~5-11-097~~

THIS DEVELOPMENT IS APPROVED FOR SOIL EROSION AND SEDIMENT CONTROL BY THE HOWARD SOIL CONSERVATION DISTRICT.

John R. Roberts 2/10/14
SOIL CONSERVATION DISTRICT DATE

DEPARTMENT OF PUBLIC WORKS
HOWARD COUNTY, MARYLAND
DATE: 1/31/14
CHIEF, BUREAU OF UTILITIES

DEPARTMENT OF PLANNING & ZONING
HOWARD COUNTY, MARYLAND
DATE: 3-5-14
CHIEF, DEVELOPMENT ENGINEERING DIVISION

ROBERT H. VOGEL ENGINEERING, INC.
ENGINEERS • SURVEYORS • PLANNERS
8407 MAIN STREET, ELLICOTT CITY, MD 21043
TEL: 410.461.7666 FAX: 410.461.8961

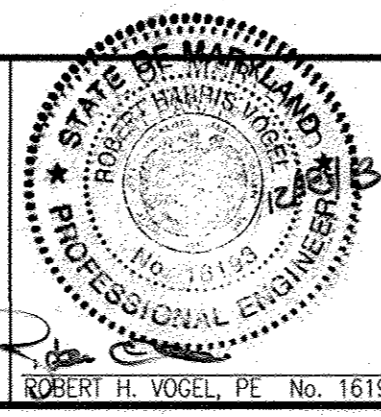

PROFESSIONAL CERTIFICATE
I HEREBY CERTIFY THAT THESE DOCUMENTS WERE PREPARED OR APPROVED BY ME AND THAT I AM A DULY LICENSED PROFESSIONAL ENGINEER UNDER THE LAWS OF THE STATE OF MARYLAND, LICENSE NO. 16193 EXPIRATION DATE: 09-27-2014
DRN: JMR DES: RHV
CHK: RHV
DATE: DECEMBER 2013

BY	NO.	REVISION	DATE
KCI	1	ISS-BUILT	3/17/13

FINAL WATER AND SEWER PLAN
CONTRACT 14-4816-D
COVER SHEET

TAYLOR WAY - VILLAGE CREST
UNITS 119-133
PART OF PARCEL C-1
ZONING: POR
PARCELS: P/O C-1
HOWARD COUNTY, MARYLAND

SHEET AS SHOWN
1 OF 3

FINAL WATER AND SEWER PLAN

TAYLOR WAY - VILLAGE CREST

UNITS 119-133 - PART OF PARCEL C-1

CONTRACT 14-4816-D

HOWARD COUNTY, MARYLAND

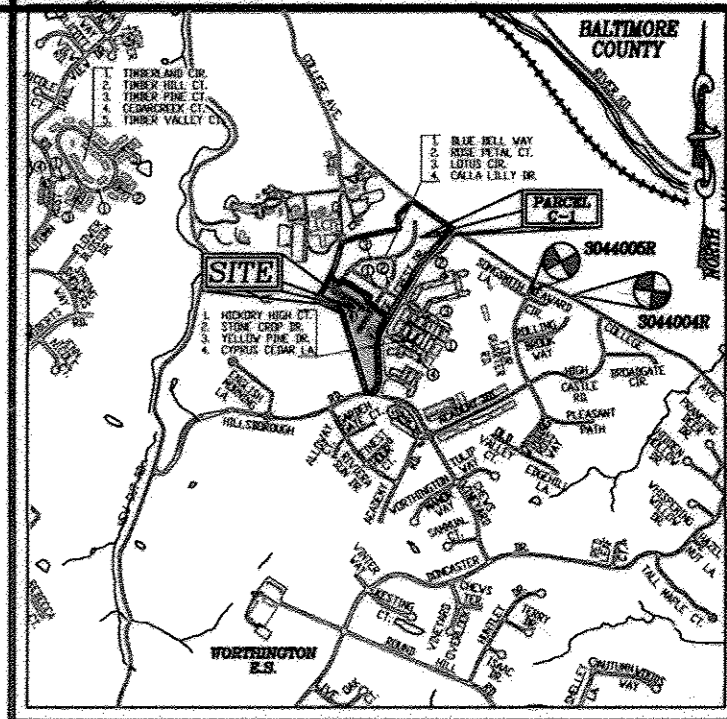

LOCATION MAP
SCALE: 1"=2,000'
ADC MAP COORDINATE: 4816, D-10

BENCHMARKS
BENCHMARK NO. 1, COUNTY CONTROL #3044005R
3/4" REBAR 0.6" BELOW SURFACE
N. 578233.92, E. 1473142.33
ELEV. = 374.389
BENCHMARK NO. 2, COUNTY CONTROL #3044004R
3/4" REBAR 0.6" BELOW SURFACE
N. 578128.03, E. 1473460.71
ELEV. = 362.575

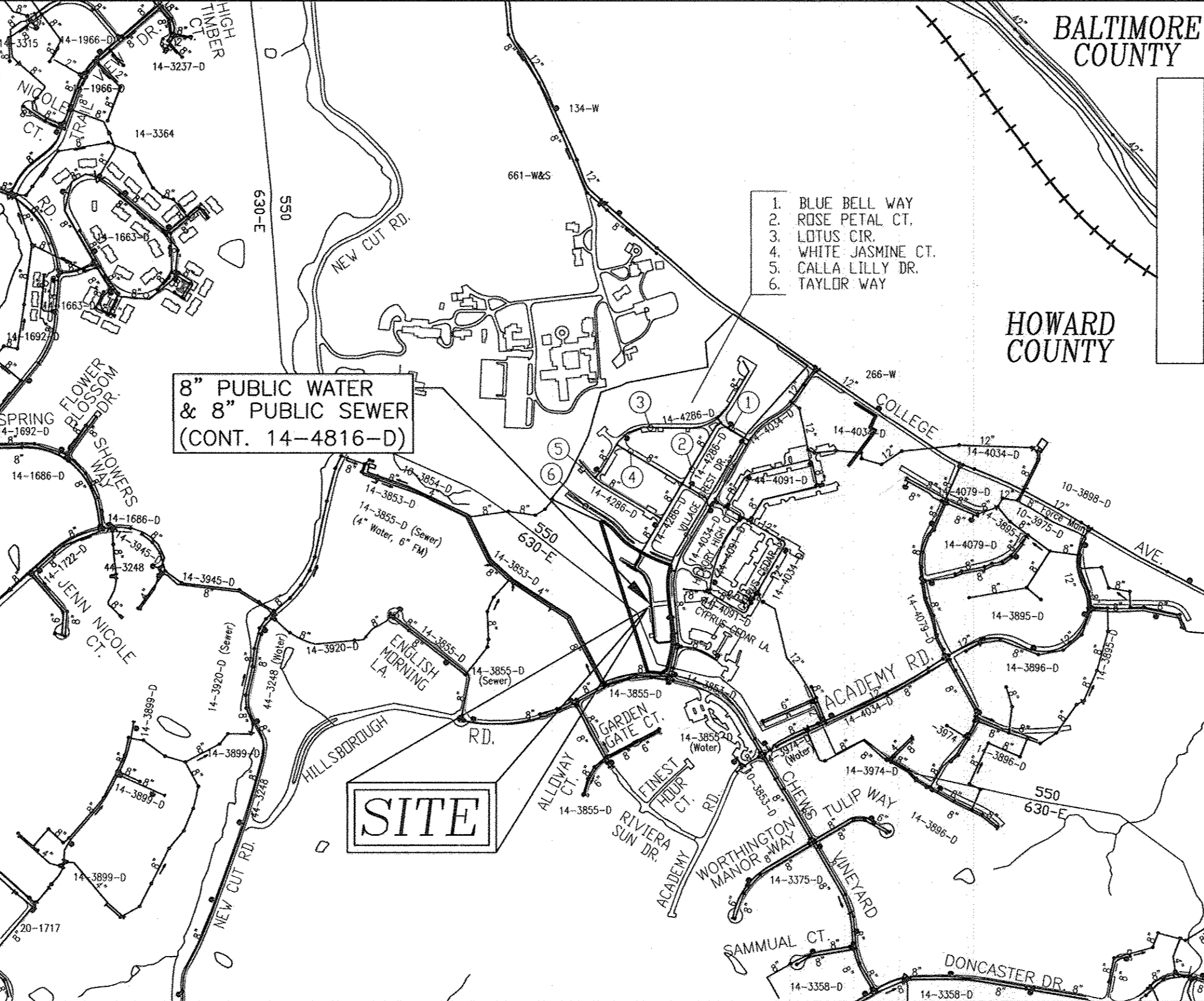

VICINITY MAP
SCALE: 1"=600'

WATER ZONE: 550
TEST GRADIENT: 700

TYPE OF BUILDING:	SINGLE, FAMILY, ATTACHED
NO. OF UNITS:	15
NO. OF SINGLE WATER HOUSE CONNECTIONS:	5
NO. OF TWIN WATER HOUSE CONNECTIONS:	0
NO. OF SEWER HOUSE CONNECTIONS:	0
NO. OF TWIN SEWER HOUSE CONNECTIONS:	0
DRAINAGE AREA:	PATAPSCO
TREATMENT PLANT:	PATAPSCO WRP VIA NEW CUT ROAD PUMPING STATION AND COLLEGE AVENUE PUMPING STATION

QUANTITIES			
NAME OF UTILITY CONTRACTOR: CCS			
SURVEY AND DRAFTING DIVISION AS-BUILT DATE: 8-7-13			
ITEMS	QUANTITIES ESTIMATED	AS-BUILT	
		QUANTITIES	MANUFACTURER/SUPPLIER
WATER			
8" WATER (DIP CLASS 54)	758 LF	750 LF	US PIPE AND FOUNDRY
6" WATER (DIP CLASS 54)	7 LF	7.00 LF	US PIPE AND FOUNDRY
8" x 8" TEE	1 EA	1 EA	STAR PIPE PRODUCTS
8" x 6" TEE	1 EA	1 EA	STAR PIPE PRODUCTS
8" VALVE	3 EA	3 EA	KENNEDY VALVE
8" 1/8 HORIZONTAL BEND	8 EA	8 EA	STAR PIPE PRODUCTS
8" 1/16 HORIZONTAL BEND	2 EA	2 EA	STAR PIPE PRODUCTS
8" 1/32 HORIZONTAL BEND	1 EA	1 EA	STAR PIPE PRODUCTS
8" PRESSURE SLEEVE	1 EA	1 EA	STAR PIPE PRODUCTS
8" CAP & BUTTRESS	1 EA	1 EA	STAR PIPE PRODUCTS
6" VALVE	1 EA	1 EA	KENNEDY VALVE
FIRE HYDRANT	1 EA	1 EA	KENNEDY VALVE
1 1/2" WHC	133 LF	140 LF	CAMBRIDGE LEE
SEWER			
8" PVC SEWER	24 LF	24.00 LF	NORTH AMERICAN

UNITS WHC METER SETTING	
UNIT 119	SINGLE 1" METER SETTING
UNIT 120	DOUBLE 1" METER SETTING
UNIT 121	DOUBLE 1" METER SETTING
UNIT 122	SINGLE 1" METER SETTING
UNIT 123	DOUBLE 1" METER SETTING
UNIT 124	DOUBLE 1" METER SETTING
UNIT 125	SINGLE 1" METER SETTING
UNIT 126	DOUBLE 1" METER SETTING
UNIT 127	DOUBLE 1" METER SETTING
UNIT 128	SINGLE 1" METER SETTING
UNIT 129	DOUBLE 1" METER SETTING
UNIT 130	DOUBLE 1" METER SETTING
UNIT 131	SINGLE 1" METER SETTING
UNIT 132	DOUBLE 1" METER SETTING
UNIT 133	DOUBLE 1" METER SETTING

OWNER/DEVELOPER
VILLAGE CREST DEVELOPMENT CORPORATION
4100 COLLEGE AVENUE
ELLICOTT CITY, MD 21041
(410) 465-3500

K:\Projects\2014\14-4816-D\DWG\FINAL_VS_UNITS_119-133_C-1_COVER.dwg, 10/20/13 11:17:51 AM

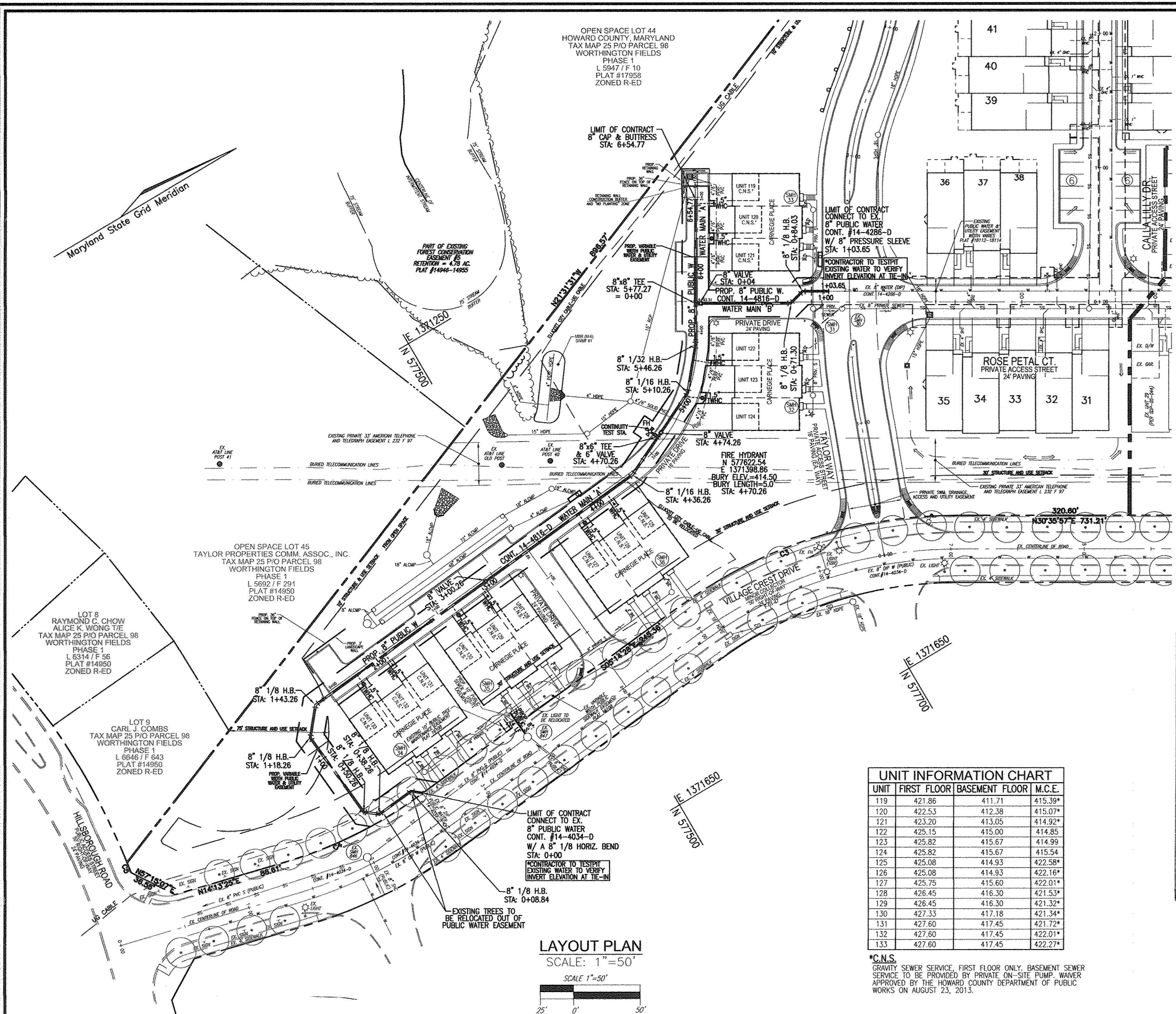

WATER MAIN LOCATION CHART

PROP. WATER MAIN 'A'

WL STA.	APPURTENANCE
WL STA. 0+00.00	8" - 1/8 HORIZONTAL BEND
WL STA. 0+08.84	8" - 1/8 HORIZONTAL BEND
WL STA. 0+38.26	8" - 1/8 HORIZONTAL BEND
WL STA. 0+50.26	8" - 1/8 HORIZONTAL BEND
WL STA. 1+18.26	8" - 1/8 HORIZONTAL BEND
WL STA. 1+43.26	8" - 1/8 HORIZONTAL BEND
WL STA. 3+00.26	8" VALVE
WL STA. 4+36.26	8" - 1/16 HORIZONTAL BEND
WL STA. 4+70.26	8"x6" TEE (6" VALVE AND FIRE HYDRANT)
WL STA. 4+74.26	8" VALVE
WL STA. 5+10.26	8" - 1/16 HORIZONTAL BEND
WL STA. 5+46.26	8" - 1/32 HORIZONTAL BEND
WL STA. 5+77.27	8" x 8" TEE - WATER MAIN 'B'
WL STA. 6+54.77	8" CAP & BUTTRESS

PROP. WATER MAIN 'B'

WL STA.	APPURTENANCE
WL STA. 0+00.00	8" x 8" TEE
WL STA. 0+04.00	8" VALVE
WL STA. 0+71.30	8" - 1/8 HORIZONTAL BEND
WL STA. 0+84.03	8" - 1/8 HORIZONTAL BEND
WL STA. 1+03.65	8" PRESSURE SLEEVE

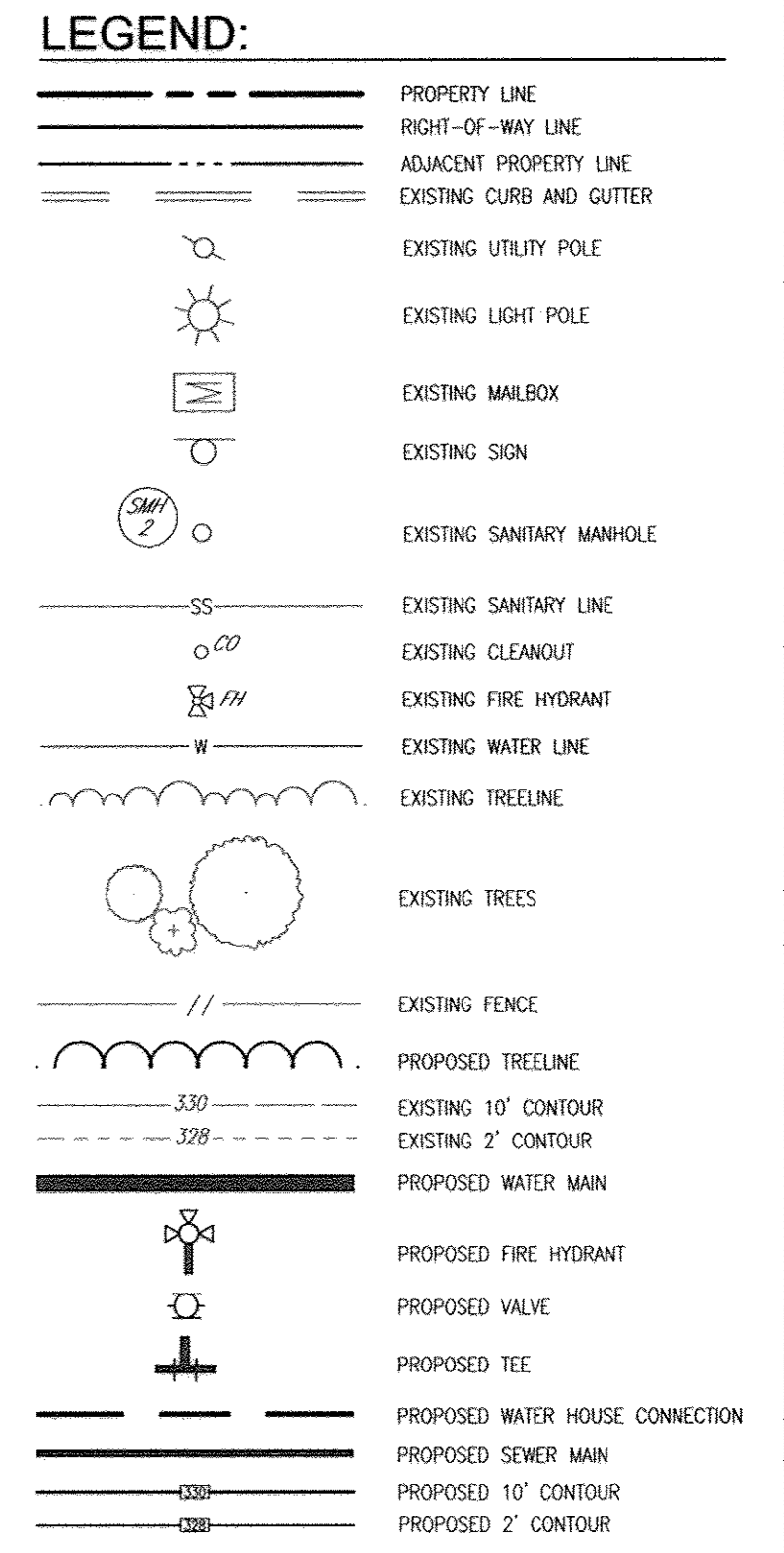

PLAN INVERT NEW

	INVERT	NEW
SMH-30	410.55	410.51
SMH-31	410.76	410.72
SMH-32	411.23	410.21
SMH-33	411.29	410.27
SMH-34	418.30	418.50
SMH-35	417.22	417.25
SMH-36	418.43	418.41

UNIT INFORMATION CHART

UNIT	FIRST FLOOR	BASEMENT FLOOR	M.C.E.
119	421.86	411.71	415.39*
120	422.53	412.38	415.07*
121	423.20	413.05	414.92*
122	425.15	415.00	414.85
123	425.82	415.67	414.99
124	425.82	415.67	415.54
125	425.08	414.93	422.58*
126	425.08	414.93	422.16*
127	425.75	415.60	422.01*
128	426.45	416.30	421.53*
129	426.45	416.30	421.32*
130	427.33	417.18	421.34*
131	427.60	417.45	421.72*
132	427.60	417.45	422.01*
133	427.60	417.45	422.27*

*C.N.S. GRAVITY SEWER SERVICE, FIRST FLOOR ONLY. BASEMENT SEWER SERVICE TO BE PROVIDED BY PRIVATE ON-SITE PUMP. WORKER APPROVED BY THE HOWARD COUNTY DEPARTMENT OF PUBLIC WORKS ON AUGUST 23, 2013.

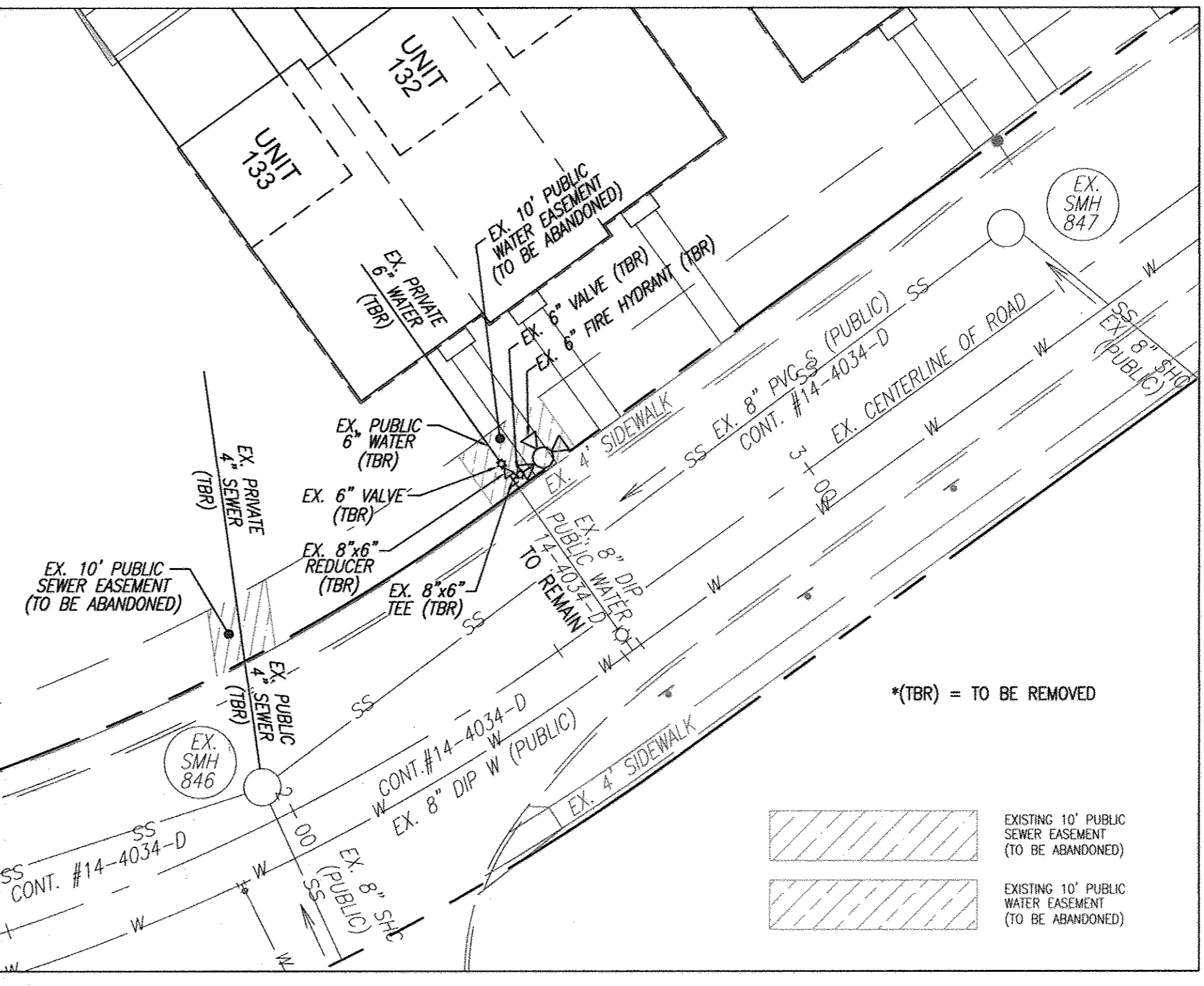

WATER HOUSE CONNECTION AS-BUILT LOCATION TABLE

UNIT	ADDRESS	LOCATION DIMENSION 1	LOCATION DIMENSION 2	1 1/2" WHC COPPER
119	8115 TAYLOR WAY	I-18 TO WHC-119 - 29'	WHC-119 TO WHC-120-25'	13
120	8113 TAYLOR WAY	I-18 TO WHC-120 - 50'	WHC-120 TO WHC-119-25'	12
121	8111 TAYLOR WAY			
122	8107 TAYLOR WAY	WV TO WHC-122 - 45'	WHC-122 TO WHC-123-23'	13
123	8105 TAYLOR WAY	FMT TO WHC-123 - 49'	WHC-123 TO WHC-122-25'	11
124	8103 TAYLOR WAY			
125	8135 VILLAGE CREST DRIVE	I-19 TO WHC-125 - 30'	WHC-125 TO WHC-126-26'	9
126	8133 VILLAGE CREST DRIVE	I-19 TO WHC-126 - 22'	WHC-126 TO WHC-125-26'	8
127	8131 VILLAGE CREST DRIVE			
128	8127 VILLAGE CREST DRIVE	MH-J TO WHC-128 - 48'	WHC-128 TO WHC-129-27'	11
129	8125 VILLAGE CREST DRIVE	SF-2 TO WHC-129 - 72'	WHC-129 TO WHC-128-27'	9
130	8123 VILLAGE CREST DRIVE			
131	8119 VILLAGE CREST DRIVE	SF-2 TO WHC-131 - 35'	WHC-131 TO WHC-132-25'	10
132	8117 VILLAGE CREST DRIVE	SF-2 TO WHC-132 - 42'	WHC-132 TO WHC-131-25'	8
133	8115 VILLAGE CREST DRIVE			

SEWER HOUSE CONNECTION AS-BUILT LOCATION TABLE

UNIT	ADDRESS	LOCATION DIMENSION 1	LOCATION DIMENSION 2	4" SHC PVC
119	8115 TAYLOR WAY	SMH-33 TO SHC-119-8'	SHC-119 TO SHC-120-14'	5'
120	8113 TAYLOR WAY	SMH-33 TO SHC-120-9'	SHC-120 TO SHC-129-14'	3'
121	8111 TAYLOR WAY	I-17 TO SHC-121 - 12'	SHC-121 TO SHC-120-26'	4'
122	8107 TAYLOR WAY	SMH-31 TO SHC-122-32'	SHC-123 TO SHC-122-22'	4'
123	8105 TAYLOR WAY	SMH-32 TO SHC-123-10'	SHC-124 TO SHC-123-29'	2'
124	8103 TAYLOR WAY	SMH-32 TO SHC-124-20'	SHC-123 TO SHC-129-29'	18'
125	8135 VILLAGE CREST DRIVE	SMH-36 TO SHC-125-26'	SHC-125 TO SHC-126-20'	23'
126	8133 VILLAGE CREST DRIVE	SMH-36 TO SHC-126-20'	SHC-126 TO SHC-125-20'	16'
127	8131 VILLAGE CREST DRIVE	SMH-36 TO SHC-127-38'	SHC-127 TO SHC-126-26'	17'
128	8127 VILLAGE CREST DRIVE	SMH-35 TO SHC-128-51'	SHC-128 TO SHC-129-24'	14'
129	8125 VILLAGE CREST DRIVE	SMH-35 TO SHC-129-28'	SHC-129 TO SHC-130-25'	10'
130	8123 VILLAGE CREST DRIVE	SMH-35 TO SHC-130-14'	SHC-130 TO SHC-129-25'	10'
131	8119 VILLAGE CREST DRIVE	SMH-34 TO SHC-131-47'	SHC-131 TO SHC-132-25'	10'
132	8117 VILLAGE CREST DRIVE	SMH-34 TO SHC-132-24'	SHC-132 TO SHC-131-25'	9'
133	8115 VILLAGE CREST DRIVE	SMH-34 TO SHC-133-13'	SHC-133 TO SHC-132-22'	9'

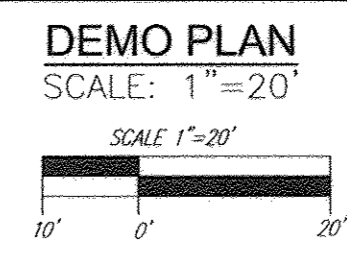

DEPARTMENT OF PUBLIC WORKS
HOWARD COUNTY, MARYLAND

CHIEF, BUREAU OF UTILITIES

DEPARTMENT OF PLANNING & ZONING
HOWARD COUNTY, MARYLAND

CHIEF, DEVELOPMENT ENGINEERING DIVISION

ROBERT H. VOGEL ENGINEERING, INC.
ENGINEERS • SURVEYORS • PLANNERS
8407 MAIN STREET
ELLICOTT CITY, MD 21043
TEL: 410.461.7666
FAX: 410.461.8961

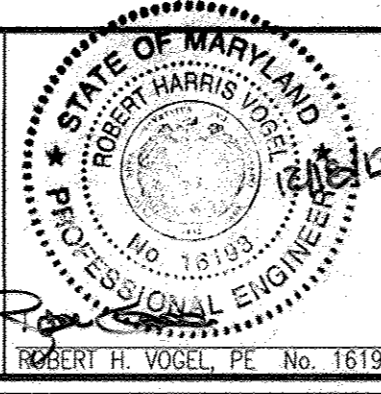

PROFESSIONAL CERTIFICATE
I HEREBY CERTIFY THAT THESE DOCUMENTS WERE PREPARED OR APPROVED BY ME, AND THAT I AM A DULY LICENSED PROFESSIONAL ENGINEER UNDER THE LAWS OF THE STATE OF MARYLAND, LICENSE NO. 16193, EXPIRATION DATE: 09-27-2014

DRN: JMR DES: RVV
CHK: RVV
DATE: DECEMBER 2013

FINAL WATER AND SEWER CONTRACT 14-4816-D LAYOUT AND DEMO PLAN

TAYLOR WAY - VILLAGE CREST UNITS 119-133 PART OF PARCEL C-1

SCALE AS SHOWN
SHEET 2 OF 3

60' SCALE MAP NO. 25 BLOCK NO. 20
ZONING: POR PARCELS: P/O C-1 HOWARD COUNTY, MARYLAND
TAX MAP: 25 GRID: 20 2ND ELECTION DISTRICT

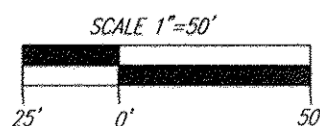
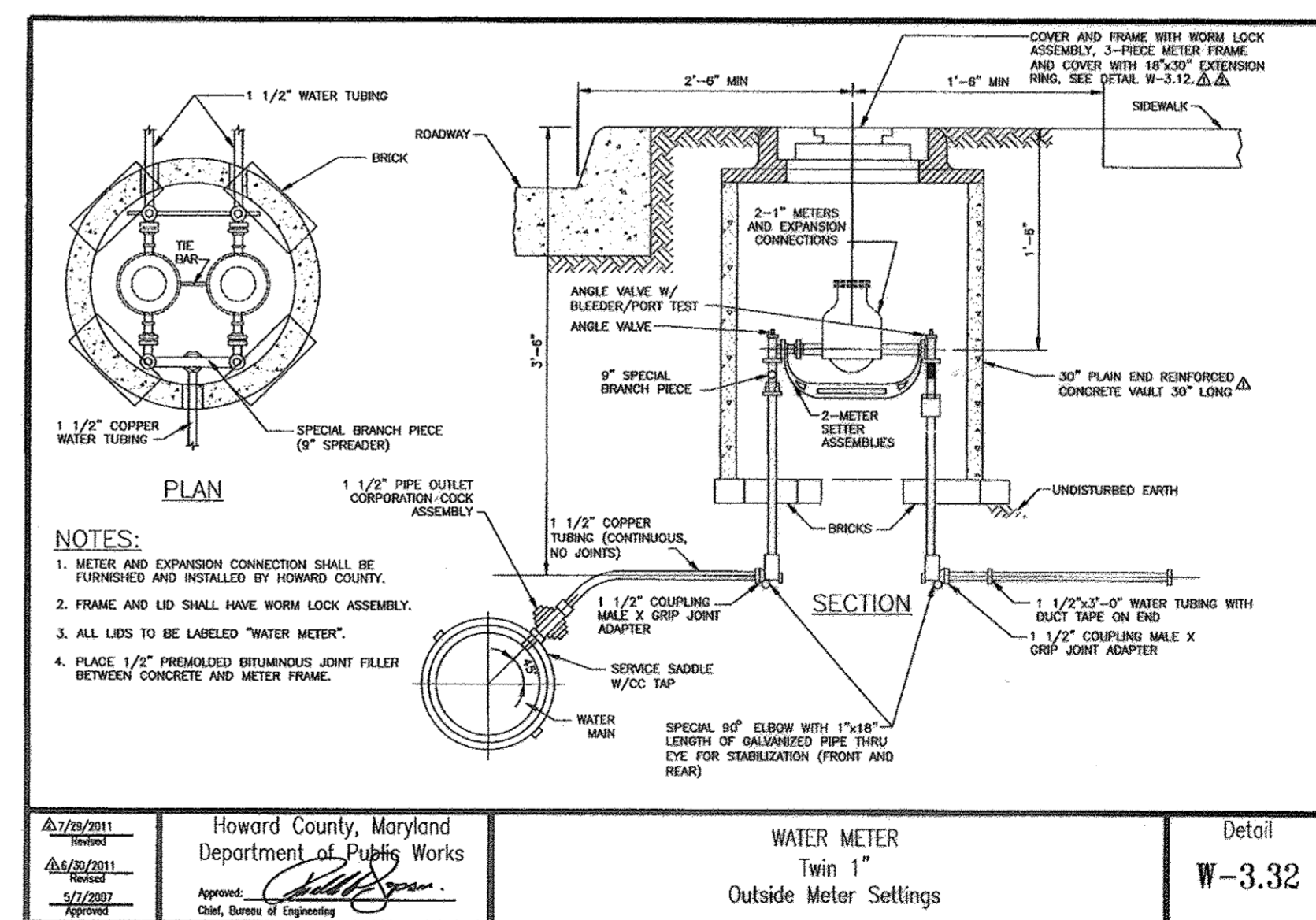
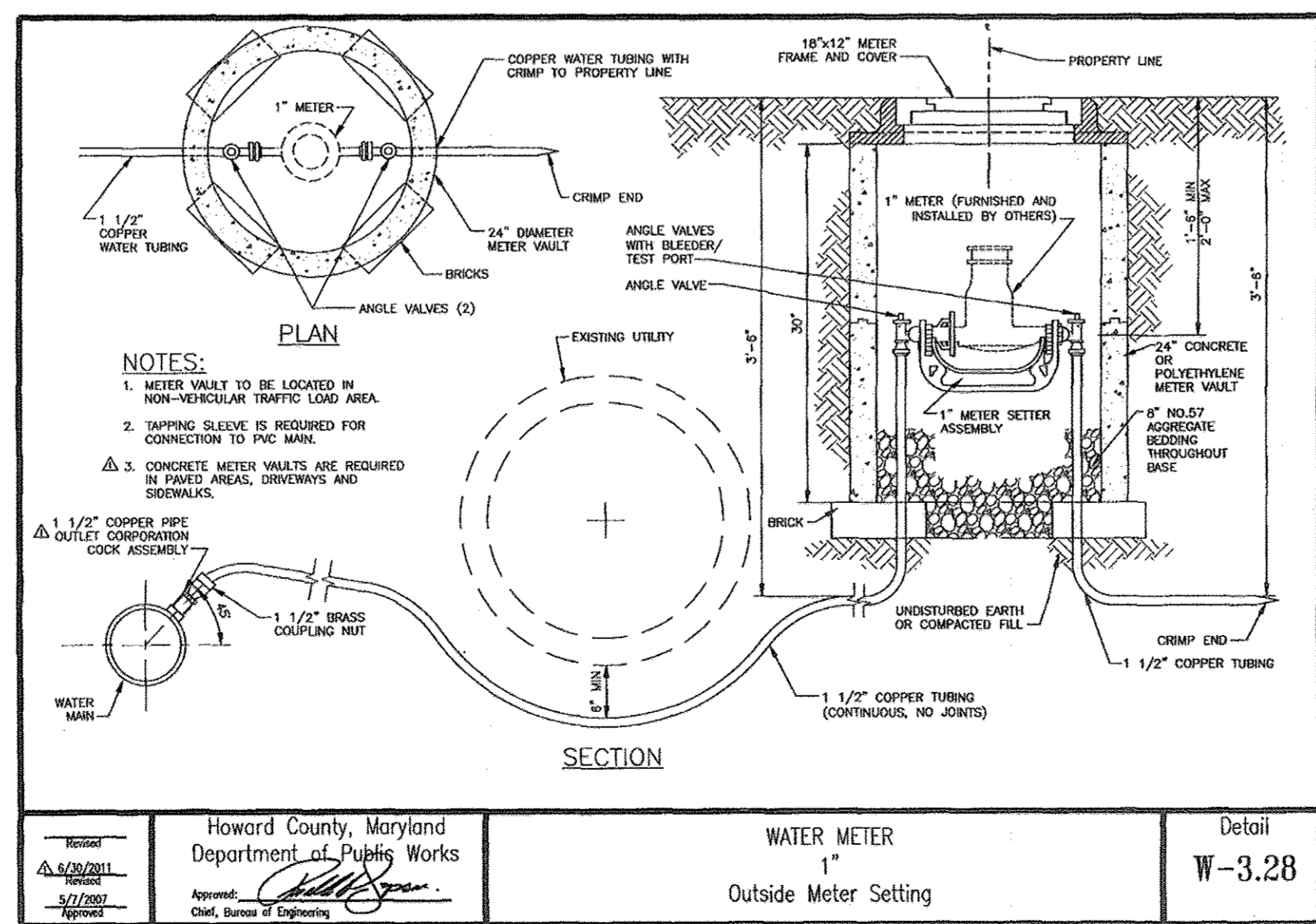
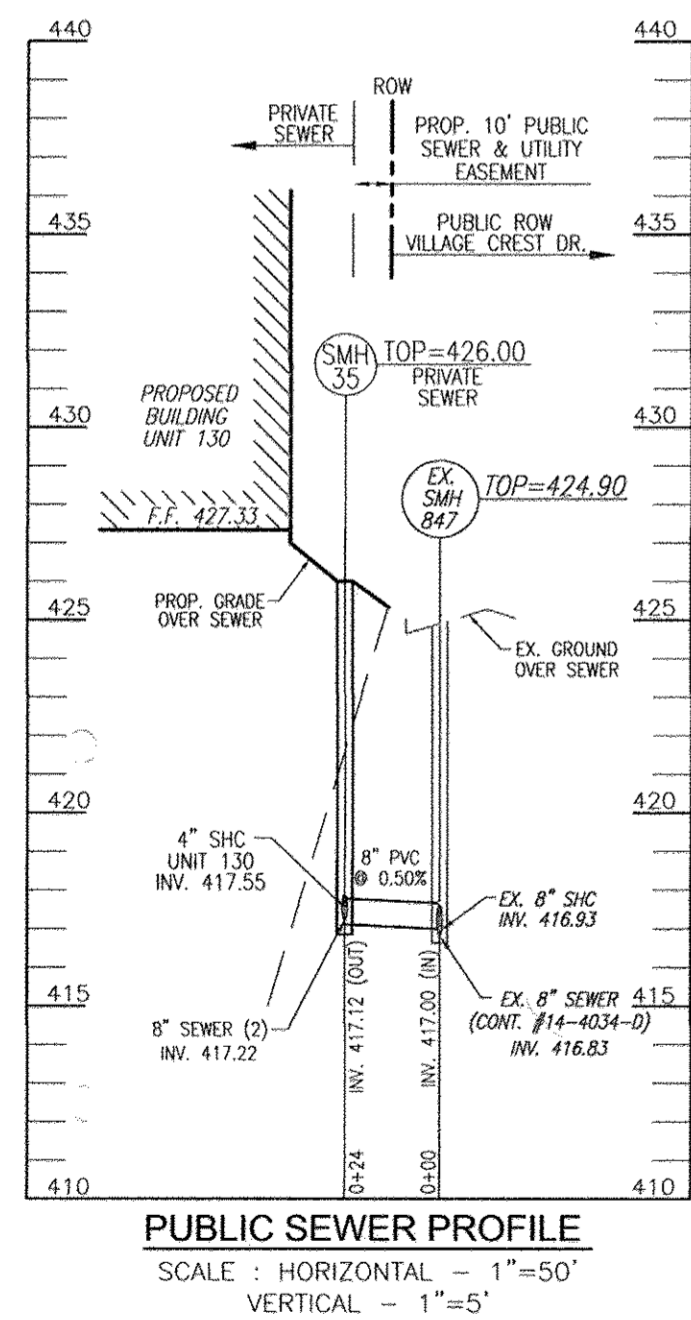
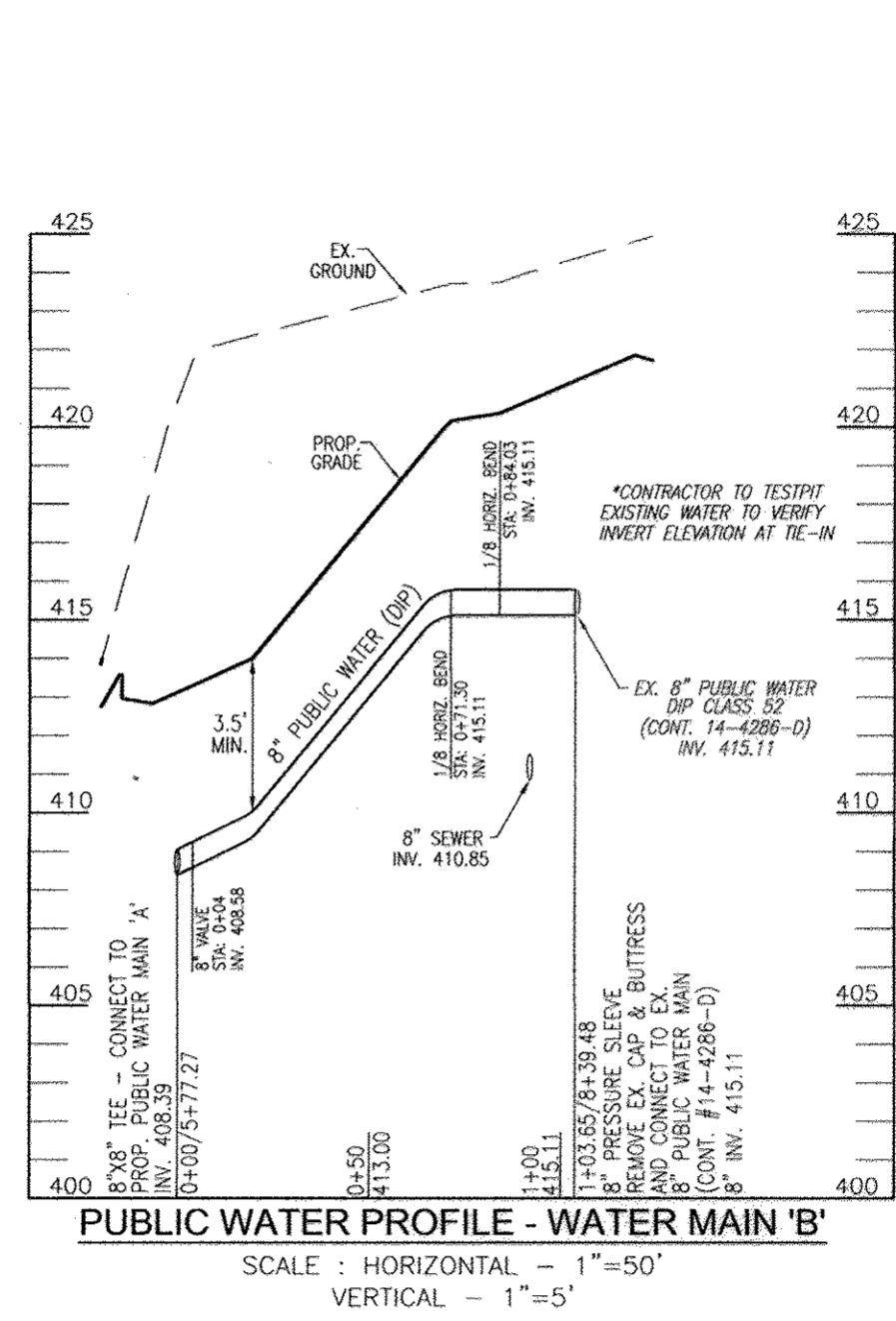
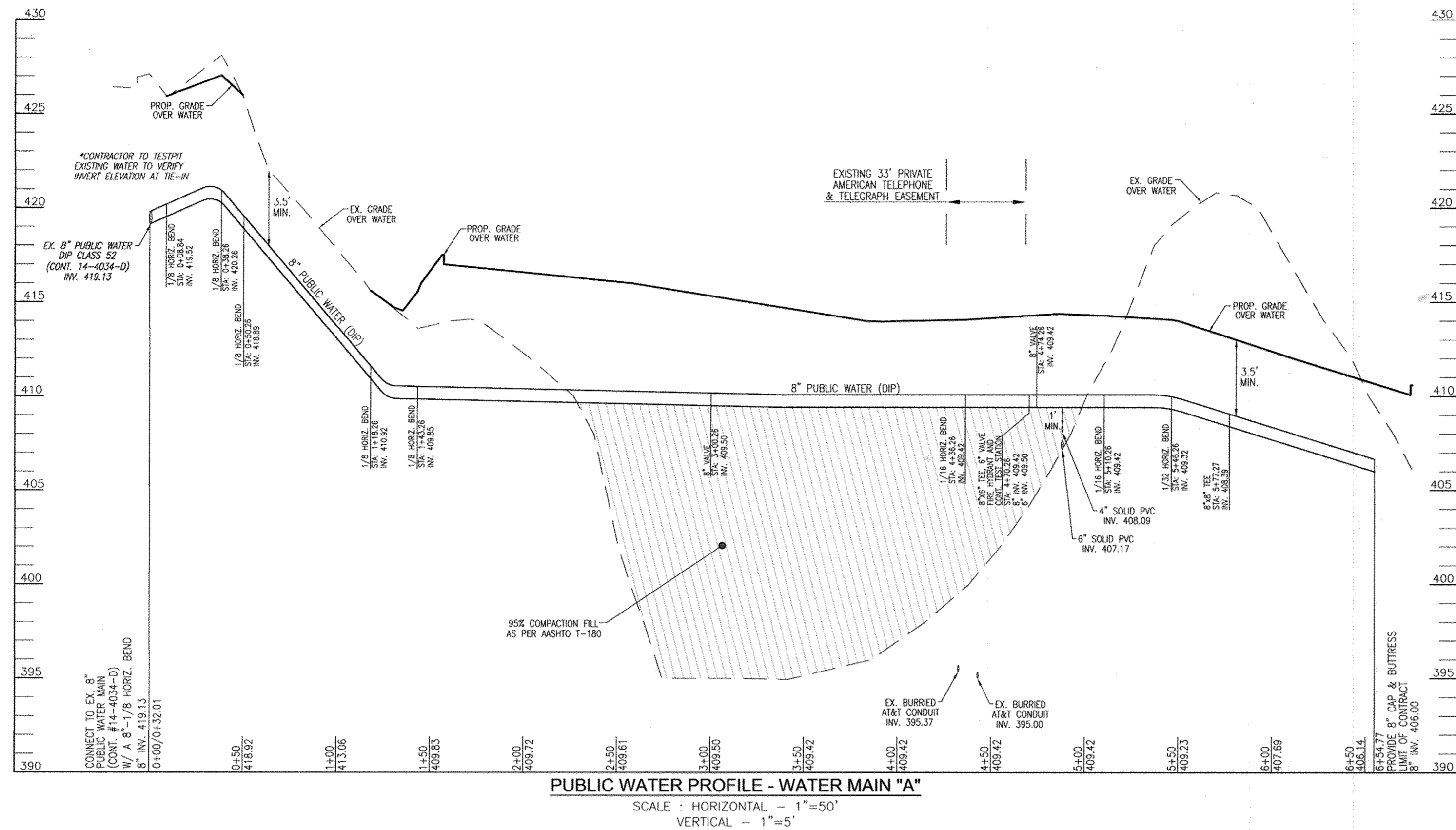

DEPARTMENT OF PUBLIC WORKS HOWARD COUNTY, MARYLAND Chief, Bureau of Utilities DATE: 11/20/14	DEPARTMENT OF PLANNING & ZONING HOWARD COUNTY, MARYLAND Chief, Development Engineering Division DATE: 3-5-14	ROBERT H. VOGEL ENGINEERING, INC. ENGINEERS • SURVEYORS • PLANNERS 8407 MAIN STREET, ELLICOTT CITY, MD 21043 TEL: 410.461.7666 FAX: 410.461.8961	PROFESSIONAL CERTIFICATE I HEREBY CERTIFY THAT THESE DOCUMENTS WERE PREPARED OR APPROVED BY ME, AND THAT I AM A duly LICENSED PROFESSIONAL ENGINEER UNDER THE LAWS OF THE STATE OF MARYLAND, LICENSE NO. 16193, EXPIRATION DATE: 09-27-2014. DRN: JMR DES: RHV CHK: RHV DATE: DECEMBER 2013	FINAL WATER AND SEWER PLAN CONTRACT 14-4816-D PROFILES AND DETAILS	TAYLOR WAY - VILLAGE CREST UNITS 119-133 PART OF PARCEL C-1	SCALE AS SHOWN SHEET 3 OF 3 ZONING: POR PARCELS: P/O C-1 HOWARD COUNTY, MARYLAND
---	---	--	---	---	--	--

OWNER/DEVELOPER
 VILLAGE CREST DEVELOPMENT CORPORATION
 4100 COLLEGE AVENUE
 ELLICOTT CITY, MD 21041
 (410) 485-3500

600' SCALE MAP NO. 25
 BLOCK NO. 20
 TAX MAP: 25 GRID: 20
 2ND ELECTION DISTRICT