

GENERAL NOTES

A. STANDARD GENERAL NOTES

- Approximate location of existing mains are shown. The contractor shall take all necessary precautions to protect existing mains and services and maintain uninterrupted service. Any damage incurred shall be repaired immediately to the satisfaction of the Engineer at the contractor's expense.
- Topographic field surveys were performed on September 2002 by DMW. The existing topography is taken from low level flight and aerial survey with 2' contour intervals prepared by 3DI dated April 8, 2002.
- The coordinates shown on the drawings are based on Maryland State Reference System NAD'83/91 as projected by Howard County Geodetic Control Stations No.#31ea and No.#37ca.
- All vertical controls are based on NAVD '88. Vertical controls provided on the drawings are BM1, #31EA-Disc set in concrete, N569641.123, E1374815.935, Elev. 468.90, 2' south of sidewalk on Ilchester Road ± 47.1' from gate in fence on the transmission line R.O.W. BM2-#37CA-Disc set in concrete, N569641.123, E1382742.880, Elev. 256.965, 20.6' south of centerline of Landing Road, 0.25 miles northwest on Landing Road from intersection of Landing Road and Montgomery Road.
- All pipe elevations shown are invert elevations unless otherwise noted.
- Clear all utilities by a minimum of 12". Clear all poles by 5' - 0" minimum or tunnels as required unless otherwise noted. The owner has contacted the utility companies and has made arrangements for bracing of poles as shown on the drawings. In the event the contractor's work requires the bracing of additional poles, any cost incurred by the owner for bracing of additional poles or damages shall be deducted from monies owed the contractor. The contractor shall coordinate with the utility companies to schedule the bracing of the poles.
- For details not shown on the drawings and for materials and construction methods use Howard County Design Manual, Volume IV, Standard Specifications and Detail for Construction (latest edition). The contractor shall have a copy of Volume IV on the job.
- Where test pits have been made on existing utilities, they are noted by the symbol at the locations of the test pits. A note or notes containing the results of the test pits or pits is included on the drawings. Existing utilities in the vicinity of the proposed work for which test pits have not been dug shall be located by the contractor two weeks in advance of construction operations at his own expense.
- The contractor shall notify the following utility companies or agencies at least five working days before starting work shown on these plans:

AT&T	1-800-252-1133
BGE (Construction Services)	410-850-4620
BGE (Emergency)	410-685-1400
Bureau of Utilities	410-313-4900
Colonial Pipeline Co.	410-795-1390
Miss Utility	1-800-257-7777
State Highway Administration	410-531-5533
Verizon	1-800-742-0033/410-224-9210
- Trees and shrubs are to be protected from damage to the maximum extent. Trees and shrubs located within the construction strip are not to be removed or damaged by the contractor.
- The contractor shall remove trees, stumps, and roots along line of excavation. Payment for such removal shall be included in the unit price bid for construction of the main.
- The contractor shall notify the Bureau of Highways, Howard County, at (410) 313-7450 at least five working days before any open cut of any county road or boring/jacking of any County roads for laying water/sewer mains or house connections. The approval of these drawings will constitute compliance with DPW requirements per section 18.114(a) of the Howard County code.

B. STANDARD WATER MAIN GENERAL NOTES

- All water mains to be D.I.P. Class 54 unless otherwise noted.
- Top of all water mains to have a minimum of 3'-6" of cover unless otherwise noted.
- Valves adjacent to tees shall be strapped to tees.
- All fittings shall be buttressed or encased with concrete in accordance with the Standard Details unless otherwise provided for on the drawings.
- Fire hydrants shall be set to the bury line elevations shown on the drawings. All fire hydrants shall be installed and buttressed with concrete in accordance with Standard Details. The soil around the fire hydrant shall be compacted in accordance with section 1000 and 1005 of the Standard Specifications.
- The contractor shall not operate any water main valves on the existing water system.
- All water house connections shall be for inside meter settings unless otherwise noted on plans or in specifications.
- For sprinkler systems for all town homes or multi-family dwelling units should have a minimum of 1" connection with a 3/4" meter.

C. STANDARD SEWER MAIN GENERAL NOTES

- All sewer mains shall be DIP or P.V.C. unless otherwise noted.
- All manholes shall be 4'-0" inside diameter unless otherwise noted.
- Force mains shall be D.I.P. only.
- Manholes shown with 12" and 16" walls are for brick manholes only.
- Manholes designated W1 in plan and profile shall have watertight frame and covers, Standard Detail C155. Where watertight frame and cover is used, set top of frame 1" above finished grade unless otherwise noted on the drawings.

8" Sewer Main Extension Blough Property

Howard County, Maryland Department of Public Works

Contract No. 24-4527-D

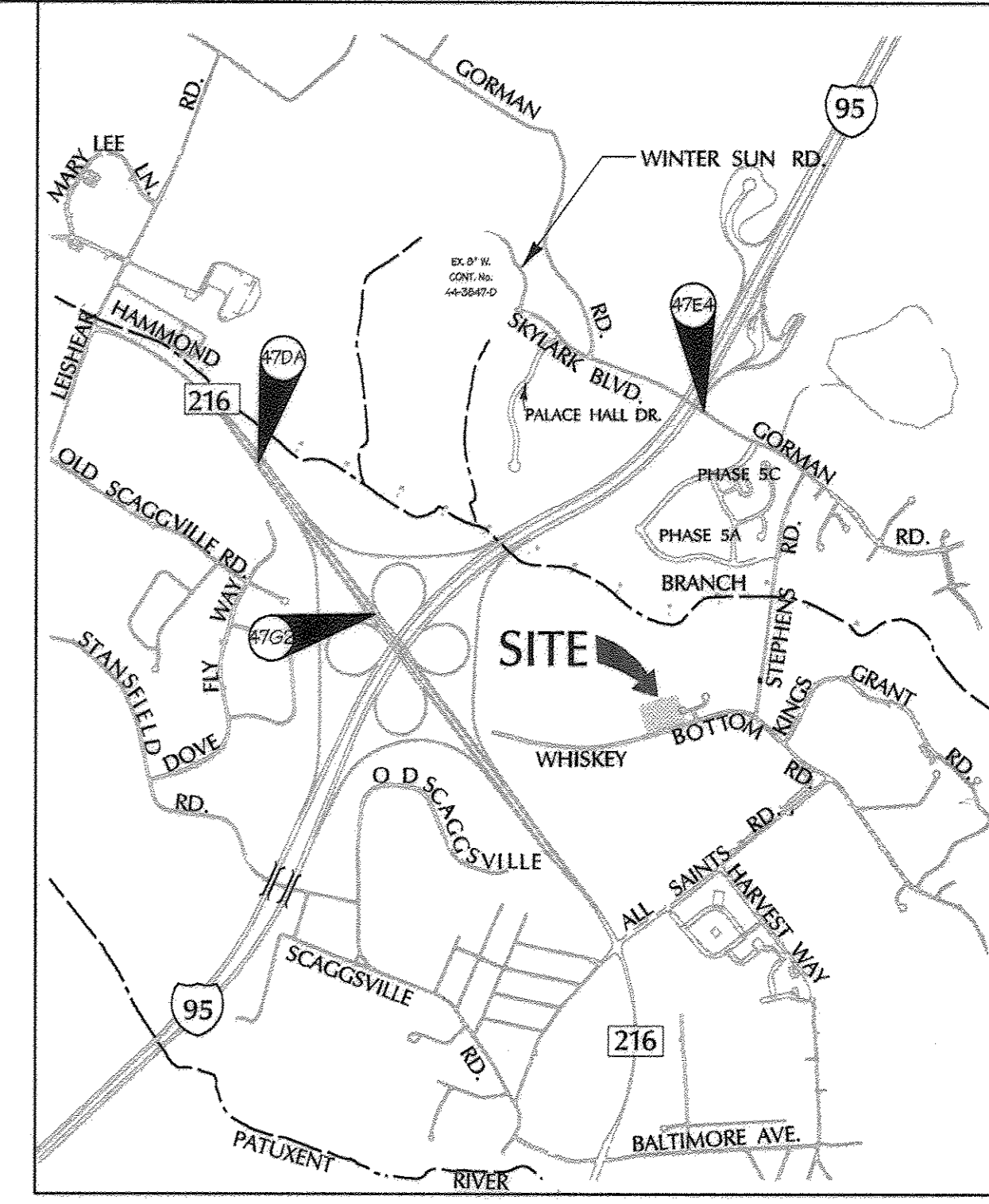

Vicinity Map
SCALE: 1"=2000'

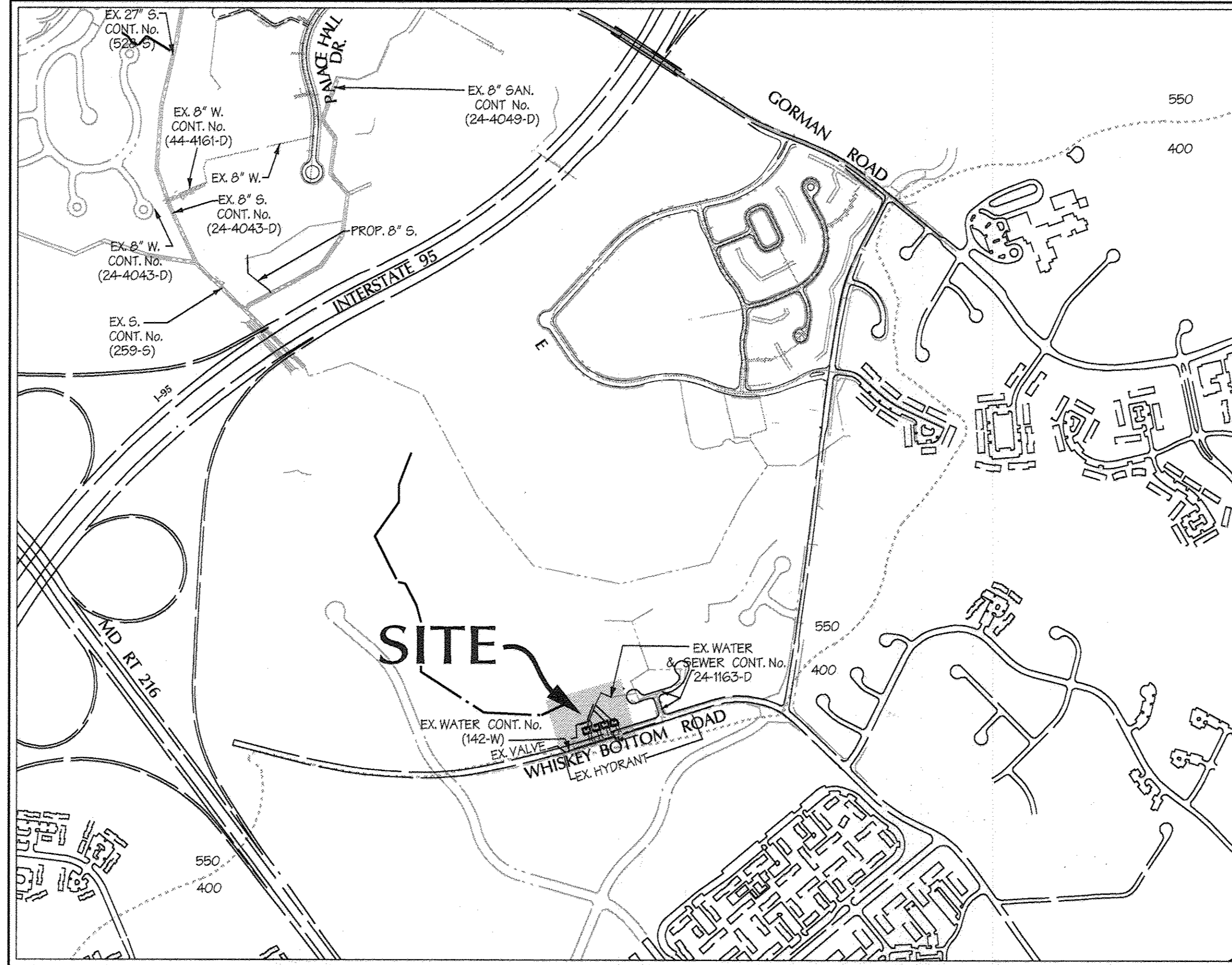

TYPE OF BUILDING:	RESIDENTIAL
NO. OF LOTS/PARCELS:	4 LOTS
NO. OF WATER CONNECTIONS:	4
NO. OF SEWER CONNECTIONS:	4
AREA OF COMMERCIAL LOT/PARCEL:	
SEWER SHED:	LITTLE PATUXENT WRP
PUMPING STATION:	

LOCATION MAP

SCALE: 1"=600'
CONTRACT NO. 24-4527-D

PROFESSIONAL CERTIFICATION

I hereby certify that these documents were prepared or approved by me, and that I am a duly licensed professional engineer under the laws of the State of Maryland.

License No. 26569 Expiration Date: 7-16-17

FOR REVISION NO. 1 ONLY

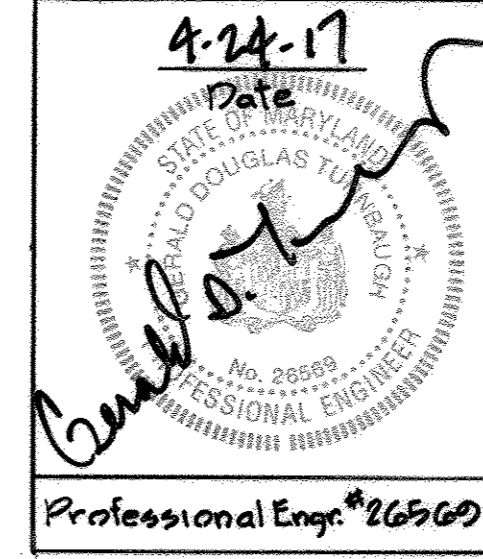

BENCHMARK

DESCRIPTION

ADC COORDINATES

Map 19, J-9

47DA	NORTHING: 163191.9104 EASTING: 412246.9759 ELEVATION: 319.905 ft.
47EA	NORTHING: 163366.2285 EASTING: 412346.2950 ELEVATION: 336.809 ft.
47ES	NORTHING: 162440.1212 EASTING: 411953.9279 ELEVATION: 364.210 ft.

DEVELOPER: THE HOWARD RESEARCH & DEVELOPMENT CORPORATION
10275 LITTLE PATUXENT PARKWAY
COLUMBIA, MARYLAND 21044
410-922-6149

ITEMS	QUANTITIES ESTIMATED	AS-BUILT		
		QUANTITIES	TYPE	MANUFACTURER / SUPPLIER
8" PVC SEWER	249 LF	249 L.F.	PVC, SDR-35	JMMFG./BELAIR ROAD SUPPLY
STD. MANHOLES	3 EA	3 EA.	PRECAST	ATLANTIC CONC. PRODUCTS/BELAIR RD SUPPLY
WHC-11/2"	4 EA	4 EA.	BALL CURB	MUELLER CO./BELAIR ROAD SUPPLY
FIRE HYDRANT	1 EA	1 EA.	8" MUELLER	MUELLER CO./BELAIR ROAD SUPPLY
6" WATER	36 LF	48 L.F.	DIP, CL. 54	GRIFFIN PIPE/BELAIR ROAD SUPPLY

NAME OF UTILITY CONTRACTOR: CONSOLIDATED CONSTRUCTION SERVICES
SURVEY AND DRAFTING DIVISION AS-BUILT DATE: NOVEMBER 14, 2008

Purpose Statement for Redline Revision No. 1
The purpose of this redline revision is to show new offsite 1.5" low pressure sewer and its associated easement through lot 5 and connect to public SMH #103, as well as, show revisions to the Forest Conservation Area per this impact.

AS BUILT
DATE: NOVEMBER 14, 2008

SHEET	DESCRIPTION
1	COVER SHEET
2	PRELIMINARY WHC & 8" SANITARY SEWER PLAN

Legend

EX. CURB & GUTTER	---	PROP. SEWER	6" S.
EX. MAJOR CONTOURS	--- 400 ---	PROPERTY LINE	---
EX. MINOR CONTOURS	--- 402 ---	ROADWAY RIGHT-OF-WAY	---
EX. STORM DRAIN	EX. 21" RCP	PROPOSED LOT LINE	---
EX. SEWER	EX. 8" S.	PROPOSED EASEMENT	---
EX. WATER	EX. 8" W.	PROPOSED CURB & GUTTER	---
EXISTING TREE LINE	---	PROPOSED SIDEWALK	---
EXISTING WETLAND LIMIT	---	PROPOSED GUARD RAIL	---
PROP. STORM DRAIN	15" RCP CL. IV	PROPOSED RIP-RAP	---
WATER LINE STATIONING	2	PROPOSED HYDRANT	---

REVIEWED FOR NATURAL RESOURCES CONSERVATION SERVICE AND MEETS TECHNICAL REQUIREMENT
[Signature]
SIGNATURE DATE

THIS DEVELOPMENT PLAN IS APPROVED FOR SOIL EROSION AND SEDIMENT CONTROL BY THE HOWARD COUNTY CONSERVATION DISTRICT.
APPROVED
[Signature] 4/14/08
HOWARD S.C.D. DATE

DEPARTMENT OF PUBLIC WORKS
HOWARD COUNTY, MARYLAND
[Signature] 4/14/08
CHIEF - BUREAU OF UTILITIES - DATE

DEPARTMENT OF PLANNING & ZONING
HOWARD COUNTY, MARYLAND
DMW
Daft-McCune-Walker, Inc.
A Team of Land Planners, Landscape Architects, Golf Course Architects, Engineers, Surveyors & Environmental Professionals
200 East Pennsylvania Avenue
Towson, Maryland 21286
(410) 296-3333
Fax 296-4706

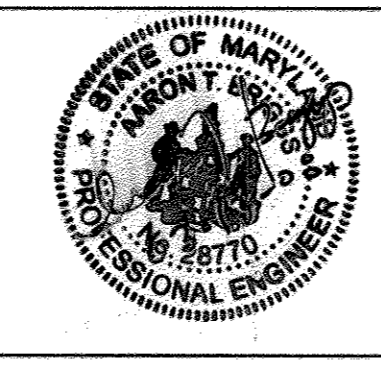

DESIGN BY:	KAD
DRAWN BY:	KAW
CHECKED BY:	
DATE:	3/14/08
BY:	NO.
REVISION:	Redline Revision No. 1 Shown for Reference
DATE:	11-30-16

TITLE SHEET
8" SEWER
6th ELECTION DISTRICT
600 SCALE MAP NO. 47 BLOCK NO. 7, 8, 9, 13

SCALE: 1"=600'
SHEET 1 of 2
BLOUGH PROPERTY
CONTRACT NO. 24-4527-D

