

SCALE: 1" = 50'

CONTRACT NO. 14-4467-D
 MT. HEBRON SECTION 24
 LOTS 1 THRU 12, OPEN SPACE LOT 13 &
 NON-BUILDABLE BULK PARCEL 'A'
 HOWARD COUNTY, MARYLAND

DEPARTMENT OF PUBLIC WORKS
 HOWARD COUNTY, MARYLAND
 DATE: 12/10/09
 JOHN C. GEAR, CHIEF, BUREAU OF UTILITIES

DEPARTMENT OF PLANNING AND ZONING
 HOWARD COUNTY, MARYLAND
 DATE: 12/24/09
 CHIEF, DEVELOPMENT ENGINEERING DIVISION

FISHER, COLLINS & CARTER, INC.
 CIVIL ENGINEERING CONSULTANTS & LAND SURVEYORS
 1100 W. WASHINGTON STREET, SUITE 200
 ELICOTT CITY, MARYLAND 21043
 (410) 481-2000



DESIGNED BY:	KCL	AS-BUILT REVISIONS	4-4-11
B.C.E.	PCG	REMOVE BURY LINE VALVES & BURY LEAKAGE FOR BOTH FIRE HYDRANTS	01/10
DRAWN BY:	PCG	REMOVE VARIOUS WHO LOCATIONS TO AVOID PROPOSED DRIVEWAYS	01/10
P.M.K.	PCG	INDICATE NOVEL REVISIONS & DRIVEWAY RECONSTRUCTIONS FOR ALL LOTS	01/10
CHECKED BY:	PCG	INDICATE THE INSTALLATION OF AN OPEN BENCH SETBACK FOR ALL LOTS	01/10
DATE:	PCG	REMOVE THE SIZE OF THE WHO FOR ALL LOTS FROM 1" TO 1 1/2"	01/10
BY NO.		REVISION	DATE

WATER AND SEWER MAINS
 PLAN
 600' SCALE MAP NO. 17 BLOCK NO. 10
 F.C.C. WORK ORDER NO. 05024-3001
 FILE NAME: WATER AND SEWER MAINS PLAN SHEET

MT. HEBRON SECTION 24
 LOTS 1 THRU 12, OPEN SPACE LOT 13 &
 NON-BUILDABLE BULK PARCEL 'A'
 CONTRACT NO. 14-4467-D
 SECOND ELECTION DISTRICT
 HOWARD COUNTY, MARYLAND

SCALE AS SHOWN
 SHEET 2 OF 3

I:\2005\05024\dwg\05024-W&S-Base-Plan.dwg, 12/7/2009 11:52:09 AM

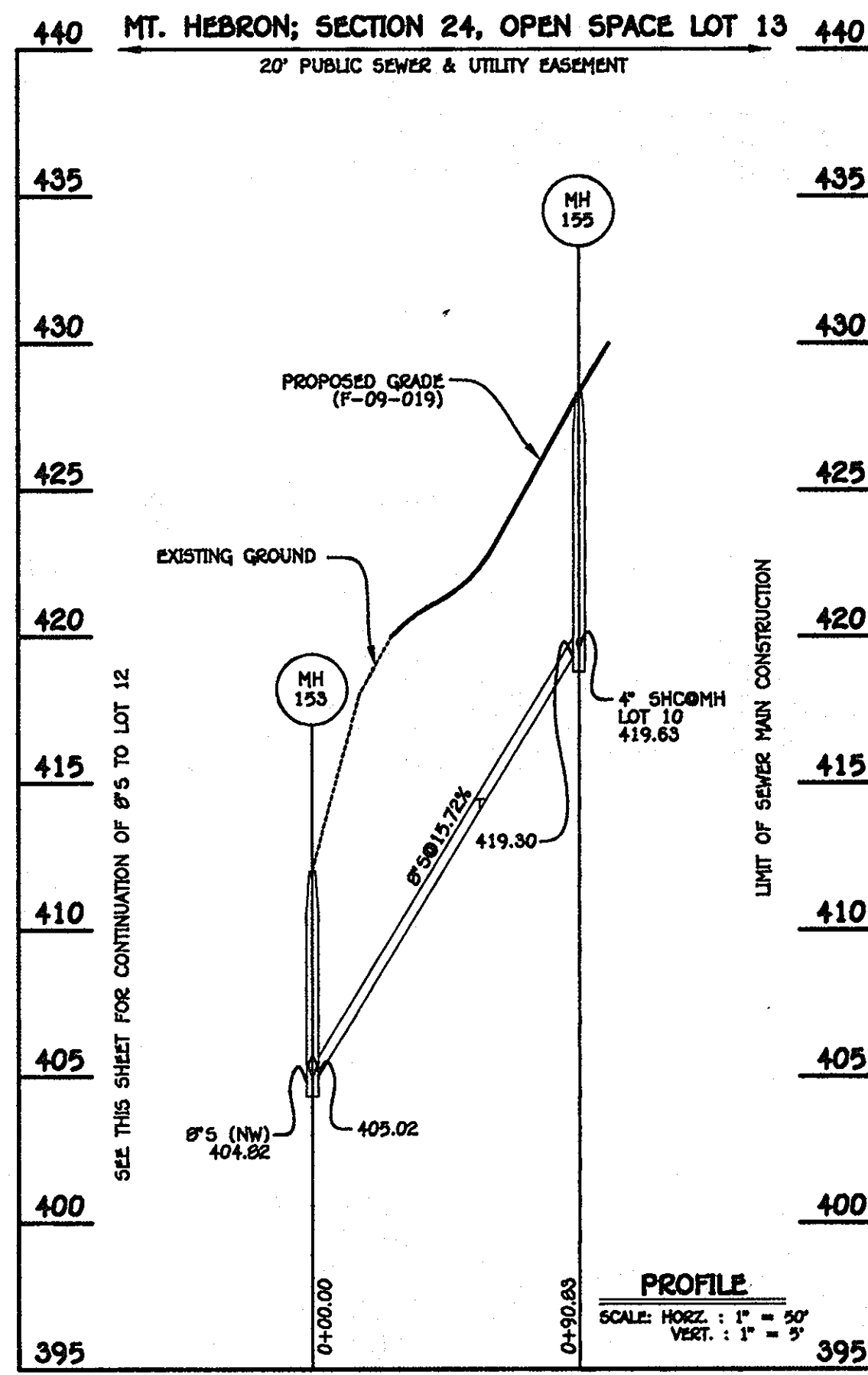

8" SEWER MAIN: LOTS 10 & 11

- WATER MAIN NOTES:**
1. ALL WATER MAINS SHALL BE AMVA C900 PVC PIPE.
 2. ALL PIPE BEDDING, TRACER WIRE, LOCATING TAPE AND OTHER APPURTENANCES SHALL BE IN ACCORDANCE WITH THE HOWARD COUNTY DESIGN MANUAL VOLUME II - WATER AND SEWER STANDARDS FOR AMVA C900 PVC WATER PIPE INSTALLATION.
 3. DEFLECTION COUPLINGS SHALL BE CERTAIN-TREED PVC HIGH DEFLECTION COUPLINGS.
 4. ALL WATER HOUSE CONNECTIONS AND TAPS SHALL BE PERFORMED USING A SADDLE.

NO.	NORTHING	EASTING	RIM ELEVATION
151	596725.73	1399394.28	407.75*
152	596824.52	1399422.61	408.00*
153	596829.45	1399471.95	412.00*
154	596913.92	1399477.57	414.00*
155	596759.06	1399529.35	428.30**

NOTE: *SET MH RIMS FLUSH W/EXISTING GROUND.
**SET MH RIM FLUSH W/PROPOSED GRADE.

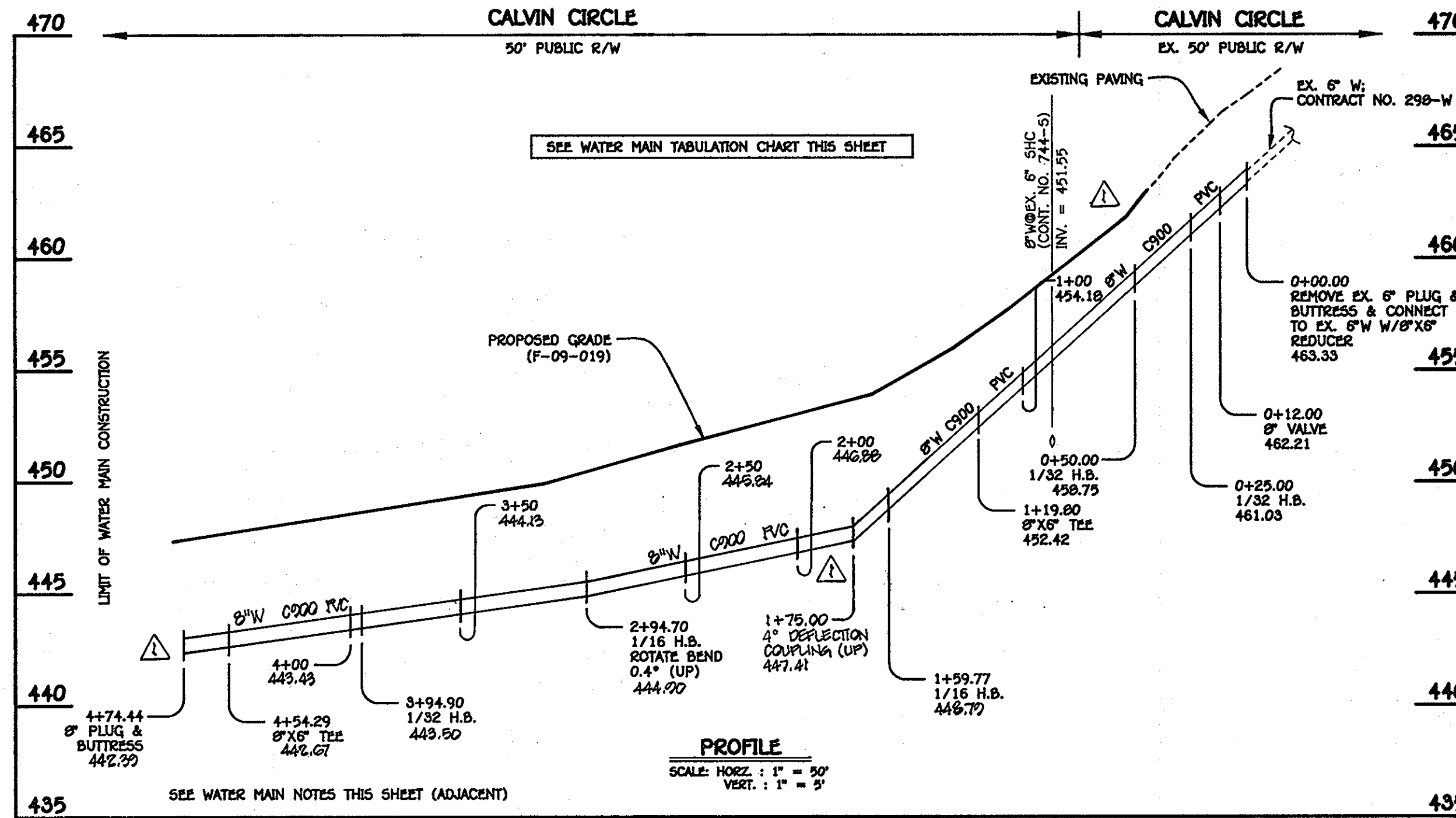

8" WATER MAIN: CALVIN CIRCLE

W.M. STA.	APPURTENANCE	NORTHING	EASTING
8" WATER MAIN: CALVIN CIRCLE			
0+00.00	CONNECT TO EX. 6" W/ 8"X6" REDUCER	596639.05	1360069.33
0+12.00	8" VALVE	596639.04	1360057.33
0+25.00	1/32 H.B.	596639.04	1360044.33
0+50.00	1/32 H.B.	596632.55	1360020.19
1+19.80	8"X6" TEE	596632.51	1359950.38
1+99.77	1/16 H.B.	596632.49	1359910.42
2+94.70	1/16 H.B.	596691.05	1359788.86
3+94.90	1/32 H.B.	596766.16	1359722.54
4+54.29	8"X6" TEE	596819.33	1359696.09
4+74.44	8" PLUG & BUTTRESS	596837.38	1359687.11

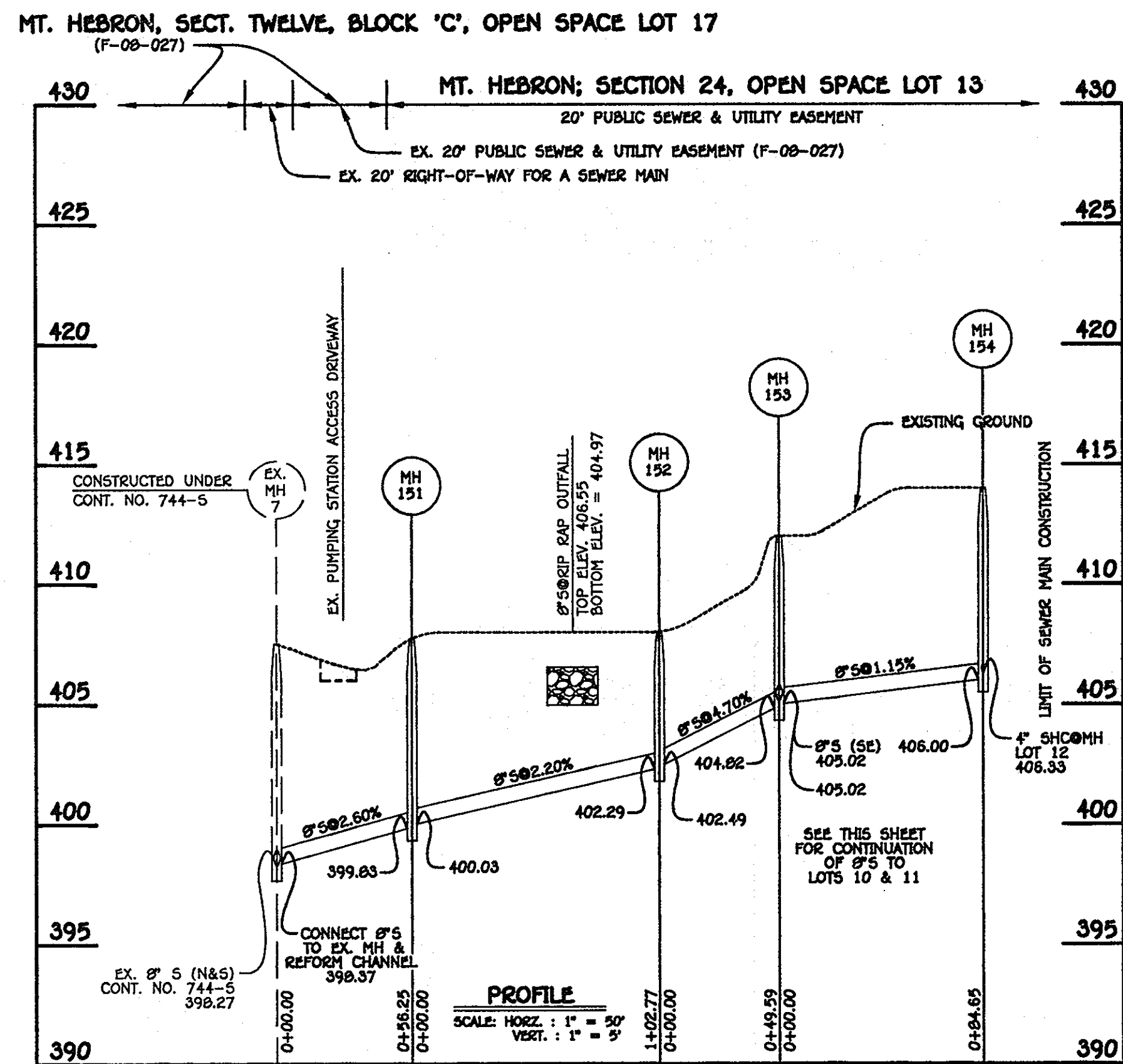

8" SEWER MAIN: LOT 12

STATION	LOT	ELEVATION
EX. MH 8 EX. MH 72		
1+50 RT.	A-1	409.49
2+25 RT.	A-2	412.06
EX. MH 72 EX. MH 73		
0+47 RT.	4	414.72
EX. MH 73 EX. MH 74		
0+29 LT.	9	417.03
0+91 LT.	8	419.79
1+14 RT.	3	420.67
1+67 RT.	2	423.03
1+78 LT.	7	423.57
EX. MH 74 EX. MH 75		
0+42 RT.	1	426.81
0+95 LT.	6	429.98
EX. MH 75 EX. MH 76		
0+46 LT.	5	434.78
MH 153 TO MH 154		
0+94 RT.	12	406.52
MH 154 TO MH 155		
0+97 LT.	11	414.49
0+95 LT.	10	419.83

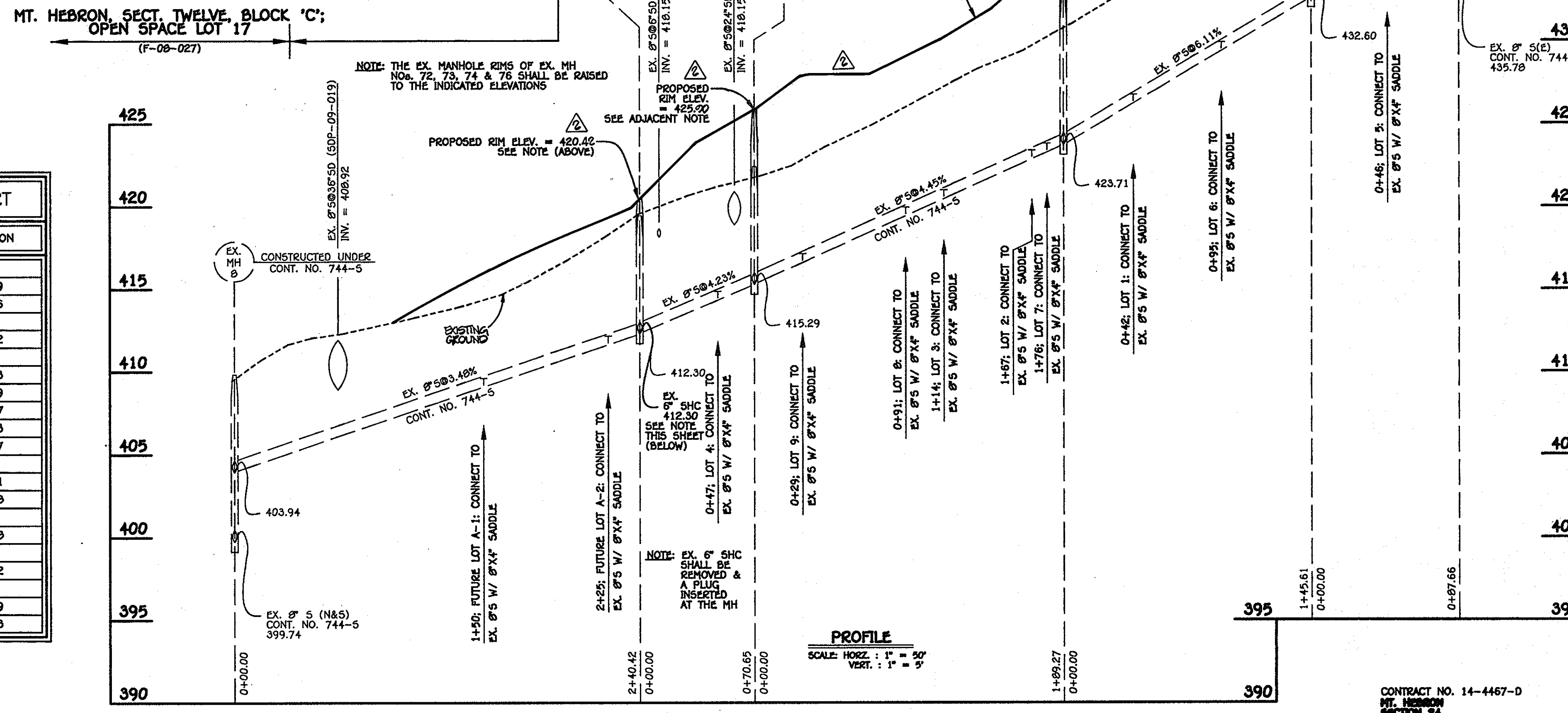

EX. 8" SEWER MAIN: LOTS 1 THRU 9 & FUTURE LOTS A-1 & A-2

DEPARTMENT OF PUBLIC WORKS
HOWARD COUNTY, MARYLAND

DEPARTMENT OF PLANNING AND ZONING
HOWARD COUNTY, MARYLAND

FISHER, COLLINS & CARTER, INC.
CIVIL ENGINEERING CONSULTANTS & LAND SURVEYORS

PAUL W. KRIBBEL
PAUL W. KRIBBEL

DESIGNED BY: B.C.R.
DRAWN BY: B.C.R.
CHECKED BY: P.M.K.
DATE: DECEMBER, 2009

WATER & SEWER MAINS
PROFILES & CHARTS

600' SCALE MAP NO. 17 BLOCK NO. 10
F.C.C. WORK ORDER NO. 09024-3001
FILE NAME: SEWER MAIN PROFILES SHEET

MT. HEBRON
SECTION 24
LOTS 1 THRU 12, OPEN SPACE LOT 13 &
NON-BUILDABLE BULK PARCEL 'A'
CONTRACT NO. 14-4467-D
SECOND ELECTION DISTRICT
HOWARD COUNTY, MARYLAND

SCALE AS SHOWN
SHEET 3 OF 3