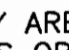

GENERAL NOTES

PART I

- APPROXIMATE LOCATION OF EXISTING MAINS ARE SHOWN. THE CONTRACTOR SHALL TAKE ALL NECESSARY PRECAUTIONS TO PROTECT EXISTING MAINS AND SERVICES AND MAINTAIN UNINTERRUPTED SERVICE. ANY DAMAGE INCURRED SHALL BE REPAIRED IMMEDIATELY TO THE SATISFACTION OF THE ENGINEER AT THE CONTRACTOR'S EXPENSE.
- TOPOGRAPHIC FIELD SURVEYS WERE PERFORMED ON JUNE 2005, BY ROBERT H. VOGEL ENGINEERING, INC.
- HORIZONTAL AND VERTICAL SURVEY CONTROLS:
THE COORDINATES SHOWN ON THE DRAWINGS ARE BASED ON MARYLAND STATE REFERENCE SYSTEM NAD '83/'91 AS PROJECTED BY HOWARD COUNTY GEODETIC CONTROL STATIONS NO. 30BA AND 30DB
ALL VERTICAL CONTROLS ARE BASED ON NAVD '88 VERTICAL CONTROL PROVIDED ON THE DRAWINGS ARE 30BA AND 30DB (ENGINEER/SURVEY FIRM SHALL PROVIDE DESCRIPTION OF VERTICAL CONTROL POINTS, I.E., IRON BARS, CROSS CUTS ON CONCRETE STRUCTURES, ETC.)
- ALL PIPE ELEVATIONS SHOWN ARE INVERT ELEVATIONS UNLESS OTHERWISE NOTED.
- CLEAR ALL UTILITIES BY A MINIMUM OF 12 INCHES. CLEAR ALL POLES BY 5'-0" MINIMUM OR TUNNEL AS REQUIRED UNLESS OTHERWISE NOTED. THE OWNER HAS CONTACTED THE UTILITY COMPANIES AND HAS MADE ARRANGEMENTS FOR BRACING OF POLES AS SHOWN ON DRAWINGS. IN THE EVENT THE CONTRACTOR'S WORK REQUIRES THE BRACING OF ADDITIONAL POLES, ANY COST INCURRED BY THE OWNER FOR BRACING OF ADDITIONAL POLES OR DAMAGES SHALL BE DEDUCTED FROM MONIES OWED THE CONTRACTOR. THE CONTRACTOR SHALL COORDINATE WITH THE UTILITY COMPANIES TO SCHEDULE THE BRACING OF THE POLES.
- FOR DETAILS NOT SHOWN ON THE DRAWINGS, AND FOR MATERIALS AND CONSTRUCTION METHODS USE, HOWARD COUNTY DESIGN MANUAL, VOLUME IV, STANDARD SPECIFICATIONS AND DETAILS FOR CONSTRUCTION (LATEST EDITION). THE CONTRACTOR SHALL HAVE A COPY OF VOLUME IV ON THE JOB.
- WHERE TEST PITS HAVE BEEN MADE ON EXISTING UTILITIES, THEY ARE NOTED BY THE SYMBOL  AT THE LOCATION OF THE TEST PIT. A NOTES OR NOTES CONTAINING THE RESULTS OF THE TEST PIT OR PITS IS INCLUDED ON THE DRAWINGS. EXISTING UTILITIES IN THE VICINITY OF THE PROPOSED WORK FOR WHICH TEST PITS HAVE NOT BEEN DUG SHALL BE LOCATED BY THE CONTRACTOR TWO WEEKS IN ADVANCE OF CONSTRUCTION OPERATION AT HIS OWN EXPENSE.
- THE CONTRACTOR SHALL NOTIFY THE FOLLOWING UTILITY COMPANIES OR AGENCIES AT LEAST FIVE WORKING DAYS BEFORE STARTING WORK SHOWN THESE PLANS:
AT &T.....1-800-252-1133
BGE (CONTRACTOR SERVICE).....410-850-4620
BGE (EMERGENCY).....410-685-1400
BUREAU OF UTILITIES.....410-313-4900
COLONIAL PIPELINE CO.....410-785-1390
MISS UTILITY.....1-800-257-7777
STATE HIGHWAY ADMINISTRATION.....410-531-5533
VERIZON.....1-800-743-0033/410-224-9210
- TREES AND SHRUBS ARE TO BE PROTECTED FROM DAMAGE TO THE MAXIMUM EXTENT. TREES AND SHRUBS LOCATED WITHIN THE CONSTRUCTION STRIP ARE NOT TO BE REMOVED OR DAMAGED BY THE CONTRACTOR
- THE CONTRACTOR SHALL REMOVE TREES, STUMPS AND ROOTS ALONG THE LINE OF EXCAVATION. PAYMENT FOR SUCH REMOVAL SHALL BE INCLUDED IN THE UNIT PRICE BID FOR THE CONSTRUCTION OF THE MAIN.
- THE CONTRACTOR SHALL NOTIFY THE BUREAU OF HIGHWAYS, HOWARD COUNTY, AT (410) 313-7450 AT LEAST FIVE WORKING DAYS BEFORE ANY OPEN CUTTING OR BORING/JACKING OF ANY COUNTY ROAD FOR LAYING WATER/SEWER MAINS OR HOUSE CONNECTIONS. THE APPROVAL OF THESE DRAWINGS WILL CONSTITUTE COMPLIANCE WITH DPW REQUIREMENTS PER SECTION 18.114(a) OF THE HOWARD COUNTY CODE.

PART II - WATER

- ALL WATER MAINS TO BE D.I.P. CLASS 52 UNLESS OTHERWISE NOTED.
- TOPS OF ALL WATER MAINS TO HAVE A MINIMUM OF 3'-6" COVER UNLESS OTHERWISE NOTED.
- VALVES ADJACENT TO TEES SHALL BE STRAPPED TO TEES.
- ALL FITTINGS SHALL BE BUTTRESSED OR ANCHORED WITH CONCRETE IN ACCORDANCE WITH THE STANDARD DETAILS UNLESS OTHERWISE PROVIDED FOR ON THE DRAWINGS.
- FIRE HYDRANTS SHALL BE SET TO THE BURY LINE ELEVATIONS SHOWN ON THE DRAWINGS. ALL FIRE HYDRANTS SHALL BE INSTALLED IN ACCORDANCE WITH STANDARD DETAILS. THE SOIL AROUND THE FIRE HYDRANT SHALL BE COMPACTED IN ACCORDANCE WITH SECTION 1000 AND 1005 OF THE STANDARD SPECIFICATIONS.
- THE CONTRACTOR SHALL NOT OPERATE ANY WATER MAIN VALVES ON THE EXISTING WATER SYSTEM.

PART III - SEWER

- ALL SEWER MAINS SHALL BE D.I.P. OR P.V.C UNLESS OTHERWISE NOTED.
- ALL MANHOLES SHALL BE 4'-0" INSIDE DIAMETER UNLESS OTHERWISE NOTED.
- FORCE MAINS SHALL BE D.I.P. ONLY.
- MANHOLES SHOWN WITH 12" AND 16" WALLS ARE FOR BRICK MANHOLES ONLY.
- MANHOLES DESIGNATED W.T. IN PLAN AND PROFILE SHALL HAVE WATERTIGHT FRAME AND COVER, STANDARD DETAIL G5.52. WHERE WATERTIGHT MANHOLE FRAME AND COVERS ARE USED, SET TOP OF FRAME 1'-6" ABOVE FINISHED GRADE UNLESS OTHERWISE NOTED ON THE DRAWINGS.
- HOUSE(S) WITH THE SYMBOL "C.N.S." INDICATES THAT CELLAR CANNOT BE SERVED.

DORSEY CROSSING

SINGLE FAMILY ATTACHED TOWNHOUSE CONDOMINIUM

UNITS 1 THROUGH 95

CONTRACT NO. 24-4366-D

| BENCHMARKS | | | |
|------------|-------------|---------------|-----------|
| NO. | NORTHING | EASTING | ELEVATION |
| 30BA | 573,149.052 | 1,357,083.226 | 397.18 |
| 300B | 572,298.132 | 1,353,001.811 | 409.18 |

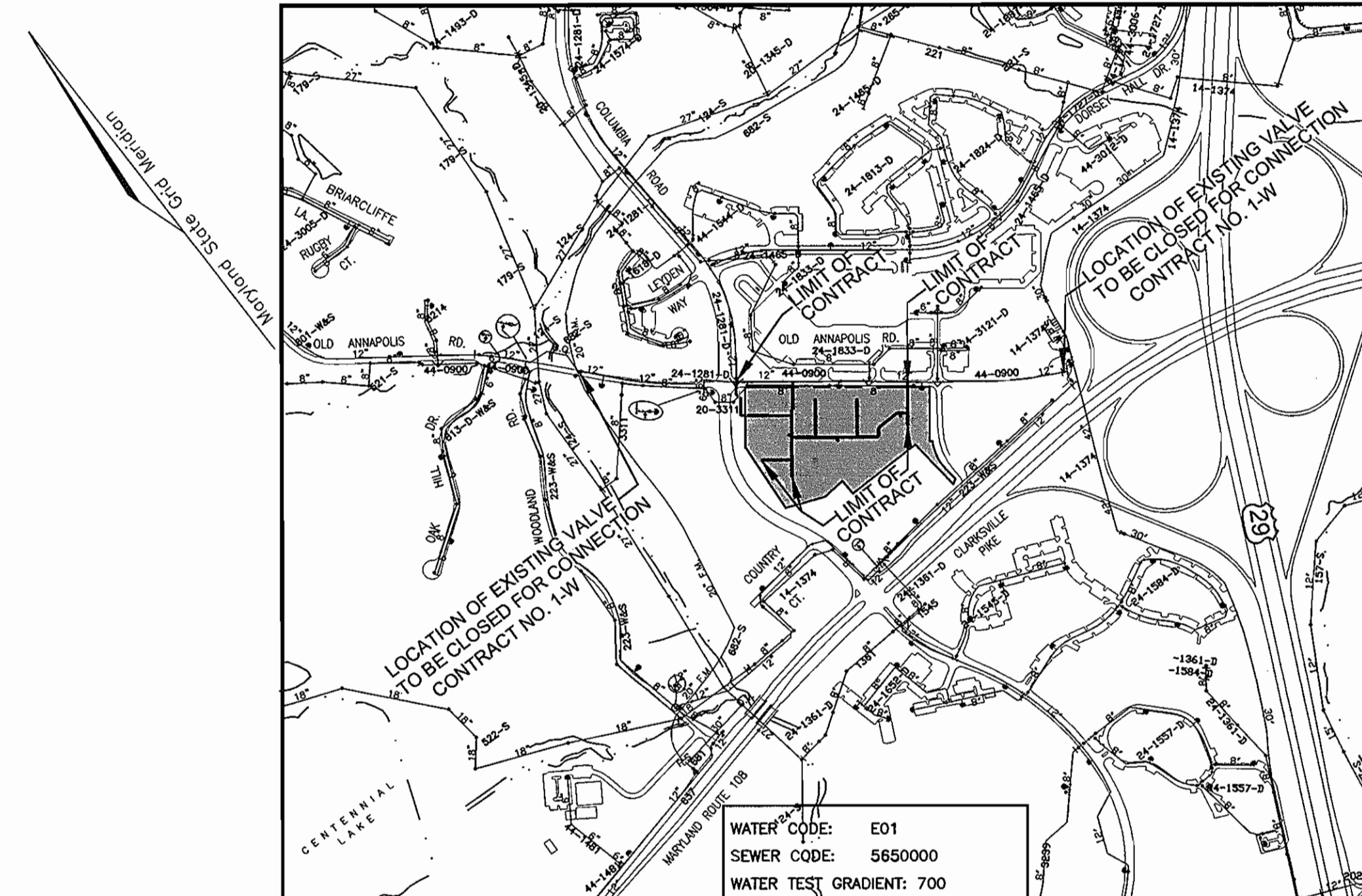
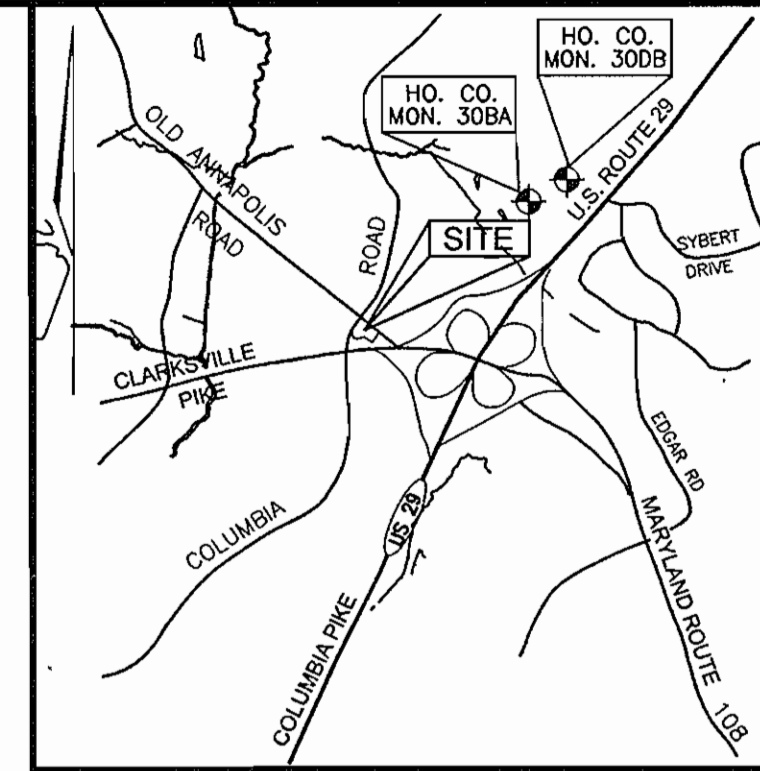

LOCATION PLAN

SCALE: 1"=600'

| | |
|---------------------------------|------------------------------------|
| TYPE OF BUILDING: | SINGLE FAMILY ATTACHED CONDOMINIUM |
| NO. OF BUILDINGS: | 95 |
| NO. OF WATER HOUSE CONNECTIONS: | 95 |
| NO. OF SEWER HOUSE CONNECTIONS: | 1 |
| DRAINAGE AREA: | LITTLE PATUXENT RIVER |
| TREATMENT PLANT: | ROUTE 108 PUMPING STATION |

| QUANTITIES | | | | |
|---|----------------------|------------|-----------|---------------------------|
| NAME OF UTILITY CONTRACTOR: C. J. MILLER | | | | |
| SURVEY AND DRAFTING DIVISION AS-BUILT DATE: | | | | |
| ITEMS | QUANTITIES ESTIMATED | AS-BUILT | | |
| | | QUANTITIES | TYPE | MANUFACTURER/SUPPLIER |
| 8" W. (DIP) | 2,075 LF | 1,958 | DIP CL 54 | GRIFFIN PIPE |
| 6" W. (DIP) | 45 LF | 38 | DIP CL 54 | GRIFFIN PIPE |
| 8"X6" FIREHYDRANT TEE & VALVE | 3 EACH | 3 | M.J.C153 | SIGMA CORP |
| FIREHYDRANT | 3 EACH | 3 | A-423 | MUELLER CO. |
| 8"X8" TEE | 6 EACH | 6 | M.J.C153 | SIGMA CORP |
| 8" VALVE | 6 EACH | 6 | M.J.GV.01 | |
| 12" VALVE | 1 EACH | 0 | | |
| 8" CAP & BUTTRESS | 6 EACH | 6 | M.J.C153 | SIGMA CORP |
| 12"X8" TAPPING SLEEVE & VALVE | 2 EACH | 2 | M.J.FL.05 | JCM INDUSTRIES |
| 1/8 HB | 2 EACH | 8 | M.J.C153 | SIGMA CORP |
| 1/16 HB | 2 EACH | 4 | M.J.C153 | SIGMA CORP |
| 8" SEWER MAIN | 90 LF | 89 | SDR 25 | J.M. MFG. |
| SEWER MANHOLES | 1 EACH | 1 | | CONTRACTOR'S PRECAST CORE |
| 1-1/2" WHC | 755 LF | 1,813 | K'COOPER | CAMBRIDGE |
| 2" TWIN WHC | 440 LF | 0 | | |

| UNITS WHC METER SETTING | | | | | | | |
|-------------------------|-------------------------|---------|-------------------------|---------|-------------------------|---------|-------------------------|
| UNIT 1 | SINGLE 1" METER SETTING | UNIT 31 | DOUBLE 1" METER SETTING | UNIT 61 | SINGLE 1" METER SETTING | UNIT 91 | DOUBLE 1" METER SETTING |
| UNIT 2 | DOUBLE 1" METER SETTING | UNIT 32 | DOUBLE 1" METER SETTING | UNIT 62 | SINGLE 1" METER SETTING | UNIT 92 | DOUBLE 1" METER SETTING |
| UNIT 3 | DOUBLE 1" METER SETTING | UNIT 33 | SINGLE 1" METER SETTING | UNIT 63 | SINGLE 1" METER SETTING | UNIT 93 | SINGLE 1" METER SETTING |
| UNIT 4 | DOUBLE 1" METER SETTING | UNIT 34 | DOUBLE 1" METER SETTING | UNIT 64 | SINGLE 1" METER SETTING | UNIT 94 | SINGLE 1" METER SETTING |
| UNIT 5 | DOUBLE 1" METER SETTING | UNIT 35 | DOUBLE 1" METER SETTING | UNIT 65 | DOUBLE 1" METER SETTING | UNIT 95 | SINGLE 1" METER SETTING |
| UNIT 6 | DOUBLE 1" METER SETTING | UNIT 36 | DOUBLE 1" METER SETTING | UNIT 66 | DOUBLE 1" METER SETTING | | |
| UNIT 7 | DOUBLE 1" METER SETTING | UNIT 37 | DOUBLE 1" METER SETTING | UNIT 67 | DOUBLE 1" METER SETTING | | |
| UNIT 8 | SINGLE 1" METER SETTING | UNIT 38 | DOUBLE 1" METER SETTING | UNIT 68 | DOUBLE 1" METER SETTING | | |
| UNIT 9 | DOUBLE 1" METER SETTING | UNIT 39 | DOUBLE 1" METER SETTING | UNIT 69 | DOUBLE 1" METER SETTING | | |
| UNIT 10 | DOUBLE 1" METER SETTING | UNIT 40 | SINGLE 1" METER SETTING | UNIT 70 | DOUBLE 1" METER SETTING | | |
| UNIT 11 | DOUBLE 1" METER SETTING | UNIT 41 | DOUBLE 1" METER SETTING | UNIT 71 | SINGLE 1" METER SETTING | | |
| UNIT 12 | DOUBLE 1" METER SETTING | UNIT 42 | DOUBLE 1" METER SETTING | UNIT 72 | DOUBLE 1" METER SETTING | | |
| UNIT 13 | DOUBLE 1" METER SETTING | UNIT 43 | DOUBLE 1" METER SETTING | UNIT 73 | DOUBLE 1" METER SETTING | | |
| UNIT 14 | DOUBLE 1" METER SETTING | UNIT 44 | DOUBLE 1" METER SETTING | UNIT 74 | SINGLE 1" METER SETTING | | |
| UNIT 15 | DOUBLE 1" METER SETTING | UNIT 45 | DOUBLE 1" METER SETTING | UNIT 75 | SINGLE 1" METER SETTING | | |
| UNIT 16 | DOUBLE 1" METER SETTING | UNIT 46 | DOUBLE 1" METER SETTING | UNIT 76 | SINGLE 1" METER SETTING | | |
| UNIT 17 | SINGLE 1" METER SETTING | UNIT 47 | DOUBLE 1" METER SETTING | UNIT 77 | SINGLE 1" METER SETTING | | |
| UNIT 18 | DOUBLE 1" METER SETTING | UNIT 48 | DOUBLE 1" METER SETTING | UNIT 78 | SINGLE 1" METER SETTING | | |
| UNIT 19 | DOUBLE 1" METER SETTING | UNIT 49 | SINGLE 1" METER SETTING | UNIT 79 | SINGLE 1" METER SETTING | | |
| UNIT 20 | DOUBLE 1" METER SETTING | UNIT 50 | SINGLE 1" METER SETTING | UNIT 80 | SINGLE 1" METER SETTING | | |
| UNIT 21 | DOUBLE 1" METER SETTING | UNIT 51 | SINGLE 1" METER SETTING | UNIT 81 | SINGLE 1" METER SETTING | | |
| UNIT 22 | DOUBLE 1" METER SETTING | UNIT 52 | SINGLE 1" METER SETTING | UNIT 82 | DOUBLE 1" METER SETTING | | |
| UNIT 23 | DOUBLE 1" METER SETTING | UNIT 53 | SINGLE 1" METER SETTING | UNIT 83 | DOUBLE 1" METER SETTING | | |
| UNIT 24 | SINGLE 1" METER SETTING | UNIT 54 | SINGLE 1" METER SETTING | UNIT 84 | SINGLE 1" METER SETTING | | |
| UNIT 25 | DOUBLE 1" METER SETTING | UNIT 55 | DOUBLE 1" METER SETTING | UNIT 85 | SINGLE 1" METER SETTING | | |
| UNIT 26 | DOUBLE 1" METER SETTING | UNIT 56 | DOUBLE 1" METER SETTING | UNIT 86 | SINGLE 1" METER SETTING | | |
| UNIT 27 | DOUBLE 1" METER SETTING | UNIT 57 | SINGLE 1" METER SETTING | UNIT 87 | SINGLE 1" METER SETTING | | |
| UNIT 28 | DOUBLE 1" METER SETTING | UNIT 58 | SINGLE 1" METER SETTING | UNIT 88 | SINGLE 1" METER SETTING | | |
| UNIT 29 | DOUBLE 1" METER SETTING | UNIT 59 | SINGLE 1" METER SETTING | UNIT 89 | SINGLE 1" METER SETTING | | |
| UNIT 30 | DOUBLE 1" METER SETTING | UNIT 60 | SINGLE 1" METER SETTING | UNIT 90 | SINGLE 1" METER SETTING | | |

APPROVED: HOWARD COUNTY DEPARTMENT OF PLANNING & ZONING
 1/22/07
CHIEF, DEVELOPMENT ENGINEERING DIVISION DATE

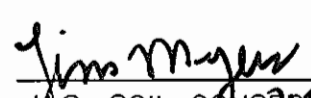
REVIEWED FOR HOWARD COUNTY SOIL CONSERVATION DISTRICT AND MEETS TECHNICAL REQUIREMENTS.
 1/18/07
S.O.S. SOIL CONSERVATION DISTRICT DATE

THIS DEVELOPMENT IS APPROVED FOR SOIL EROSION AND SEDIMENT CONTROL BY THE HOWARD COUNTY SOIL CONSERVATION DISTRICT.
 1/18/07
HOWARD COUNTY SOIL CONSERVATION DISTRICT DATE

SEDIMENT CONTROL MEASURES WILL BE IMPLEMENTED IN ACCORDANCE WITH SECTION 219 OF THE SPECIFICATIONS AND WITH FINAL ROAD CONSTRUCTION PLAN SDP-06-036.

DEVELOPER
DORSEY CROSSING, LLC
P.O. BOX 417
ELLCOTT CITY, MD 21041-0417

APPROVED: HOWARD COUNTY DEPARTMENT OF PUBLIC WORKS
 1-2-07
CHIEF, BUREAU OF UTILITIES DATE

ROBERT H. VOGEL ENGINEERING, INC.
ENGINEERS • SURVEYORS • PLANNERS
8407 MAIN STREET TEL: 410.461.7666
ELLCOTT CITY, MD 21043 FAX: 410.461.8961

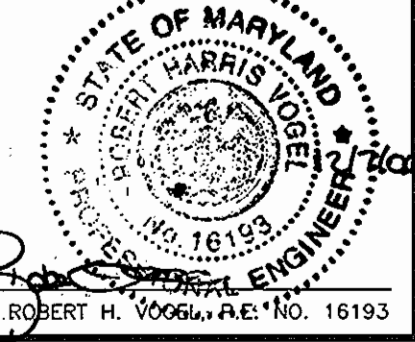

| | | | | | |
|-------------|------------|---------------------|---------|--|--|
| DESIGN BY: | MY/RJ | | | | |
| DRAWN BY: | MY/RJ | | | | |
| CHECKED BY: | RHV | | | | |
| DATE: | APRIL 2006 | | | | |
| KCI | 1 | AS-BUILT DATA SHOWN | 01/1/08 | | |
| BY | NO | REVISION | DATE | | |

PUBLIC FINAL WATER & SEWER MAIN EXTENSIONS
600' SCALE MAP NO. 30 BLOCK NO. 3

DORSEY CROSSING SINGLE FAMILY ATTACHED TOWNHOUSE CONDOMINIUM CONTRACT NO. 24-4366-D
REF:SDP-06-036 TAX MAP 30 BLOCK NO. 3 2ND ELECTION DISTRICT
PARCEL A HOWARD COUNTY, MARYLAND

SCALE AS SHOWN
SHEET 1 OF 5

- NOTES**
1. ALL WATER HOUSE CONNECTIONS ARE 1-1/2" COPPER WATER LATERALS FROM WATER MAIN.
 2. 1" OUTSIDE METER SETTINGS.

NOTE
SINGLE WHC
HOWARD COUNTY, DETAIL W3.33 WITH 1 1/2" CONNECTIONS.

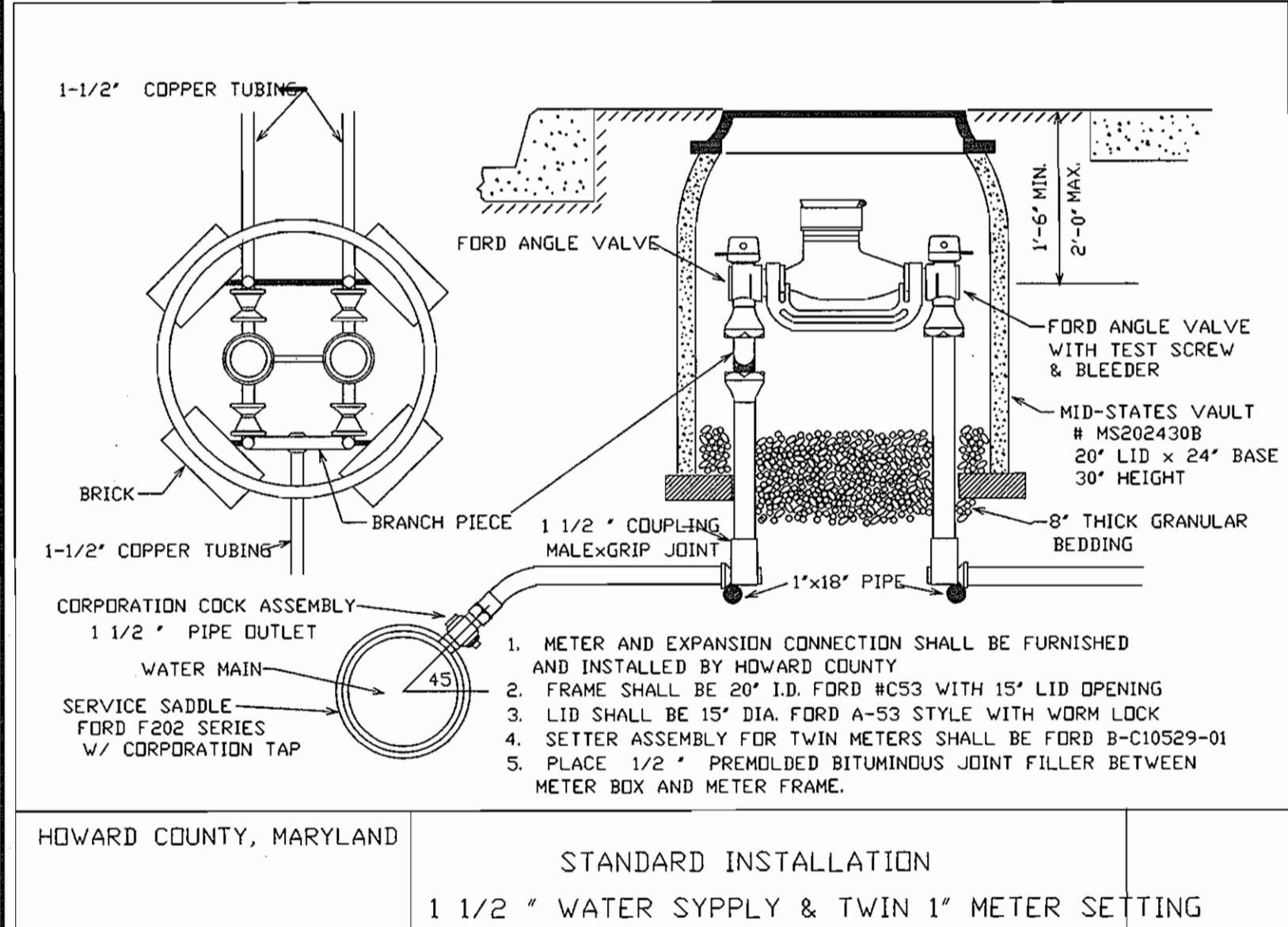

NOTE
TWIN WHC TO BE USED FOR INTERNAL UNITS IN GRASS AREA BETWEEN DRIVEWAY.

APPROVED: HOWARD COUNTY DEPARTMENT OF PLANNING & ZONING
[Signature] 1/26/07
CHIEF, DEVELOPMENT ENGINEERING DIVISION DATE

REVIEWED FOR HOWARD COUNTY SOIL CONSERVATION DISTRICT AND MEETS TECHNICAL REQUIREMENTS.
[Signature]
U.S. SOIL CONSERVATION DISTRICT DATE

THIS DEVELOPMENT IS APPROVED FOR SOIL EROSION AND SEDIMENT CONTROL BY THE HOWARD COUNTY SOIL CONSERVATION DISTRICT.
[Signature]
HOWARD COUNTY SOIL CONSERVATION DISTRICT DATE

SEDIMENT CONTROL MEASURES WILL BE IMPLEMENTED IN ACCORDANCE WITH SECTION 219 OF THE SPECIFICATIONS AND WITH FINAL ROAD CONSTRUCTION PLAN SDP-06-036.

APPROVED: HOWARD COUNTY DEPARTMENT OF PUBLIC WORKS
[Signature] 1-2-07
CHIEF, BUREAU OF UTILITIES DATE

ROBERT H. VOGEL ENGINEERING, INC.
ENGINEERS • SURVEYORS • PLANNERS
8407 MAIN STREET ELLICOTT CITY, MD 21043
TEL: 410.461.7666 FAX: 410.461.8961

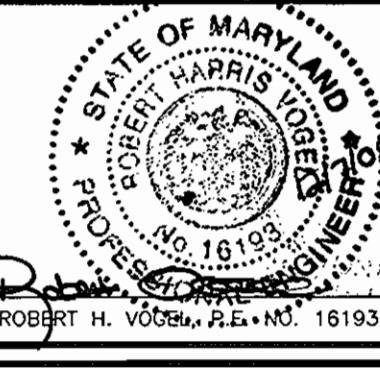

| | | | | | |
|------------------|-----|---|---------------------|----------|--|
| DESIGN BY: MY/RJ | | | | | |
| DRAWN BY: MY/RJ | | | | | |
| CHECKED BY: RHV | | | | | |
| DATE: DEC. 2006 | KCI | 1 | AS-BUILT DATA SHOWN | 01/17/08 | |
| BY | NO | | REVISION | DATE | |

PUBLIC FINAL WATER & SEWER MAIN EXTENSIONS
600' SCALE MAP NO. 30 BLOCK NO. 3

DORSEY CROSSING SINGLE FAMILY ATTACHED TOWNHOUSE CONDOMINIUM CONTRACT NO. 24-4366-D
REF:SDP-06-036 TAX MAP 30 BLOCK NO. 3 2ND ELECTION DISTRICT
PARCEL A HOWARD COUNTY, MARYLAND

SCALE AS SHOWN
SHEET 2 OF 5

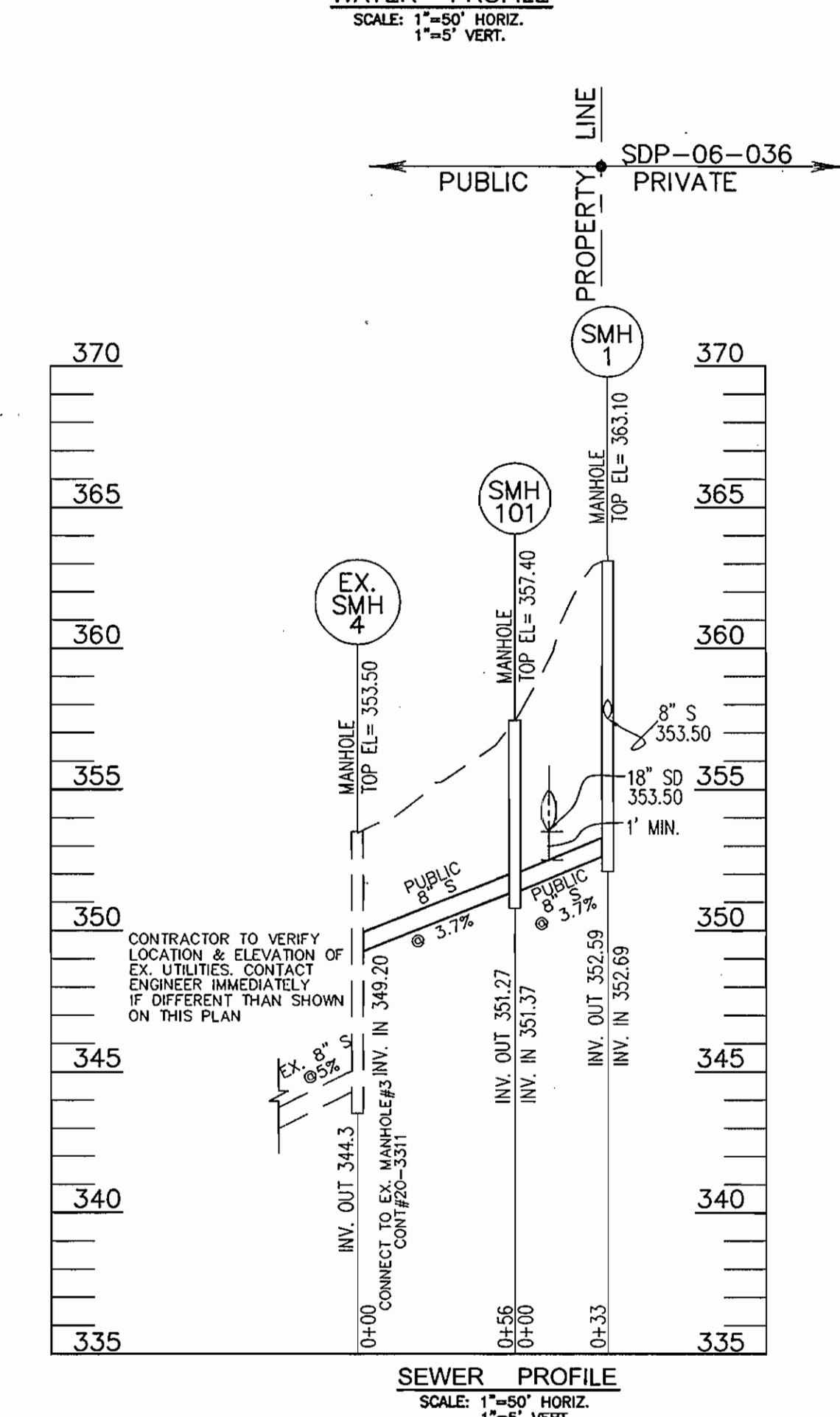
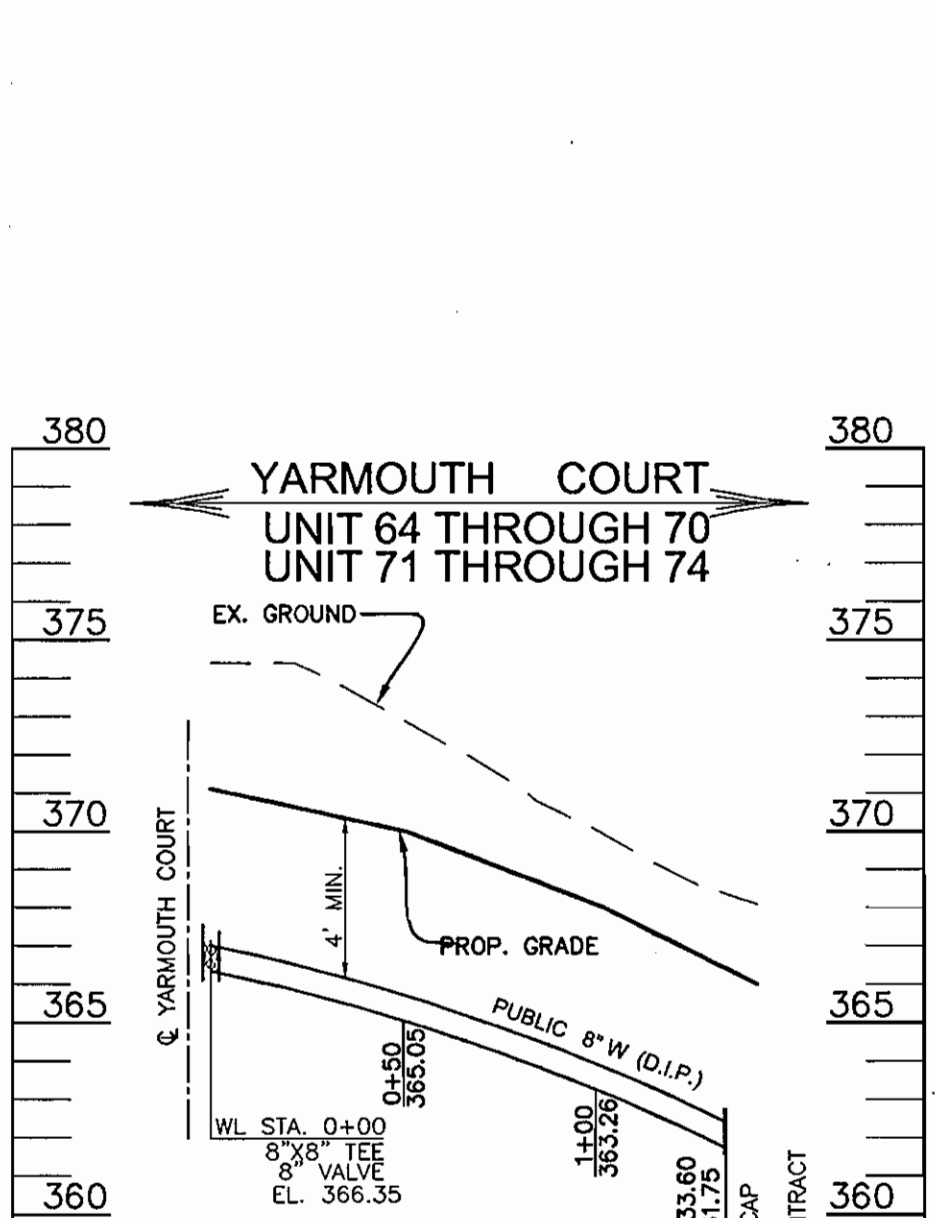
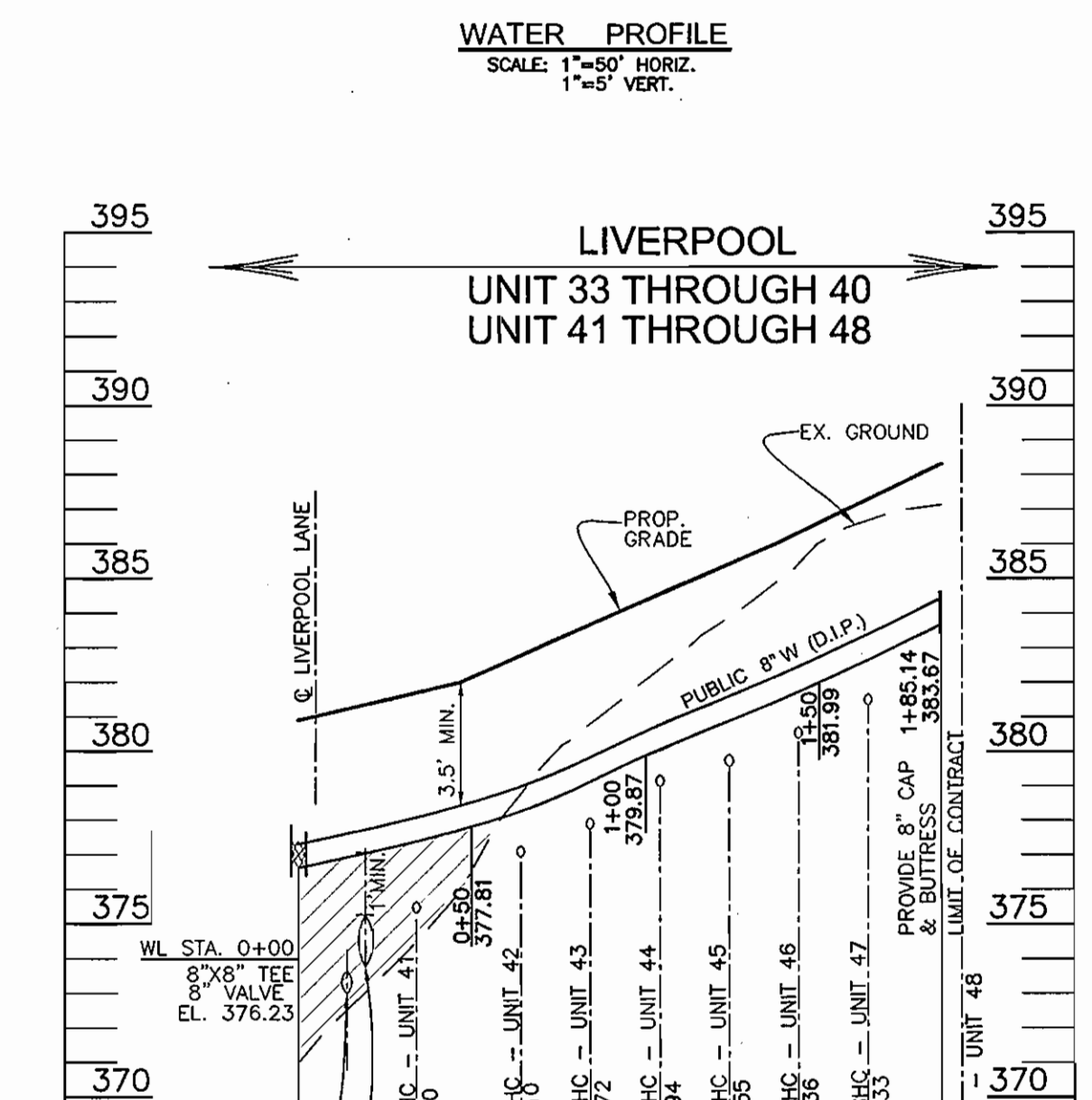
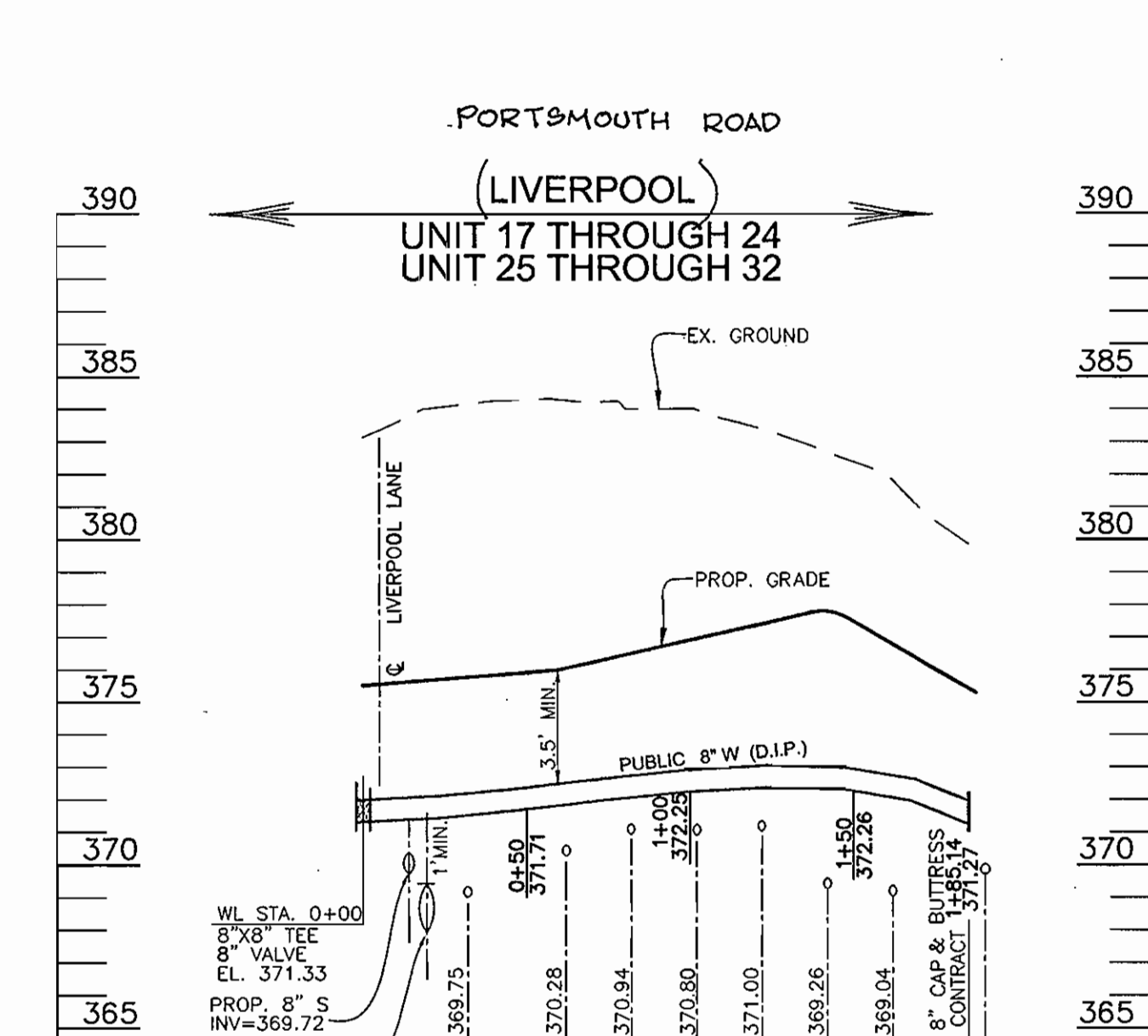
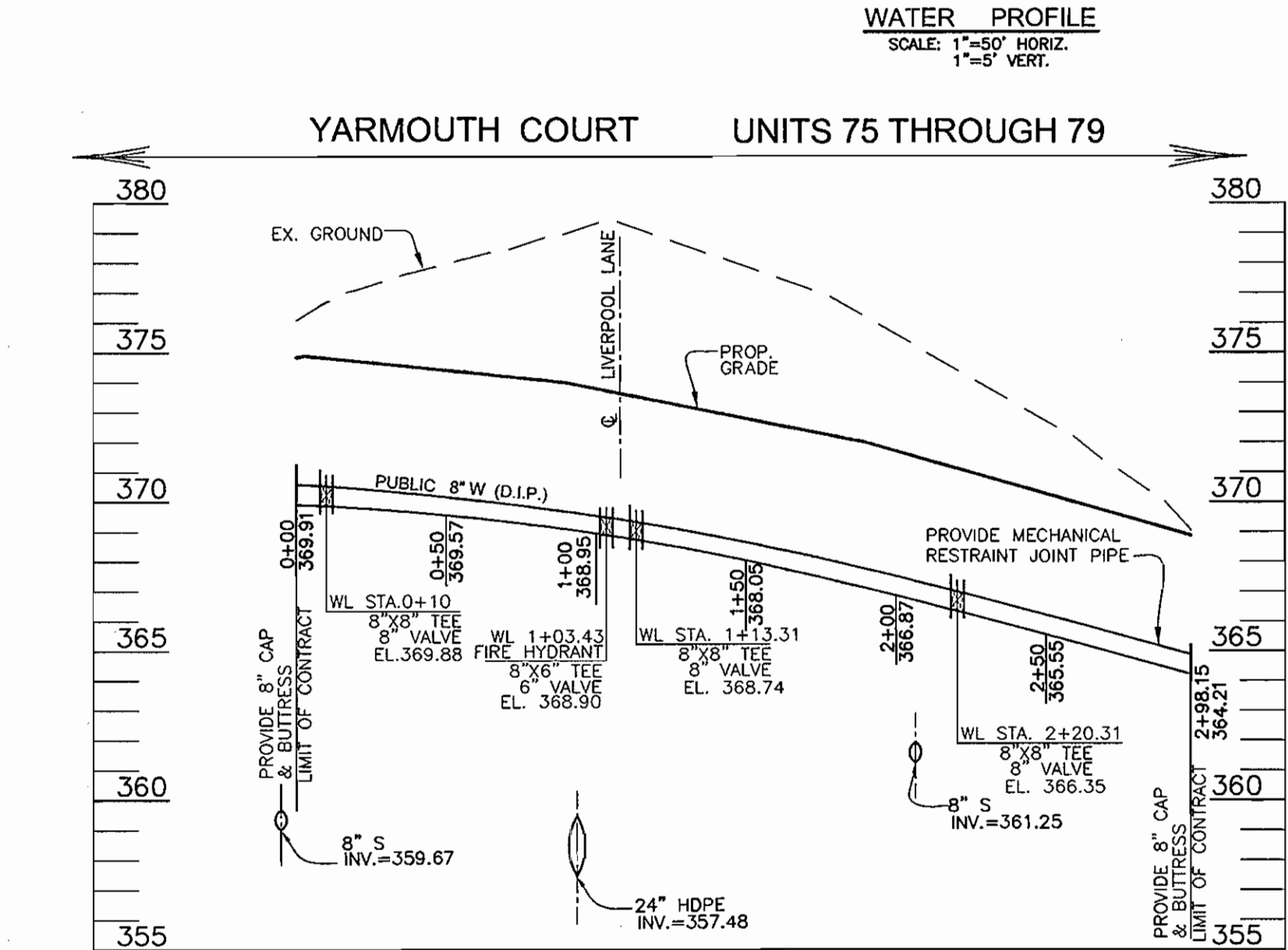
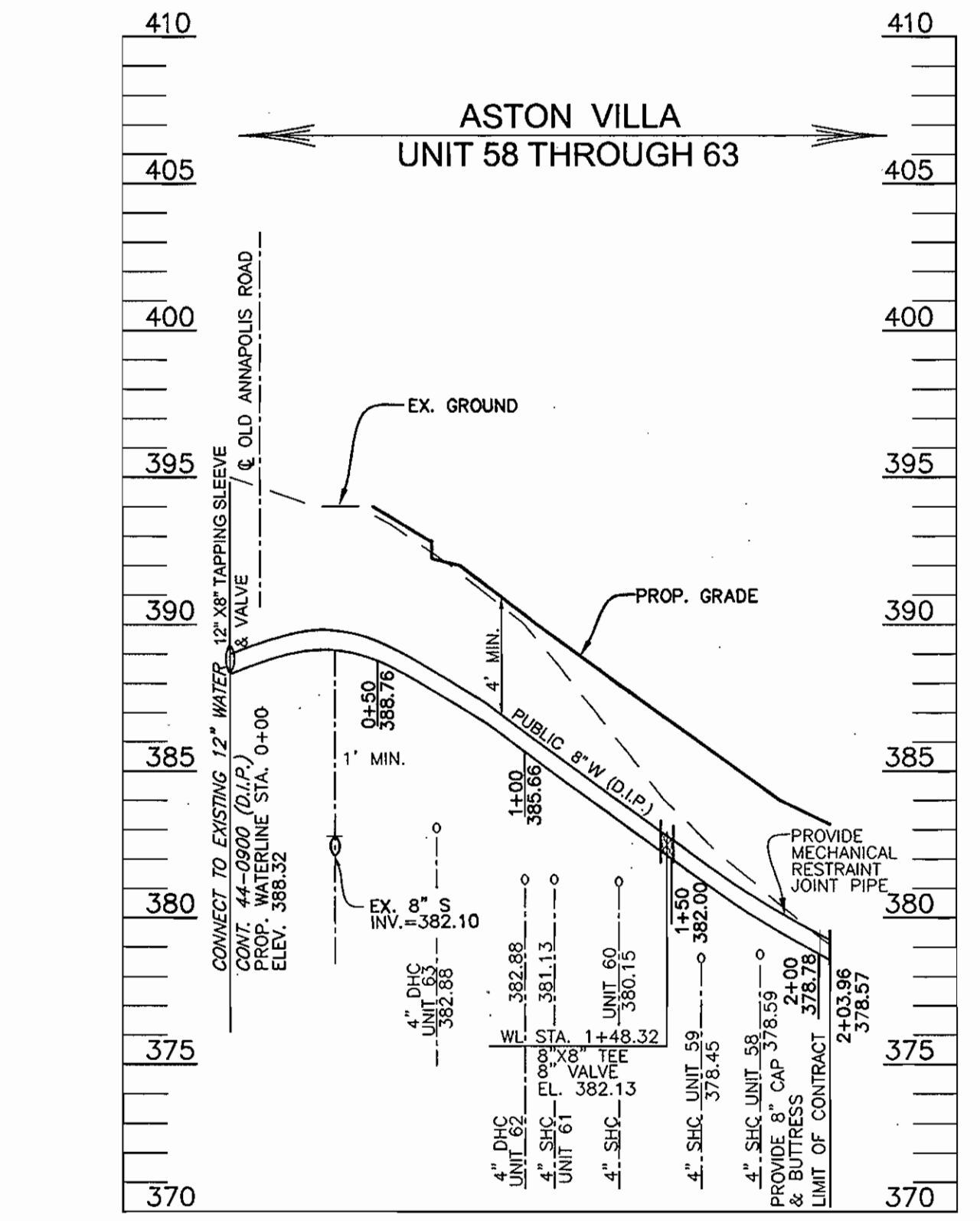
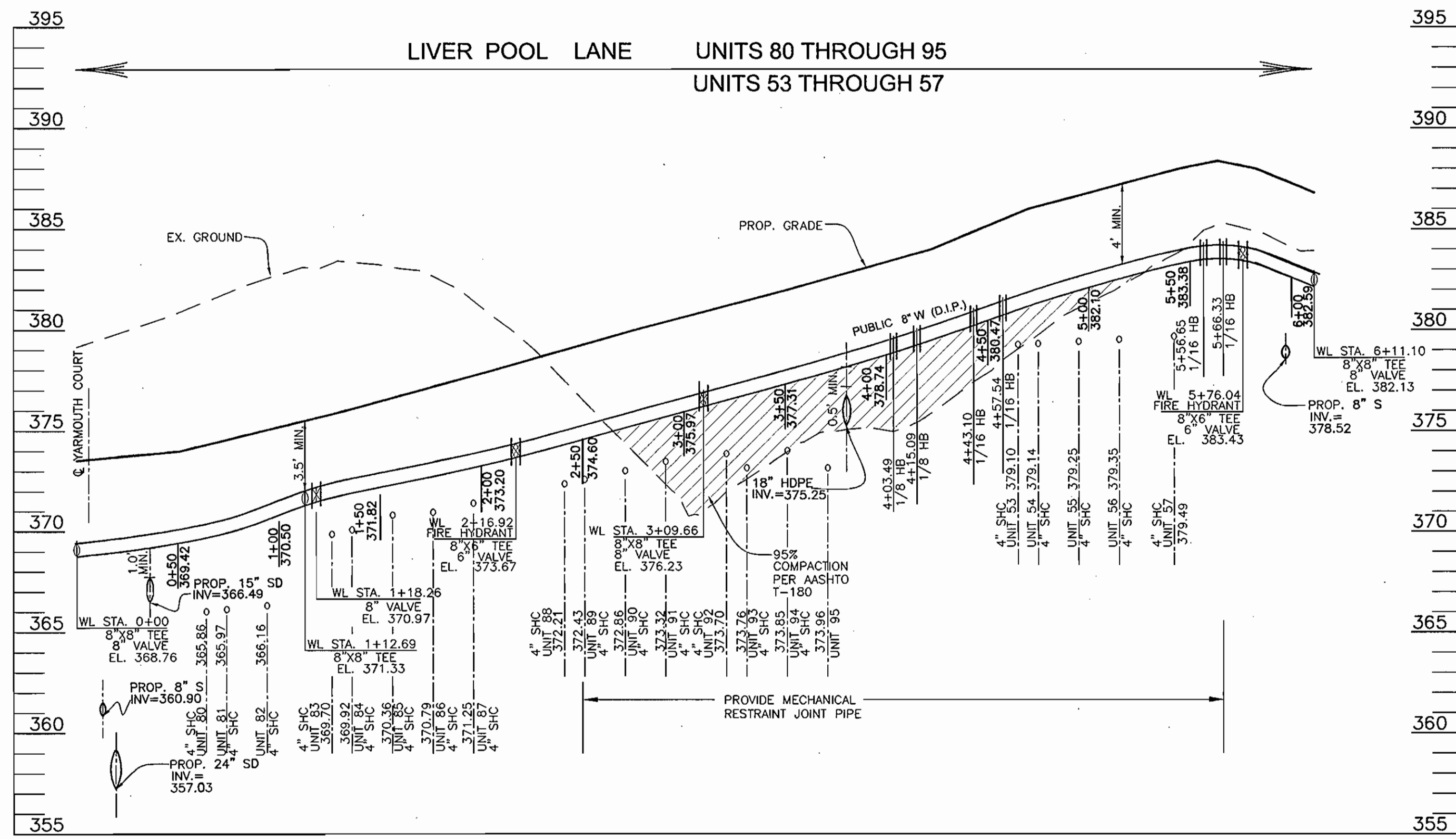
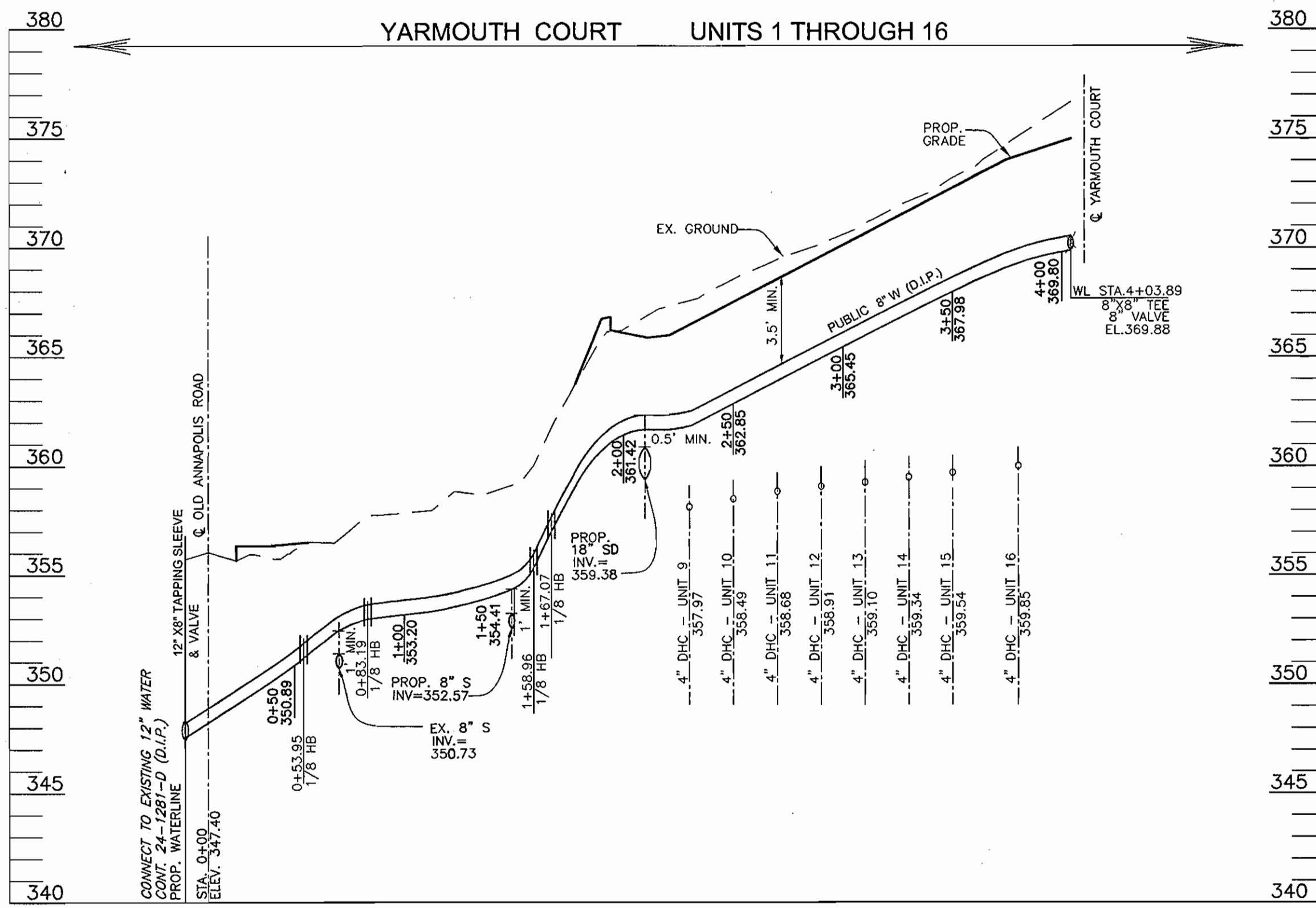

APPROVED: HOWARD COUNTY DEPARTMENT OF PLANNING & ZONING
 [Signature] 1/22/07
 CHIEF, DEVELOPMENT ENGINEERING DIVISION DATE

REVIEWED FOR HOWARD COUNTY SOIL CONSERVATION DISTRICT AND MEETS TECHNICAL REQUIREMENTS.
 [Signature]
 U.S. SOIL CONSERVATION DISTRICT DATE

THIS DEVELOPMENT IS APPROVED FOR SOIL EROSION AND SEDIMENT CONTROL BY THE HOWARD COUNTY SOIL CONSERVATION DISTRICT.
 [Signature]
 HOWARD COUNTY SOIL CONSERVATION DISTRICT DATE

SEDIMENT CONTROL MEASURES WILL BE IMPLEMENTED IN ACCORDANCE WITH SECTION 219 OF THE SPECIFICATIONS AND WITH FINAL ROAD CONSTRUCTION PLAN SDP-06-036.

DEVELOPER
 DORSEY CROSSING, LLC
 P.O. BOX 417
 ELLICOTT CITY, MD 21041-0417

APPROVED: HOWARD COUNTY DEPARTMENT OF PUBLIC WORKS
 [Signature] 1-2-07
 CHIEF, BUREAU OF UTILITIES DATE

ROBERT H. VOGEL ENGINEERING, INC.
 ENGINEERS • SURVEYORS • PLANNERS
 8407 MAIN STREET TEL: 410.461.7666
 ELLICOTT CITY, MD 21043 FAX: 410.461.8961

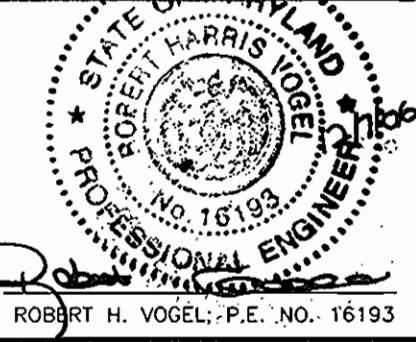

| | | | |
|------------------|----|---------------------|----------|
| DESIGN BY: MY/RJ | | | |
| DRAWN BY: MY/RJ | | | |
| CHECKED BY: RHV | | | |
| DATE: DEC. 2006 | | | |
| KCI | 1 | AS-BUILT DATA SHOWN | 01/17/08 |
| BY | NO | REVISION | DATE |

PUBLIC FINAL WATER & SEWER MAIN EXTENSIONS
 600' SCALE MAP NO. 30 BLOCK NO. 3

DORSEY CROSSING SINGLE FAMILY ATTACHED TOWNHOUSE CONDOMINIUM CONTRACT NO. 24-4366-D
 REF: SDP-06-036 TAX MAP 30 BLOCK NO. 3 2ND ELECTION DISTRICT
 PARCEL A HOWARD COUNTY, MARYLAND

SCALE AS SHOWN
 SHEET 3 OF 5

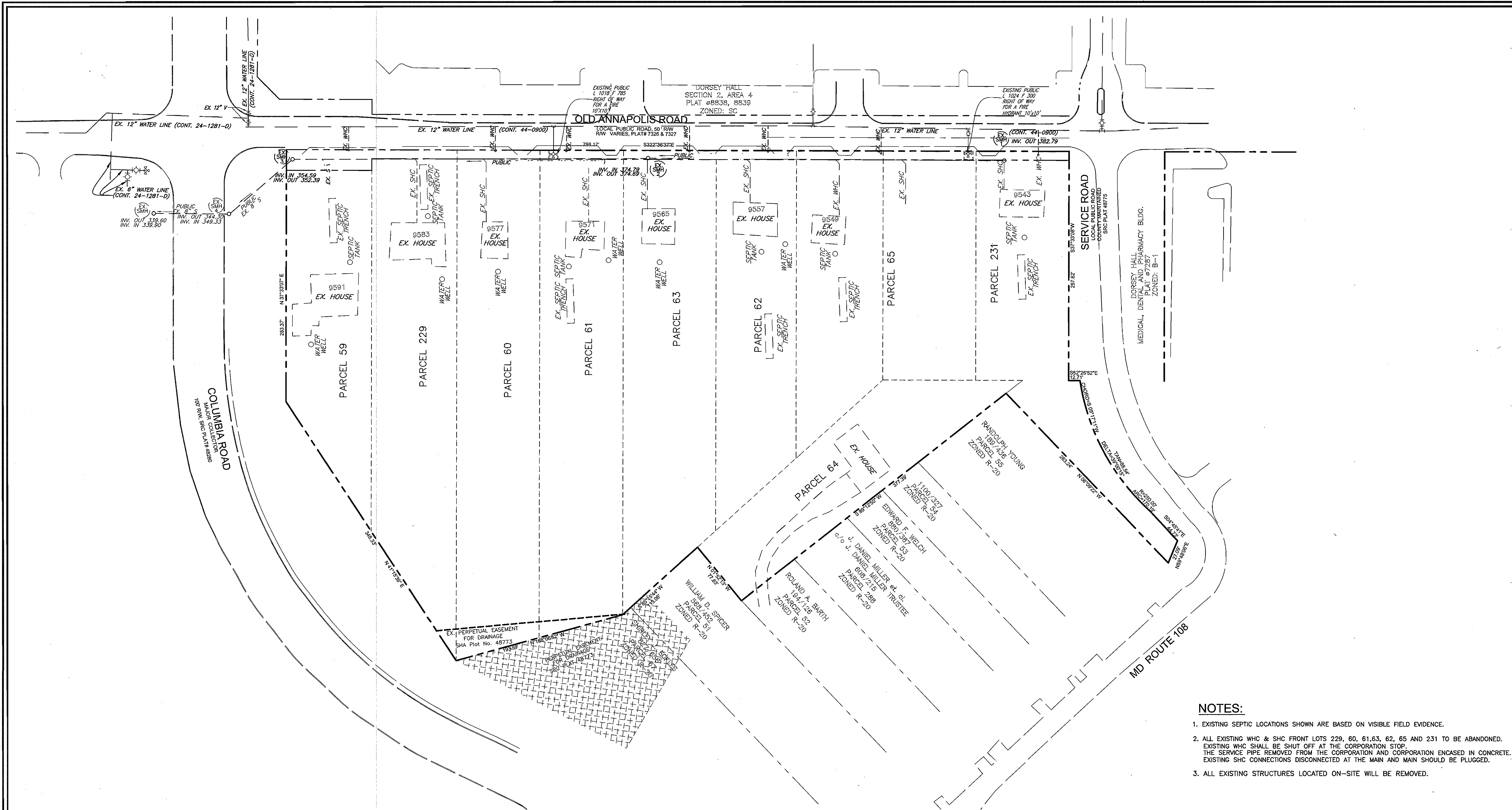

EXISTING CONDITION PLAN
SCALE: 1"=50'

- NOTES:**
1. EXISTING SEPTIC LOCATIONS SHOWN ARE BASED ON VISIBLE FIELD EVIDENCE.
 2. ALL EXISTING WHC & SHC FRONT LOTS 229, 60, 61, 63, 62, 65 AND 231 TO BE ABANDONED. EXISTING WHC SHALL BE SHUT OFF AT THE CORPORATION STOP. THE SERVICE PIPE REMOVED FROM THE CORPORATION AND CORPORATION ENCASED IN CONCRETE. EXISTING SHC CONNECTIONS DISCONNECTED AT THE MAIN AND MAIN SHOULD BE PLUGGED.
 3. ALL EXISTING STRUCTURES LOCATED ON-SITE WILL BE REMOVED.

APPROVED: HOWARD COUNTY DEPARTMENT OF PLANNING & ZONING

REVIEWED FOR HOWARD COUNTY SOIL CONSERVATION DISTRICT AND MEETS TECHNICAL REQUIREMENTS.

THIS DEVELOPMENT IS APPROVED FOR SOIL EROSION AND SEDIMENT CONTROL BY THE HOWARD COUNTY SOIL CONSERVATION DISTRICT

[Signature] 1/22/07
CHIEF, DEVELOPMENT ENGINEERING DIVISION DATE

[Signature] DATE
U.S. SOIL CONSERVATION DISTRICT

[Signature] DATE
HOWARD COUNTY SOIL CONSERVATION DISTRICT

SEDIMENT CONTROL MEASURES WILL BE IMPLEMENTED IN ACCORDANCE WITH SECTION 219 OF THE SPECIFICATIONS AND WITH FINAL ROAD CONSTRUCTION PLAN SDP-06-036.

DEVELOPER
DORSEY CROSSING, LLC
P.O. BOX 417
ELLICOTT CITY, MD 21041-0417

APPROVED: HOWARD COUNTY DEPARTMENT OF PUBLIC WORKS

[Signature] 1-2-07
CHIEF, BUREAU OF UTILITIES DATE

ROBERT H. VOGEL ENGINEERING, INC.
ENGINEERS • SURVEYORS • PLANNERS
8407 MAIN STREET ELLICOTT CITY, MD 21043 TEL: 410.461.7666 FAX: 410.461.8961

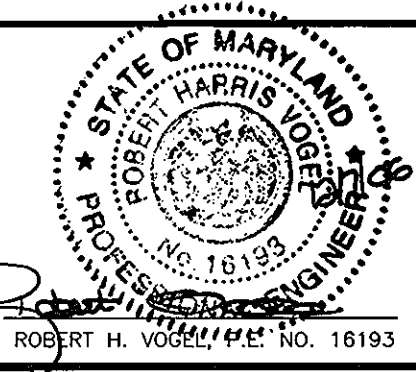

| | | | | | |
|------------------|----|----|----------|------|--|
| DESIGN BY: MY/RJ | | | | | |
| DRAWN BY: MY/RJ | | | | | |
| CHECKED BY: RHV | | | | | |
| DATE: DEC. 2006 | BY | NO | REVISION | DATE | |

PUBLIC FINAL WATER & SEWER MAIN EXTENSIONS

600' SCALE MAP NO. 30 BLOCK NO. 3

DORSEY CROSSING SINGLE FAMILY ATTACHED TOWNHOUSE CONDOMINIUM CONTRACT NO. 24-4366-D

REF:SDP-06-036 TAX MAP 30 BLOCK NO. 3 2ND ELECTION DISTRICT

PARCEL A HOWARD COUNTY, MARYLAND

SCALE AS SHOWN
SHEET 4 OF 5

WATER AS-BUILT DETAILS

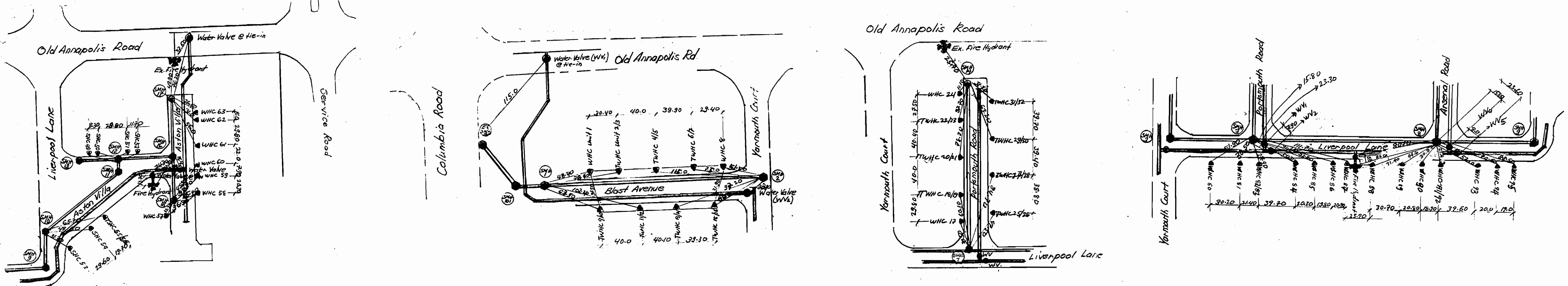

SEWER AS-BUILT DETAILS

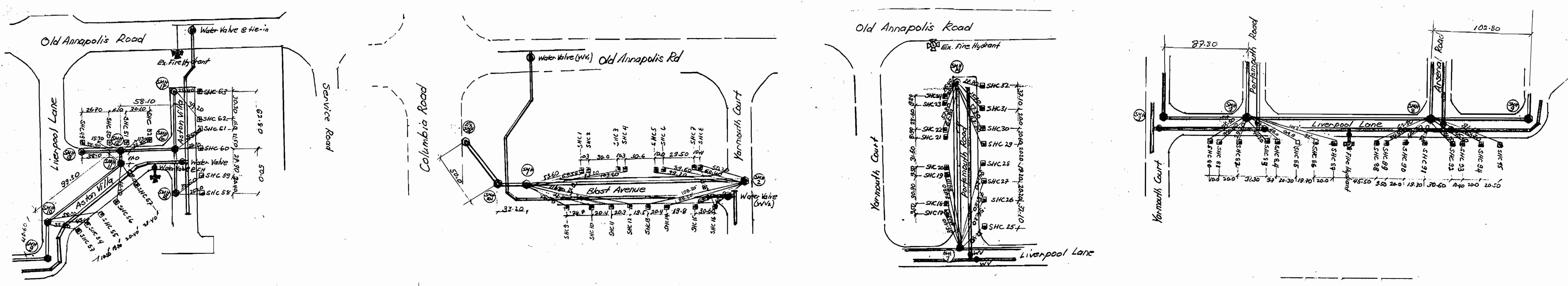

WATER AS-BUILT DETAILS

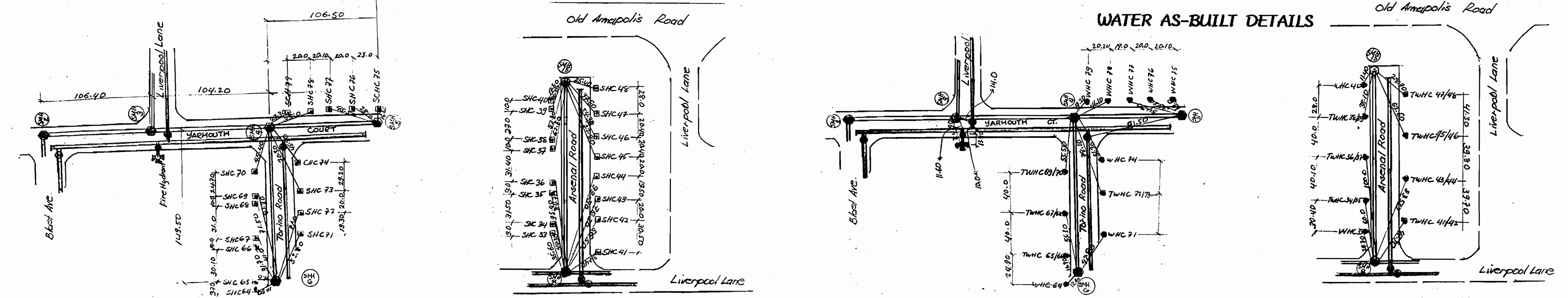

APPROVED: HOWARD COUNTY DEPARTMENT OF PUBLIC WORKS
 CHIEF BUREAU OF UTILITIES
 DATE

AS-BUILT WATER AND SEWER DETAILS ONLY
KCI TECHNOLOGIES, INC.
 10 NORTH PARK DRIVE
 HUNT VALLEY, MD 21030-1846

| | | | |
|-------------|----|------------------------------|----------|
| DESIGN BY: | | | |
| DRAWN BY: | | | |
| CHECKED BY: | | | |
| DATE: | | | |
| BY | NO | REVISION | DATE |
| KCI | 1 | AS-BUILT DATA SHOWN ON PLANS | 01/18/08 |

AS-BUILT FIELD REVISIONS
 600' SCALE MAP NO. 30
 BLOCK NO. 3

DORSEY CROSSING
 SINGLE FAMILY ATTACHED
 TOWNHOUSE/CONDOMINIUM
 CONTRACT NO. 24-4366-D
 REF:SDP-06-036
 TAX MAP 30 BLOCK NO. 3
 2ND ELECTION DISTRICT
 PARCEL A
 HOWARD COUNTY, MARYLAND

SCALE
 AS
 SHOWN
 SHEET
 5 OF 5