

GENERAL NOTES

PART I

- APPROXIMATE LOCATIONS OF EXISTING MAINS ARE SHOWN. THE CONTRACTOR SHALL TAKE ALL NECESSARY PRECAUTIONS TO PROTECT EXISTING MAINS AND SERVICES AND MAINTAIN UNINTERRUPTED SERVICE. ANY DAMAGE INCURRED SHALL BE REPAIRED IMMEDIATELY TO THE SATISFACTION OF THE ENGINEER AT THE CONTRACTOR'S EXPENSE.
- ALL HORIZONTAL CONTROLS ARE BASED ON MARYLAND STATE COORDINATES, NAD 83/91.
- ALL VERTICAL CONTROLS ARE BASED ON NAVD 88.
- ALL PIPE ELEVATIONS SHOWN ARE INVERT ELEVATIONS UNLESS OTHERWISE NOTED ON THE PLANS.
- CLEAR ALL UTILITIES BY A MINIMUM OF 12 INCHES. CLEAR ALL POLES BY 5'-0" MINIMUM OR TUNNEL AS REQUIRED UNLESS OTHERWISE NOTED. THE OWNER HAS CONTACTED THE UTILITY COMPANIES AND HAS MADE ARRANGEMENTS FOR BRACING OF POLES AS SHOWN ON THE DRAWINGS. IN THE EVENT THE CONTRACTOR'S WORK REQUIRES THE BRACING OF ADDITIONAL POLES, ANY COST INCURRED BY THE OWNER FOR THE BRACING OF ADDITIONAL POLES OR DAMAGES SHALL BE DEDUCTED FROM MONIES OWED THE CONTRACTOR. THE CONTRACTOR SHALL COORDINATE WITH THE UTILITY COMPANIES TO SCHEDULE THE BRACING OF THE POLES.
- FOR DETAILS NOT SHOWN ON THE DRAWING, AND FOR MATERIALS AND CONSTRUCTION METHODS, USE HOWARD COUNTY DESIGN MANUAL, VOLUME IV, STANDARD SPECIFICATIONS AND DETAILS FOR CONSTRUCTION (LATEST EDITION). THE CONTRACTOR SHALL HAVE A COPY OF VOLUME IV ON THE JOB.
- WHERE TEST PITS HAVE BEEN MADE ON EXISTING UTILITIES, THEY ARE NOTED BY THE SYMBOL AT THE LOCATIONS OF THE TEST PITS. A NOTE OR NOTES CONTAINING THE RESULTS OF THE TEST PIT OR PITS IS INCLUDED ON THE DRAWINGS. EXISTING UTILITIES IN THE VICINITY OF THE PROPOSED WORK FOR WHICH TEST PITS HAVE NOT BEEN DUG SHALL BE LOCATED BY THE CONTRACTOR TWO WEEKS IN ADVANCE OF CONSTRUCTION OPERATIONS AT HIS OWN EXPENSE.
- THE CONTRACTOR SHALL NOTIFY THE FOLLOWING UTILITY COMPANIES OR AGENCIES AT LEAST FIVE WORKING DAYS BEFORE STARTING WORK SHOWN ON THESE PLANS:

AT&T	1-800-252-1133
BGE (CONTRACTOR SERVICES)	410-850-4620
BGE (UNDERGROUND DAMAGE CONTROL)	410-787-9068
BUREAU OF UTILITIES	410-313-4900
COLONIAL PIPELINE CO	410-795-1390
MISS UTILITY	1-800-257-7777
STATE HIGHWAY ADMINISTRATION	410-531-5533
VERTIZON	1-800-743-003/410-224-9210
- TREES AND SHRUBS ARE TO BE PROTECTED FROM DAMAGE TO THE MAXIMUM EXTENT. TREES AND SHRUBS LOCATED WITHIN THE CONSTRUCTION STRIP ARE NOT TO BE REMOVED OR DAMAGED BY THE CONTRACTOR.
- THE CONTRACTOR SHALL REMOVE TREES, STUMPS AND ROOTS ALONG THE LINE OF EXCAVATION. PAYMENT FOR SUCH REMOVAL SHALL BE INCLUDED IN THE UNIT PRICE BID FOR CONSTRUCTION OF THE MAIN.
- THE CONTRACTOR SHALL NOTIFY THE BUREAU OF HIGHWAYS, HOWARD COUNTY, AT (410) 313-7450 AT LEAST FIVE WORKING DAYS BEFORE OPEN CUTTING OR BORING/JACKING OF ANY COUNTY ROAD FOR LAYING WATER/SEWER MAINS OR HOUSE CONNECTIONS. THE APPROVAL OF THESE DRAWINGS WILL CONSTITUTE COMPLIANCE WITH DPW REQUIREMENTS PER SECTION 18.114(g) OF THE HOWARD COUNTY CODE.

PART II WATER

- ALL WATER MAINS SHALL BE D.I.P. CLASS 52 UNLESS OTHERWISE NOTED.
- TOPS OF ALL WATER MAINS SHALL HAVE A MINIMUM OF 3'-6" OF COVER UNLESS OTHERWISE NOTED.
- VALVES ADJACENT TO TEES SHALL BE STRAPPED TO TEES.
- ALL FITTINGS SHALL BE BUTTRESSED OR ANCHORED WITH CONCRETE IN ACCORDANCE WITH STANDARD DETAILS UNLESS OTHERWISE PROVIDED FOR THE DRAWINGS.
- FIRE HYDRANTS SHALL BE SET TO THE BURY LINE ELEVATIONS SHOWN ON THE DRAWINGS. ALL FIRE HYDRANTS SHALL BE INSTALLED IN ACCORDANCE WITH STANDARD DETAILS. THE SOIL AROUND THE FIRE HYDRANT SHALL BE COMPACTED IN ACCORDANCE WITH SECTION 1000 AND SECTION 1005 OF THE STANDARD SPECIFICATIONS.
- THE CONTRACTOR SHALL NOT OPERATE ANY WATER MAIN VALVES ON THE EXISTING WATER SYSTEM.

PART III SEWER

- ALL SEWER MAINS SHALL BE D.I.P. OR P.V.C. UNLESS OTHERWISE NOTED.
- ALL MANHOLES SHALL BE 4'-0" INSIDE DIAMETER UNLESS OTHERWISE NOTED.
- FORCE MAINS SHALL BE D.I.P. ONLY.
- MANHOLES SHOWN WITH 12" AND 16" WALL ARE FOR BRICK MANHOLES ONLY.
- MANHOLES DESIGNATED W.T. IN PLAN AND PROFILE SHALL HAVE WATERTIGHT FRAME AND COVER. STANDARD DETAIL QS.52. WHERE WATERTIGHT MANHOLE FRAMES AND COVERS ARE USED, SET TOP OF FRAME 1'-6" ABOVE FINISHED GRADE UNLESS OTHERWISE NOTED ON THE DRAWINGS.
- HOUSE(S) WITH SYMBOL "C.N.S." INDICATES THAT THE CELLAR CANNOT BE SERVED.

TYPE OF BUILDING:	RESIDENTIAL
NO. OF LOTS/PARCELS:	1
NO. OF WATER HOUSE CONNECTIONS:	23
NO. OF SEWER HOUSE CONNECTIONS:	23
DRAINAGE AREA:	LITTLE PATUXENT
TREATMENT PLANT:	LITTLE PATUXENT

SEDIMENT CONTROL MEASURES WILL BE IMPLEMENTED IN ACCORDANCE WITH SECTION 219 OF THE SPECIFICATIONS AND WITH SITE DEVELOPMENT PLAN SDP-04-85.

THIS DEVELOPMENT IS APPROVED FOR SOIL EROSION AND SEDIMENT CONTROL BY THE HOWARD COUNTY SOIL CONSERVATION DISTRICT.

REVIEWED FOR HOWARD COUNTY SOIL CONSERVATION DISTRICT AND MEETS TECHNICAL REQUIREMENTS.

OWNER/DEVELOPER
 SK KING GEORGE, LLC.
 C/O WILLIAM KNOTT
 15 WEST AYLESBURY ROAD
 TIMONUM, MARYLAND 21093
 (410) 480-9105

DEPARTMENT OF PUBLIC WORKS
 HOWARD COUNTY, MARYLAND

DEPARTMENT OF PLANNING & ZONING
 HOWARD COUNTY, MARYLAND

ROBERT H. VOGEL ENGINEERING, INC.
 ENGINEERS • SURVEYORS • PLANNERS
 8407 MAIN STREET TEL: 410.461.7666
 ELLICOTT CITY, MD 21043 FAX: 410.461.8961

DES:	CMH				
DRN:	CMH				
CHK:	RHV				
DATE:	NOV. 2004	KCI	1	AS-BUILT DATA ADDED TO PLAN	11/18/09
		BY	NO.	REVISION	DATE

TITLE SHEET

600' SCALE MAP NO. 47
 BLOCK NO. 9

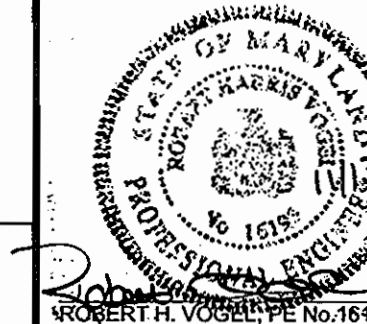

TAX MAP 47 BLOCK 6
 6TH ELECTION DISTRICT
 REF: SDP-04-85

MARY LANE
 AGE RESTRICTED COMMUNITY
 UNITS 1-22 AND COMMUNITY CENTER
 CONTRACT NO. 24-4215-D

PARCEL '665'
 HOWARD COUNTY, MARYLAND

SCALE AS SHOWN

SHEET 1 OF 2

MARY LANE

AGE RESTRICTED COMMUNITY

UNITS 1-22 AND COMMUNITY CENTER

HOWARD COUNTY, MARYLAND

CONTRACT NO. 24-4215-D

BENCHMARK NO. 1: COUNTY MONUMENT #47C4
 TYPICAL HOWARD COUNTY CONCRETE MONUMENT
 N 539,645.6687, E 1,361,379.3637
 ELEV. = 288.845
 BENCHMARK NO. 2: COUNTY MONUMENT #47R1
 TYPICAL HOWARD COUNTY CONCRETE MONUMENT
 N 539,734.5080, E 1,363,098.8714
 ELEV. = 282.440

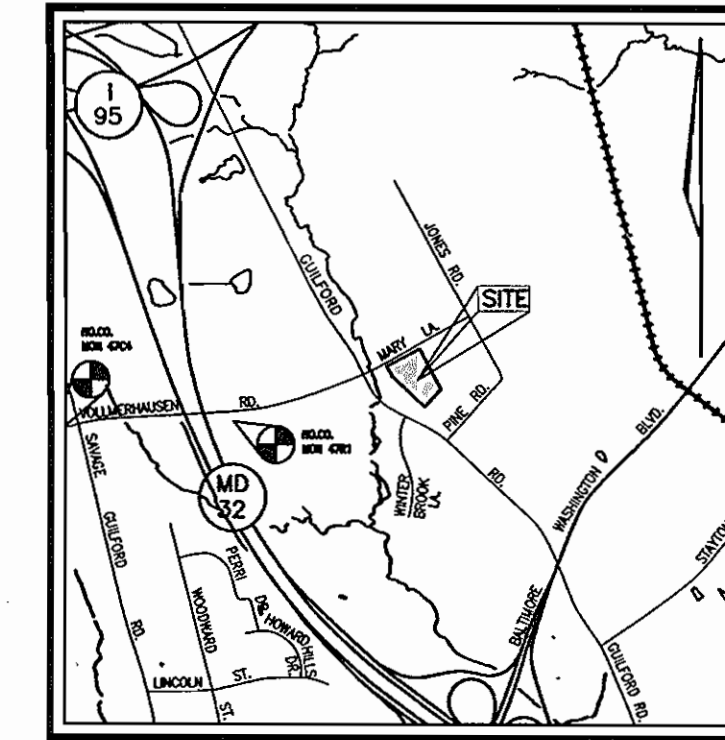

VICINITY MAP
 SCALE: 1"=2000'

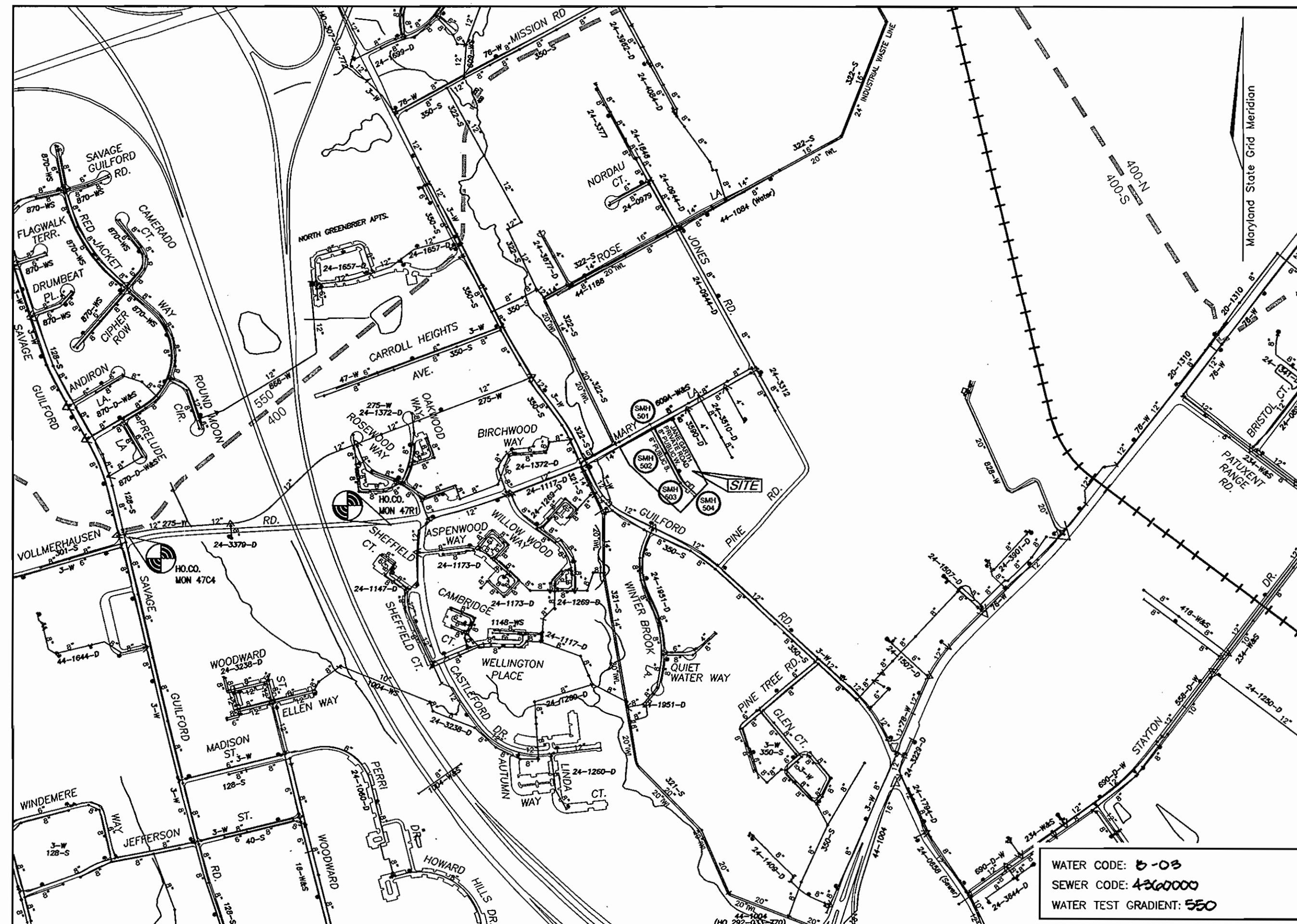

LOCATION PLAN
 SCALE: 1"=600'

WATER CODE: B-03
 SEWER CODE: 4360000
 WATER TEST GRADIENT: 550

QUANTITIES

NAME OF UTILITY CONTRACTOR:				
SURVEY AND DRAFTING DIVISION AS-BUILT DATE:				
ITEMS	QUANTITIES ESTIMATED	AS-BUILT		
		QUANTITIES	TYPE	MANUFACTURER/SUPPLIER
8" WATER (DIP)	472 LF	473	D.I.P.	U.S. PIPE / BR3
8"x8" TAPPING SLEEVE	1	1	8" R5VGR	MUELLER / BR3
8" VALVE	2	2	" "	MUELLER / BR3
8"x6" TEE	1	1	8"x6" TEE	U.S. PIPE / BR3
6" VALVE	1	1	G'GATE VAL	MUELLER CO./BR3
6" WATER (DIP)	12 LF	13	D.I.P.	U.S. PIPE / BR3
FIRE HYDRANT	1	1	EO"	MUELLER CO./BR3
8" CAP AND BUTTRESS	1	1	D.I.P.	U.S. PIPE / BR3
1" WHC	487 LF			
8" SEWER (PVC)	556 LF			
MANHOLE	4	4	48" PRECAST	ATLANTIC
4" SHC	475 LF			

SEWER MANHOLE SCHEDULE					
NO.	TYPE	LOCATION	TOP ELEV.	INV. IN	INV. OUT
SMH 501	STD. PRECAST MH HO. CO. STD. DET. G5.12	CL STA. -0+12.27-2.96' RT.	233.80	8"-224.90	8"-224.80
SMH 502	STD. PRECAST MH HO. CO. STD. DET. G5.12	CL STA. 2+00.31-6.79' RT.	236.61	8"-227.13	8"-227.03
SMH 503	STD. PRECAST MH HO. CO. STD. DET. G5.12	CL STA. 4+14.33-8.03' RT.	241.92	(2) 4"-234.76 8"-234.76	8"-221.09
SMH 504	STD. PRECAST MH HO. CO. STD. DET. G5.12	N 539906.22, E 1365080.88	245.60	-	8"-239.24

BENCHMARK NO. 1: COUNTY MONUMENT #47C4
TYPICAL HOWARD COUNTY CONCRETE MONUMENT
N 539,645.6687, E 1,361,379.3637
ELEV. = 288.845

BENCHMARK NO. 2: COUNTY MONUMENT #47R1
TYPICAL HOWARD COUNTY CONCRETE MONUMENT
N 539,734.5090, E 1,363,098.8714
ELEV. = 282.440

SEWER HOUSE CONNECTION SCHEDULE					
UNIT NO.	TYPE	MCE	CO INV. IN	CO INV. OUT	ELEV. @ MAIN
1	DHC	234.50	230.60	227.60	227.30
2	DHC	234.50	230.60	229.67	229.35
3	DHC	236.00	232.11	229.47	229.15
4	DHC	236.00	232.11	229.27	228.95
5	DHC	238.20	234.34	231.34	231.10
6	DHC	238.20	234.34	231.34	231.10
7	DHC	240.10	236.19	233.19	232.95
8	SHC	240.10	236.19	232.76	232.52
9	DHC	242.00	238.09	235.09	234.85
10	SHC	242.00	237.98	234.98	234.76
11	SHC	243.00	239.50	236.50	236.25
12	SHC	243.40	239.50	238.01	237.52
13	SHC	242.50	238.38	234.77	234.25
14	SHC	240.40	236.33	233.33	232.87
15	SHC	239.70	235.64	232.64	232.18
16	DHC	239.70	235.64	232.64	232.18
17	DHC	237.80	233.74	230.74	230.28
18	DHC	237.80	233.74	230.74	230.28
19	DHC	236.30	232.44	229.44	228.98
20	DHC	236.10	232.21	229.21	228.75
21	DHC	234.30	230.36	227.36	226.90
22	DHC	233.20	230.36	227.99	227.53
COMMUNITY CENTER	SHC	243.20	239.71	237.46	236.58



LOT #	FROM	TO	DIST.	REMARK
1	DHC 2	WHC 1	31	
1	WHC 22	WHC 1	41	
2	DHC 21	WHC 2	41	
2	DHC 2	WHC 2	27	
2	WHC 20	WHC 2	42	
2	DHC 4	WHC 3	20	
3	SH 502	WHC 4	17	
4	DHC 3	WHC 4	12	
5	WHC 18	WHC 5	40	
5	WHC 17	WHC 5	50	
6	WHC 16	WHC 6	43	
6	WHC 17	WHC 6	30	
7	WHC 15	WHC 7	51	
7	WHC 16	WHC 7	41	
8	F.H.	WHC 8	20	
8	8" VAL.	WHC 8	20	
9	8" VAL.	WHC 9	43	
9	DHC	WHC 9	11	
10	SMH 503	WHC 10	17	
10	SHC #	WHC 10	58	# COMM CTR. SHC.
11	SMH 504	WHC 11	27	
11	SMH 504	WHC 11	27	
12	SMH 504	WHC 12	46	
12	DHC 12	WHC 12	10	
12	WHC 12	WHC 12	10	
12	WHC 10	WHC 12	58	
13	SHC 10	WHC 13	20	
13	SMH 503	WHC 13	20	
14	8" VAL.	WHC 14	19	
14	F.H.	WHC 14	32	
15	F.H.	WHC 15	7	
15	FH VAL	WHC 15	12	
16	DHC 7	WHC 16	41	
16	WHC 6	WHC 16	43	
17	WHC 5	WHC 17	50	
17	WHC 6	WHC 17	20	
18	SMH 502	WHC 18	36	
18	WHC 5	WHC 18	40	
19	SMH 502	WHC 19	32	
19	WHC 20	WHC 19	43	
20	WHC 3	WHC 20	43	
20	WHC 12	WHC 20	43	
21	WHC 2	WHC 21	41	
21	DHC 20	WHC 21	18	
22	8" VAL.	WHC 22	35	
22	WHC 1	WHC 22	41	

CRIMP TABLE				
CRIMP	LENGTH	RADIUS	PC STA.	PT STA.
CR1	24.02	500.00	0+12.82	0+36.84
CR2	82.58	250.00	3+58.79	4+31.37

WATER MAIN LOCATION CHART				
CL ROAD	APPURTENANCE	OFFSET		
JANE GARTH				
CL ROAD 0+15	8"x8" TAPPING SLEEVE	8' LEFT		
CL ROAD 0+19	8" VALVE	8' LEFT		
CL ROAD 3+45	8"x6" TEE	7' LEFT		
CL ROAD 3+45	8" VALVE	10' LEFT		
CL ROAD 3+45	FIRE HYDRANT	19' LEFT		
CL ROAD 3+48	8" VALVE	7' LEFT		
CL ROAD 5+23	8" CAP & BUTRESS	7' LEFT		

LOT #	FROM	TO	DIST.	REMARK
1	DHC 22	DHC 1	44	
1	8"	DHC 1	46	
2	DHC 21	DHC 2	46	
2	WHC 21	DHC 2	31	
3	DHC 20	DHC 3	42	
3	WHC 2	DHC 3	27	
4	SMH 502	DHC 4	27	
4	WHC 3	DHC 4	20	
5	DHC 18	DHC 5	46	
5	DHC 17	DHC 5	54	
6	DHC 16	DHC 6	45	
6	DHC 17	DHC 6	40	
7	DHC 15	DHC 7	54	
7	DHC 16	DHC 7	45	
8	F.H.	DHC 8	41	
8	8" VAL.	DHC 8	20	
9	8" VAL.	DHC 9	26	
9	WHC 9	DHC 9	11	
10	SMH 503	DHC 10	13	
10	SHC 12	DHC 10	43	
11	SMH 503	DHC 11	20	
11	SMH 504	DHC 11	101	
12	SMH 504	DHC 12	56	
12	WHC 12	DHC 12	10	
12	WHC 10	DHC 12	58	
13	SHC 10	DHC 13	43	
13	SMH 503	DHC 13	32	
14	8" VAL.	DHC 14	25	
14	F.H.	DHC 14	22	
15	F.H.	DHC 15	17	
15	FH VAL	DHC 15	21	
16	DHC 7	DHC 16	45	
16	DHC 6	DHC 16	40	
17	DHC 5	DHC 17	45	
17	DHC 6	DHC 17	54	
18	SMH 502	DHC 18	34	
18	DHC 5	DHC 18	46	
19	SMH 502	DHC 19	35	
19	WHC 19	DHC 19	12	
20	DHC 3	DHC 20	42	
20	WHC 21	DHC 20	18	
21	WHC 22	DHC 21	35	
21	DHC 2	DHC 21	46	
22	8" VAL.	DHC 22	34	
22	DHC 1	DHC 22	44	

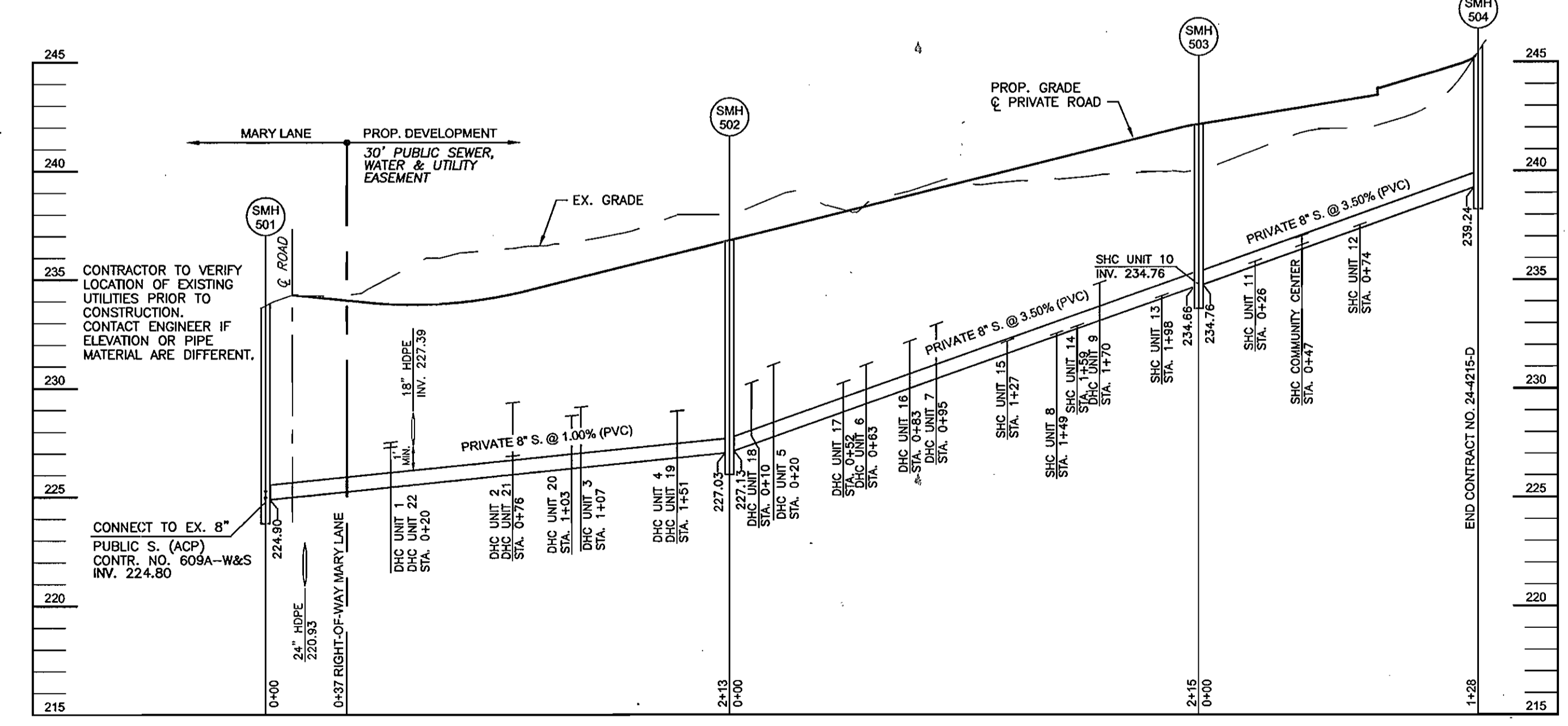

SEWER PROFILE
SCALE: HORIZ. 1"=50'
VERT. 1"=5'

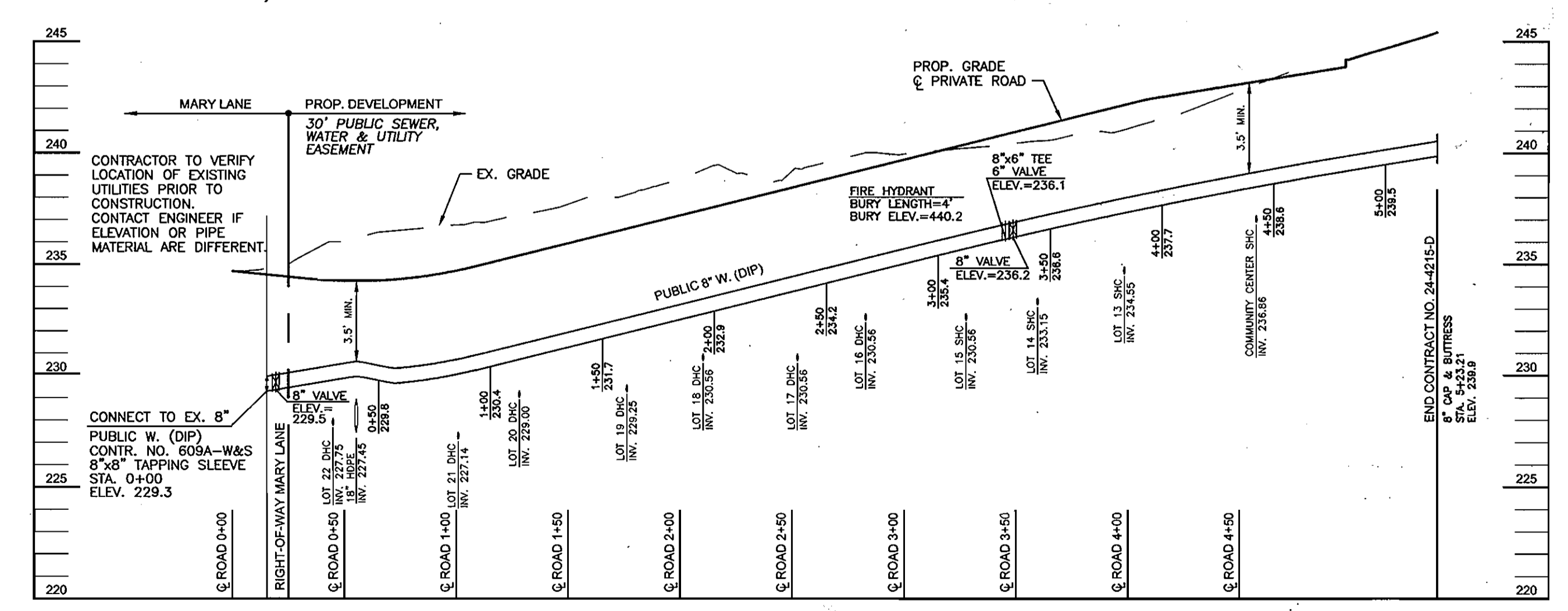

WATER PROFILE
SCALE: HORIZ. 1"=50'
VERT. 1"=5'

DEPARTMENT OF PUBLIC WORKS
HOWARD COUNTY, MARYLAND

Ruth Berman 12-6-04
CHIEF, BUREAU OF UTILITIES

DEPARTMENT OF PLANNING & ZONING
HOWARD COUNTY, MARYLAND

David Williams 12/15/04
CHIEF, DEVELOPMENT ENGINEERING DIVISION

ROBERT H. VOGEL ENGINEERING, INC.
ENGINEERS • SURVEYORS • PLANNERS
8407 MAIN STREET, ELLICOTT CITY, MD 21043
TEL: 410.461.7666 FAX: 410.461.8961

DES: CMH				
DRN: CMH				
CHK: RHV				
DATE: NOV. 2004	KCI: 1	ASBUILT DATA ADDED TO PLAN	NOV 18/08	
BY NO.		REVISION	DATE	

PLAN VIEW AND PROFILES

600' SCALE MAP NO. 47
BLOCK NO. 6

STATE OF MARYLAND
DEPARTMENT OF PUBLIC WORKS
HOWARD COUNTY

MARY LANE
AGE RESTRICTED COMMUNITY
UNITS 1-22 AND COMMUNITY CENTER
CONTRACT NO. 24-4215-D

TAX MAP 47 BLOCK 6
6TH ELECTION DISTRICT
REF.: SDP-04-85

PARCEL '665'
HOWARD COUNTY, MARYLAND

SCALE AS SHOWN

SHEET 2 OF 2