

PLAN
SCALE: 1" = 50'
(VARIABLE WIDTH R/W MSHA PLAT NO. 53340, 53341)

TRAVERSE COORDINATE SCHEDULE			
LOCATION	NORTHING	EASTING	ELEVATION
TRV1/GSC 38AA	561158.78	1389726.39	220.03
TRV3	561612.83	1390162.91	189.21
TRV4	561482.029	1389951.74	199.24
TRV5	561762.96	1390321.27	185.18

WATERMAIN STAKEOUT COORDINATE SCHEDULE			
STATION	FITTING	NORTHING	EASTING
0+02	12" CAP	561200.77	1389588.92
0+04	12" VALVE	561199.86	1389587.14
0+06	12" 45° HB	561202.57	1389586.17
0+08	12" 45° HB	561201.68	1389590.70
0+07	12"X12" CROSS	561204.77	1389597.25
0+16	12"X8" REDUCER	561208.58	1389605.40
0+73	8" 22 1/2° HB	561232.73	1389656.76
+0+4	8" 45° HB	561234.15	1389687.28
+1+91	PC	561297.47	1389747.85
3+69	PT/8" 45° HB	561418.33	1389877.82
3+78	8" 22 1/2° VB	561417.02	1389886.72
3+83	8" 22 1/2° VB	561416.32	1389891.51
3+95	8" 45° HB	561414.49	1389904.05
4+45	8" 11/4" HB	561444.32	1389944.12
5+37	8"X6" FH TEE	561511.40	1390004.70
5+37	22" LT. FH	561526.31	1389988.73
6+59	8" HD COUPLING	561602.78	1390087.21
8+51	8" 45° HB	561742.62	1390218.61
8+89	8" 45° HB	561780.41	1390216.68
9+94	8" VALVE	561856.44	1390289.53
10+61	8"X6" FH TEE	561905.44	1390335.22
10+61	11" LT. FH	561912.94	1390327.18
10+72	8" CAP	561912.54	1390343.23

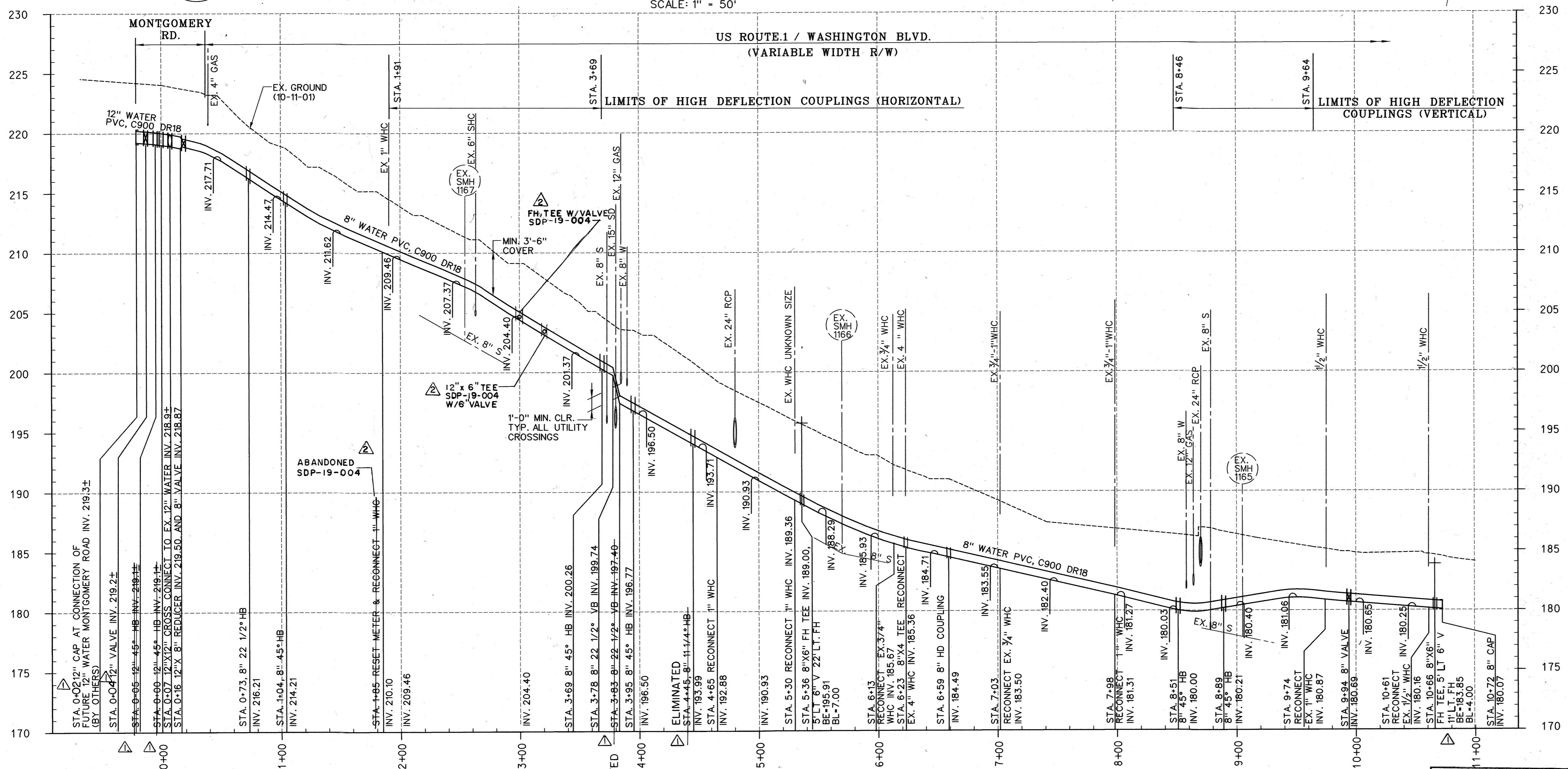

PROFILE
SCALE: HORIZONTAL 1" = 50'
VERTICAL 1" = 5'

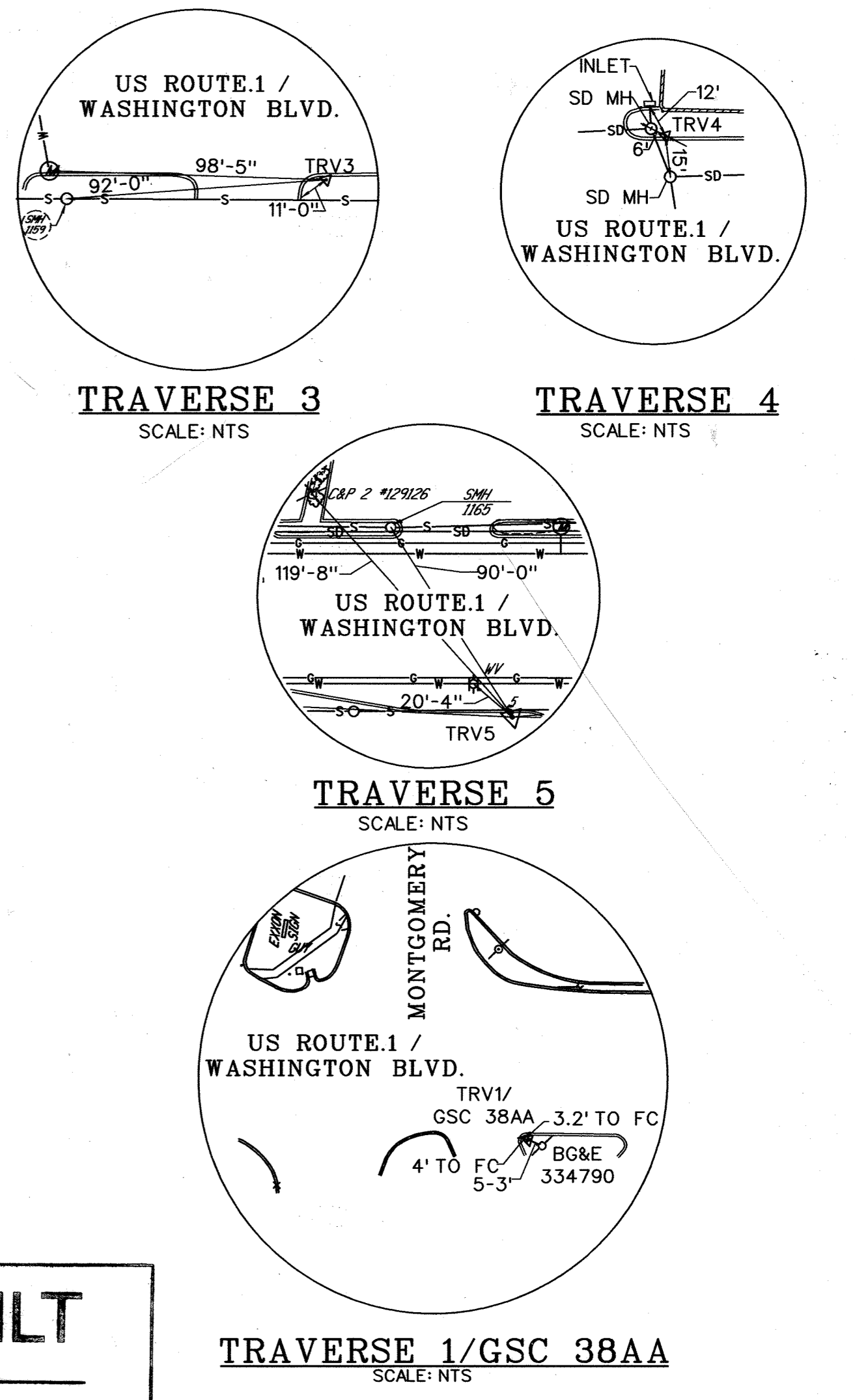

AS-BUILT
DATE 9-25-07

PLOT: 09:31 AM on Tuesday, January 03, 2006
FILE: M:\1999\092818020\Drawings\New_C01.dwg

DEPARTMENT OF PUBLIC WORKS
HOWARD COUNTY, MARYLAND

[Signature] 1/6/06
DIRECTOR OF PUBLIC WORKS
DATE

[Signature] 1-6-06
CHIEF, BUREAU OF UTILITIES
DATE

[Signature] 1/5/06
CHIEF, BUREAU OF ENGINEERING
DATE

[Signature] 1-5-06
CHIEF, UTILITY DESIGN DIVISION
DATE

ENGINEERS
PLANNERS
SCIENTISTS
CONSTRUCTION MANAGERS

KCI
TECHNOLOGIES

10 NORTH PARK DRIVE
HUNT VALLEY, MD 21030
PHONE: (410) 316-7800
FAX: (410) 316-7817
www.kci.com

DES: GW
DRN: KJ
CHK: TW

DATE: 12/05

BY	NO.	REVISION	DATE
WRA	1	AS BUILT	11/05/02
LN	2	AS BUILT	9-25-07

8" WATER MAIN
PLAN AND PROFILE
STA. 0+00 TO STA. 10+50

600' SCALE MAP NO. 38 BLOCK NO. 27-37

US ROUTE 1
WATER MAIN REPLACEMENT
CAPITAL PROJECT No. W-8205
CONTRACT No. 44-4019

ELECTION DISTRICT NO.1 HOWARD COUNTY, MARYLAND

SCALE AS SHOWN
SHEET 2 OF 3

FILE NAME: M:\1999\092818020\Drawings\New_C01.dwg

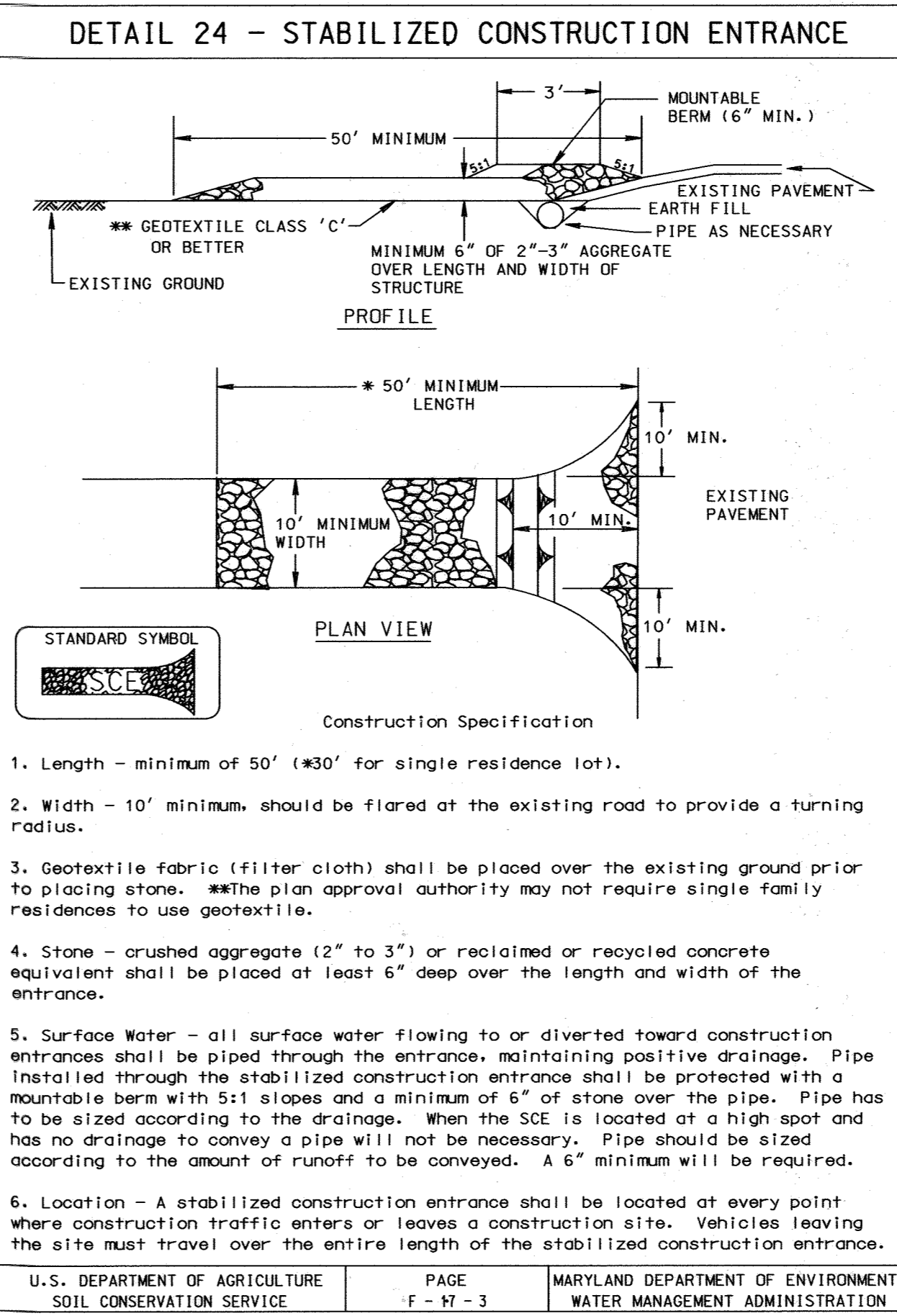
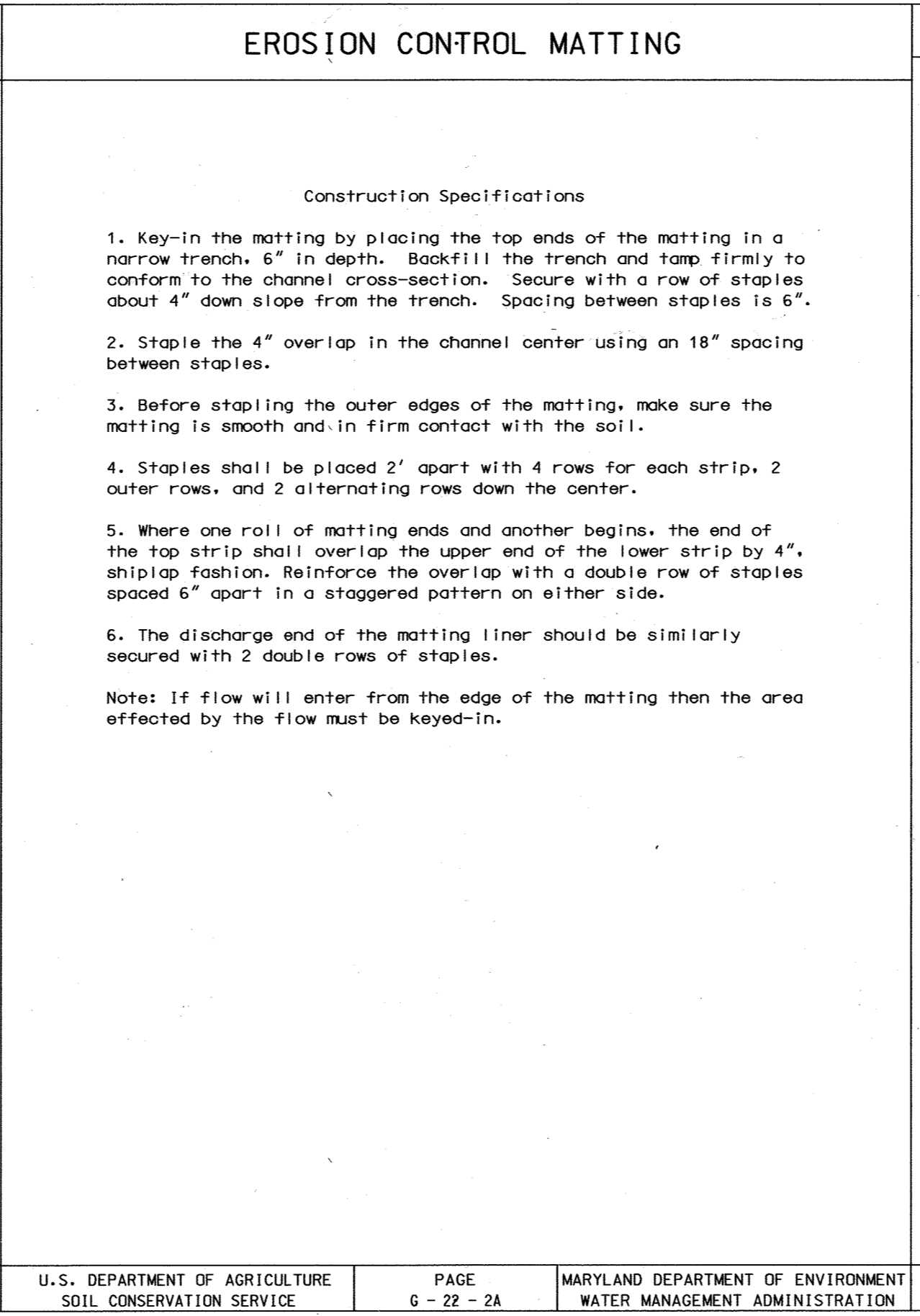
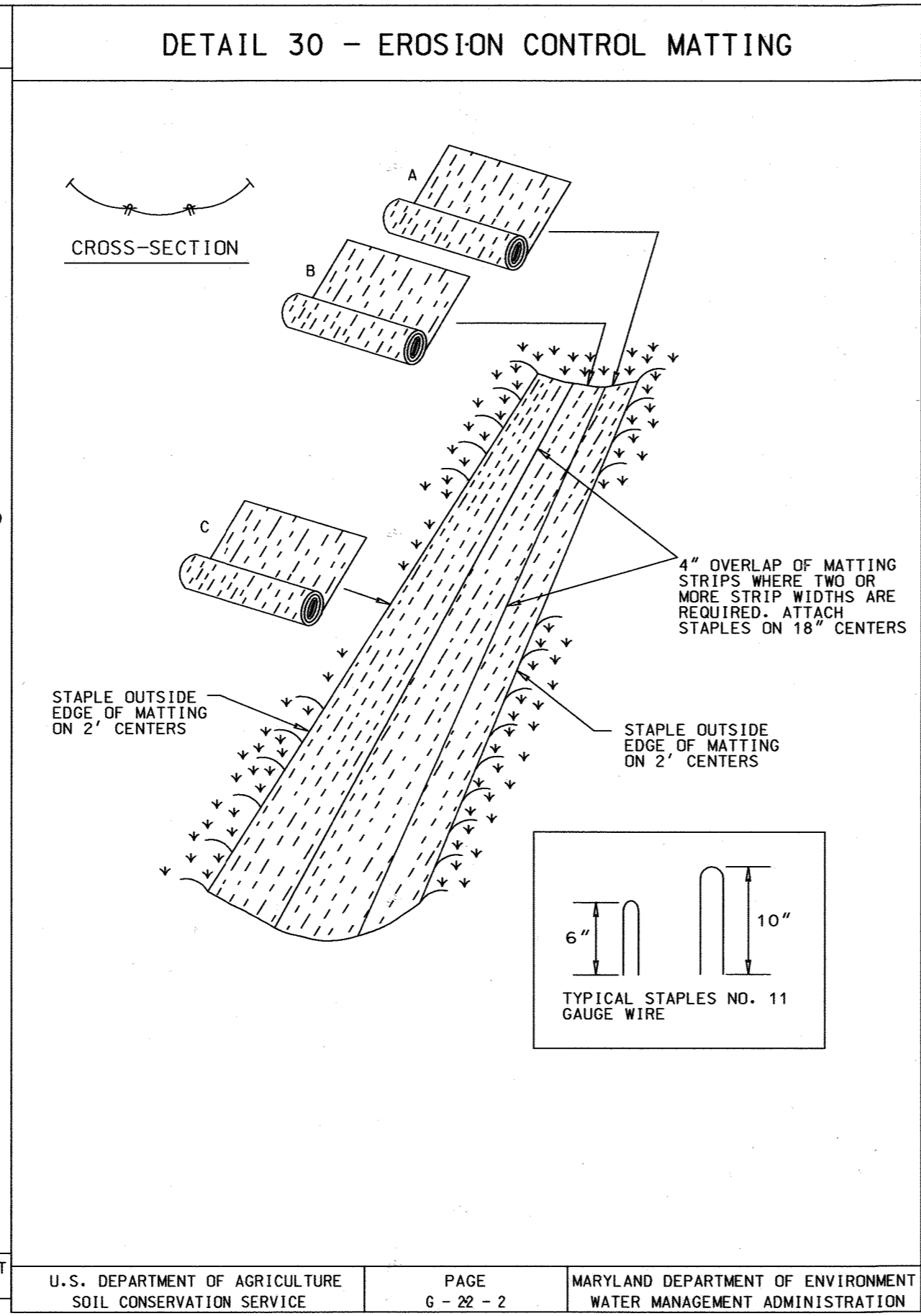
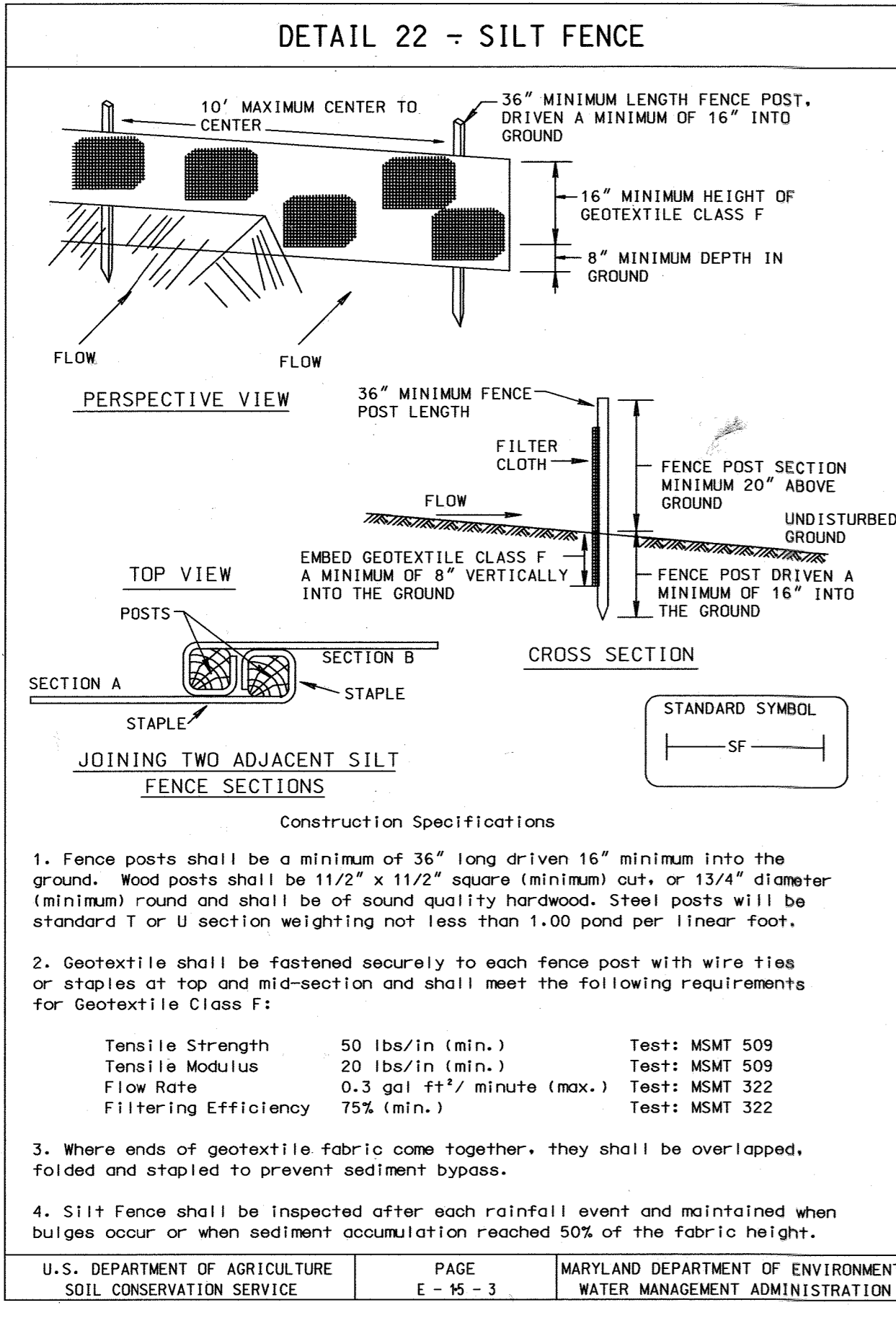

STANDARD SEDIMENT CONTROL NOTES

- A MINIMUM OF 48 HOURS NOTICE MUST BE GIVEN TO THE HOWARD COUNTY DEPARTMENT OF INSPECTIONS, LICENSES AND PERMITS, SEDIMENT CONTROL DIVISION PRIOR TO THE START OF ANY CONSTRUCTION. (313-1855).
- ALL VEGETATIVE AND STRUCTURAL PRACTICES ARE TO BE INSTALLED ACCORDING TO THE PROVISIONS OF THIS PLAN AND ARE TO BE IN CONFORMANCE WITH THE MOST CURRENT MARYLAND STANDARDS AND SPECIFICATIONS FOR SOIL EROSION AND SEDIMENT CONTROL, AND REVISIONS THEREOF.
- FOLLOWING INITIAL SOIL DISTURBANCE OR REDISTURBANCE, PERMANENT OR TEMPORARY STABILIZATION SHALL BE COMPLETED WITHIN:
 - 7 CALENDAR DAYS FOR ALL PERIMETER SEDIMENT CONTROL STRUCTURES, DIKES, PERIMETER SLOPES AND ALL SLOPES GREATER THAN 3:1.
 - 14 DAYS AS TO ALL OTHER DISTURBED OR GRADED AREAS ON THE PROJECT SITE.
- ALL SEDIMENT TRAPS/BASINS SHOWN MUST BE FENCED AND WARNING SIGNS POSTED AROUND THEIR PERIMETER IN ACCORDANCE WITH VOL. I, CHAPTER 12, OF THE HOWARD COUNTY DESIGN MANUAL, STORM DRAINAGE.
- ALL DISTURBED AREAS MUST BE STABILIZED WITHIN THE TIME PERIOD SPECIFIED ABOVE IN ACCORDANCE WITH THE 1994 MARYLAND STANDARDS AND SPECIFICATIONS FOR SOIL EROSION AND SEDIMENT CONTROL (SEC. G20.0) FOR PERMANENT SEEDINGS, SOD, TEMPORARY SEEDING AND MULCHING. TEMPORARY STABILIZATION WITH MULCH ALONE CAN ONLY BE DONE WHEN RECOMMENDED SEEDING DATES DO NOT ALLOW FOR PROPER GERMINATION AND ESTABLISHMENT OF GRASSES.
- ALL SEDIMENT CONTROL STRUCTURES ARE TO REMAIN IN PLACE AND ARE TO BE MAINTAINED IN OPERATIVE CONDITION UNTIL PERMISSION FOR THEIR REMOVAL HAS BEEN OBTAINED FROM THE HOWARD COUNTY SEDIMENT CONTROL INSPECTOR.
- SITE ANALYSIS:

TOTAL AREA OF SITE	N/A	ACRES
AREA DISTURBED	8.38	ACRES
AREA TO BE ROOFED OR PAVED	0.25	ACRES
AREA TO BE VEGETATIVELY STABILIZED	0.28	ACRES
TOTAL CUT	N/A	CU. YDS.
TOTAL FILL	N/A	CU. YDS.
OFFSITE WASTE/BORROW AREA LOCATION	N/A	
- ANY SEDIMENT CONTROL PRACTICE WHICH IS DISTURBED BY GRADING ACTIVITY FOR PLACEMENT OF UTILITIES MUST BE REPAIRED ON THE SAME DAY OF THE DISTURBANCE.
- ADDITIONAL SEDIMENT CONTROLS MUST BE PROVIDED, IF DEEMED NECESSARY BY THE HOWARD COUNTY SEDIMENT CONTROL INSPECTOR.
- ON ALL SITES WITH DISTURBED AREAS IN EXCESS OF 2 ACRES, APPROVAL OF THE INSPECTION AGENCY SHALL BE REQUESTED UPON COMPLETION OF INSTALLATION OF PERIMETER EROSION AND SEDIMENT CONTROLS, BUT BEFORE PROCEEDING WITH ANY OTHER EARTH DISTURBANCE OR GRADING. OTHER BUILDING OR GRADING INSPECTION APPROVALS MAY NOT BE AUTHORIZED UNTIL THIS INITIAL APPROVAL BY THE INSPECTION AGENCY IS MADE.
- TRENCHES FOR THE CONSTRUCTION OF UTILITIES IS LIMITED TO THREE (3) PIPE LENGTHS OR THAT WHICH CAN BE BACK FILLED AND STABILIZED WITHIN ONE WORKING DAY, WHICHEVER IS SHORTER.
- CONTRACTOR SHALL PLACE EXCAVATED MATERIALS ON UPHILL SIDE OF TRENCH AND PLACE SILT FENCE ON DOWNHILL SIDE OF TRENCH.

PERMANENT SEEDING NOTES

APPLY TO GRADED OR CLEARED AREAS NOT SUBJECT TO IMMEDIATE FURTHER DISTURBANCE WHERE A PERMANENT LONG-LIVED VEGETATIVE COVER IS NEEDED.

SEEDBED PREPARATION: LOOSEN UPPER THREE INCHES OF SOIL BY RAKING, DISKING OR OTHER ACCEPTABLE MEANS BEFORE SEEDING. IF NOT PREVIOUSLY LOOSENED.

SOIL AMENDMENTS: IN LIEU OF SOIL TEST RECOMMENDATIONS, USE ONE OF THE FOLLOWING SCHEDULES:

- PREFERRED - APPLY 2 TONS PER ACRES DOLOMITIC LIMESTONE (92 LBS/1000 SQ FT.) AND 600 LBS PER ACRE 18-10-10 FERTILIZER (14 LBS/1000 SQ FT.) BEFORE SEEDING. HARROW OR DISK INTO UPPER THREE INCHES OF SOIL. AT TIME OF SEEDING, APPLY 400 LBS PER ACRE 30-0-0 UREAFORM FERTILIZER (9 LBS/1000 SQ FT.).
- ACCEPTABLE - APPLY 2 TONS PER ACRES DOLOMITIC LIMESTONE (92 LBS/1000 SQ FT.) AND 1000 LBS PER ACRE 18-10-10 FERTILIZER (23 LBS/1000 SQ FT.) BEFORE SEEDING. HARROW OR DISK INTO UPPER THREE INCHES OF SOIL.

SEEDING - FOR THE PERIODS MARCH 1 THRU APRIL 30, AND AUGUST 1 THRU OCTOBER 15, SEED WITH 60 LBS PER ACRE (1.4 LBS/1000 SQ FT.) OF KENTUCKY 31 TALL FESCUE. FOR THE PERIOD MAY 1 THRU JULY 31, SEED WITH 60 LBS KENTUCKY 31 TALL FESCUE PER ACRE AND 2 LBS PER ACRE (.05 LBS/1000 SQ FT.) OF WEEPING LOVEGRASS. DURING THE PERIOD OF OCTOBER 16 THRU FEBRUARY 28, PROTECT SITE BY OPTION (1) 2 TONS PER ACRE OF WELL ANCHORED STRAW MULCH AND SEED AS SOON AS POSSIBLE IN THE SPRING. OPTION (2) USE SOD. OPTION (3) SEED WITH 60 LBS/ACRE KENTUCKY 31 TALL FESCUE AND MULCH WITH 2 TONS/ACRE WELL ANCHORED STRAW.

MULCHING - APPLY 1-1/2 TO 2 TONS PER ACRE (70 TO 90 LBS/1000 SQ FT.) OF UNROTTED SMALL GRAIN STRAW IMMEDIATELY AFTER SEEDING. ANCHOR MULCH IMMEDIATELY AFTER APPLICATION USING MULCH ANCHORING TOOL OR 210 GALLONS PER ACRE (5 GAL/1000 SQ FT.) OF EMULSIFIED ASPHALT ON FLAT AREAS. ON SLOPES 8 FEET OR HIGHER, USE 348 GALLONS PER ACRE (8 GAL/1000 SQ FT.) FOR ANCHORING.

MAINTENANCE - INSPECT ALL SEEDING AREAS AND MAKE NEEDED REPAIRS, REPLACEMENTS AND RESEEDINGS.

U.S. DEPARTMENT OF AGRICULTURE SOIL CONSERVATION SERVICE PAGE E-15-3 MARYLAND DEPARTMENT OF ENVIRONMENT WATER MANAGEMENT ADMINISTRATION

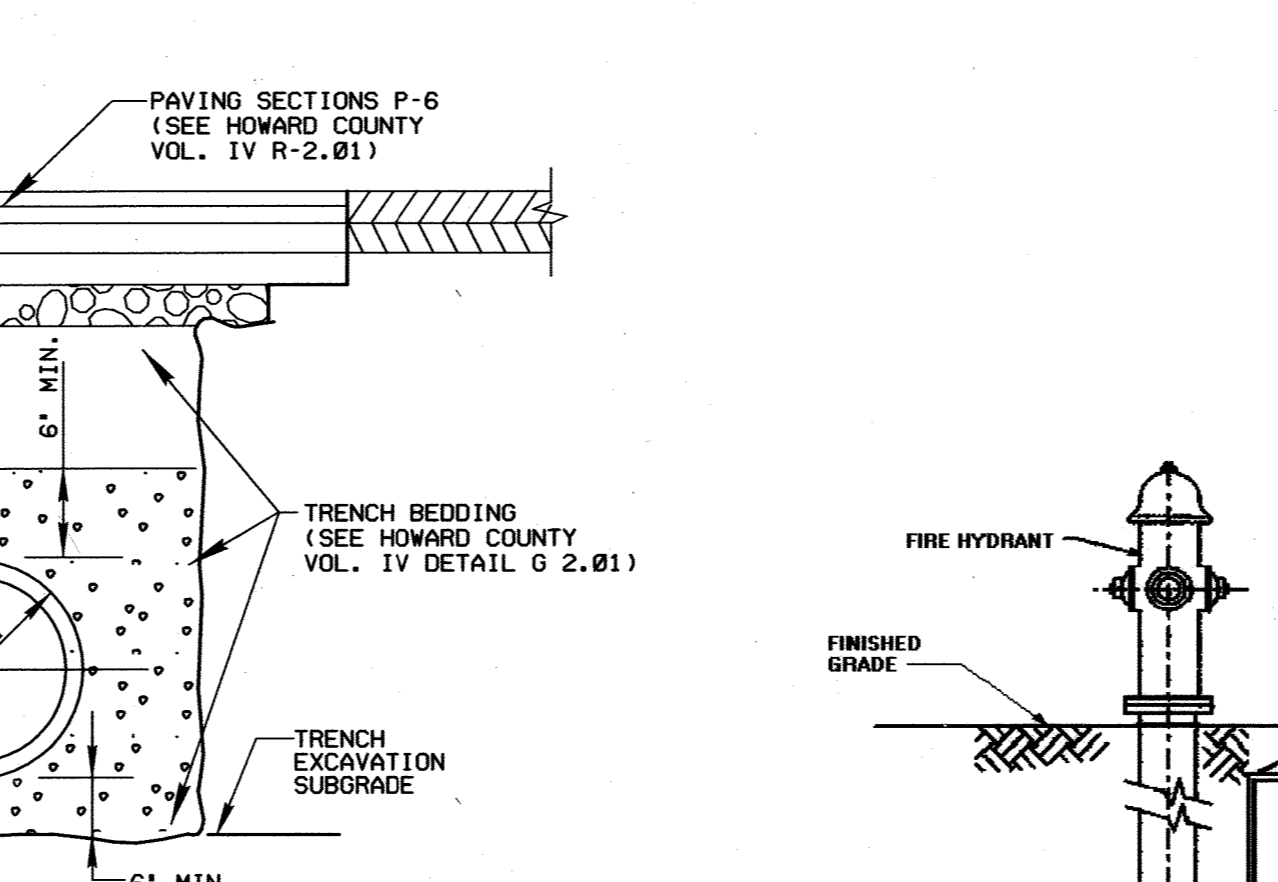
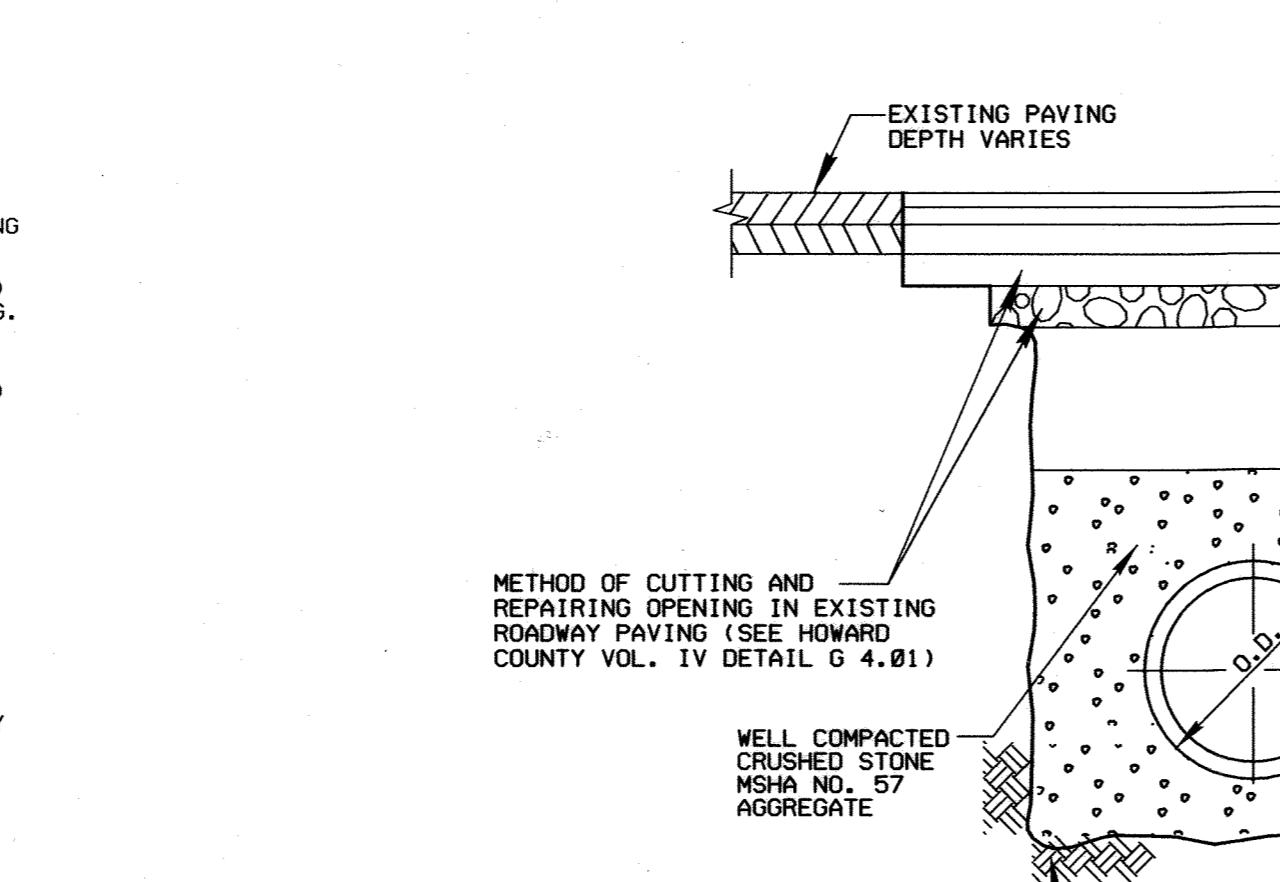

TEMPORARY SEEDING NOTES

APPLY TO GRADED OR CLEARED AREAS LIKELY TO BE REDISTURBED WHERE A SHORT-TERM VEGETATIVE COVER IS NEEDED.

SEEDBED PREPARATION: LOOSEN UPPER THREE INCHES OF SOIL BY RAKING, DISKING OR OTHER ACCEPTABLE MEANS BEFORE SEEDING. IF NOT PREVIOUSLY LOOSENED.

SOIL AMENDMENTS: - APPLY 600 LBS PER ACRE 18-10-10 FERTILIZER (14 LBS/1000 SQ FT.).

SEEDING - FOR PERIODS MARCH 1 THRU APRIL 30 AND FROM AUGUST 15 THRU OCTOBER 15, SEED WITH 2-1/2 BUSHEL PER ACRE OF ANNUAL RYE (3.2 LBS/1000 SQ FT.). FOR THE PERIOD MAY 1 THRU AUGUST 14, SEED WITH 3 LBS PER ACRE OF WEEPING LOVEGRASS (.07 LBS/1000 SQ FT.). FOR THE PERIOD NOVEMBER 16 THRU FEBRUARY 28, PROTECT SITE BY APPLYING 2 TONS PER ACRE OF WELL ANCHORED STRAW MULCH AND SEED AS SOON AS POSSIBLE IN THE SPRING, OR USE SOD.

MULCHING - APPLY 1-1/2 TO 2 TONS PER ACRE (70 TO 90 LBS/1000 SQ FT.) OF UNROTTED SMALL GRAIN STRAW IMMEDIATELY AFTER SEEDING. ANCHOR MULCH IMMEDIATELY AFTER APPLICATION USING MULCH ANCHORING TOOL OR 210 GALLONS PER ACRE (5 GAL/1000 SQ FT.) OF EMULSIFIED ASPHALT ON FLAT AREAS. ON SLOPES 8 FT OR HIGHER, USE 348 GAL PER ACRE (8 GAL/1000 SQ FT.) FOR ANCHORING.

REFER TO THE 1994 MARYLAND STANDARDS AND SPECIFICATIONS FOR SOIL EROSION AND SEDIMENT CONTROL FOR RATE AND METHODS NOT COVERED.

SEQUENCE OF CONSTRUCTION

- OBTAIN GRADING PERMIT.
- LAYOUT ALIGNMENT AT SITE. (3 DAYS)
- INSTALL SEDIMENT CONTROL DEVICES AS SHOWN ON PLAN.
- EXCAVATE DITCH TO THE GRADE SPECIFIED ON THE PROFILE. INSTALL WATER MAIN AND BACKFILL TRENCH AND RESURFACE WITH BITUMINOUS PAVING (30 DAYS) TRENCHES FOR THE CONSTRUCTION OF UTILITIES IS LIMITED TO 25' OF PIPE LENGTH OR THAT WHICH CAN BE BACK FILLED AND STABILIZED WITHIN ONE WORKING DAY, WHICHEVER IS SHORTER.
- CLEAN UP CONSTRUCTION SITE. (1 DAY)
- REMOVE SEDIMENT CONTROL DEVICES AFTER PERMISSION IS GRANTED BY THE SEDIMENT CONTROL INSPECTOR. (1 DAY)

TRAFFIC MAINTENANCE

FOR TRAFFIC MAINTENANCE REQUIREMENTS SEE SPECIFICATION DOCUMENT D, ITEM 15.

U.S. DEPARTMENT OF AGRICULTURE SOIL CONSERVATION SERVICE PAGE E-15-3 MARYLAND DEPARTMENT OF ENVIRONMENT WATER MANAGEMENT ADMINISTRATION

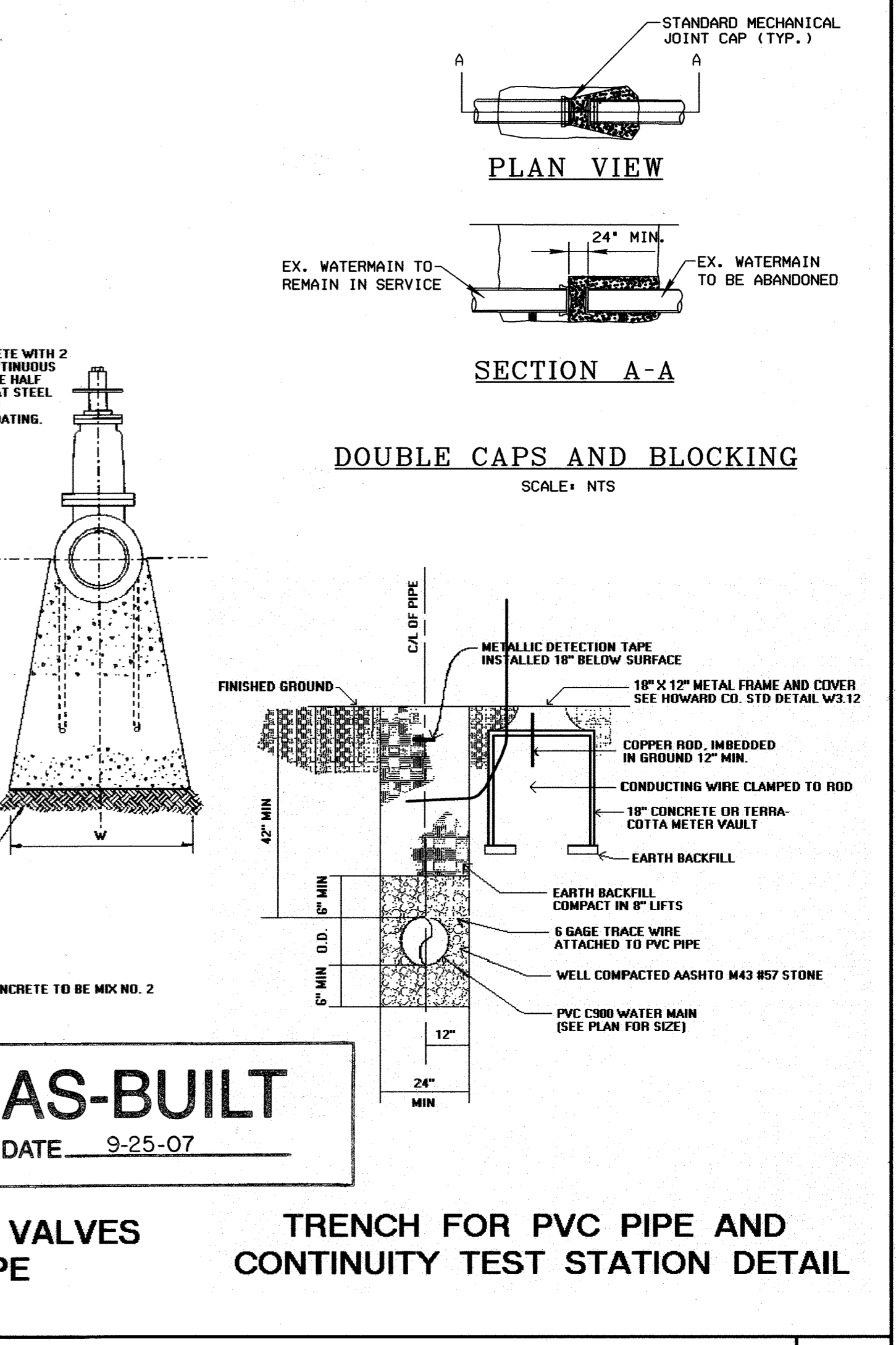
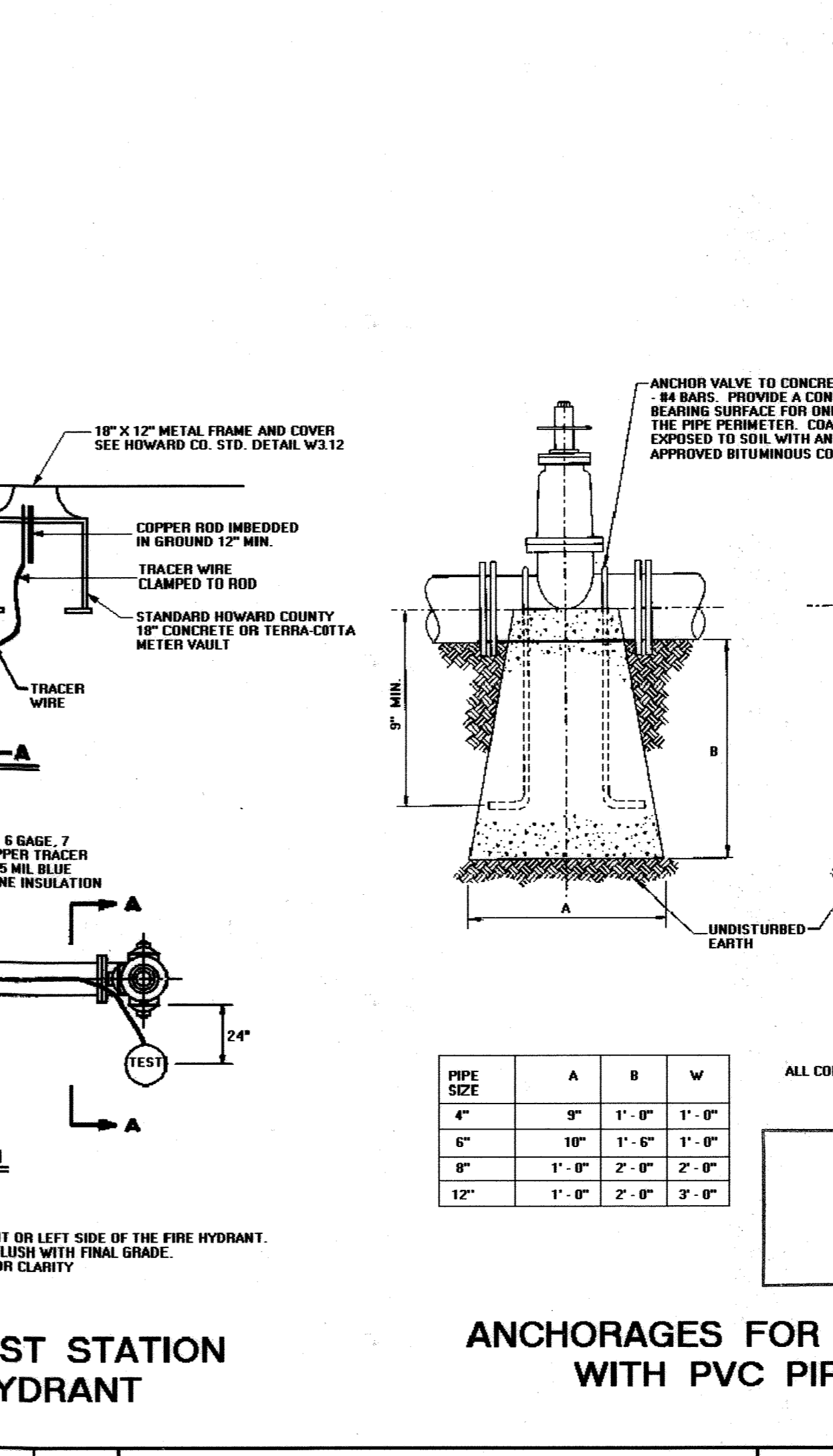
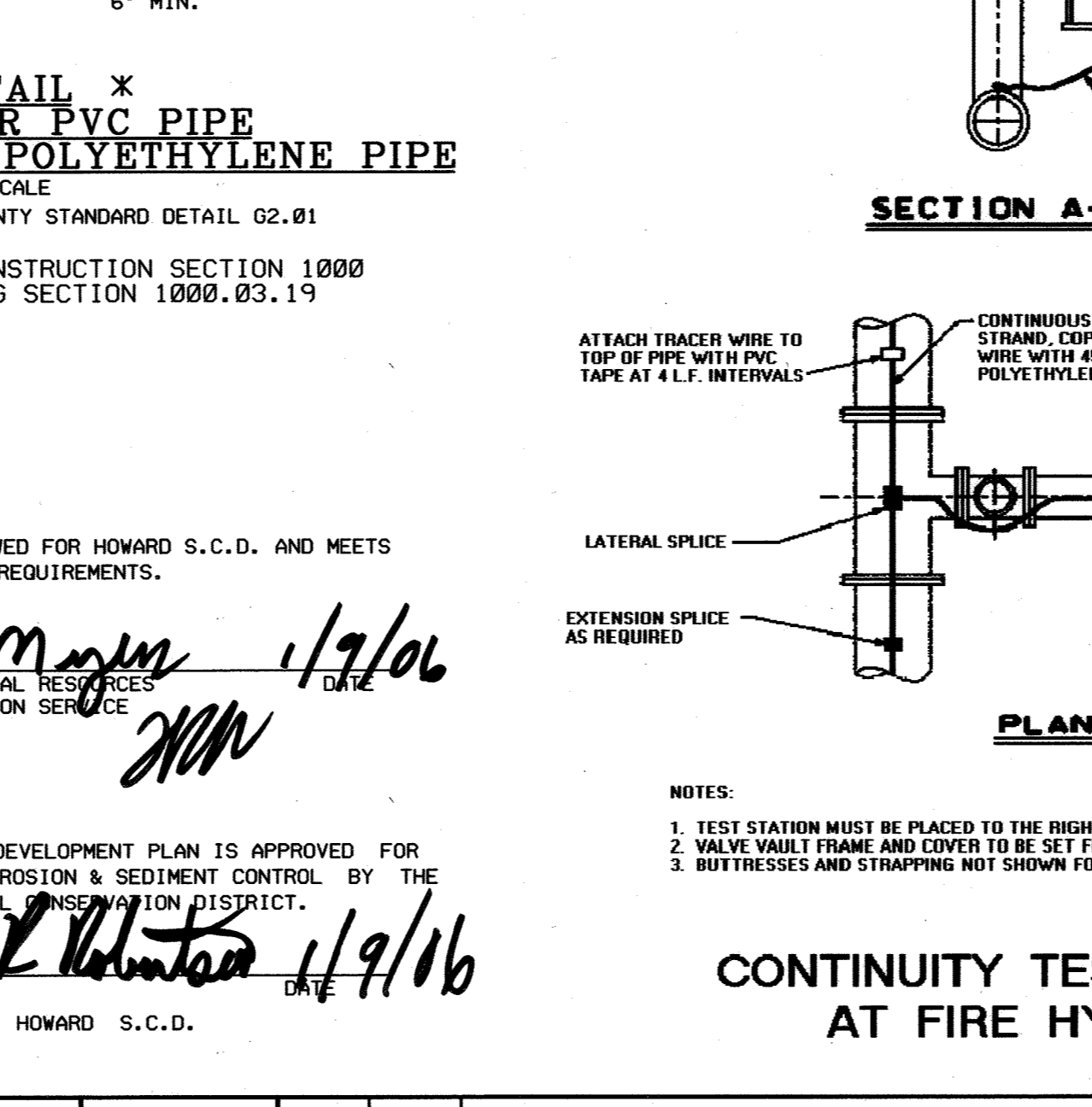
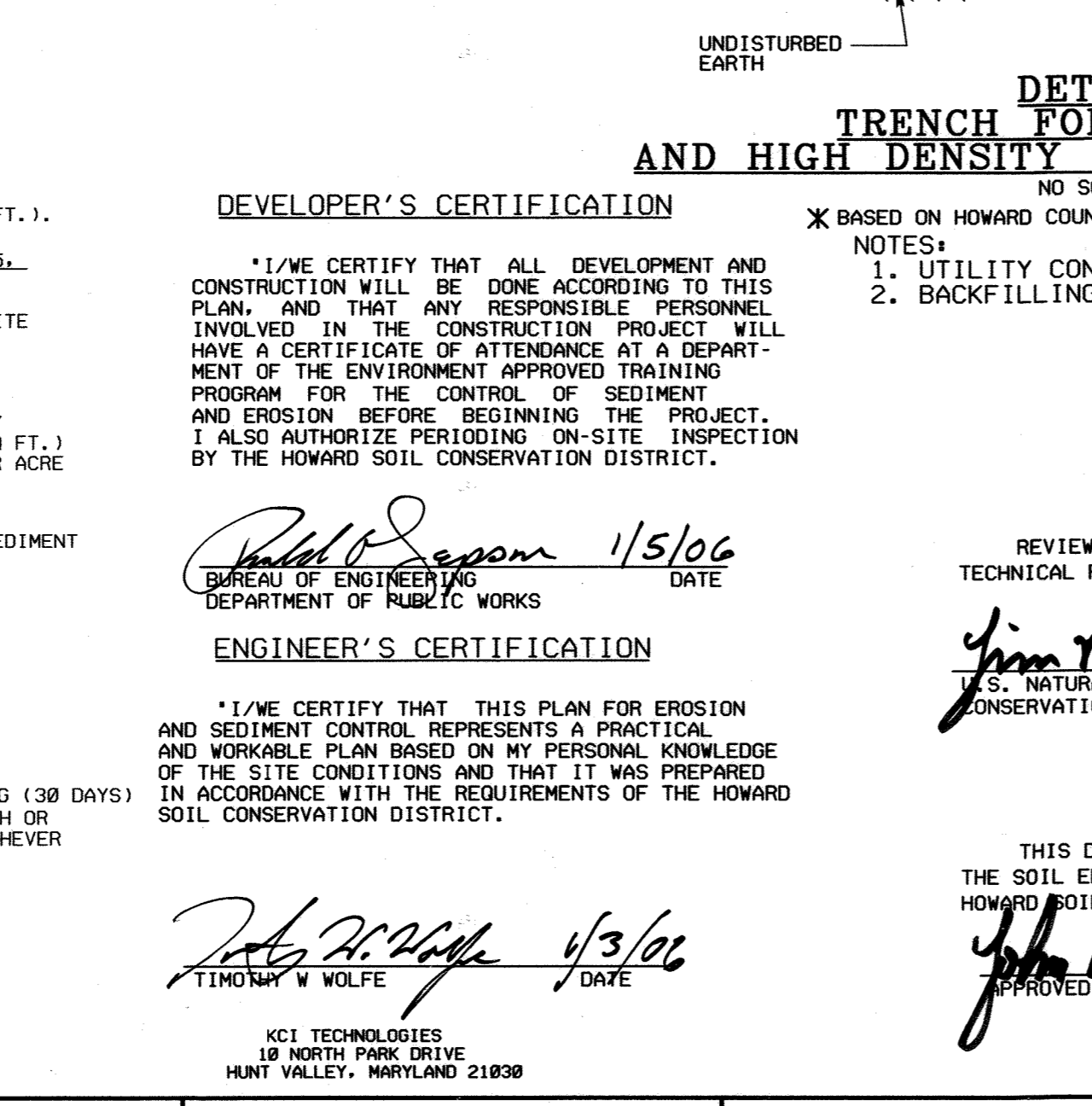

DEPARTMENT OF PUBLIC WORKS
HOWARD COUNTY, MARYLAND

James J. Smith, 1/6/06, DATE
DIRECTOR OF PUBLIC WORKS

Paul D. Eason, 1/5/06, DATE
CHIEF, BUREAU OF ENGINEERING

Paul D. Eason, 1-05-06, DATE
CHIEF, UTILITY DESIGN DIVISION

KCI TECHNOLOGIES
18 NORTH PARK DRIVE
HUNT VALLEY, MARYLAND 21083

ENGINEERS
PLANNERS
SCIENTISTS
CONSTRUCTION MANAGERS

Paul D. Eason, 1/3/06, DATE
CHIEF, UTILITY DESIGN DIVISION

DES: GW					
DRN: KJ					
CHK: TW					
DATE: 12/05	BY: NO.	REVISION	DATE	600' SCALE MAP NO. 38	BLOCK NO. 27-37

EROSION AND SEDIMENT CONTROL NOTES AND DETAILS

U.S. DEPARTMENT OF AGRICULTURE SOIL CONSERVATION SERVICE PAGE F-17-3 MARYLAND DEPARTMENT OF ENVIRONMENT WATER MANAGEMENT ADMINISTRATION

US ROUTE 1
WATER MAIN REPLACEMENT
CAPITAL PROJECT No. W-8205
CONTRACT No. 44-4019

ELECTION DISTRICT NO.1 HOWARD COUNTY, MARYLAND

SCALE AS SHOWN
SHEET 3 OF 3

PLotted: 10:40 AM on Tuesday, January 03, 2006
By: Kevin Jackson, Division: Environmental Engineering
File: M:\993\0918620\Drawings\sed1.dwg

FILE NAME: M:\993\0918620\Drawings\sed1.dwg