

# GENERAL NOTES

- Approximate location of existing mains are shown. The contractor shall take all necessary precautions to protect existing mains and services and maintain uninterrupted supply. Any damage incurred shall be repaired immediately to the satisfaction of the Engineer at the Contractor's expense.
- All horizontal controls are based on Maryland State Coordinates.
- All vertical controls are based on U.S.G.S. data.
- All pipe elevations shown are invert elevations.
- Clear all utilities by a minimum of 6". Clear all poles by 2'-0" minimum or tunnel as required. The owner has contacted the utility companies and has made arrangements for bracing of poles as shown on the drawings. In the event the contractor's work requires the bracing of additional poles, any cost incurred by the owner for bracing of additional poles or damages shall be deducted from money owed the contractor. The contractor shall coordinate with the utility companies to schedule the bracing of the poles.
- For details not shown on the drawings, and for materials and construction methods use Howard County Design Manual, Volume IV, Standard Specifications and Detail for Construction (Latest Edition). The contractor shall have a copy of Volume IV on the job.
- Where test pits have been made on existing utilities, they are noted by the symbol  at the location of the test pit. A note or notes containing the results of the test pit or pits is included on the drawings. Existing utilities in the vicinity of the proposed work for which test pits have not been dug shall be located by the contractor two weeks in advance of construction operations at his own expense.
- Contractor shall notify the following utility companies or agencies at least five working days before starting work shown on these plans:
 

State Highway Administration	531-5533
Baltimore Gas & Electric Co. Contractor Services	850-4520
Baltimore Gas & Electric Co. Underground Damage Control	787-9068
Miss Utility	1-800-257-7777
Colonial Pipeline Co.	795-1390
Bureau of Utilities, Howard County Department of Public Works	313-4900
- Contractor shall remove trees, stumps and roots along line of excavation. Payment for such removal shall be included in the unit price bid for construction of the main.
- All fill areas within future roadway and under structures to be compacted to a minimum of 95% compaction as determined by AASHTO T-180.
- Valves adjacent to tees shall be strapped to tees.
- All water mains to be D.I.P. Class 52 unless otherwise noted.
- Tops of all water mains to have a minimum of 3'-1/2' cover unless otherwise noted.
- All fittings shall be buttressed or anchored with concrete in accordance with the Standard Details unless otherwise provided for on the drawings.
- Fire hydrants shall be set to the bury line elevations shown on the drawings. All fire hydrants shall be restrained and buttressed with concrete in accordance with Standard Details. Soil around the fire hydrant shall be compacted in accordance with Section 1000 and 1005 of the Standard Specifications.
- The contractor shall notify the Bureau of Highways, Howard County, at (410) 313-2450 at least five working days before any open cut of any County road or boring/jacking operation in County roads for laying water/sewer mains or house connections. The approval of these drawings will constitute compliance with DPW requirements per Section 18.114(c) of the Howard County Code.
- The contractor shall not operate any water main valves on the existing water system.
- All water house connections shall be for inside meter setting unless otherwise noted on plans or in specifications.
- All sewer mains shall be D.I.P. or P.V.C., unless otherwise noted.
- All manholes shall be 4'-0" inside diameter unless otherwise noted.
- Manholes to be precast concrete structure.
- Manholes shown with 12" and 16" area are for brick manholes only.

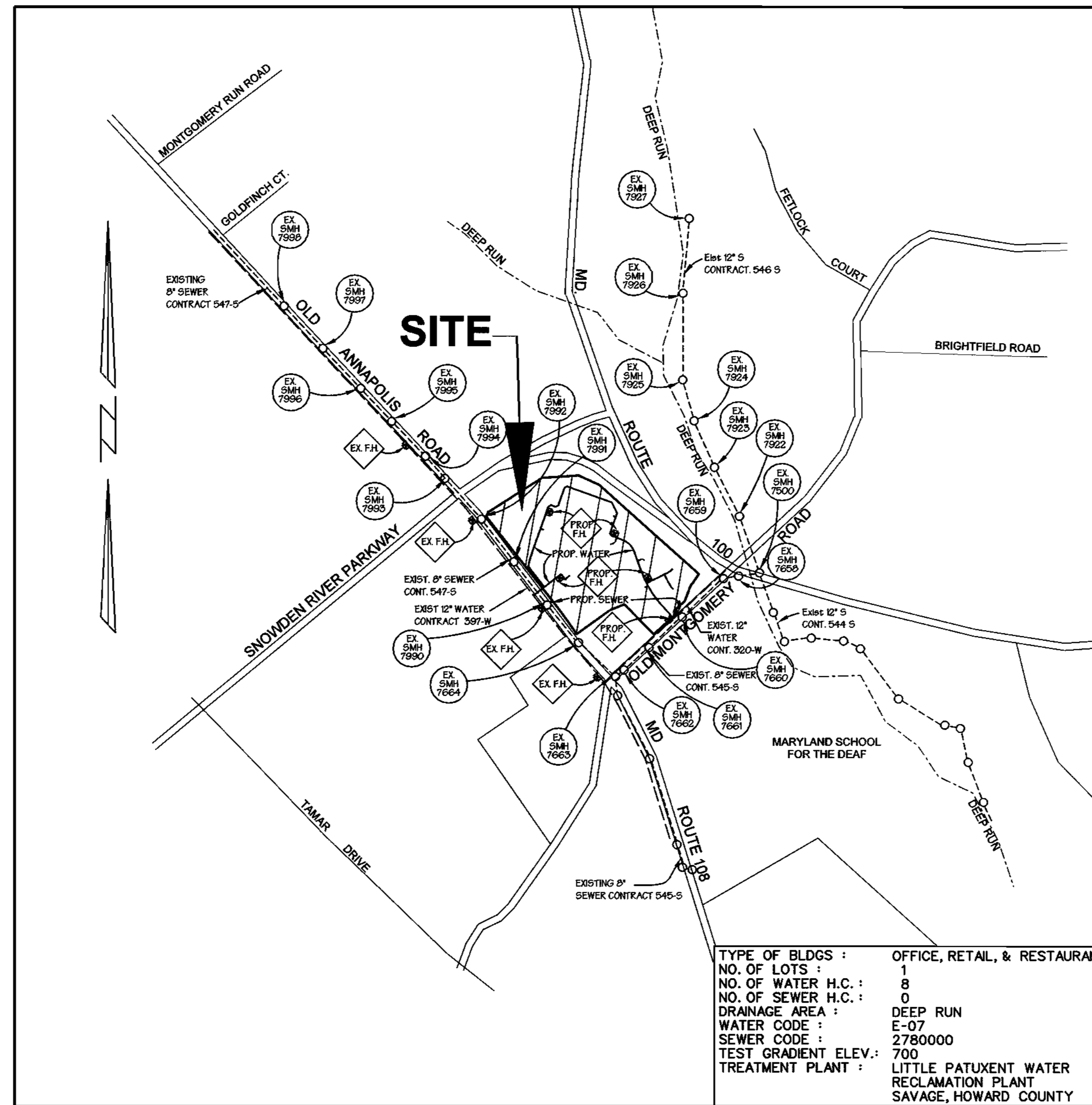

## LOCATION MAP

SCALE: 1" = 600'

## WATER & SEWER CONSTRUCTION PLANS THE HORSE FARM

1st ELECTION DISTRICT HOWARD COUNTY, MARYLAND

CONTRACT NO. 14-3768-D

## INDEX OF SHEETS

SHEET NO.	TITLES
1	COVER SHEET, GENERAL NOTES & LOCATION MAP
2	PLAN VIEW
3	PROFILES
4	PROFILES

## Benchmarks

Pt. #37A2, Aka - 2643002 - Howard Co. Geodetic Control  
 Northing : 562120.856  
 Easting : 1369300.289  
 NAD27 datum N 501371.9, E 856882.1  
 Elevation : 403.675'

Pt. #37A5, Aka - 2643003 - Howard Co. Geodetic Control  
 Northing : 561130.903  
 Easting : 1369913.306  
 NAD27 datum N 500361.9, E 857495.1  
 Elevation : 385.627'

## QUANTITIES

ITEMS	QUANTITIES ESTIMATED	AS-BUILT		
		QUANTITIES	TYPE	MANUFACTURER/ SUPPLIER
8" D.I.P. Water Main	2,495 L.F.			
6" D.I.P. Water Main	166 L.F.			
Fire Hydrants	5 Each			
8"X8" TEE	2 Each			
8"X6" TEE	12 Each			
8" Valve and Roadway Box	5 Each			
6" Valve and Roadway Box	11 Each			
8"X6" Reducer	1 Each			
Sanitary Manholes (G 5.01)	2 Each			
8" P.V.C. Sanitary Sewer	145 L.F.			
12" X 6" Tapping Sleeve and Valve	2 Each			

NAME OF UTILITY CONTRACTOR : \_\_\_\_\_  
 SURVEY AND DRAFTING DIVISION AS-BUILT DATE: \_\_\_\_\_

SEDIMENT CONTROL MEASURES FOR THIS CONTRACT WILL BE IMPLEMENTED IN ACCORDANCE WITH SECTION 219 OF THE STANDARD SPECIFICATIONS, SDP 99-65

THE DEVELOPMENT PLAN IS APPROVED FOR SOIL EROSION AND SEDIMENT CONTROL BY THE HOWARD SOIL CONSERVATION DISTRICT.

APPROVED:  6/23/99  
 HOWARD SOIL CONSERVATION DISTRICT DATE

REVIEWED FOR HOWARD SOIL CONSERVATION DISTRICT AND MEETS TECHNICAL REQUIREMENTS.

APPROVED:  6/23/99  
 U.S. SOIL CONSERVATION SERVICE DATE

DEVELOPER / CONTRACTOR / PURCHASER  
**HORSE FARM - LINDEN L.L.C.**  
 906 POPLAR HILL ROAD SUITE 200  
 BALTIMORE, MARYLAND, 21210  
 410 - 532 6250  
 OWNER  
 STATE OF MARYLAND BOARD OF REGENTS OF THE UNIVERSITY  
 OF MARYLAND DGS / OFFICE OF REAL ESTATE L. 153 F. 288  
 300 WEST PRESTON STREET ROOM 601  
 BALTIMORE, MARYLAND, 21201  
 410 - 767-4309

DEPARTMENT OF PUBLIC WORKS  
 HOWARD COUNTY, MARYLAND

DEPARTMENT OF PLANNING & ZONING  
 HOWARD COUNTY, MARYLAND



**GEORGE W. STEPHENS, JR.  
AND ASSOCIATES, INC.**  
 Civil Engineers and Land Surveyors  
 658 Kenilworth Drive, Suite 100  
 Towson Maryland 21204  
 (410) 825-8120



DESIGNED : PRC, KE  
 DRAFTED : KE  
 CHECKED : PRC

## COVER SHEET, GENERAL NOTES & LOCATION MAP

CONTRACT NO. 14-3768-D  
 600 SCALE MAP NO. 37

BLOCK NO. 8

## PUBLIC WATER & SEWER MAIN THE HORSE FARM CONTRACT NO. 14-3768-D

HOWARD COUNTY, MARYLAND  
 ELECTION DISTRICT #01

JANUARY 06, 1999  
 SHEET 1 OF 4

**MD. ROUTE 100**  
(UNDER CONSTRUCTION)  
PLATS 54190, 54191 & 54193

**OLD MONTGOMERY ROAD**

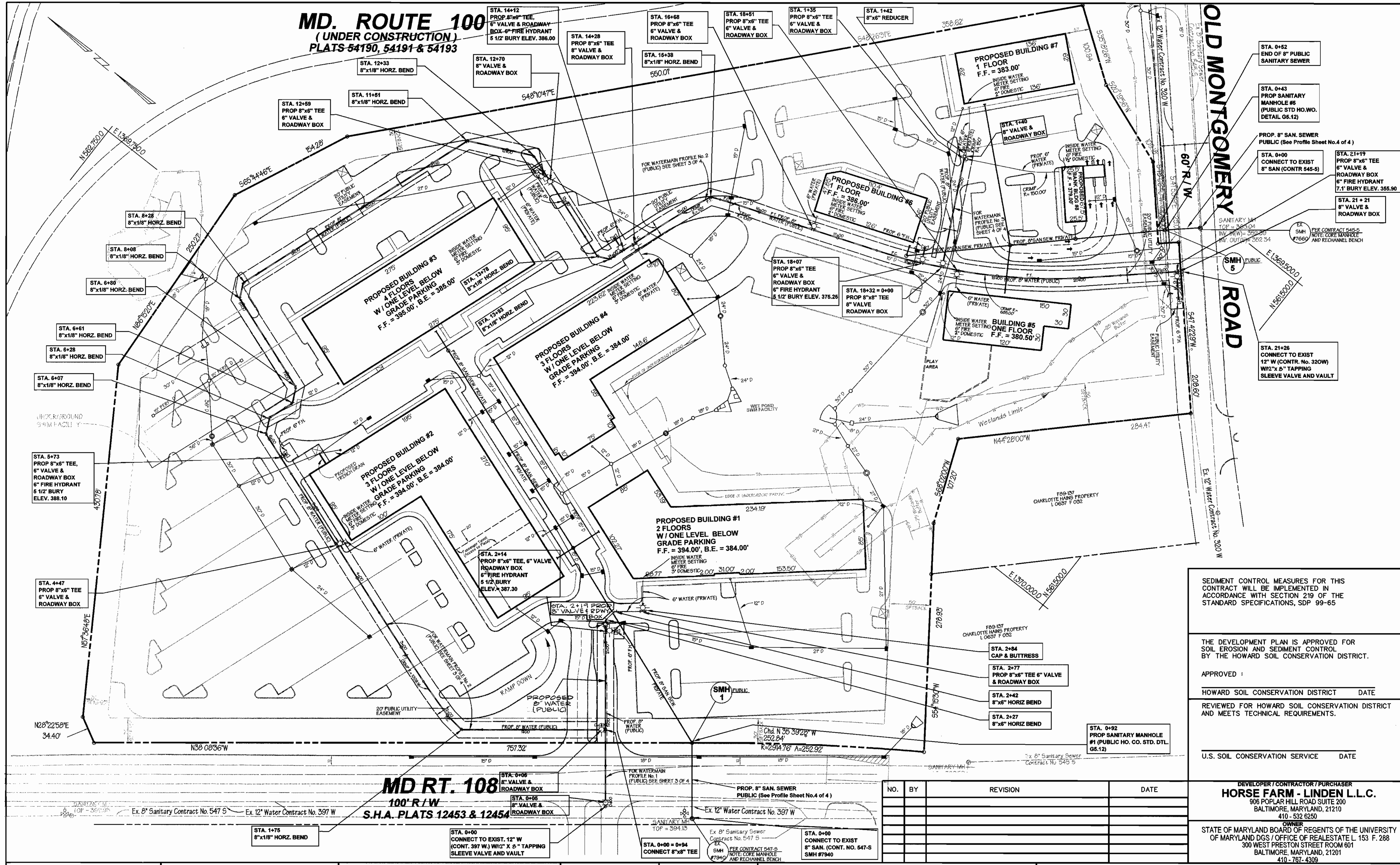

SEDIMENT CONTROL MEASURES FOR THIS CONTRACT WILL BE IMPLEMENTED IN ACCORDANCE WITH SECTION 219 OF THE STANDARD SPECIFICATIONS, SDP 99-65

THE DEVELOPMENT PLAN IS APPROVED FOR SOIL EROSION AND SEDIMENT CONTROL BY THE HOWARD SOIL CONSERVATION DISTRICT.

APPROVED :  
HOWARD SOIL CONSERVATION DISTRICT DATE  
REVIEWED FOR HOWARD SOIL CONSERVATION DISTRICT AND MEETS TECHNICAL REQUIREMENTS.

U.S. SOIL CONSERVATION SERVICE DATE

DEVELOPER / CONTRACTOR / PURCHASER  
**HORSE FARM - LINDEN L.L.C.**  
906 POPLAR HILL ROAD SUITE 200  
BALTIMORE, MARYLAND, 21210  
410 - 532 6250

OWNER  
STATE OF MARYLAND BOARD OF REGENTS OF THE UNIVERSITY OF MARYLAND  
300 WEST PRESTON STREET ROOM 601  
BALTIMORE, MARYLAND, 21201  
410 - 767-4309

NO.	BY	REVISION	DATE

DEPARTMENT OF PUBLIC WORKS  
HOWARD COUNTY, MARYLAND

*Nicholas J. ...*  
CHIEF, BUREAU OF UTILITIES DATE

DEPARTMENT OF PLANNING & ZONING  
HOWARD COUNTY, MARYLAND

*...*  
CHIEF, DEVELOPMENT ENGINEERING DIVISION DATE

**GWS**

**GEORGE W. STEPHENS, JR. AND ASSOCIATES, INC.**  
Civil Engineers and Land Surveyors  
658 Kenilworth Drive, Suite 100  
Towson Maryland 21204  
(410) 825-8120



DESIGNED : PRC, KE  
DRAFTED : P.T., K.E.  
CHECKED : PRC

**PLAN VIEW**

CONTRACT NO. 14-3768-D  
600 SCALE MAP NO. 37

**PUBLIC WATER & SEWER PLAN**  
**THE HORSE FARM**  
CONTRACT NO. 14-3768-D

ELECTION DISTRICT #1  
HOWARD COUNTY, MARYLAND

JANUARY 06, 1999  
SHEET 2 OF 4

P/N 8594 - waterplan1.s1

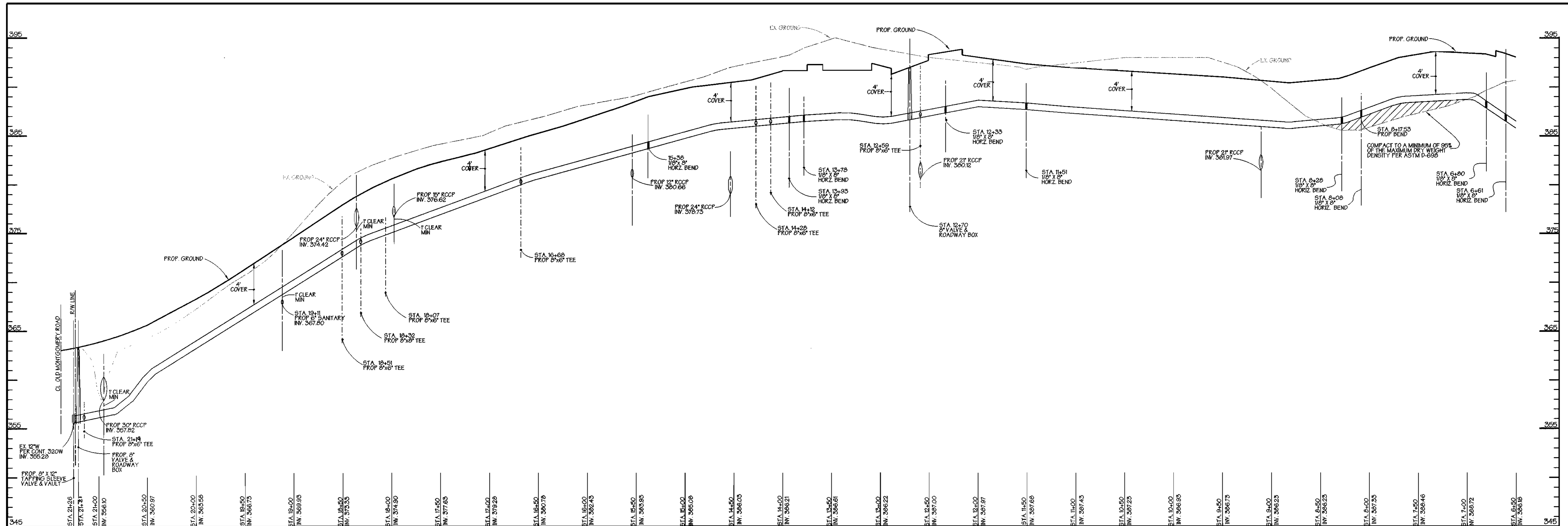

WATERMAIN PROFILE NO. 2  
SCALE: HORIZ=1"=50'  
VERT=1"=5'

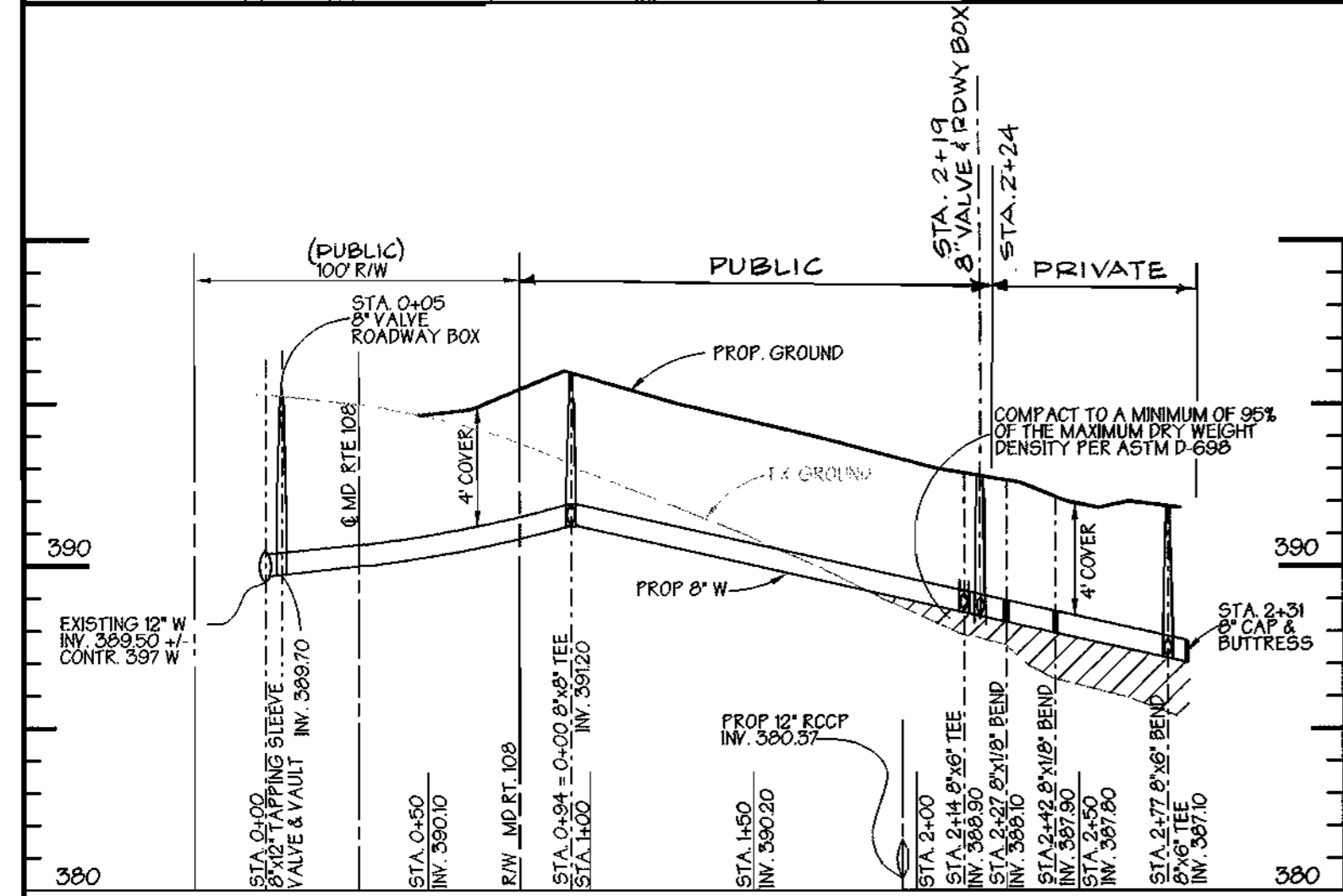

WATERMAIN PROFILE NO. 1  
SCALE: HORIZ=1"=50'  
VERT=1"=5'

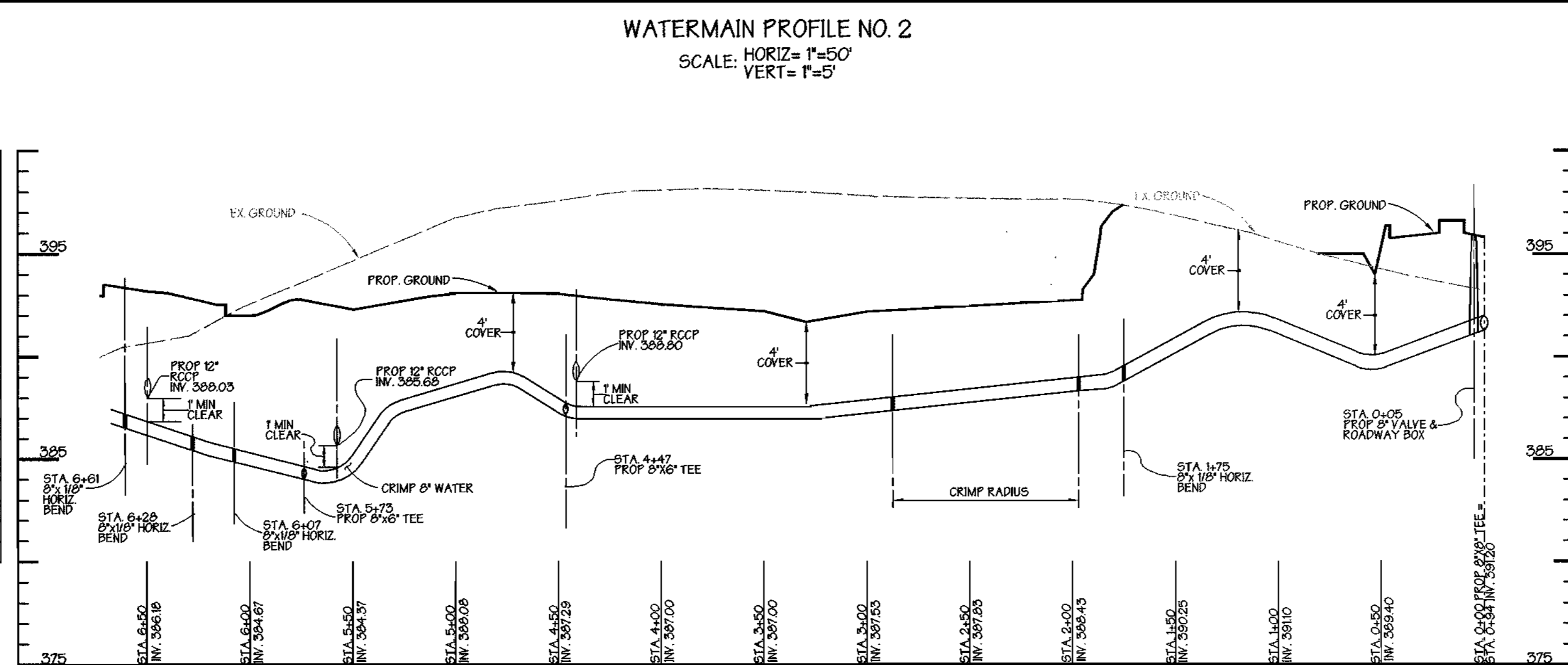

WATERMAIN PROFILE NO. 2  
SCALE: HORIZ=1"=50'  
VERT=1"=5'

SEDIMENT CONTROL MEASURES FOR THIS CONTRACT WILL BE IMPLEMENTED IN ACCORDANCE WITH SECTION 219 OF THE STANDARD SPECIFICATIONS, SDP 99-65

THE DEVELOPMENT PLAN IS APPROVED FOR SOIL EROSION AND SEDIMENT CONTROL BY THE HOWARD SOIL CONSERVATION DISTRICT.

APPROVED :  
HOWARD SOIL CONSERVATION DISTRICT DATE  
REVIEWED FOR HOWARD SOIL CONSERVATION DISTRICT AND MEETS TECHNICAL REQUIREMENTS.

\_\_\_\_\_  
U.S. SOIL CONSERVATION SERVICE DATE

NO.	BY	REVISION	DATE

DEVELOPER / CONTRACTOR / PURCHASER  
**HORSE FARM - LINDEN L.L.C.**  
906 POPLAR HILL ROAD SUITE 200  
BALTIMORE, MARYLAND, 21210  
410 - 532 6250  
OWNER  
STATE OF MARYLAND BOARD OF REGENTS OF THE UNIVERSITY  
OF MARYLAND DGS / OFFICE OF REAL ESTATE L. 153 F. 288  
300 WEST PRESTON STREET ROOM 601  
BALTIMORE, MARYLAND, 21201  
410 - 767- 4309

DEPARTMENT OF PUBLIC WORKS  
HOWARD COUNTY, MARYLAND  
*Michael A. ...*  
CHIEF, BUREAU OF UTILITIES DATE

DEPARTMENT OF PLANNING & ZONING  
HOWARD COUNTY, MARYLAND  
*...*  
CHIEF, DEVELOPMENT ENGINEERING DIVISION DATE

**GEORGE W. STEPHENS, JR. AND ASSOCIATES, INC.**  
Civil Engineers and Land Surveyors  
658 Kenilworth Drive, Suite 100  
Towson Maryland 21204  
(410) 825-8120



DESIGNED : PRC, KE  
DRAFTED : PT  
CHECKED : PRC

**PROFILES**  
CONTRACT NO. 14-3768-D  
600 SCALE MAP NO. 37 BLOCK NO. 8

**PUBLIC WATER & SEWER PROFILES**  
**THE HORSE FARM**  
CONTRACT NO. 14-3768-D  
ELECTION DISTRICT #1  
HOWARD COUNTY, MARYLAND  
JANUARY 06, 1999  
SHEET 3 OF 4  
P/N 8594 - waterplan2.s01

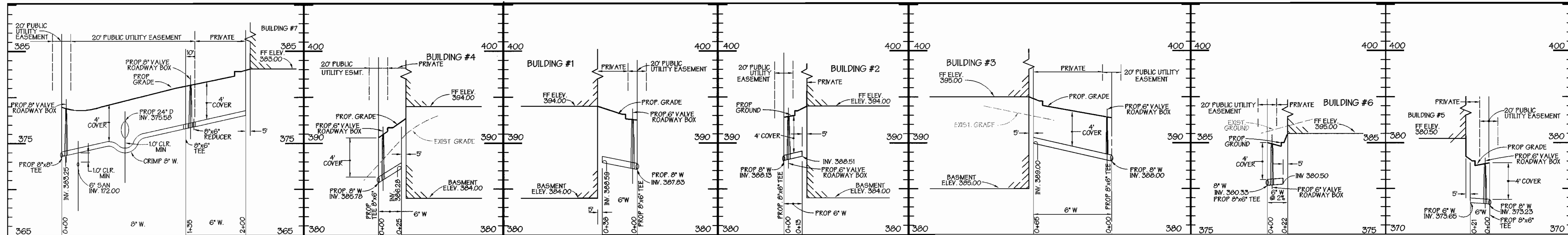

WATERMAIN PROFILE NO. 3 & WATERHOUSE CONNECTION BUILDING #7  
SCALE: HORZ. 1" = 50'  
VERT. 1" = 5'

WATERHOUSE CONNECTION BUILDING #4  
SCALE: HORZ. 1" = 50'  
VERT. 1" = 5'

WATERHOUSE CONNECTION BUILDING #1  
SCALE: HORZ. 1" = 50'  
VERT. 1" = 5'

WATERHOUSE CONNECTION BUILDING #2  
SCALE: HORZ. 1" = 50'  
VERT. 1" = 5'

WATERHOUSE CONNECTION BUILDING #3  
SCALE: HORZ. 1" = 50'  
VERT. 1" = 5'

WATERHOUSE CONNECTION BUILDING #6  
SCALE: HORZ. 1" = 50'  
VERT. 1" = 5'

WATERHOUSE CONNECTION BUILDING #5  
SCALE: HORZ. 1" = 50'  
VERT. 1" = 5'

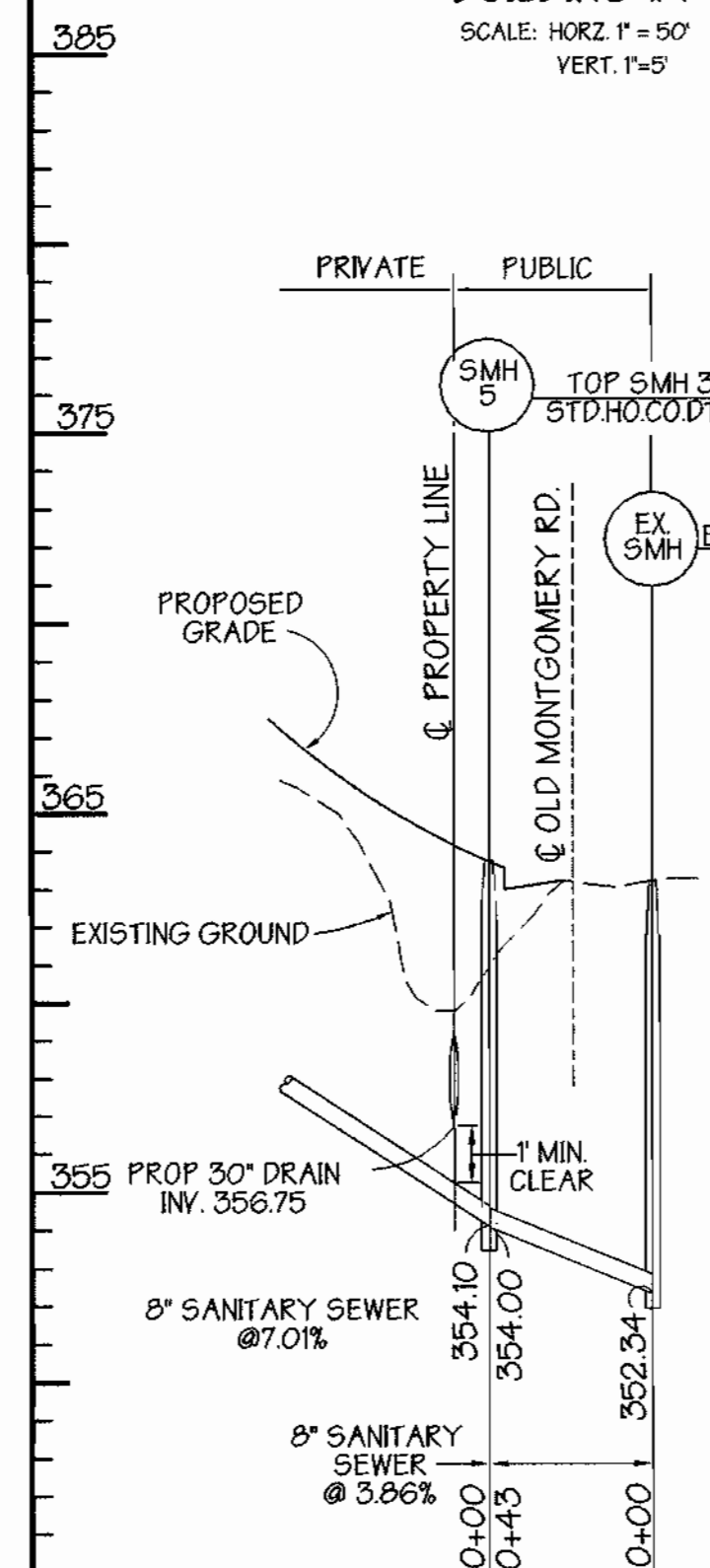

SANITARY SEWER  
SCALE: HORZ. 1" = 50'  
VERT. 1" = 5'

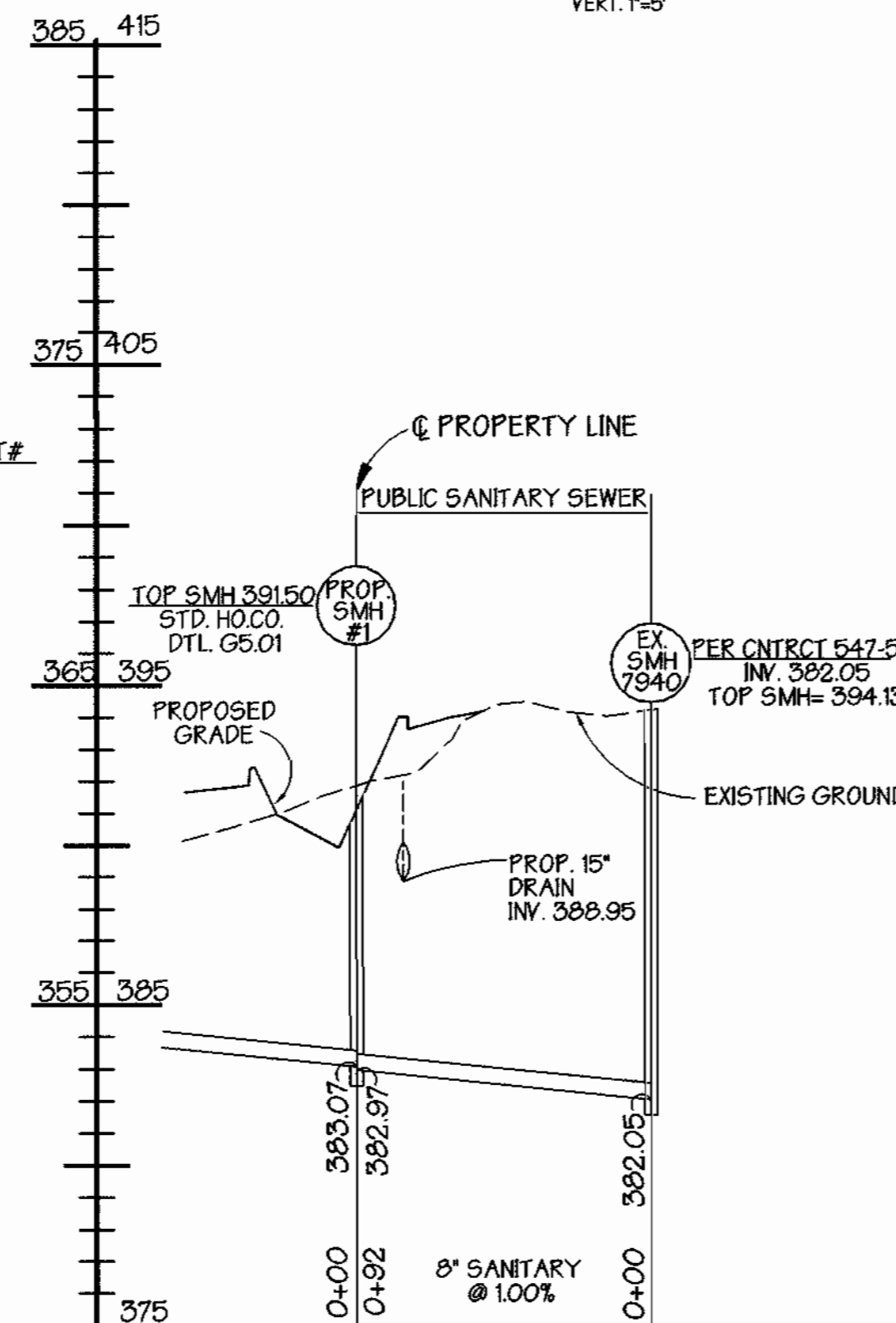

SANITARY SEWER  
SCALE: HORZ. 1" = 50'  
VERT. 1" = 5'

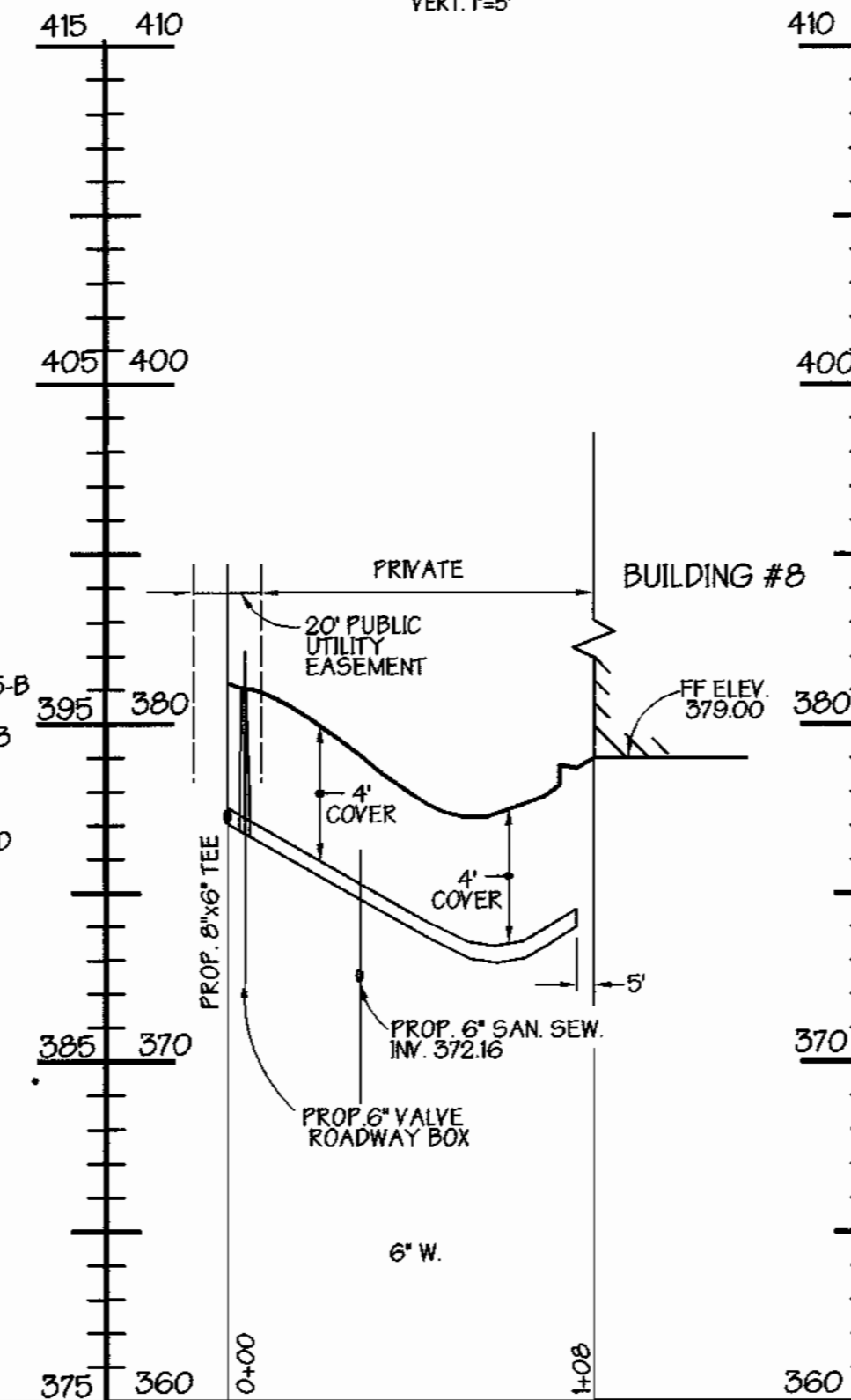

WATERHOUSE CONNECTION BUILDING #8  
SCALE: HORZ. 1" = 50'  
VERT. 1" = 5'

SEDIMENT CONTROL MEASURES FOR THIS CONTRACT WILL BE IMPLEMENTED IN ACCORDANCE WITH SECTION 219 OF THE STANDARD SPECIFICATIONS, SDP 99-65

THE DEVELOPMENT PLAN IS APPROVED FOR SOIL EROSION AND SEDIMENT CONTROL BY THE HOWARD SOIL CONSERVATION DISTRICT.

APPROVED : \_\_\_\_\_  
HOWARD SOIL CONSERVATION DISTRICT DATE

REVIEWED FOR HOWARD SOIL CONSERVATION DISTRICT AND MEETS TECHNICAL REQUIREMENTS.

U.S. SOIL CONSERVATION SERVICE DATE

DEVELOPER / CONTRACTOR / PURCHASER  
**HORSE FARM - LINDEN L.L.C.**  
906 POPLAR HILL ROAD SUITE 200  
BALTIMORE, MARYLAND, 21210  
410 - 532 6250

OWNER  
STATE OF MARYLAND BOARD OF REGENTS OF THE UNIVERSITY  
OF MARYLAND DGS / OFFICE OF REAL ESTATE L. 153 F. 288  
300 WEST PRESTON STREET ROOM 601  
BALTIMORE, MARYLAND, 21201  
410 - 767- 4309

NO.	BY	REVISION	DATE

DEPARTMENT OF PUBLIC WORKS  
HOWARD COUNTY, MARYLAND

*Michael A. ...* 6-27-99  
CHIEF, BUREAU OF UTILITIES DATE

DEPARTMENT OF PLANNING & ZONING  
HOWARD COUNTY, MARYLAND

*...* 7/2/99  
CHIEF, DEVELOPMENT ENGINEERING DIVISION DATE

**GW&S**  
**GEORGE W. STEPHENS, JR. AND ASSOCIATES, INC.**  
Civil Engineers and Land Surveyors  
658 Kenilworth Drive, Suite 100  
Towson Maryland 21204  
(410) 825-8120



DESIGNED : PRC, KE  
DRAFTED : PT  
CHECKED : PRC

**PROFILES**

CONTRACT NO. 14-3768-D  
600 SCALE MAP NO. 37 BLOCK NO. 8

**PUBLIC WATER & SEWER PROFILES**  
**THE HORSE FARM**  
CONTRACT NO. 14-3768-D

ELECTION DISTRICT #1  
HOWARD COUNTY, MARYLAND

JANUARY 06, 1999  
SHEET 4 OF 4

P/N 8594 - waterplan3.s01

# GENERAL NOTES

- Approximate location of existing mains are shown. The contractor shall take all necessary precautions to protect existing mains and services and maintain uninterrupted supply. Any damage incurred shall be repaired immediately to the satisfaction of the Engineer at the Contractor's expense.
- All horizontal controls are based on Maryland State Coordinates.
- All vertical controls are based on U.S.G.S. data.
- All pipe elevations shown are invert elevations.
- Clear all utilities by a minimum of 6". Clear all poles by 2'-0" minimum or tunnel as required. The owner has contacted the utility companies and has made arrangements for bracing of poles as shown on the drawings. In the event the contractor's work requires the bracing of additional poles, any cost incurred by the owner for bracing of additional poles or damages shall be deducted from money owed the contractor. The contractor shall coordinate with the utility companies to schedule the bracing of the poles.
- For details not shown on the drawings, and for materials and construction methods use Howard County Design Manual, Volume IV, Standard Specifications and Detail for Construction (Latest Edition). The contractor shall have a copy of Volume IV on the job.
- Where test pits have been made on existing utilities, they are noted by the symbol  at the location of the test pit. A note or notes containing the results of the test pit or pits is included on the drawings. Existing utilities in the vicinity of the proposed work for which test pits have not been dug shall be located by the contractor two weeks in advance of construction operations at his own expense.
- Contractor shall notify the following utility companies or agencies at least five working days before starting work shown on these plans:
 

State Highway Administration	531-5533
Baltimore Gas & Electric Co. Contractor Services	950-4820
Baltimore Gas & Electric Co. Underground Damage Control	787-9068
Miss Utility	1-800-257-7777
Colonial Pipeline Co.	795-1390
Bureau of Utilities, Howard County Department of Public Works	313-4900
- Contractor shall remove trees, stumps and roots along line of excavation. Payment for such removal shall be included in the unit price bid for construction of the main.
- All fill areas within future roadway and under structures to be compacted to a minimum of 95% compaction as determined by AASHTO T-180.
- Valves adjacent to tees shall be strapped to tees.
- All water mains to be D.I.P. Class 52 unless otherwise noted.
- Tops of all water mains to have a minimum of 3-1/2' cover unless otherwise noted.
- All fittings shall be buttressed or anchored with concrete in accordance with the Standard Details unless otherwise provided for on the drawings.
- Fire hydrants shall be set to the bury line elevations shown on the drawings. All fire hydrants shall be restrained and buttressed with concrete in accordance with Standard Details. Soil around the fire hydrant shall be compacted in accordance with Section 1000 and 1005 of the Standard Specifications.
- The contractor shall notify the Bureau of Highways, Howard County, at (410) 313-2450 at least five working days before any open cut of any County road or boring/jacking operation in County roads for laying water/sewer mains or house connections. The approval of these drawings will constitute compliance with DPW requirements per Section 18.114(a) of the Howard County Code.
- The contractor shall not operate any water main valves on the existing water system.
- All water house connections shall be for inside meter setting unless otherwise noted on plans or in specifications.
- All sewer mains shall be D.I.P. or P.V.C., unless otherwise noted.
- All manholes shall be 4'-0" inside diameter unless otherwise noted.
- Manholes to be precast concrete structure.
- Manholes shown with 12" and 16" area are for brick manholes only.

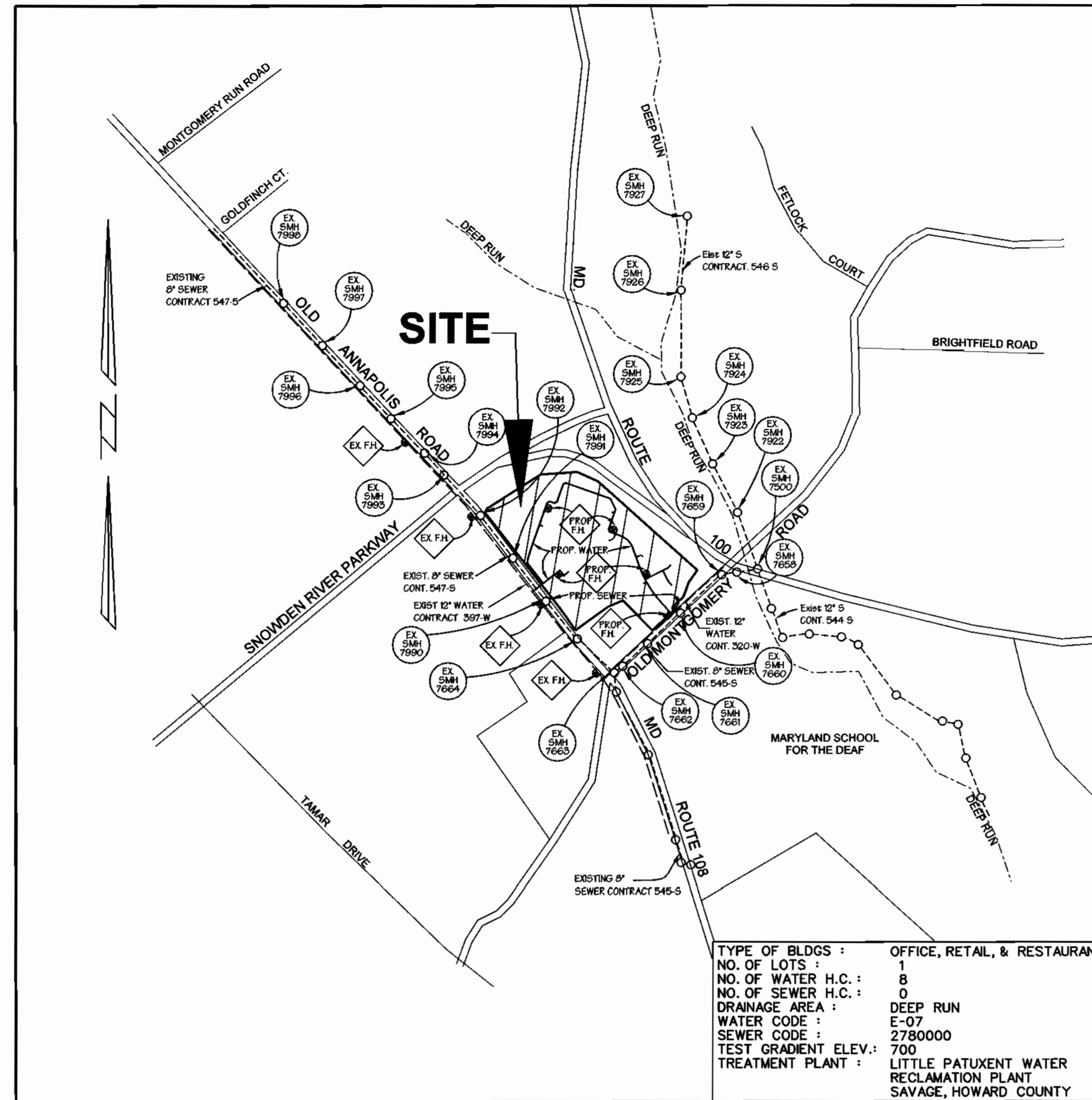

## LOCATION MAP

SCALE : 1" = 600'

## WATER & SEWER CONSTRUCTION PLANS THE HORSE FARM

1st ELECTION DISTRICT HOWARD COUNTY, MARYLAND

CONTRACT NO. 14-3768-D

## INDEX OF SHEETS

SHEET NO.	TITLES
1	COVER SHEET, GENERAL NOTES & LOCATION MAP
2	PLAN VIEW
3	PROFILES
4	PROFILES

## Benchmarks

Pt. #37A2, Aka - 2643002 - Howard Co. Geodetic Control  
 Northing : 562120.856  
 Easting : 1369300.289  
 NAD27 datum N 5013719, E 856882.1  
 Elevation : 403.675'

Pt. #37A3, Aka - 2643003 - Howard Co. Geodetic Control  
 Northing : 561130.803  
 Easting : 1369913.306  
 NAD27 datum N 5003819, E 857495.1  
 Elevation : 385.627'

## QUANTITIES

ITEMS	QUANTITIES ESTIMATED	AS-BUILT		
		QUANTITIES	TYPE	MANUFACTURER/ SUPPLIER
8" D.I.P. Water Main	2,495 L.F.			
6" D.I.P. Water Main	166 L.F.			
Fire Hydrants	5 Each			
8"X8" TEE	2 Each			
8"X6" TEE	12 Each			
8" Valve and Roadway Box	5 Each			
6" Valve and Roadway Box	11 Each			
8"X 6" Reducer	1 Each			
Sanitary Manholes (G 5.01)	2 Each			
8" P.V.C. Sanitary Sewer	145 L.F.			
12" X 8" Tapping Sleeve and Valve	2 Each			

NAME OF UTILITY CONTRACTOR :

SURVEY AND DRAFTING DIVISION AS-BUILT DATE \_\_\_\_\_

SEDIMENT CONTROL MEASURES FOR THIS CONTRACT WILL BE IMPLEMENTED IN ACCORDANCE WITH SECTION 219 OF THE STANDARD SPECIFICATIONS, SDP 99-85

THE DEVELOPMENT PLAN IS APPROVED FOR SOIL EROSION AND SEDIMENT CONTROL BY THE HOWARD SOIL CONSERVATION DISTRICT.

APPROVED  6/30/99  
 HOWARD SOIL CONSERVATION DISTRICT DATE

REVIEWED FOR HOWARD SOIL CONSERVATION DISTRICT AND MEETS TECHNICAL REQUIREMENTS.

 6/30/99  
 U.S. SOIL CONSERVATION SERVICE DATE

OWNER/DEVELOPER  
**HORSE FARM - LINDEN L.L.C.**  
 906 POPLAR HILL ROAD SUITE 200  
 BALTIMORE, MARYLAND 21210  
 410-532-6250

DEPARTMENT OF PUBLIC WORKS  
 HOWARD COUNTY, MARYLAND

DEPARTMENT OF PLANNING & ZONING  
 HOWARD COUNTY, MARYLAND



**GEORGE W. STEPHENS, JR.  
 AND ASSOCIATES, INC.**

Civil Engineers and Land Surveyors

658 Kenilworth Drive, Suite 100  
 Towson Maryland 21204  
 (410) 825-8120



DESIGNED : PRC, KE  
 DRAFTED : KE  
 CHECKED : PRC

## COVER SHEET, GENERAL NOTES & LOCATION MAP

CONTRACT NO. 14-3768-D

600 SCALE MAP NO. 37

BLOCK NO. 8

## PUBLIC WATER & SEWER MAIN THE HORSE FARM CONTRACT NO. 14-3768-D

HOWARD COUNTY, MARYLAND  
 ELECTION DISTRICT \*01

JANUARY 06, 1999  
 SHEET 1 OF 4

**MD. ROUTE 100**  
( UNDER CONSTRUCTION )  
PLATS 54190, 54191 & 54193

**OLD MONTGOMERY ROAD**

**MD RT. 108**  
100' R/W  
S.H.A. PLATS 12453 & 12454

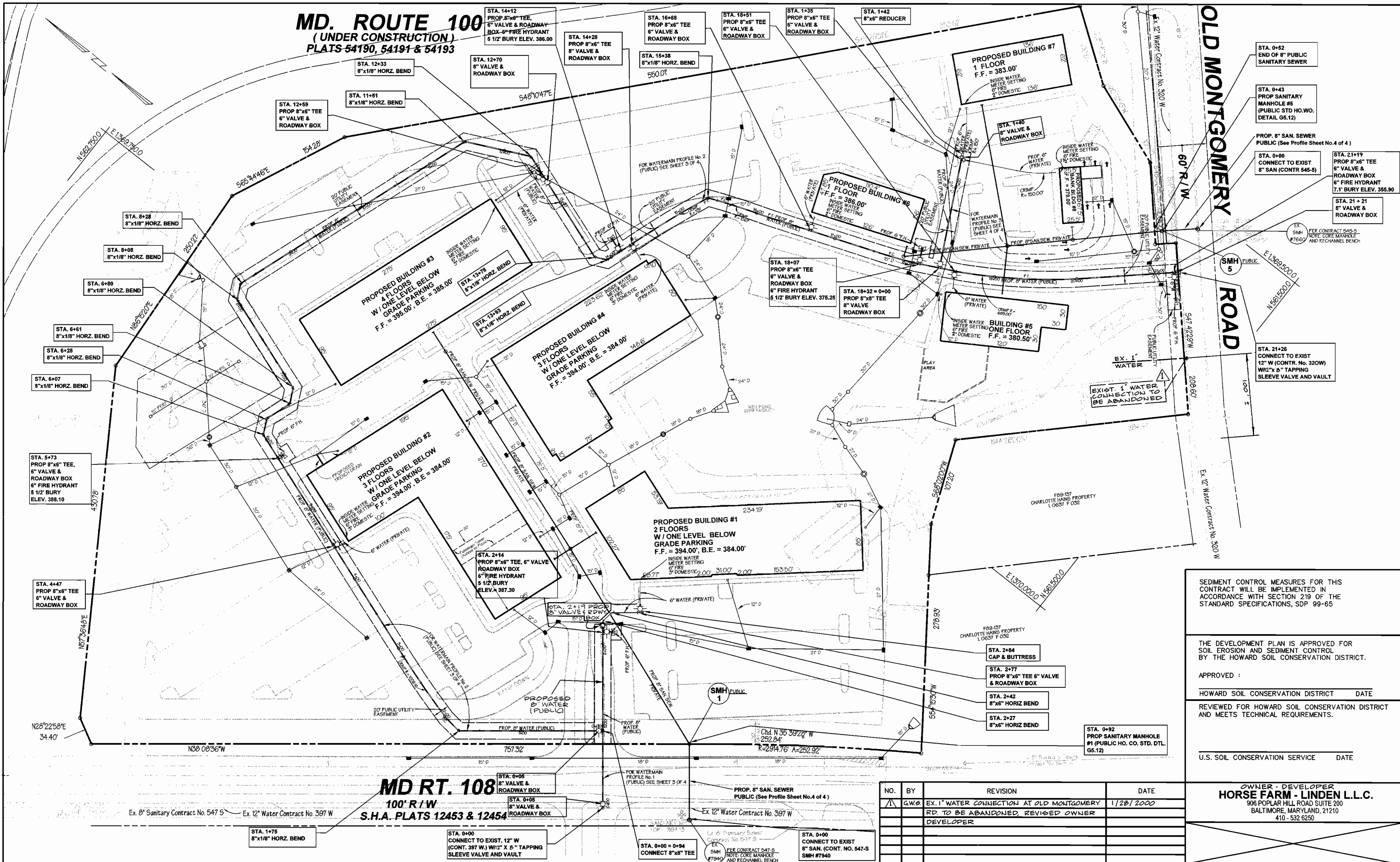

SEDIMENT CONTROL MEASURES FOR THIS CONTRACT WILL BE IMPLEMENTED IN ACCORDANCE WITH SECTION 219 OF THE STANDARD SPECIFICATIONS, SDP 99-65

THE DEVELOPMENT PLAN IS APPROVED FOR SOIL EROSION AND SEDIMENT CONTROL BY THE HOWARD SOIL CONSERVATION DISTRICT.

APPROVED :  
HOWARD SOIL CONSERVATION DISTRICT DATE  
REVIEWED FOR HOWARD SOIL CONSERVATION DISTRICT AND MEETS TECHNICAL REQUIREMENTS.

U.S. SOIL CONSERVATION SERVICE DATE

OWNER - DEVELOPER  
**HORSE FARM - LINDEN L.L.C.**  
906 POPLAR HILL ROAD SUITE 200  
BALTIMORE, MARYLAND, 21210  
410 - 532 6250

NO.	BY	REVISION	DATE
1	G.W.B.	EX. 1" WATER CONNECTION AT OLD MONTGOMERY RD. TO BE ABANDONED. REVISED OWNER DEVELOPER	1/28/2000

DEPARTMENT OF PUBLIC WORKS  
HOWARD COUNTY, MARYLAND  
*Nicholas A. Designillo*  
CHIEF, BUREAU OF UTILITIES DATE

DEPARTMENT OF PLANNING & ZONING  
HOWARD COUNTY, MARYLAND  
*John D. ...*  
CHIEF, DEVELOPMENT ENGINEERING DIVISION DATE

**GEORGE W. STEPHENS, JR. AND ASSOCIATES, INC.**  
Civil Engineers and Land Surveyors  
658 Kenilworth Drive, Suite 100  
Towson Maryland 21204  
(410) 825-8120



DESIGNED : PRC, KE  
DRAFTED : P.T., K.E.  
CHECKED : PRC

**PLAN VIEW**  
CONTRACT NO. 14-3768-D  
600 SCALE MAP NO. 37  
BLOCK NO. 8

**PUBLIC WATER & SEWER PLAN**  
**THE HORSE FARM**  
CONTRACT NO. 14-3768-D  
ELECTION DISTRICT #1  
HOWARD COUNTY, MARYLAND  
JANUARY 06, 1999  
SHEET 2 OF 4  
P/N 8594 - waterplan.1.s01

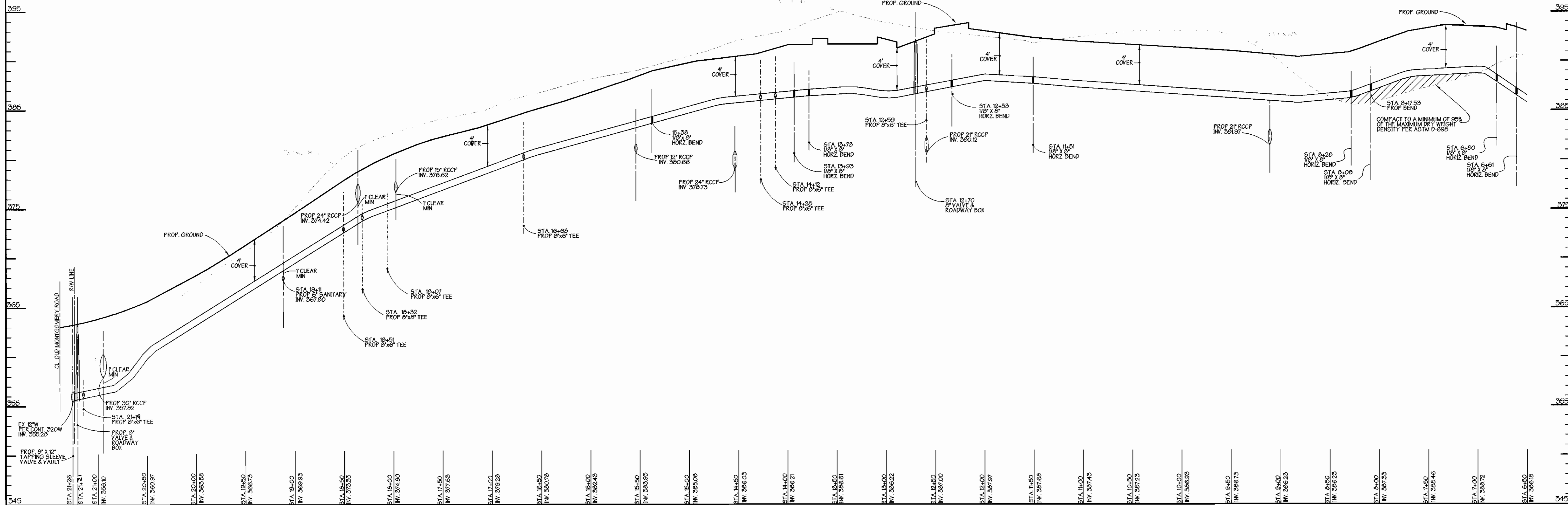

WATERMAIN PROFILE NO. 2  
SCALE: HORIZ = 1"=50'  
VERT = 1"=5'

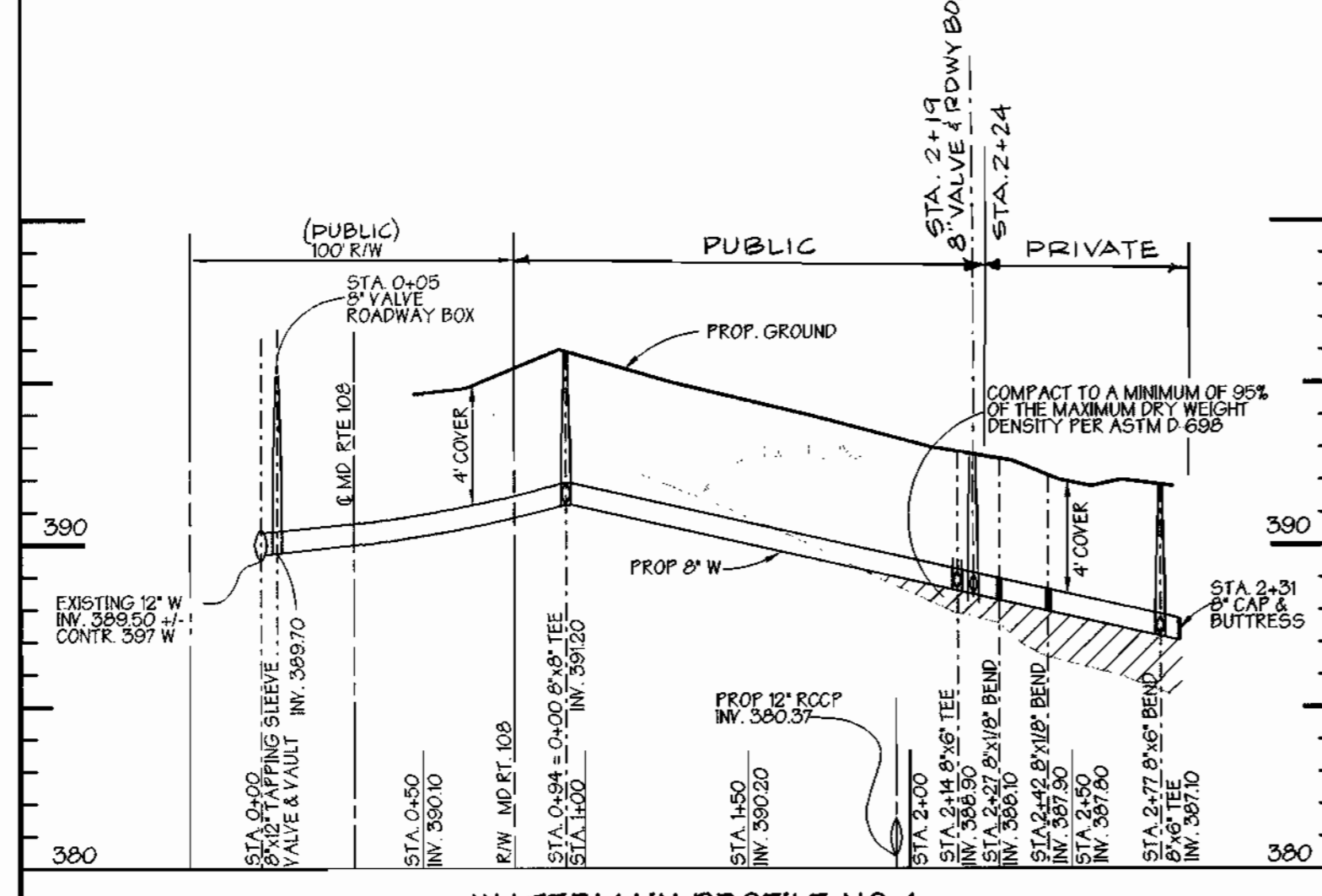

WATERMAIN PROFILE NO. 1  
SCALE: HORIZ = 1"=50'  
VERT = 1"=5'

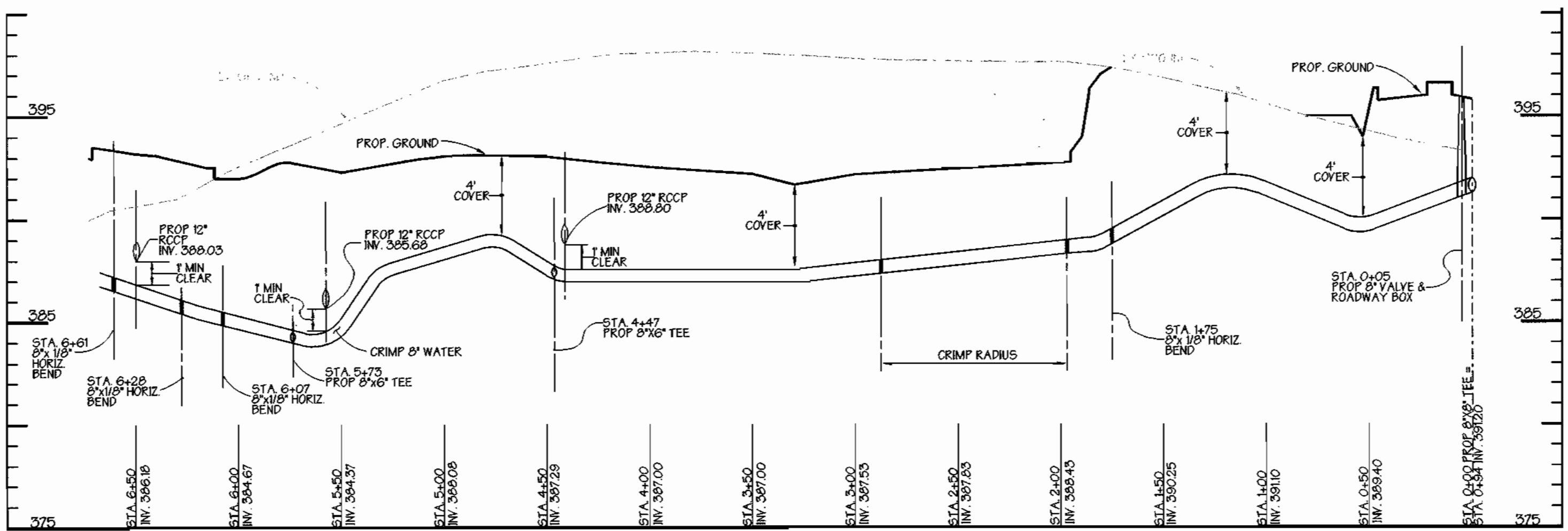

WATERMAIN PROFILE NO. 2  
SCALE: HORIZ = 1"=50'  
VERT = 1"=5'

SEDIMENT CONTROL MEASURES FOR THIS CONTRACT WILL BE IMPLEMENTED IN ACCORDANCE WITH SECTION 219 OF THE STANDARD SPECIFICATIONS, SDP 99-65

THE DEVELOPMENT PLAN IS APPROVED FOR SOIL EROSION AND SEDIMENT CONTROL BY THE HOWARD SOIL CONSERVATION DISTRICT.

APPROVED :  
HOWARD SOIL CONSERVATION DISTRICT DATE

REVIEWED FOR HOWARD SOIL CONSERVATION DISTRICT AND MEETS TECHNICAL REQUIREMENTS.

U.S. SOIL CONSERVATION SERVICE DATE

NO.	BY	REVISION	DATE
1	G.W.S.	REVISED OWNER/DEVELOPER	1/28/2000

OWNER - DEVELOPER  
**HORSE FARM - LINDEN L.L.C.**  
906 POPLAR HILL ROAD SUITE 200  
BALTIMORE, MARYLAND, 21210  
410 - 532 6250

DEPARTMENT OF PUBLIC WORKS  
HOWARD COUNTY, MARYLAND  
*Michael A. ...*  
CHIEF, BUREAU OF UTILITIES DATE

DEPARTMENT OF PLANNING & ZONING  
HOWARD COUNTY, MARYLAND  
*...*  
CHIEF, DEVELOPMENT ENGINEERING DIVISION DATE

**GEORGE W. STEPHENS, JR. AND ASSOCIATES, INC.**  
Civil Engineers and Land Surveyors  
658 Kenilworth Drive, Suite 100  
Towson, Maryland 21204  
(410) 825-8120



DESIGNED : PRC, KE  
DRAFTED : PT  
CHECKED : PRC

**PROFILES**  
CONTRACT NO. 14-3768-D  
600 SCALE MAP NO. 37  
BLOCK NO. 8

**PUBLIC WATER & SEWER PROFILES**  
**THE HORSE FARM**  
CONTRACT NO. 14-3768-D  
ELECTION DISTRICT #1  
HOWARD COUNTY, MARYLAND  
JANUARY 06, 1999  
SHEET 3 OF 4

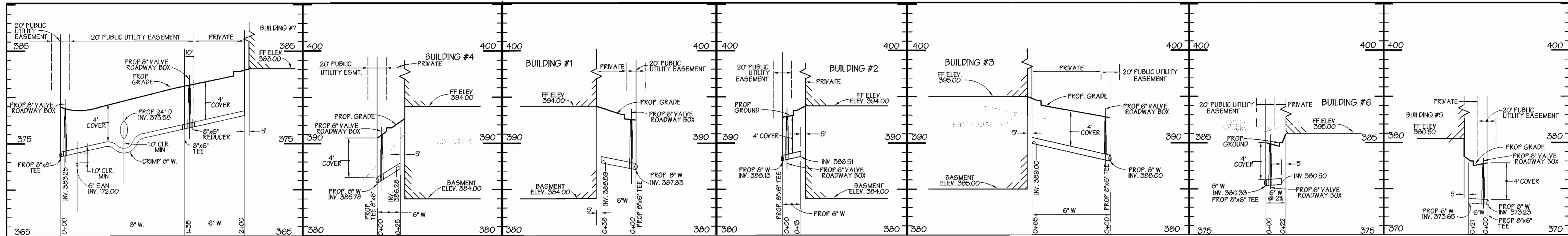

WATERMAIN PROFILE NO. 3 & WATERHOUSE CONNECTION BUILDING #7  
SCALE: HORZ. 1" = 50' VERT. 1" = 5'

WATERHOUSE CONNECTION BUILDING #4  
SCALE: HORZ. 1" = 50' VERT. 1" = 5'

WATERHOUSE CONNECTION BUILDING #1  
SCALE: HORZ. 1" = 50' VERT. 1" = 5'

WATERHOUSE CONNECTION BUILDING #2  
SCALE: HORZ. 1" = 50' VERT. 1" = 5'

WATERHOUSE CONNECTION BUILDING #3  
SCALE: HORZ. 1" = 50' VERT. 1" = 5'

WATERHOUSE CONNECTION BUILDING #6  
SCALE: HORZ. 1" = 50' VERT. 1" = 5'

WATERHOUSE CONNECTION BUILDING #5  
SCALE: HORZ. 1" = 50' VERT. 1" = 5'

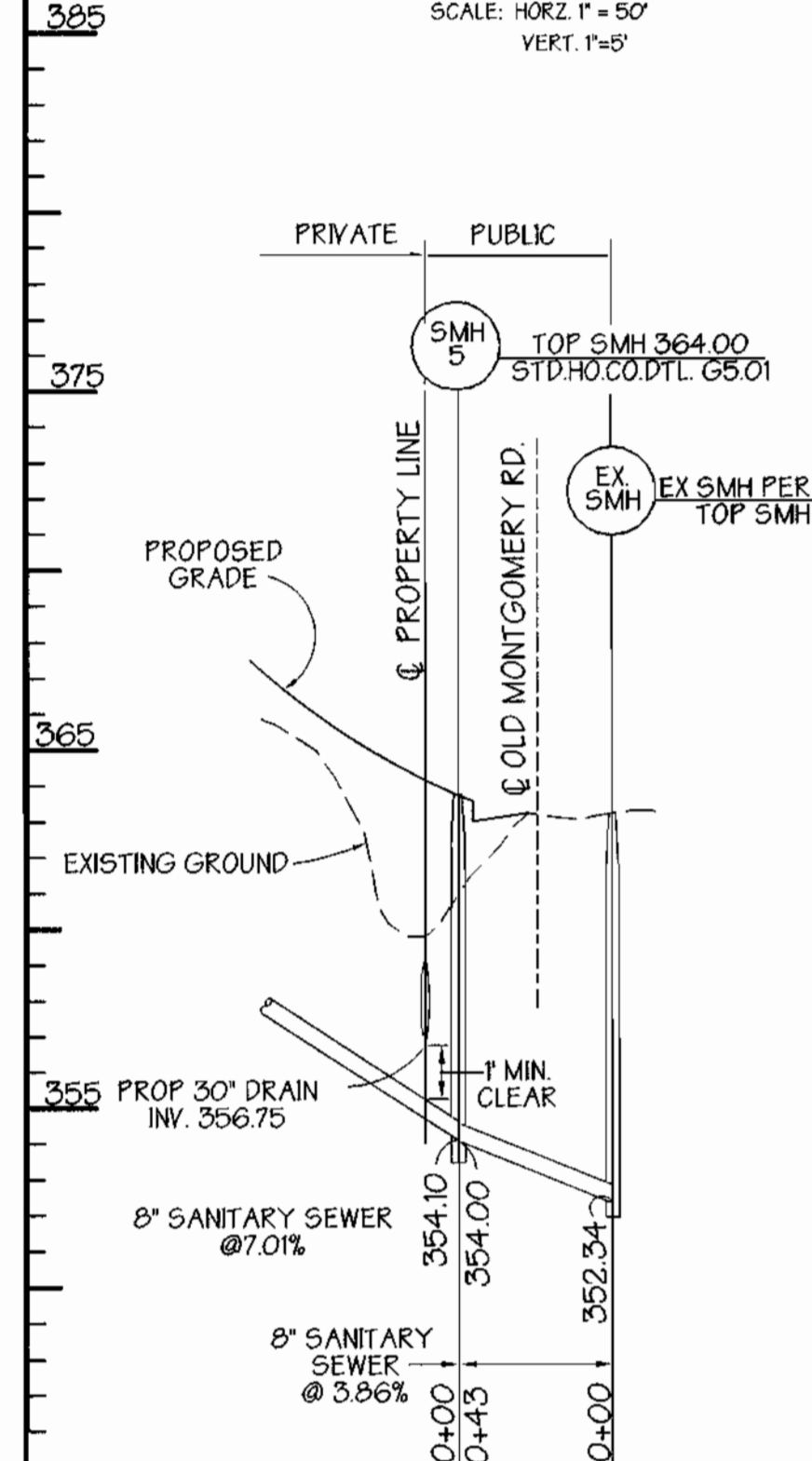

SANITARY SEWER  
SCALE: HORZ. 1" = 50' VERT. 1" = 5'

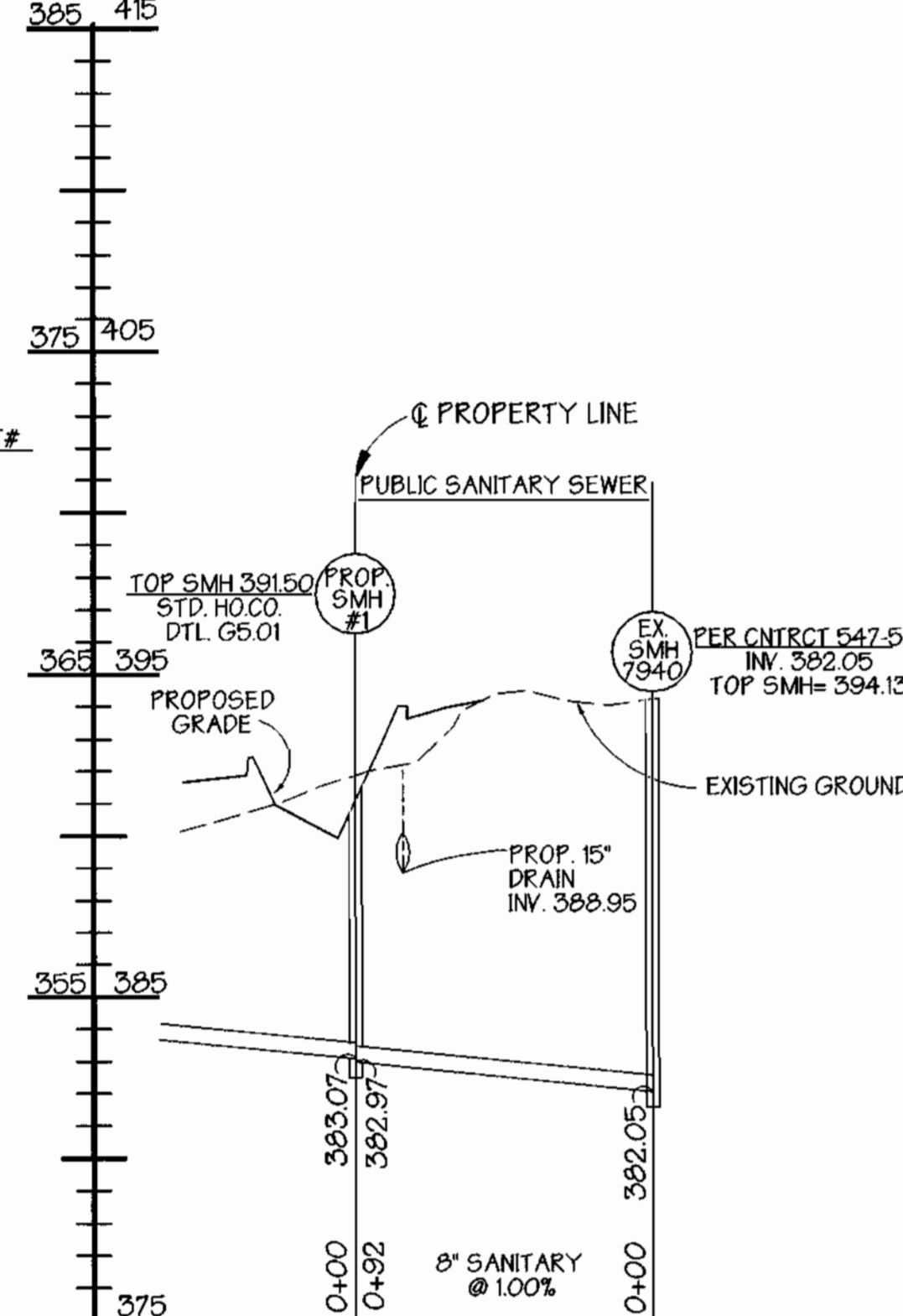

SANITARY SEWER  
SCALE: HORZ. 1" = 50' VERT. 1" = 5'

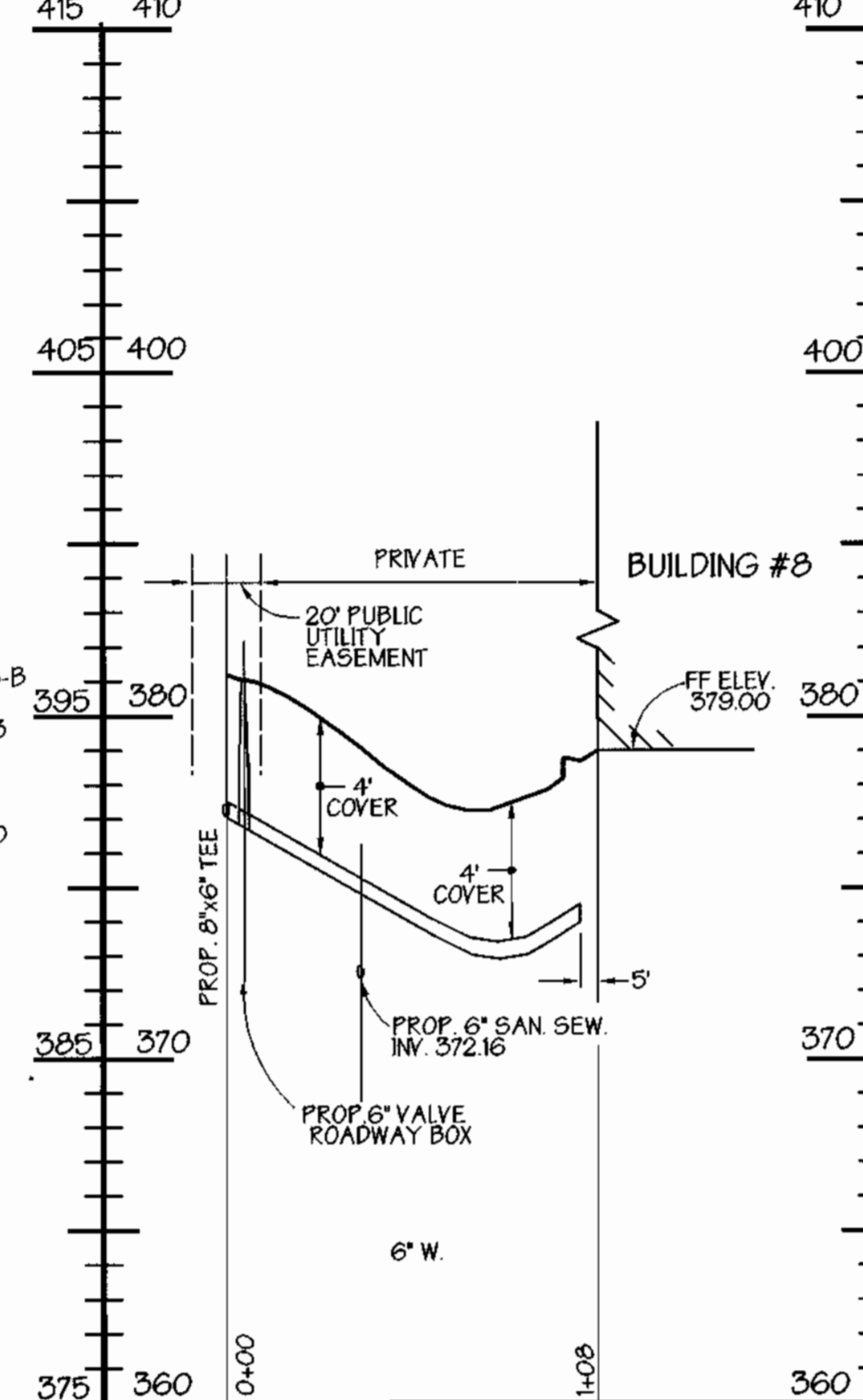

WATERHOUSE CONNECTION BUILDING #8  
SCALE: HORZ. 1" = 50' VERT. 1" = 5'

SEDIMENT CONTROL MEASURES FOR THIS CONTRACT WILL BE IMPLEMENTED IN ACCORDANCE WITH SECTION 219 OF THE STANDARD SPECIFICATIONS, SDP 99-65

THE DEVELOPMENT PLAN IS APPROVED FOR SOIL EROSION AND SEDIMENT CONTROL BY THE HOWARD SOIL CONSERVATION DISTRICT.

APPROVED :  
HOWARD SOIL CONSERVATION DISTRICT DATE

REVIEWED FOR HOWARD SOIL CONSERVATION DISTRICT AND MEETS TECHNICAL REQUIREMENTS.

U.S. SOIL CONSERVATION SERVICE DATE

NO.	BY	REVISION	DATE
1	G.W.S.	REVISED OWNER/DEVELOPER	

OWNER / DEVELOPER  
**HORSE FARM - LINDEN L.L.C.**  
906 POPLAR HILL ROAD SUITE 200  
BALTIMORE, MARYLAND, 21210  
410-532-6250

DEPARTMENT OF PUBLIC WORKS  
HOWARD COUNTY, MARYLAND  
*Michael J. ...*  
CHIEF, BUREAU OF UTILITIES DATE

DEPARTMENT OF PLANNING & ZONING  
HOWARD COUNTY, MARYLAND  
*...*  
CHIEF, DEVELOPMENT ENGINEERING DIVISION DATE

**GEORGE W. STEPHENS, JR. AND ASSOCIATES, INC.**  
Civil Engineers and Land Surveyors  
658 Kenilworth Drive, Suite 100  
Towson Maryland 21204  
(410) 825-8120



DESIGNED : PRC, KE  
DRAFTED : PT  
CHECKED : PRC

**PROFILES**  
CONTRACT NO. 14-3768-D  
600 SCALE MAP NO. 37  
BLOCK NO. 8

**PUBLIC WATER & SEWER PROFILES**  
**THE HORSE FARM**  
CONTRACT NO. 14-3768-D  
ELECTION DISTRICT #1  
HOWARD COUNTY, MARYLAND  
JANUARY 06, 1999  
SHEET 4 OF 4