

GENERAL NOTES

- Approximate location of existing mains are shown. The contractor shall take all necessary precautions to protect existing mains and services and maintain uninterrupted supply. Any damage incurred shall be repaired immediately to the satisfaction of the Engineer at the Contractor's expense.
- All horizontal controls are based on Maryland State Coordinates.
- All vertical controls are based on U.S.G.S. data.
- All pipe elevations shown are invert elevations.
- Clear all utilities by a minimum of 6". Clear all poles by 2'-0" minimum or tunnels required. The owner has contacted the utility companies and has made arrangements for bracing of poles as shown on the drawings. In the event the contractor's work requires the bracing of additional poles, any cost incurred by the owner for bracing of additional poles or damages shall be deducted from money owed the contractor. The contractor shall coordinate with the utility companies to schedule the bracing of the poles.
- For details not shown on the drawings, and for materials and construction methods use Howard County Design Manual, Volume IV, Standard Specifications and Detail for Construction (Latest Edition). The contractor shall have a copy of Volume IV on the job.
- Where test pits have been made on existing utilities, they are noted by the symbol  at the location of the test pit. A note or notes containing the results of the test pit or pits is included on the drawings. Existing utilities in the vicinity of the proposed work for which test pits have not been dug shall be located by the contractor two weeks in advance of construction operations at his own expense.
- Contractor shall notify the following utility companies or agencies at least five working days before starting work shown on these plans:

State Highway Administration	410-531-5533
Baltimore Gas & Electric Co. Contractor Services	410-850-4620
Baltimore Gas & Electric Co. Underground Damage Control	410-597-6377
Miss Utility	1-800-257-7777
Colonial Pipeline Co.	410-795-1590
Bureau of Utilities, Howard County Department of Public Works	410-313-4900
Bell Atlantic	1-800-446-5266
- Trees and shrubs are to be protected from damage to maximum extent. Trees and shrubs located within the construction strip are not to be removed or damaged by the contractor.
- Contractor shall remove trees, stumps and roots along line of excavation. Payment for such removal shall be included in the unit price bid for construction of the main.
- All fill areas within future roadway and under structures to be compacted to a minimum of 95% compaction as determined by AASHTO T-180.
- Valves adjacent to tees shall be strapped to tees.
- All water mains to be D.I.P. Class 52 unless otherwise noted.
- Tops of all water mains to have a minimum of 3-1/2' cover unless otherwise noted.
- All fittings shall be buttressed or anchored with concrete in accordance with the Standard Details unless otherwise provided for on the drawings.
- Fire hydrants shall be set to the bury line elevations shown on the drawings. All fire hydrants shall be restrained and buttressed with concrete in accordance with Standard Details. Soil around the fire hydrant shall be compacted in accordance with Section 1000 and 1005 of the Standard specifications.
- The contractor shall notify the Bureau of Highways, Howard County, at (410) 313-2450 at least five working days before any open cut of any County road or boring/jacking operation in County roads for laying water/sewer mains or house connections. The approval of these drawings will constitute compliance with DPW requirements per Section 18.114(a) of the Howard County Code.
- The contractor shall not operate any water main valves on the existing water system.
- All water house connections shall be for inside meter setting unless otherwise noted on plans or in specifications.

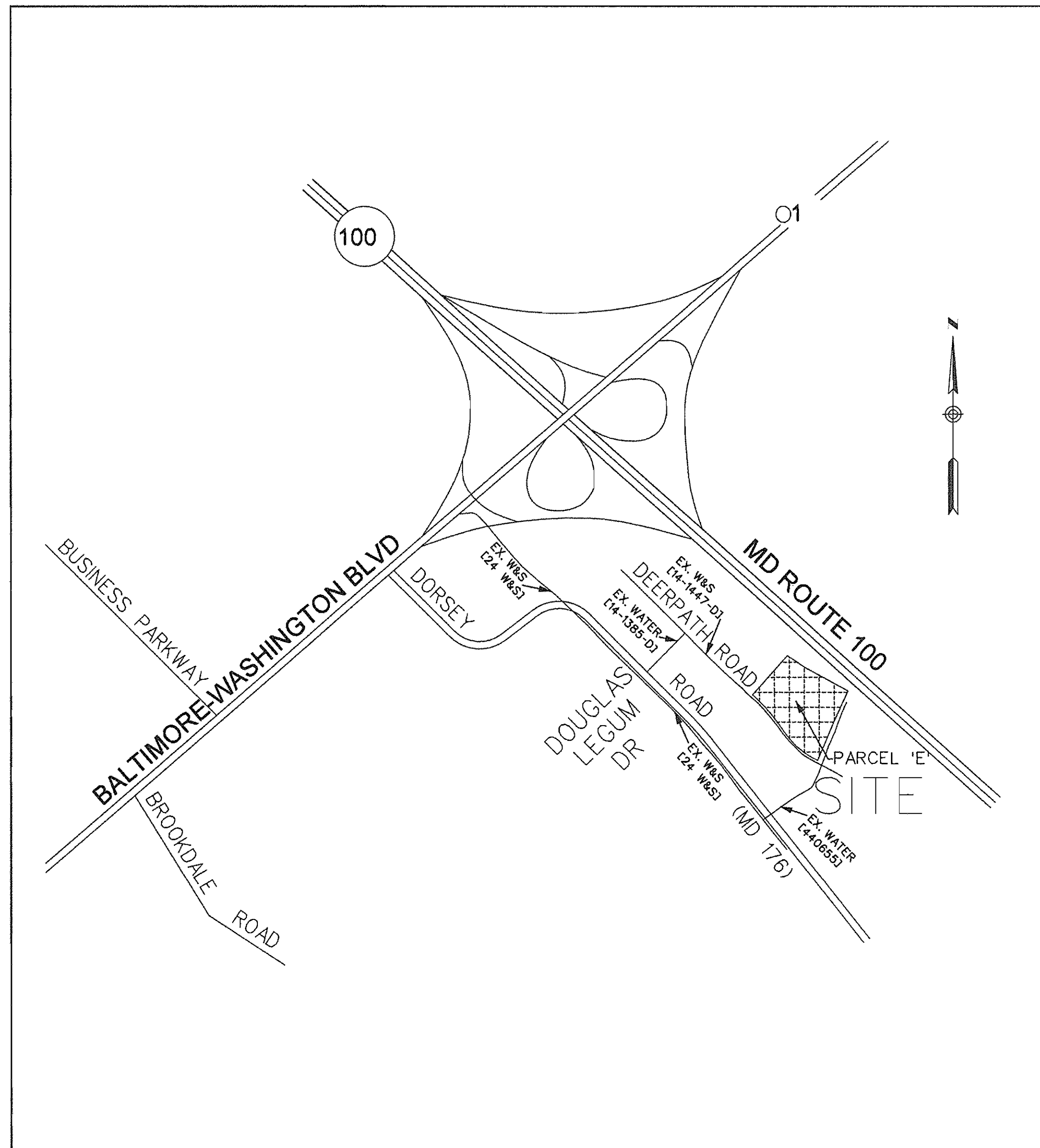

LOCATION MAP

Scale: 1"=600'

BUILDING TYPE: OFFICE
 No. OF LOTS: 1
 No. OF WATER H.C.: 1
 No. OF SEWER H.C.: 1
 DRAINAGE AREA: PATAPSCO
 WATER CODE: B01
 SEWER CODE: 2280000
 TEST GRADIENT ELEV.: 550
 TREATMENT PLANT: PATAPSCO

WATER CONSTRUCTION PLANS DORSEY BUSINESS PARK

PARCEL E
 HOWARD COUNTY, MARYLAND ELECTION DISTRICT #1
 CONTRACT NO. 44-3688-D

INDEX OF SHEETS

SHEET NO.	TITLE
1	COVER SHEET, GENERAL NOTES & LOCATION MAP
2	PLAN VIEW
3	PROFILES

BENCHMARK:

Howard County Geodetic Control No.: 371A - Elev.: 195.76
 Station is a 3/4" Iron Rod with a 4" Stamped aluminum cap.
 West side of Route 1, between edge of paving and iron fence,
 247' N. of CL main entrance of Meadowridge Memorial Park.

QUANTITIES

ITEMS	QUANTITIES ESTIMATED	AS-BUILT		
		QUANTITIES	TYPE	MANUFACTURER / SUPPLIER
8" D.I.P.	712 LF	712 EA		ATLANTIC STATES
6" D.I.P.	24 LF	24 EA		"
6" FIRE HYDRANTS	2 EA	2 EA		MUELLER CO.
8" VALVE AND VALVE BOX	1 EA	1 EA		"
6" VALVE AND VALVE BOX	3 EA	3 EA		"
8" 1/8" HB	2 EA	2 EA		TYLER PIPE
8" 1/16" HB	3 EA	1 EA		"
8" 1/32" HB	1 EA			"
8" CAP & BUTTRESS	2 EA	2 EA		TYLER PIPE
8" X 8" TEE	2 EA	2 EA		"
8" X 6" TEE	2 EA	2 EA		"
8" X 6" FHT	2 EA	2 EA		"

NAME OF UTILITY CONTRACTOR : HAWKINS BROS.

SURVEY AND DRAFTING DIVISION AS-BUILT DATE _____

SEDIMENT CONTROL MEASURES FOR THIS CONTRACT WILL BE IMPLEMENTED IN ACCORDANCE WITH SECTION 219 OF THE STANDARD SPECIFICATIONS, SDP 98-104

THE DEVELOPMENT PLAN IS APPROVED FOR SOIL EROSION AND SEDIMENT CONTROL BY THE HOWARD SOIL CONSERVATION DISTRICT.

APPROVED:  6/15/98
 HOWARD SOIL CONSERVATION DISTRICT DATE

REVIEWED FOR HOWARD SOIL CONSERVATION DISTRICT AND MEETS TECHNICAL REQUIREMENTS.

 6/15/98
 U.S. SOIL CONSERVATION SERVICE DATE

DEPARTMENT OF PUBLIC WORKS
 HOWARD COUNTY, MARYLAND

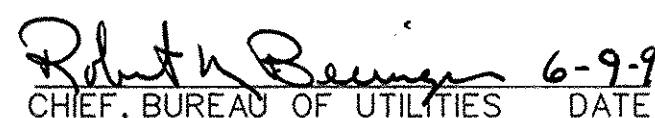
 6-9-98
 CHIEF, BUREAU OF UTILITIES DATE

DEPARTMENT OF PLANNING & ZONING
 HOWARD COUNTY, MARYLAND

 6/10/98
 CHIEF, DEVELOPMENT ENGINEERING DIVISION DATE

 **STV Incorporated**
 engineers / architects / planners / scientists / construction managers
 21 Governor's Court Baltimore, MD 21244-2722 (410) 944-9112

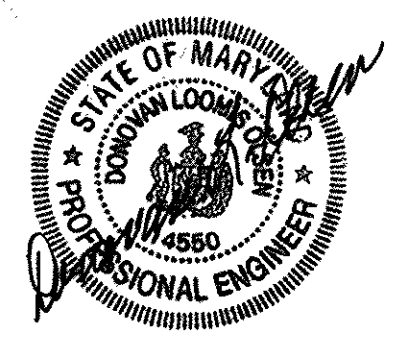

DES : PGC
 DRN : KKK
 CHK : DLO
 DATE: _____

K.C.I. 1 AS-BUILT CONDITIONS ADDED TO PLAN 10-21-98
 BY NO. REVISION DATE

COVER SHEET,
 GENERAL NOTES &
 LOCATION MAP

CONTRACT NO. 44-3688-D

600 SCALE MAP NO. 37,43

BLOCK NO. 6

PUBLIC WATERMAIN DEERPATH ROAD
DORSEY BUSINESS PARK
 PARCEL E
 AS-BUILT

HOWARD COUNTY, MARYLAND
 ELECTION DISTRICT #1

MAY 21, 1998
 SHEET 1 OF 3

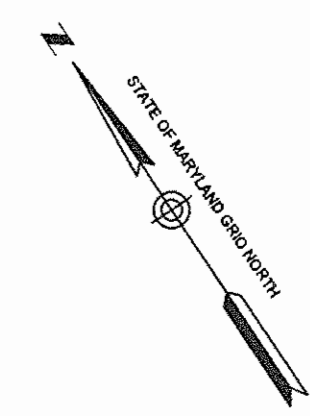
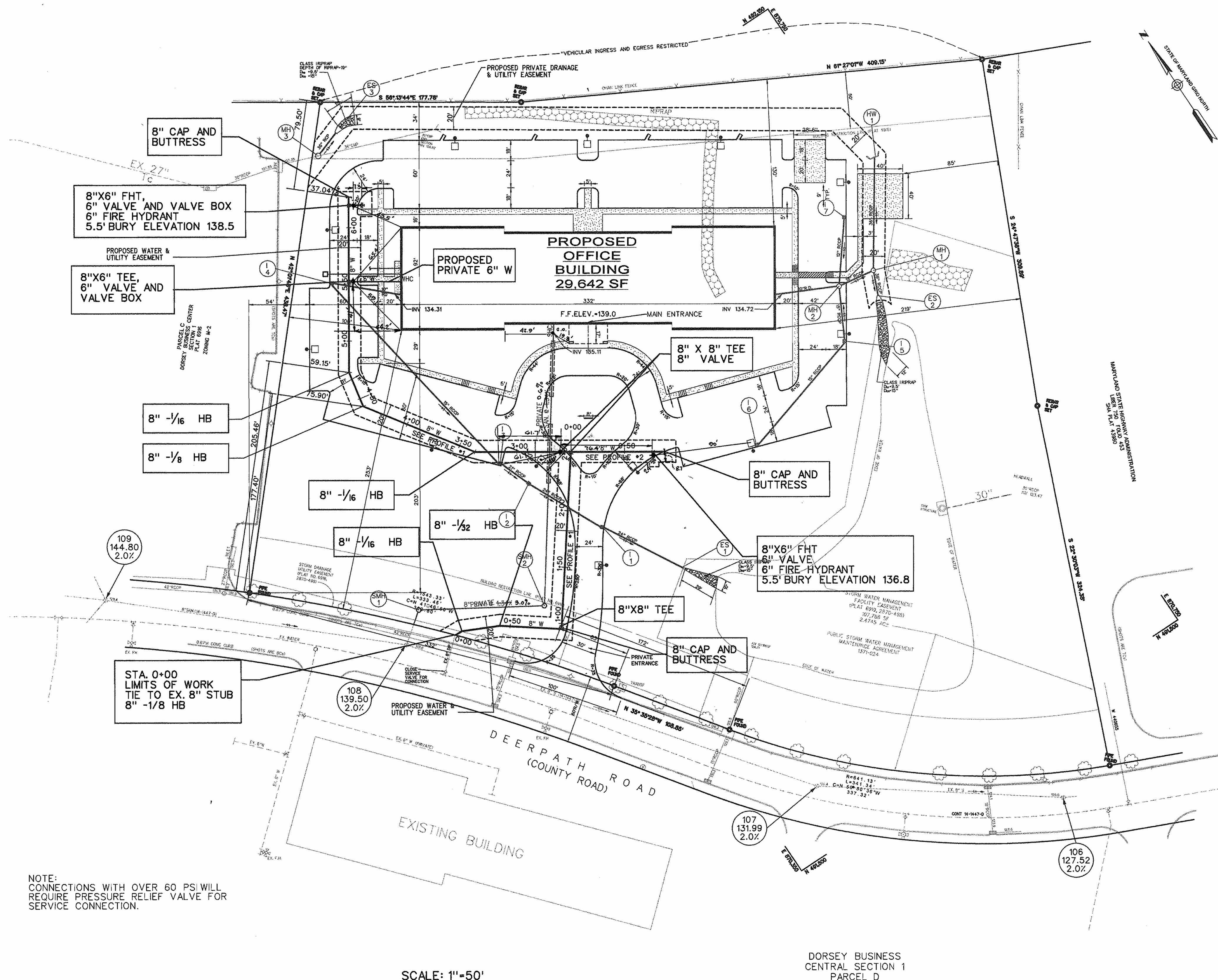

SEDIMENT CONTROL MEASURES FOR THIS CONTRACT WILL BE IMPLEMENTED IN ACCORDANCE WITH SECTION 219 OF THE STANDARD SPECIFICATIONS, SDP 98-104

THE DEVELOPMENT PLAN IS APPROVED FOR SOIL EROSION AND SEDIMENT CONTROL BY THE HOWARD SOIL CONSERVATION DISTRICT.
APPROVED: *John R. Polunton* 6/15/98
HOWARD SOIL CONSERVATION DISTRICT DATE

REVIEWED FOR HOWARD SOIL CONSERVATION DISTRICT AND MEETS TECHNICAL REQUIREMENTS.
Clayton Simmons 6/15/98
U.S. SOIL CONSERVATION SERVICE DATE

NOTE:
CONNECTIONS WITH OVER 60 PSI WILL REQUIRE PRESSURE RELIEF VALVE FOR SERVICE CONNECTION.

LEGEND:

	PROPOSED WATER MAIN
	PROPOSED SANITARY SEWER
	PROPOSED WATER VALVE, TEE & CROSS
	EXISTING WATER VALVE, TEE & CROSS
	EXISTING WATER FIRE HYDRANT

DEPARTMENT OF PUBLIC WORKS
HOWARD COUNTY, MARYLAND
Robert W. Beaman 6-9-98
CHIEF, BUREAU OF UTILITIES DATE

DEPARTMENT OF PLANNING & ZONING
HOWARD COUNTY, MARYLAND
John R. Polunton 6/15/98
CHIEF, DEVELOPMENT ENGINEERING DIVISION DATE

STV Incorporated
engineers / architects / planners / scientists / construction managers
21 Governor's Court, Baltimore, MD 21244-2722 (410) 944-9112

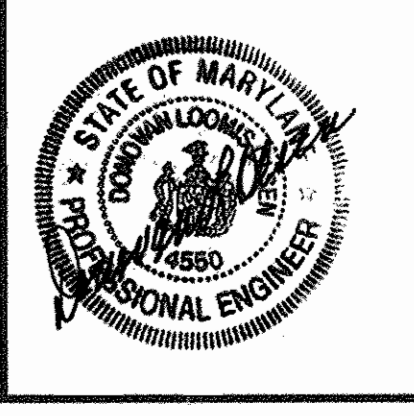

DES :	PGC
DRN :	MB
CHK :	DLC
DATE:	
BY NO.	101/1/98
REVISION	AS-BUILT CONDITIONS ADDED TO PLAN
DATE	10/15/98

WATER MAIN PLAN VIEW
CONTRACT NO. 44-3688-D
600 SCALE MAP NO. 37,43 BLOCK NO. 6

**PUBLIC WATERMAIN DEERPATH ROAD
DORSEY BUSINESS PARK
PARCEL E
"AS-BUILT"**
HOWARD COUNTY, MARYLAND
ELECTION DISTRICT #1
MAY 21, 1998
SHEET 2 OF 3

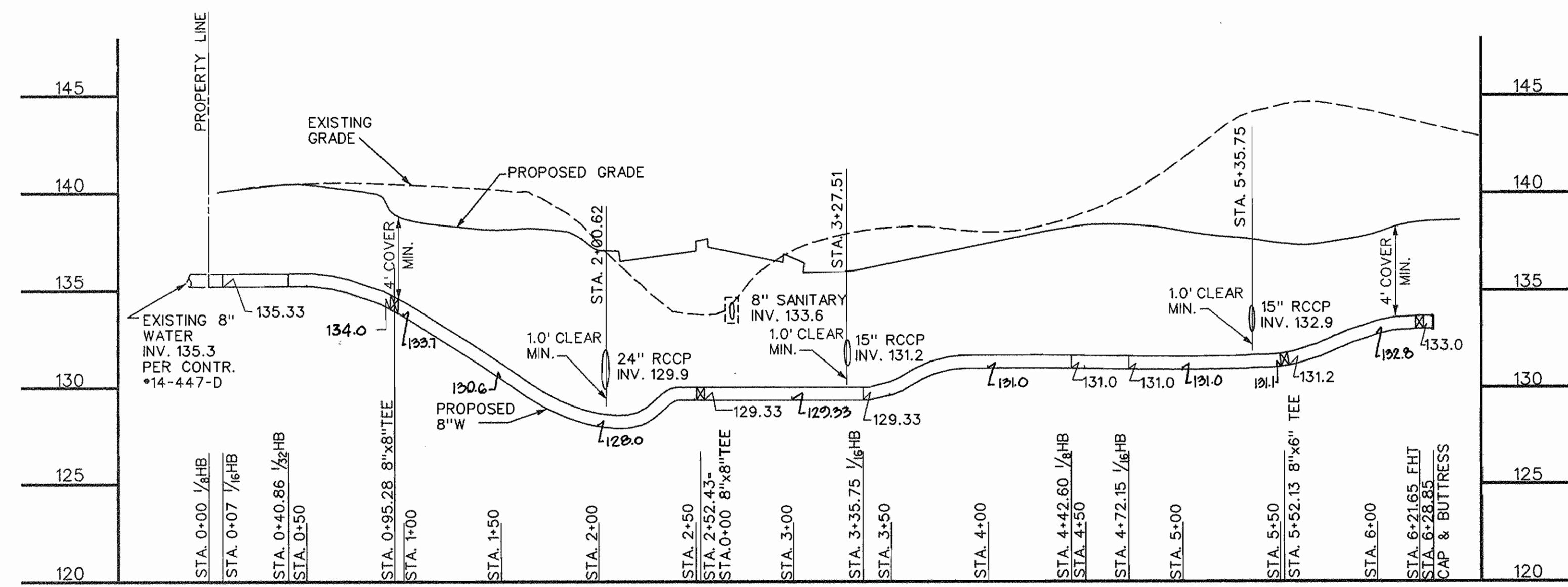

WATERMAIN PROFILE #1
 SCALE: HORIZ: 1"=50'
 VERT: 1"=5'

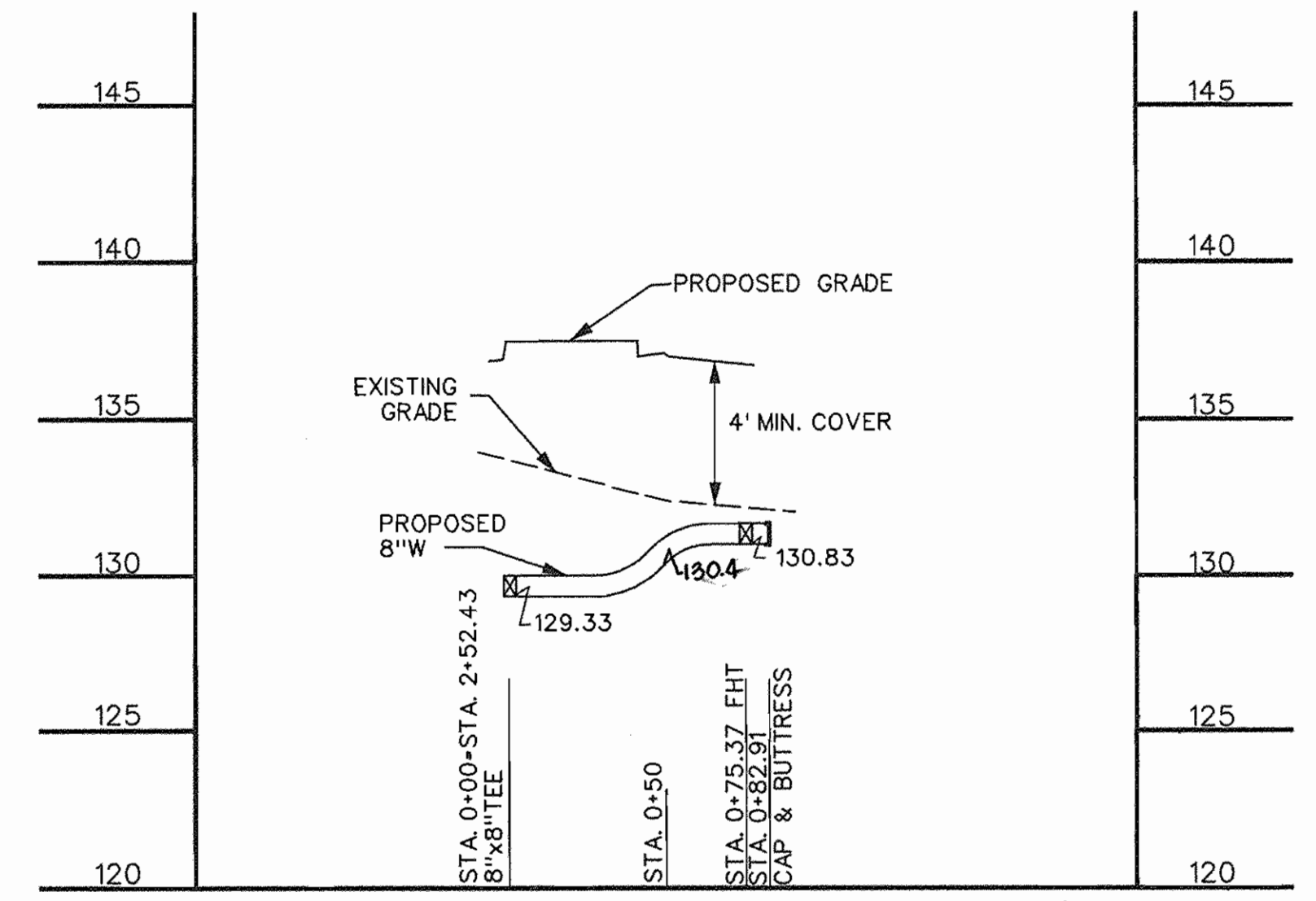

WATERMAIN PROFILE #2
 SCALE: HORIZ: 1"=50'
 VERT: 1"=5'

SEDIMENT CONTROL MEASURES FOR THIS CONTRACT WILL BE IMPLEMENTED IN ACCORDANCE WITH SECTION 219 OF THE STANDARD SPECIFICATIONS, SDP 98-104

THE DEVELOPMENT PLAN IS APPROVED FOR SOIL EROSION AND SEDIMENT CONTROL BY THE HOWARD SOIL CONSERVATION DISTRICT.
 APPROVED: *John K. Robertson* 6/15/98
 HOWARD SOIL CONSERVATION DISTRICT DATE

REVIEWED FOR HOWARD SOIL CONSERVATION DISTRICT AND MEETS TECHNICAL REQUIREMENTS.
Deepl Simmons 6/15/98
 U.S. SOIL CONSERVATION SERVICE DATE

DEPARTMENT OF PUBLIC WORKS
 HOWARD COUNTY, MARYLAND
Robert Berman 6-9-98
 CHIEF, BUREAU OF UTILITIES DATE

DEPARTMENT OF PLANNING & ZONING
 HOWARD COUNTY, MARYLAND
[Signature] 6/15/98
 CHIEF, DEVELOPMENT ENGINEERING DIVISION DATE

STV Incorporated
 engineers / architects / planners / scientists / construction managers
 21 Governor's Court, Baltimore, MD 21244-2722 (410) 944-9112



DES :	PGC
DRN :	KKK
CHK :	DLO
DATE:	
BY NO.	REVISION
	DATE
KCI 1 ASBUILT CONDITIONS ADDED TO PLAN 6-21-98	

WATER MAIN PROFILES
 CONTRACT NO. 44-3688-D
 600 SCALE MAP NO. 37,43 BLOCK NO. 6

**PUBLIC WATERMAIN DEERPETH ROAD
 DORSEY BUSINESS PARK
 PARCEL E
 "ASBUILT"**
 HOWARD COUNTY, MARYLAND
 ELECTION DISTRICT #1
 MAY 21, 1998
 SHEET 3 OF 3

GENERAL NOTES

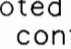
- Approximate location of existing mains are shown. The contractor shall take all necessary precautions to protect existing mains and services and maintain uninterrupted supply. Any damage incurred shall be repaired immediately to the satisfaction of the Engineer at the Contractor's expense.
- All horizontal controls are based on Maryland State Coordinates.
- All vertical controls are based on U.S.G.S. data.
- All pipe elevations shown are invert elevations.
- Clear all utilities by a minimum of 6". Clear all poles by 2'-0" minimum or tunnels required. The owner has contacted the utility companies and has made arrangements for bracing of poles as shown on the drawings. In the event the contractor's work requires the bracing of additional poles, any cost incurred by the owner for bracing of additional poles or damages shall be deducted from money owed the contractor. The contractor shall coordinate with the utility companies to schedule the bracing of the poles.
- For details not shown on the drawings, and for materials and construction methods use Howard County Design Manual, Volume IV, Standard Specifications and Detail for Construction (Latest Edition). The contractor shall have a copy of Volume IV on the job.
- Where test pits have been made on existing utilities, they are noted by the symbol  at the location of the test pit. A note or notes containing the results of the test pit or pits is included on the drawings. Existing utilities in the vicinity of the proposed work for which test pits have not been dug shall be located by the contractor two weeks in advance of construction operations at his own expense.
- Contractor shall notify the following utility companies or agencies at least five working days before starting work shown on these plans:

State Highway Administration	410-531-5533
Baltimore Gas & Electric Co. Contractor Services	410-850-4620
Baltimore Gas & Electric Co. Underground Damage Control	410-597-6377
Miss Utility	1-800-257-7777
Colonial Pipeline Co.	410-795-1590
Bureau of Utilities, Howard County Department of Public Works	410-313-4900
Bell Atlantic	1-800-446-5266
- Trees and shrubs are to be protected from damage to maximum extent. Trees and shrubs located within the construction strip are not to be removed or damaged by the contractor.
- Contractor shall remove trees, stumps and roots along line of excavation. Payment for such removal shall be included in the unit price bid for construction of the main.
- All fill areas within future roadway and under structures to be compacted to a minimum of 95% compaction as determined by AASHTO T-180.
- Valves adjacent to tees shall be strapped to tees.
- All water mains to be D.I.P. Class 52 unless otherwise noted.
- Tops of all water mains to have a minimum of 3'-1/2' cover unless otherwise noted.
- All fittings shall be buttressed or anchored with concrete in accordance with the Standard Details unless otherwise provided for on the drawings.
- Fire hydrants shall be set to the bury line elevations shown on the drawings. All fire hydrants shall be restrained and buttressed with concrete in accordance with Standard Details. Soil around the fire hydrant shall be compacted in accordance with Section 1000 and 1005 of the Standard specifications.
- The contractor shall notify the Bureau of Highways, Howard County, at (410) 313-2450 at least five working days before any open cut of any County road or boring/jacking operation in County roads for laying water/sewer mains or house connections. The approval of these drawings will constitute compliance with DPW requirements per Section 18.114(a) of the Howard County Code.
- The contractor shall not operate any water main valves on the existing water system.
- All water house connections shall be for inside meter setting unless otherwise noted on plans or in specifications.

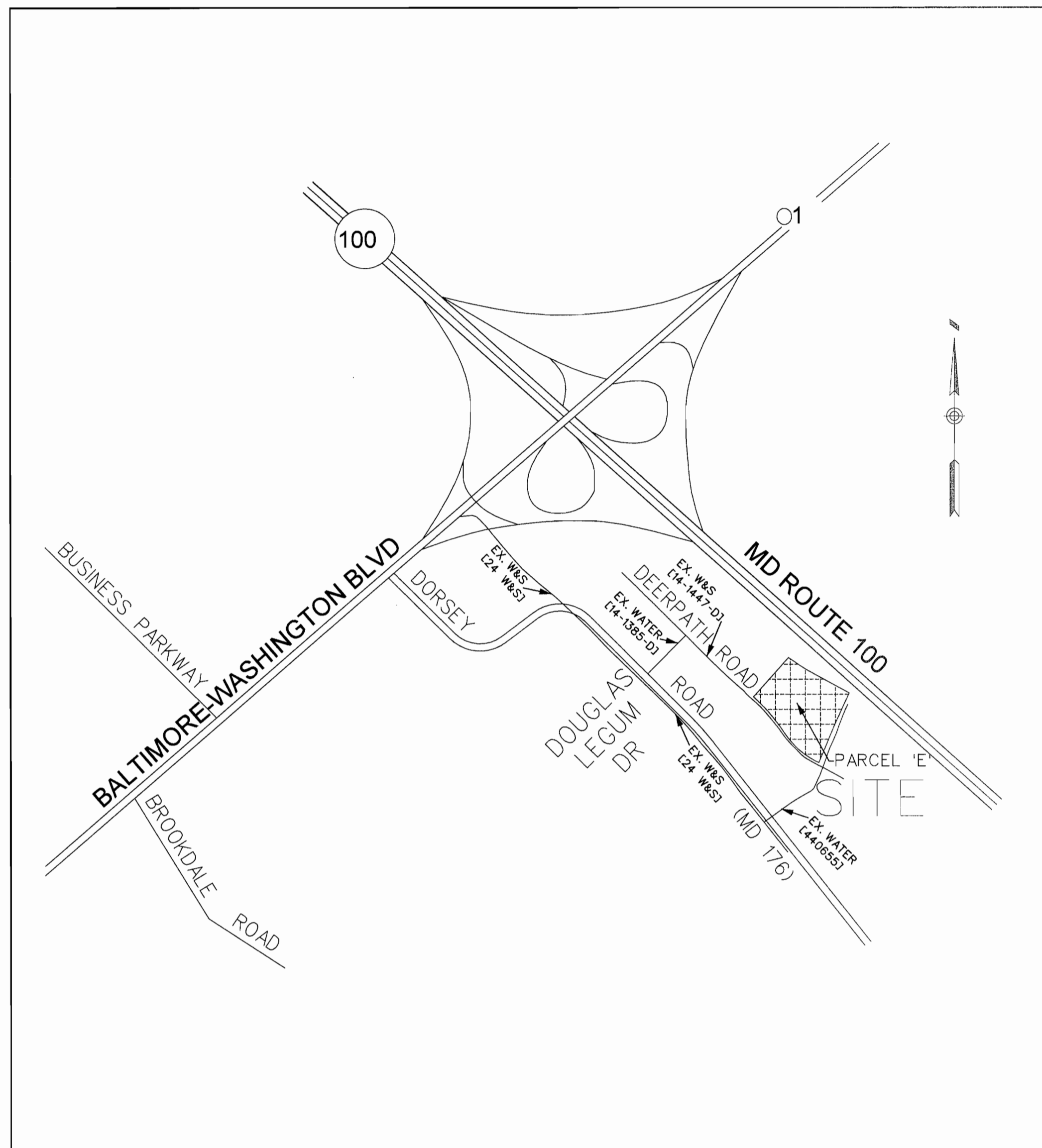

LOCATION MAP

Scale: 1"=600'

BUILDING TYPE: OFFICE
 No. OF LOTS: 1
 No. OF WATER H.C.: 1
 No. OF SEWER H.C.: 1
 DRAINAGE AREA: PATAPSCO
 WATER CODE: B01
 SEWER CODE: 2280000
 TEST GRADIENT ELEV.: 550
 TREATMENT PLANT: PATAPSCO

WATER CONSTRUCTION PLANS DORSEY BUSINESS PARK

PARCEL E
 HOWARD COUNTY, MARYLAND ELECTION DISTRICT #1
 CONTRACT NO. 44-3688-D

INDEX OF SHEETS

SHEET NO.	TITLE
1	COVER SHEET, GENERAL NOTES & LOCATION MAP
2	PLAN VIEW
3	PROFILES

BENCHMARK:

Howard County Geodetic Control No.: 371A - Elev.: 195.76
 Station is a 3/4" Iron Rod with a 4" Stamped aluminum cap.
 West side of Route 1, between edge of paving and iron fence,
 247' N. of CL main entrance of Meadowridge Memorial Park.

QUANTITIES

ITEMS	QUANTITIES ESTIMATED	AS-BUILT		
		QUANTITIES	TYPE	MANUFACTURER / SUPPLIER
8" D.I.P.	712 LF	712 EA		ATLANTIC STATES
6" D.I.P.	24 LF	24 EA		" "
6" FIRE HYDRANTS	2 EA	2 EA		MUELLER CO.
8" VALVE AND VALVE BOX	1 EA	1 EA		" "
6" VALVE AND VALVE BOX	3 EA	3 EA		" "
8" 1/8" HB	2 EA	3 EA		TYLER PIPE
8" 1/16" HB	3 EA	1 EA		" "
8" 1/32" HB	1 EA			" "
8" CAP & BUTTRESS	2 EA	2 EA		TYLER PIPE
8" X 8" TEE	2 EA	2 EA		" "
8" X 6" TEE	2 EA	2 EA		" "
8" X 6" FHT	2 EA	2 EA		" "

NAME OF UTILITY CONTRACTOR: *HAWKINS BROS.*
 SURVEY AND DRAFTING DIVISION AS-BUILT DATE _____

SEDIMENT CONTROL MEASURES FOR THIS CONTRACT WILL BE IMPLEMENTED IN ACCORDANCE WITH SECTION 219 OF THE STANDARD SPECIFICATIONS, SDP 98-104

THE DEVELOPMENT PLAN IS APPROVED FOR SOIL EROSION AND SEDIMENT CONTROL BY THE HOWARD SOIL CONSERVATION DISTRICT.

APPROVED: *John P. Robertson* 6/15/98
 HOWARD SOIL CONSERVATION DISTRICT DATE

REVIEWED FOR HOWARD SOIL CONSERVATION DISTRICT AND MEETS TECHNICAL REQUIREMENTS.

Carol Simmons 6/15/98
 U.S. SOIL CONSERVATION SERVICE DATE

DEPARTMENT OF PUBLIC WORKS
 HOWARD COUNTY, MARYLAND

Robert Beniger 6-9-98
 CHIEF, BUREAU OF UTILITIES DATE

DEPARTMENT OF PLANNING & ZONING
 HOWARD COUNTY, MARYLAND

John P. Robertson 6/15/98
 CHIEF, DEVELOPMENT ENGINEERING DIVISION DATE

STV Incorporated
 engineers / architects / planners / scientists / construction managers
 21 Governor's Court Baltimore, MD 21244-2722 (410) 946-9112



DES :	PGC
DRN :	KKK
CHK :	DLO
DATE :	
K.C.I. BY NO.	1 AS-BUILT CONDITIONS ADDED TO PLAN 10-21-98
REVISION	DATE

COVER SHEET,
 GENERAL NOTES &
 LOCATION MAP

CONTRACT NO. 44-3688-D
 600 SCALE MAP NO. 37,43 BLOCK NO. 6

PUBLIC WATERMAIN DEERPETH ROAD
 DORSEY BUSINESS PARK
 PARCEL E
 "AS-BUILT"

HOWARD COUNTY, MARYLAND
 ELECTION DISTRICT #1

MAY 21, 1998
 SHEET 1 OF 3

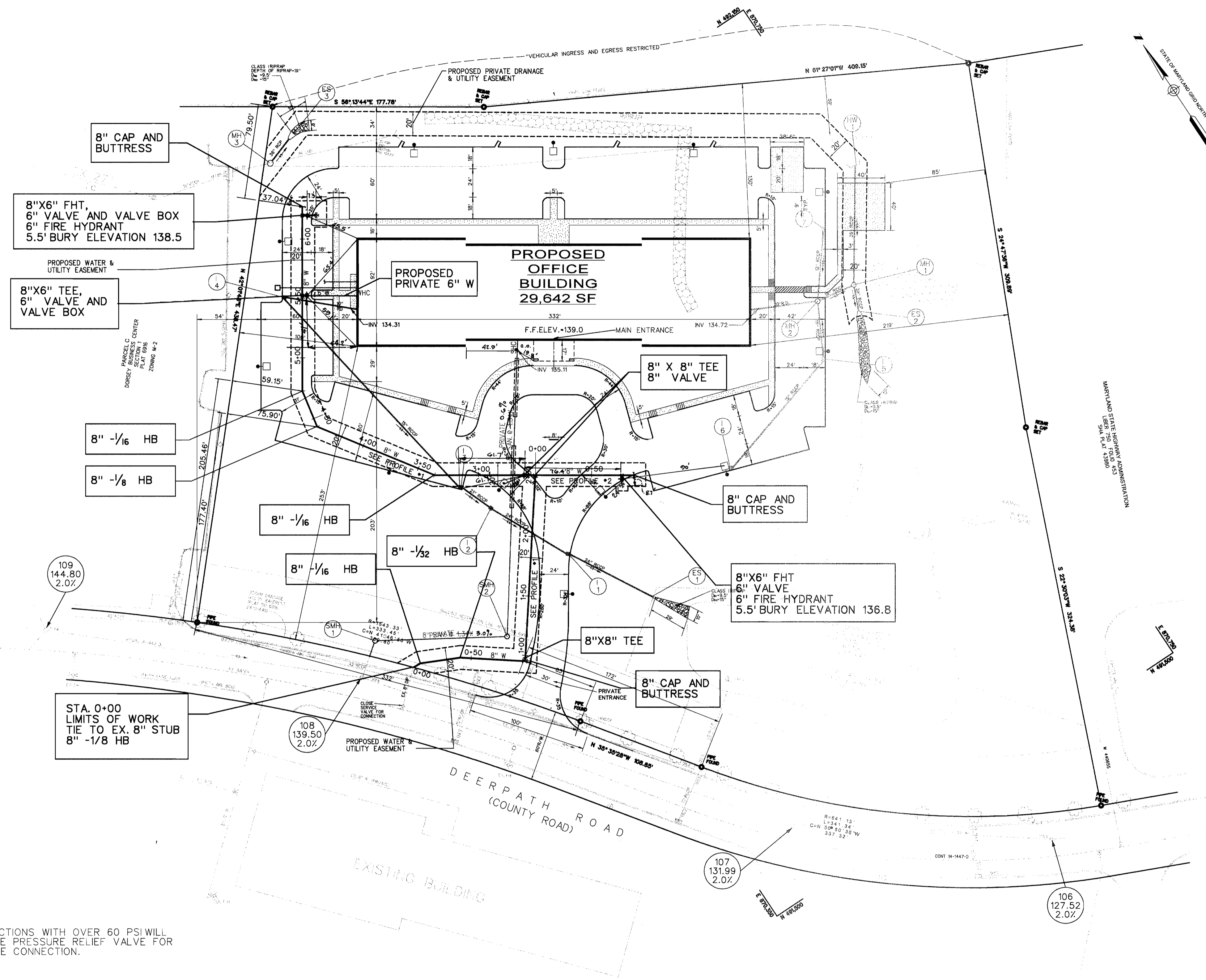

NOTE:
CONNECTIONS WITH OVER 60 PSI WILL
REQUIRE PRESSURE RELIEF VALVE FOR
SERVICE CONNECTION.

SCALE: 1"=50'

DORSEY BUSINESS
CENTRAL SECTION 1
PARCEL D
CONTRACT 24-1905-P

- LEGEND:**
- PROPOSED WATER MAIN
 - PROPOSED SANITARY SEWER
 - PROPOSED WATER VALVE, TEE & CROSS
 - EXISTING WATER VALVE, TEE & CROSS
 - EXISTING WATER FIRE HYDRANT

SEDIMENT CONTROL MEASURES FOR THIS CONTRACT WILL BE IMPLEMENTED IN ACCORDANCE WITH SECTION 219 OF THE STANDARD SPECIFICATIONS, SDP 98-104

THE DEVELOPMENT PLAN IS APPROVED FOR SOIL EROSION AND SEDIMENT CONTROL BY THE HOWARD SOIL CONSERVATION DISTRICT.

APPROVED: *John K. Polinton* 6/15/98
HOWARD SOIL CONSERVATION DISTRICT DATE

REVIEWED FOR HOWARD SOIL CONSERVATION DISTRICT AND MEETS TECHNICAL REQUIREMENTS.

Cheryl Simmons 6/15/98
U.S. SOIL CONSERVATION SERVICE DATE

DEPARTMENT OF PUBLIC WORKS
HOWARD COUNTY, MARYLAND

Robert W. Bevington 6-9-98
CHIEF, BUREAU OF UTILITIES DATE

DEPARTMENT OF PLANNING & ZONING
HOWARD COUNTY, MARYLAND

[Signature] 6/11/98
CHIEF, DEVELOPMENT ENGINEERING DIVISION DATE

STV Incorporated
engineers / architects / planners / scientists / construction managers
21 Governor's Court, Baltimore, MD 21244-2722 (410) 944-9112

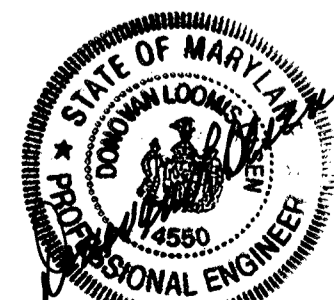

DES : PGC
DRN : MB
CHK : DLC
DATE:

NO.	REVISION	DATE
1	AS-BUILT CONDITIONS ADDED TO PLAN	05/21/98

WATER MAIN PLAN VIEW

CONTRACT NO. 44-3688-D

600 SCALE MAP NO. 37.43

**PUBLIC WATERMAIN DEERPETH ROAD
DORSEY BUSINESS PARK**

PARCEL E
"AS-BUILT"

HOWARD COUNTY, MARYLAND
ELECTION DISTRICT #1

MAY 21, 1998
SHEET 2 OF 3

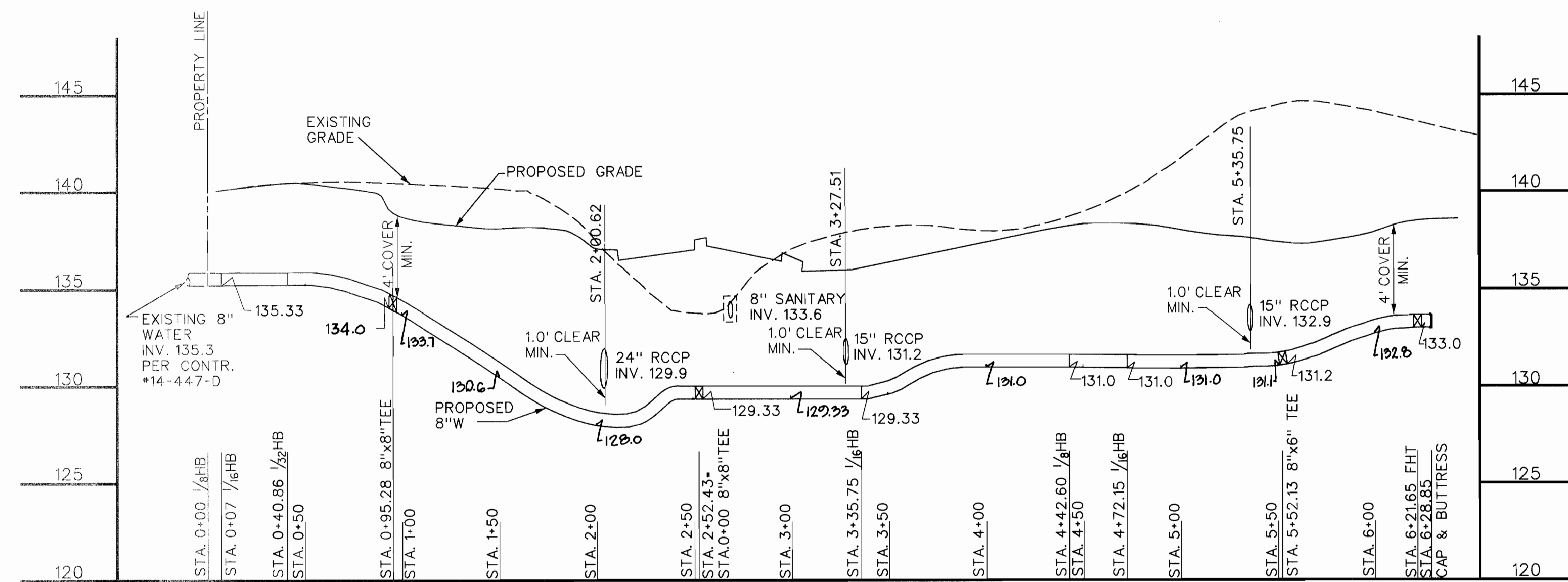

WATERMAIN PROFILE #1

SCALE: HORIZ: 1"=50'
VERT: 1"=5'

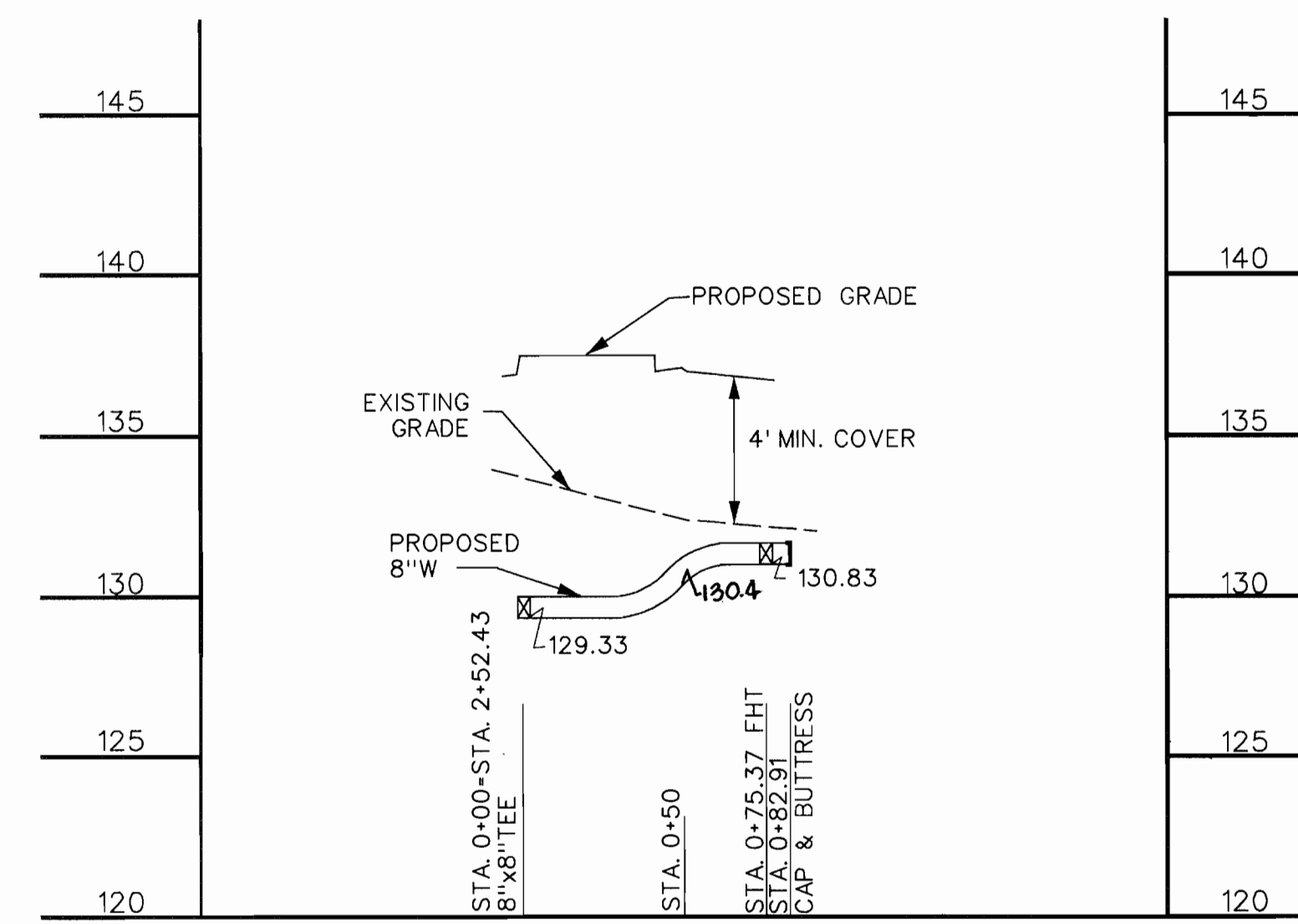

WATERMAIN PROFILE #2

SCALE: HORIZ: 1"=50'
VERT: 1"=5'

SEDIMENT CONTROL MEASURES FOR THIS CONTRACT WILL BE IMPLEMENTED IN ACCORDANCE WITH SECTION 219 OF THE STANDARD SPECIFICATIONS, SDP 98-104

THE DEVELOPMENT PLAN IS APPROVED FOR SOIL EROSION AND SEDIMENT CONTROL BY THE HOWARD SOIL CONSERVATION DISTRICT.

APPROVED: *[Signature]* 6/15/98
HOWARD SOIL CONSERVATION DISTRICT DATE

REVIEWED FOR HOWARD SOIL CONSERVATION DISTRICT AND MEETS TECHNICAL REQUIREMENTS.

[Signature] 6/15/98
U.S. SOIL CONSERVATION SERVICE DATE

DEPARTMENT OF PUBLIC WORKS
HOWARD COUNTY, MARYLAND

[Signature] 6-9-98
CHIEF, BUREAU OF UTILITIES DATE

DEPARTMENT OF PLANNING & ZONING
HOWARD COUNTY, MARYLAND

[Signature] 6/11/98
CHIEF, DEVELOPMENT ENGINEERING DIVISION DATE

STV Incorporated
engineers / architects / planners / scientists / construction managers
21 Governor's Circle, Baltimore, MD 21241-2722 (410) 944-9112



DES : PGC
DRN : KKK
CHK : DLO
DATE: 10-21-98

NO.	REVISION	DATE
1	AS BUILT CONDITIONS ADDED TO PLAN	10-21-98

WATER MAIN PROFILES

CONTRACT NO. 44-3688-D
600 SCALE MAP NO. 37,43

**PUBLIC WATERMAIN DEERPETH ROAD
DORSEY BUSINESS PARK**

PARCEL E
"ASBUILT"

HOWARD COUNTY, MARYLAND
ELECTION DISTRICT #1

MAY 21, 1998
SHEET 3 OF 3