

GENERAL NOTES

- PART I**
- Approximate location of existing mains are shown. The contractor shall take all necessary precautions to protect existing mains and services and maintain uninterrupted supply. Any damage incurred shall be repaired immediately to the satisfaction of the Engineer or the Contractor's expense.
 - All horizontal controls are based on Maryland State Coordinates (North American Datum of 1983 (NAD 83)).
 - All vertical controls are based on U.S. G. S. data.
 - All pipe elevations shown are invert elevations.
 - Clear all utilities by a minimum of 6". Clear all poles by 2' - 0" minimum or tunnel as required. The owner has contacted the utility companies and has made arrangements for bracing of poles as shown on the drawings. In the event the contractor's work requires the bracing of additional poles, any cost incurred by the owner for bracing of additional poles or damages shall be deducted from money owed the contractor. The contractor shall coordinate with the utility companies to schedule the bracing of the poles.
 - For details not shown on the drawings, and for materials and construction methods use Howard County Design Manual, Volume IV, Standard Specifications and Detail for Construction (Latest Edition). The contractor shall have a copy of Volume IV on the job.
 - Where test pits have been made on existing utilities, they are noted by the symbol at the location of the test pit. A note or notes containing the result of the test pit is included on the drawings. Existing utilities in the vicinity of the proposed work for which test pits have not been dug shall be located by the contractor two weeks in advance of construction operations at his own expense.
 - Contractor shall notify the following utility companies or agencies at least five (5) working days before starting work shown on these plans:
 AT & T 855-3903
 BGE - (Contractor Services) 850-4620
 BGE - (Underground Damage Control) 787-9068
 Bureau of Utilities (BPU) 315-4900
 Chesapeake & Potomac Telephone Co. 597-8585
 Colonial Pipeline Co. 795-1390
 Miss Utility (800)257-7777
 State Highway Administration 531-5533
 - Trees and shrubs are to be protected from damage to maximum extent. Trees and shrubs located within the construction strip are not to be removed or damaged by the contractor.
 - Contractor shall remove trees, stumps and roots along line of excavation. Payment for such removal shall be included in the unit price for construction of the main.
 - The contractor shall notify the Bureau of Highways, Howard County, at (410) 313-2450 at least five (5) working days before any open cut of a County road or boring/packing operation in County roads for laying water / sewer mains or house connections. The approval of these drawings will constitute compliance with DPM requirements per Section 18.114 (c) of the Howard County Code.
- PART II - WATER**
- All water mains shall be D.I.P. Class 52 unless otherwise noted.
 - Top of all water mains to have a minimum of 3' - 1/2' cover unless otherwise noted.
 - Valves adjacent to tees shall be strapped to tees.
 - All fittings shall be buttressed or anchored with concrete in accordance with the Standard Details unless otherwise provided for on the drawings.
 - Fire hydrants shall be set to the bury line elevations shown on the drawings. All fire hydrants shall be restrained and buttressed with concrete in accordance with the Standard Details. Soil around the fire hydrant shall be compacted in accordance with Section 1000 and 1005 of the Standard Specifications.
 - The contractor shall not operate any water main valves on the existing water system.
 - All water house connections shall be for inside meter setting unless otherwise noted on plans or in specifications.
 - For sprinkler system for all townhomes or multi-family dwelling units should have a minimum of 1' connection with a 3/4" meter.
- PART III - SEWER**
- All sewer mains shall be P.V.C. or D.I.P. Class 52 unless otherwise noted.
 - All manholes shall be 4' - 0" inside diameter unless otherwise noted.
 - Force mains shall be D. I. P. only.
 - Manholes designated W.I. in plan and profile shall have watertight frame and covers. Standard Detail 65.52. Where watertight frame and cover is used, set top of frame 1" above finished grade unless otherwise noted on the drawings.
 - House(s) with the symbol "C.N.S." indicated that cellar cannot be served.

QUANTITIES

ITEMS	QUANTITIES ESTIMATED	AS BUILT		
		QUANTITIES	TYPE	MANUFACTURER / SUPPLIER
12" x 8" TAPPING SLEEVE & VALVE	1 EA	1 EA	AMERICAN FLOW	FERGUSON ENTERPRISES
8" WATER MAIN	388 LF	388 LF	GRIFFIN PIPE	"
8" 1/16 HOR BEND	2 EA	2 EA	TYLER/UNION	"
8" x 6" TEES	2 EA	1 EA	"	"
6" VALVES	1 EA	1 EA	AMERICAN FLOW	"
6" WATER MAIN	8 LF	8 LF	GRIFFIN PIPE	"
FIRE HYDRANTS	1 EA	1 EA	AMERICAN FLOW	"
8"x8" TEE	1 EA	1 EA	TYLER/UNION	"
8" VALVE	2 EA	2 EA	AMERICAN FLOW	"
8" PLUG & BUTTRESS	1 EA	1 EA	TYLER/UNION	"
SEWER MANHOLES (13.5')	3 EA	3 EA	CONCRETE PIPE	AND PRODUCTS
8" P.V.C.	216 LF	216 LF	I PEX	I PEX
8" HOUSE CONNECTION	15 LF	15 LF	"	"
CHECKBOX				
AS-BUILT DATE				
SURVEY AND DRAFTING DIVISION				

Sediment control measures for this contract will be implemented in accordance with section 219 of the Specifications and as shown on SP-97-10

Cheryl Simmons 11/12/97
 Review for Howard Soil Conservation District and meets technical requirements

John Robertson 11/12/97
 HOWARD SOIL CONSERVATION DISTRICT DATE

GERALD A. OTTEN
 2/9/69
 USE: RESIDENTIAL

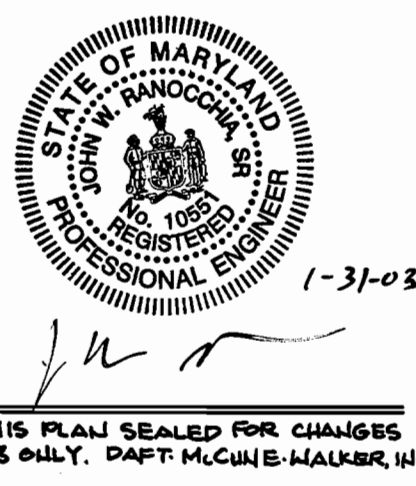

DEPARTMENT OF PUBLIC WORKS
 HOWARD COUNTY, MARYLAND

Robert Berman 10-30-97
 CHIEF, BUREAU OF UTILITIES DATE

DEPARTMENT OF PLANNING & ZONING
 HOWARD COUNTY, MARYLAND

John D. ... 11/5/97
 CHIEF, DEVELOPMENT ENGINEERING DIVISION DATE

SITE RESOURCES
 Incorporated
 Comprehensive Land Planning & Site Design Services

1738 Boggs Road • Forest Hill, Maryland 21050
 (410) 879-8964 • fax (410) 879-8965

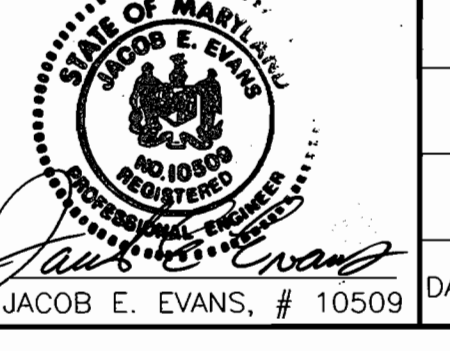

DES: JEE			
DRN: DAM			
CHK: JEE			
DATE: 10/28/97			
BY NO.	REVISION	DATE	
DMW 3	10" STEEL SLEEVE & MH 5-1000 ADDED	10/02	
KCI 2	AS BUILT CONDITIONS ADDED TO PLAN	6/99	
ODM 1	WATER & SEWER CONNECTION	9/17/90	

WATER AND SEWER PLAN

600 SCALE MAP NO. 24 BLOCK NO. 6

PARK VIEW AT ELLICOTT CITY
 PARCEL 56
 2nd ELECTION DISTRICT
 HOWARD COUNTY, MARYLAND
 CONTRACT 14-3642-D

SCALE: 1"=50'
 SHEET 1 OF 2

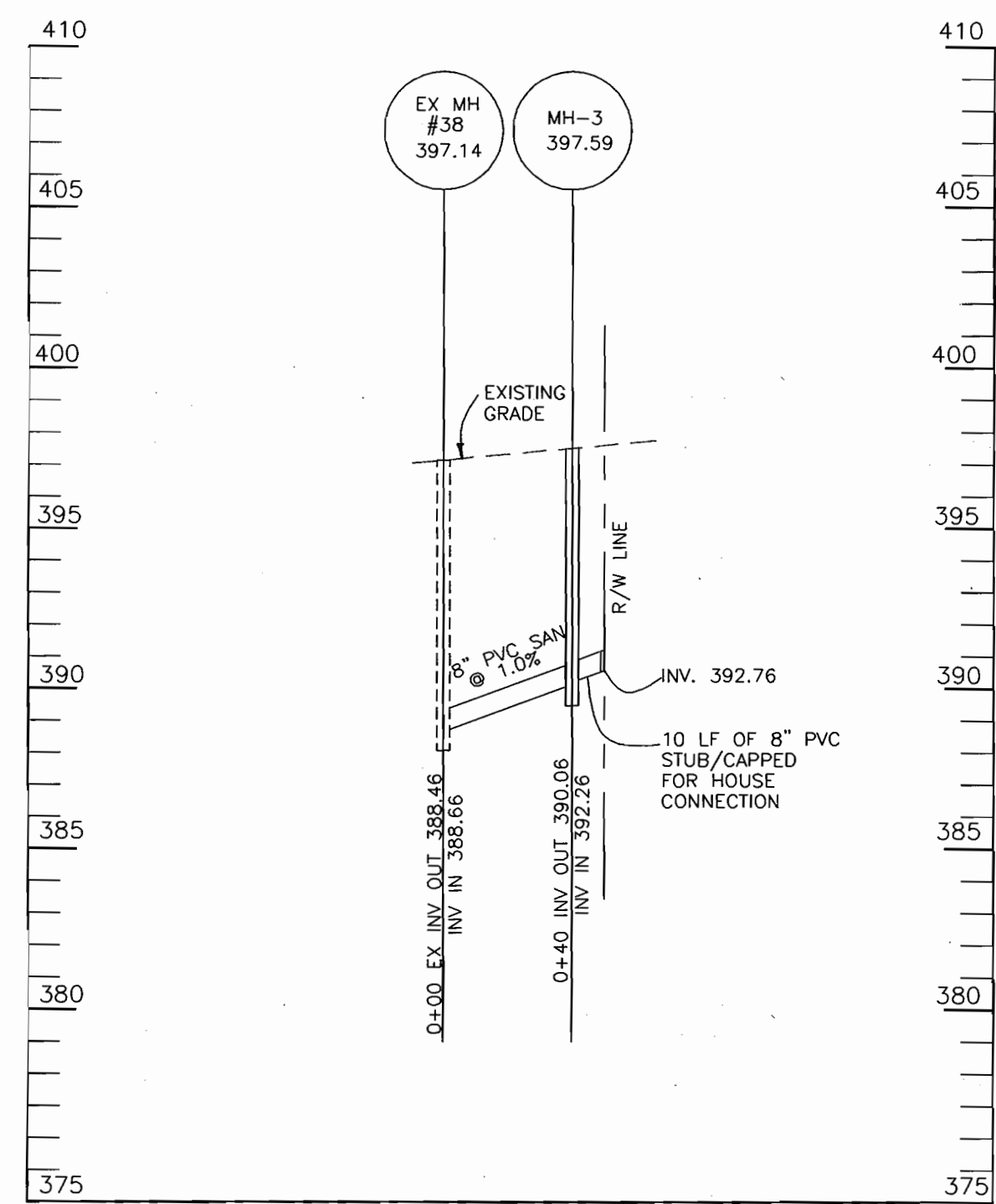

SEWER PROFILE

SCALE:
HOR: 1"=50'
VERT: 1"=5'

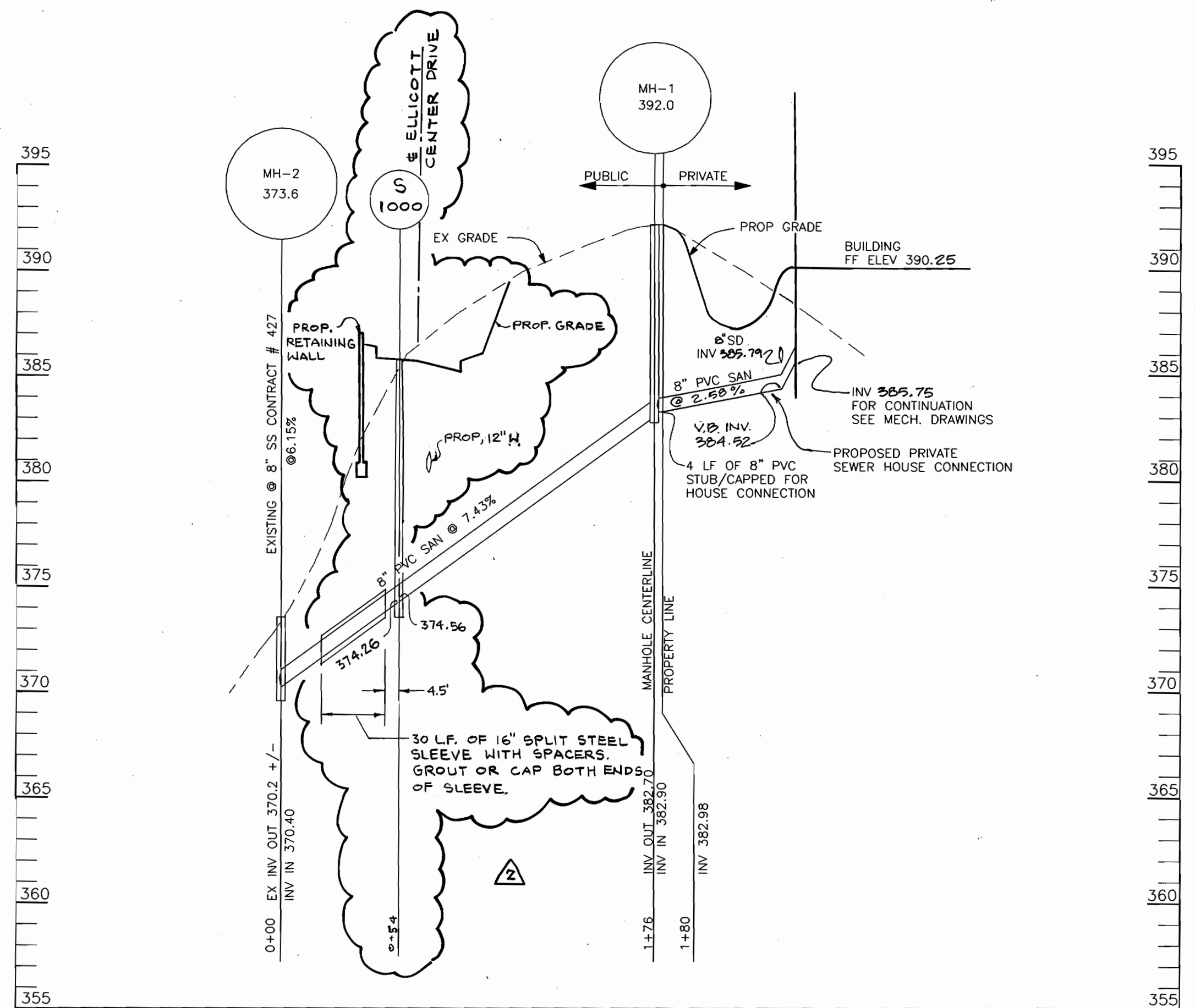

SEWER PROFILE

SCALE:
HOR: 1"=50'
VERT: 1"=5'

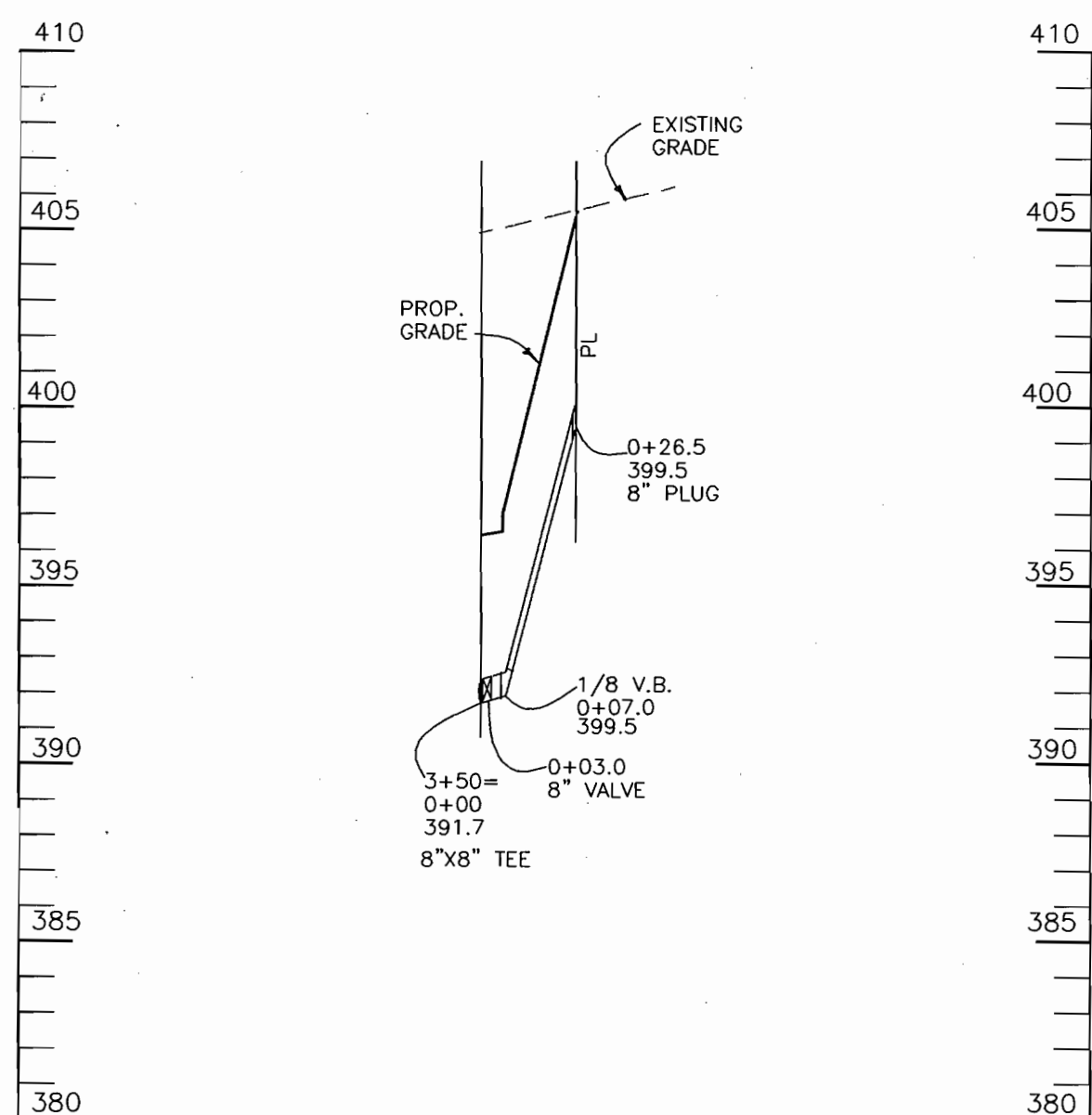

WATER PROFILE

SCALE:
HOR: 1"=50'
VERT: 1"=5'

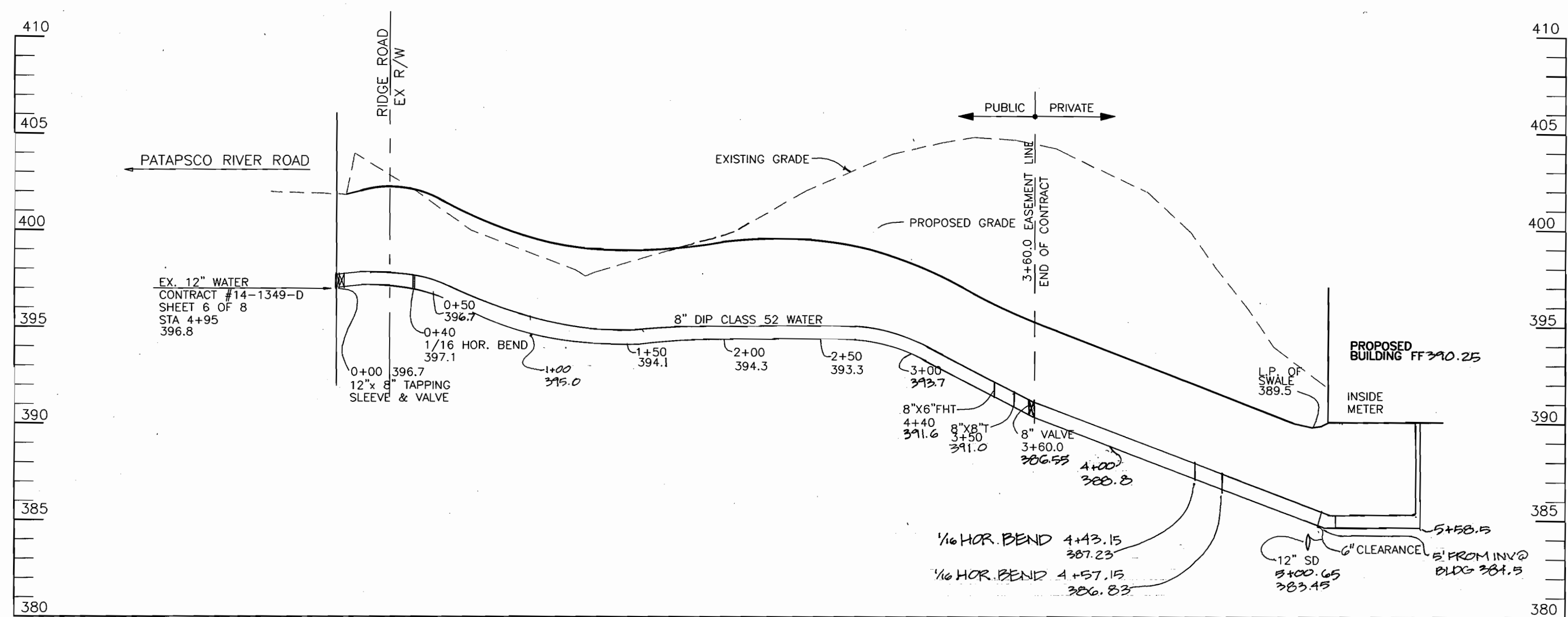

WATER PROFILE

SCALE:
HOR: 1"=50'
VERT: 1"=5'



1-31-03

THIS PLAN SEALED FOR CHANGE #2 ONLY. DANT McGUIRE WALKER, INC.

Sediment control measures for this contract will be implemented in accordance with section 219 of the Specifications and as shown on 'SDP'.

Cheryl Simms 11/12/97

Review for Howard Soil Conservation District and meets technical requirements.

John R. Deaton 11/12/97

HOWARD SOIL CONSERVATION DISTRICT DATE

DEPARTMENT OF PUBLIC WORKS
HOWARD COUNTY, MARYLAND

DEPARTMENT OF PLANNING & ZONING
HOWARD COUNTY, MARYLAND

SITE RESOURCES
incorporated
Comprehensive Land Planning & Site Design Services
1738 Boggs Road • Forest Hill, Maryland 21050
(410) 879-6964 • fax (410) 879-6965

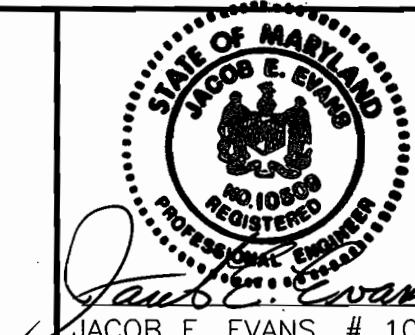

DES:	JEE				
DRN:	DAM				
CHK:	JEE				
DRAWN BY:	DAM	2.	16" STEEL SLEEVE & MH S-1000 ADDED	1/03	
DATE:					10/28/97
REVISION:	1.		WATER & SEWER PROFILES		9/17/98

WATER AND SEWER PROFILES

PARK VIEW AT ELLICOTT CITY
PARCEL 56
2nd ELECTION DISTRICT
HOWARD COUNTY, MARYLAND
CONTRACT

SCALE:
AS SHOWN

SHEET
2 OF 2