

QUANTITY TABLE

ITEMS	QUANTITIES ESTIMATED			
		QUANTITIES	TYPE	MANUFACTURER/SUPPLIER
STANDARD MH	17			
TYPE "B" DROP @ MANHOLE	3			
8" SEWER MAIN	2,726 L.F.			
8" DIP SEWER MAIN	475 L.F.			
4" SEWER HOUSE CONNECTION	1,081 L.F.			
# SEWER HOUSE CONNECTIONS	34			
# MH CONNECTIONS	8			
8" DIP WATER	1,164 L.F.			
6" DIP WATER	35 L.F.			
4" DIP WATER	636 L.F.			
F.H.	3			
F.H.T.	3			
8"x4" TS&V	1			
8"x8" T	1			
8"x4" T	2			
8" V	6			
4" V	2			
8" CAP & BUTTRESS	2			
4" CAP & BUTTRESS	3			
# WATER HOUSE CONNECTIONS	18			
# TWIN WATER HOUSE CONNECTIONS	12			
3/4" WATER HOUSE CONNECTION	379 L.F.			
1" WATER HOUSE CONNECTION	282 L.F.			
WATERTIGHT MANHOLES	5			
1 1/2" DRAINS	3			
OUTSIDE WATER METER (W3.31)	1			
TYPE "A" DROP @ MANHOLE	3			
NAME OF UTILITY CONTRACTOR:				
SURVEY AND DRAFTING DIVISION AS-BUILT DATE				

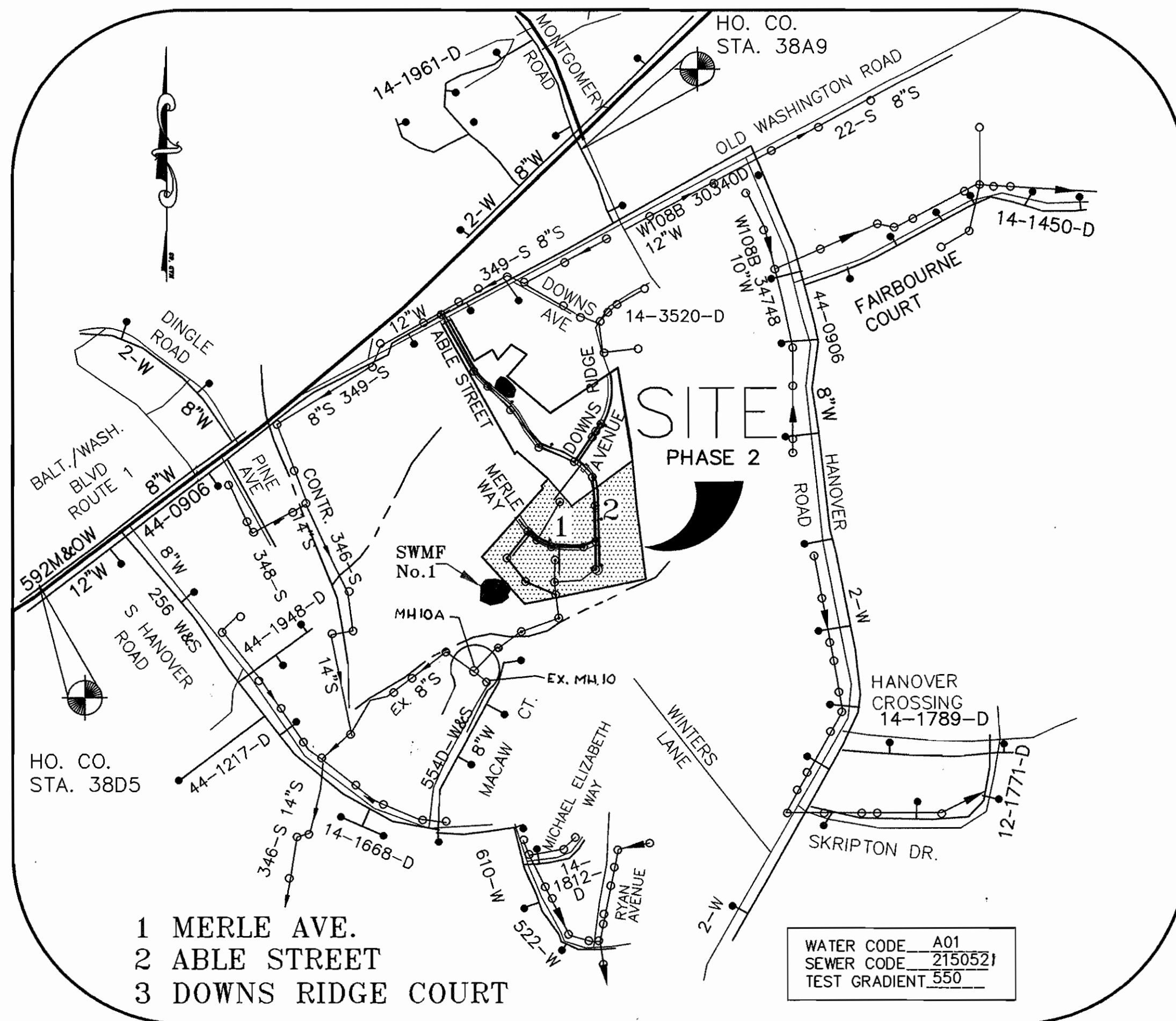

VICINITY MAP

SCALE: 1"=600'

TYPE OF BUILDING	SFD
No. OF UNITS	42
No. OF TWIN WATER HOUSE CONNECTIONS	12
No. OF WATER HOUSE CONNECTIONS	18
No. OF SEWER HOUSE CONNECTIONS	42
DRAINAGE AREA	PATAPSCO
TREATMENT PLANT	PATAPSCO WASTE WATER TREATMENT PLANT

GENERAL NOTES

- APPROXIMATE LOCATION OF EXISTING MAINS ARE SHOWN. THE CONTRACTOR SHALL TAKE ALL NECESSARY PRECAUTIONS TO PROTECT EXISTING MAINS AND SERVICES AND MAINTAIN UNINTERRUPTED SUPPLY. ANY DAMAGE INCURRED SHALL BE REPAIRED IMMEDIATELY TO THE SATISFACTION OF THE ENGINEER AT THE CONTRACTOR'S EXPENSE.
- ALL HORIZONTAL CONTROLS ARE BASED ON MARYLAND STATE COORDINATES (NAD '83)
- ALL VERTICAL CONTROLS ARE BASED ON U.S.G.S. DATA.
- ALL PIPE ELEVATIONS SHOWN ARE INVERT ELEVATIONS.
- CLEAR ALL UTILITIES BY A MINIMUM OF 6". CLEAR ALL POLES BY 2'-0" MINIMUM OR TUNNEL REQUIRED. THE OWNER HAS CONTACTED THE UTILITY COMPANIES AND HAS MADE ARRANGEMENTS FOR BRACING OF POLES AS SHOWN ON THE DRAWINGS. IN THE EVENT THE CONTRACTOR'S WORK REQUIRES THE BRACING OF ADDITIONAL POLES, ANY COST INCURRED BY THE OWNER FOR BRACING OF ADDITIONAL POLES OR DAMAGES SHALL BE DEDUCTED FROM MONEY OWED THE CONTRACTOR. THE CONTRACTOR SHALL COORDINATE WITH THE UTILITY COMPANIES TO SCHEDULE THE BRACING OF THE POLES.
- FOR DETAILS NOT SHOWN ON THE DRAWINGS, AND FOR MATERIALS AND CONSTRUCTION METHODS USE HOWARD COUNTY DESIGN MANUAL, VOLUME IV, STANDARD SPECIFICATIONS AND DETAIL FOR CONSTRUCTION (LATEST EDITION). THE CONTRACTOR SHALL HAVE A COPY OF VOLUME IV ON THE JOB.
- WHERE TEST PITS HAVE BEEN MADE ON EXISTING UTILITIES, THEY ARE NOTED BY THE SYMBOL AT THE LOCATION OF THE TEST PIT. A NOTE OR NOTES CONTAINING THE RESULTS OF THE TEST PIT OR PITS IS INCLUDED ON THE DRAWINGS. EXISTING UTILITIES IN THE VICINITY OF THE PROPOSED WORK FOR WHICH TEST PITS HAVE NOT BEEN DUG SHALL BE LOCATED BY THE CONTRACTOR TWO WEEKS IN ADVANCE OF CONSTRUCTION OPERATIONS AT HIS OWN EXPENSE. CONTRACTOR SHALL NOTIFY THE FOLLOWING UTILITY COMPANIES OR AGENCIES AT LEAST FIVE WORKING DAYS BEFORE STARTING WORK SHOWN ON THESE PLANS:

STATE HIGHWAY ADMINISTRATION	531-5533
BG & E CO. CONTRACTOR SERVICES	850-4620
BG & E CO. UNDERGROUND DAMAGE CONTROL	787-9068
MISS UTILITY	1-800-257-7777
COLONIAL PIPELINE CO.	795-1390
HOWARD COUNTY DEPARTMENT OF PUBLIC WORKS	
BUREAU OF UTILITIES	313-4900
- TREES AND SHRUBS ARE TO BE PROTECTED FROM DAMAGE TO THE MAXIMUM EXTENT. TREES AND SHRUBS LOCATED WITHIN THE CONSTRUCTION STRIP ARE NOT TO BE REMOVED OR DAMAGED BY THE CONTRACTOR.
- CONTRACTOR SHALL REMOVE TREES, STUMPS AND ROOTS ALONG LINE OF EXCAVATION. PAYMENT FOR SUCH REMOVAL SHALL BE INCLUDED IN THE UNIT PRICE BID FOR CONSTRUCTION OF THE MAIN.
- ALL WATER MAINS TO BE D.I.P. CLASS 52 UNLESS OTHERWISE NOTED.
- TOPS OF ALL WATER MAINS TO HAVE A MINIMUM OF 3-1/2" COVER UNLESS OTHERWISE NOTED.
- VALVES ADJACENT TO TEES SHALL BE STRAPPED TO TEES.
- ALL FITTINGS SHALL BE BUTTRESSED OR ANCHORED WITH CONCRETE IN ACCORDANCE WITH THE STANDARD DETAILS UNLESS OTHERWISE PROVIDED FOR ON THE DRAWINGS.
- FIRE HYDRANTS SHALL BE SET TO THE BURY LINE ELEVATIONS SHOWN ON THE DRAWINGS. ALL FIRE HYDRANTS SHALL BE STRAPPED AND BUTTRESSED WITH CONCRETE IN ACCORDANCE WITH STANDARD DETAILS. SOIL AROUND THE FIRE HYDRANT SHALL BE COMPACTED IN ACCORDANCE WITH SECTION 1000 AND 1005 OF THE STANDARD SPECIFICATIONS.
- THE CONTRACTOR SHALL NOT OPERATE ANY WATER MAIN VALVES ON THE EXISTING WATER SYSTEM.
- ALL WATER HOUSE CONNECTIONS SHALL BE FOR INSIDE METER SETTING UNLESS OTHERWISE NOTED ON PLANS OR IN SPECIFICATIONS.
- ALL SEWER MAINS SHALL BE P.V.C. UNLESS OTHERWISE NOTED.
- THE CONTRACTOR SHALL PROVIDE A JOINT IN ALL SEWER MAINS WITH 2'-0" OF EXTERIOR MANHOLE WALL.
- ALL MANHOLES SHALL BE 4'-0" INSIDE DIAMETER UNLESS OTHERWISE NOTED.
- FORCE MAINS SHALL BE D.I.P. ONLY.
- MANHOLES SHOWN WITH 12" AND 16" WALLS ARE FOR BRICK MANHOLES ONLY.
- MANHOLES DESIGNATED W.T. IN PLAN AND PROFILE SHALL HAVE WATERTIGHT FRAME AND COVERS, STANDARD DETAIL G5.32. WHERE WATERTIGHT MANHOLE FRAME AND COVER IS USED, SET TOP OF FRAME 1" - 6" ABOVE FINISHED GRADE UNLESS OTHERWISE NOTED ON THE DRAWINGS.
- HOUSE(S) WITH THE SYMBOL "C.N.S." INDICATES THAT CELLAR CANNOT BE SERVED.
- STATIONING SHOWN IS WATER MAIN AND CENTER LINE STATIONING.
- ALL CLEANOUTS AND BALL VALVES ARE TO BE LOCATED AT THE WATER, SEWER AND UTILITY EASEMENT LINE.
- CONTRACTOR TO VERIFY THE LOCATION OF ALL EXISTING UTILITIES PRIOR TO COMMENSING CONSTRUCTION.
- SEDIMENT CONTROL TO BE PROVIDED BY F-97-110, ALL WATER AND SEWER CONSTRUCTION TO BE INSIDE F-97-154'S LIMIT OF DISTURBANCE.
- STORM DRAIN SYSTEM INDICATED FOR INFORMATIONAL PURPOSES ONLY. SEE ROAD PLANS FOR CONSTRUCTION DATA.

**CONTRACT NO. 14-3637-D:
WILLIAMS KNOLL, SECTION II
LOTS 42 THRU 84
A RESUBDIVISION OF WILLIAMS KNOLL
SECTION I, BULK PARCEL A.
WATER AND SEWER MAIN EXTENSIONS
HOWARD COUNTY, MARYLAND
DEPARTMENT OF PUBLIC WORKS**

SHEET INDEX

NO.	DESCRIPTION
1	TITLE SHEET
2	WATER AND SEWER PLAN
3	WATER PROFILES
4	WATER PROFILES
5	SEWER PROFILES
6	SEWER PROFILES
7	SEWER PROFILES
8	SEDIMENT CONTROL

I/WE CERTIFY THAT ALL DEVELOPMENT AND CONSTRUCTION WILL BE DONE ACCORDING TO THIS PLAN, AND THAT ANY RESPONSIBLE PERSONNEL INVOLVED IN THE CONSTRUCTION PROJECT WILL HAVE A CERTIFICATE OF ATTENDANCE AT A DEPARTMENT OF THE ENVIRONMENT APPROVED TRAINING PROGRAM FOR THE CONTROL OF SEDIMENT AND EROSION BEFORE BEGINNING THE PROJECT. I ALSO AUTHORIZE PERIODIC ON-SITE INSPECTION BY THE HOWARD SOIL CONSERVATION DISTRICT.

JNSD, LG 10-13-97
By *James L Newburn* DATE
DEVELOPER'S SIGNATURE
DEVELOPER'S NAME

I HEREBY CERTIFY THAT THIS PLAN FOR EROSION AND SEDIMENT CONTROL REPRESENTS A PRACTICAL AND WORKABLE PLAN BASED ON MY PERSONAL KNOWLEDGE OF THE SITE CONDITIONS AND THAT IT WAS PREPARED IN ACCORDANCE WITH THE REQUIREMENTS OF THE HOWARD SOIL CONSERVATION DISTRICT.

R. JAGB HIKMAT 10/14/97
ENGINEER'S SIGNATURE DATE
ENGINEER'S NAME

REVIEWED FOR HOWARD SCD AND MEET TECHNICAL REQUIREMENTS.

Cheryl Simmons 10/22/97
USDA-NATURAL RESOURCES DATE
CONSERVATION SERVICE

THIS DEVELOPMENT PLAN IS APPROVED FOR SOIL EROSION AND SEDIMENT CONTROL BY THE SOIL CONSERVATION DISTRICT. (F-97-154)

John R. Robertson 10/22/97
HOWARD SCD DATE

DPZ REFERENCE NUMBERS

S	95-08
P	96-20
WP	96-69
AA	96-19
F-97-110	F-97-154

DEPARTMENT OF PUBLIC WORKS
HOWARD COUNTY, MARYLAND

Michael A. Simanillo 10-20-97
CHIEF, BUREAU OF UTILITIES DATE

DEPARTMENT OF PLANNING & ZONING
HOWARD COUNTY, MARYLAND

John R. Robertson 10/24/97
CHIEF, DEVELOPMENT ENGINEERING DIVISION DATE

MILDENBERG, BOENDER & ASSOC., INC.
Engineers Planners Surveyors
5072 Dorsey Hall Drive, Suite 202, Beltsville City, Maryland 21042
(410) 997-0286 Bulk (301) 621-5521 Wash. (410) 997-0286 Fax



engineering SD					
illustration SD					
approval					
project	95136	RCJ	1	CHANGE # OF MANHOLES	5-28-98
date	OCT 1997	BY	NO.	REVISION	DATE

TITLE SHEET

600' SCALE MAP NO. 38 BLOCK NO. 8

**WILLIAMS KNOLL, SECTION II
LOTS 42-84
A RESUBDIVISION OF WILLIAMS KNOLL,
SECTION I, BULK PARCEL A**

CONTRACT NO. 14-3637-D
FIRST ELECTION DISTRICT
HOWARD COUNTY, MARYLAND

scale AS SHOWN
1 OF 8

95136/PHASE2/FINAL/PHASE2/MS&S/COV2.DWG

WATER MAIN TABULATION CHART

ABEL STREET		
STATION	APPURTENANCE	DIST. FROM CL
11+74	8"x8" TS&V	7' LT.
11+86	1 1/2" D	217' RT.
11+85	4" C & B	218' RT.
14+83.5	8"x6" F.H.T.	7' LT.
14+83.5	6" V	9' LT.
14+83.82	F.H.	15.80' LT.
14+85	8" V	7' LT.
15+72	8" V	7' LT.
15+74	8"x8" T	7' LT.
15+76	8" V	7' LT.
17+10	8" V	7' LT.
17+10	8" V	7' LT.
17+10	F.H.	22' RT.
17+76	8" C&B	7' LT.

MERLE WAY		
STATION	APPURTENANCE	DIST. FROM CL
2+48	8" V	7' RT.
2+49	1 1/2" D	188' LT.
2+49	4" C&B	190' LT.
2+50	8"x4" T	7' RT.
2+50	4" V	5' RT.
2+52	8" V	7' RT.
4+31	8" V	7' RT.
4+33	8" x 4" T	7' RT.
4+33	8" V	5' RT.
4+40	1 1/2" D	202' LT.
4+40	4" C&B	204' LT.
4+90	8"x6" F.H.T.	7' RT.
4+90	6" V	9' RT.
4+90	F.H.	16' RT.
5+46	8" C&B	7' RT.
4+35	8" V	7' RT.

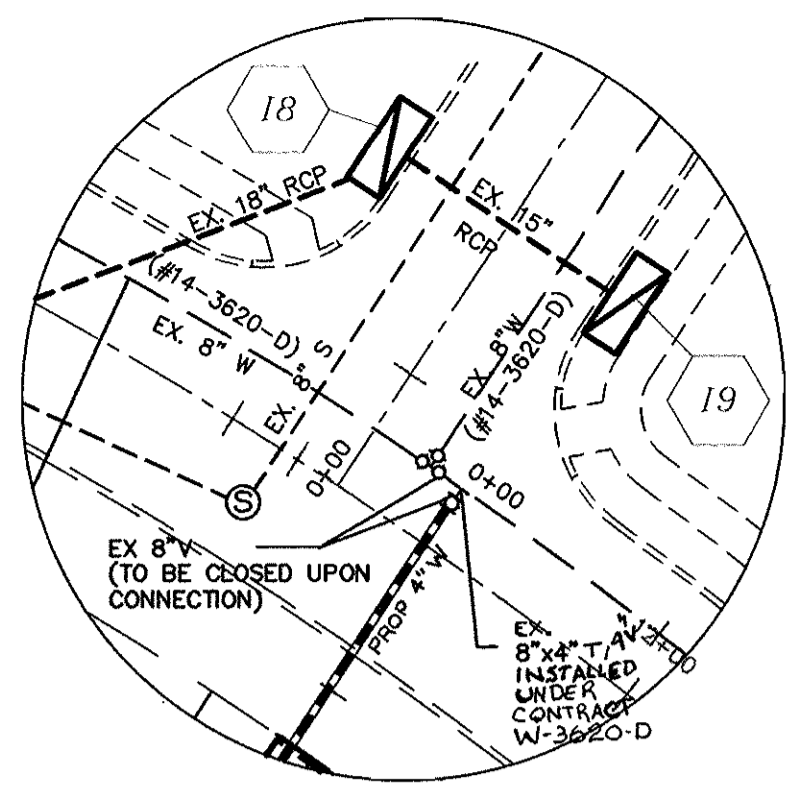

DETAIL A
SCALE: 1"=20'

SEE MATCHLINE A-A
THIS SHEET

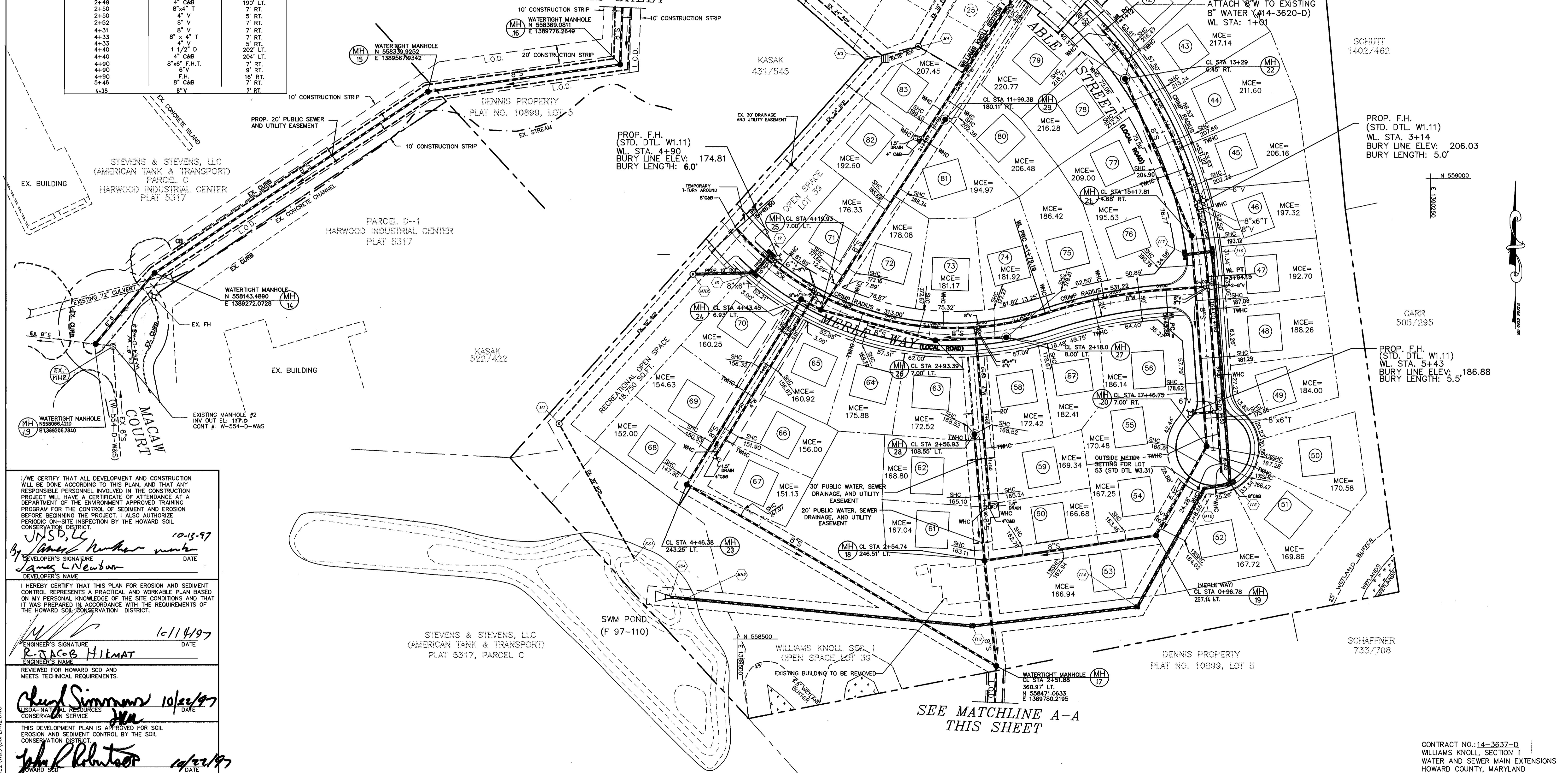

I/WE CERTIFY THAT ALL DEVELOPMENT AND CONSTRUCTION WILL BE DONE ACCORDING TO THIS PLAN, AND THAT ANY RESPONSIBLE PERSONNEL INVOLVED IN THE CONSTRUCTION PROJECT WILL HAVE A CERTIFICATE OF ATTENDANCE AT A DEPARTMENT OF THE ENVIRONMENT APPROVED TRAINING PROGRAM FOR THE CONTROL OF SEDIMENT AND EROSION BEFORE BEGINNING THE PROJECT. I ALSO AUTHORIZE PERIODIC ON-SITE INSPECTION BY THE HOWARD SOIL CONSERVATION DISTRICT.

JNSD, LLC 10-13-97
DEVELOPER'S SIGNATURE
James L. Newson
DEVELOPER'S NAME

I HEREBY CERTIFY THAT THIS PLAN FOR EROSION AND SEDIMENT CONTROL REPRESENTS A PRACTICAL AND WORKABLE PLAN BASED ON MY PERSONAL KNOWLEDGE OF THE SITE CONDITIONS AND THAT IT WAS PREPARED IN ACCORDANCE WITH THE REQUIREMENTS OF THE HOWARD SOIL CONSERVATION DISTRICT.

R. JACOB HILMAT 10/14/97
ENGINEER'S SIGNATURE
ENGINEER'S NAME

REVIEWED FOR HOWARD SCD AND MEETS TECHNICAL REQUIREMENTS.

Cheryl Simmons 10/22/97
USDA-NATIONAL RESOURCES CONSERVATION SERVICE

THIS DEVELOPMENT PLAN IS APPROVED FOR SOIL EROSION AND SEDIMENT CONTROL BY THE SOIL CONSERVATION DISTRICT.

John R. Roberts 10/22/97
HOWARD SCD

DEPARTMENT OF PUBLIC WORKS
HOWARD COUNTY, MARYLAND

Michael A. Russell 10-30-97
CHIEF, BUREAU OF UTILITIES RMB DATE

DEPARTMENT OF PLANNING & ZONING
HOWARD COUNTY, MARYLAND

John R. Roberts 10/24/97
CHIEF, DEVELOPMENT ENGINEERING DIVISION DATE

**MILDENBERG,
BOENDER & ASSOC., INC.**
Engineers Planners Surveyors
5072 Dorsey Hall Drive, Suite 202, Elkwood City, Maryland 21042
(410) 997-0286 Bulk (301) 621-5221 Wash. (410) 997-0286 Fax.

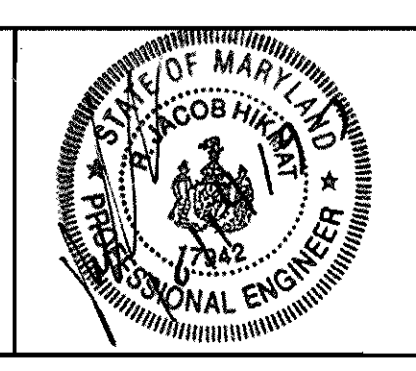

engineering	SD				
illustration	SD				
approval					
project	RCJ	1	CHANGE MH #'S, ELEV. & STATIONING OF SHC	5-28-98	
date	OCT 97	BY NO.	REVISION	DATE	

**WATER AND SEWER
PLAN**

600' SCALE MAP NO. 38 BLOCK NO. 8

WILLIAMS KNOLL, SECTION II
LOTS 42-84
A RESUBDIVISION OF WILLIAMS KNOLL,
SECTION I, BULK PARCEL A

CONTRACT NO. 14-3637-D
FIRST ELECTION DISTRICT
HOWARD COUNTY, MARYLAND

scale
1"=50'
2 OF 8

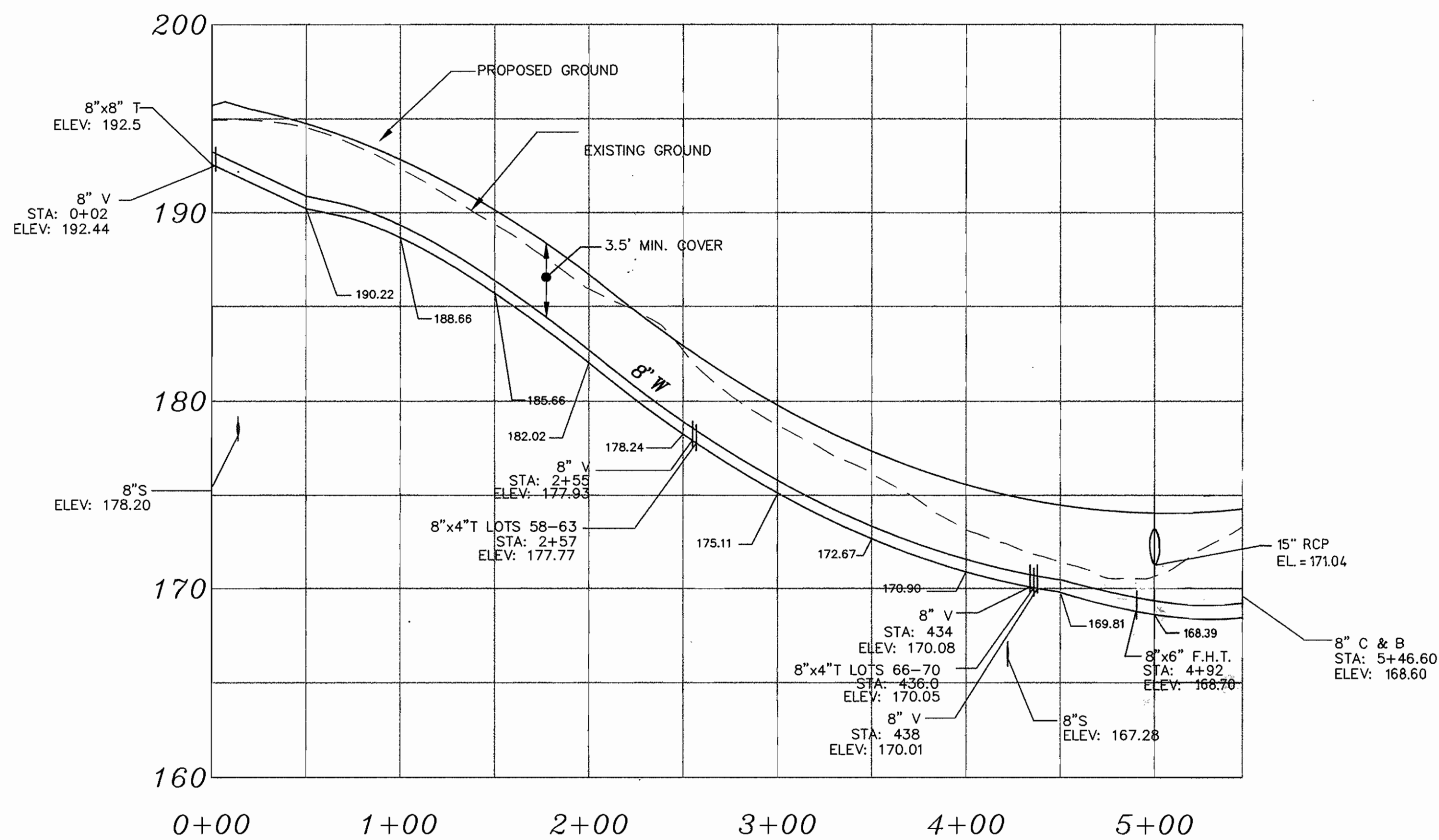

8" WATER MAIN PROFILE
MERLE WAY
 SCALE: 1"=50' HOR
 1"=5' VERT.

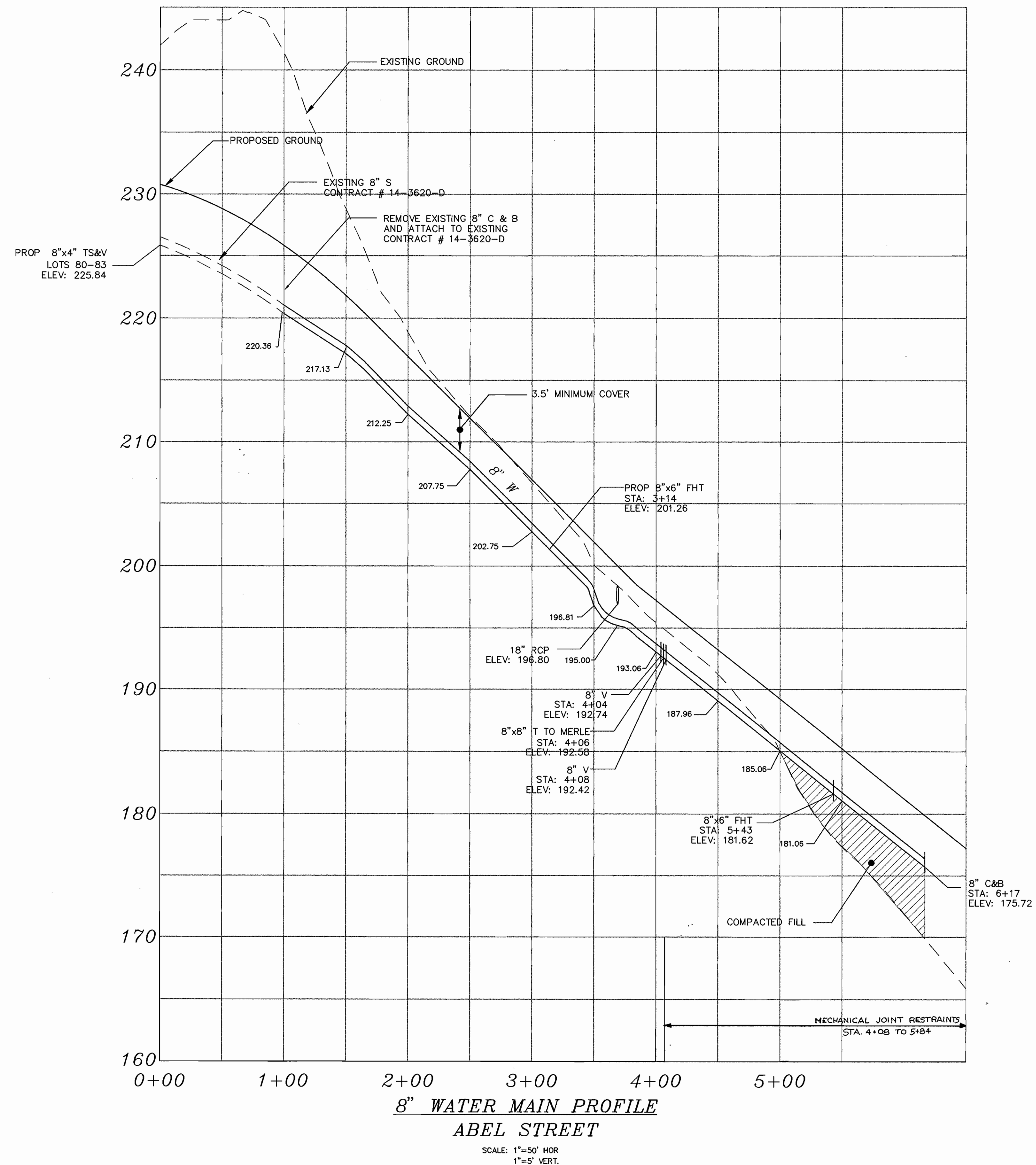

8" WATER MAIN PROFILE
ABEL STREET
 SCALE: 1"=50' HOR
 1"=5' VERT.

CONTRACT NO.: 14-3637-D
 WILLIAMS KNOLL, SECTION II
 WATER AND SEWER MAIN EXTENSIONS
 HOWARD COUNTY, MARYLAND

DEPARTMENT OF PUBLIC WORKS
 HOWARD COUNTY, MARYLAND

DEPARTMENT OF PLANNING & ZONING
 HOWARD COUNTY, MARYLAND

**MILDENBERG,
 BOENDER & ASSOC., INC.**
 Engineers Planners Surveyors

5072 Dorsey Hall Drive, Suite 202, Ellicott City, Maryland 21042
 (410) 997-0286 Bldg. (301) 621-5521 Wash. (410) 997-0286 Fax

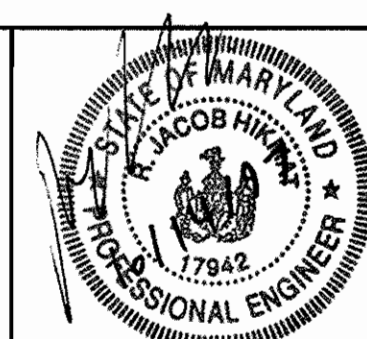

engineering	SD				
illustration	SD				
approval					
project	95136	RCJ	1	CHANGE ELEV. OF WATER MAIN	5-28-98
date	OCT 97	BY	NO.	REVISION	DATE

**WATER
 PROFILES**

WILLIAMS KNOLL, SECTION II
 LOTS 42-84
 A RESUBDIVISION OF WILLIAMS KNOLL,
 SECTION I, BULK PARCEL A
 CONTRACT NO.: 14-3637-D
 FIRST ELECTION DISTRICT
 HOWARD COUNTY, MARYLAND

scale
 AS SHOWN

3 OF 8

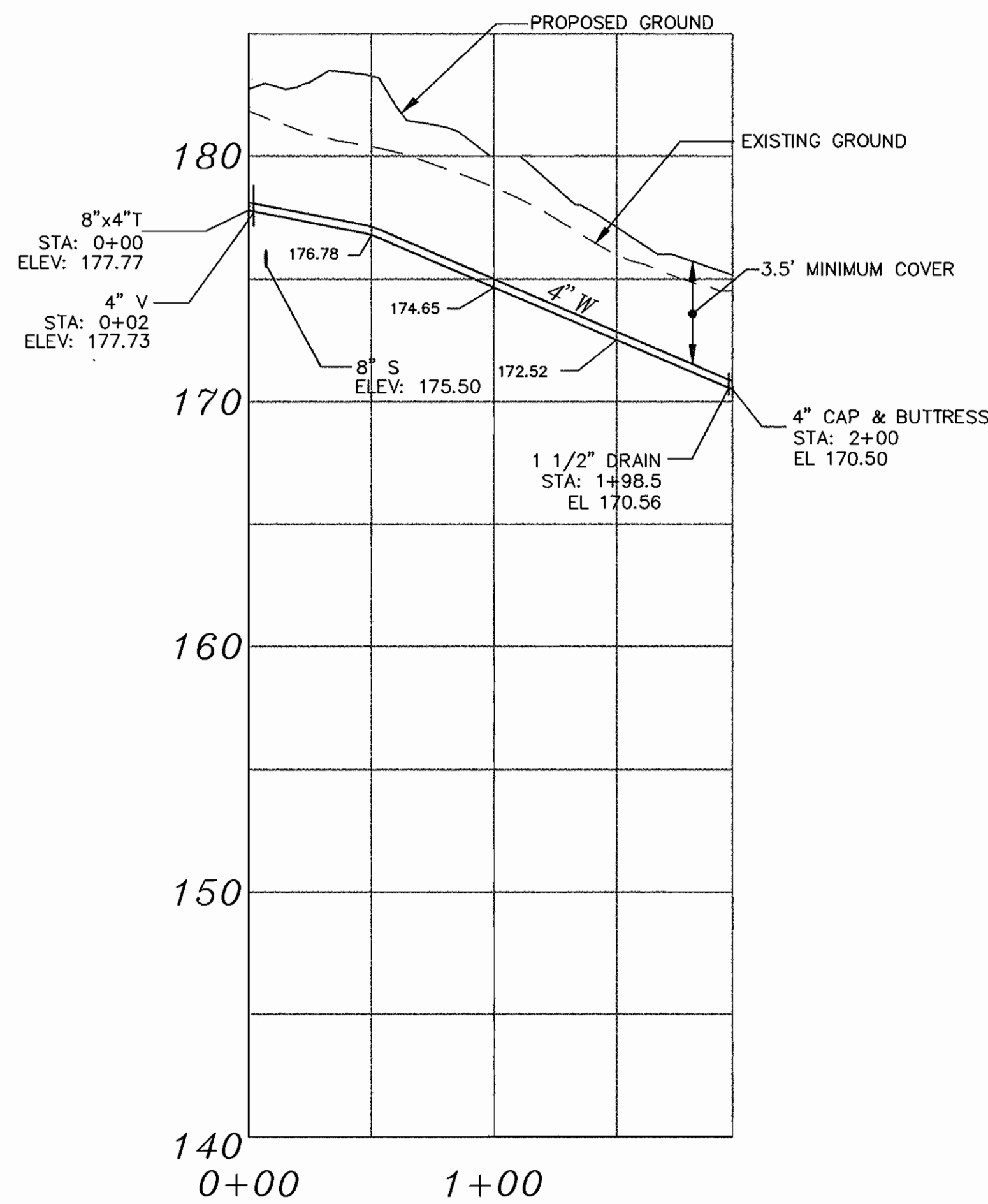

LOTS 58-63
4" WATER MAIN PROFILE
 SCALE: 1"=50' HOR
 1"=5' VERT.

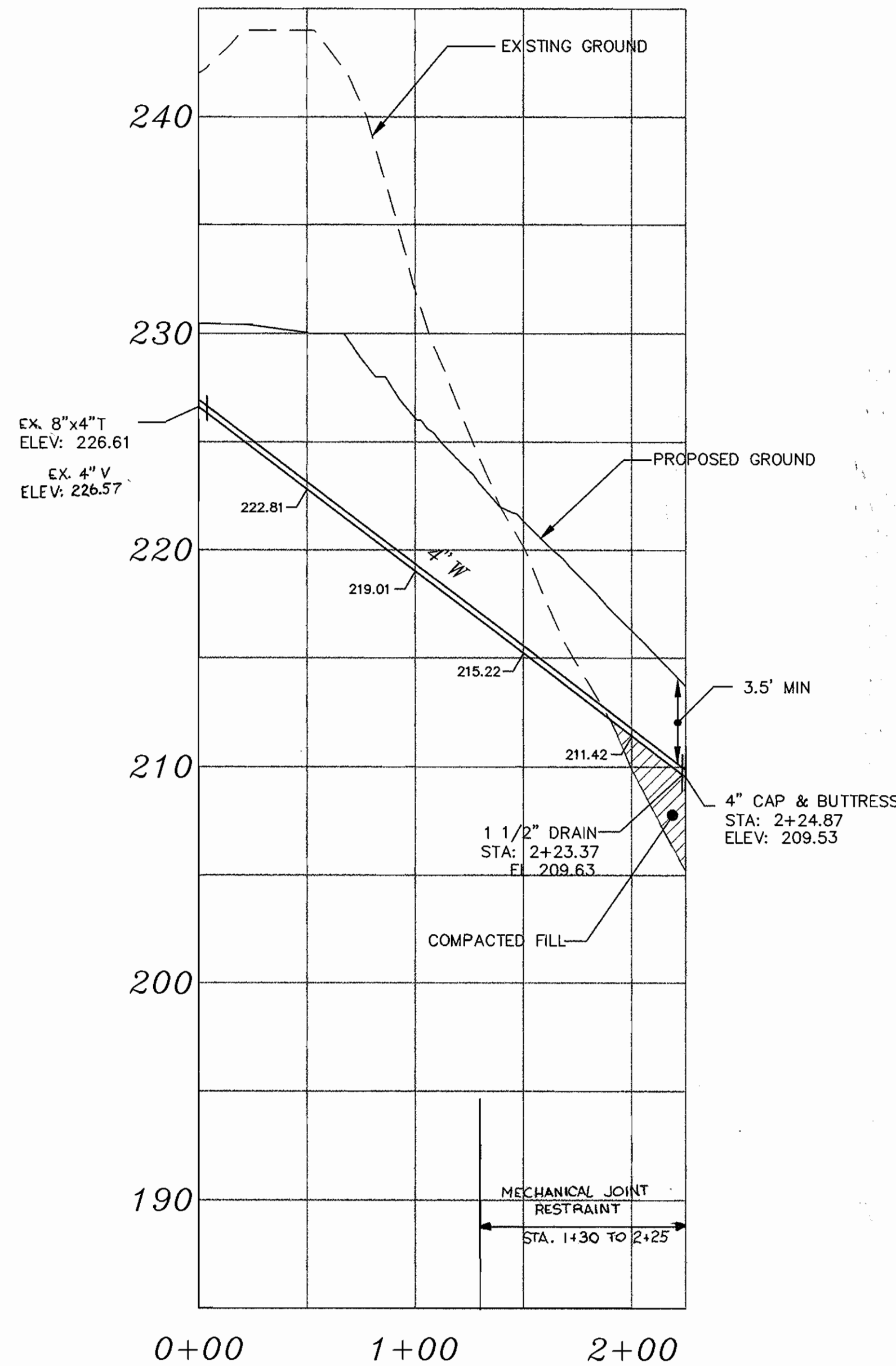

LOTS 80-83
4" WATER MAIN PROFILE
 SCALE: 1"=50' HOR
 1"=5' VERT.

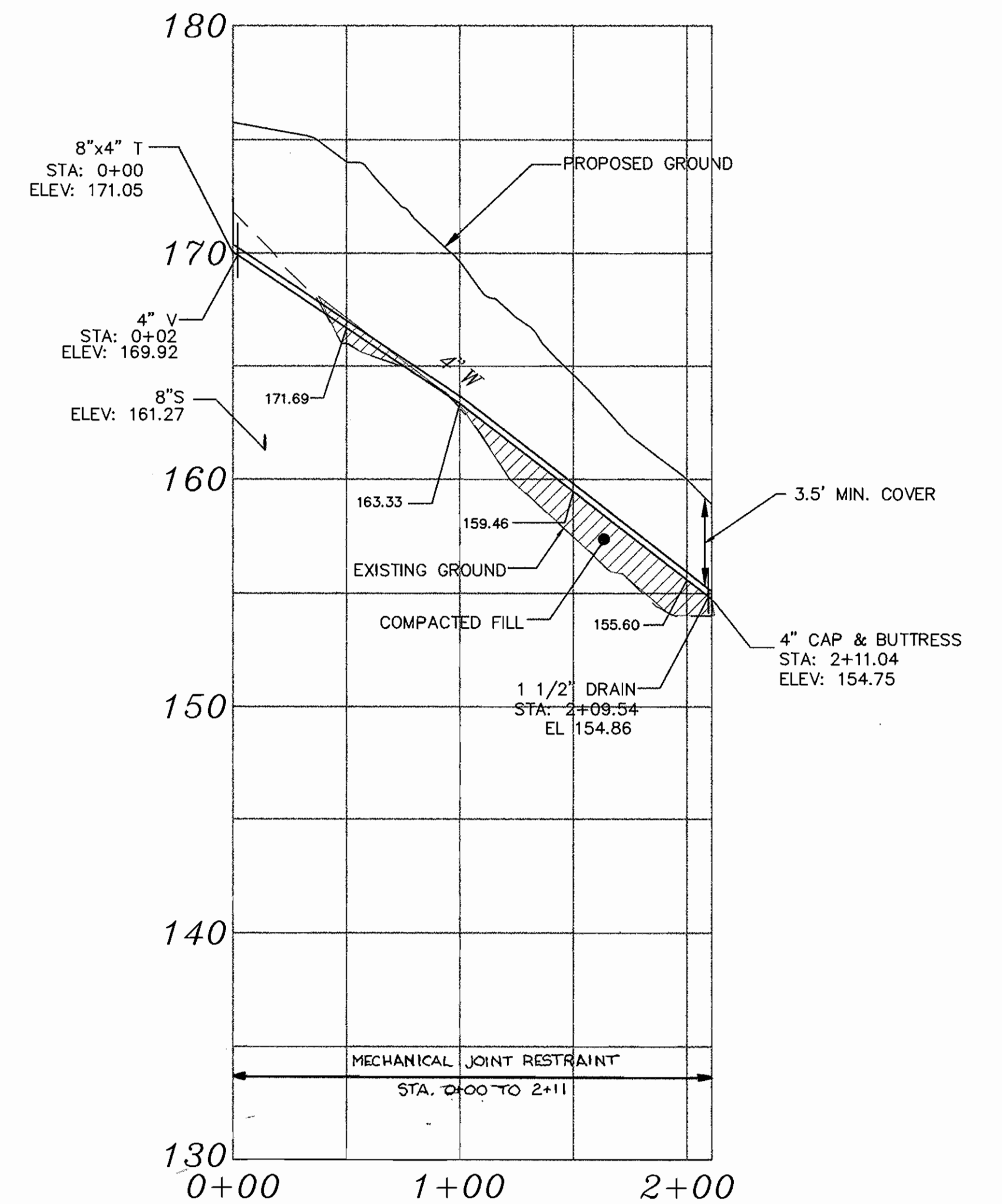

LOTS 66-70
4" WATER MAIN PROFILE
 SCALE: 1"=50' HOR
 1"=5' VERT.

CONTRACT NO.: 14-3637-D
 WILLIAMS KNOLL, SECTION II
 WATER AND SEWER MAIN EXTENSIONS
 HOWARD COUNTY, MARYLAND

95136.DWG.FINAL_Volume2_WMS_136-WTR2

DEPARTMENT OF PUBLIC WORKS
 HOWARD COUNTY, MARYLAND
 Michael A. Romano
 CHIEF, BUREAU OF UTILITIES
 10-20-97
 DATE

DEPARTMENT OF PLANNING & ZONING
 HOWARD COUNTY, MARYLAND
 [Signature]
 CHIEF, DEVELOPMENT ENGINEERING DIVISION
 10/24/97
 DATE

MILDENBERG, BOENDER & ASSOC., INC.
 Engineers Planners Surveyors
 5072 Dorsey Hall Drive, Suite 202, Ellicott City, Maryland 21042
 (410) 997-0296 Bulk (301) 821-5521 Wash. (410) 997-0298 Fax.

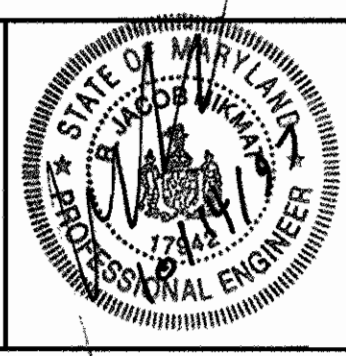

engineering	SD				
illustration	SD				
approval					
project	95136				
date	OCT 97	BY	NO.	REVISION	DATE

WATER PROFILES
 600' SCALE MAP NO. 38 BLOCK NO. 8

WILLIAMS KNOLL, SECTION II
 LOTS 42-84
 A RESUBDIVISION OF WILLIAMS KNOLL,
 SECTION I, BULK PARCEL A
 CONTRACT NO.: 14-3637-D
 FIRST ELECTION DISTRICT
 HOWARD COUNTY, MARYLAND

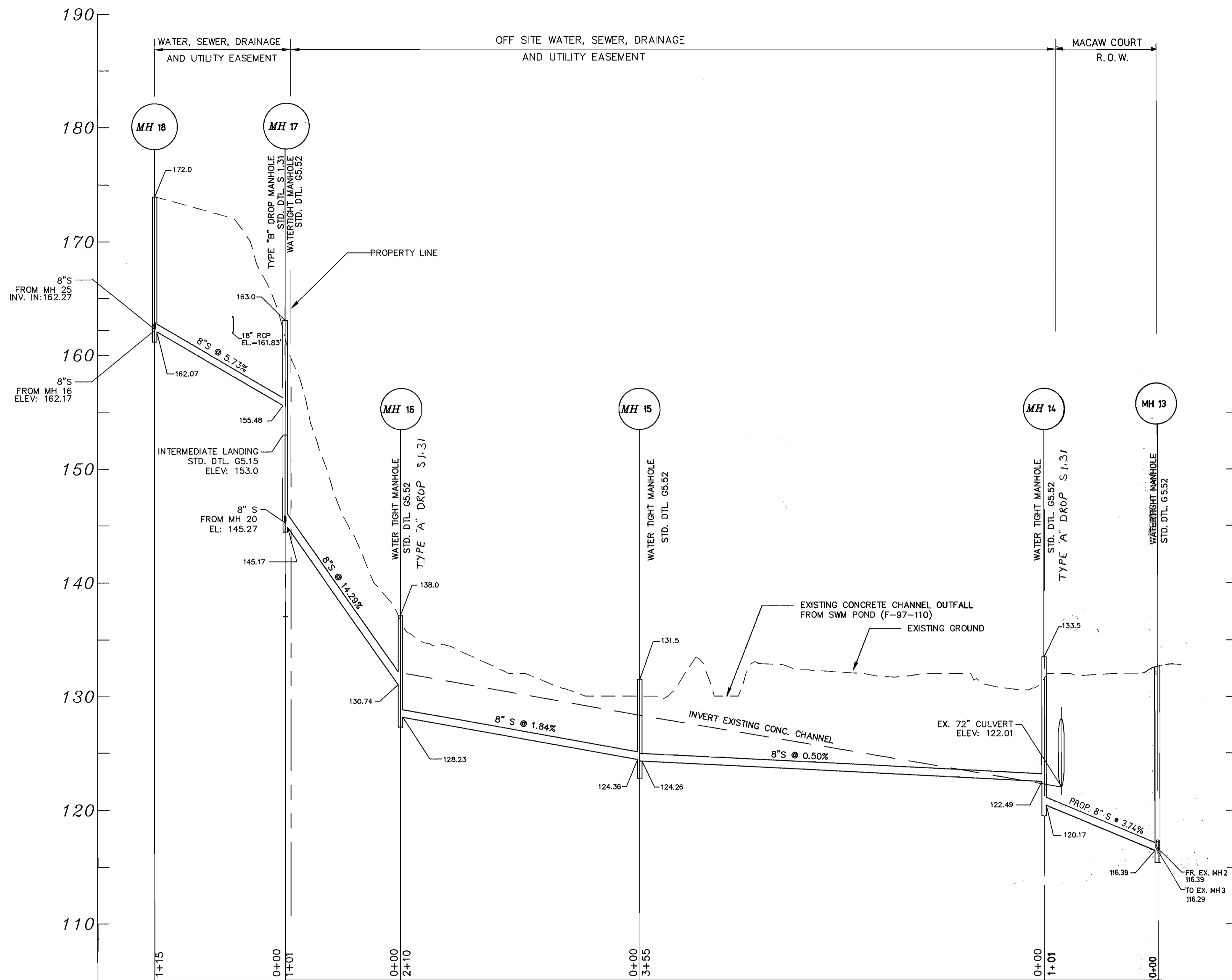

8" SEWER PROFILE
MH 15 TO EXISTING MH
 SCALE: 1"=50' HOR
 1"=5' VER

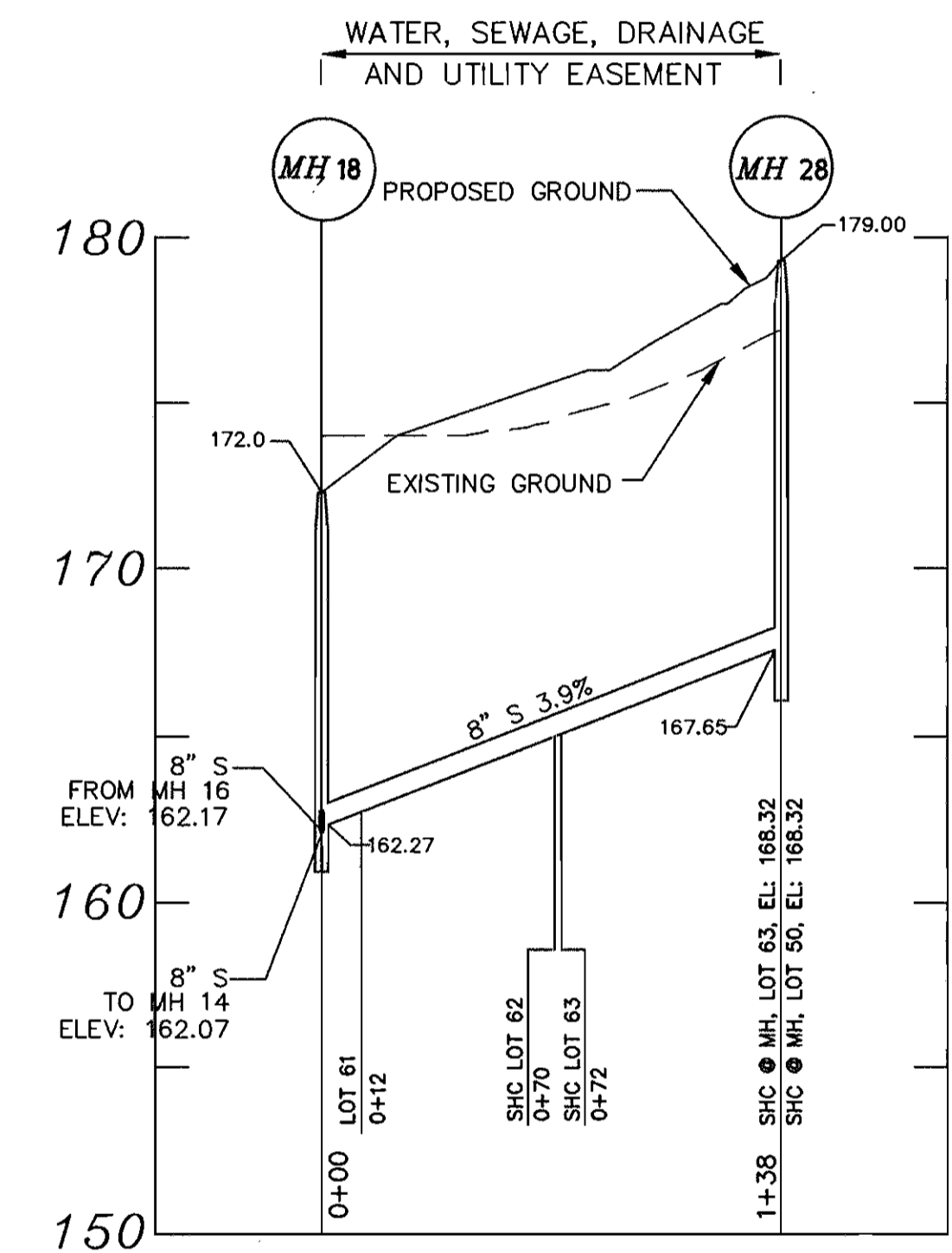

8" SEWER PROFILE
MH 15 TO MH 25 (LOTS 58-63)
 SCALE: 1"=50' HOR
 1"=5' VER

95136 (PHASE 2) (M&S) 36-SWR2

DEPARTMENT OF PUBLIC WORKS
 HOWARD COUNTY, MARYLAND
 Michael A. Savanillo
 CHIEF, BUREAU OF UTILITIES
 10-20-97
 DATE

DEPARTMENT OF PLANNING & ZONING
 HOWARD COUNTY, MARYLAND
 [Signature]
 CHIEF, DEVELOPMENT ENGINEERING DIVISION
 10/24/97
 DATE

MILDENBERG, BOENDER & ASSOC., INC.
 Engineers Planners Surveyors
 5072 Dorsey Hall Drive, Suite 202, Beltsville, Maryland 21042
 (410) 997-0296 Balt. (301) 621-5521 Wash. (410) 997-0298 Fax

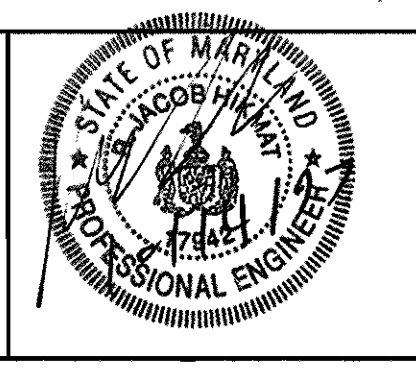

engineering	SD				
illustration	SD				
approval					
project	95136	RCJ	1	CHANGE MH #S; ADD MH 13 & ASSOC. CHANGES	5-28-94
date	OCT 97	BY	NO.	REVISION	DATE

SEWER PROFILES

600' SCALE MAP NO. 38 BLOCK NO. 8

WILLIAMS KNOLL, SECTION II
 LOTS 42-84
 A RESUBDIVISION OF WILLIAMS KNOLL,
 SECTION I, BULK PARCEL A
 CONTRACT NO.: 14-3637-D
 FIRST ELECTION DISTRICT
 HOWARD COUNTY, MARYLAND

CONTRACT NO.: 14-3637-D
 WILLIAMS KNOLL, SECTION II
 WATER AND SEWER MAIN EXTENSIONS
 HOWARD COUNTY, MARYLAND

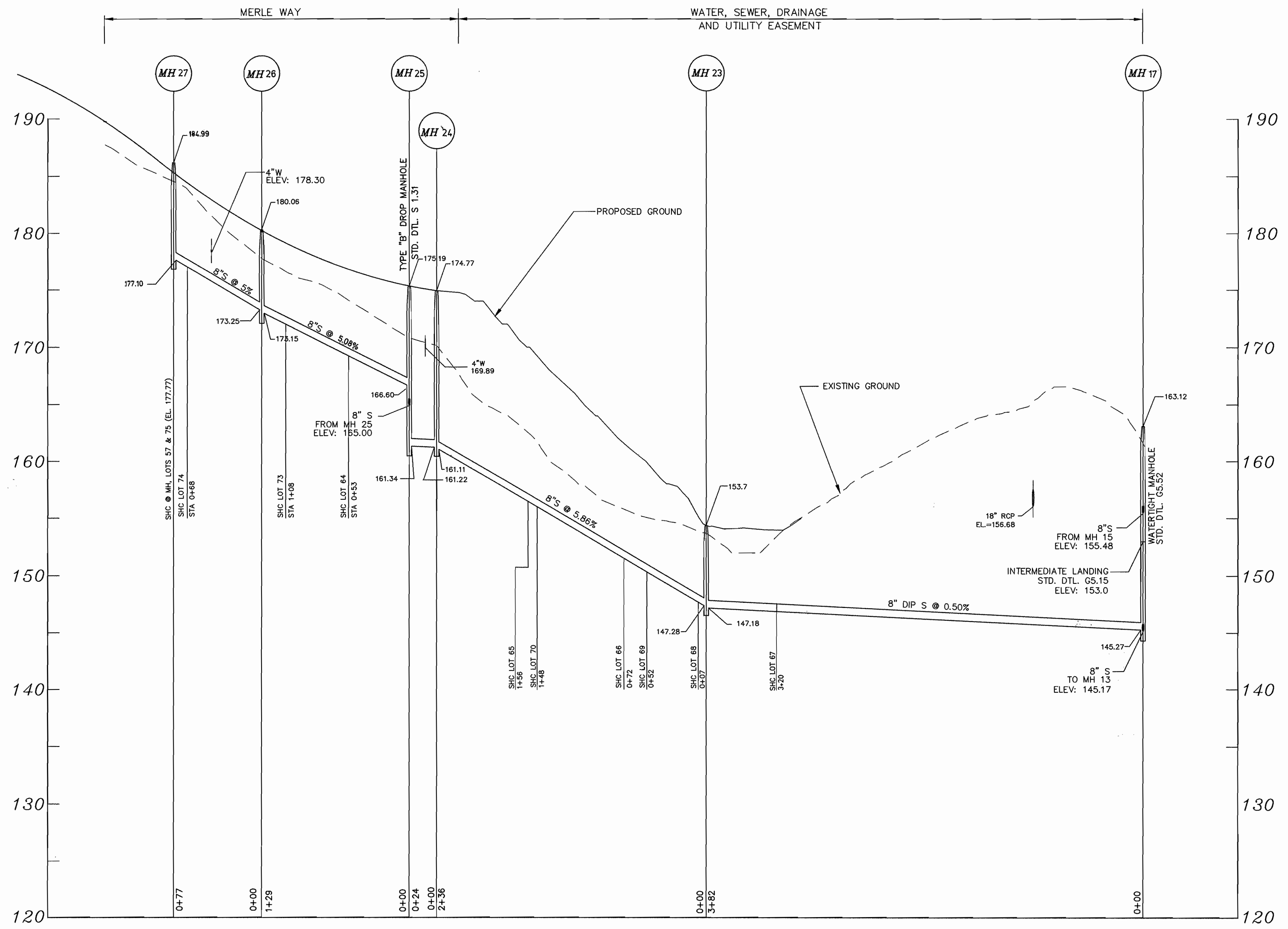

8" SEWER PROFILE
MERLE WAY & LOTS 66-69
 SCALE: 1"=50' HOR
 1"=5' VER

CONTRACT NO.: 14-3637-D
 WILLIAMS KNOLL, SECTION II
 WATER AND SEWER MAIN EXTENSIONS
 HOWARD COUNTY, MARYLAND

95136.DWG (FINAL PHASE 2) W&S 16-SW2

DEPARTMENT OF PUBLIC WORKS
 HOWARD COUNTY, MARYLAND
 Michael R. ... 10-20-97
 CHIEF, BUREAU OF UTILITIES

DEPARTMENT OF PLANNING & ZONING
 HOWARD COUNTY, MARYLAND
 ... 10/24/97
 CHIEF, DEVELOPMENT ENGINEERING DIVISION

MILDENBERG, BOENDER & ASSOC., INC.
 Engineers Planners Surveyors
 5972 Dorsey Hall Drive, Suite 202, Ellicott City, Maryland 21042
 (410) 987-0296 Toll (301) 621-5321 Wash. (410) 987-0298 Fax

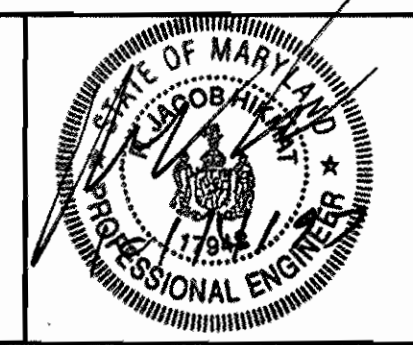

engineering	SD				
illustration	SD				
approval					
project	95136	RCJ	1	CHANGE MH #'S, CHANGE ELEV. & STATIONING OF SEWER	5-28-98
date	OCT 97	BY	NO.	REVISION	DATE

SEWER PROFILES

600' SCALE MAP NO. 38 BLOCK NO. 8

WILLIAMS KNOLL, SECTION II
 LOTS 42-84
 A RESUBDIVISION OF WILLIAMS KNOLL,
 SECTION I, BULK PARCEL A
 CONTRACT NO. 14-3637-D
 FIRST ELECTION DISTRICT
 HOWARD COUNTY, MARYLAND

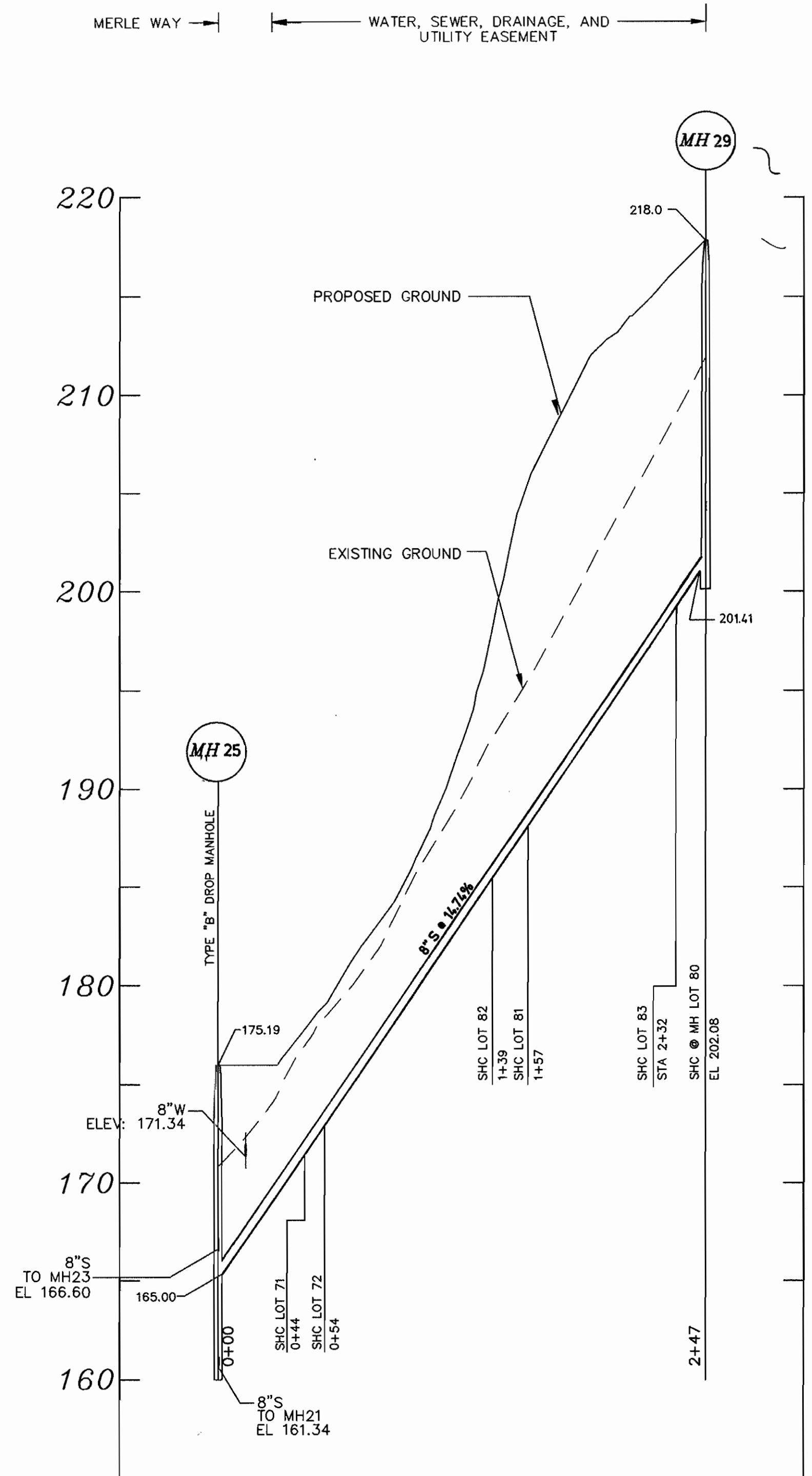

**8" SEWER PROFILE
MH 25 TO MH 21 (LOTS 71, 72 & 80-83)**

SCALE: 1"=50' HOR
1"=5' VER

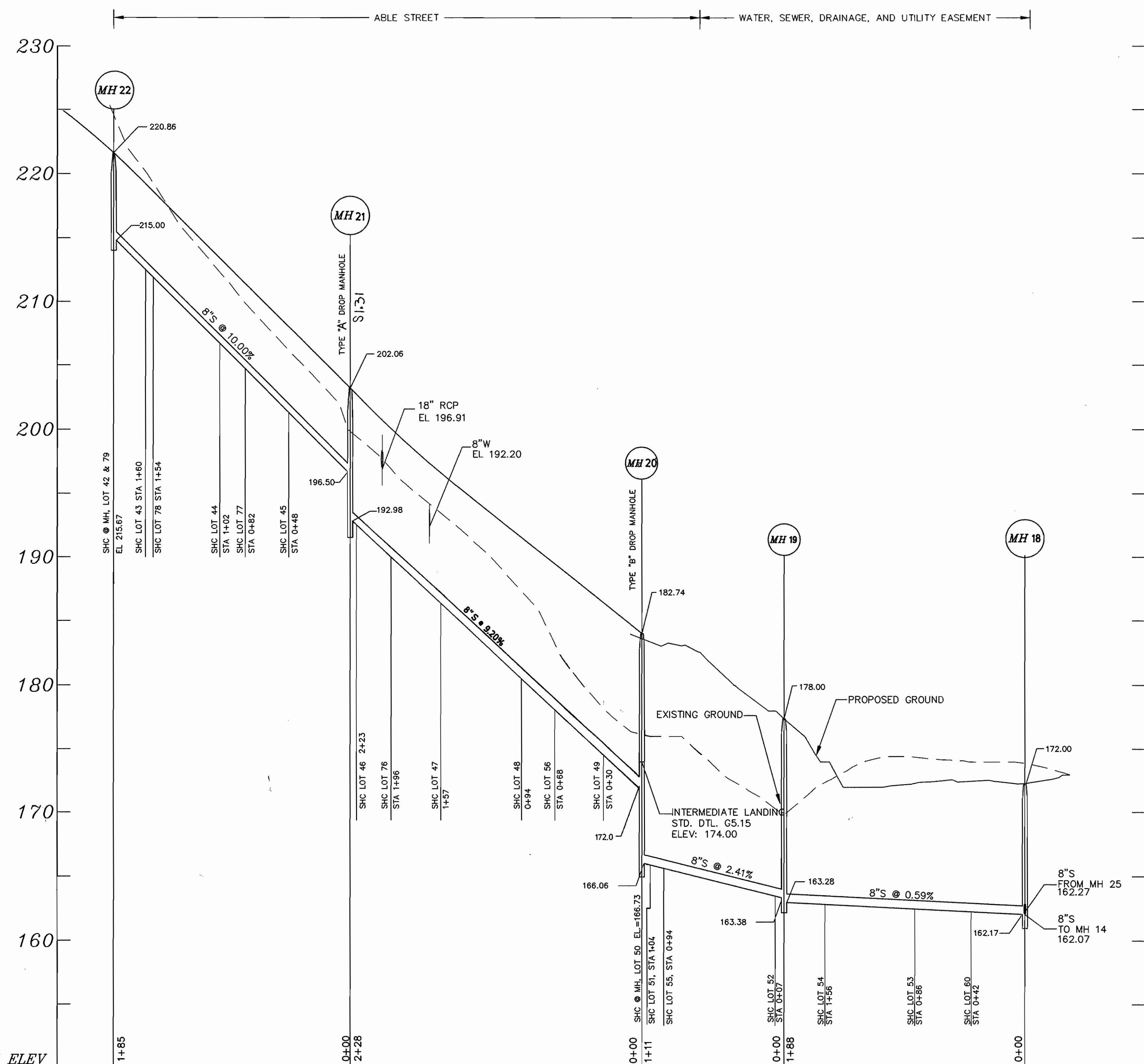

**8" SEWER PROFILE
MH 19 TO MH 15 (ABEL ST.)**

SCALE: 1"=50' HOR
1"=5' VER

DEPARTMENT OF PUBLIC WORKS
HOWARD COUNTY, MARYLAND
Michael A. ... 10-20-97
CHIEF, BUREAU OF UTILITIES

DEPARTMENT OF PLANNING & ZONING
HOWARD COUNTY, MARYLAND
... 10/21/97
CHIEF, DEVELOPMENT ENGINEERING DIVISION

**MILDENBERG,
BOENDER & ASSOC., INC.**
Engineers Planners Surveyors
5072 Dorsey Hall Drive, Suite 202, Ellicott City, Maryland 21042
(410) 997-0296 Balt. (301) 621-5521 Wash. (410) 997-0298 Fax.



engineering	SD				
illustration	SD				
approval					
project	95136				
date	OCT 97				
RCJ	1	CHANGE MH #'S, MOVE SEWER & ASSOC. CHANGES		5-28-98	
BY	NO.	REVISION		DATE	

**SEWER
PROFILES**
600' SCALE MAP NO. 38 BLOCK NO. 8

WILLIAMS KNOLL, SECTION II
LOTS 42-84
A RESUBDIVISION OF WILLIAMS KNOLL,
SECTION I, BULK PARCEL A
CONTRACT NO.: 14-3637-D
FIRST ELECTION DISTRICT
HOWARD COUNTY, MARYLAND

scale
AS SHOWN
7 OF 8

95136.DWG\FINAL\PHASE2\WMS\136-SWR2

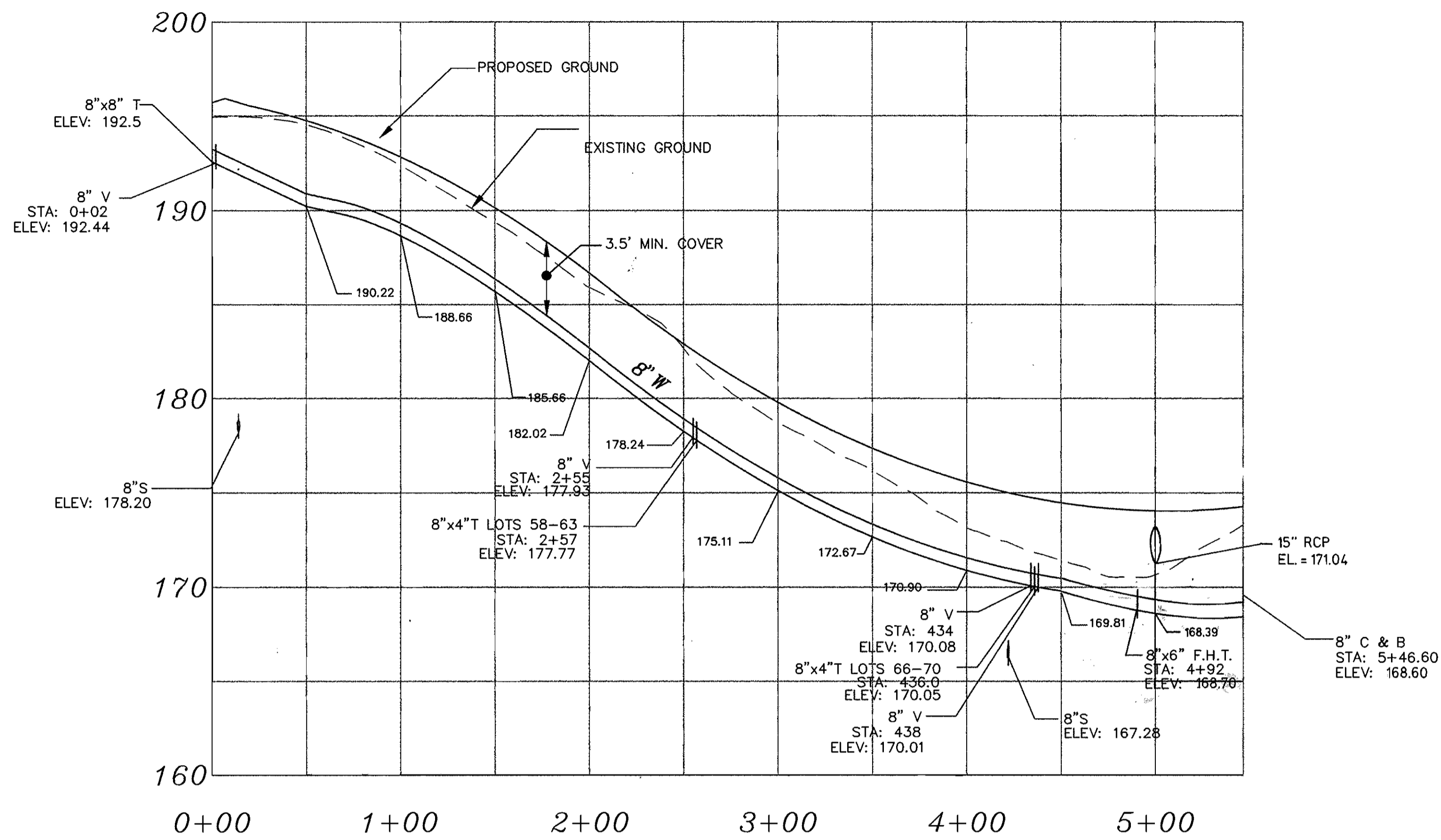

8" WATER MAIN PROFILE
MERLE WAY
 SCALE: 1"=50' HOR
 1"=5' VERT.

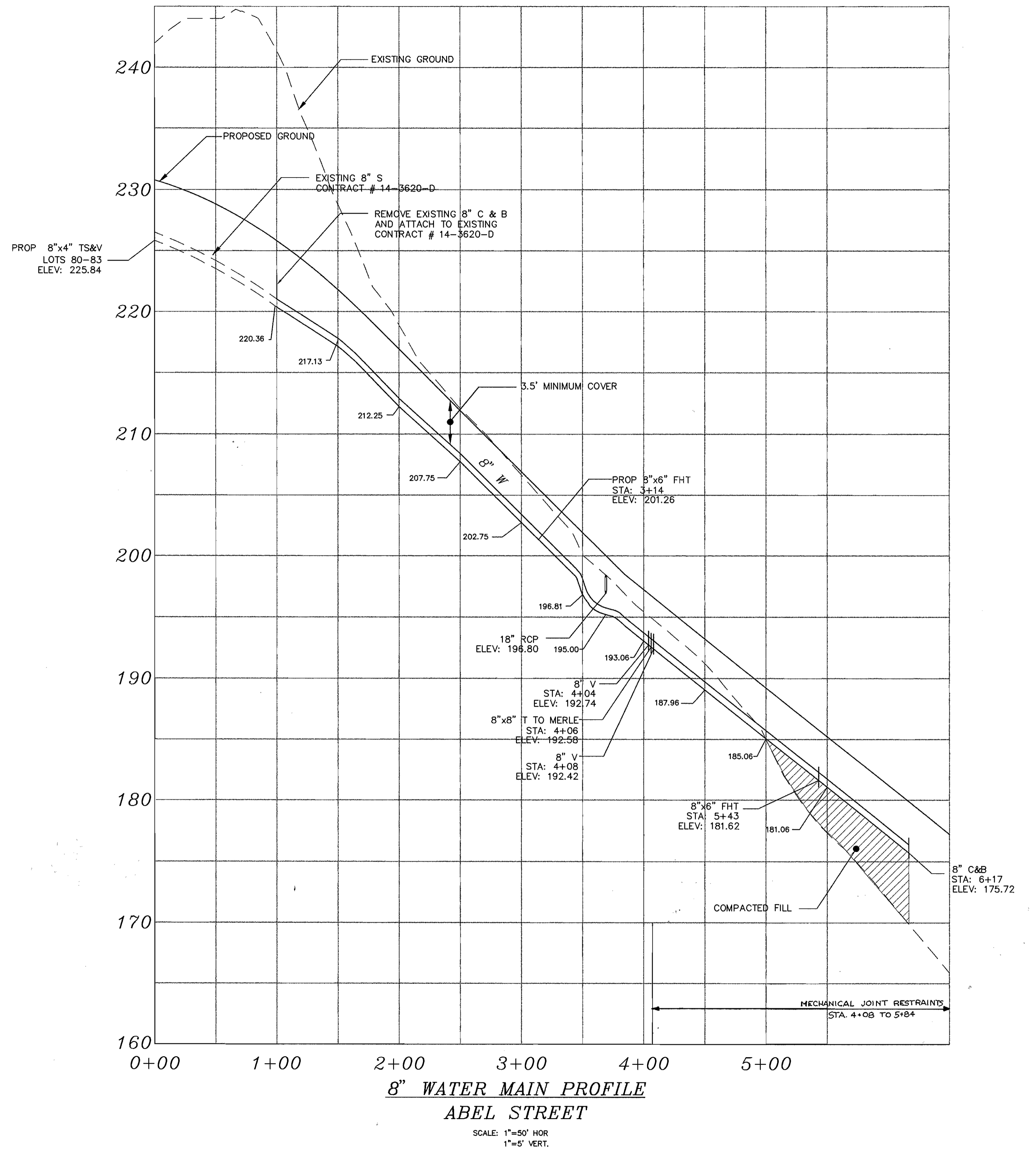

8" WATER MAIN PROFILE
ABEL STREET
 SCALE: 1"=50' HOR
 1"=5' VERT.

CONTRACT NO.: 14-3637-D
 WILLIAMS KNOLL, SECTION II
 WATER AND SEWER MAIN EXTENSIONS
 HOWARD COUNTY, MARYLAND

DEPARTMENT OF PUBLIC WORKS
 HOWARD COUNTY, MARYLAND

DEPARTMENT OF PLANNING & ZONING
 HOWARD COUNTY, MARYLAND

MILDENBERG, BOENDER & ASSOC., INC.
 Engineers Planners Surveyors



engineering	SD				
illustration	SD				
approval					
project	95136	RCJ	1	CHANGE ELEV. OF WATER MAIN	5-28-98
date	OCT 97	BY	NO.	REVISION	DATE

WATER PROFILES

WILLIAMS KNOLL, SECTION II
 LOTS 42-84
 A RESUBDIVISION OF WILLIAMS KNOLL,
 SECTION I, BULK PARCEL A
 CONTRACT NO.: 14-3637-D
 FIRST ELECTION DISTRICT
 HOWARD COUNTY, MARYLAND

scale
 AS SHOWN

3 OF 8

95136.DWG.FINAL (Phase 2) (WSS) (36-WTR2)

Richard A. Sincinillo for RMB 10-20-97
 CHIEF, BUREAU OF UTILITIES DATE

Howard A. Danman 10/24/97
 CHIEF, DEVELOPMENT ENGINEERING DIVISION DATE

5072 Dorsey Hall Drive, Suite 202, Elkocott City, Maryland 21042
 (410) 997-0296 Bull. (301) 621-5521 Wash. (410) 997-0298 Fax.

600' SCALE MAP NO. 38 BLOCK NO. 8