

PLAN
SCALE: 1" = 50'

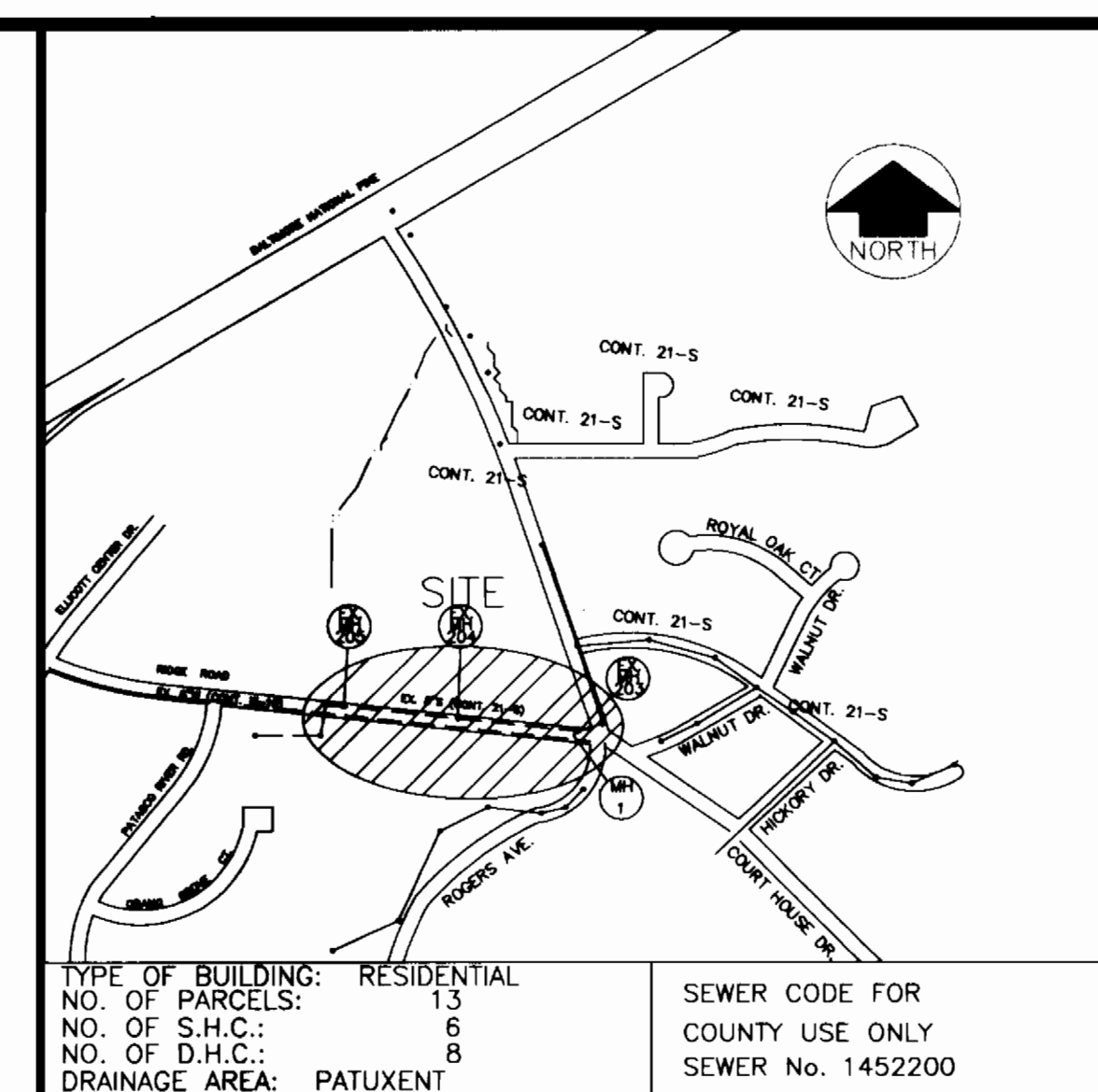

VICINITY MAP
SCALE: 1" = 600'

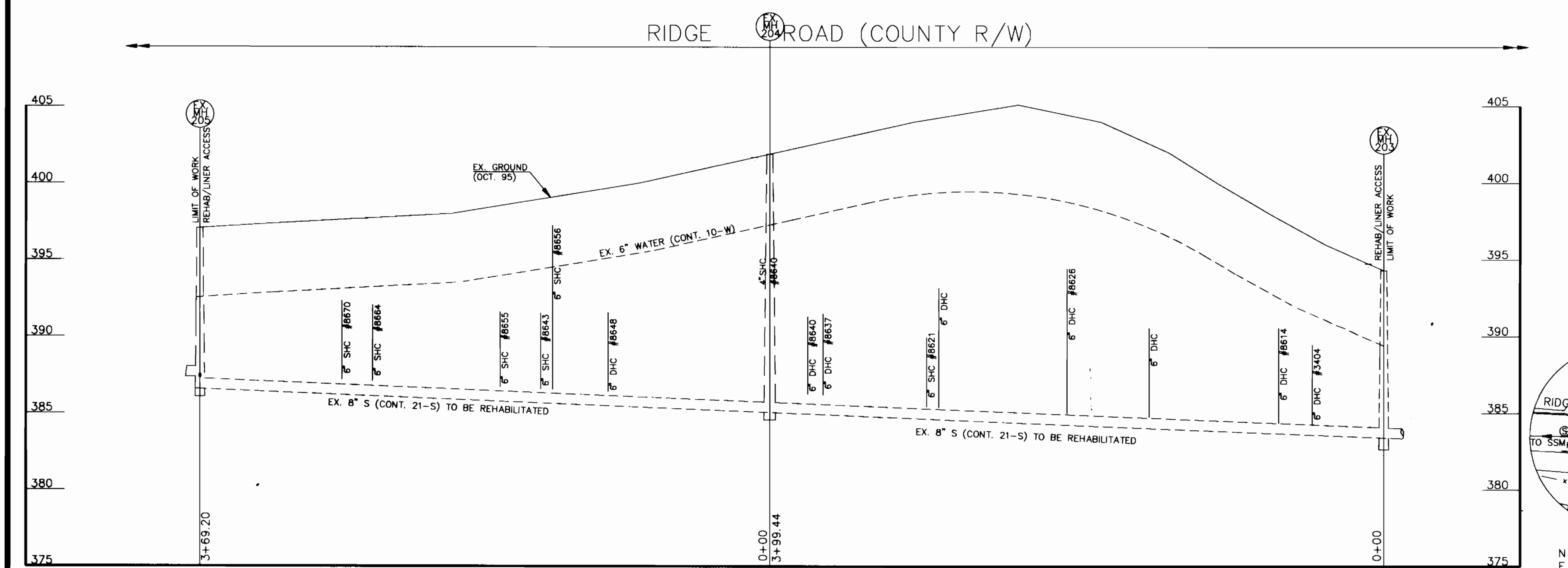

PROFILE
SCALE: HORIZ.: 1" = 50'
VERT.: 1" = 5'

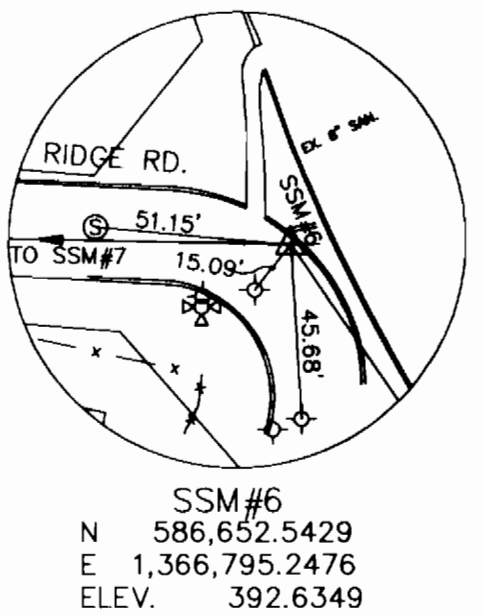

SURVEY CONTROL

- HOWARD COUNTY STATION 24FA
STD. HOWARD CO. SURVEY DISC
SET ON CONC. MONUMENT @
NW CORNER OF INTERSECTION OF
ROGERS AVE. & FREDRICK RD.
NORTH(83) 583,751.3486
EAST (83) 1,366,091.717
ELEV. 263.123
- HOWARD COUNTY STATION 25AA
STD. HOWARD CO. SURVEY DISC
SET ON CONC. MONUMENT @
NW CORNER OF INTERSECTION OF
ROGERS AVE. & PATAPSCO RIVER RD.
NORTH(83) 585,307.1128
EAST (83) 1,366,070.832
ELEV. 307.841
- BENCH MARK (BM#1)
RAIL ROAD SPIKE IN BGE POLE
#56358 ON S. SIDE OF RIDGE RD.
NORTH 586,650.0323
EAST 1,366,561.5708
ELEV. 405.641
- BENCH MARK (BM#2)
RAIL ROAD SPIKE IN BGE POLE
#95390 ON S. SIDE OF RIDGE RD.
NORTH 586,686.9181
EAST 1,366,219.6718
ELEV. 399.90
- SSM#6
N 586,652.5429
E 1,366,795.2476
ELEV. 392.6349
- SSM#7
N 586,657.4146
E 1,366,581.4833
ELEV. 403.4233
- SSM#8
N 586,681.7391
E 1,366,308.2588
ELEV. 401.2227
- SSM#9
N 586,701.800
E 1,366,128.4675
ELEV. 397.9266
- SSM#10
N 586,710.6353
E 1,365,908.6536
ELEV. 397.1234

GENERAL NOTES

- APPROXIMATE LOCATION OF EXISTING MAINS ARE SHOWN. THE CONTRACTOR SHALL TAKE ALL NECESSARY PRECAUTIONS TO PROTECT EXISTING MAINS AND SERVICES AND MAINTAIN UNINTERRUPTED SERVICE. ANY DAMAGE INCURRED SHALL BE REPAIRED IMMEDIATELY TO THE SATISFACTION OF THE ENGINEER AT THE CONTRACTOR EXPENSE.
- ALL HORIZONTAL CONTROLS ARE BASED ON MARYLAND STATE COORDINATES.
- ALL VERTICAL CONTROLS ARE BASED ON U.S.G.S. DATA.
- ALL PIPE ELEVATIONS SHOWN ARE INVERT ELEVATIONS UNLESS OTHERWISE NOTED ON THE PLANS.
- CLEAR ALL UTILITIES BY A MINIMUM OF 4'-0" CLEAR ALL POLES BY 7'-0" MINIMUM OR TUNNEL AS REQUIRED. THE OWNER HAS CONTACTED THE UTILITY COMPANIES AND HAS MADE ARRANGEMENTS FOR BRACING OF POLES AS SHOWN ON THE DRAWINGS. IN THE EVENT THE CONTRACTOR'S WORK REQUIRES THE BRACING OF ADDITIONAL POLES ANY COST INCURRED BY THE OWNER FOR THE BRACING OF ADDITIONAL POLES OR DAMAGES SHALL BE DEDUCTED FROM MONEY OWED TO THE CONTRACTOR. THE CONTRACTOR SHALL COORDINATE WITH THE UTILITY COMPANIES TO SCHEDULE THE BRACING OF THE POLES.
- FOR DETAILS NOT SHOWN ON THE DRAWINGS, AND FOR MATERIALS AND CONSTRUCTION METHODS, USE HOWARD COUNTY DESIGN MANUAL, VOLUME IV, STANDARD SPECIFICATIONS AND DETAILS FOR CONSTRUCTION (LATEST EDITION). THE CONTRACTOR SHALL HAVE A COPY OF VOLUME IV ON THE JOB.
- WHERE TEST PITS HAVE BEEN MADE ON EXISTING UTILITIES, THEY ARE NOTED BY THE SYMBOL (S) AT THE LOCATION OF THE TEST PIT. A NOTE OR NOTES CONTAINING THE RESULTS OF THE TEST PIT OR PITS IS INCLUDED ON THE DRAWINGS. EXISTING UTILITIES IN THE VICINITY OF THE PROPOSED WORK FOR WHICH TEST PITS HAVE NOT BEEN DUG SHALL BE LOCATED BY THE CONTRACTOR TWO WEEKS IN ADVANCE OF CONSTRUCTION OPERATIONS AT HIS OWN EXPENSE.
- CONTRACTOR SHALL NOTIFY THE FOLLOWING UTILITY COMPANIES OR AGENCIES AT LEAST FIVE WORKING DAYS BEFORE STARTING WORK SHOWN ON THESE PLANS:

ATA&T	865-3803
BGA&E (CONTRACTOR SERVICES)	850-4820
BGA&E - UNDERGROUND DAMAGE CONTROL	787-9088
BUREAU OF UTILITIES (DPM)	313-4900
CHESAPEAKE & POTOMAC TELEPHONE CO.	597-8585
COLONIAL PIPELINE CO.	785-1380
MISS UTILITY	1-800-257-7777
STATE HIGHWAY ADMINISTRATION	531-5533
- TREES AND SHRUBS ARE TO BE PROTECTED FROM DAMAGE TO THE MAXIMUM EXTENT. TREES AND SHRUBS LOCATED WITHIN THE CONSTRUCTION STRIP ARE NOT TO BE REMOVED OR DAMAGED BY THE CONTRACTOR.
- CONTRACTOR SHALL REMOVE TREES, STUMPS AND ROOTS ALONG LINE OF EXCAVATION. PAYMENT FOR SUCH REMOVAL SHALL BE INCLUDED IN THE UNIT PRICE BID FOR CONSTRUCTION OF THE MAIN.
- THE CONTRACTOR SHALL NOTIFY THE BUREAU OF HIGHWAYS, HOWARD COUNTY, AT (410)313-2450 AT LEAST FIVE WORKING DAYS BEFORE ANY OPEN CUT OF ANY COUNTY ROAD OR BORING/JACKING OPERATION IN COUNTY ROADS FOR LAYING SEWER MAINS OR HOUSE CONNECTIONS. THE APPROVAL OF THESE DRAWINGS WILL CONSTITUTE COMPLIANCE WITH DPM REQUIREMENTS PER SECTION 18.114(5) OF THE HOWARD COUNTY CODE.
- ALL SEWER MAINS SHALL BE D.I.P. OR P.V.C. UNLESS OTHERWISE NOTED.
- ALL MANHOLES SHALL BE 4'-0" INSIDE DIAMETER UNLESS OTHERWISE NOTED.
- FORCE MAINS SHALL BE D.I.P. ONLY.
- MANHOLES SHOWN WITH 12" AND 18" WALLS ARE FOR BRICK MANHOLES ONLY.
- MANHOLES DESIGNATED W.T. IN PLAN AND PROFILE SHALL HAVE WATERTIGHT FRAME AND COVER, STANDARD DETAIL G5.52 WHERE WATERTIGHT MANHOLE FRAME AND COVER ARE USED; SET TOP OF FRAME 1'-8" ABOVE FINISHED GRADE UNLESS OTHERWISE NOTED ON THE DRAWINGS.
- HOUSE(S) WITH THE SYMBOL "C.N.S." INDICATES THAT CELLAR CANNOT BE SERVED.

QUANTITIES

ITEM	UNIT	ESTIMATE	AS-BUILT	MATERIAL SUPPLIER
8" SEWER RELINE	L.F.	769		
8" SHC RECONNECT	EA.	14		
NAME OF UTILITY CONTRACTOR: _____				
CHECKBOX				
AS-BUILT DATE: _____				
SURVEY AND DRAFTING DIVISION				

DEPARTMENT OF PUBLIC WORKS
HOWARD COUNTY, MARYLAND

John K. Webb 12/31/96
DIRECTOR OF PUBLIC WORKS

John K. Webb 12/31/96
CHIEF, BUREAU OF UTILITIES

John K. Webb 12/31/96
CHIEF, WATER AND SEWER DESIGN DIVISION

SSM
SPOTTIS, STEVENS and MCCOY, INC.
ENGINEERS + SURVEYORS + SCIENTISTS
555 FAIRMOUNT AVENUE, STE. 230
TOWSON, MARYLAND, 21286-5497
(410)944-0200 FAX (410)298-3580



DES: FCL				
DRN: FCL				
CHK: TWW				
DATE: SEP. 96	BY	NO.	REVISION	DATE

SEWER REPLACEMENT
PLAN & PROFILE
RIDGE ROAD

600' SCALE MAP NO. 24 & 25 BLOCK NO. 6 & 1

RIDGE ROAD SEWER REHABILITATION
CAPITAL PROJECT No. S-6197
CONTRACT No. 10-3497
ELECTION DISTRICT No. 2
HOWARD COUNTY, MARYLAND

SCALE AS SHOWN
SHEET 1 OF 1

AS BUILT 12-12-97