

ITEM	ESTIMATED	AS-BUILT		
		QUANTITIES	TYPE	SUPPLIER
6" SEWER	16 LF	16	PVC	J-M MFG.
6" PLUG	1 EA	0		
6" CLEANOUT	1 EA	1	PVC	G-M MFG.
8" WATER D.I.P.	340 LF	349 LF	DIP	GRIFFIN PIPE
6" WATER D.I.P.	15 LF	11	DIP	GRIFFIN PIPE
4" WATER D.I.P.	8 LF	10	DIP	GRIFFIN PIPE
6" VALVE	1 EA	1	CAST IRON GATE VALVE	AMERICAN DARLING
4" VALVE	1 EA	1	CAST IRON GATE VALVE	AMERICAN DARLING
2" COPPER	10 LF	12	" COPPER	CEBRO
6" X 4" REDUCER	1 EA	1	DIP	AMERICAN DARLING
6" (TYPICAL)	1 EA	1	CAST IRON	GRIFFIN PIPE
2" CAP	1 EA	0	DIP	
2" METER	1 EA	1		
4" CAP 1/2" TAP	1 EA	1	DIP	GRIFFIN PIPE

NAME OF UTILITY CONTRACTOR: R.J.S. CONTRACTORS
 SURVEY & DRAFTING DIVISION AS-BUILT DATE:

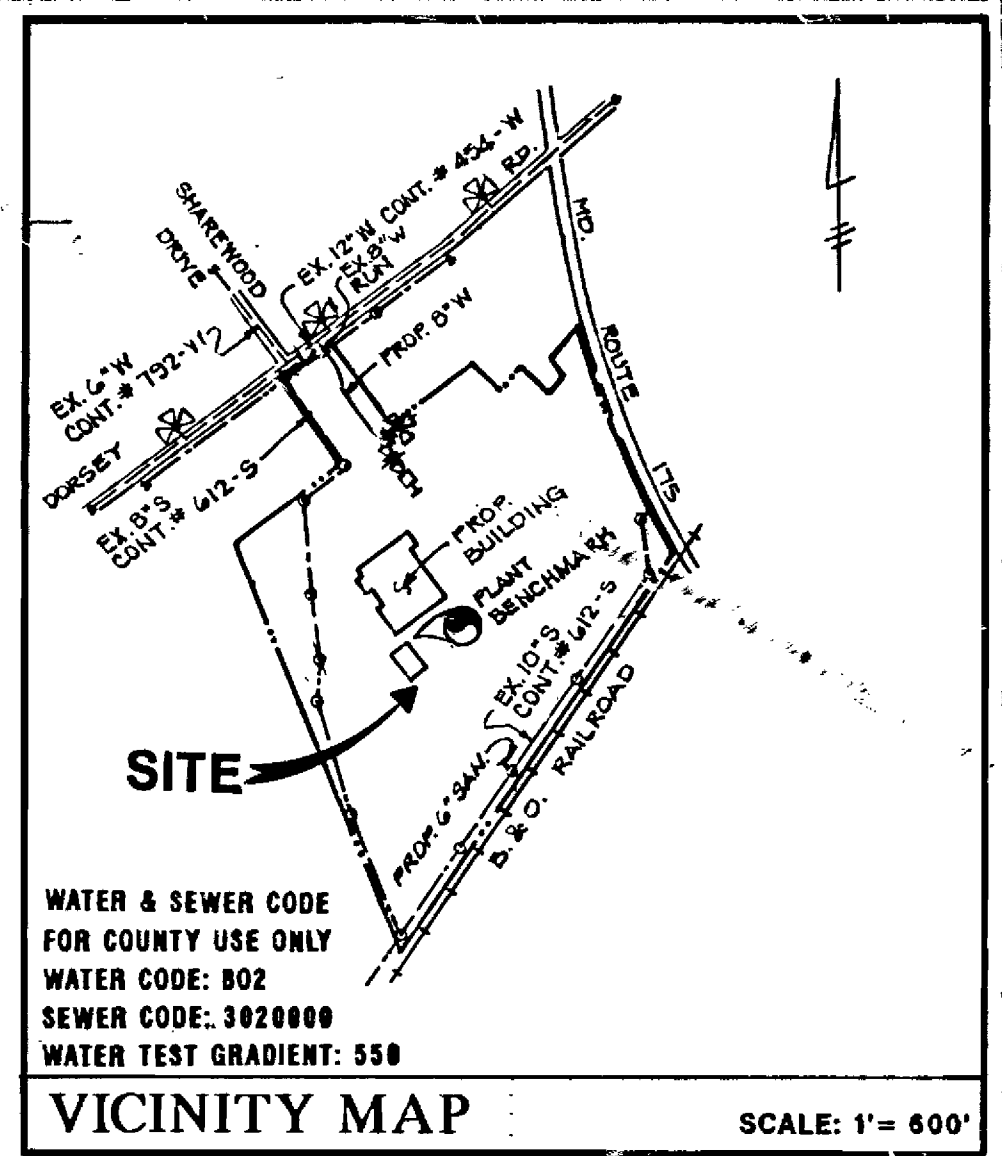

BENCHMARK DATA: ELEV. 217.38
 HOWARD COUNTY SURVEY CONTROL STATION 0030 MD STATE COORDINATES N 166398.24, E 418052.93
 LOCATION: WEST SIDE OF ROUTE 1, NORTH OF HICKS ROAD.
 DESCRIPTION: STAMPED CONCRETE MONUMENT.

PLANT BENCHMARK: N.E. CORNER OF EXISTING FITTINGS SHOP
 ELEV. 175.6 (PLANT DATUM 59.0)

TYPE OF BUILDING: MANUFACTURING PLANT
 No. OF LOTS/PARCELS: 1
 No. OF WATER HOUSE CONNECTIONS: 1
 No. OF SEWER HOUSE CONNECTIONS: 1
 DRAINAGE AREA: LITTLE PATUXENT RIVER
 TREATMENT PLANT: LITTLE PATUXENT WATER QUALITY MANAGEMENT CENTER

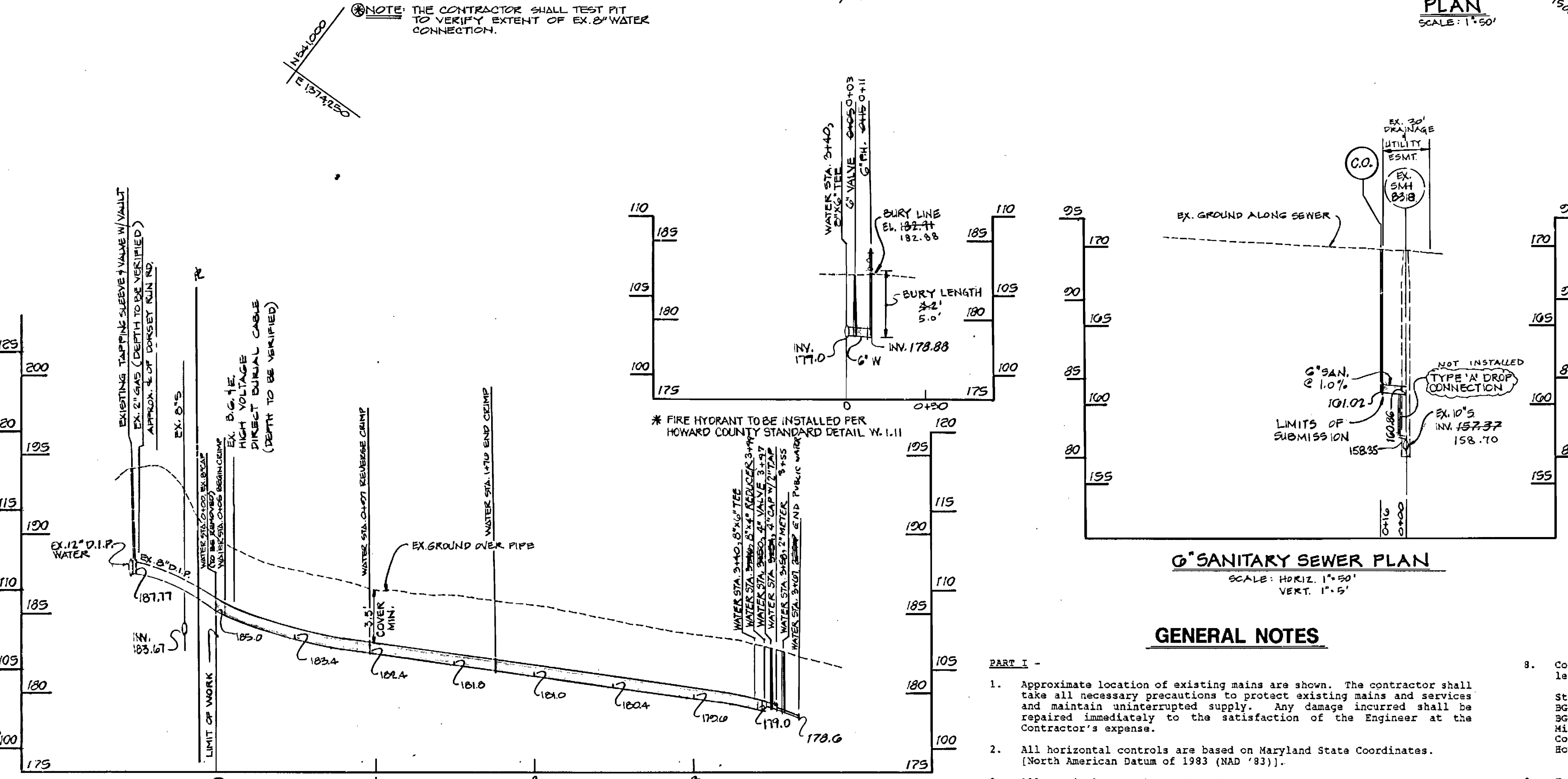

GENERAL NOTES

- PART I -**
- Approximate location of existing mains are shown. The contractor shall take all necessary precautions to protect existing mains and services and maintain uninterrupted supply. Any damage incurred shall be repaired immediately to the satisfaction of the Engineer at the Contractor's expense.
 - All horizontal controls are based on Maryland State Coordinates. (North American Datum of 1983 (NAD '83)).
 - All vertical controls are based on U.S.G.S. data.
 - All pipe elevations shown are invert elevations.
 - Clear all utilities by a minimum of 6". Clear all poles by 2' - 0" minimum or tunnel as required. The owner has contacted the utility companies and has made arrangements for bracing of poles as shown on the drawings. In the event the contractor's work requires the bracing of additional poles, any cost incurred by the owner for bracing of additional poles or damages shall be deducted from money owed the contractor. The contractor shall coordinate with the utility companies to schedule the bracing of the poles.
 - For details not shown on the drawings, and for materials and construction methods use Howard County Design Manual, Volume IV, Standard Specifications and Detail for Construction (Latest Edition). The contractor shall have a copy of Volume IV on the job.
 - Where test pits have been made on existing utilities, they are noted by the symbol at the location of the test pit. A note or notes containing the results of the test pit or pits is included on the drawings. Existing utilities in the vicinity of the proposed work for which test pits have not been dug shall be located by the contractor two weeks in advance of construction operations at his own expense.
- PART II - WATER**
- All water mains to be D.I.P. Class 52 unless otherwise noted.
 - Tops of all water mains to have a minimum of 3-1/2" cover unless otherwise noted.
 - Valves adjacent to tees shall be strapped to tees.
 - All fittings shall be buttressed or anchored with concrete in accordance with the Standard Details unless otherwise provided for on the drawings.
- PART III - SEWER (To be printed on sewer plans only)**
- All sewer mains shall be DIP, RCP, and P.V.C. unless otherwise noted.
 - All manholes shall be 4' - 0" inside diameter unless otherwise noted.
 - Force mains shall be D.I.P. only.
 - Manholes shown with 12" and 16" walls are for brick manholes only.
 - Manholes designated W.T. in plan and profile shall have watertight frame and covers, Standard Detail G3.32. Where watertight frame and cover is used, set top of frame 1' - 5" above finished grade unless otherwise noted on the drawings.
 - House(s) with the symbol "C.N.S." indicates that cellar cannot be served.
- PART IV - FIRE HYDRANT**
- Fire hydrants shall be set to the bury line elevations shown on the drawings. All fire hydrants shall be restrained with concrete in accordance with the Standard Details. Soil around the fire hydrant shall be compacted in accordance with Section 1000 and 1005 of the Standard Specifications.
 - The contractor shall not operate any water main valves on the existing water system.
 - All water house connections shall be for inside meter setting unless otherwise noted on plans or in specifications.
 - For sprinkler system for all townhomes or multi-family dwelling units should have a minimum of 1' connection with a 3/4" meter.

SOP-95-128
 REVIEWED FOR HOWARD SOIL CONSERVATION DISTRICT AND MEETS TECHNICAL REQUIREMENTS.
 Patricia Engle
 U.S. SOIL CONSERVATION DISTRICT
 DATE 9/27/95

SOP-95-128
 THIS DEVELOPMENT IS APPROVED FOR SOIL EROSION AND SEDIMENT CONTROL BY THE HOWARD COUNTY SOIL CONSERVATION DISTRICT.
 John R. Edenton
 HOWARD COUNTY SOIL CONSERVATION DISTRICT
 DATE 9/27/95

DEPARTMENT OF PUBLIC WORKS HOWARD COUNTY, MARYLAND Robert Benson CHIEF, DEPARTMENT OF UTILITIES DATE 2-26-95	DEPARTMENT OF PLANNING & ZONING HOWARD COUNTY, MARYLAND Chief Development Engineering Division DATE 9/27/95	D.S. THALER & ASSOC. INC. 7115 AMBASSADOR ROAD BALTIMORE, MARYLAND 21244 (410)944-ENGR, 944-3847	DES. J.D.C. GRN. J.A.U. CHK. A.J.D. DATE 9/22/95	PUBLIC WATER & SEWER PLANS & PROFILES	CONCRETE PIPE AND PRODUCTS CO., INC. BUILDING ADDITION JESSUP FACILITY 7970 WATERLOO ROAD JESSUP, MD. 20794	SCALE AS SHOWN SHEET 1 OF 1 ELECTION DISTRICT: 6, HOWARD COUNTY, MD. CONTRACT # 24-3462
--	--	--	---	--	--	---

3462 topo/pos. skt. Dorsey Run Rd, concrete pipe & products

TOPOGRAPHIC SURVEY PLAT

LEGEND

CONCRETE PIPE
 SUBD NAME: PRODUCTS CO., INC.
 SEC AREA
 STREET NAME: DORSEY RUN ROAD
 CAP. PROJ. NO. 24-3462-W-1
 CONTRACT NO. 24-3462
 FIELD BOOK NO. W/A
 SCALE 1" = 50'

PREPARED BY:

P.S. TABLER & ASSOC. INC.
 7115 EMBASSADOR ROAD
 BLDG. NO. 21201
 (410) 979-7047

SURVEY BASED ON HOWARD COUNTY SURVEY CONTROL POINTS:

4336 N 54417.5216
 E 1370550.8100
 ELEV. 220.16
 # 30 N 545284.880
 E 1371501.666
 ELEV. 217.36

[Signature]
 10/6/95

