

QUANTITIES				
ITEM	ESTIMATED	QUANTITIES	AS-BUILT	SUPPLIER
8" WATER, D.I.P.	105 LF.	110 LF.	DIP	QUINN PIP CO.
8" PLUG	1 EACH	1 EA.	DIP	QUINN PIP CO.
SADDLE	3 EACH	3 EA.	STAINLESS STEEL	MUSCOLE CO.
4" SHC	70 LF.	73 LF.	P.V.C.	J.M. MARSH INC.
1/2" WMC	30 LF.	33 LF.	P. COPPER	HUNTER METAL
1" WMC	30 LF.	33 LF.	P. COPPER	HUNTER METAL
3/4" METER YADLT	1 EACH	1 EA.	P.V.C.	QUINN PIP CO.
DRAIN FOR MAIN	1 EACH	1 EA.	P.V.C.	QUINN PIP CO.

SURVEY & DRAFTING DIVISION "AS-BUILT" DATE:  
NAME OF UTILITY CONTRACTOR:

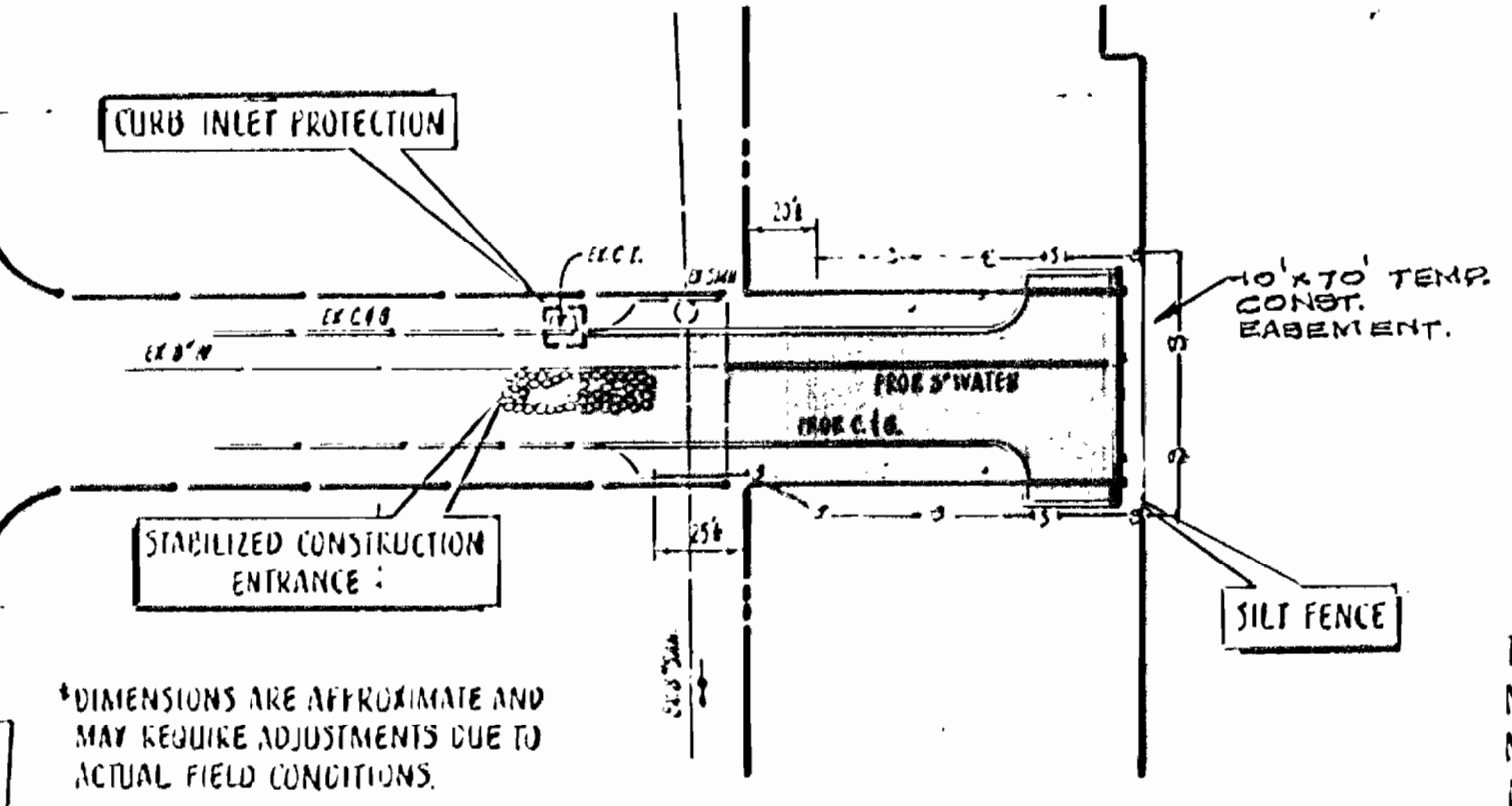
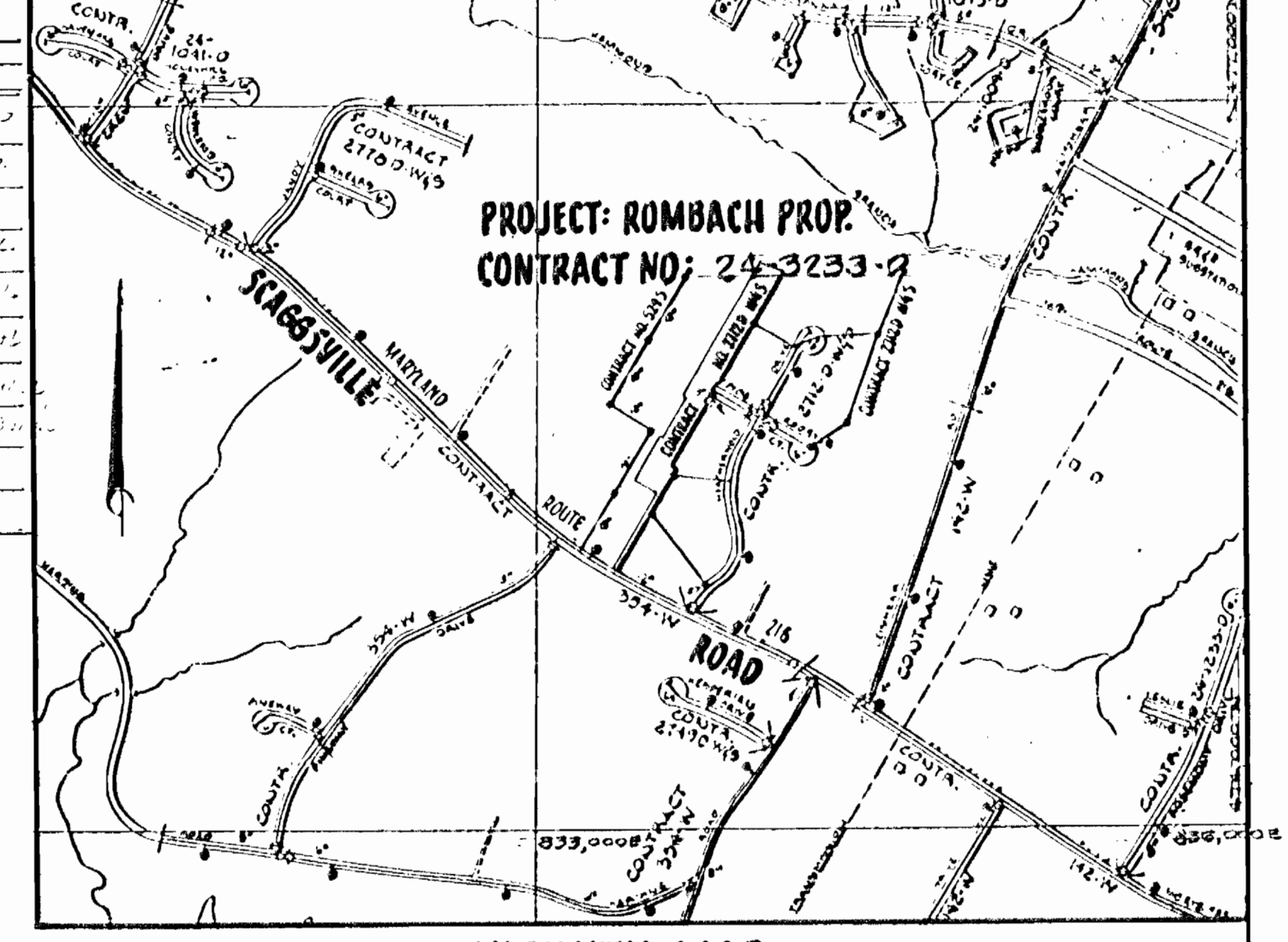

**SEDIMENT CONTROL PLAN**  
SCALE: 1" = 50'

**VICINITY MAP**  
SCALE: 1" = 600'

TYPE OF BUILDING	SINGLE FAMILY RESIDENTIAL	WATER AND SEWER CODE	(FOR COUNTY OFFICE USE ONLY)
NO. OF LOTS/PARCELS	4	WATER NO. E-13	
NO. OF WATER HOUSE CONNECTIONS	3	SEWER NO. 7530000	
NO. OF SEWER HOUSE CONNECTIONS	3	TEST GRADIENT	100
DRAINAGE AREA	LITTLE PATENT		
TREATMENT PLANT	LITTLE PATENT WATER QUALITY MANAGEMENT CENTER SAVAGE, HOWARD COUNTY		

**CONSTRUCTION SEQUENCE AND MISCELLANEOUS REQUIREMENTS**

- Sediment Control Requirements**
- These requirements cover Water Line Extension, WMC and SHC, as well as Road Extension although under separate contract. If different contractors are used coordination of these requirements between the contractors is necessary.
  - Do not proceed with construction until all agreements and permits have been executed and issued.
  - All sediment control measures shall be in accordance with Section 219 of Howard County Design Manual, Volume IV, Standard Specifications and Details and 1993 Maryland Standards and Specifications for Soil Erosion and Sediment Control.
  - Provide and maintain safety barricades, flashing lights, signs, etc. for public and workperson protection.
  - Install Curb Inlet Protection (Md. Std. IPO-1) for existing curb inlet structures: 1/4 work day.
  - Remove existing paving beginning at approx. sta. 1+55 to end (sta. 1+71.03). Remove existing barricade: 1/2 work day.
  - Install Stabilized Construction Entrance (Md. Std. SCE-1): 1/4 work day.
  - Install silt fence (Md. Std. SF-1): 1 work day.
  - Clear and grub: 1 work day.
  - Install 6" water pipe extension, appurtenances, and 3/4" WMC thereto prior to road extension: 2 work days.
  - Construct road extension and appurtenances: 4 work days.
  - Install all SHC Lots #4 thru #6. Provide and maintain safety devices (Item #4 above) and sediment control devices (Item #3 above): 2 work days.
  - Maintain all sediment control devices on a daily basis.
  - Temporarily stabilize all disturbed soil areas within 7 calendar days (Md. Std. Category III, 50.01).
  - Permanently stabilize all disturbed soil areas at end of construction (Md. Std. Category III): 1/2 work day.
  - After all construction approvals have been received, remove all sediment control devices, clean and restore areas and after receiving permission from the Sediment Control Inspector. (1 work day).
  - Total Time: 12 1/2 Work Days.

**GENERAL NOTES**

- Approximate location of existing mains are shown. The contractor shall take all necessary precautions to protect existing mains and services and maintain uninterrupted supply. Any damage incurred shall be repaired immediately to the satisfaction of the Engineer at the contractor's expense.
- All horizontal controls are based on Maryland State Coordinates.
- All vertical controls are based on U.S.G.S. data.
- All pipe elevations shown are invert elevations.
- Clear all utilities by a minimum of 6". Clear all poles by 2'-0" minimum or tunnel as required. The owner has contacted the utility companies and has made arrangements for bracing of poles as shown on the drawings. In the event the contractor's work requires the bracing of additional poles, any cost incurred by the owner for bracing of additional poles or damages shall be deducted from money owed the contractor. The contractor shall coordinate with the utility companies to schedule the bracing of the poles.
- For details not shown on the drawings, and for materials and construction methods use Howard County Design Manual, Volume IV, Standard Specifications and Details for Construction (Latest Edition). The contractor shall have a copy of Volume IV on the job.
- Where test pits have been made on existing utilities, they are noted by the symbol at the location of the test pit. A note or notes containing the results of the test pit or pits is included on the drawings. Existing utilities in the vicinity of the proposed work for which test pits have not been dug shall be located by the contractor at his own expense.
- Contractor shall notify the following utility companies or agencies at least five working days before starting work shown on these plans:  
State Highway Administration 531-5333  
B.G. & E. Co. - Contractor Services 950-4620  
B.G. & E. Co. - Under Ground Damage Control 787-7069  
Miss Utility 1-800-559-0100  
Colonial Pipeline Co. 775-1370  
Howard County Department of Public Works Bureau of Utilities 313-4700
- Trees and shrubs are to be protected from damage to maximum extent. Trees and shrubs located within the construction strip are not to be removed or damaged by the contractor.
- Contractor shall remove trees, stumps and roots along line of excavation. Payment for such removal shall be included in the unit price for construction of the main.
- All water mains to be D.I.P. Class 52 unless otherwise noted. All D.I.P. fittings shall be in accordance with AWWA Specifications on C-153; Ductile Iron Compact Fittings, 3-inch through 12-inch for water and other liquids.
- Tops of all water mains to have a minimum of 3'-1/2" cover unless otherwise noted.
- Values adjacent to trees shall be strapped to trees.
- All fittings shall be buttressed or anchored with concrete in accordance with the Standard Details unless otherwise provided for on the drawings.
- The contractor shall not operate any water main valves on the existing water system.
- All water house connections shall be for inside meter setting unless otherwise noted on plans or in specifications.

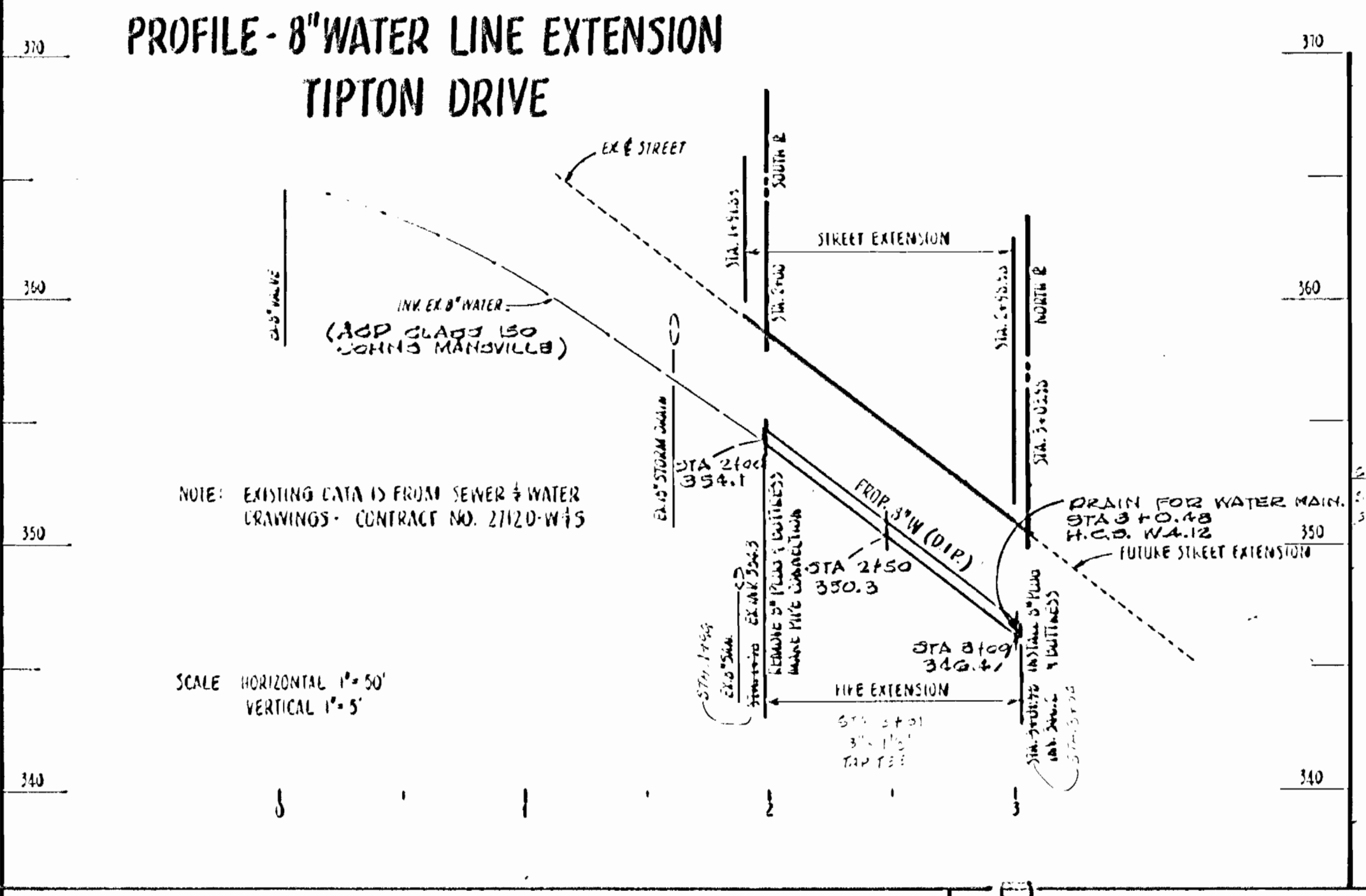

**DEPARTMENT OF PUBLIC WORKS**  
HOWARD COUNTY, MARYLAND

**AEdile Inc.**  
ENGINEERS - BUILDERS  
1521 CENTERCOTE DRIVE  
SILVER SPRING, MARYLAND 20905  
(301) 589-2830

DES: RLP  
DRN: WVA  
CHK:  
DATE: 12-8-92 BY NO. REVISION DATE

**PLAN & PROFILE - EXTENSION OF 8" WATER - TIPTON DR. WATER AND SEWER HOUSE CONNECTIONS**  
Lots 3 through 6  
Tax Map no. 46

**ROMBACH PROPERTY**  
Lots 3 through 6  
SIXTH ELECTION DISTRICT  
HOWARD COUNTY, MARYLAND  
CONTRACT NO. 24-2233-D

SCALE A3 SHOWN  
Parcel no. 319  
SHEET 1 OF 2  
AS-BUILT

**PLAN SCALE: 1" = 30'**

**PROFILE - 8" WATER LINE EXTENSION TIPTON DRIVE**

NOTE: EXISTING DATA IS FROM SEWER & WATER DRAWINGS - CONTRACT NO. 2712-0-W45

SCALE: HORIZONTAL 1" = 50'  
VERTICAL 1" = 5'

Item	Howard County Standard
Trench Bedding for Pipe	0 2.01
Buttress for 8" Plug	0 2.21
4" sewer house connection	5 2.11 modified for Cast Iron Saddle per 5 2.21
Cleanout for sewer house connection	
3/4" water service connection (lots 4 and 5 - inside meter)	0 3.21
3/4" water service connection (lot 6 - outside meter)	0 3.31
Frame and cover for outside meters	0 3.12
DRAIN FOR WATER MAIN	0 4.12

6. Invert elevations for 4" sewer house connections:

Lot No.	Invert elev. (ex. 3" san.)	Invert elev. at property line (SLOPE 2% E)
3	349.6	350.2
4	325.1	349.1
5	347.1	347.7

These invert elevations have been calculated on the basis of "As-built" drawings from contract 2712-0-W45. Should actual field measured invert elevations be greater than +.10' compared to those calculated, contact Engineer immediately (1-301-989-0230) before proceeding.

No sewer services are provided for basement facilities, except by sewage ejector pump systems. Listed below are required minimum first floor elevations (H.F.E.) with sewer entering houses approx. 3' to 4' below these elevations.

Lot No.	H.F.E.
3	356.0
4	354.0
5	354.2

This development is approved for erosion and sediment control by the Howard Soil Conservation District.

Approved: *John E. ...*  
Howard Soil Conservation District

Sediment Control measures for this contract will be implemented in accordance with Section 219 of the Howard County Design Manual and Standards and Specifications for soil erosion and sediment control in developing areas AND AS PER ROAD CONSTRUCTION PLAN, P-42-157. Reviewed for Howard County Soil Conservation District and meets technical requirements.

*James M. ...*  
U.S. Soil Conservation Service

OWNER: ALEX ROMBACH  
10270 SCAGGSVILLE RD  
LAUREL, MD 20783

CONTRACT NO. 24-2233-D  
ROMBACH PROPERTY, LOTS 3 THRU 6  
WATER AND SEWER  
HOWARD COUNTY, MARYLAND

