

QUANTITIES				
ITEMS	QUANTITIES ESTIMATED	AS-BUILT		
		QUANTITIES	TYPE	MANUFACTURER/SUPPLIER
FIRE HYDRANT	1 EA.	1 EA.	CAST IRON	MUELLER CO.
12" X 6" TEE	1 EA.	1 EA.	D.I.P.	ATLANTIC STATES
12" X 12" V.	1 EA.	1 EA.	CAST IRON	MUELLER CO.
12" P	1 EA.	1 EA.	CAST IRON	ATLANTIC STATES
12" DIP WATER	127 LF	104 LF	D.I.P.	HALSTEAD CO.
1-1/2" TYPE K WATER	75 LF	10 LF	K COPPER	IM - MANUFACTURING
4" PVC LATERAL	5 LF	5 LF	PVC	
UTILITY CONTRACTOR: FERGUSON TRENCHING COMPANY				
SURVEY AND DRAFTING DIVISION AS-BUILT DATE:				

**Owner**  
Route 1 & 31 Limited Partnership  
6917 Arlington Boulevard  
Suite 350  
Bethesda, Maryland 20814

**Developer**  
Crown Central Petroleum Corp.  
7310 Ritchie Highway  
Suite 817  
Glen Burnie, Maryland 21061

**BENCHMARKS**

BM #1 PIN W/CAP (FOUND)  
EL. 233.14  
BM #2 PK NAIL (FOUND)  
EL. 225.62

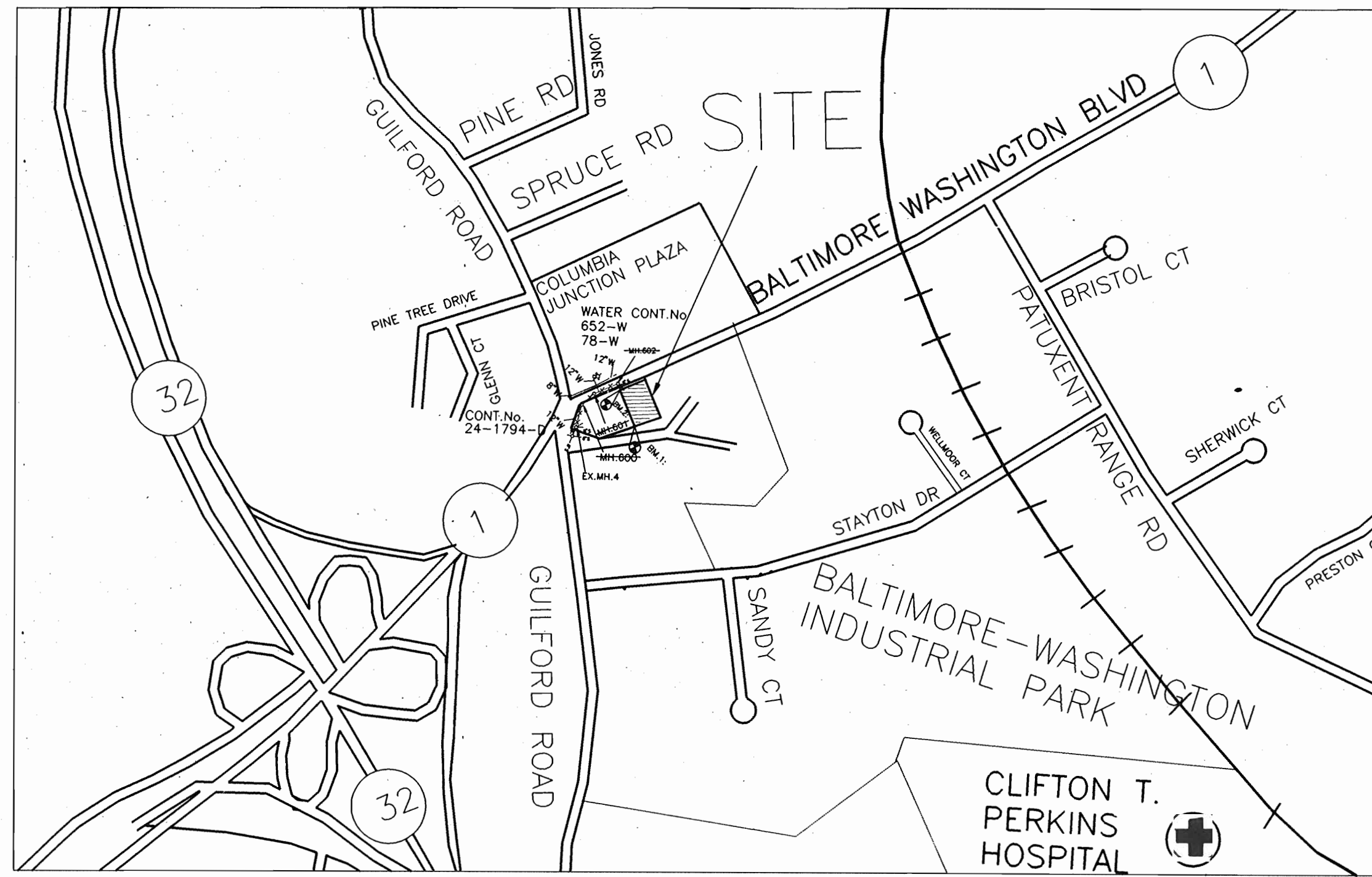

TYPE OF BUILDING: GASOLINE SERVICE STATION  
NUMBER OF LOTS: 1  
No. OF WATER HOUSE CONNECTIONS: 1  
No. OF SEWER HOUSE CONNECTIONS: 1  
DRAINAGE AREA:

VICINITY MAP  
SCALE: 1" = 600'

WATER AND SEWER CODE  
FOR COUNTY USE ONLY  
WATER No. B02  
SEWER No. 4250000  
TEST GRADIENT 550

**GENERAL NOTES**

- APPROXIMATE LOCATION OF EXISTING MAINS ARE SHOWN. THE CONTRACTOR SHALL TAKE ALL NECESSARY PRECAUTIONS TO PROTECT EXISTING MAINS AND SERVICES AND MAINTAIN UNINTERRUPTED SUPPLY. ANY DAMAGE INCURRED SHALL BE REPAIRED IMMEDIATELY TO THE SATISFACTION OF THE ENGINEER AT THE CONTRACTOR'S EXPENSE.
- ALL HORIZONTAL CONTROLS ARE BASED ON MARYLAND STATE COORDINATES.
- ALL VERTICAL CONTROLS ARE BASED ON U.S.G.S. DATA.
- ALL PIPE ELEVATIONS SHOWN ARE INVERT ELEVATIONS.
- CLEAR ALL UTILITIES BY A MINIMUM OF 6". CLEAR ALL POLES BY 2'-0" MINIMUM OR TUNNEL AS REQUIRED.
- FOR DETAILS NOT SHOWN ON THE DRAWINGS, AND FOR MATERIALS AND CONSTRUCTION METHODS USE HOWARD COUNTY DESIGN MANUAL, VOLUME IV, STANDARD SPECIFICATIONS AND DETAIL FOR CONSTRUCTION (LATEST EDITION). THE CONTRACTOR SHALL HAVE A COPY OF VOLUME IV ON THE JOB.
- WHERE TEST PITS HAVE BEEN MADE ON EXISTING UTILITIES, THEY ARE NOTED BY THE SYMBOL AT THE LOCATION OF THE TEST PIT. A NOTE OR NOTES CONTAINING THE RESULTS OF THE TEST PIT OR PITS IS INCLUDED ON THE DRAWINGS. EXISTING UTILITIES IN THE VICINITY OF THE PROPOSED WORK FOR WHICH TEST PITS HAVE NOT BEEN DUG SHALL BE LOCATED BY THE CONTRACTOR TWO WEEKS IN ADVANCE OF CONSTRUCTION OPERATIONS AT HIS OWN EXPENSE.
- CONTRACTOR SHALL NOTIFY THE FOLLOWING UTILITY COMPANIES OR AGENCIES AT LEAST FIVE WORKING DAYS BEFORE STARTING WORK SHOWN ON THESE PLANS:
 

STATE HIGHWAY ADMINISTRATION	531-5533
BG&E CO. CONTRACTOR SERVICES	850-4620
BG&E CO. UNDER GROUND DAMAGE CONTROL	787-9068
COLONIAL PIPELINE CO.	795-1390
HOWARD COUNTY DEPARTMENT OF PUBLIC WORKS	
BUREAU OF UTILITIES	313-4900
BG&E TROUBLE SHOOTING	298-9002
C&P TELEPHONE	1-800-257-7777
- TREES AND SHRUBS ARE TO BE PROTECTED FROM DAMAGE TO MAXIMUM EXTENT. TREES AND SHRUBS LOCATED WITHIN THE CONSTRUCTION STRIP ARE NOT TO BE REMOVED OR DAMAGED BY THE CONTRACTOR.
- CONTRACTOR SHALL REMOVE TREES, STUMPS AND ROOTS ALONG LINE OF EXCAVATION. PAYMENT FOR SUCH REMOVAL SHALL BE INCLUDED IN THE UNIT PRICE BID FOR CONSTRUCTION OF THE MAIN.
- PLACE REGULATION "MEN WORKING" AND WARNING SIGNS AS REQUIRED TO COMPLY WITH MARYLAND STATE HIGHWAY ADMINISTRATION MANUAL OF TRAFFIC CONTROL FOR HIGHWAY CONSTRUCTION & MAINTENANCE OPERATIONS.

**WATER NOTES**

- ALL WATER MAINS TO BE D.I.P. CLASS 52 UNLESS OTHERWISE NOTED.
- TOPS OF ALL WATER MAINS TO HAVE A MINIMUM OF 3-1/2' COVER UNLESS OTHERWISE NOTED.
- VALVES ADJACENT TO TEES SHALL BE STRAPPED TO TEES.
- ALL FITTINGS SHALL BE BUTTRESSED OR ANCHORED WITH CONCRETE IN ACCORDANCE WITH THE STANDARD DETAILS UNLESS OTHERWISE PROVIDED FOR ON THE DRAWINGS.
- FIRE HYDRANTS SHALL BE SET TO THE BURY LINE ELEVATIONS SHOWN ON THE DRAWINGS. ALL FIRE HYDRANTS SHALL BE STRAPPED AND BUTTRESSED WITH CONCRETE IN ACCORDANCE WITH STANDARD DETAILS. SOIL AROUND THE FIRE HYDRANT SHALL BE COMPACTED IN ACCORDANCE WITH SECTION 1000 AND 1005 OF THE STANDARD SPECIFICATIONS.
- THE CONTRACTOR SHALL NOT OPERATE ANY WATER MAIN VALVES ON THE EXISTING WATER SYSTEM.
- ALL DIP FITTINGS SHALL BE IN ACCORDANCE WITH AWWA SPECIFICATION C-153 DUCTILE IRON COMPACT FITTINGS, 3" THROUGH 12" FOR WATER AND OTHER LIQUIDS.
- ALL WATER HOUSE CONNECTIONS SHALL BE FOR INSIDE METER SETTING UNLESS OTHERWISE NOTED ON PLANS OR IN SPECIFICATIONS.
- WATER MAIN AND WATER HOUSE CONNECTION LINES MUST BE PLACED SO AS TO HAVE AT LEAST ONE (1) FOOT SEPARATION FROM THE SEWER MAIN OF SEWER HOUSE CONNECTION AS THEY PASS ABOUT IT. WATER HOUSE CONNECTION AS PER HOWARD CO. STANDARD (W3.21).

**SEWER NOTES**

- ALL SEWER MAINS SHALL BE DIP, RCP, VCPX, CSPX, RCCP AND P.V.C. UNLESS OTHERWISE NOTED.
- THE CONTRACTOR SHALL PROVIDE A JOINT IN ALL SEWER MAINS WITHIN 2'-0" OF EXTERIOR MANHOLE WALL.
- ALL MANHOLES SHALL BE 4'-0" INSIDE DIA. UNLESS OTHERWISE NOTED.
- FORCE MAINS SHALL BE D.I.P. ONLY.
- MANHOLES SHOWN WITH 12" AND 16" WALLS ARE FOR BRICK MANHOLES ONLY.
- MANHOLES DESIGNATED W.T. IN PLAN AND PROFILE SHALL HAVE WATERTIGHT FRAME AND COVERS, STANDARD DETAIL G5.52. WHERE WATERTIGHT MANHOLE FRAME AND COVER IS USED, SET TOP OF FRAME 1"-6" ABOVE FINISHED GRADE UNLESS OTHERWISE NOTED ON THE DRAWINGS.
- HOUSE(S) WITH THE SYMBOL "C.N.S." INDICATES THAT THE CELLAR CANNOT BE SERVED.
- MANHOLES LOCATED WITHIN PROPOSED ROADWAYS WILL HAVE STANDARD HEAVY TRAFFIC MANHOLE FRAME AND COVER STANDARD DETAIL G5.51.

CONTRACT NO. 24-3229-D  
**CROWN STATION**  
**8755 WASHINGTON BLVD.**  
**WATER AND SEWER MAIN EXTENSION**  
**HOWARD COUNTY, MARYLAND**  
**DEPARTMENT OF PUBLIC WORKS**

SEDIMENT CONTROL MEASURES FOR THIS CONTRACT WILL BE IMPLEMENTED IN ACCORDANCE WITH SECTION 219 OF THE HOWARD COUNTY DESIGN MANUAL AND STANDARDS AND SPECIFICATIONS FOR SOIL EROSION AND SEDIMENT CONTROL IN DEVELOPING AREAS AND ALSO AS SHOWN ON THE GRADING AND SEDIMENT CONTROL PLAN SDP-93-11.

REVIEWED FOR HOWARD COUNTY SOIL CONSERVATION DISTRICT AND MEETS TECHNICAL REQUIREMENTS.

*Jean M. Zuber / ps.* 2/5/93  
 U.S. SOIL CONSERVATION SERVICE DATE

THIS DEVELOPMENT PLAN IS APPROVED FOR EROSION AND SEDIMENT CONTROL BY HOWARD SOIL CONSERVATION DISTRICT

APPROVED:  
*Shoff G. Selig* 2/5/93  
 HOWARD SOIL CONSERVATION DISTRICT DATE

SITE PLAN SHEET INDEX	
SHEET NO.	SHEET TITLE
1.)	TITLE SHEET
2.)	WATER AND SEWER EXTENSION PLAN & PROFILE

CONTRACT NO. 24-3229-D  
 CROWN STATION  
 WATER AND SEWER MAIN EXTENSION  
 HOWARD COUNTY, MARYLAND

DEPARTMENT OF PUBLIC WORKS  
 HOWARD COUNTY, MARYLAND  
*James P. Selig* 2/9/93  
 DIRECTOR OF PUBLIC WORKS DATE  
*Robert R. Bunn* 2-2-93  
 CHIEF, BUREAU OF UTILITIES DATE  
*David G. Kotecki* 2/5/93  
 CHIEF, LAND DEVELOPMENT DIVISION DATE

**SOI SHAK CONSULTANTS, INC.**  
 ENGINEERS - PROJECT MANAGEMENT - PLANNERS  
 30 West Gude, Suite 120, Rockville, Maryland 20850  
 P.O. Box 10313 Rockville 20849-0313  
 Phone 301 294 6390

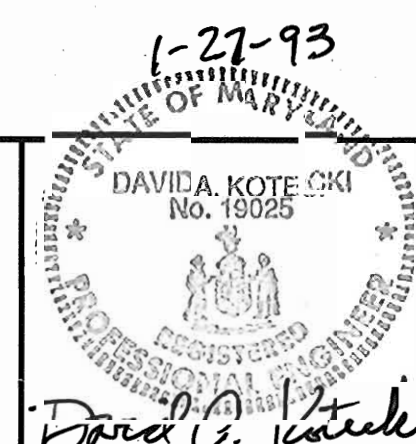

DES:	HAC:	ECC	1	-SAN-SEW-ENCASEMENT WITH D.I.P.-	
DRN:	CoV.	LEM	2	REVISED QUANTITIES	1-18-95
CHK:	DAK.	LEM	3	REVISED VICINITY MAP	1-18-95
		AEF	4	REVISED QUANTITIES	10-95
DATE:	1/27/93	BY:	NO.	REVISION	DATE

AutoCad File: 8551CVR2.DWG

TITLE SHEET

**CROWN STATION**  
**8755 WASHINGTON BOULEVARD**  
 CONTRACT NO. 24-3229-D  
 ELECTION DISTRICT NO. 6  
 HOWARD COUNTY, MARYLAND

SCALE AS SHOWN

SHEET

1 OF 2

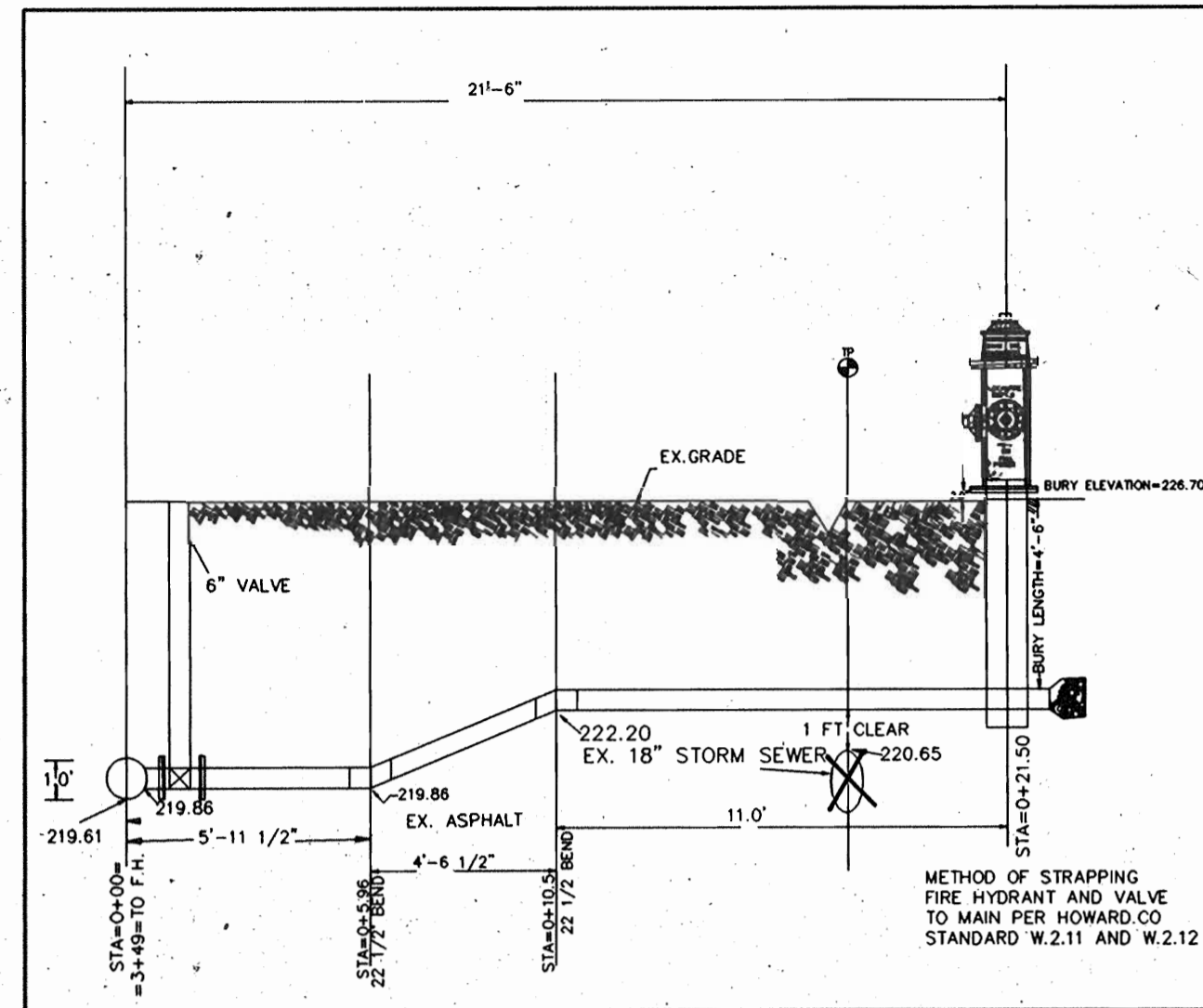

FIRE HYDRANT DETAIL  
N.T.S.

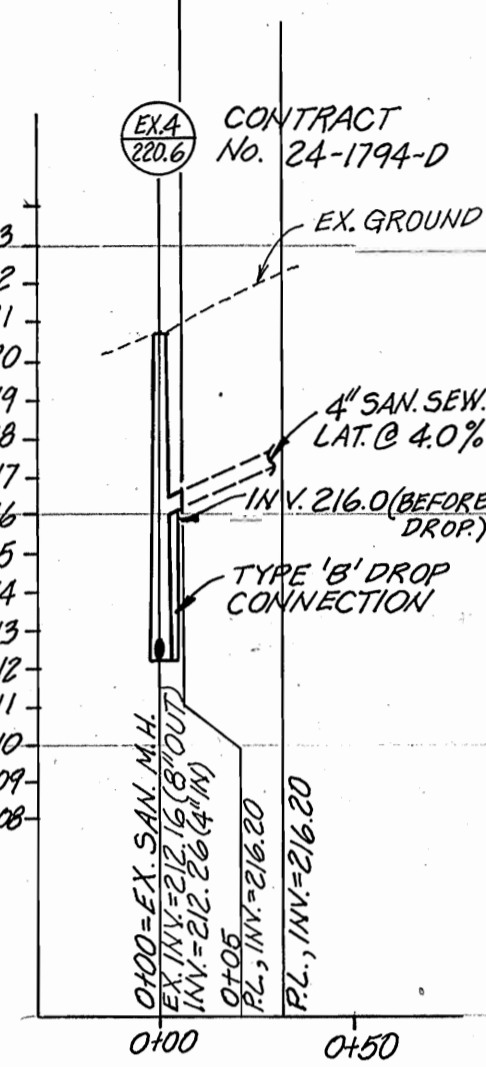
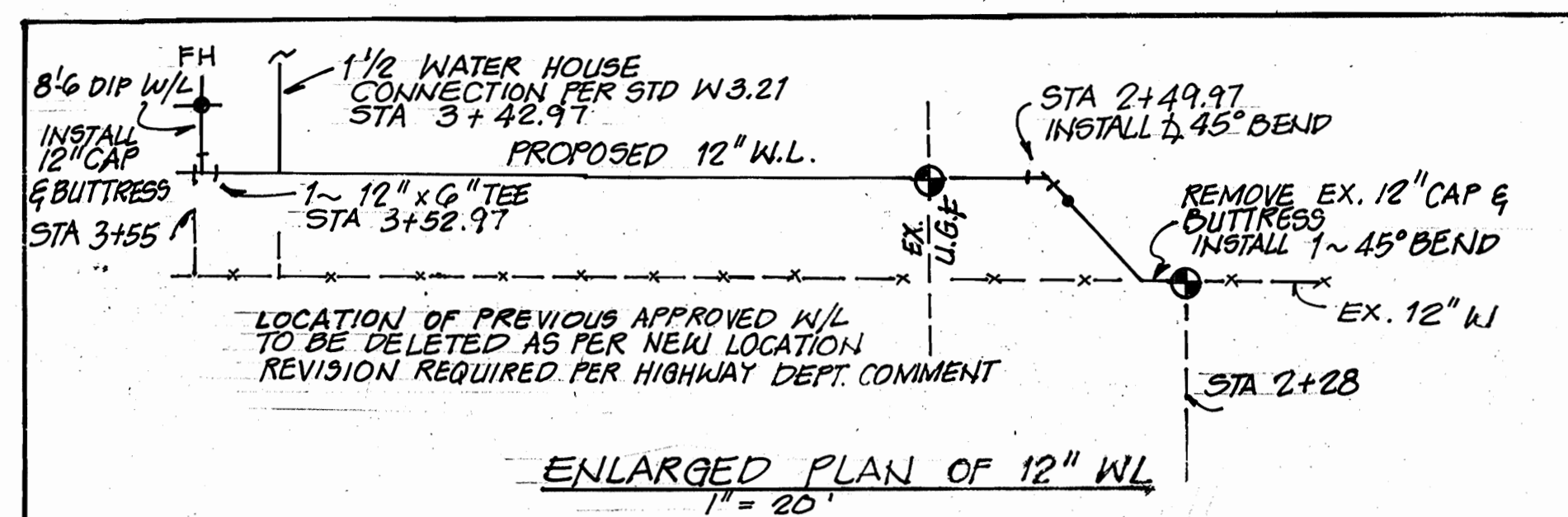

SANITARY SEWER  
PROFILE 'B'

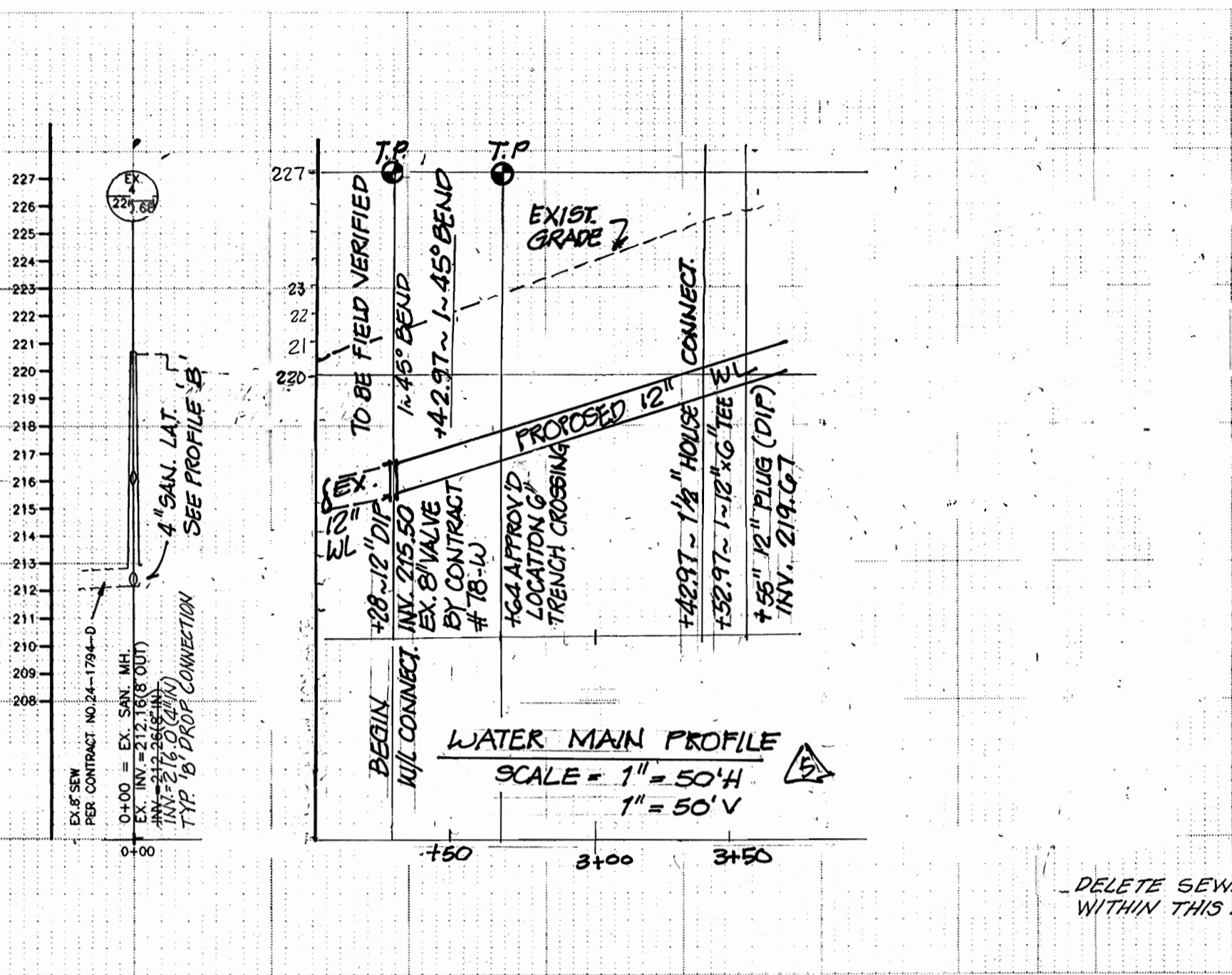

WATER &  
SANITARY SEWER PROFILE  
SCALE: 1"=5' VERT.  
1"=50' HORZ.

F.H. 4.50 BURY - B.L. ELEV. = 226.70  
12" x 6" F.H. T. 3'-48" O.C.  
6" VALVE - 0'-08"  
6" F.H. 0'-08"  
6" VALVE - 3' OFF F.H.  
6" VALVE - 04' OFF TELE MH  
F.H. SET TO EX. CURB

SEE ENLARGED PLAN  
ABOVE FOR THIS AREA

THIS EXTENSION IS DELETED  
AND REPLACED BY SEWER  
LINE THRU ADJACENT PROPERTY.  
SEE PLAN AND PROFILE (ABOVE)

- NOTES:**
1. SEDIMENT CONTROL MEASURES FOR THIS CONTRACT WILL BE IMPLEMENTED IN ACCORDANCE WITH SECTION 219 OF THE STANDARD SPECIFICATION AND FINAL PLANS
  2. BEFORE BEGINNING CONSTRUCTION, CONTACT "MISS UTILITY" AT 1-800-257-7777 AT LEAST 48 HOURS PRIOR TO CONSTRUCTION.
  3. X AN OPEN CUT METHOD WILL BE USED TO INSTALL UTILITIES.
  4. X EX. 12" VALVE WILL BE TEMPORARILY CLOSED. IT WILL AFFECT THE PROPERTIES ACROSS RT. 1 TO THE NORTH OF THE SITE INCLUDING THE FIRE HYDRANT.
  5. X CONCRETE ENCASUREMENTS OF WATER MAINS SHALL NOT BE USED.
  6. X WHEN WATER LINE CROSSES OVER OR UNDER ANY OTHER UTILITY OR OBSTRUCTION, IT SHALL NOT EXCEED THE MINIMUM RADIUS ALLOWED BY THE MANUFACTURER.
  7. X WATER HOUSE CONNECTION AS PER HOWARD CO. STANDARD (W3.21)
  8. X FOR ADDITIONAL INFORMATION ON THE FINAL CROWN SITE DEVELOPMENT PLAN REFER TO SDP 93-11
- TEST PIT REQUIRED PRIOR TO CONSTRUCTION TO PREVENT CROSSING CONFLICTS.

**Owner**  
Route 1 & 31 Limited Partnership  
6917 Arlington Boulevard,  
Suite 350  
Bethesda, Maryland 20814

**Developer**  
Crown Central Petroleum Corp.  
7310 Ritchie Highway  
Suite 817  
Glen Burnie, Maryland 21061

1-27-93

AutoCad File: 8551UTIL.DWG

DEPARTMENT OF PUBLIC WORKS  
HOWARD COUNTY, MARYLAND  
2/2/93  
2/2/93  
2/2/93

**SHAK CONSULTANTS, INC.**  
ENGINEERS - PROJECT MANAGEMENT - PLANNERS  
30 West Gude, Suite 120, Rockville, Maryland 20850  
P.O. Box 10313, Rockville 20849-0313  
Phone 301 294 6390

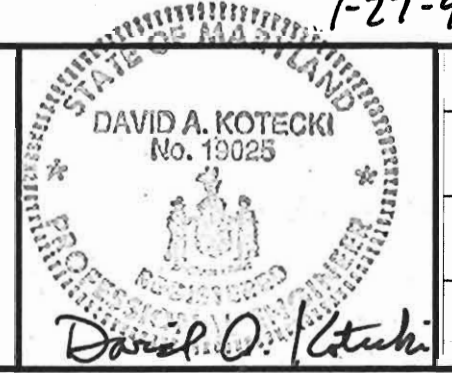

DES: HAC	ECC 1	SAN SEW ENCASEMENT WITH D.I.P	
	LEM 2	REVISED LOCATION OF PROPOSED SANITARY SEWER	1-13-93
DRN: Cav	LEM 3	ADD SAN SEW PROFILE 'B'	
	LEM 4	DELETED SAN SEW PROFILE	
CHK: D.A.K.	AEF 5	ADDED WATER PROFILE & ENLARGED PLAN	10-11-93
DATE: 1/27/93	BY NO.	REVISION	DATE

600' SCALE MAP NO. 48 BLOCK NO. 1

**WATER AND SEWER MAIN EXTENSION PLAN & PROFILE**

**CROWN STATION**  
8755 WASHINGTON BOULEVARD  
CONTRACT NO. 24-3229-D  
ELECTION DISTRICT NO. 6  
HOWARD COUNTY, MARYLAND

SCALE  
1"=50'  
SHEET  
2 OF 2

CONTRACT NO. 24-3229-D  
CROWN STATION  
WATER AND SEWER MAIN EXTENSION  
HOWARD COUNTY, MARYLAND