

PLAN SCALE  
1" = 50'

FOR STAKEOUT TABLE SEE SHEET 10P3

DEPARTMENT OF PUBLIC WORKS  
HOWARD COUNTY, MARYLAND

*James P. ...* 3-19-92  
DIRECTOR OF PUBLIC WORKS DATE

*...* 3-29-92  
CHIEF, BUREAU OF ENGINEERING DATE

*...* 3-12-92  
CHIEF, BUREAU OF UTILITIES DATE

*...* 3-12-92  
CHIEF, LAND DEVELOPMENT DIV. DATE

**CFS** CLARK · FINEPROCK & SACKETT, INC.  
ENGINEERS · PLANNERS · SURVEYORS

7135 MINSTREL WAY COLUMBIA MARYLAND 21045  
(301) 381-7500 BALTO. (301) 621-8100 WASH.

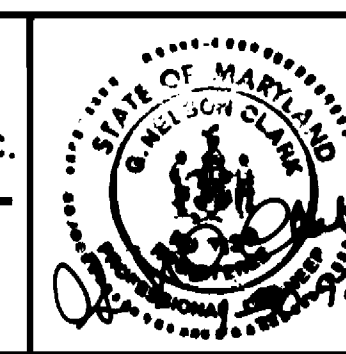

DES: JTR	JTR	1	Revised Finish Grade Elev. at Blow Off Hydrants. Rev. align. of 8" SW CONN. A - East 8" Same Song Sq. to 8" SW. Rev. Ex. 8" S from Ex. MH 100 to MH 5 from private sewer to Public sewer. Rev. Contract Number, Added Sew. Main.	10-8-92
DRN: CAD / JTR	JTR	1		10-8-92
CHK: D.C.M				
DATE: JAN 92	BY	NO.	REVISION	DATE

PLAN & PROFILE OF  
WATER & SEWER MAINS

600'S SCALE MAP NO. 36 BLOCK NO. 1

COLUMBIA TOWN CENTER  
PARCEL A, SECTION THREE, AREA TWO  
5<sup>TH</sup> ELECTION DISTRICT  
CONTRACT NO. 24-3162-D

SCALE  
AS SHOWN

SHEET  
2 OF 3

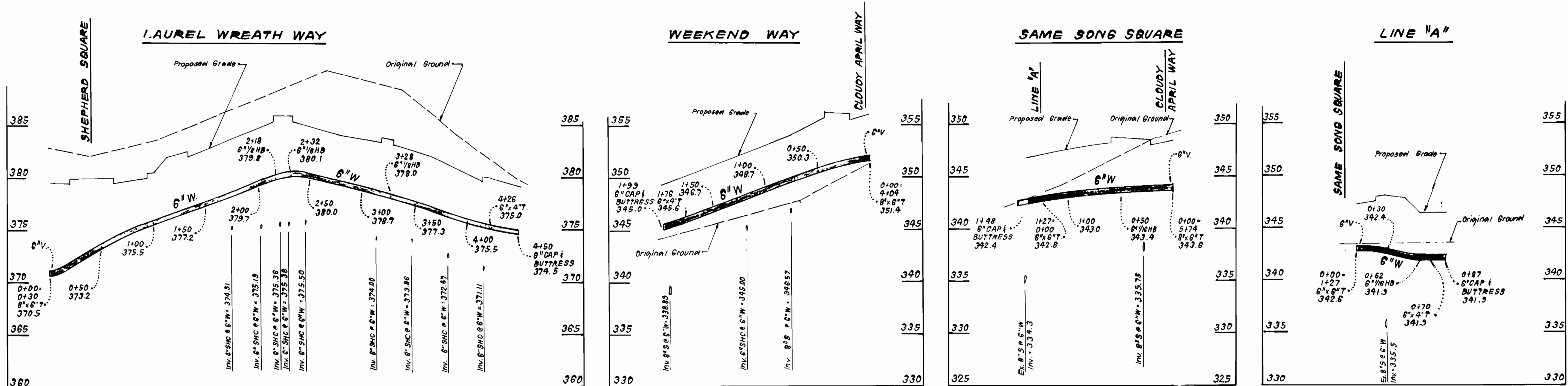

BANNEKER ROAD

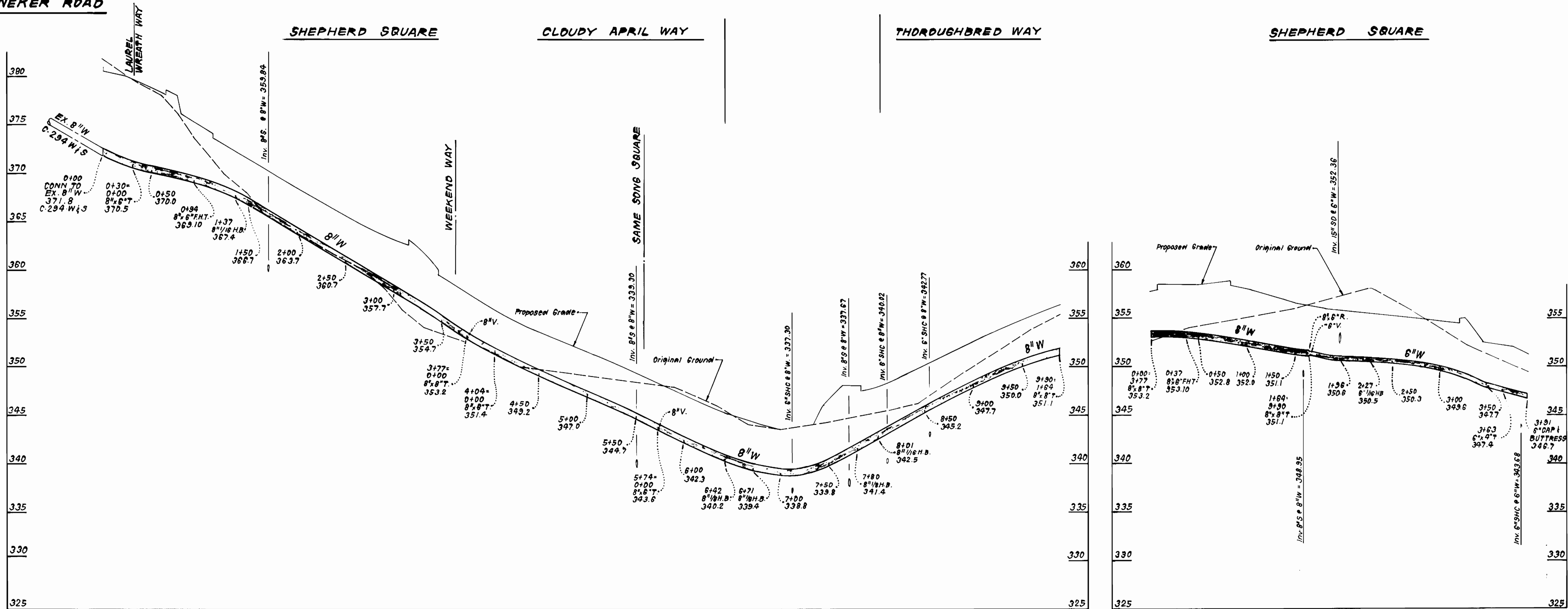

PROFILE SCALE  
 HORIZONTAL: 1" = 50'  
 VERTICAL: 1" = 5'

DEPARTMENT OF PUBLIC WORKS HOWARD COUNTY, MARYLAND Director of Public Works: <i>James J. ...</i> 3-12-92 Chief, Bureau of Utilities: <i>Robert ...</i> 3-12-92		CLARK, FINEPROCK & SACKETT, INC. ENGINEERS - PLANNERS - SURVEYORS 7135 MINSTREL WAY COLUMBIA MARYLAND 21045 (301) 381-7500 BALTO. (301) 621-8100 WASH.		DES: JTR DRN: JTR CHK: C.C.M. DATE: DEC. 91		Rev. Contract Number, Extended 6" W Same Song Square Resized Water Main From LINE "A" 10-8-92		PROFILES OF WATER MAINS		COLUMBIA TOWN CENTER PARCEL A, SECTION THREE, AREA TWO 5TH ELECTION DISTRICT CONTRACT NO. 24-3162-D		SCALE AS SHOWN SHEET 3 OF 3	
		STATE OF MARYLAND DEPARTMENT OF PUBLIC WORKS HOWARD COUNTY		BY NO. REVISION DATE		600' SCALE MAP NO. 36 BLOCK NO. 1		AS-BUILT		CFS 91-061			