

TYPE OF BUILDING: RESIDENTIAL  
 NUMBER OF PARCELS: 2  
 WATER HOUSE CONNECTIONS: 2  
 DRAINAGE AREA: LITTLE PATUXENT

**VICINITY MAP**  
 SCALE: 1" = 600'

**WATER CODE FOR COUNTY USE ONLY:**  
 WATER NO. E-28

**PLAN**  
 Scale: 1" = 50'  
 EDWIN BASSLER SUB-DIVISION NO. 2

**GENERAL NOTES:**

- APPROXIMATE LOCATION OF EXISTING MAINS ARE SHOWN. THE CONTRACTOR SHALL TAKE ALL NECESSARY PRECAUTIONS TO PROTECT EXISTING MAINS, SERVICES AND MAINTAIN UNINTERRUPTED SUPPLY. ANY DAMAGE INCURRED SHALL BE REPAIRED IMMEDIATELY TO THE SATISFACTION OF THE ENGINEER AT THE CONTRACTOR'S EXPENSE.
- ALL HORIZONTAL CONTROLS BASED ON MARYLAND STATE COORDINATES.
- ALL VERTICAL CONTROLS BASED ON U.S.G.S. DATUM.
- ALL PIPE ELEVATIONS SHOWN ARE INVERT ELEVATIONS.
- CLEAR ALL UTILITIES BY A MINIMUM OF 6".
- FOR DETAILS NOT SHOWN ON THE DRAWINGS, AND FOR MATERIALS AND CONSTRUCTION METHODS USE HOWARD COUNTY DESIGN MANUAL, VOLUME IV, STANDARD SPECIFICATIONS AND DETAILS FOR CONSTRUCTION. THE CONTRACTOR SHALL HAVE A COPY OF VOLUME IV ON THE JOB.
- WHERE TEST PITS ARE TO BE MADE ON EXISTING UTILITIES, THEY ARE NOTED BY THE SYMBOL [Symbol] AT THE LOCATION OF THE TEST PIT. A NOTE OR NOTES CONTAINING THE RESULTS OF THE TEST PIT OR PITS IS INCLUDED ON THE DRAWINGS. EXISTING UTILITIES IN THE VICINITY OF THE PROPOSED WORK FOR WHICH TEST PITS HAVE NOT BEEN DUG SHALL BE VERIFIED BY THE CONTRACTOR TO HIS OWN SATISFACTION. ANY DAMAGE TO EXISTING FACILITIES DUE TO THE CONTRACTOR'S NEGLIGENCE SHALL BE REPAIRED AT THE CONTRACTOR'S EXPENSE.
- THE CONTRACTOR SHALL NOTIFY THE FOLLOWING UTILITIES OR AGENCIES AT LEAST FIVE WORKING DAYS BEFORE STARTING WORK SHOWN ON THESE PLANS:  
 BALTO. GAS & ELECTRIC CO. - CONTRACTOR SERVICE 850-4620  
 BALTO. GAS & ELECTRIC CO. - UNDERGROUND DAMAGE CONTROL 859-9004  
 BALTO. GAS & ELECTRIC CO. - TROUBLE SHOOTING 298-9001  
 BUREAU OF UTILITIES, HOWARD COUNTY DEPT. OF PUBLIC WORKS 992-2366  
 C & P TELEPHONE COMPANY 1-800-257-7777  
 COLONIAL PIPELINE COMPANY 795-1390  
 STATE HIGHWAY ADMINISTRATION 531-5533  
 MISS UTILITY 1-559-0100
- TREE AND SHRUBS ARE TO BE PROTECTED FROM DAMAGE TO MAXIMUM EXTENT. TREES AND SHRUBS LOCATED WITHIN THE CONSTRUCTION STRIP ARE NOT TO BE REMOVED OR DAMAGED BY THE CONTRACTOR.
- CONTRACTOR SHALL REMOVE TREES, STUMPS AND ROOTS ALONG LINE OF EXCAVATION. PAYMENT FOR SUCH REMOVAL SHALL BE INCLUDED IN THE UNIT PRICE BID FOR CONSTRUCTION OF THE MAIN.
- ALL WATER MAINS TO BE D.I.P. CLASS 52 UNLESS OTHERWISE NOTED.
- TOPS OF ALL WATER MAINS TO HAVE A MIN. OF 3.5' COVER UNLESS OTHERWISE NOTED.
- VALVES ADJACENT TO TEES SHALL BE STRAPPED TO TEES.
- ALL FITTINGS SHALL BE BUTTRESSED OR ANCHORED WITH CONCRETE IN ACCORDANCE WITH THE STANDARD DETAILS UNLESS OTHERWISE PROVIDED FOR ON THE DRAWINGS.
- FIRE HYDRANTS SHALL BE SET TO THE BURY LINE ELEVATIONS SHOWN ON THE DRAWINGS. ALL FIRE HYDRANTS SHALL BE STRAPPED AND BUTTRESSED WITH CONCRETE IN ACCORDANCE WITH STANDARD DETAILS. SOIL AROUND THE FIRE HYDRANT SHALL BE COMPACTED IN ACCORDANCE WITH SECTION 1003 FROM THE STANDARD SPECIFICATIONS.
- THE CONTRACTOR SHALL NOT OPERATE ANY WATER MAIN VALVES ON THE EXISTING WATER SYSTEM. CALL HOWARD COUNTY BUREAU OF UTILITIES AT 992-2366. COORDINATE THE TIE-IN TO THE EXISTING 8" WATER AT LEAST FIVE WORKING DAYS PRIOR TO SCHEDULING.
- ALL WATER HOUSE CONNECTIONS SHALL BE FOR INSIDE METER SETTING, UNLESS OTHERWISE NOTED ON THE PLANS OR IN THE SPECIFICATIONS.

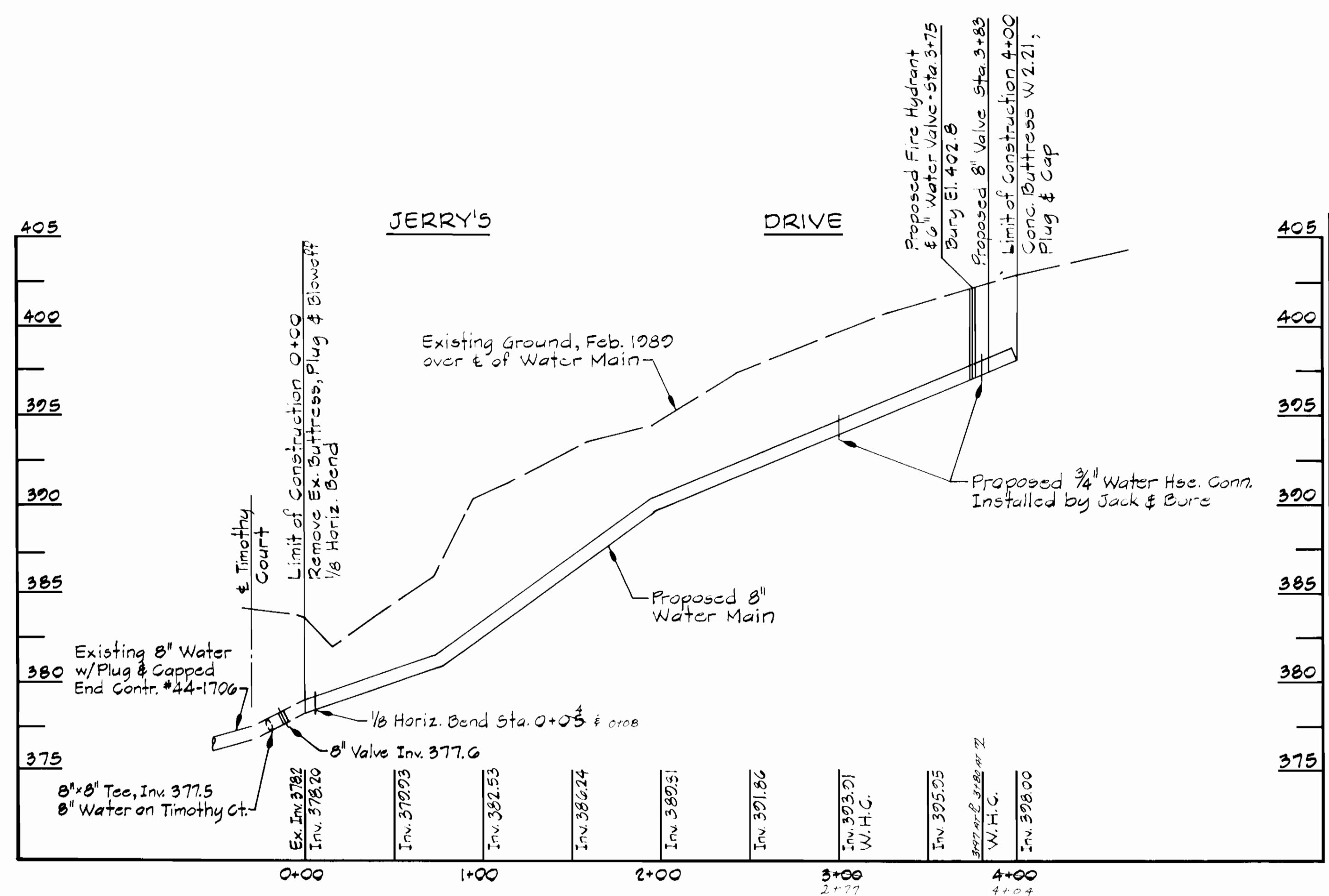

**QUANTITIES**

ITEM	QUANTITIES		TYPE	SUPPLIER
	ESTIM.	AS BUILT		
8" Water Pipe	400 L.F.	404 L.F.	D.I.P.	ATLANTIC STATES CAST IRON PIPE SUPPLIES
3/4" Water Hse. Conn.	90 L.F.	96 L.F.	COPPER	HALSTEAD CO. A.P. SUPPLIES
Standard Fire Hyd.	1	1 EA	MODEL # 4-423	A.P. SUPPLIES
8" Water Valve	1	1 EA	# 2370-20	MUELLER A.P. SUPPLIES

**PROFILE**  
 Scale: 1" = 50' Horiz. & 1" = 5' Vert.

**DEPARTMENT OF PUBLIC WORKS**  
 HOWARD COUNTY, MARYLAND

James M. [Signature] 9-20-89  
 DIRECTOR OF PUBLIC WORKS DATE

Robert [Signature] 9-21-89  
 CHIEF, BUREAU OF UTILITIES DATE

W. [Signature] 9-12-89  
 CHIEF, BUREAU OF ENGINEERING DATE

O. [Signature] 9-12-89  
 CHIEF, UTILITY DIVISION DATE

**WALLACE, MONTGOMERY & ASSOCIATES**  
 1544 YORK ROAD  
 LUTHERVILLE, MARYLAND 21093  
 (301) 494-9093

DES: J.C.W.  
 DRN: S.W.S.  
 CHK: J.C.W.  
 DATE: 4/23/89

**PLAN AND PROFILE OF WATER EXTENSION**

BY NO. REVISION DATE

**JERRY'S DRIVE ROUTINE WATER EXTENSION**  
 CAPITAL PROJECT W 8689  
 CONTRACT NO. 44-1941  
 ELECTION DISTRICT NO. 5  
 HOWARD COUNTY, MARYLAND

SCALE AS SHOWN  
 SHEET 1 OF 2



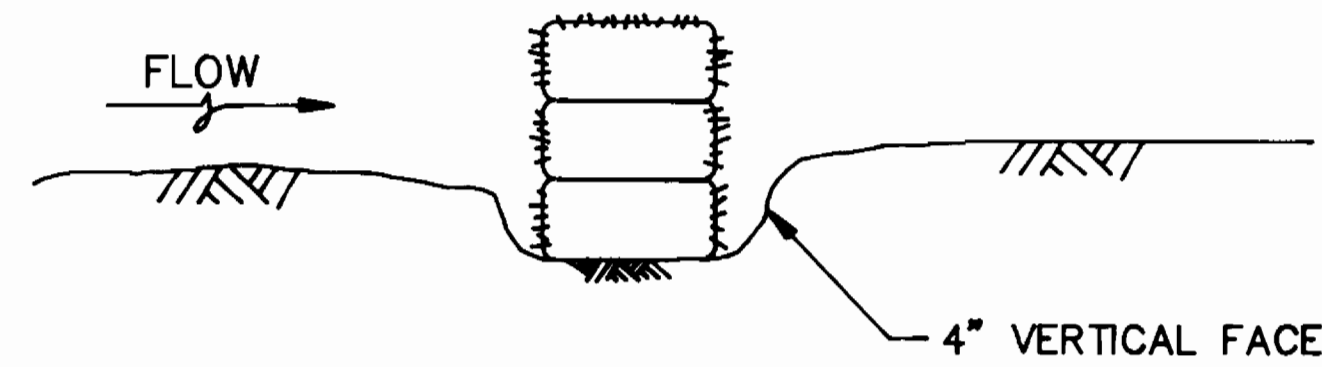

EMBEDDING DETAIL

RESTORATION SCHEDULE		
LOCATION	LENGTH	MATERIAL
Sta. 0+00 to Sta. 0+03	3'	Mac. & Curb/gutter
Sta. 0+03 to Sta. 0+07	04'	Sod
Sta. 0+07 to Sta. 1+12	15'	Concrete Entrance
Sta. 1+12 to Sta. 1+01	00'	Sod
Sta. 1+01 to Sta. 1+04	13'	Gravel Drive
Sta. 1+04 to Sta. 3+05	101'	Sod
Sta. 3+05 to Sta. 4+00	15'	Macadam

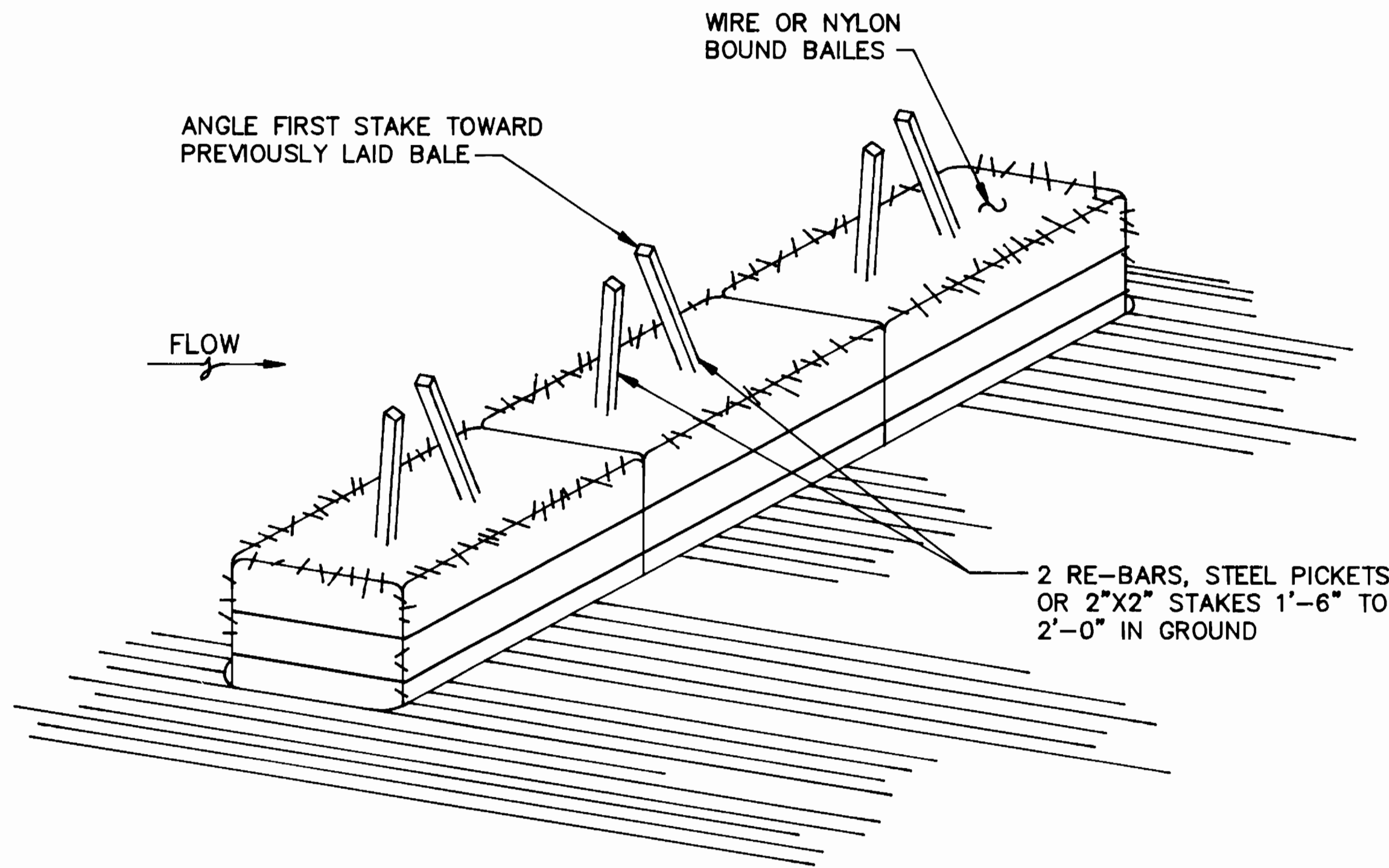

ANCHORING DETAIL

TRAVERSE DESCRIPTION				
POINT NO.	NORTH	EAST	BEARING	DISTANCE
2440008	495711.3310	837912.7130		
			N34° 12' 17"E	2602.25'
2540001	497863.4778	839375.5747		
			S48° 26' 22"W	676.76'
100	497414.5090	838869.1862		
			S82° 55' 21"W	864.53'
101	497307.9876	838011.2465		
			N80° 08' 00"W	725.19'
102	497432.2535	837296.7784		
			N56° 12' 43"W	1304.41'
103	498157.6648	836212.6891		
			N88° 09' 57"W	544.79'
104	498175.1009	835668.1820		
			S76° 59' 36"W	651.42'
105	498028.4885	835033.4767		
			N15° 05' 31"W	1274.63'
106	499259.1581	834701.6022		
			S08° 58' 19"E	184.32'
107	499077.0978	834730.3459		
			S37° 55' 02"W	180.69'
108	498934.5518	834619.3082		
			S80° 15' 42"E	159.13'
109	498907.6348	834776.1453		
			S14° 52' 24"E	924.72'
110	498013.9020	835013.5036		
			N78° 38' 23"E	789.10'
111	498169.3349	835787.1404		
			S73° 32' 24"E	739.21'
112	497959.8808	836496.0573		
			S56° 04' 24"E	1140.12'
113	497323.5432	837442.0717		
			S87° 40' 22"E	671.67'
114	497296.2678	838113.1872		
			N81° 16' 43"E	870.48'
115	497428.2574	838973.5971		
			N42° 43' 16"E	592.53'
2540001	497863.5710	839375.5880		

CONSTRUCTION SPECIFICATIONS

- BALES SHALL BE PLACED IN A ROW WITH ENDS TIGHTLY ABUTTING THE ADJACENT BALES.
- EACH BALE SHALL BE EMBEDDED IN THE SOIL A MINIMUM OF 4".
- BALES SHALL BE SECURELY ANCHORED IN PLACE BY STAKES OR RE-BARS DRIVEN THRU THE BALES. THE FIRST STAKE IN EACH BALE SHALL BE ANGLED TOWARD PREVIOUSLY LAID BALE TO FORCE BALES TOGETHER.
- INSPECTION SHALL BE FREQUENT AND REPAIR OR REPLACEMENT SHALL BE MADE PROMPTLY AS NEEDED.
- BALES SHALL BE REMOVED WHEN THEY HAVE SERVED THEIR USEFULNESS SO AS NOT TO BLOCK OR IMPEDE STORM FLOW OR DRAINAGE.

STANDARD SYMBOL - \_\_\_\_\_ S.B.D. \_\_\_\_\_

STRAW BALE DIKE DETAIL

NOT TO SCALE

SOIL EROSION AND SEDIMENT CONTROL NOTES:

- THE CONTRACTOR WILL COMPLY WITH ALL REQUIREMENTS OF SEDIMENT AND EROSION CONTROL SET FORTH IN THE CONTRACT DRAWINGS, 1983 "MARYLAND STANDARDS SPECIFICATIONS FOR SOIL EROSION AND SEDIMENT CONTROL", AND VOLUME IV-SECTION 219 OF THE HOWARD COUNTY DESIGN MANUAL, VOLUME IV.
- THE CONTRACTOR SHALL NOT PUMP FROM EXCAVATED AREAS DIRECTLY INTO THE HOWARD COUNTY STORM DRAINAGE SYSTEM OR ANY NATURAL WATER COURSE. WHERE GROUND WATER IS ENCOUNTERED DURING CONSTRUCTION, THE CONTRACTOR SHALL PROVIDE PORTABLE OR EXCAVATED SEDIMENT TRAPS TO PREVENT SILTED TRENCH WATER FROM ENTERING STORM DRAINAGE SYSTEMS OR NATURAL WATERWAYS.
- ALL EXCAVATED MATERIAL SHALL BE PLACED ON THE HIGH SIDE OF THE TRENCH WHENEVER POSSIBLE, AND CONFINED TO AN AREA WHERE IT WILL NOT OBSTRUCT THE NORMAL FLOW OR DRAINAGE COURSES.
- ALL SWALES SHALL BE EQUIPPED WITH A SEDIMENT RETENTION DEVICE TO TRAP SEDIMENT AND FILTER WATER LEAVING THE RIGHT-OF-WAY PRIOR TO ENTERING ANY RUNNING STREAM.
- THE CONTRACTOR SHALL PROVIDE STRAW BALE DIKES NORMAL TO SURFACE WATER FLOW AROUND ALL VEHICLE AND EQUIPMENT STAGING AREAS AS SHOWN IN "DETAIL OF A STRAW BALE DIKE" ENCLOSED IN SPECIFICATIONS.
- ROAD SIDE DITCHES AND DRAINAGE PIPES SHALL BE RESTORED TO A CONDITION FOLLOWING COMPLETION OF CONSTRUCTION.
- THE CONTRACTOR SHALL DISPOSE OF SPOILS IN ACCORDANCE WITH GOOD SOIL CONSERVATION PRACTICE AND IN SUCH A MANNER THAT NONE CAN BE CARRIED INTO ANY DRAINAGE FACILITY OR WATER COURSE. THE CONTRACTOR SHALL BE RESPONSIBLE FOR DISPOSING OF ALL SPOIL OR EXCESS EXCAVATED MATERIAL ON A SITE APPROVED BY THE SOIL CONSERVATION DISTRICT. DOCUMENTATION OF APPROVAL AND SITE SHALL BE PROVIDED TO THE ENGINEER PRIOR TO BEGINNING WORK.
- THE HOWARD COUNTY SOIL CONSERVATION DISTRICT MUST BE NOTIFIED IN WRITING BY THE CONTRACTOR AS TO WHERE EXCESS MATERIAL WILL BE DISPOSED FROM THE PROJECT, COPIES SHALL BE PROVIDED TO THE ENGINEER.
- CONTINUOUS INSPECTION AND MAINTENANCE OF ALL SEDIMENT AND EROSION CONTROL DEVICES WILL BE REQUIRED.
- THE CONTRACTOR SHALL PROVIDE ADDITIONAL SOIL EROSION AND SEDIMENT CONTROL AS REQUIRED BY THE SEDIMENT CONTROL INSPECTOR, AS THE WORK PROGRESSES OR REQUIRES.
- THE CONTRACTOR SHALL NOTIFY IN WRITING, A HOWARD COUNTY SEDIMENT CONTROL DIVISION REPRESENTATIVE AT LEAST THREE (3) DAYS PRIOR TO STARTING WORK. PLEASE CONTACT: HOWARD COUNTY 992-2436. COPIES SHALL BE PROVIDED TO THE ENGINEER.
- THE CONTRACTOR SHALL PLACE A STABILIZED CONSTRUCTION ENTRANCE AS SHOWN IN THE HOWARD COUNTY STANDARD DETAILS, G6.11 WHERE SHOWN ON THE PLANS UNLESS OTHERWISE DIRECTED BY THE ENGINEER.
- SEDIMENT REMOVAL - ALL TRAPPED SEDIMENT IS TO BE REMOVED AND DISPOSED OF AT THE AUTHORIZED LANDFILLS PRIOR TO REMOVAL OF SEDIMENT CONTROL STRUCTURES.
- FOLLOWING INITIAL SOIL DISTURBANCE, OR REDISTURBANCE, PERMANENT OR TEMPORARY STABILIZATION SHALL BE COMPLETED WITHIN:
  - SEVEN (7) CALENDAR DAYS FOR ALL PERIMETER SEDIMENT CONTROL STRUCTURES, DIKES, SWALES, DITCHES, PERIMETER SLOPES AND ALL SLOPES GREATER THAN 3:1.
  - FOURTEEN (14) DAYS AS TO ALL OTHER DISTURBED OR GRADED AREAS ON THE PROJECT SITE.

<p>ENGINEER'S CERTIFICATION</p> <p>I CERTIFY THAT THIS PLAN FOR EROSION AND SEDIMENT CONTROL REPRESENTS A PRACTICAL AND WORKABLE PLAN BASED ON MY PERSONAL KNOWLEDGE OF THE SITE CONDITIONS AND THAT IT WAS PREPARED IN ACCORDANCE WITH THE HOWARD COUNTY SOIL CONSERVATION DISTRICT.</p> <p>WALLACE, MONTGOMERY &amp; ASSOCIATES 1544 YORK ROAD LUTHERVILLE, MARYLAND 21093 (301) 494-9093</p> <p>APPROVED: _____ DATE: 4/28/89</p>	<p>REVIEWED FOR HOWARD COUNTY S.C.D. MEETS TECHNICAL REQUIREMENTS.</p> <p>U.S. SOIL CONSERVATION SERVICE DATE: _____</p> <p>THIS DEVELOPMENT PLAN IS APPROVED FOR THE SOIL EROSION AND SEDIMENT CONTROL BY THE HOWARD COUNTY CONSERVATION DISTRICT.</p> <p>APPROVED: _____ DATE: _____</p> <p>HOWARD COUNTY S.C.D.</p>
--	--

<p>DEPARTMENT OF PUBLIC WORKS HOWARD COUNTY, MARYLAND</p> <p>James M. Lane 9-20-89 DIRECTOR OF PUBLIC WORKS DATE</p> <p>Robert R. Berman 9-21-89 CHIEF, BUREAU OF UTILITIES DATE</p>	<p>WALLACE, MONTGOMERY &amp; ASSOCIATES 1544 YORK ROAD LUTHERVILLE, MARYLAND 21093 (301) 494-9093</p> <p>9-12-89 CHIEF, BUREAU OF ENGINEERING DATE</p> <p>9-12-89 CHIEF, UTILITY DIVISION DATE</p>	<p>DES: J.C.W.</p> <p>DRN: S.W.S.</p> <p>CHK: J.C.W.</p> <p>DATE: 4/28/89</p>	<p>BY: _____ NO. _____</p> <p>REVISION _____</p> <p>DATE _____</p>	<p>DETAILS OF ROUTINE WATER EXTENSION</p> <p>600' SCALE MAP NO. _____ BLOCK NO. _____</p>	<p>JERRY'S DRIVE ROUTINE WATER EXTENSION CAPITAL PROJECT W 8689 CONTRACT NO. 44-1941 ELECTION DISTRICT NO. 5 HOWARD COUNTY, MARYLAND</p>	<p>SCALE AS SHOWN</p> <p>SHEET 2 OF 2</p>
--	--	---	--	---	--	---