

**WATER AND SEWER CODE**  
 WATER NO. 602  
 SEWER NO. 5750638

**VICINITY MAP**  
 SCALE: 1" = 600'

GENERAL NOTES

- APPROXIMATE LOCATION OF EXISTING MAINS ARE SHOWN. THE CONTRACTOR SHALL TAKE ALL NECESSARY PRECAUTIONS TO PROTECT EXISTING MAINS AND SERVICES AND MAINTAIN UNINTERRUPTED SUPPLY. ANY DAMAGE INCURRED SHALL BE REPAIRED IMMEDIATELY TO THE SATISFACTION OF THE ENGINEER AT THE CONTRACTOR'S EXPENSE.
- ALL HORIZONTAL CONTROLS ARE BASED ON MARYLAND STATE COORDINATES.
- ALL VERTICAL CONTROLS ARE BASED ON U.S.G.S. DATA.
- ALL PIPE ELEVATIONS SHOWN ARE INVERT (I) ELEVATIONS.
- CLEAR ALL UTILITIES BY A MINIMUM OF 6". CLEAR ALL POLES BY 2'-0" MINIMUM OR TIMPF AS REQUIRED. THE OWNER HAS CONTACTED THE UTILITY COMPANY AND HAS MADE ARRANGEMENTS FOR BRACING OF POLES AS SHOWN ON THE DRAWINGS. IN THE EVENT THE CONTRACTOR'S WORK REQUIRES ADDITIONAL BRACING OF POLES, ANY COST INCURRED BY THE OWNER FOR THE BRACING OF ADDITIONAL POLES OR DAMAGES SHALL BE DEDUCTED FROM MONEY OWED TO THE CONTRACTOR. THE CONTRACTOR SHALL COORDINATE WITH THE UTILITY COMPANY TO SCHEDULE THE BRACING OF THE POLES.
- FOR DETAILS NOT SHOWN ON THE DRAWINGS, AND FOR MATERIALS AND CONSTRUCTION METHODS, USE HOWARD COUNTY DESIGN MANUAL VOLUME IV, STANDARD SPECIFICATIONS AND DETAILS FOR CONSTRUCTION. THE CONTRACTOR SHALL HAVE A COPY OF VOLUME IV ON THE JOB.
- WHERE TEST PITS HAVE BEEN MADE ON EXISTING UTILITIES, THEY ARE NOTED BY THE SYMBOL (S) AT THE LOCATION OF THE TEST PIT. A NOTE OR NOTES CONTAINING THE RESULTS OF THE TEST PIT OR PITS IS INCLUDED ON THE DRAWINGS. EXISTING UTILITIES IN THE VICINITY OF THE PROPOSED WORK FOR WHICH TEST PITS HAVE BEEN DUG SHALL BE LOCATED BY THE CONTRACTOR TWO WEEKS IN ADVANCE OF CONSTRUCTION OPERATIONS AT THE CONTRACTOR'S EXPENSE.
- CONTRACTOR SHALL NOTIFY THE FOLLOWING UTILITIES OR AGENCIES AT LEAST FIVE WORKING DAYS BEFORE STARTING WORK SHOWN ON THESE PLANS:
  - STATE HIGHWAY ADMINISTRATION..... 1-800-257-7777
  - BALTIMORE GAS & ELECTRIC CO. CONTRACTOR SERVICES..... 531-5533
  - BALTIMORE GAS & ELECTRIC CO. UNDERGROUND DAMAGE CONTROL..... 850-4620
  - BALTIMORE GAS & ELECTRIC CO. TROUBLE SHOOTING..... 859-9004
  - MISS UTILITY..... 298-9001
  - COLONIAL PIPELINE CO..... 1-559-0100
  - BUREAU OF UTILITIES, HOWARD COUNTY DEPARTMENT OF PUBLIC WORKS..... 795-1390
- TREES ARE TO BE PROTECTED FROM DAMAGE TO MAXIMUM EXTENT. TREES LOCATED WITHIN THE CONSTRUCTION STRIP ARE NOT TO BE REMOVED OR DAMAGED BY THE CONTRACTOR.
- CONTRACTOR SHALL REMOVE TREES, STUMPS AND ROOTS ALONG LINE OF EXCAVATION AS DIRECTED BY THE ENGINEER. PAYMENT FOR SUCH REMOVAL SHALL BE INCLUDED IN THE UNIT PRICE BID FOR EXCAVATION AND BACKFILL.
- PLACE REGULATION "MEN WORKING" AND WARNING SIGNS AS REQUIRED TO COMPLY WITH MARYLAND STATE HIGHWAY ADMINISTRATION MANUAL OF TRAFFIC CONTROL FOR HIGHWAY MAINTENANCE OPERATIONS.
- ALL WATER MAINS TO BE D.I.P. UNLESS OTHERWISE NOTED.
- TOP OF ALL WATER MAINS TO HAVE A MINIMUM OF 3'-6" COVER UNLESS OTHERWISE NOTED.
- VALVES ADJACENT TO TEES SHALL BE STRAPPED TO TEES.
- BLOCK ALL FITTINGS WITH CONCRETE.
- BURY LINE ELEVATIONS ON FIRE HYDRANTS SHALL BE SET TO THE ELEVATIONS ON THE DRAWINGS. ALL FIRE HYDRANTS SHALL BE STRAPPED AND BUTTRESSED WITH CONCRETE IN ACCORDANCE WITH STANDARD DETAILS. SOIL AROUND THE FIRE HYDRANT TO BE COMPACTED IN ACCORDANCE WITH SECTIONS 1003 AND 1008 OF THE GENERAL REQUIREMENTS FOR WATER AND SEWER.
- ALL WATER HOUSE CONNECTIONS SHALL BE FOR AN INSIDE METER SETTING.
- THE CONTRACTOR SHALL NOT OPERATE ANY WATER MAIN VALVES ON THE EXISTING SYSTEM.
- ALL D.I.P. FITTINGS SHALL BE IN ACCORDANCE WITH AWWA SPEC. C-153 DUCTILE IRON COMPACT FITTINGS 3'-12" FOR WATER AND OTHER LIQUIDS.
- THE SERVICE CLAMPS ARE TO HAVE STAINLESS STEEL STRAPS.
- ALL SEWER MAINS SHALL BE C.S.P.X., V.C.P.X., P.V.C. OR A.C.P. CLASS 2400 UNLESS OTHERWISE NOTED.
- THE CONTRACTOR SHALL PROVIDE A JOINT IN ALL SEWER MAINS WITHIN 2'-0" OF EXTERIOR MANHOLE WALL.
- ALL MANHOLES SHALL BE 4'-0" INSIDE DIAMETER UNLESS OTHERWISE NOTED.
- MANHOLES SHOWN WITH 12" AND 16" WALLS ARE BRICK MANHOLES ONLY.
- MANHOLES DESIGNATED M.T. IN PLAN AND PROFILE SHALL HAVE WATERTIGHT FRAME AND COVERS, STANDARD DETAIL 65.52 VOLUME IV WHERE WATERTIGHT MANHOLE IS USED. SET TOP OF FRAME 1'-6" ABOVE FINISHED GRADE.
- LOT (S) WITH SYMBOL "C.N.S." INDICATES CELLAR CANNOT BE SERVED.
- ALL WATER HOUSE CONNECTIONS SHALL HAVE A MINIMUM VERTICAL CLEARANCE OF 12" ABOVE ALL SANITARY SEWER CROSSINGS.
- ALL SANITARY SEWER HOUSE CONNECTIONS SHALL HAVE A MINIMUM VERTICAL CLEARANCE OF 12" BELOW ALL WATER MAIN CROSSINGS.
- PROFILE STATIONS SHALL BE ADJUSTED AS NECESSARY TO CONFORM TO PLAN DIMENSIONS.
- NO PIPE SHALL BE LAID UNTIL LINES OF EXCAVATION HAVE BEEN BROUGHT TO SUBGRADE.

QUANTITIES			
ITEM	QUANTITY	AS-BUILT	SUPPLIER
8" SEWER	204 LF	131 LF	BEHAR RD. SUPPLY
4" SUC	914 LF	847 LF	"
V.F. MANHOLE	92 V.F.	94 V.F.	ATLANTIC CONCRETE
6" WATER	393 LF	401 LF	ATP SUPPLIES
8" WATER	860 LF	878 LF	"
6" V (EXCL. F.H.V.)	1	1	"
FIRE HYDRANTS	3	3	"
1" WHC	225 LF	532 LF	"
3/4" WHC	293 LF	312 LF	"

HOWARD SOIL CONSERVATION DISTRICT:  
 REVIEWED FOR HOWARD SOIL CONSERVATION DISTRICT  
 AND MEETS TECHNICAL REQUIREMENTS

*James M. Hahn* 2/3/87  
 S. SOIL CONSERVATION SERVICE DATE

THIS PLAN IS APPROVED FOR SOIL EROSION AND SEDIMENT CONTROL BY THE HOWARD SOIL CONSERVATION DISTRICT.

*Steph L. ...* 1/18  
 HOWARD SOIL CONSERVATION DISTRICT DATE

SEDIMENT CONTROL MEASURES FOR THIS CONTRACT WILL BE IMPLEMENTED IN ACCORDANCE WITH SECTION 219 OF THE HOWARD COUNTY STANDARD SPECIFICATIONS AND AS PER ROAD CONSTRUCTION PLANS #F-B9-67

**DEPARTMENT OF PUBLIC WORKS**  
 HOWARD COUNTY, MARYLAND

DIRECTOR OF PUBLIC WORKS DATE: 2-9-89  
 CHIEF, BUREAU OF UTILITIES DATE: 2/11/89

CHIEF, BUREAU OF ENGINEERING DATE: 2/14/89  
 CHIEF, LAND DEVELOPMENT DIVISION DATE: 2/11/89

**TRACY, SCHULTE & ASSOCIATES INC.**  
 planning architecture engineering  
 8480 Baltimore National Pike Suite 418  
 Ellicott City, Maryland 21043

*James M. Hahn*

DES. DAM/JH			
DRN. JH			
CHK. DAM	EJS	CHANGED EASEMENT ON LOT NO. 418	8/4/89
DATE	10-6-88	CHANGED LOT NUMBERS	5/25/89
	1-13-89	BY NO.	

**PLAN OF WATER AND SEWER MAINS**

600' SCALE MAP NO. 30 BLOCK NO. 6

**LONG GATE SECTION 3, AREA 2**  
 ELECTION DISTRICT NO. 2  
**CONTRACT NO. 24-1894-D**

SCALE AS SHOWN  
 SHEET 1 OF 2

AS-BUILT 2/5/92

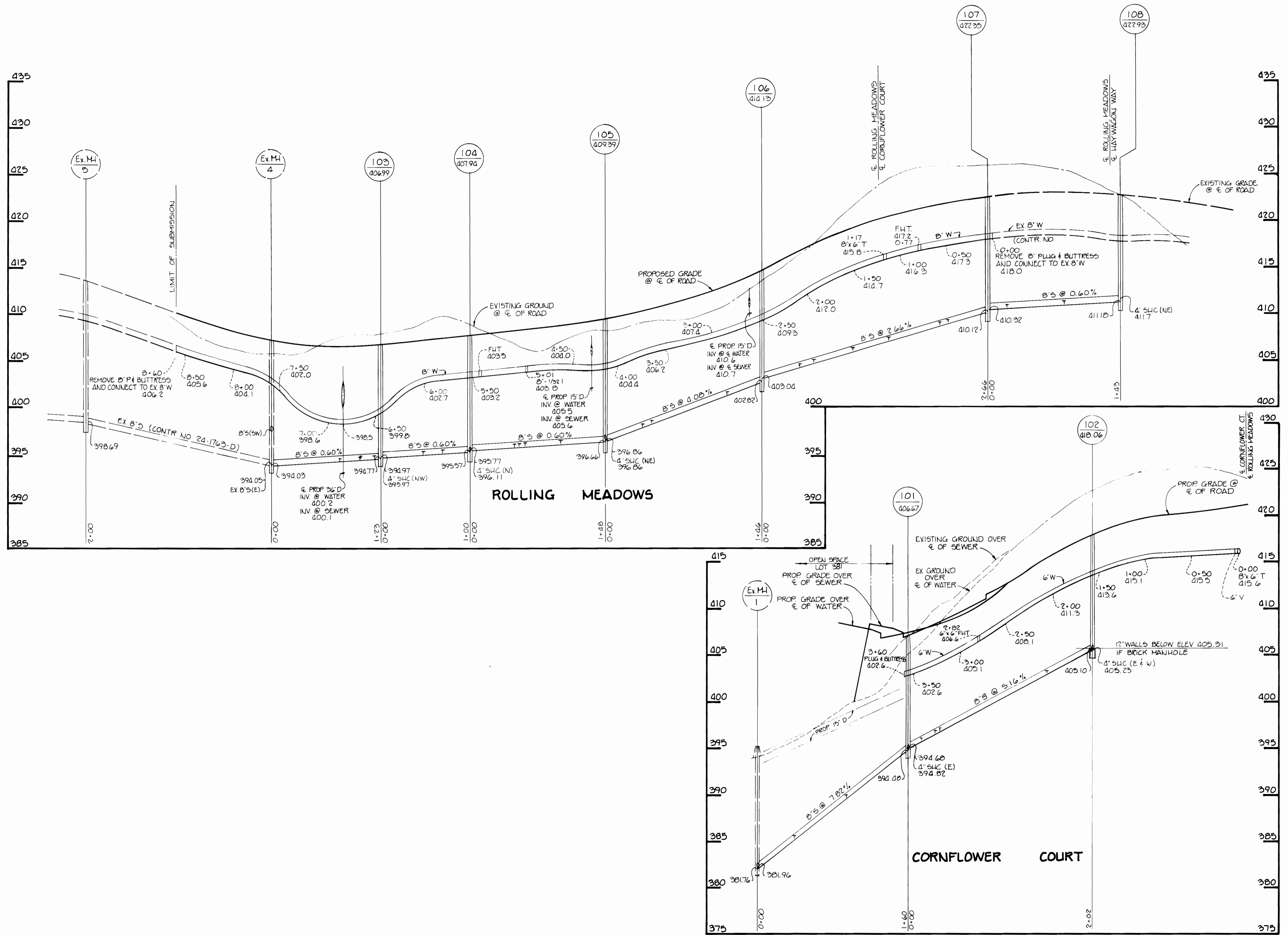

DEPARTMENT OF PUBLIC WORKS  
HOWARD COUNTY, MARYLAND

TRACY, SCHULTE &  
ASSOCIATES INC.

planning architecture engineering  
8480 Baltimore National Pike Suite 418  
Ellicott City, Maryland 21043

DES. DAM/JH					
DRN. JH					
CHK. DAM					
DATE	10-6-88	BY	EJS	NO.	1-13-89
CHANGE LOT NUMBERS			5/25/89		
REVISIONS			DATE	600' SCALE MAP NO. 30 BLOCK NO. 6	

PROFILES OF  
WATER AND SEWER MAINS

LONG GATE  
SECTION 3, AREA 2  
ELECTION DISTRICT NO. 2  
CONTRACT NO. 24-1094-D

SCALE  
HORIZ: 1"=50'  
VERT: 1"=5'  
SHEET  
2 OF 2

Director of Public Works  
DATE 2-9-89  
Chief, Bureau of Engineering  
DATE 2-14-89  
Chief, Bureau of Utilities  
DATE 2-9-89  
Chief, Land Development Division  
DATE 2-11-89