

BENCH MARK DESCRIPTION

BM #3043001-R
CONCRETE MONUMENT AT 3 IN TRANSMISSION LINES
BACK OF SCHOOL, ELEV 437.915

BM #3043002-R
CONCRETE MONUMENT 0.5' BELOW SURFACE W/ 1/2\"/>

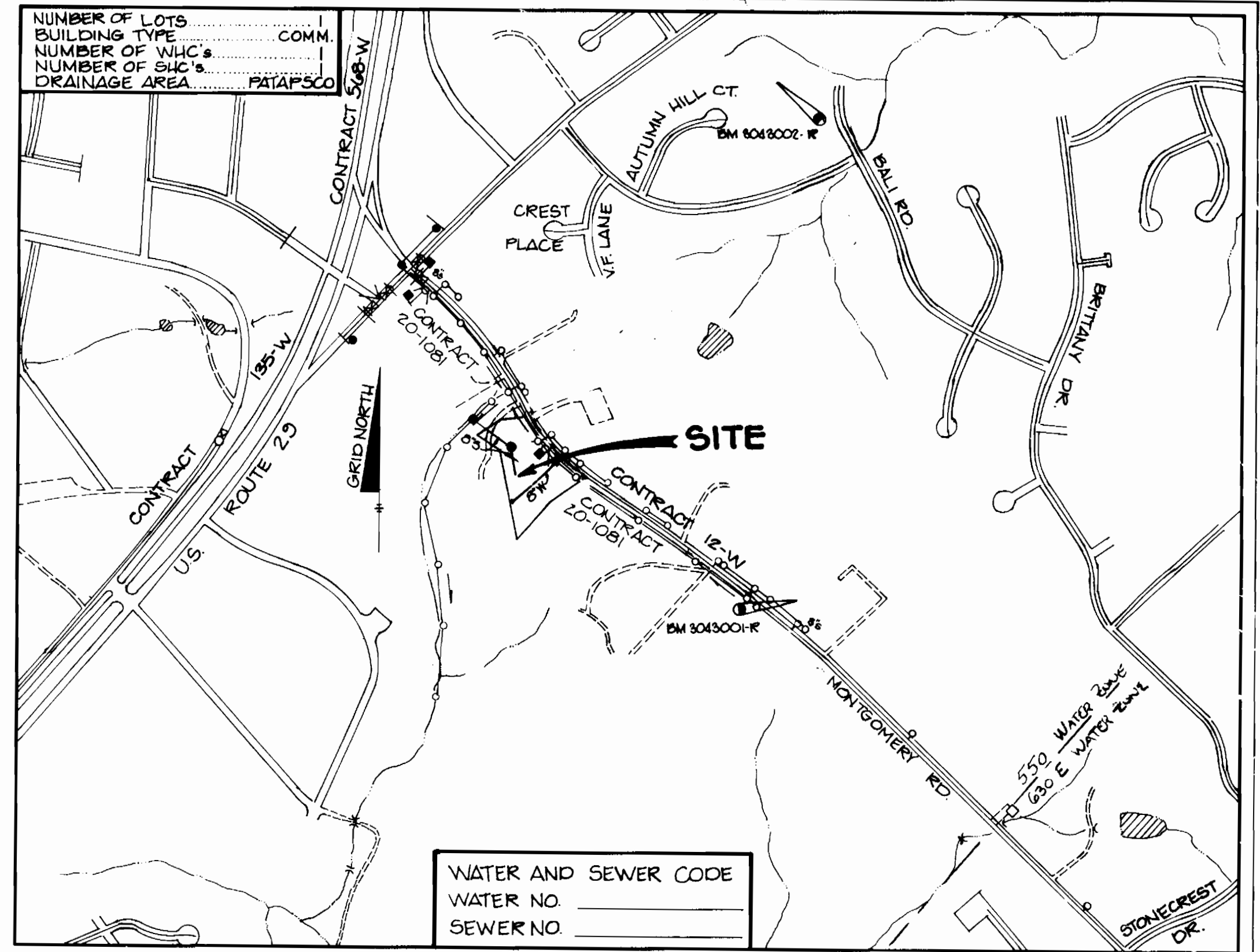

- GENERAL NOTES**
- APPROXIMATE LOCATION OF EXISTING MAINS ARE SHOWN. THE CONTRACTOR SHALL TAKE ALL NECESSARY PRECAUTIONS TO PROTECT EXISTING MAINS AND SERVICES AND MAINTAIN UNINTERRUPTED SUPPLY. ANY DAMAGE INCURRED SHALL BE REPAIRED IMMEDIATELY TO THE SATISFACTION OF THE ENGINEER AT THE CONTRACTOR'S EXPENSE.
 - ALL HORIZONTAL CONTROLS ARE BASED ON MARYLAND STATE COORDINATES.
 - ALL VERTICAL CONTROLS ARE BASED ON U.S.G.C. DATA.
 - ALL PIPE ELEVATIONS SHOWN ARE INVERT (I) ELEVATIONS.
 - CLEAR ALL UTILITIES BY A MINIMUM OF 4'. CLEAR ALL POLES BY 2'-0" MINIMUM OR THINER AS REQUIRED. THE OWNER HAS CONTACTED THE UTILITY COMPANIES AND HAS MADE ARRANGEMENTS FOR BRACING OF POLES AS SHOWN ON THE DRAWINGS. IN THE EVENT THE CONTRACTOR'S WORK REQUIRES THE BRACING OF ADDITIONAL POLES, ANY COST INCURRED BY THE OWNER FOR THE BRACING OF ADDITIONAL POLES OR DAMAGES SHALL BE DEDUCTED FROM MONEY OWED THE CONTRACTOR. THE CONTRACTOR SHALL COORDINATE WITH THE UTILITY COMPANIES TO SCHEDULE THE BRACING OF THE POLES.
 - FOR DETAILS NOT SHOWN ON THE DRAWINGS, AND FOR MATERIALS AND CONSTRUCTION METHODS, USE HOWARD COUNTY DESIGN MANUAL, VOLUME IV, STANDARD SPECIFICATIONS AND DETAILS FOR CONSTRUCTION. THE CONTRACTOR SHALL HAVE A COPY OF VOLUME IV ON THE JOB.
 - WHERE TEST PITS HAVE BEEN MADE ON EXISTING UTILITIES, THEY ARE NOTED BY THE SYMBOL \square AT THE LOCATION OF THE TEST PIT. A NOTE OR NOTES CONTAINING THE RESULTS OF THE TEST PIT OR PITS IS INCLUDED ON THE DRAWINGS. EXISTING UTILITIES IN THE VICINITY OF THE PROPOSED WORK FOR WHICH TEST PITS HAVE NOT BEEN DUG SHALL BE LOCATED BY THE CONTRACTOR TWO WEEKS IN ADVANCE OF CONSTRUCTION OPERATIONS AT HIS OWN EXPENSE.
 - CONTRACTOR SHALL NOTIFY THE FOLLOWING UTILITIES OR AGENCIES AT LEAST FIVE WORKING DAYS BEFORE STARTING WORK SHOWN ON THESE PLANS:
 - CEP - 1-800-257-1277
 - STATE HIGHWAY ADMINISTRATION - 531-5533
 - BALTIMORE GAS & ELECTRIC CO. CONTRACTOR SERVICES - 250-4620
 - BALTIMORE GAS & ELECTRIC CO. UNDER GROUND DAMAGE CONTROL - 859-9114
 - BALTIMORE GAS & ELECTRIC CO. TROUBLE SHOOTING - 788-9901
 - MISS UTILITY - 1-800-911-0100
 - COLONIAL PIPELINE CO. - 795-1390
 - BUREAU OF UTILITIES, HOWARD COUNTY DEPARTMENT OF PUBLIC WORKS - 992-2366
 - TREES ARE TO BE PROTECTED FROM DAMAGE TO MAXIMUM EXTENT. TREES LOCATED WITHIN THE CONSTRUCTION STRIP ARE NOT TO BE REMOVED OR DAMAGED BY THE CONTRACTOR.
 - CONTRACTOR SHALL REMOVE TREES, STUMPS AND ROOTS ALONG LINE OF EXCAVATION AS DIRECTED BY THE ENGINEER. PAYMENT FOR SUCH REMOVAL SHALL BE INCLUDED IN THE UNIT PRICE BID FOR EXCAVATION AND BACKFILL.
 - PLACE REGULATION "MEN WORKING" AND WARNING SIGNS AS REQUIRED TO COMPLY WITH MARYLAND STATE HIGHWAY ADMINISTRATION MANUAL OF TRAFFIC CONTROL FOR HIGHWAY CONSTRUCTION AND MAINTENANCE OPERATIONS.
 - ALL WATER MAINS TO BE 0.1 P. UNLESS OTHERWISE NOTED. (CLASS 52)
 - TOP OF ALL WATER MAINS TO HAVE A MINIMUM OF 3" COVER UNLESS OTHERWISE NOTED.
 - VALVES ADJACENT TO TEES SHALL BE STRAPPED TO TEES.
 - GLUEK ALL FITTINGS WITH CONCRETE.
 - BURY LINE ELEVATIONS ON FIRE HYDRANTS SHALL BE SET TO THE ELEVATIONS SHOWN ON THE DRAWINGS. ALL FIRE HYDRANTS SHALL BE STRAPPED AND BUTTRESSED WITH CONCRETE IN ACCORDANCE WITH STANDARD DETAILS, 5011 AROUND THE FIRE HYDRANT TO BE COMPACTED IN ACCORDANCE WITH SECTIONS 1003 AND 1004 OF THE GENERAL REQUIREMENTS FOR WATER AND SEWER.
 - ALL WATER HOUSE CONNECTIONS SHALL BE FOR AN IN-SIDE METER SETTING.
 - THE CONTRACTOR SHALL NOT OPERATE ANY WATER MAIN VALVES ON THE EXISTING SYSTEM.
 - ALL D.I.P. FITTINGS SHALL BE IN ACCORDANCE W/ AWWA SPEC C-153 DUCTILE IRON COMPACT FITTING 8" TO 12" FOR WATER AND OTHER LIQUIDS.
 - THE SERVICE CLAMPS ARE TO HAVE STAINLESS STEEL STRAPS.
 - ALL SEWER MAINS SHALL BE C.S.P.X., V.C.P.X., P.V.C. OR A.C.P. CLASS 2400 UNLESS OTHERWISE NOTED.
 - THE CONTRACTOR SHALL PROVIDE A JOINT IN ALL SEWER MAINS WITHIN 2'-0" OF EXTERIOR MANHOLE WALL.
 - ALL MANHOLES SHALL BE 4'-0" INSIDE DIAMETER UNLESS OTHERWISE NOTED.
 - BRICK MANHOLES DEEPER THAN 12' SHALL HAVE 12" O.K. 6" WALLS.
 - MANHOLES DESIGNATED M.T. IN PLAN AND PROFILE SHALL HAVE WATERTIGHT FRAME AND COVERS, STANDARD DETAIL 05.52 VOLUME 1. WHERE WATERTIGHT MANHOLE FRAME AND COVER IS USED, SET TOP OF FRAME 1'-6" ABOVE FINISHED GRADE.
 - ALL WATER HOUSE CONNECTIONS SHALL HAVE A MINIMUM VERTICAL CLEARANCE OF 12" ABOVE ALL ARBITRARY SLEWER CROSSINGS.
 - ALL ARBITRARY SEWER HOUSE CONNECTIONS SHALL HAVE A MINIMUM VERTICAL CLEARANCE OF 12" BELOW ALL WATER MAIN CROSSINGS.
 - PROFILE STATIONS SHALL BE ADJUSTED AS NECESSARY TO CONFORM TO PLAN DIMENSIONS.
 - NO PIPE SHALL BE LAID UNTIL LINES OF EXCAVATION HAVE BEEN BROUGHT TO SUBGRADE.

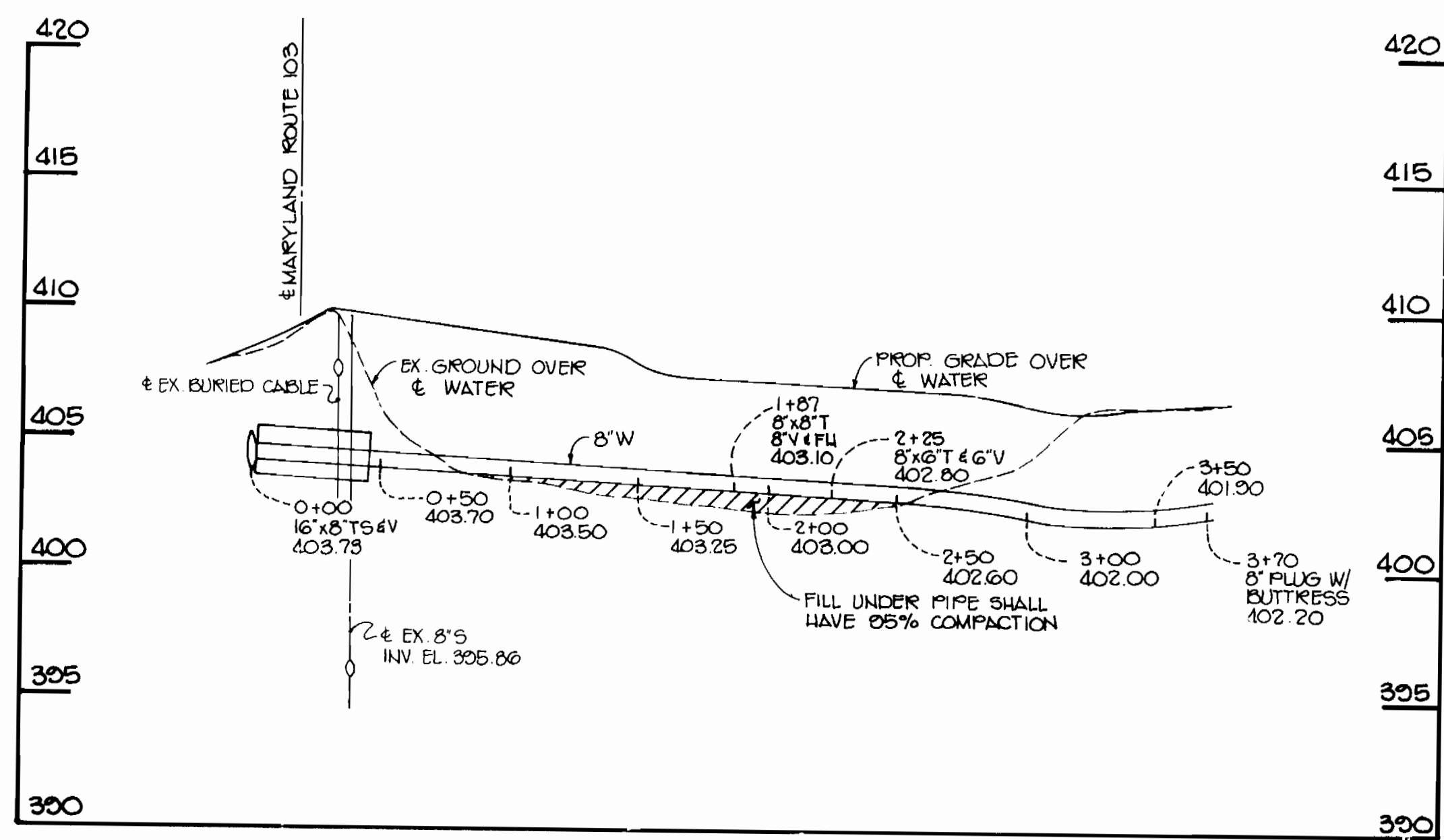

HOWARD COUNTY DEPARTMENT OF PUBLIC WORKS
REVIEWED FOR HOWARD COUNTY DEPARTMENT OF PUBLIC WORKS
AND MEETS TECHNICAL REQUIREMENTS.

James M. Helm 6/28/88
CHIEF ENGINEER

THIS PLAN IS APPROVED FOR THE CONSTRUCTION AND EQUIPMENT CONTROL BY THE HOWARD COUNTY DEPARTMENT OF PUBLIC WORKS.

Stephen J. Smith 6/28/88
CHIEF ENGINEER

DEPARTMENT OF PUBLIC WORKS
HOWARD COUNTY, MARYLAND

SEDIMENT CONTROL MEASURES AND THE CONTRACTOR SHALL BE IMPLEMENTED IN ACCORDANCE WITH THE CONSTRUCTION DISTRICT BOARD COUNTY ORDINANCE NO. 10-1987 AND THE ROAD CONSTRUCTION PLAN S.O.P. - 87-155

6/28/88
DATE

TRACY, SCHULTE & ASSOCIATES INC.
planning architecture engineering
8480 Baltimore National Pike Suite 418
Lillicott City, Maryland 21043

DATE 5-13-88

DATE 5-13-88

WATER MAINS

ITEM	QUANTITY	AS-BUILT	SUPPLIER
8" WATER	370 LF	300 LF	ATLANTIC STATES
6" WATER	15 LF	15 LF	ATLANTIC STATES
FIRE HYDRANTS	1 EA	1 EA	MUELLER
6" W/IC	10 LF	10 LF	ATLANTIC STATES
20" STEEL CASING	40 LF	40 LF	UNION FOUNDRY
6" VALVES	2	2EA	MUELLER
18" DRAPPING SLEEVE	1	1EA	AMERICAN DRAPPING
4" SLEEVE	1	1EA	UNION FOUNDRY
6" CAP	2EA	2EA	UNION FOUNDRY
VALVE BOXES	2EA	2EA	BINGHAM & TAYLOR
6" CAP	1EA	1EA	UNION FOUNDRY

WHEATFIELDS CENTER
PHASE I
ELECTION DISTRICT NO.2
CONTRACT NO. 24-1823-D

SCALE AS SHOWN
SHEET 1 OF 1