

VICINITY MAP  
SCALE: 1" = 600'

WASTEWATER DISPOSAL: Patapsco  
DRAINAGE AREA: Little Patuxent  
NO. OF S.H.C.: 3  
NO. OF W.H.C.: 2

WATER & SEWER CODE  
COUNTY USE  
WATER: F03  
SEWER: 5750500, 5750600

PLAN  
Scale: 1" = 50'

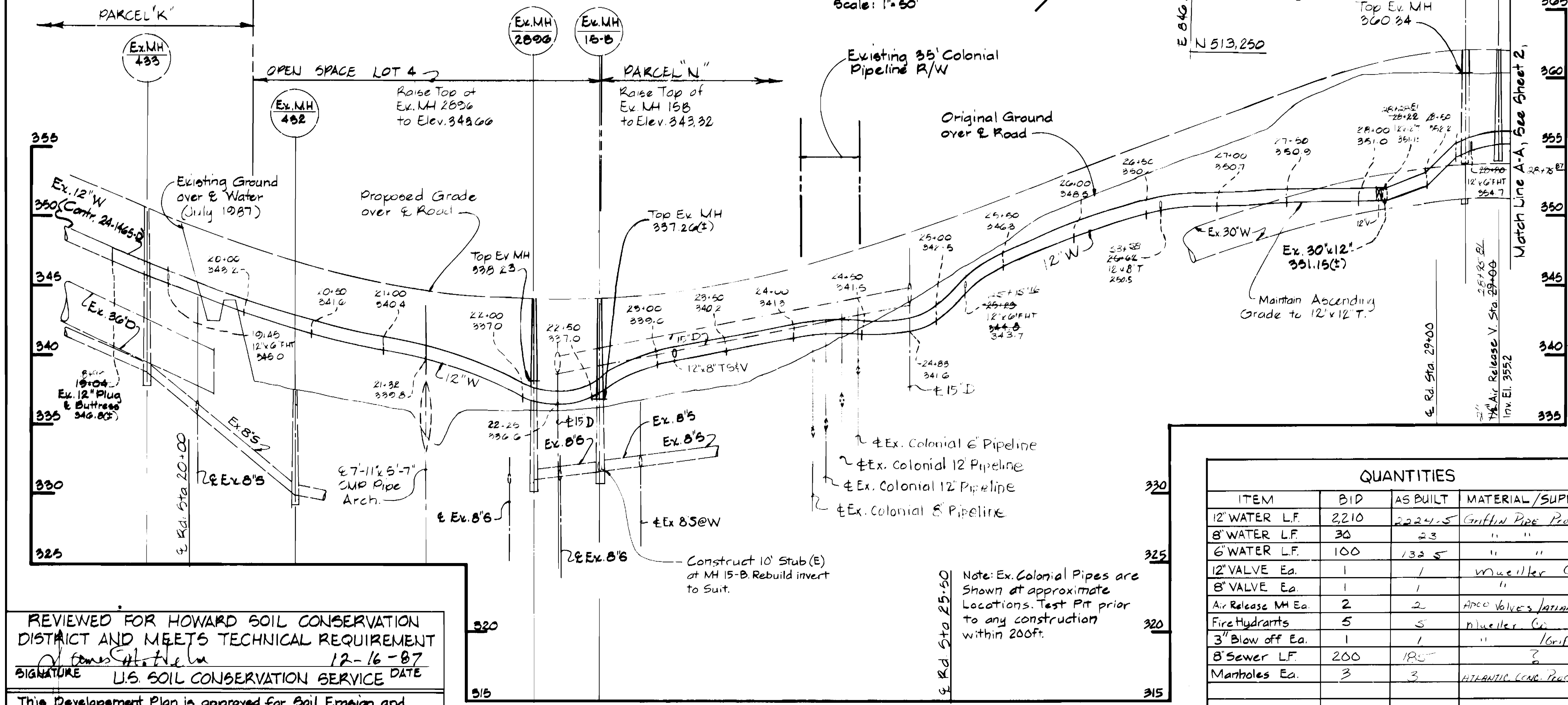

QUANTITIES			
ITEM	BID	AS BUILT	MATERIAL/SUPPLIER
12" WATER LF	2210	2224.5	Griffin Pipe Products
8" WATER LF	30	23	"
6" WATER LF	100	132.5	"
12" VALVE Ea.	1	1	Muesler Co.
8" VALVE Ea.	1	1	"
Air Release MH Ea.	2	2	Arco Valve's International Co.
Fire Hydrants	5	5	Muesler Co.
3" Blow off Ea.	1	1	Griffin Pipe
8" Sewer LF	200	182	"
Manholes Ea.	3	3	Muesler Co. Products

REVIEWED FOR HOWARD SOIL CONSERVATION DISTRICT AND MEETS TECHNICAL REQUIREMENT  
12-16-87  
SIGNATURE: [Signature]  
U.S. SOIL CONSERVATION SERVICE DATE

This Development Plan is approved for Soil Erosion and Sediment Control by the Howard County Conservation District  
APPROVED: [Signature]  
HOWARD S.C.D. DATE: 12-16-87

Sediment Control Measures for this Contract will be implemented in accordance with Section 219 of the Standard Specifications and Road Construction Drawing F. 88-37

PROFILE: Scale: Horizontal 1" = 50'  
Vertical 1" = 5'

DEPARTMENT OF PUBLIC WORKS  
HOWARD COUNTY, MARYLAND  
[Signature]  
DIRECTOR OF PUBLIC WORKS - DATE: 12-18-87  
[Signature]  
CHIEF-BUREAU OF UTILITIES - DATE

WHITMAN, REQUARDT AND ASSOCIATES ENGINEERS  
2315 ST PAUL ST  
BALTIMORE, MARYLAND  
[Signature]  
CHIEF-ENGINEER - DATE: 12-18-87  
[Signature]  
CHIEF-LAND DEVELOPMENT DIVISION - DATE

DES: SJ			
DRN: RM			
CHK: RBN			
DATE:	BY:	NO.:	REVISION:
			Added MH 1001 and Easmt. Noted Parcel N-1 & N-2 Added 8" Plug & Buttr. 12" x 12" V
			9/23/87

VICINITY MAP, GENERAL NOTES, PLAN & PROFILE OF WATER & SEWER MAINS  
600' SCALE MAP NO. 20 BLOCK NO.

DORSEY HALL  
SECTION 2 AREA 5  
ELECTION DISTRICT NO. 2  
CONTRACT NO. 24-1727-D

SCALE AS SHOWN  
SHEET 1 OF 3





