

Note: 8" water to be installed by open trench in St. Johns Lane. Paving to be repaired as per Ho. Co. Std. G4 01.

BENCH MARKS
 B.M. # 3242008 Elev 385.295
 Concrete monument 18" x 6" of south edge of Rt. 40 East (traffic lane) 150' E. of East and of Sutoco Sts. opposite Howard County Medical Center 1.5' below surface.
 N. 525,712.292 E. 846,807.881
 B.M. # 3242002 Elev 400.78
 Concrete monument @ surface 1' N. of edge of macadam shoulder Rt. 40 West 150' E. of St. Johns Lane.
 N. 525,789.095 E. 849,475.765

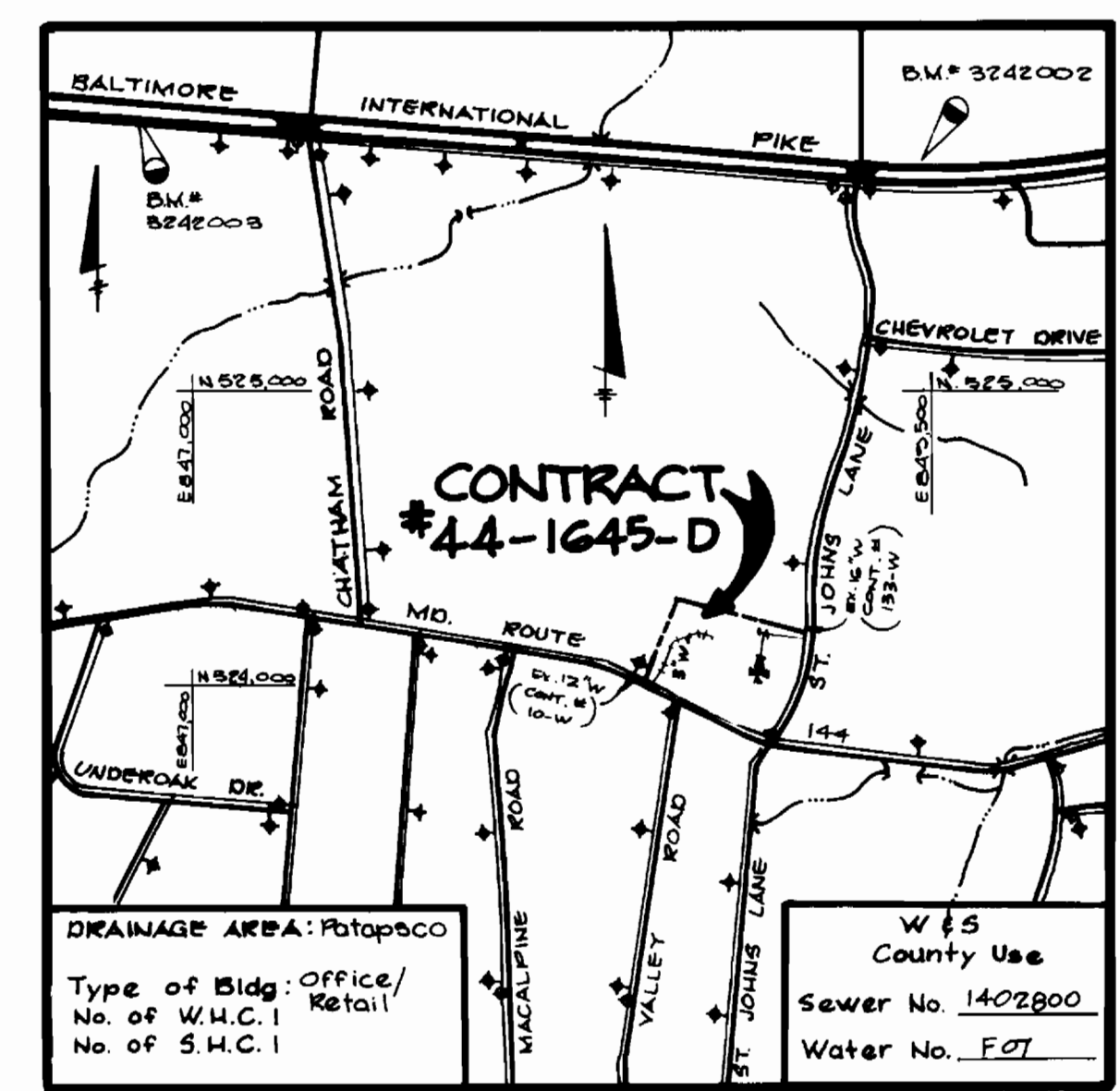

VICINITY MAP
 SCALE: 1" = 600'

GENERAL NOTES

- APPROXIMATE LOCATION OF EXISTING MAINS ARE SHOWN. THE CONTRACTOR SHALL TAKE ALL NECESSARY PRECAUTIONS TO PROTECT EXISTING MAINS AND SERVICES AND MAINTAIN UNINTERRUPTED SUPPLY. ANY DAMAGE INCURRED SHALL BE REPAIRED IMMEDIATELY TO THE SATISFACTION OF THE ENGINEER AT THE CONTRACTOR'S EXPENSE.
- ALL HORIZONTAL CONTROLS ARE BASED ON MARYLAND STATE COORDINATES.
- ALL VERTICAL CONTROLS ARE BASED ON U.S.G.S. DATA.
- ALL PIPE ELEVATIONS SHOWN ARE INVERT ELEVATIONS.
- CLEAR ALL UTILITIES BY A MINIMUM OF 6".
- FOR DETAILS NOT SHOWN ON THE DRAWINGS, AND FOR MATERIALS AND CONSTRUCTION METHODS, USE HOWARD COUNTY DESIGN MANUAL, VOLUME IV, STANDARD SPECIFICATIONS AND DETAILS FOR CONSTRUCTIONS. THE CONTRACTOR SHALL HAVE A COPY OF VOLUME IV ON THE JOB.
- WHERE TEST PITS HAVE BEEN MADE ON EXISTING UTILITIES, THEY ARE NOTED BY THE SYMBOL AT THE LOCATION OF THE TEST PIT. A NOTE OR NOTES CONTAINING THE RESULTS OF THE TEST PIT OR PITS IS INCLUDED ON THE DRAWINGS. EXISTING UTILITIES IN THE VICINITY OF THE PROPOSED WORK FOR WHICH TEST PITS HAVE NOT BEEN DUG SHALL BE VERIFIED BY THE CONTRACTOR TO HIS OWN PERSONAL SATISFACTION. ANY DAMAGE TO EXISTING FACILITIES DUE TO THE CONTRACTOR'S NEGLIGENCE SHALL BE REPAIRED AT THE CONTRACTOR'S EXPENSE.
- THE CONTRACTOR SHALL NOTIFY THE FOLLOWING UTILITIES OR AGENCIES AT LEAST FIVE WORKING DAYS BEFORE STARTING WORK SHOWN ON THESE PLANS:

STATE HIGHWAY ADMINISTRATION	531-5533
BALTIMORE GAS AND ELECTRIC CO. - CONTRACTOR SERVICES	850-4620
BALTIMORE GAS AND ELECTRIC CO. - UNDERGROUND DAMAGE CONTROL	859-9004
BALTIMORE GAS AND ELECTRIC CO. - TROUBLE SHOOTING	298-9004
MISS UTILITY	1-559-0100
COLONIAL PIPELINE CO.	795-1390
BUREAU OF UTILITIES, HO. CO. DEPARTMENT OF PUBLIC WORKS	992-2366
C & P TELEPHONE CO.	1-800-257-7777
- TREES AND SHRUBS ARE TO BE PROTECTED FROM DAMAGE TO MAXIMUM EXTENT. TREES AND SHRUBS LOCATED WITHIN THE CONSTRUCTION STRIP ARE NOT TO BE REMOVED OR DAMAGED BY THE CONTRACTOR.
- THE CONTRACTOR SHALL REMOVE TREES, STUMPS AND ROOTS ALONG LINE OF EXCAVATION. PAYMENT FOR SUCH REMOVAL SHALL BE INCLUDED IN THE UNIT PRICE BID FOR CONSTRUCTION OF THE MAIN.
- ALL WATER MAINS TO BE D.I.P. CLASS 52 UNLESS OTHERWISE NOTED.
- TOPS OF ALL WATER MAINS TO HAVE A MINIMUM OF 3'-1/2' COVER UNLESS OTHERWISE NOTED.
- VALVES ADJACENT TO TEES SHALL BE STRAPPED TO TEES.
- ALL FITTINGS SHALL BE BUTTRESSED OR ANCHORED WITH CONCRETE IN ACCORDANCE WITH THE STANDARD DETAILS UNLESS OTHERWISE PROVIDED FOR ON THE DRAWINGS.
- FIRE HYDRANTS SHALL BE SET TO THE BURY LINE ELEVATION SHOWN ON THE DRAWINGS. ALL FIRE HYDRANTS SHALL BE STRAPPED AND BUTTRESSED WITH CONCRETE IN ACCORDANCE WITH THE STANDARD DETAILS. SOIL AROUND THE FIRE HYDRANT SHALL BE COMPACTED IN ACCORDANCE WITH SECTION 1003 OF THE STANDARD SPECIFICATIONS.
- THE CONTRACTOR SHALL NOT OPERATE ANY WATER MAIN VALVES ON THE EXISTING WATER SYSTEM.
- ALL WATER HOUSE CONNECTIONS SHALL BE FOR INSIDE METER SETTING, UNLESS OTHERWISE NOTED ON THE PLANS OR IN THE SPECIFICATIONS.

PLAN
 SCALE: 1" = 30'

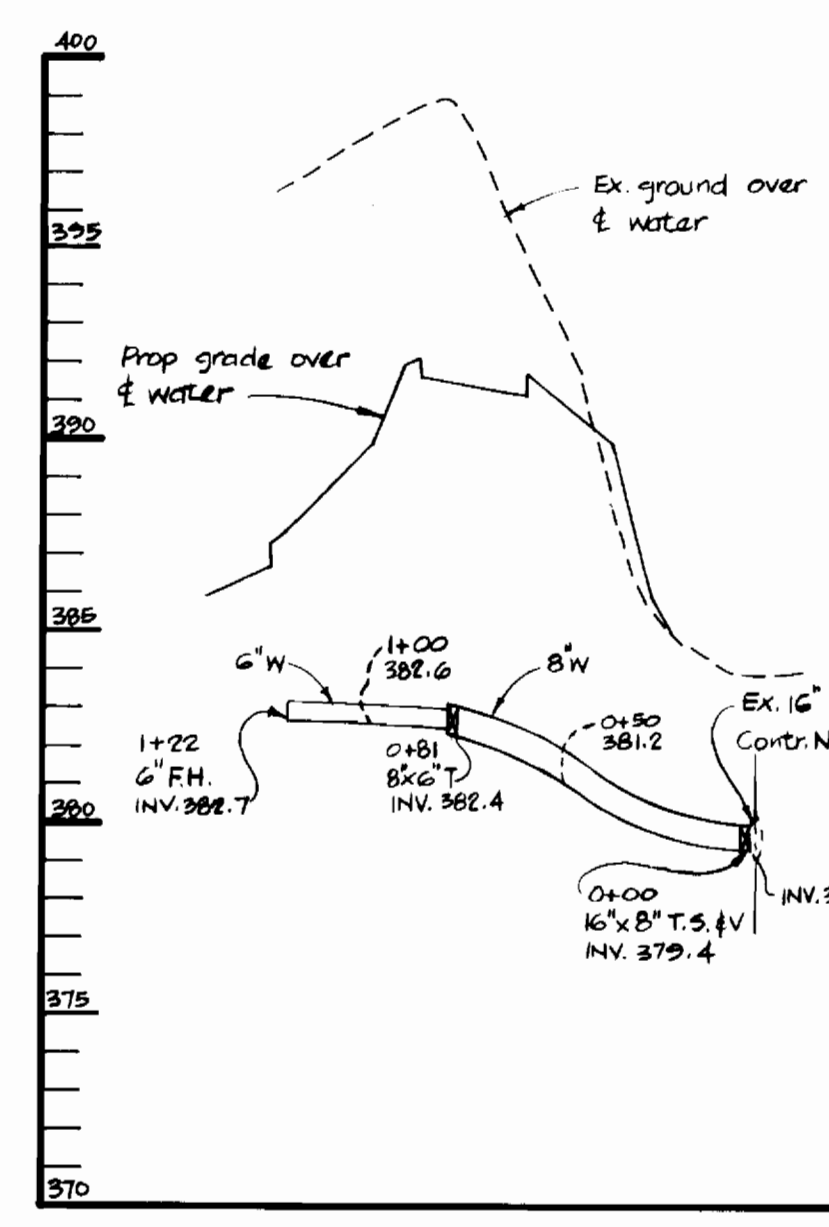

PROFILE
 SCALE: HOR. 1" = 50'
 VERT. 1" = 5'

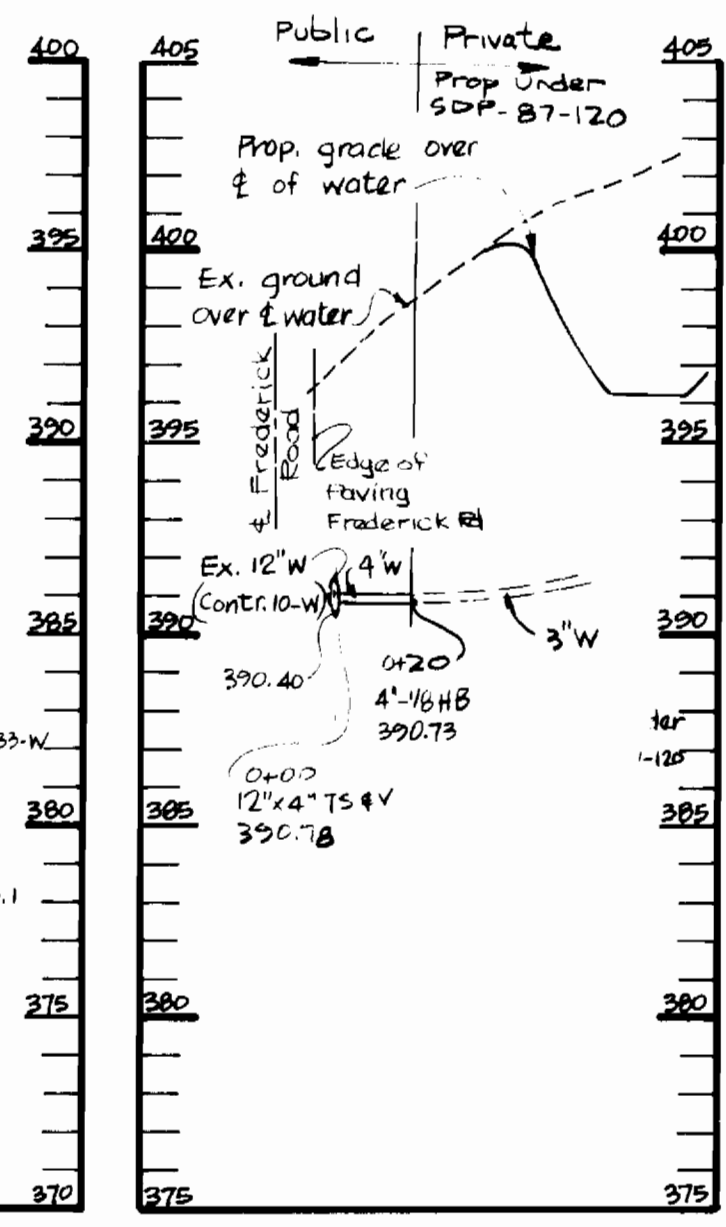

PROFILE
 SCALE: HOR. 1" = 50'
 VERT. 1" = 5'

Item	Quantities		Material Supplier
	Estimated	As Built	
8" W	81 LF		GRIFFIN
6" W	41 LF	41	" "
4" W	20 LF		" "
8" V			AMERICAN DARLING
6" V			" "
12" x 4" TS & V			" "
FH			MUELLER
4" x 3" Reducer			" "
8" x 6" FHT			" "
8" Plug & Butress			MUELLER
16" x 8" TS & V			" "

13. ALL D.I.P. FITTINGS SHALL BE IN ACCORDANCE WITH AWWA SPECIFICATION C-153 DUCTILE IRON COMPACT FITTINGS, 3" THROUGH 12" FOR WATER AND OTHER LIQUIDS.

Sediment control measures for this contract will be implemented in accordance with section 219 of the specifications as shown on (SDP-87-120)

Howard Soil Conservation District:
 Review for Howard Soil Conservation District and meets technical requirements.
 Howard M. Stelm Date 2-16-88
 U.S. Soil Conservation Service
 This plan is approved for soil erosion and sediment control by the Howard Soil Conservation District.
 Stephen A. Hark Date 2/16/88
 Howard Soil Conservation District

DEPARTMENT OF PUBLIC WORKS
 HOWARD COUNTY, MARYLAND

THE RIEMER GROUP INC.
 3105 NORTH RIDGE ROAD
 ELLICOTT CITY, MARYLAND 21043

ARTHUR E. MUEGGE
 PROFESSIONAL ENGINEER

DES: C.J.R.
 DRN: D.B.S.
 CHK: J.K.B.
 DATE: 12-30-87

DATE: 3-9-88
 DATE: 2-14-88

PLAN AND PROFILE
 OF A WATER MAIN

FREDERICK CROSSING
 ELECTION DISTRICT NO. 2
 CONTRACT NO. 44-1645-D

SCALE AS SHOWN
 SHEET 1 OF 1

600' SCALE MAP NO. 24 BLOCK NO.