

PLAN
Scale: 1"=50'

ITEM	QUANTITIES		TYPE MATERIAL	SUPPLIER
	ESTIM.	AS BUILT		
10" Water	250 LF	200 LF	CL52 D.I.P.	A&P Water
6" Water	5 LF	3 LF	" "	" "
2" Air Release Valve & Vault	2 EA.	2 EA.	Mueller	" "
Fire Hydrant, Tee & 6" Valve	1 EA.	1 EA.	" "	" "

G & E Poles to be relocated by others prior to main construction

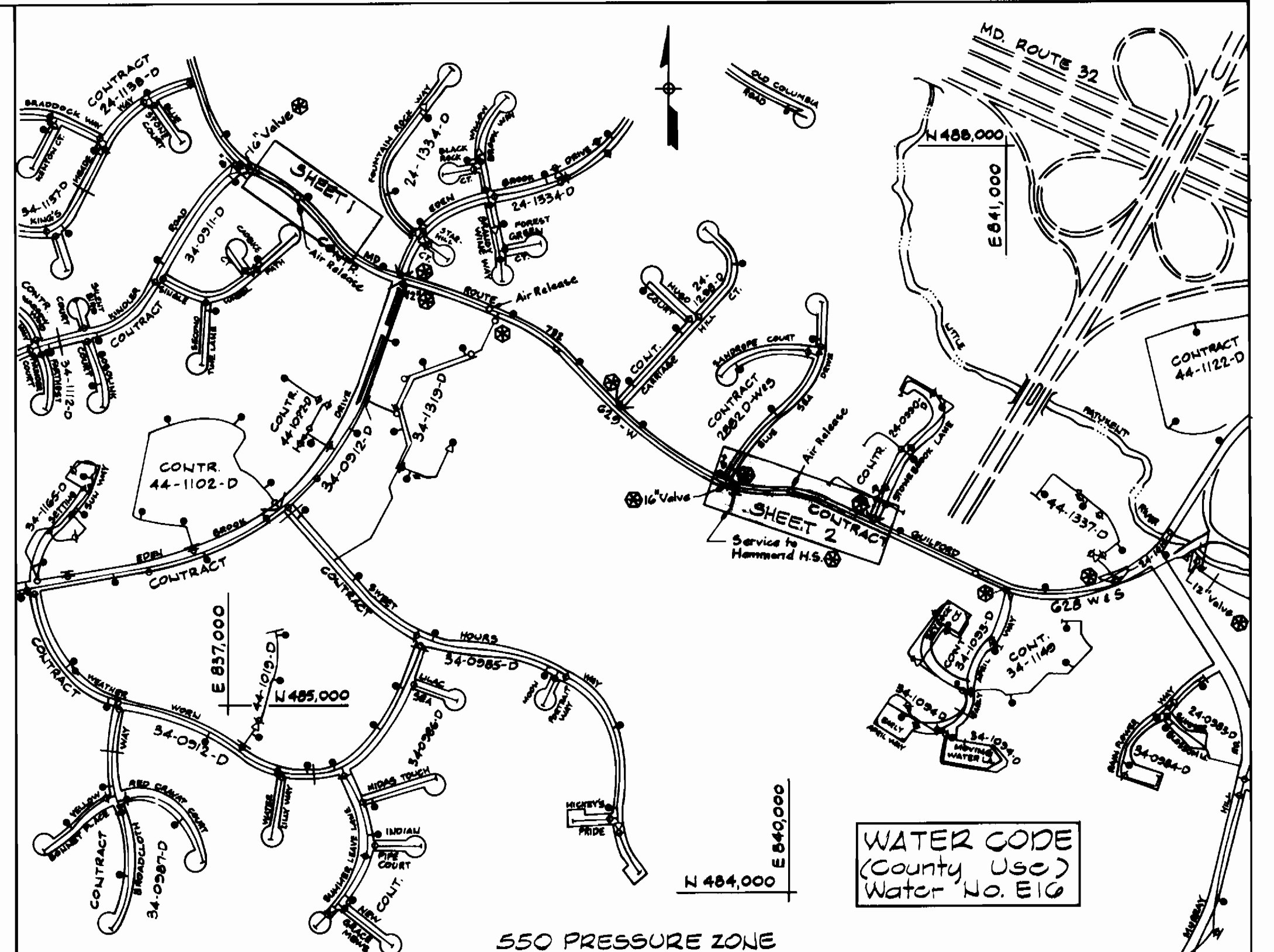

VICINITY MAP
Scale: 1"=600'

Type of Building: None
Number of Parcels: None
Number of Water House Conn.: None
Drainage Area: N/A

Values to be closed during connection of existing 10" Water Main to relocate 10" Water Main.

Notes:

- The existing and finished ground lines shown are based on Cross Sections from SHA Contract HO-642-501-783.
- The locations of existing underground utilities are based on record drawings and are shown in an approximate way only. The contractor shall determine the exact location of all existing utilities before commencing work. He agrees to be fully responsible for any and all damages which might be occasioned by his failure to exactly locate and preserve any and all underground utilities.

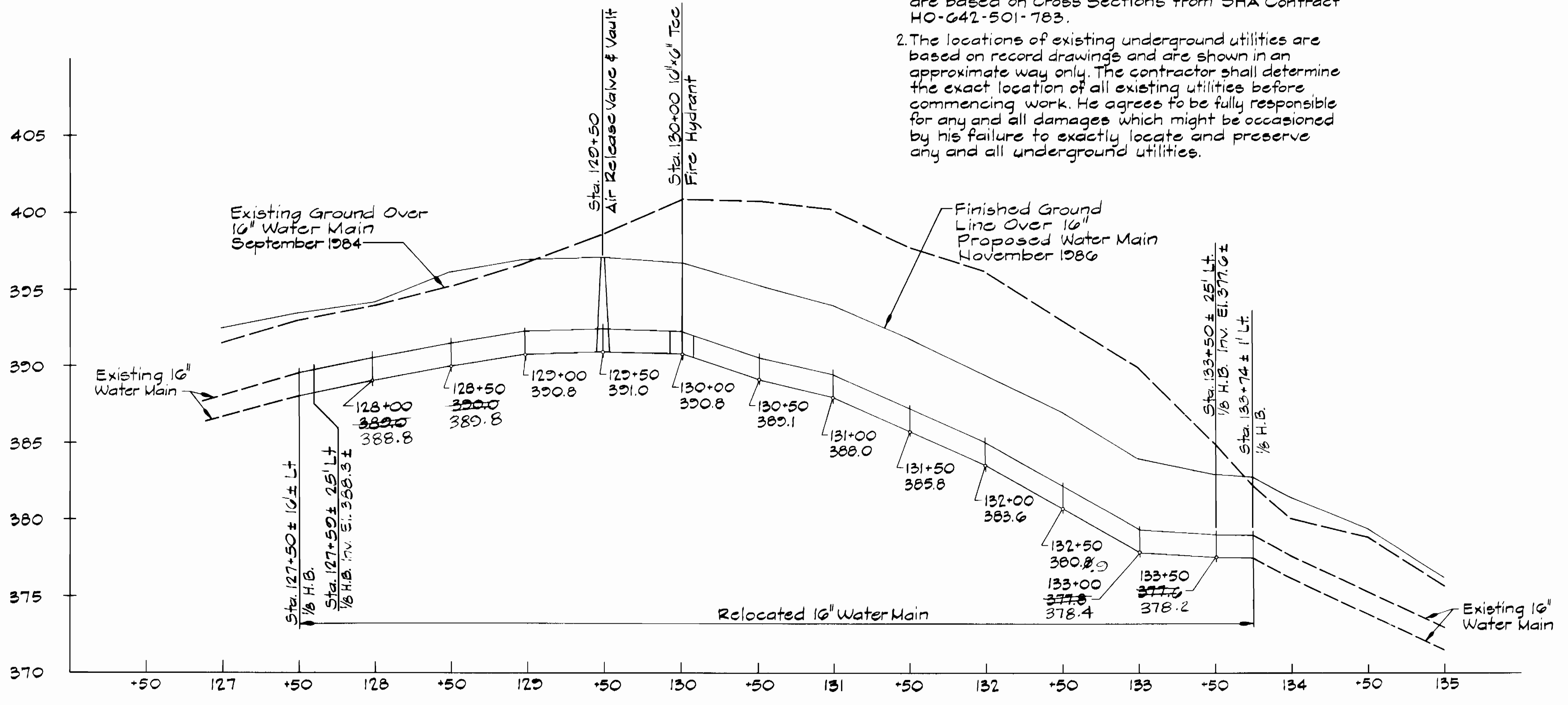

PROFILE
Scale: 1"=50' Horiz. & 1"=5' Vert.

GENERAL NOTES

- Approximate location of existing mains are shown. The contractor shall take all necessary precautions to protect existing mains and services and maintain uninterrupted supply. Any damage incurred shall be repaired immediately to the satisfaction of the Engineer at the Contractor's expense.
- All horizontal controls based on Maryland State Coordinates.
- All vertical controls based on U.S.G.S. data.
- All pipe elevations shown are invert elevations.
- Clear all utilities by a minimum of 6".
- For details not shown on the drawings, and for materials and construction methods, use Howard County Design Manual, Volume IV, Standard Specifications and Details for Construction. The contractor shall have a copy of Volume IV on the job.
- Where test pits are to be made on existing utilities, they are noted by the symbol [] at the location of the test pit. Existing utilities in the vicinity of the proposed work for which test pits have not been dug shall be verified by the Contractor to his own satisfaction. Any damage to existing facilities due to the Contractor's negligence shall be repaired at the Contractor's expense.
- The Contractor shall notify the following utilities or agencies at least five working days before starting work shown on these plans:
Baltimore Gas & Electric Co.-Contractor Service - 850-4620
Baltimore Gas & Electric Co.-Under Ground Damage Control - 850-9004
Baltimore Gas & Electric Co.- Trouble Shooting - 298-9001
Miss Utility - 1-559-0100
Bureau of Utilities, Howard County Department of Public Works - 292-2366
- Trees and shrubs are to be protected from damage to maximum extent. Trees and shrubs located within the construction strip are not to be removed or damaged by the Contractor.
- Contractor shall remove trees, stumps and roots along line of excavation. Payment for such removal shall be included in the unit price bid for construction of the main.
- All water mains to be D.I.P. Class 52 unless otherwise noted.
- Tops of all water mains to have a minimum of 3.5' cover unless otherwise noted.
- Valves adjacent to tees shall be strapped to tees.
- All fittings shall be buttressed or anchored with concrete in accordance with the Standard Details unless otherwise provided for on the drawings.
- Fire hydrants shall be set to the bury line elevations shown on the drawings. All fire hydrants shall be strapped and buttressed with concrete in accordance with Standard Details. Soil around the fire hydrant shall be compacted in accordance with Section 1003 from the Standard Specifications.
- The Contractor shall not operate any water main valves on the existing water system. Call Bureau of Utilities at 292-2366.
- All water house connections shall be for inside meter setting, unless otherwise noted on the plans or in the specifications.

S.H.A. DRAWING NO. 12
S.H.A. CONTRACT HO-642-501-783

DEPARTMENT OF PUBLIC WORKS
HOWARD COUNTY, MARYLAND
James P. ...
12/22/86
12/27/86

WALLACE, MONTGOMERY & ASSOCIATES
8 ASSOCIATES
9 W. 29TH STREET
BALTIMORE, MARYLAND 21218
(301)235-7600
John C. Wallace

DES: J.C.W.
DRN: D.E.D.
CHK: J.C.W.
DATE: 12-5-86

BY	NO.	REVISION	DATE

ROUTE 732 WATER RELOCATIONS
CAPITAL PROJECT W-8156
CONTRACT NO. 44-1578
ELECTION DISTRICT NO. 6
HOWARD COUNTY, MARYLAND

SCALE AS SHOWN
SHEET 1 OF 2

