



Property of  
Oakland Executive Park  
Parcel A-1  
Plat No. 6000

Property of  
Oakland Executive Park  
Parcel A-3  
Plat No. 6000

Property of  
Oakland Executive Park  
Parcel A-4  
Plat No. 6000

CENTRE PARK DRIVE

Property of  
Oakland Executive Park  
Parcel B  
Plat No. 6000

**PLAN**  
SCALE: 1"=50'

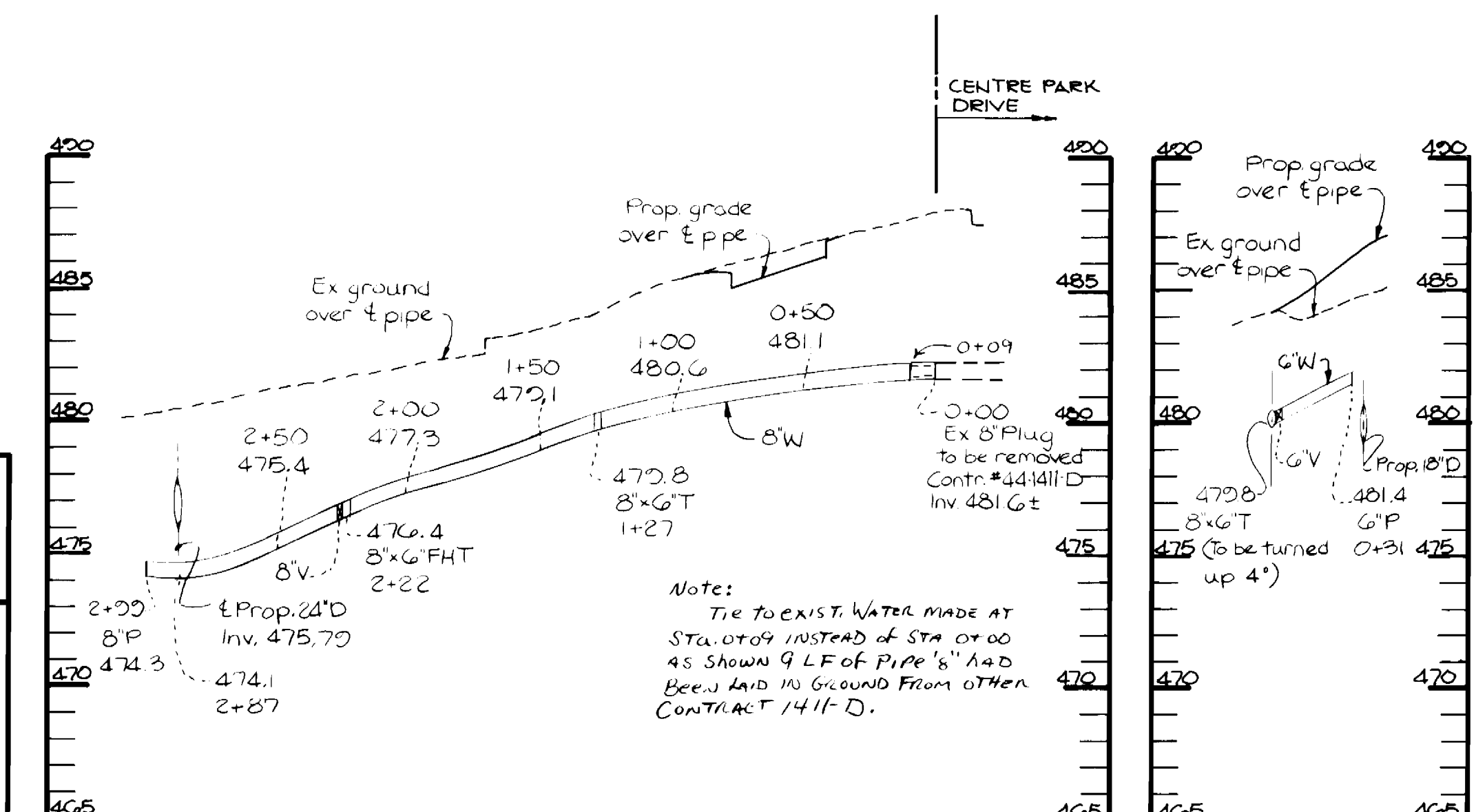

**PROFILE**  
SCALE: HOR: 1"=50'  
VERT: 1"=5'

**PROFILE**  
SCALE: HOR: 1"=50'  
VERT: 1"=5'

**Bench Marks**  
B.M. # Ho Co. 2743010-R Elev. 482.25'  
3/4" Rebar 0.4 Below surface, 34.7' South of curb on Maryland Route 10B, 175' East of E of Phelps Luck Drive  
B.M. # Ho Co. 2743000 Elev. 530.07'  
Concrete Monument at surface 45' East of Northwest Drive of Howard High School on North Side of Maryland Route 10B.

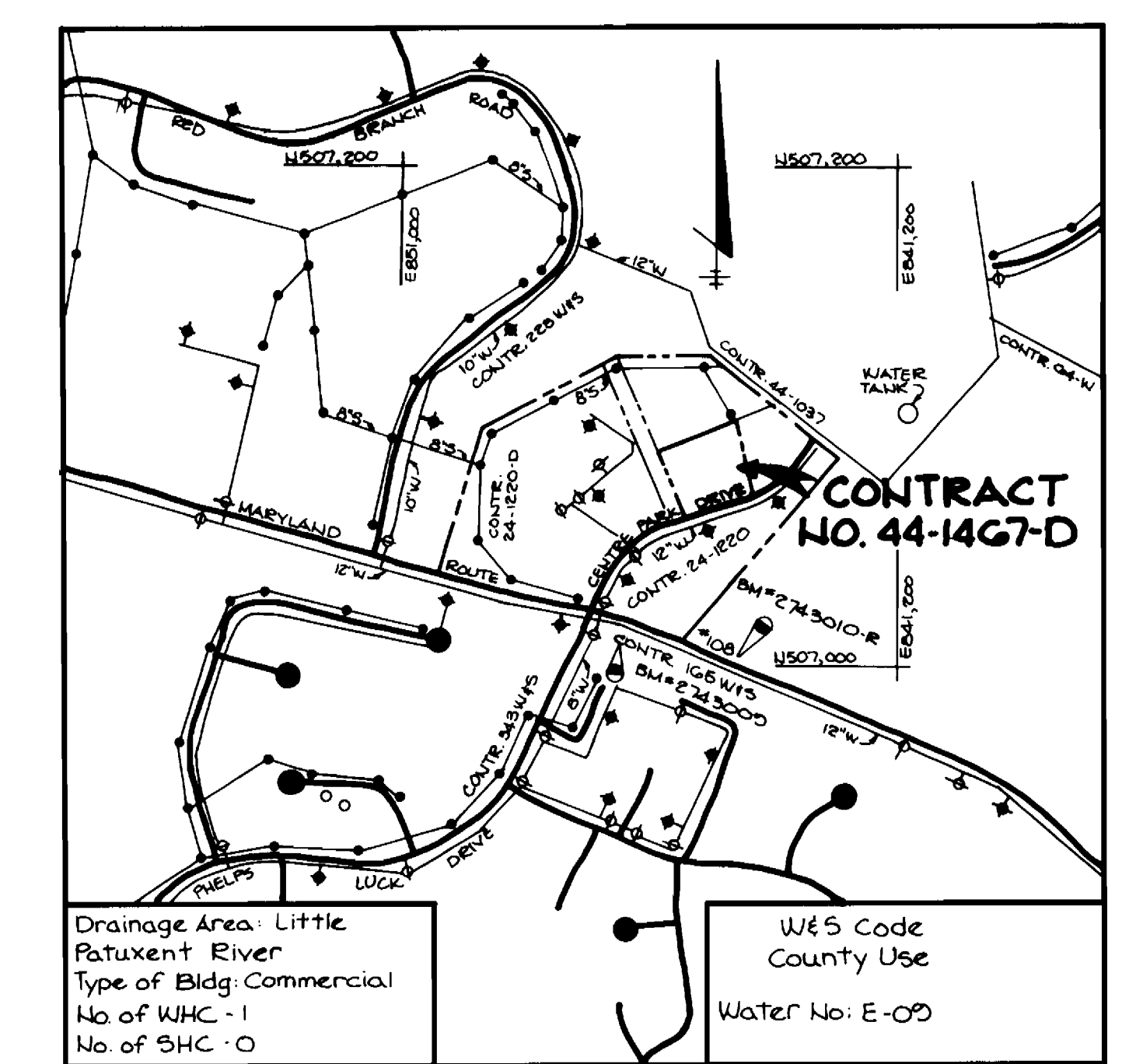

**VICINITY MAP**  
Scale: 1"=600'

**GENERAL NOTES**

1. Approximate location of existing mains are shown. The contractor shall take all necessary precautions to protect existing mains and services and maintain uninterrupted supply. Any damage incurred shall be repaired immediately to the satisfaction of the Engineer at the Contractor's expense.
2. All horizontal controls are based on Maryland State Coordinates.
3. All vertical controls are based on U.S.G.S. data.
4. All pipe elevations shown are invert elevations.
5. Clear all utilities by a minimum of 6'. Clear all poles by 2'-0" minimum or tunnel as required. The owner has contacted the utility companies and has made arrangements for bracing of poles as shown on the drawings. In the event the contractor's work requires the bracing of additional poles, any cost incurred by the owner for the bracing of additional poles or damages shall be deducted from money owed the contractor. The contractor shall coordinate with the utility companies to schedule the bracing of the poles.
6. For details not shown on the drawings, and for materials and construction methods use Howard County Design Manual, Volume IV, Standard Specifications and Details for Construction. The contractor shall have a copy of Volume IV on the job.
7. Where test pits have been made on existing utilities, they are noted by the symbol at the location of the test pit. A note or notes containing the results of the test pit or pits is included on the drawings. Existing utilities in the vicinity of the proposed work for which test pits have not been dug shall be located by the contractor two weeks in advance of construction operations at his own expense.
8. Contractor shall notify the following utilities or agencies at least five working days before starting work shown on these plans:  
State Highway Administration - 531-5533  
Baltimore Gas & Electric Co. - Contractor Services - 561-2585  
Baltimore Gas & Electric Co. Under Ground Damage Control - 234-5621  
Baltimore Gas & Electric Co. Trouble Shooting - 298-2013  
Miss Utility - 1-555-0100  
Colonial Pipeline Co. - 705-1300  
Bureau of Utilities, Howard County Department of Public Works - 292-2366
9. Trees are to be protected from damage to maximum extent. Trees located within the construction strip are not to be removed or damaged by the contractor.
10. Contractor shall remove trees, stumps and roots along line of excavation as directed by the Engineer. Payment for such removal shall be included in the unit price bid for excavation and backfill.
11. Place regulation "Men Working" and warning signs as required to comply with Maryland State Highway Administration Manual of Traffic Control for Highway Construction and Maintenance Operations.
12. All water mains to be D.I.P. unless otherwise noted.
13. Top of all water mains to have a minimum of 3 1/2' cover unless otherwise noted.
14. Valves adjacent to trees shall be strapped to trees.
15. Block all fittings with concrete.
16. Bury line elevations on fire hydrants shall be set to the elevation shown on the drawings. All fire hydrants shall be strapped and buttressed with concrete in accordance with standard details. Soil around the fire hydrant to be compacted in accordance with Section 1003 & 1008 of the General Requirements for Water and Sewer.
17. All water house connections shall be for an inside meter setting.
18. The contractor shall not operate any water main valves on the existing system.
19. For all copper water house connections utilize flared type fittings only.
20. Profile stations shall be adjusted as necessary to conform to Plan dimensions.
21. No pipe shall be laid until lines of excavation have been brought to subgrade.
22. The service clamps are to have stainless steel straps.

Note: Supplier - A & P Water & Sewer, Inc.

ITEM	ESTIMATED	AS BUILT	MATERIAL SUPPLIER
8" Water	290 LF	290.48 LF	ATLANTIC STATES - MFG.
6" Water	42 LF	40 LF	ATLANTIC STATES - MFG.
8" Valves			MUELLER CO. - MFG.
Fire Hydrants			MUELLER CO. - MFG.
6" V (Excl. F.H.)			MUELLER CO. - MFG.
8 1/2" x 8" Tee - 8" x 6" FHTee		1 Tee / 1 FHTee	UNION FOUNDRY - MFG.
6" F.H. VALVE			MUELLER CO. - MFG.
6" Plug & Plug		1 6" x 1-8"	UNION FOUNDRY - MFG.

Sediment Control measures for this contract will be implemented in accordance with article 15 of the specification and as shown on SDP- 86-158

Howard Soil Conservation District:  
Reviewed for Howard Soil Conservation District and meets technical requirements.  
*Stephen M. Stetson* 4-4-86  
Date

U.S. Soil Conservation Service  
This plan is approved for soil erosion and sediment control by the Howard Soil Conservation District.  
*Stephen M. Stetson* 4/4/86  
Date

Howard Soil Conservation District

**DEPARTMENT OF PUBLIC WORKS**  
HOWARD COUNTY, MARYLAND

*William J. ...* 4-14-86  
DIRECTOR OF PUBLIC WORKS DATE

*William J. ...* 4-14-86  
CHIEF BUREAU OF UTILITIES DATE

*William J. ...* 4-14-86  
CHIEF LAND DEVELOPMENT DIVISION DATE

**THE RIEMER GROUP, INC.**  
3105 HEALTH PARK DRIVE  
ELLCOTT CITY, MARYLAND 21043

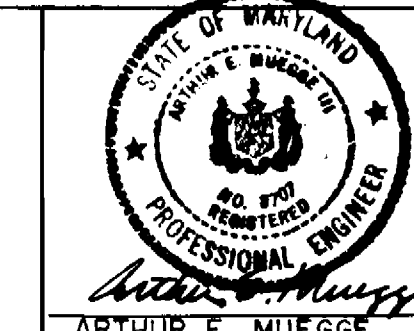

DES: J.K.B.					
DRN: DAN					
CHK:					
DATE: 1/31/86	BY: NO.	REVISION	DATE	600' SCALE MAP NO. 30	BLOCK NO.

**CABINART**  
PARCEL A-2  
OAKLAND EXECUTIVE PARK  
ELECTION DISTRICT NO. 2  
CONTRACT NO. 44-1467-D

SCALE AS SHOWN

SHEET 1 OF 1