

BILL OF MATERIALS	
ITEM	QUANTITY
6" WATER	300 LF
6" WATER	300 LF
6" W. SEV	300 LF
6" W. SEV	300 LF
6" CAP	300 LF

6" WATER WORKS / US CONT D.P. CL. 151
 GATE VALVES 6" METAL RESILIENT SEAL CATO 4148
 P.H. US Pipe & Foundry

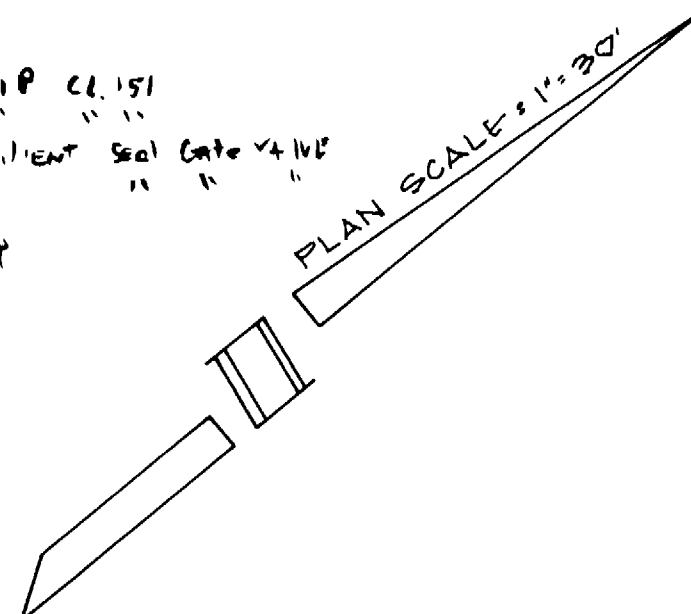

THE EX. UNDERGROUND UTILITIES SHOWN HEREON ARE BASED ON INFORMATION AVAILABLE FROM SURVEYS AND RECORDS. THE CONTRACTOR SHALL BE RESPONSIBLE FOR DETERMINING THE EXACT LOCATION OF ALL UTILITIES BEFORE COMMENCING WORK AND FOR ANY DAMAGES WHICH MIGHT OCCUR BY HIS FAILURE TO LOCATE OR PRESERVE THESE UNDERGROUND UTILITIES IF DURING CONSTRUCTION OPERATION THE CONTRACTOR SHOULD ENCOUNTER UTILITIES OTHER THAN THOSE SHOWN ON THE PLANS, HE SHALL IMMEDIATELY NOTIFY THE ENGINEER AND TAKE ALL NECESSARY AND PROPER STEPS TO PROTECT THE FACILITY AND ASSURE THE CONTINUANCE OF SERVICE.

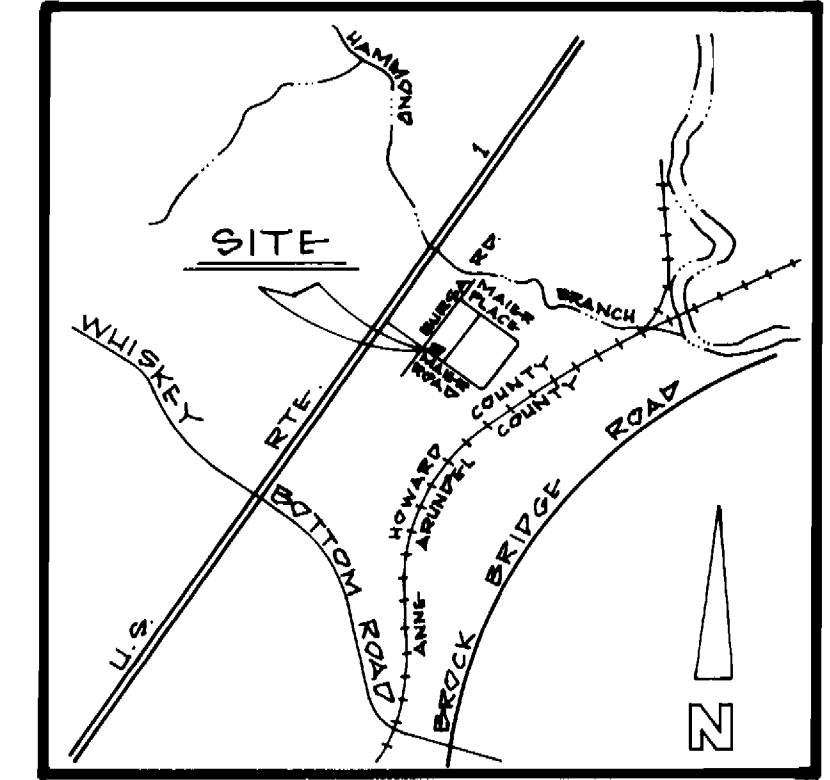

VICINITY MAP
 SCALE = 1" = 200'
 Water Code : E-14
 Sewer Code : 7100800
 Drainage Area : Little potomac

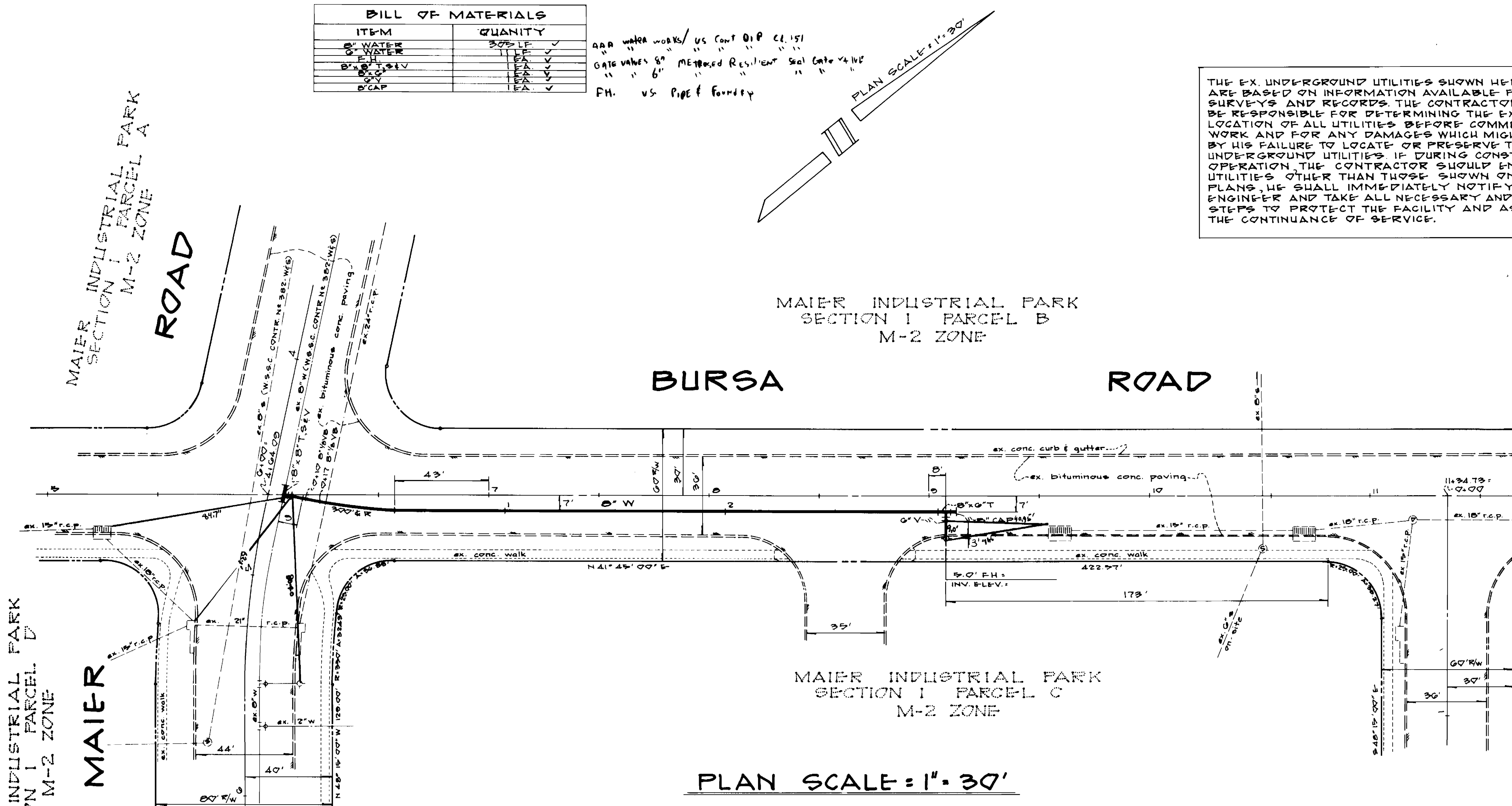

PLACE
MAIER
N/E
R. OGBURN
L. HEN 100-P-224

GENERAL NOTES

- APPROXIMATE LOCATION OF EX. MAIN ARE SHOWN. THE CONTRACTOR SHALL TAKE ALL NECESSARY PRECAUTIONS TO PROTECT EX. MAINS AND SERVICES AND MAINTAIN UNINTERRUPTED SUPPLY. ANY DAMAGE INCURRED SHALL BE REPAIRED IMMEDIATELY.
- ALL PIPE ELEVATIONS SHOWN ARE INVERT ELEVATIONS.
- THE CONTRACTOR SHALL LOCATE EX UTILITIES A MINIMUM OF TWO WEEKS IN ADVANCE OF CONSTRUCTION OPERATIONS IN VICINITY OF UTILITIES.
- FOR ALL STANDARD DETAILS SEE STANDARDS BOUND IN SPECIFICATIONS.
- ALL WATER MAINS SHALL HAVE A MINIMUM OF 4' COVER.
- BLOCK ALL FITTINGS WITH CONCRETE, SEE STANDARDS BOUND IN SPECIFICATIONS.
- BURY LINE ELEVATIONS ON FIRE HYDRANTS SHALL BE SET TO THE ELEVATIONS SHOWN ON THE DRAWINGS OR AS DIRECTED BY THE ENGINEER IN THE FIELD.
- ALL FIRE HYDRANTS SHALL BE STRAPPED AND BUTTRESSED IN ACCORDANCE WITH STANDARD DETAILS.
- COST OF STRAPPING FIRE HYDRANTS AND VALVES TO TEES TO BE INCLUDED IN PRICE BID FOR FURNISHING AND INSTALLING FIRE HYDRANTS.
- CLEAR ALL UTILITIES BY A MINIMUM OF 6' CLEAR ALL PILES BY A MINIMUM OF 2'-0" OR TUNNEL AS REQUIRED.
- ALL HORIZONTAL AND VERTICAL CONTROLS ARE IN HOWARD COUNTY DATUM AS EXTENDED FROM W.S.S.C.
- TIME OF CONNECTION TO EX. B.W. TO BE AS DIRECTED BY HOWARD COUNTY DEPARTMENT OF PUBLIC WORKS. IT MAY BE ANY TIME ON ANY DAY OR NIGHT.
- ALL WATER MAINS TO BE D.I.P. UNLESS OTHERWISE NOTED.

DEVELOPER'S CERTIFICATE

I CERTIFY THAT ALL DEVELOPMENT AND/OR CONSTRUCTION WILL BE DONE ACCORDING TO THIS PLAN FOR DEVELOPMENT AND EROSION AND SEDIMENT CONTROL. I AUTHORIZE PERIODIC ON-SITE INSPECTION BY THE HOWARD SOIL CONSERVATION DISTRICT, OR THEIR AUTHORIZED AGENT, AS ARE DEEMED NECESSARY. DEVIATION FROM THIS PLAN WILL NOT BE MADE UNLESS AUTHORIZED BY THE HOWARD SOIL CONSERVATION DISTRICT.

Alvin R. Maier
 ALVIN R. MAIER

6/19/85
 DATE

ENGINEER'S CERTIFICATE

I CERTIFY THAT THIS PLAN FOR SOIL EROSION AND SEDIMENT CONTROL REPRESENTS A PRACTICAL AND WORKABLE PLAN BASED ON MY PERSONAL KNOWLEDGE OF THE SITE CONDITIONS. IT WAS PREPARED IN ACCORDANCE WITH THE REQUIREMENTS OF THE HOWARD SOIL CONSERVATION DISTRICT.

William R. Joyce
 WILLIAM R. JOYCE, P.E.

3-14-85
 DATE

PAVEMENT PATCHING DETAIL

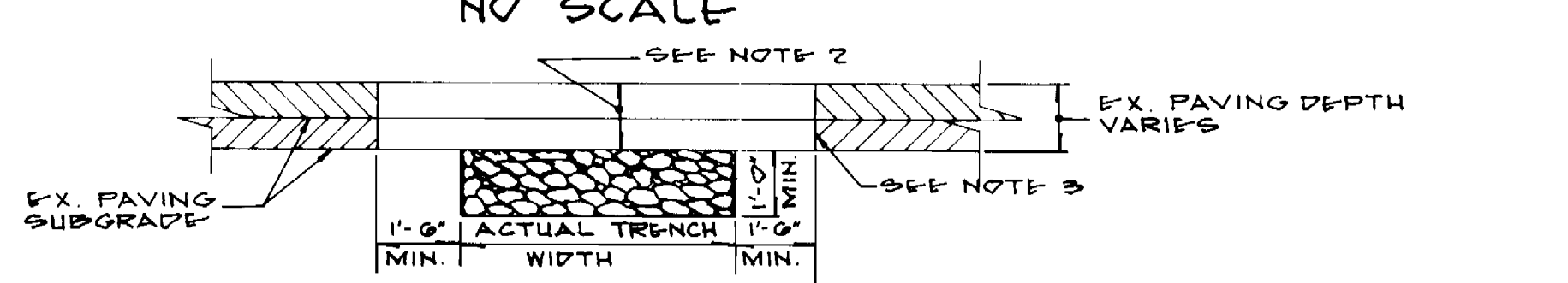

- CLEAN AND WET EDGES OF CUT BEFORE PLACING CONCRETE.
- PAVEMENT PATCH MATERIALS AND COURSE THICKNESS SHALL BE EQUAL TO EX. PAVING SECTION OR AS APPROVED BY D.P.W. THE MINIMUM PAVING PATCH SHALL CONSIST OF 3" BITUMINOUS CONC. SURFACE MATERIAL PLACED IN TWO 1 1/2" COURSES. BITUMINOUS CONC. BASE MATERIAL, WHEN PLACED, SHALL NOT EXCEED 3" THICKNESS PER COURSE. STONE BASE MATERIAL SHALL NOT EXCEED 3" THICKNESS PER COURSE.
- PLACE HOT LIQUID ASPHALT (M.P.K. OR AS APPROVED BY D.P.W.) ALONG VERTICAL FACE OF EX. PAVING PRIOR TO PLACING NEW MATERIAL TO INSURE CONTINUOUS BOND UPON COMPLETION OF PAVING PATCH THE HOT LIQUID ASPHALT SHALL BE BRUSHED INTO THE JOINT BETWEEN OLD AND NEW PAVING SURFACES TO PREVENT EXCESS LIQUID ASPHALT FROM BEING TRACKED BY TRAFFIC.

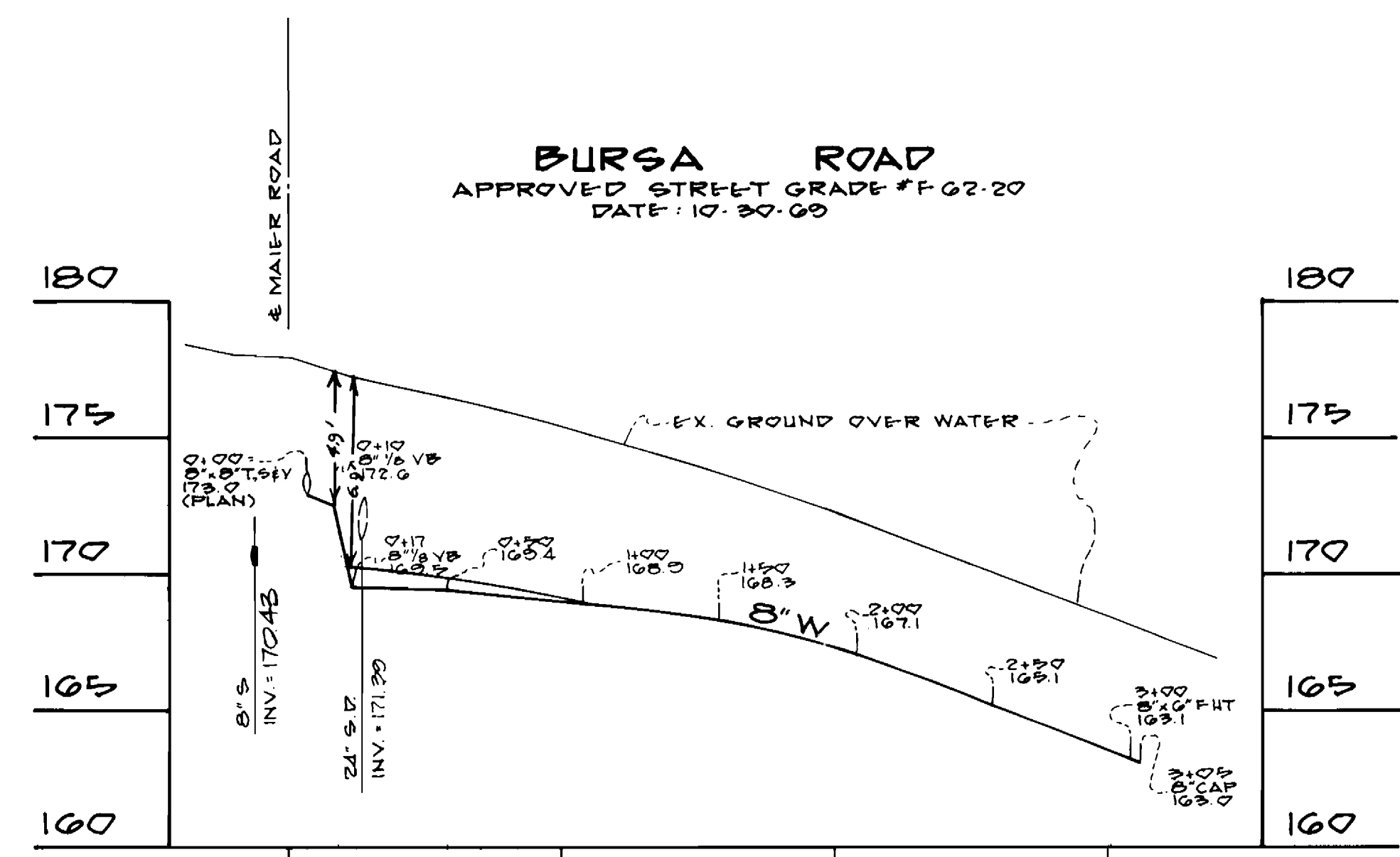

REVIEWED FOR HOWARD S.C.D. AND MEETS TECHNICAL REQUIREMENTS
John M. Johnson 8/27/85
 U.S. SOIL CONSERVATION SERVICE
 THIS DEVELOPMENT IS APPROVED SOIL EROSION AND SEDIMENT CONTROL BY THE HOWARD SOIL CONSERVATION DISTRICT
William L. Fisher 8/27/85
 HOWARD SOIL CONSERVATION DISTRICT

DEPARTMENT OF PUBLIC WORKS
 HOWARD COUNTY, MARYLAND
Robert W. Waller 9/17/85
 CHIEF, BUREAU OF UTILITIES
William R. Joyce 9-11-85
 CHIEF, BUREAU OF ENGINEERING
William L. Fisher 9-11-85
 CHIEF, LAND DEVELOPMENT DIVISION

JOYCE ENGINEERING CORPORATION
 PROFESSIONAL ENGINEERS, LAND PLANNING, SURVEYING
 11033 BALTIMORE AVE. BELTSVILLE, MD. 20705 (301) 559-4893

CONTRACT No 44-1394-D

MAIER INDUSTRIAL PARK-SECTION I SECTION ONE

ELECTION DISTRICT
 GUILFORD No 6

DRAWING No 1 OF 1
 SCALE AS SHOWN

William R. Joyce
 3-14-85