

**GENERAL NOTES**

- APPROXIMATE LOCATION OF EXISTING MAINS ARE SHOWN. THE CONTRACTOR SHALL TAKE ALL NECESSARY PRECAUTIONS TO PROTECT EXISTING MAINS AND SERVICES AND MAINTAIN UNINTERRUPTED SUPPLY. ANY DAMAGE INCURRED SHALL BE REPAIRED IMMEDIATELY TO THE SATISFACTION OF THE ENGINEER, AT THE CONTRACTOR'S EXPENSE.
- ALL HORIZONTAL CONTROLS ARE BASED ON MARYLAND STATE COORDINATES.
- ALL VERTICAL CONTROLS ARE BASED ON U.S.G.S. DATUM.
- ALL PIPE ELEVATIONS SHOWN ARE INVERT ELEVATIONS.
- CLEAR ALL UTILITIES BY A MINIMUM OF 6". CLEAR ALL POLES BY 2'-0" MINIMUM OR TUNNEL AS REQUIRED.
- FOR DETAILS NOT SHOWN ON THE DRAWINGS, AND FOR MATERIALS AND CONSTRUCTION METHODS, USE HOWARD COUNTY DESIGN MANUAL, VOLUME IV, STANDARD SPECIFICATIONS AND DETAILS FOR CONSTRUCTION. THE CONTRACTOR SHALL HAVE A COPY OF VOLUME IV ON THE JOB.
- WHERE TEST PITS HAVE BEEN MADE ON EXISTING UTILITIES, THEY ARE NOTED BY THE SYMBOL AT THE LOCATION OF THE TEST PIT. A NOTE OR NOTES CONTAINING THE RESULTS OF THE TEST PIT OR PITS IS INCLUDED ON THE DRAWINGS. EXISTING UTILITIES IN THE VICINITY OF THE PROPOSED WORK FOR WHICH TEST PITS HAVE NOT BEEN DUG SHALL BE LOCATED BY THE CONTRACTOR TWO WEEKS IN ADVANCE OF CONSTRUCTION OPERATIONS AT HIS OWN EXPENSE. TEST PIT SYMBOL:
- CONTRACTOR SHALL NOTIFY THE FOLLOWING UTILITIES OR AGENCIES AT LEAST FIVE WORKING DAYS BEFORE STARTING WORK SHOWN ON THESE PLANS:
  - STATE HIGHWAY ADMINISTRATION - 531-5533
  - BALTIMORE GAS AND ELECTRIC CO. - CONTRACTOR SERVICES 561-2585
  - BALTIMORE GAS AND ELECTRIC CO. - UNDER GROUND DAMAGE CONTROL - 234-5621
  - BALTIMORE GAS AND ELECTRIC CO. - TROUBLE SHOOTING - 298-9013
  - MISS UTILITY - 1 - 559-0100
  - COLONIAL PIPELINE CO. - 795-1390
  - BUREAU OF UTILITIES, HOWARD COUNTY DEPARTMENT OF PUBLIC WORKS - 992-2366
- TREES AND SHRUBS ARE TO BE PROTECTED FROM DAMAGE TO MAXIMUM EXTENT. TREES AND SHRUBS LOCATED WITHIN THE CONSTRUCTION STRIP ARE NOT TO BE REMOVED OR DAMAGED BY THE CONTRACTOR.
- CONTRACTOR SHALL REMOVE TREES, STUMPS AND ROOTS ALONG LINE OF EXCAVATION.
- ALL WATER MAINS TO BE D.I.P. UNLESS OTHERWISE NOTED.
- TOPS OF ALL WATER MAINS TO HAVE A MINIMUM OF 3-1/2' COVER UNLESS OTHERWISE NOTED.
- VALVES ADJACENT TO TEES SHALL BE STRAPPED TO TEES.
- ALL FITTINGS SHALL BE BUTTRESSED OR ANCHORED WITH CONCRETE IN ACCORDANCE WITH THE STANDARD DETAILS UNLESS OTHERWISE PROVIDED FOR ON THE DRAWINGS.
- FIRE HYDRANTS SHALL BE SET TO THE BURY LINE ELEVATIONS SHOWN ON THE DRAWINGS. ALL FIRE HYDRANTS SHALL BE STRAPPED AND BUTTRESSED WITH CONCRETE IN ACCORDANCE WITH STANDARD DETAILS. SOIL AROUND THE FIRE HYDRANT SHALL BE COMPACTED IN ACCORDANCE WITH SECTION 1003 THE STANDARD SPECIFICATIONS.
- THE CONTRACTOR SHALL NOT OPERATE ANY WATER MAIN VALVES ON THE EXISTING WATER SYSTEM.
- ALL WATER HOUSE CONNECTIONS SHALL BE FOR AN INSIDE METER SETTING, UNLESS OTHERWISE NOTED.
- ALL W.H.C.'S SHALL BE UNLESS OTHERWISE NOTED.
- ALL COPPER WATER HOUSE CONNECTIONS SHALL UTILIZE FLARED FITTINGS.
- ALL SEWER MAINS SHALL BE C.S.P.X., R.C.S.P., V.C.P.X., A.C.P. CLASS 2400 OR P.V.C. UNLESS OTHERWISE NOTED.
- THE CONTRACTOR SHALL PROVIDE A JOINT IN ALL SEWER MAINS WITHIN 2'-0" OF EXTERIOR MANHOLE WALL.
- ALL MANHOLES SHALL BE 4'-0" INSIDE DIAMETER UNLESS OTHERWISE NOTED.
- STRAW BALE DIKE AND SILT FENCE ARE INTERCHANGEABLE.
- MANHOLES DESIGNATED W.T. IN PLAN AND PROFILE SHALL HAVE WATERTIGHT FRAME AND COVERS, STANDARD DETAIL 85.52 WHERE WATERTIGHT MANHOLE FRAME AND COVER IS USED SET TOP OF FRAME 0.5 ABOVE FINISHED GRADE UNLESS OTHERWISE NOTED ON THE DRAWINGS.

Wastewater Disposal: Savage  
 Drainage Area: Little Patuxent  
 Type of Building: Office  
 No. of BHC: 3  
 No. of WHC: 3  
 No. of Lots: 3  
**WATER & SEWER CODE**  
 County Use:  
 Water: E 31  
 Sewer: 5521000

REVIEWED FOR HOWARD SOIL CONSERVATION DISTRICT AND MEETS TECHNICAL REQUIREMENT  
 Signature: *James McHelm* B-1-85  
 U.S. SOIL CONSERVATION SERVICE DATE  
 This Development Plan is approved for Soil Erosion and Sediment Control by the Howard County Conservation District.  
 APPROVED: *Stephen L. Huber* 8/1/85  
 HOWARD S.C.D. DATE

Sediment Control Measures for this Contract will be implemented in accordance with Article 15 of the Standard Specifications and Road Construction Plans F-85-145.

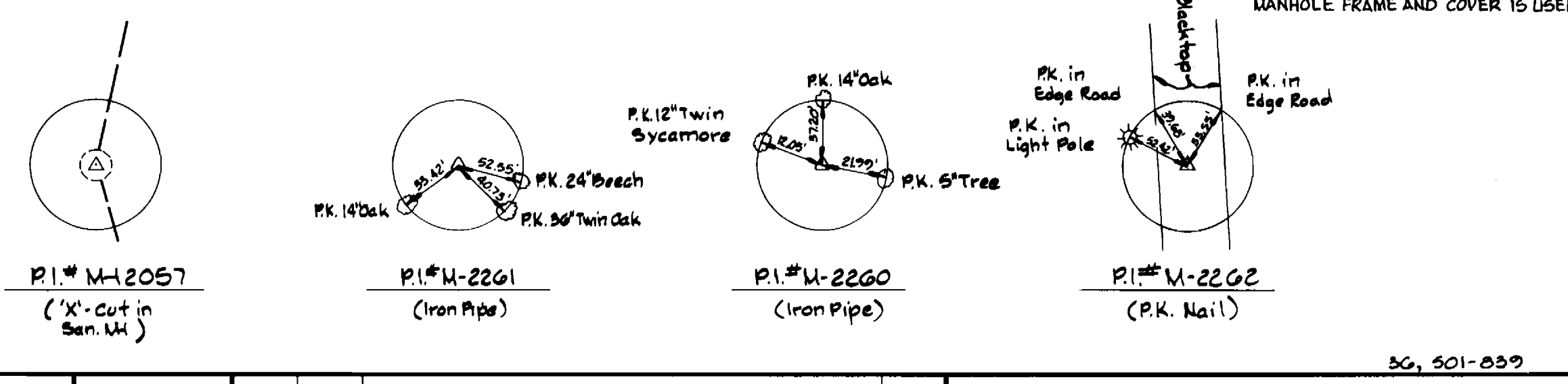

QUANTITIES				
ITEM	BID	AS-BUILT	MATERIAL/SUPPLIER	
8" Sewer L.F.	1620	1766	J.M. Corp. / Belzer Rd. Supply	
Manholes Ea	10	10	Atlantic Precast Concrete Corp	
8" Water L.F.	440	438	Griffin Pipe Products	
6" Water L.F.	20	150	Griffin Pipe Products	
8" Valve Ea	3	3	U.S. Pipe / Belzer Rd. Supply	
6" V (Including F.I.) Ea	3	3	U.S. Pipe / Belzer Rd. Supply	
12" 8" T.S. V. Ea	1	1	U.S. Pipe / Belzer Rd. Supply	
8" BHC L.F.	120	187	J.M. Corp. / Belzer Rd. Supply	
6" WHC L.F.	150	151	Griffin Pipe Products	
Fire Hydrants Ea	2	2	U.S. Pipe / Belzer Rd. Supply	

DEPARTMENT OF PUBLIC WORKS  
 HOWARD COUNTY, MARYLAND  
 Director: *Robert M. Beaman* GEN 8-5-85  
 Chief - Bureau of Public Works - DATE  
 Chief - Bureau of Utilities - DATE

WHITMAN, REQUARDT AND ASSOCIATES ENGINEERS  
 2315 ST PAUL ST. BALTIMORE, MARYLAND

DES: S.J.  
 DRN: J.R.K.  
 CHK: R.B.N.  
 DATE: 7/10/85

PLAN AND PROFILE OF SEWER MAINS  
 600' SCALE MAP NO. 36 BLOCK NO. 1

COLUMBIA TOWN CENTER SECTION 2 AREA 1 & AREA 5 PARCELS A, B & C ELECTION DISTRICT GUILFORD NO. 5 CONTRACT NO. 24-1376-D

SCALE AS SHOWN  
 SHEET 1 OF 2

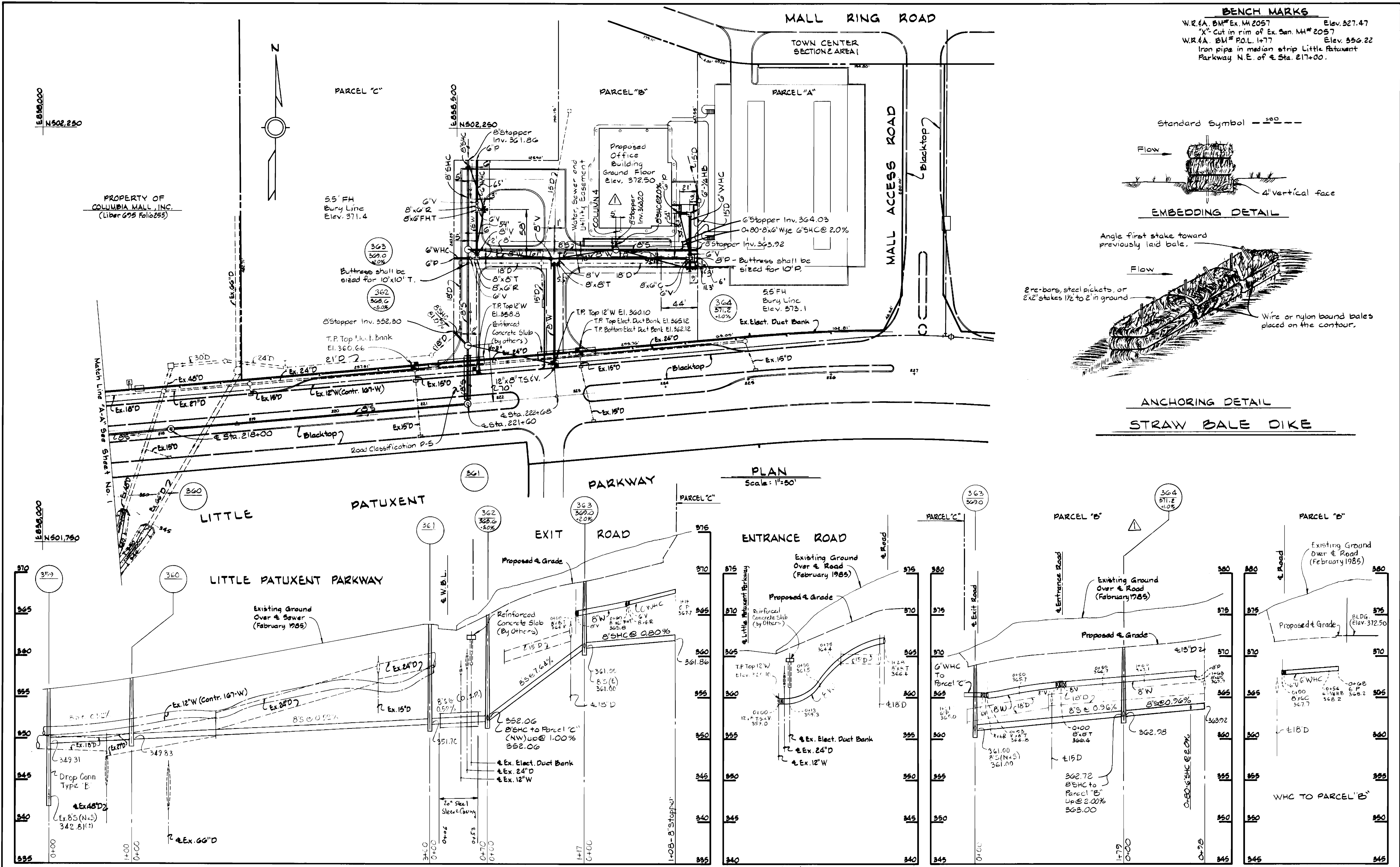

**BENCH MARKS**

W.R.#A, B.M.# Ex. M# 2057	Elev. 327.47
X <sup>2</sup> Cut in rim of Ex. San. M# 2057	Elev. 356.22
W.R.#A, B.M.# P.O.L. 1+77	Elev. 356.22
Iron pipe in median strip Little Patuxent Parkway N.E. of Sta. 217+00.	

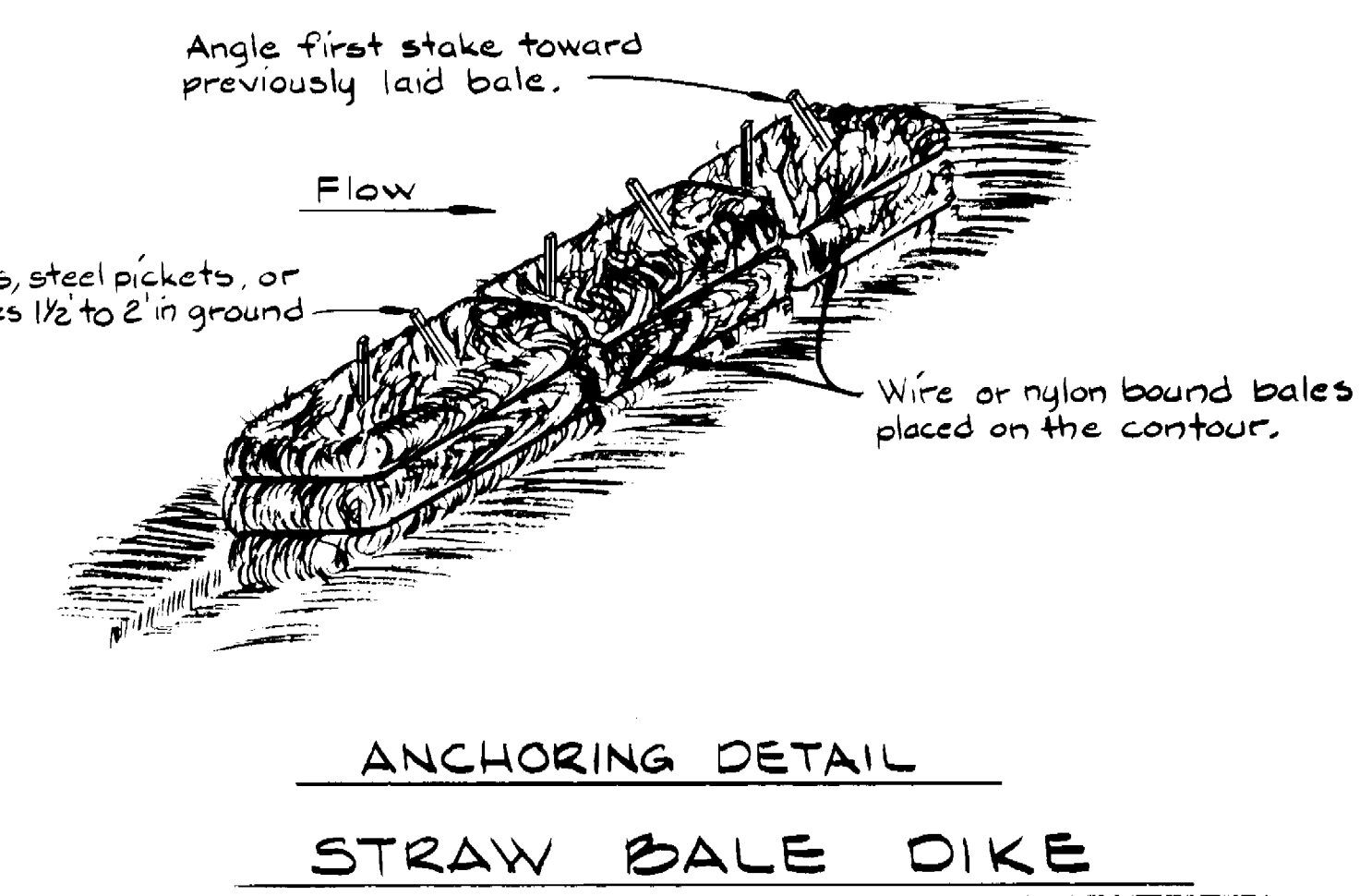
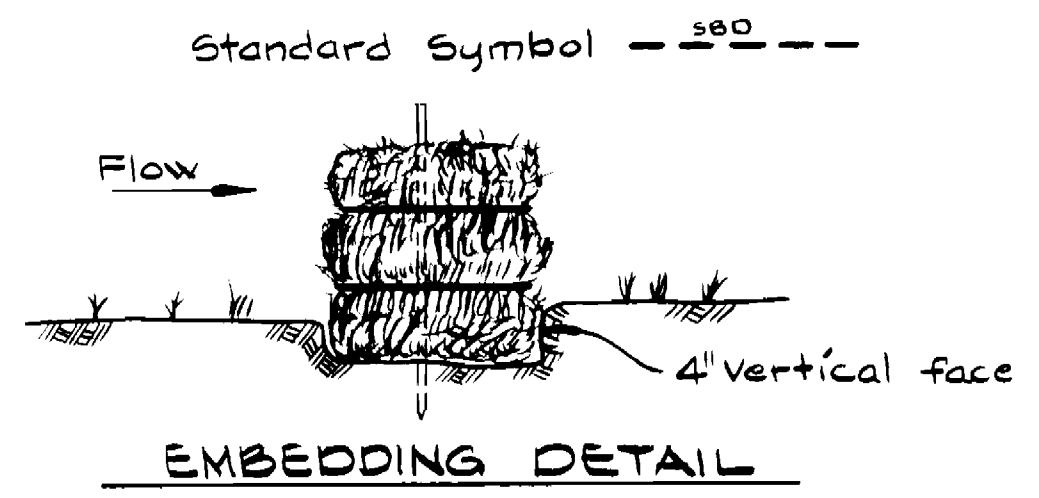

<p>DEPARTMENT OF PUBLIC WORKS HOWARD COUNTY, MARYLAND</p> <p><i>Robert M. Berman</i> for GEN. 8-5-85 DIRECTOR OF PUBLIC WORKS - DATE</p> <p><i>Robert W. Ward</i> for CHIEF-UTL. 8/2/85 CHIEF - BUREAU OF UTILITIES - DATE</p>	<p>WHITMAN, REQUARDT AND ASSOCIATES ENGINEERS</p> <p>2315 ST PAUL ST BALTIMORE, MARYLAND</p>	<p>DES: S. J.</p> <p>DRN: J. R. K.</p> <p>CHK: R. B. N.</p> <p>DATE: 7/10/85</p> <p>JRK  Moved NH 864 1/286</p>	<p>PLAN AND PROFILE OF WATER &amp; SEWER MAINS</p> <p>COLUMBIA TOWN CENTER SECTION 2 AREA 1 &amp; AREA 5 PARCELS A, B &amp; C ELECTION DISTRICT GUILFORD NO. 5 CONTRACT NO. 24-1376-D</p> <p>SCALE AS SHOWN</p> <p>SHEET 2 OF 2</p>
--	--	---	---