

CONTRACT NO. 20-1350-D

Wastewater Disposal: Savage  
 Drainage Area: Little Patuxent  
 Type of Buildings: N/A  
 No. of S.H.C.: -  
 No. of W.H.C.: N/A  
 No. of Lots: N/A  
**WATER & SEWER CODE**  
 County Use:  
 Water: N/A  
 Sewer: 5260000

VICINITY MAP  
 Scale: 1" = 600'

PLAN  
 Scale: 1" = 50'

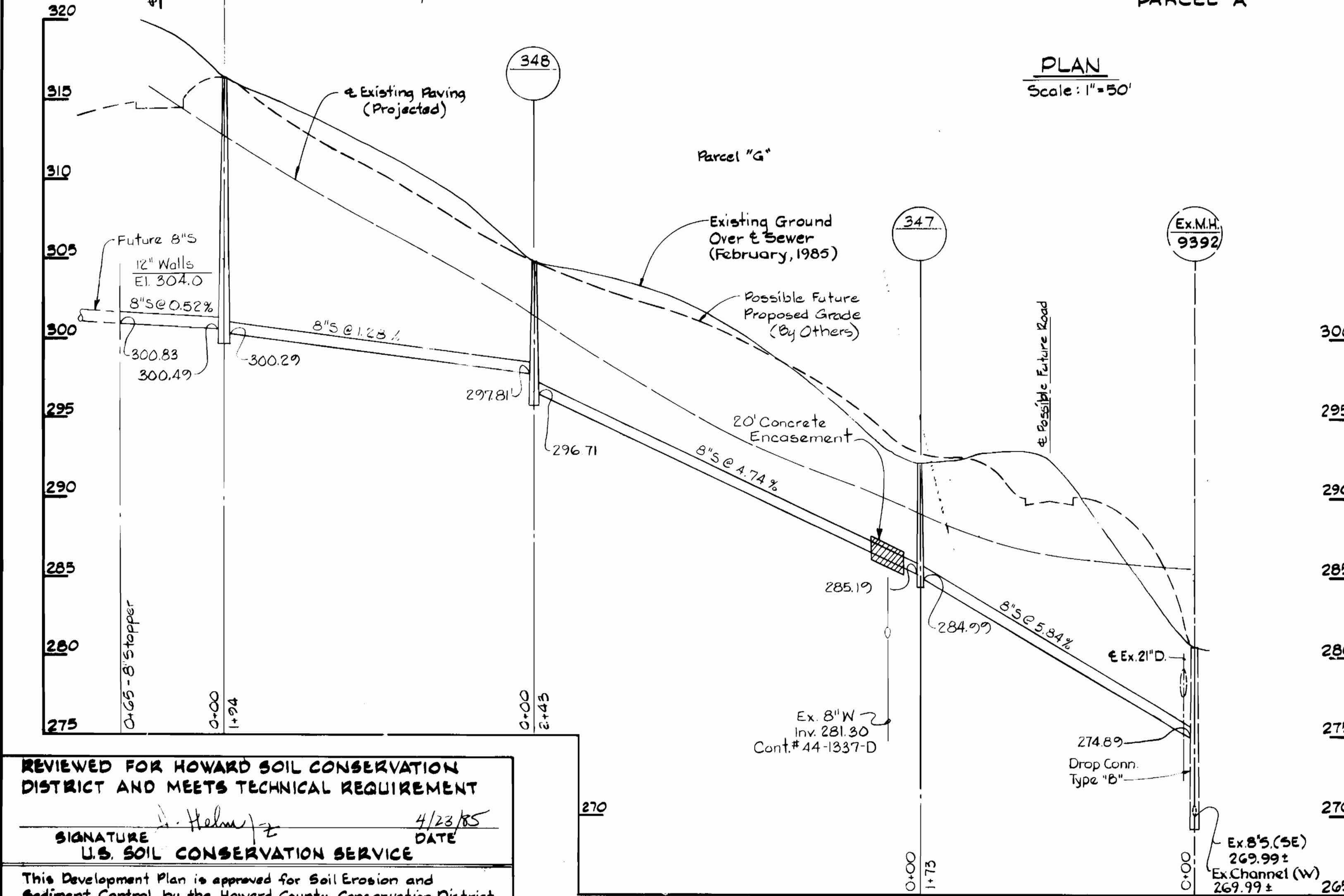

PROFILE  
 Scale: H: 1" = 50'  
 V: 1" = 5'

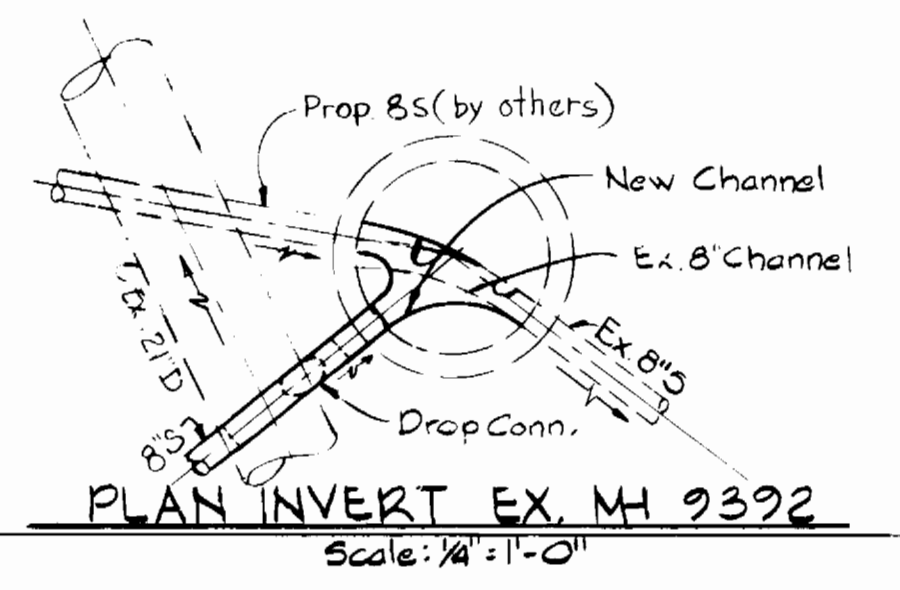

PLAN INVERT EX.MH 9392  
 Scale: 1/4" = 1'-0"

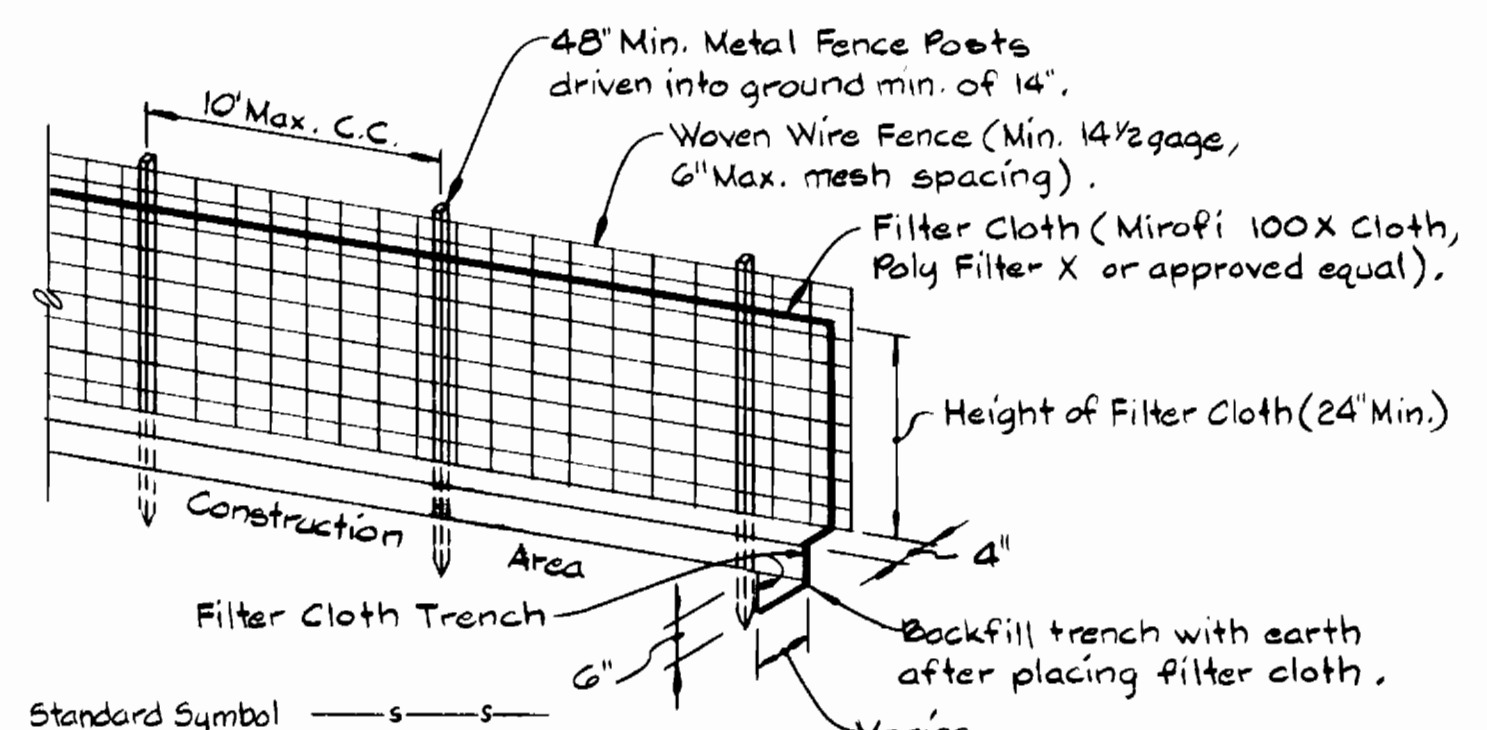

NOTES:  
 1. Woven wire fence to be fastened securely to fence posts by use of wire ties.  
 2. Filter cloth to be fastened securely to wavy wire fence by use of wire ties spaced every 24" at top and mid section.

SILT FENCE DETAIL

QUANTITIES			
ITEM	BID	AS BUILT	MATERIAL/SUPPLIER
8" Sewer L.F.	680	639	CHARLOTTE PIPE & FOUNDRY
Manholes Ea.	3	3	ATLANTIC PRE-CAST

REVIEWED FOR HOWARD SOIL CONSERVATION DISTRICT AND MEETS TECHNICAL REQUIREMENT  
 SIGNATURE: *[Signature]* DATE: 4/23/85  
 U.S. SOIL CONSERVATION SERVICE

This Development Plan is approved for Soil Erosion and Sediment Control by the Howard County Conservation District.

APPROVED: *[Signature]* DATE: 4/23/85  
 HOWARD S.C.D.

Sediment Control Measures for this Contract will be implemented in accordance with Article 15 of the Standard Specifications, and Road Construction Plans F-84-20B.

DEPARTMENT OF PUBLIC WORKS  
 HOWARD COUNTY, MARYLAND  
 Director: *[Signature]* 4/26/85  
 Chief - Bureau of Engineering: *[Signature]* 4/26/85  
 Chief - Bureau of Utilities: *[Signature]* 4/26/85  
 Chief - Land Development Division: *[Signature]* 4/26/85

WHITMAN, REQUARDT AND ASSOCIATES ENGINEERS  
 2315 ST. PAUL ST.  
 BALTIMORE, MARYLAND



DES: S.J.  
 CHK: M.T.K.  
 R.B.N.  
 DATE: 4/9/85

PLAN AND PROFILES OF SEWER MAINS  
 600' SCALE MAP NO. 42 BLOCK NO. 14

COLUMBIA RIVERS CORPORATE PARK  
 SECTION 2 AREA 2  
 ELECTION DISTRICT GUILFORD NO. 6  
 CONTRACT NO. 20-1350-D  
 SCALE AS SHOWN  
 SHEET 1 OF 1