

Bench Marks

BM #1 Elev. 313.02
Concrete monument 0.10 below surface located 375± SW of Murray Hill Road and Md. Route 32 28.4± NE of BG#E 46508C 4th pole from road.

BM #2 Elev. 314.00
Monument is located on transmission line NE of intersection of Route 32 & Bergen Road, 215± SW of GE Tower #32 & 32E

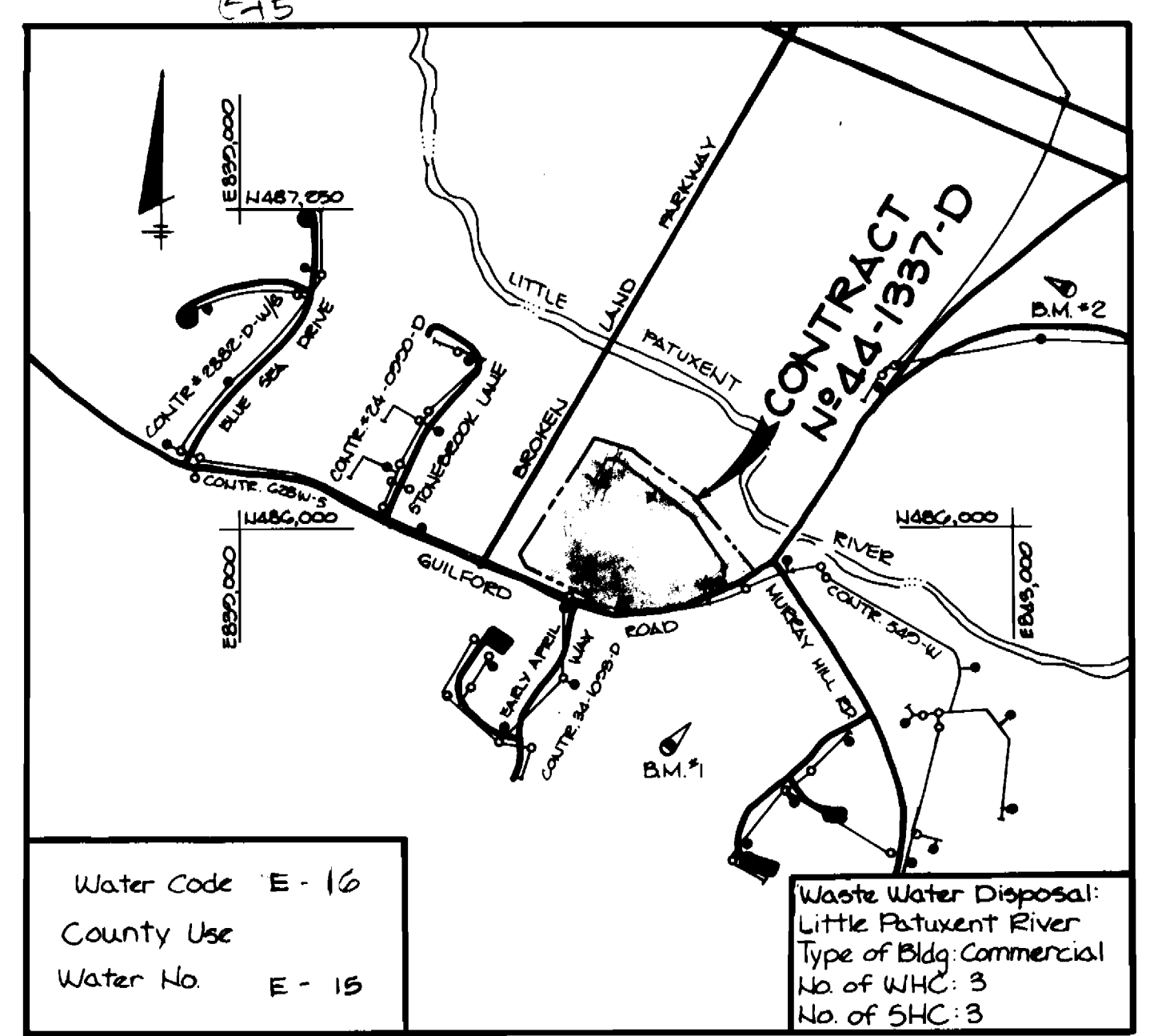

Water Code E - 16
County Use
Water No E - 15

Waste Water Disposal:
Little Pasture River
Type of Bldg Commercial
No. of WWC: 3
No. of SHC: 3

VICINITY MAP
Scale: 1"=600'

GENERAL NOTES

- Approximate location of existing mains are shown. The contractor shall take all necessary precautions to protect existing mains and services and maintain uninterrupted supply. Any damage incurred shall be repaired immediately to the satisfaction of the Engineer at the Contractor's expense.
- All horizontal controls are based on Maryland State Coordinates.
- All vertical controls are based on U.S.G.S. data.
- All pipe elevations shown are invert elevations.
- Clear all utilities by a minimum of 2'-0" minimum or tunnel as required.
- The owner has contacted the utility companies and has made arrangements for bracing of poles as shown on the drawings. In the event the contractor's work requires the bracing of additional poles, any cost incurred by the owner for the bracing of additional poles or damage shall be deducted from money owed the contractor. The contractor shall coordinate with the utility companies to schedule the bracing of the poles.
- For details not shown on the drawings, and for materials and construction methods, use Howard County Design Manual, Volume IV, Standard Specifications and Details for Construction. The contractor shall have a copy of Volume IV on the job.
- Where test pits have been made on existing utilities, they are noted by the symbol [] at the location of the test pit. A note or notes containing the results of the test pits is included on the drawings. Existing utilities in the vicinity of the proposed work for which test pits have not been dug shall be located by the contractor two weeks in advance of construction operations at his own expense.
- Contractor shall notify the following utilities or agencies at least five working days before starting work shown on these plans:
 - State Highway Administration 551-5533
 - Baltimore Gas & Electric Co - Contractor Services 561-2585
 - Baltimore Gas & Electric Co. Under Ground Damage Control 234-5621
 - Baltimore Gas & Electric Co. Trouble Shooting 228-5013
 - Miss Utility 1-550-0100
 - Colonial Pipeline Co. 795-13900
 - Bureau of Utilities, Howard County Department of Public Works 292-2306
- Trees are to be protected from damage to maximum extent. Trees located within the construction strip are not to be removed or damaged by the contractor.
- Contractor shall remove trees, stumps and roots along line of excavation as directed by the Engineer. Payment for such removal shall be included in the unit price bid for excavation and backfill.
- Place regulation "Men Working" and warning signs as required to comply with Maryland State Highway Administration Manual of Traffic Control for Highway Construction and Maintenance Operations.
- All water mains to be D.I.P. unless otherwise noted.
- Top of all water mains to have a minimum of 3/4" cover unless otherwise noted.
- Valves adjacent to trees shall be strapped to trees.
- Block all fittings with concrete.
- Bury line elevations on fire hydrants shall be set to the elevations shown on the drawings.
- All fire hydrants shall be strapped and buttressed with concrete in accordance with standard details. Soil around the fire hydrants to be compacted in accordance with Section 5 of the Standard Specifications.
- All water house connections shall be for an inside meter setting.
- The contractor shall not operate any water valves on the existing system.
- For all copper water house connections utilize flared type fittings only.
- Profile stations shall be adjusted as necessary to conform to Plan dimensions.
- No pipe shall be laid until lines of excavation have been brought to subgrade.

ITEM	QUANTITIES		MATERIAL/SUPPLIER
	ESTIMATED	AS BUILT	
8" Water M/J	150	150'	GREEN PIPES
6" Water Push on	300	361'	PIPE, GREEN PIPE
Fire Hydrants/VALVES	3	3	PIPE, VALVE
8" V (Excl. FHV)	1	1	PIPE, VALVE
6" V (Excl. FHV)	3	3	" "
8" WATER PUSH ON	478	495	PIPE, VALVE, FITTING
M/J FITTING	14	14	M/J FITTINGS, GREEN PIPE

Sediment control measures for this contract will be implemented in accordance with article 15 of the specifications and SDP-05-120

Howard Soil Conservation District Reviewed for Howard Soil Conservation District and meets technical requirements

James M. Belman 3/25/85
Date
US Soil Conservation Service

This plan is approved for soil erosion and sediment control by the Howard Soil Conservation District.

Stephen R. Fisher 3/25/85
Date
Howard Soil Conservation District

DEPARTMENT OF PUBLIC WORKS
HOWARD COUNTY, MARYLAND

Walter W. Wynn 4-19-85
DIRECTOR OF PUBLIC WORKS DATE

Arthur B. Muegge 4-19-85
CHIEF, BUREAU OF UTILITIES DATE

THE RIEMER GROUP, INC.
3105 HEALTH PARK DRIVE
ELLCOTT CITY, MARYLAND 21043

Arthur B. Muegge
ARTHUR B. MUEGGE

DES: JDP					
DRN: DAM					
CHK:					
DATE: 3-15-85	DAM	CHANGED PARKING AREA, STORM DRAINS, SEWER AND WATER MAIN	4-11-85		
BY NO.		REVISION	DATE		

PLAN OF A WATER MAIN

600' SCALE MAP NO. 42 BLOCK NO.

RIVERS CORPORATE PARK
(RIVERS BUSINESS COMMONS)
SECTION 2 AREA 2 PARCEL G
6TH ELECTION DISTRICT
HOWARD COUNTY, MARYLAND
CONTRACT NO. 44-1337-D

SCALE AS SHOWN
SHEET 1 OF 2

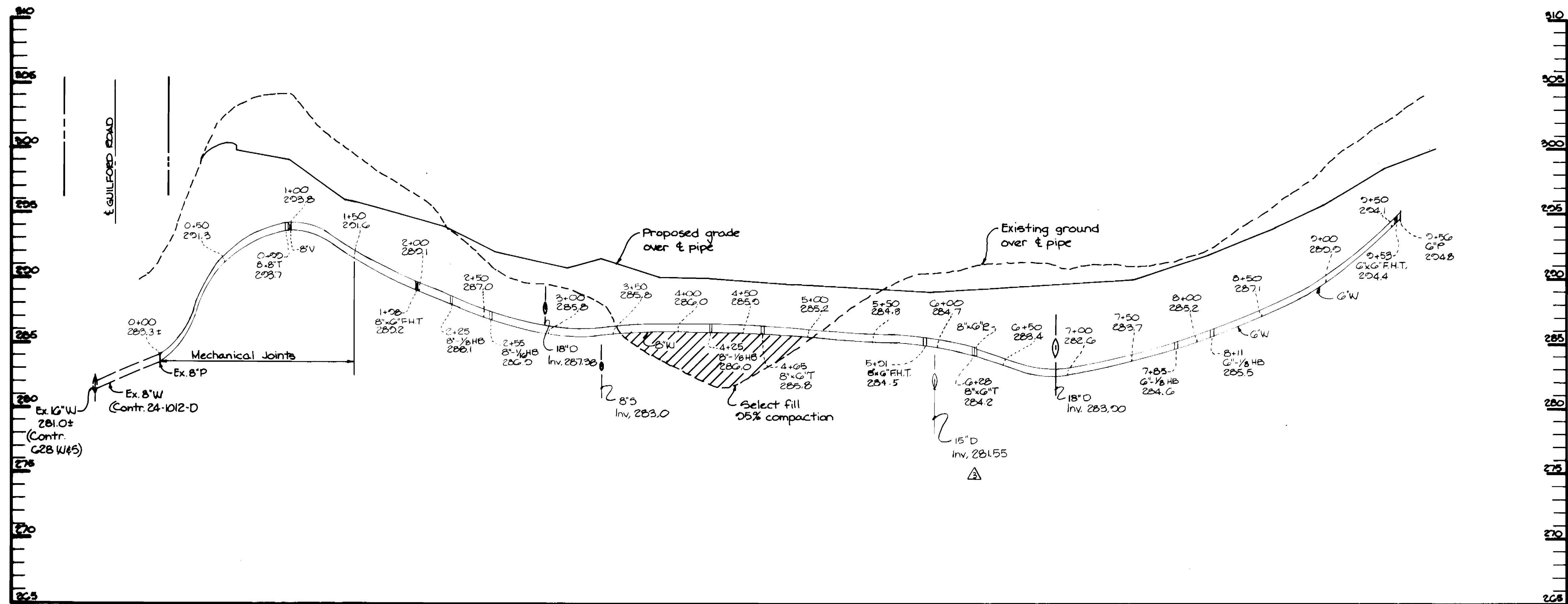

PROFILE
SCALE: HORIZ. 1"=50'
VERT. 1"=5'

DEPARTMENT OF PUBLIC WORKS
HOWARD COUNTY, MARYLAND

W. F. Neuman 4-19-85
DIRECTOR OF PUBLIC WORKS DATE

W. F. Neuman 4-19-85
CHIEF, BUREAU OF UTILITIES DATE

W. F. Neuman 4-19-85
CHIEF, BUREAU OF ENGINEERING DATE

W. F. Neuman 4-19-85
CHIEF, LAND DEVELOPMENT DIVISION DATE

THE RIEMER GROUP, INC.
3105 HEALTH PARK DRIVE
ELLCOTT CITY, MARYLAND 21043

Arthur E. Luegde
ARTHUR E. LUEGDE

DES: J.D.P.					
DRN: DAM					
CHK:	DAM	CHANGED S.D. CROSSING		0-25-85	
	EJW	CHANGED S.D. CROSSINGS AND PHT. SIZE		0-2-85	
	DAM	CHANGED WATER MAIN		4-11-85	
DATE: 3-15-85	BY: NO.	REVISION		DATE	

PROFILE OF A
WATER MAIN

600' SCALE MAP NO. 42 BLOCK NO. _____

RIVERS CORPORATE PARK
(RIVERS BUSINESS COMMONS)
SECTION 2 AREA 2 PARCEL G
6TH ELECTION DISTRICT
HOWARD COUNTY, MARYLAND
CONTRACT NO. 44-1337-D

SCALE
AS
SHOWN

SHEET
2 OF 2