

- NOTES:**
- APPROXIMATE LOCATION OF EXISTING MAINS ARE SHOWN. THE CONTRACTOR SHALL TAKE ALL NECESSARY PRECAUTIONS TO PROTECT EXISTING MAINS AND SERVICES AND MAINTAIN UNINTERRUPTED SUPPLY. ANY DAMAGE INCURRED SHALL BE REPAIRED IMMEDIATELY AT THE CONTRACTOR'S EXPENSE.
 - ALL PIPE ELEVATIONS SHOWN ARE INVERT ELEVATIONS.
 - CLEAR ALL UTILITIES BY A MINIMUM OF 2'-0" OR TUNNEL AS REQUIRED. ANY COSTS INCURRED TO THE CONTRACTOR FOR TUNNELING OR BRACING AT POLES SHALL BE INCLUDED IN UNIT PRICES BID FOR EXCAVATION.
 - ALL WORK SHOWN HEREON WILL BE IN ACCORDANCE WITH HOWARD COUNTY DESIGN MANUAL, VOLUME II (STANDARD SPECIFICATIONS AND DETAILS)
 - THE CONTRACTOR SHALL LOCATE EXISTING UTILITIES A MINIMUM OF TWO WEEKS IN ADVANCE OF CONSTRUCTION OPERATIONS IN THE VICINITY OF PROPOSED UTILITIES.
 - THE CONTRACTOR SHALL NOTIFY THE FOLLOWING UTILITIES OR AGENCIES AT LEAST FIVE (5) DAYS BEFORE STARTING WORK SHOWN ON THESE PLANS:
BALTIMORE GAS & ELECTRIC CO. - UNDERGROUND ELECTRIC DISTRIBUTION ENGINEERING - "DAMAGE CONTROL" - 234-5041
BALTIMORE GAS & ELECTRIC CO. - UNDERGROUND GAS DISTRIBUTION ENGINEERING - 559-0100
C & P TELEPHONE CO. - 725-9976
M&S UTILITY - 1-800-393-9648
 - TREES ARE TO BE PROTECTED FROM DAMAGE TO MAXIMUM EXTENT. TREES LOCATED WITHIN THE CONSTRUCTION STRIPS ARE NOT TO BE REMOVED OR DAMAGED BY THE CONTRACTOR WITHOUT PERMISSION OF THE HOWARD COUNTY BOARD OF EDUCATION.
 - PLACE REGULATION "MEN WORKING" AND WARNING SIGNS AS REQUIRED TO COMPLY WITH MARYLAND STATE HIGHWAY ADMINISTRATION MANUAL OF TRAFFIC CONTROL FOR HIGHWAY CONSTRUCTION AND MAINTENANCE.
 - ALL WATER MAINS TO BE C.I.P OR D.I.P.
 - TOP OF ALL WATER MAINS TO HAVE A MINIMUM OF 3.5' OF COVER UNLESS OTHERWISE NOTED.
 - HORIZONTAL AND VERTICAL CONTROLS ARE BASED ON HOWARD COUNTY CONTROL SURVEY CARDS.
 - ALL PAVEMENT PATCHING, REPAIR & REPLACEMENT SHALL BE IN ACCORDANCE WITH SECTION P-3, "FULL DEPTH BIT. CONC. ALTERNATE", DETAIL R-201 OF HOWARD COUNTY DESIGN MANUAL, VOLUME II.

CONTRACT #44-1314-D
SDP-85-01

DEPARTMENT OF PUBLIC WORKS
HOWARD COUNTY, MARYLAND

James F. Nemes 1-23-85
DIRECTOR OF PUBLIC WORKS DATE

William E. Poy 11/23/85
CHIEF BUREAU OF ENGINEERING DATE

Robert H. Bunker 1-23-85
CHIEF BUREAU OF UTILITIES DATE

Chief Land Development Div. DATE

REVIEWED FOR HOWARD SOIL CONSERVATION DISTRICT AND MEETS TECHNICAL REQUIREMENTS

James M. Nelson
SIGNATURE DATE 12/17/84
U.S. SOIL CONSERVATION SERVICE

THIS DEVELOPMENT PLAN IS APPROVED FOR SOIL EROSION AND SEDIMENT CONTROL BY THE HOWARD SOIL CONSERVATION DISTRICT

APPROVED:
Stephen L. Fisher
HOWARD SOIL CONSERVATION DISTRICT DATE 12/17/84

DES: JWH			
DRN: JWH			
CHK: RGR			
DATE: 11/20/84	BY: JWH	NO: 1	REVISION: CHANGE W. LINE & PH LOCATION PER COMMENTS 11/18/84

PLAN - WATER MAIN VICINITY MAP
HOWARD COUNTY BOARD OF EDUCATION
VOCATIONAL TECHNICAL CENTER

600' SCALE MAP NO. 29 BLOCK NO. _____

CLARKSVILLE PIKE (MD RT 108)
6th ELECTION DISTRICT
HOWARD COUNTY, MD.

CONTRACT 44-1314-D

SCALE AS SHOWN
SHEET 1 OF 2

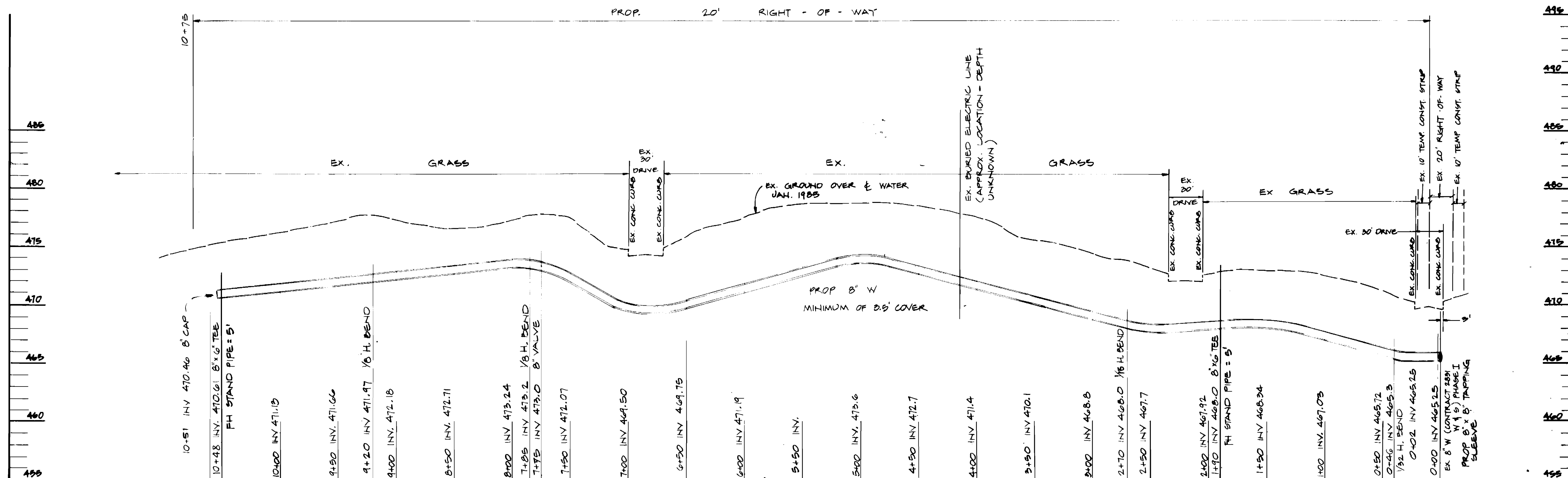

SCALE
 HOR - 1" = 50'
 VER - 1" = 5'

REVIEWED FOR HOWARD SOIL CONSERVATION DISTRICT
 AND MEETS TECHNICAL REQUIREMENTS

SIGNATURE _____ DATE _____
 U.S. SOIL CONSERVATION SERVICE

THIS DEVELOPMENT PLAN IS APPROVED FOR SOIL
 EROSION AND SEDIMENT CONTROL BY THE HOWARD
 SOIL CONSERVATION DISTRICT

APPROVED:
Stephen L. Huber 12/17/84
 HOWARD SOIL CONSERVATION DISTRICT DATE

CONTRACT #44-1314-D
 SDP - 85-01

HOFF, ROSENFEY & WOOLFOLK, INC.
 SITE #
 10708 REISTERSTOWN RD.
 OWINGS MILLS, MARYLAND 21117



DEPARTMENT OF PUBLIC WORKS
 HOWARD COUNTY, MARYLAND

Ray F. Neumaier 1-23-85
 DIRECTOR OF PUBLIC WORKS DATE

Robert M. Berger 1-23-85
 CHIEF, BUREAU OF UTILITIES DATE

Stephen L. Huber 1-23-85
 CHIEF, BUREAU OF ENGINEERING DATE

Michael K. ... 1-23-85
 CHIEF, LAND DEVELOPMENT DIV. DATE

DES:	JWH		
DRN:	JWH		
CHK:	RSR		
DATE:	11/30/84		
BY:	JWH	1	CHANGE PROFILE DUE TO CHANGE IN LOCATION
NO.:			
REVISION:			
DATE:			

PROFILE - WATER MAIN
 HOWARD COUNTY BOARD OF
 EDUCATION
 VOCATIONAL TECHNICAL CENTER

CLARKSVILLE PIKE (MD RT 108)

5th ELECTION DISTRICT
 HOWARD COUNTY, MD
 CONTRACT 44-1314-D

SCALE
 AS
 SHOWN

SHEET
 2 OF 2