

BENCHMARKS
 H.C. MONUMENT 3042001-R ELEV. 427.02
 CONCRETE MONUMENT 9' ANGLE IN
 TRANSMISSION LINE BACK OF SCHOOL.

SEWER HOUSE CONN. INVERT ELEV. & R.

STATION	LOT	ELEV.
MH#101 TO MH#102		
0+04 RT.	LOT 1	419.28
0+04 LT.	LOT 2	419.18
MH#5	LOT 8	420.58
MH#102 TO MH#103		
MH#3	LOT 8	420.58
0+52 RT.	LOT 9	420.54
0+01 RT.	LOT 10	420.97
1+08 LT.	LOT 3	420.37
1+40 RTE 1/2	LOT 11	420.13
1+50 RTE 1/2	LOT 12	421.20
1+77 LTE 1/2	LOT 4	421.49
2+06 RTE 1/2	LOT 13	421.56
2+27 LTE 1/2	LOT 5	421.85
MH#4 RT 1/2	LOT 14	422.03

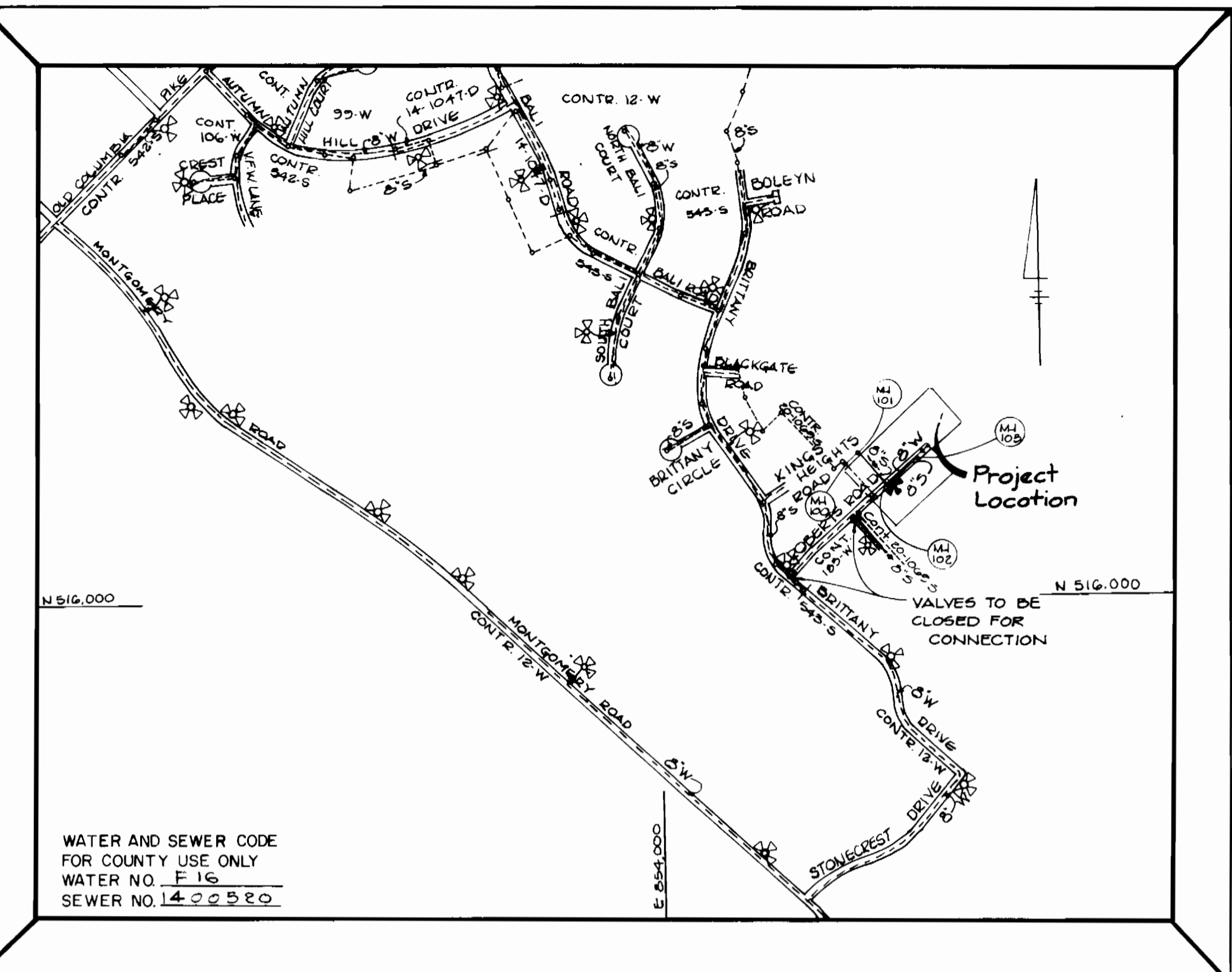

TYPE OF BUILDING - RESIDENTIAL

NUMBER OF LOTS	12
NO OF WATER HOUSE CONN.	12
NO OF SEWER HOUSE CONN.	12
DRAINAGE AREA	DATALESS

VICINITY MAP
 SCALE 1"=600'

GENERAL NOTES

- APPROXIMATE LOCATION OF EXISTING MAINS ARE SHOWN THE CONTRACTOR SHALL TAKE ALL NECESSARY PRECAUTIONS TO PROTECT EXISTING MAINS AND SERVICES AND MAINTAIN UNINTERRUPTED SUPPLY ANY DAMAGE INCURRED SHALL BE REPAIRED IMMEDIATELY TO THE SATISFACTION OF THE ENGINEER, AT THE CONTRACTOR'S EXPENSE.
- ALL HORIZONTAL CONTROLS ARE BASED ON MARYLAND STATE COORDINATES.
- ALL VERTICAL CONTROLS ARE BASED ON U.S.C.B.G.S.
- ALL PIPE ELEVATIONS SHOWN ARE INVERT ELEVATIONS.
- CLEAR ALL UTILITIES BY A MINIMUM OF 6" CLEAR ALL POLES BY 2'-0" MINIMUM OR TUNNEL AS REQUIRED THE OWNER HAS CONTACTED THE UTILITIES COMPANIES AND HAS MADE ARRANGEMENTS FOR BRACING OF POLES AS SHOWN ON THE DRAWINGS. IN THE EVENT THE CONTRACTOR'S WORK REQUIRES THE BRACING OF ADDITIONAL POLES, ANY COST INCURRED BY THE OWNER FOR THE BRACING OF ADDITIONAL POLES OR DAMAGES SHALL BE DEDUCTED FROM MONEY OWED THE CONTRACTOR. THE CONTRACTOR SHALL COORDINATE WITH THE UTILITIES COMPANIES TO SCHEDULE THE BRACING OF THE POLES.
- CONTRACTOR SHALL LOCATE EXISTING UTILITIES A MINIMUM OF TWO (2) WEEKS IN ADVANCE OF CONSTRUCTION OPERATIONS IN THE VICINITY OF PROPOSED UTILITIES AT HIS OWN EXPENSE.
- CONTRACTOR SHALL NOTIFY THE FOLLOWING UTILITIES OR AGENCIES AT LEAST FIVE (5) WORKING DAYS BEFORE STARTING WORK SHOWN ON THESE PLANS:
 - BALTIMORE GAS AND ELECTRIC CO - CONTRACTOR'S SERVICES 561-2585
 - BALTIMORE GAS AND ELECTRIC CO - UNDERGROUND DAMAGE CONTROL - 234-5621
 - BALTIMORE GAS AND ELECTRIC CO. - TROUBLE SHOOTING - 298-9013
 - "MISS UTILITY" - (1-559-0100)
 - CHESAPEAKE AND POTOMAC (C & P) TELEPHONE COMPANY - (725-9976)
 - BUREAU OF UTILITIES, HOWARD COUNTY - (992-2366)
- TREES ARE TO BE PROTECTED FROM DAMAGE TO MAXIMUM EXTENT. TREES LOCATED WITHIN THE CONSTRUCTION STRIP ARE NOT TO BE REMOVED OR DAMAGED BY THE CONTRACTOR.
- CONTRACTOR SHALL REMOVE TREES, STUMPS AND ROOTS ALONG LINE OF EXCAVATION AS DIRECTED BY THE ENGINEER. PAYMENT FOR SUCH REMOVAL SHALL BE INCLUDED IN THE UNIT PRICE BID FOR THE CONSTRUCTION OF THE MAIN.
- PLACE REGULATION "MEN WORKING" AND WARNING SIGNS AS REQUIRED TO COMPLY WITH MARYLAND STATE HIGHWAY ADMINISTRATION MANUAL OF TRAFFIC CONTROL FOR HIGHWAY CONSTRUCTION AND MAINTENANCE OPERATION.
- ALL WATER MAINS TO BE 6" D.I.P. UNLESS OTHERWISE NOTED.
- TOP OF ALL WATER MAINS HAVE A MINIMUM OF 3'-6" COVER UNLESS OTHERWISE NOTED.
- VALVES ADJACENT TO TEES SHALL BE STRAPPED TO TEES
- BURY LINE ELEVATIONS ON FIRE HYDRANTS SHALL BE SET TO THE ELEVATIONS SHOWN ON THE DRAWINGS. ALL FIRE HYDRANTS SHALL BE STRAPPED AND BUTTRESSED WITH CONCRETE IN ACCORDANCE WITH STANDARD DETAILS SOIL AROUND THE FIRE HYDRANTS TO BE COMPLETED IN ACCORDANCE WITH SECTION 12025-10008 OF THE STANDARD SPECIFICATIONS.
- ALL WATER HOUSE CONNECTIONS SHALL BE FOR AN INSIDE METER SETTINGS.
- THE CONTRACTOR SHALL NOT OPERATE ANY WATER MAIN VALVES ON THE EXISTING SYSTEM.
- ALL SEWER MAINS SHALL BE C.S.P.X., V.C.P.X., A.C.P. CLASS 2400 OR P.V.C. UNLESS OTHERWISE NOTED.
- THE CONTRACTOR SHALL PROVIDE A JOINT IN ALL SEWER MAINS WITHIN 2'-0" OF THE EXTERIOR MANHOLE WALL.
- ALL MANHOLES SHALL BE 4'-0" INSIDE DIAMETER, UNLESS OTHERWISE NOTED.
- MANHOLES SHOWN WITH 12" AND 16" WALLS ARE BRICK MANHOLES ONLY.
- WATER MAIN AND WATER HOUSE CONNECTION LINE MUST BE PLACED SO AS TO HAVE AT LEAST ONE (1) FOOT SEPARATION FROM THE SEWER MAIN OR SEWER HOUSE CONNECTION AS THEY PASS ABOUT IT.
- FOR ALL COPPER WATER HOUSE CONNECTIONS, UTILIZE FLARED TYPE FITTINGS ONLY.
- FOR DETAILS NOT SHOWN ON THE DRAWINGS, AND FOR MATERIALS AND CONSTRUCTION METHODS, USE HOWARD COUNTY DESIGN MANUAL, VOLUME IV, STANDARD SPECIFICATIONS AND DETAILS FOR CONSTRUCTION. THE CONTRACTOR SHALL HAVE A COPY OF VOLUME IV ON THE JOB.
- ALL FITTINGS SHALL BE BUTTRESSED OR ANCHORED WITH CONCRETE IN ACCORDANCE WITH THE STANDARD DETAILS UNLESS OTHERWISE PROVIDED FOR ON THE DRAWINGS.

QUANTITIES

ITEM	EST'D	AS-BUILT	SUPPLIER
8" SEWER	565 L.F.	565	J.M. MFG. CO.
MANHOLES	4 EA.	4EA.	TERACE HILL
6" S.H.C.	200 L.F.	200 L.F.	J.M. MFG. CO.
8" WATER	50 L.F.	512 L.F.	GRIFETH PIPE
6" WATER	28 L.F.	27 L.F.	"
F.H.	1 EA.	1EA.	U.S. PIPE & FNDRY
8" VALVES	1 EA.	1EA.	U.S. PIPE & FNDRY
6" F.H. VALVE	1 EA.	1EA.	U.S. PIPE & FNDRY
1/2" W.H.C.	100 L.F.	267 L.F.	HOWELL METAL
1" W.H.C.	20 L.F.	40 L.F.	HOWELL METAL
1/2" DRAIN	1 EA.	1 EA.	GRIFETH PIPE

CONTRACT NO. 14-1251-D
 ANGELA VALLEY SECTION ONE
 WATER AND SEWER EXTENSION
 HOWARD COUNTY, MARYLAND

DEPARTMENT OF PUBLIC WORKS
 HOWARD COUNTY, MARYLAND

Director of Public Works: *[Signature]* 8-29-84
 Chief, Bureau of Engineering: *[Signature]* 8-29-84
 Chief, Bureau of Utilities: *[Signature]* 8-10-84
 Chief, Land Development Division: *[Signature]* 8-10-84

FISHER, COLLINS AND CARTER, INC.
 CONSULTING ENGINEERS AND LAND SURVEYORS
 8388 COURT AVENUE
 ELLICOTT CITY, MARYLAND 21043
 461-2855

TERRILL A. FISHER DATE: _____

DES: DBS
 DRN: DBS
 CHK: TAF

BY	NO.	REVISION	DATE

PLAN, PROFILE & DETAILS
WATER AND SEWER MAINS

ANGELA VALLEY
 SECTION ONE
 CONTRACT NO. 14-1251-D
 SECOND ELECTION DISTRICT
 HOWARD COUNTY, MARYLAND

SCALE AS SHOWN
 SHEET 1 OF 1