

TYPE OF BUILDING	RESIDENTIAL
NUMBER OF LOTS (2 BUILDABLE)	14
NO OF WATER HOUSE CONN.	12
NO OF SEWER HOUSE CONN.	12
DRAINAGE AREA	FATAFGO

GENERAL NOTES

- APPROXIMATE LOCATION OF EXISTING MAINS ARE SHOWN THE CONTRACTOR SHALL TAKE ALL NECESSARY PRECAUTIONS TO PROTECT EXISTING MAINS AND SERVICES AND MAINTAIN UNINTERRUPTED SUPPLY. ANY DAMAGE INCURRED SHALL BE REPAIRED IMMEDIATELY TO THE SATISFACTION OF THE ENGINEER, AT THE CONTRACTOR'S EXPENSE.
- ALL HORIZONTAL CONTROLS ARE BASED ON MARYLAND STATE COORDINATES.
- ALL VERTICAL CONTROLS ARE BASED ON U.S.C. & G.S.
- ALL PIPE ELEVATIONS SHOWN ARE INVERT ELEVATIONS.
- CLEAR ALL UTILITIES BY A MINIMUM OF 6". CLEAR ALL POLES BY 2'-0" MINIMUM OR TUNNEL AS REQUIRED THE OWNER HAS CONTACTED THE UTILITIES COMPANIES AND HAS MADE ARRANGEMENTS FOR BRACING OF POLES AS SHOWN ON THE DRAWINGS. IN THE EVENT THE CONTRACTOR'S WORK REQUIRES THE BRACING OF ADDITIONAL POLES, ANY COST INCURRED BY THE OWNER FOR THE BRACING OF ADDITIONAL POLES OR DAMAGES SHALL BE DEDUCTED FROM MONEY OWED THE CONTRACTOR THE CONTRACTOR SHALL COORDINATE WITH THE UTILITY COMPANIES TO SCHEDULE THE BRACING OF THE POLES.
- CONTRACTOR SHALL LOCATE EXISTING UTILITIES A MINIMUM OF TWO (2) WEEKS IN ADVANCE OF CONSTRUCTION OPERATIONS IN THE VICINITY OF PROPOSED UTILITIES AT HIS OWN EXPENSE.
- CONTRACTOR SHALL NOTIFY THE FOLLOWING UTILITIES OR AGENCIES AT LEAST FIVE (5) WORKING DAYS BEFORE STARTING WORK SHOWN ON THESE PLANS:
BALTIMORE GAS AND ELECTRIC CO. - CONTRACTOR'S SERVICES: 561-2585
BALTIMORE GAS AND ELECTRIC CO. - UNDERGROUND DAMAGE CONTROL: 234-5621
BALTIMORE GAS AND ELECTRIC CO. - TROUBLE SHOOTING: 298-9013
"MISS UTILITY" - (1-559-0100)
CHESAPEAKE AND POTOMAC (C & P) TELEPHONE COMPANY - (725-9976)
BUREAU OF UTILITIES, HOWARD COUNTY - (992-2366)
- TREES ARE TO BE PROTECTED FROM DAMAGE TO MAXIMUM EXTENT. TREES LOCATED WITHIN THE CONSTRUCTION STRIP ARE NOT TO BE REMOVED OR DAMAGED BY THE CONTRACTOR.
- CONTRACTOR SHALL REMOVE TREES, STUMPS AND ROOTS ALONG LINE OF EXCAVATION AS DIRECTED BY THE ENGINEER. PAYMENT FOR SUCH REMOVAL SHALL BE INCLUDED IN THE UNIT PRICE BID FOR THE CONSTRUCTION OF THE MAIN.
- PLACE REGULATION "MEN WORKING" AND WARNING SIGNS AS REQUIRED TO COMPLY WITH MARYLAND STATE HIGHWAY ADMINISTRATION MANUAL OF TRAFFIC CONTROL FOR HIGHWAY CONSTRUCTION AND MAINTENANCE OPERATION.
- ALL WATER MAINS TO BE D.I.P. UNLESS OTHERWISE NOTED.
- TOP OF ALL WATER MAINS HAVE A MINIMUM OF 3'-6" COVER UNLESS OTHERWISE NOTED.
- VALVES ADJACENT TO TEES SHALL BE STRAPPED TO TEES.
- BURY LINE ELEVATIONS ON FIRE HYDRANTS SHALL BE SET TO THE ELEVATIONS SHOWN ON THE DRAWINGS. ALL FIRE HYDRANTS SHALL BE STRAPPED AND BUTTRESSED WITH CONCRETE IN ACCORDANCE WITH STANDARD DETAILS SOIL AROUND THE FIRE HYDRANTS TO BE COMPACTED IN ACCORDANCE WITH SECTION 1035 OF THE STANDARD SPECIFICATIONS.
- ALL WATER HOUSE CONNECTIONS SHALL BE FOR AN INSIDE METER SETTINGS.
- THE CONTRACTOR SHALL NOT OPERATE ANY WATER MAIN VALVES ON THE EXISTING SYSTEM.
- ALL SEWER MAINS SHALL BE C.S.P.X. - V.C.P.X. - A.C.P. CLASS 2400 OR P.V.C. UNLESS OTHERWISE NOTED.
- THE CONTRACTOR SHALL PROVIDE A JOINT IN ALL SEWER MAINS WITHIN 2'-0" OF THE EXTERIOR MANHOLE WALL.
- ALL MANHOLES SHALL BE 4'-0" INSIDE DIAMETER, UNLESS OTHERWISE NOTED.
- MANHOLES SHOWN WITH 12" AND 16" WALLS ARE BRICK MANHOLES ONLY.
- WATER MAIN AND WATER HOUSE CONNECTION LINE MUST BE PLACED SO AS TO HAVE AT LEAST ONE (1) FOOT SEPARATION FROM THE SEWER MAIN OR SEWER HOUSE CONNECTION AS THEY PASS ABOUT IT.
- FOR ALL COPPER WATER HOUSE CONNECTIONS, UTILIZE FLARED TYPE FITTINGS ONLY.
- FOR DETAILS NOT SHOWN ON THE DRAWINGS, AND FOR MATERIALS AND CONSTRUCTION METHODS, USE HOWARD COUNTY DESIGN MANUAL, VOLUME IV, STANDARD SPECIFICATIONS AND DETAILS FOR CONSTRUCTION. THE CONTRACTOR SHALL HAVE A COPY OF VOLUME IV ON THE JOB.
- ALL FITTINGS SHALL BE BUTTRESSED OR ANCHORED WITH CONCRETE IN ACCORDANCE WITH THE STANDARD DETAILS UNLESS OTHERWISE PROVIDED FOR ON THE DRAWINGS.

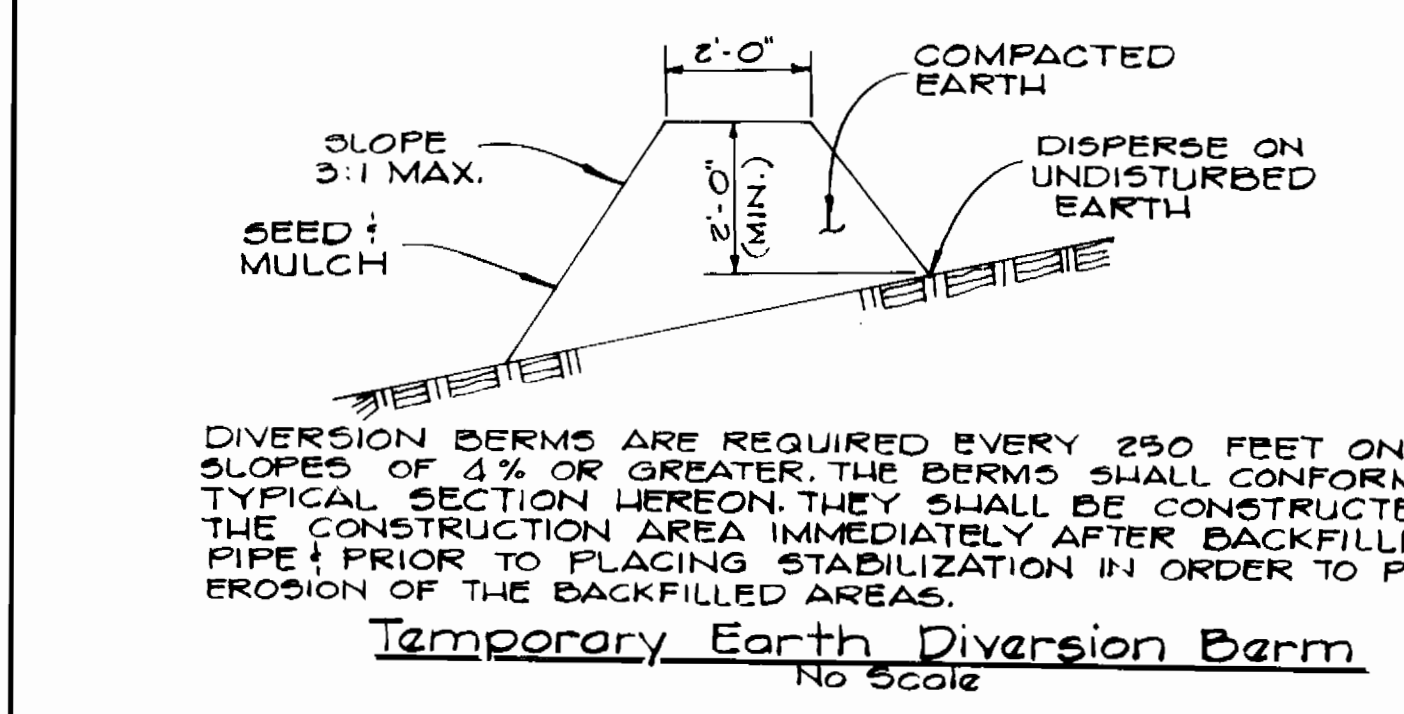
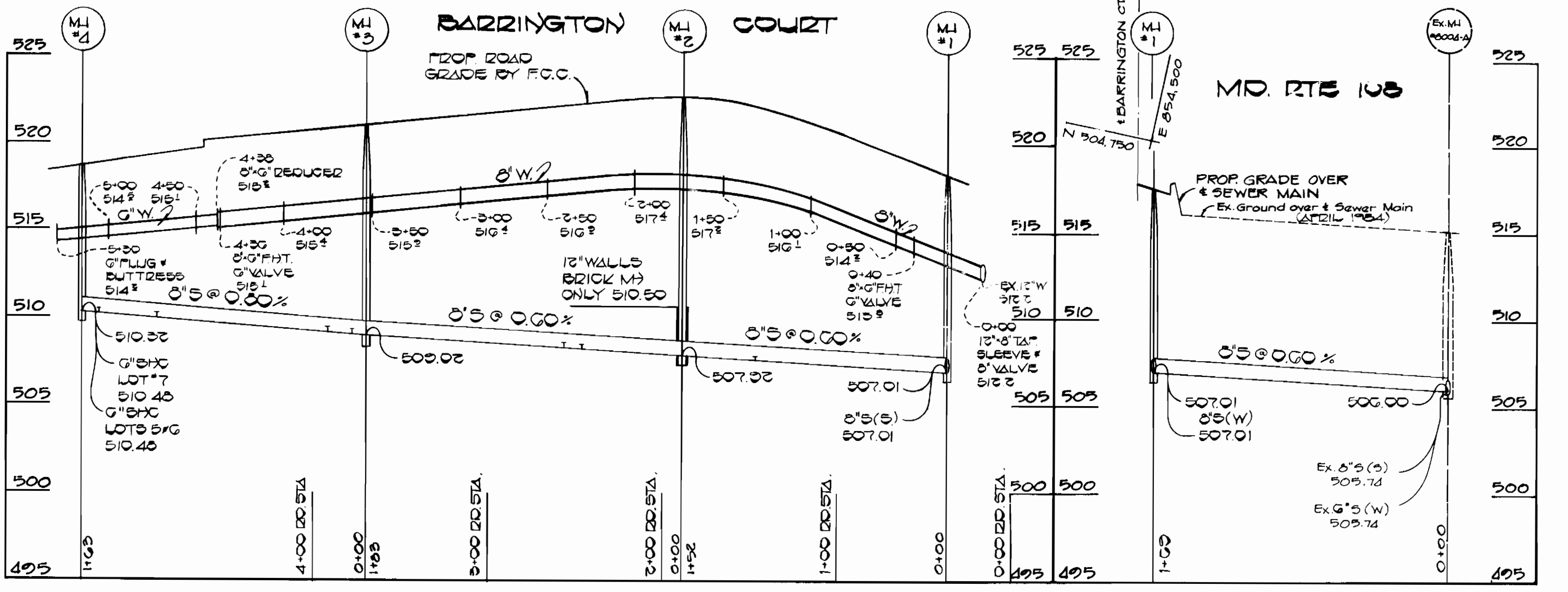
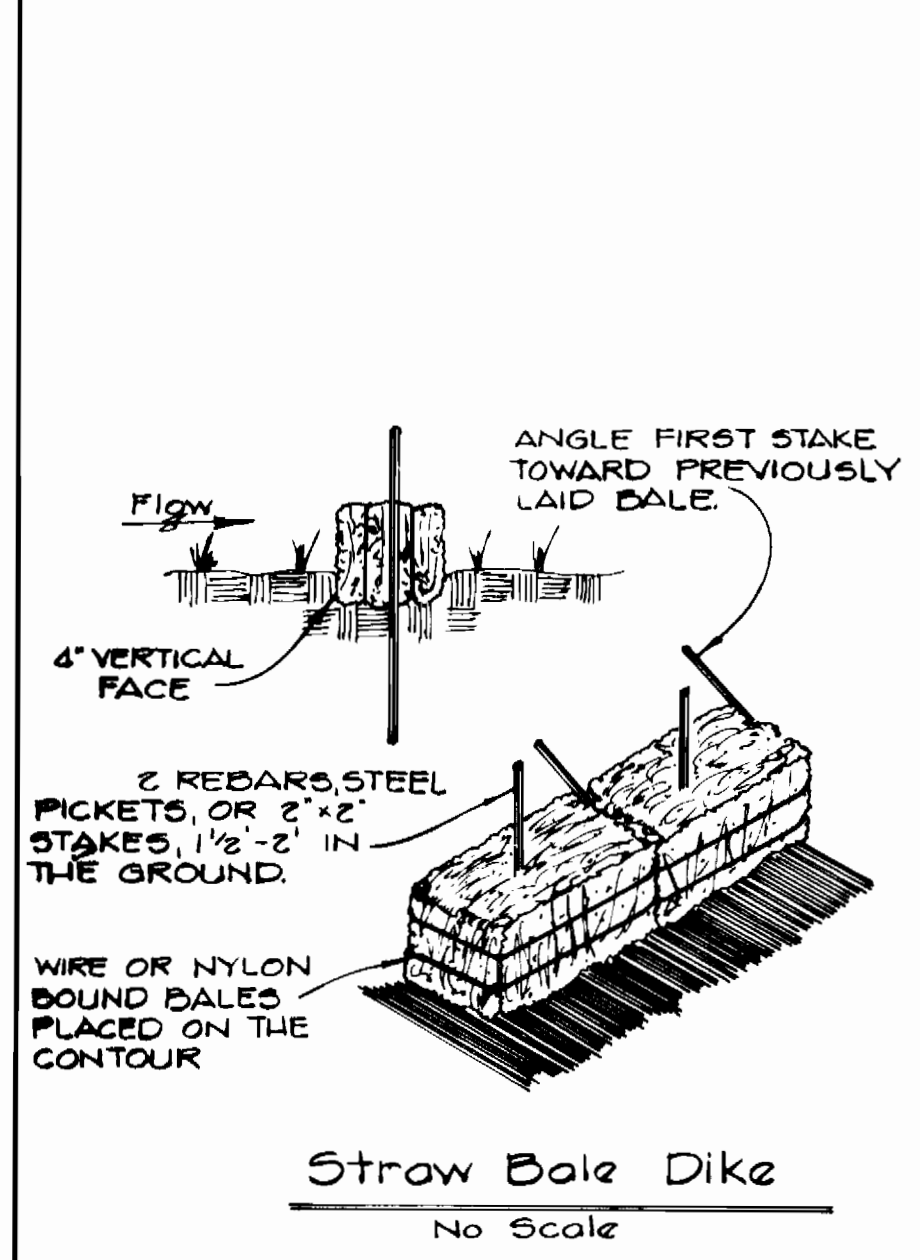

SEDMENT CONTROL MEASURES FOR THIS CONTRACT WILL BE IMPLEMENTED IN ACCORDANCE WITH ARTICLE 10 OF THE HOWARD COUNTY DESIGN MANUAL AND STANDARDS AND SPECIFICATIONS FOR SOIL EROSION AND SEDIMENT CONTROL IN DEVELOPING AREAS AND ALSO AS SHOWN ON THE GRADING AND SEDIMENT CONTROL PLAN F.O.S.-41.

REVIEWED FOR HOWARD COUNTY SOIL CONSERVATION DISTRICT AND MEETS TECHNICAL REQUIREMENTS.

U.S. SOIL CONSERVATION SERVICE DATE: 10-11-84
THIS DEVELOPMENT PLAN IS APPROVED FOR EROSION & SEDIMENT CONTROL BY HOWARD SOIL CONSERVATION DISTRICT. APPROVED: [Signature]

HOWARD SOIL CONSERVATION DISTRICT DATE

Sewer House Conn. Invert Elev. @ Ft.

STATION	LOT #	ELEV.
M.I. #1 to M.I. #2		
1+10 LT	LOT 1	508.11
M.I. #2 to M.I. #3		
0+50 LT	LOT 2	508.77
0+60 RT	LOT 10	509.01
M.I. #3 to M.I. #4		
0+00 RT	LOTS 11&12	503.84
0+22 LT	LOT 3	503.57
1+20 LT	LOT 4	510.74
1+35 RT	LOTS 9,10	511.40
M.I. #4	LOTS 5,6	511.15
M.I. #4	LOT 7	511.34

Construction Stakeout Table

M.I. #	R.D. STA.	DIST.	RIM	SLOPE
M.I. #1	0+50	8' LT	517.50	+4.0%
M.I. #2	1+00	8' LT	522.50	+0.2%
M.I. #3	2+00	8' LT	520.00	(-1.0%)
M.I. #4	5+04	7' LT	510.0	(-1.0%)

QUANTITIES

ITEM	EST'D	AS-BUILT	SUPPLIER
8" SEWER	607 L.F.	657.6 L.F.	BELLAR ROAD
6" SEWER	200 L.F.	267 L.F.	BRS/J.M. COOP
MANHOLES	4 EA.	4 EA.	BRS/TERRILL HILL
8" WATER	430 L.F.	435 L.F.	BRS/SRIFFIN PIPE
6" WATER	112 L.F.	116 L.F.	BRS/SRIFFIN PIPE
FIRE HYD.	2 EA.	2 EA.	BRS/U.S. PIPE
1" WHC	15 L.F.	16 L.F.	"
3/4" WHC	354 L.F.	374 L.F.	BRS/HOWELL MTL

DEPARTMENT OF PUBLIC WORKS
HOWARD COUNTY, MARYLAND

Director of Public Works: [Signature] DATE: 10-17-84

Chief, Bureau of Engineering: [Signature] DATE: 10-17-84

Chief, Bureau of Utilities: [Signature] DATE: 10-17-84

Chief, Land Development Division: [Signature] DATE: 10-17-84

FISHER, COLLINS AND CARTER, INC.
CONSULTING ENGINEERS AND LAND SURVEYORS

8388 COURT AVENUE
ELLICOTT CITY, MARYLAND 21043
461-2855

TERRELL A. FISHER DATE

DES: T.A.F.
DRN: D.E.V.
CHK: T.A.F.
DATE: 8/10/84

PLAN

WATER AND SEWER MAINS

600' SCALE MAP NO. 20431 BLOCK NO.

BARRINGTON WOODS

CONTRACT NO. 14-1244-D
SIXTH ELECTION DISTRICT
HOWARD COUNTY, MARYLAND

SCALE AS SHOWN
SHEET 1 OF 1

AS BUILT, OCT. 1985