

UTILITIES CONTRACTOR TO USE EXTREME CAUTION WHEN WORKING NEAR ELECTRIC CONDUIT

LOCATE THE EXISTING ELECTRIC CONDUIT BY TEST PIT FOR VALVE CONNECTION

BM 78 ELEV. 376.11 - SPIKE IN UTILITY POLE 150 RT  
 STA 7+18.0 DOBBIN RD  
 BM 160 ELEV. 354.03 SPIKE 2' BLACK CHERRY TREE  
 230' RT STA 60+15.0 DOBBIN RD.

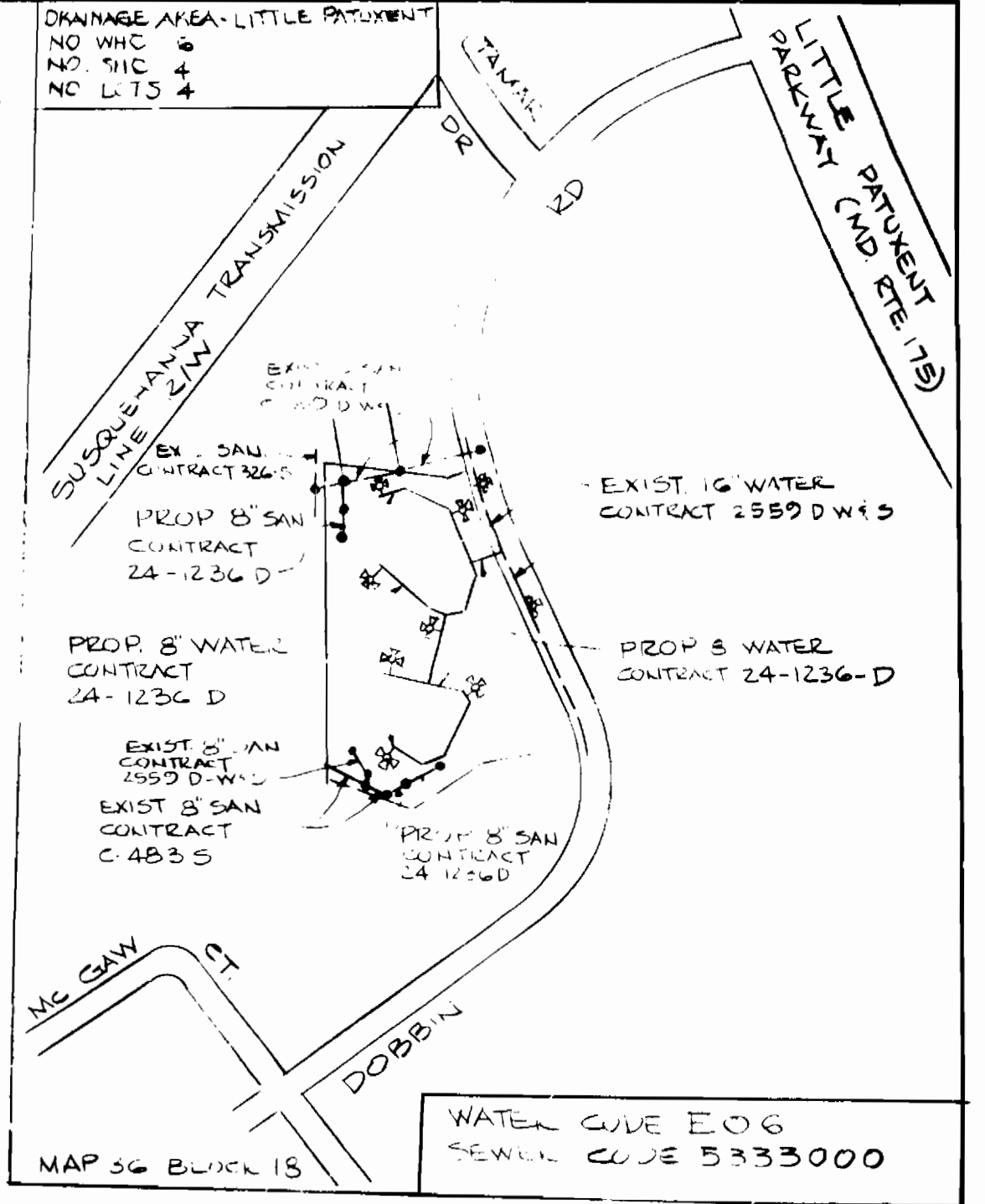

LOCATION MAP  
SCALE 1" = 600'

GENERAL NOTES

1. ALL WATER MAINS TO BE CIP, 30" DIA UNLESS OTHERWISE SHOWN.
2. TOP OF ALL WATER MAINS TO HAVE A MINIMUM OF 3.5 FT COVER UNLESS OTHERWISE NOTED.
3. ALL VALVES SHALL BE STEPPED TO TEE, IN ACCORDANCE WITH STANDARD DETAILS.
4. BLOCK ALL FITTINGS WITH CONCRETE SEE STANDARDS BOUND IN SPECIFICATIONS.
5. FIRE HYDRANTS SHALL BE SET TO THE FULL LINE ELEVATIONS SHOWN ON THE DRAWINGS. ALL FIRE HYDRANTS SHALL BE STAMPED AND BUTTRESSED WITH CONCRETE IN ACCORDANCE WITH STANDARD DETAILS. SOIL AROUND FIRE HYDRANTS SHALL BE COMPACTED TO ACCORDANCE WITH SECTION 5.11 OF THE STANDARD SPECIFICATIONS.
6. ALL SANITARY SEWERS SHALL BE CSPI, VCPV OR ACP CLASS 2400 OR PV UNLESS OTHERWISE NOTED.
7. THE CONTRACTOR SHALL PROVIDE A JOINT IN ALL SEWER MAINS WITHIN 2'-0" OF EXTERIOR MANHOLE WALL.
8. ALL MANHOLES SHALL BE 4'-0" INSIDE DIAMETER UNLESS OTHERWISE NOTED.
9. APPROXIMATE LOCATIONS OF EXISTING MAINS ARE SHOWN. THE CONTRACTOR SHALL TAKE ALL NECESSARY PRECAUTIONS TO PROTECT EXISTING MAINS AND SERVICES AND MAINTAIN UNINTERRUPTED SUPPLY AND SERVICE. DAMAGE INCURRED SHALL BE REPAIRED IMMEDIATELY.
10. ALL HORIZONTAL CONTROLS ARE BASED ON MARYLAND STATE COORDINATED.
11. ALL VERTICAL CONTROLS ARE BASED ON U.S. & DATUM.
12. ALL PIPE ELEVATIONS SHOWN ARE INVERT ELEVATIONS.
13. CLEAR ALL UTILITIES BY A MINIMUM OF 6" CLEAR ALL PILES BY 2'-0" MINIMUM OR TUNNEL AS REQUIRED.
14. FOR ALL STANDARD DETAILS SEE STANDARDS BOUND IN SPECIFICATIONS.
15. CONTRACTOR SHALL LOCATE EXISTING UTILITIES IN ADVANCE OF CONSTRUCTION OPERATIONS IN THE VICINITY OF PROPOSED UTILITIES.
16. CONTRACTOR SHALL NOTIFY THE FOLLOWING UTILITIES OR AGENCIES AT LEAST FIVE (5) DAYS BEFORE STARTING WORK SHOWN ON THESE PLANS:  
 STATE HIGHWAY ADMINISTRATION 531-5553  
 BALTIMORE GAS & ELECTRIC COMPANY CONTRACTOR SERVICES 561-2885  
 BALTIMORE GAS & ELECTRIC COMPANY TRUCK SHEDS 208-0018  
 M&T UTILITY 1-550-0100  
 BUREAU OF UTILITIES, HOWARD CO. D.W. 992-2400  
 AMERICAN PIPELINE COMPANY 781-3641  
 COLONIAL PIPELINE COMPANY 781-3641
17. TREES ARE TO BE PROTECTED FROM DAMAGE TO MAXIMUM EXTENT. TREES LOCATED WITHIN THE CONSTRUCTION ZONE ARE NOT TO BE REMOVED OR DAMAGED BY THE CONTRACTOR.
18. CONTRACTOR SHALL REMOVE TREE STUMPS AND CHIPS ALONG LINE OF EXCAVATION AS DIRECTED BY THE ENGINEER. PAYMENT FOR SUCH REMOVAL SHALL BE INCLUDED IN THE UNIT PRICE BID FOR EXCAVATION AND BACKFILL.
19. PLACE REGULATORY TRAFFIC WARNING SIGNS AS REQUIRED TO COMPLY WITH MARYLAND STATE HIGHWAY ADMINISTRATION MANUAL OF TRAFFIC CONTROL FOR HIGHWAY CONSTRUCTION AND MAINTENANCE OPERATIONS.
20. ALL WATER METER SETTINGS SHALL BE INSHUL METER SETTINGS UNLESS OTHERWISE SHOWN.
21. ALL OTHER W.H.C. SHALL UTILIZE FLARED TYPE FITTINGS ONLY.

QUANTITIES		
ITEM	QUANTITIES	AS-BUILT
8" SAN SEWER	474 LF.	453 Belair RD Supply
6" SAN SEWER	25 LF	25 LF Belair RD Supply
SAN. MANHOLES	7	7 Belair RD Supply
8" WATER MAIN	2112 LF	Amstead Industries 2207 LF GRIFFEN
6" WATER	138 LF	Amstead Industries Inc 139 LF GRIFFEN Pipe Prod. Co.
FIRE HYDRANTS	7	MH 7 MUNICIPAL + CNTRS SALES US BRASS
2" W.H.C	20 LF	25 MUNICIPAL + CNTRS SALES MH
4" W.H.C	20 LF	18 MUNICIPAL + CNTRS SALES
METER VAULT	2 (2' x 3')	Smith CATTLE GUARD 2
8" VALVE	6	6 MH Municipal + Cntrs Sales
6" VALVE (EXC. F.H.)	2	2 MH Municipal + Cntrs SALES

PLAN SCALE 1" = 50'

SEDIMENT CONTROL MEASURED FOR THIS CONTRACT WILL BE IMPLEMENTED IN ACCORDANCE WITH ARTICLE 15 OF THE STANDARD SPECIFICATIONS AND ROAD CONSTRUCTION PLANS - F 84-133 & SDP 84-214

REVIEWED FOR THE HOWARD SOIL CONSERVATION DISTRICT & MEETS TECHNICAL REQUIREMENTS

*James M. Nelson* 1/5/84  
 U.S. SOIL CONSERVATION DISTRICT DATE

HOWARD SOIL CONSERVATION DISTRICT  
 THIS PLAN IS APPROVED FOR SOIL EROSION & SEDIMENT CONTROL BY HOWARD SOIL CONSERVATION DISTRICT

*Stephen J. ...* 7/8/84  
 APPROVED: H.S.C.D. DATE

DEPARTMENT OF PUBLIC WORKS  
 HOWARD COUNTY, MARYLAND

*Robert M. ...* 7-9-84  
 CHIEF, BUREAU OF UTILITIES DATE

*Arthur E. ...* 5/9/84  
 CHIEF, LAND DEVELOPMENT DIVISION DATE

HOOKINS ASSOCIATES, INC.  
 101 SHELL BUILDING  
 200 EAST JOHNS ROAD  
 TOWSON, MARYLAND 21284  
 410-280-0000

*Arthur E. ...* 5/9/84

DES: DWB			
DRN: DWB			
CHK: AL	M.S. 2	DELETE VALVE STA. 7+67	1/8/85
DATE:	EJM	AS PER REQUEST BY BUREAU OF ENGINEERING	10/18/84
BY:	NO.	REVISION	DATE

WATER AND SEWER  
 PLAN AND PROFILE

600' SCALE MAP NO. 36 BLOCK NO. 18

COLUMBIA BUSINESS CENTER,  
 PARCELS U-1, U-2, U-3, U-4 AND U-5  
 DOBBIN ROAD COMMERCIAL CENTER  
 SECTION 1, AREA 1  
 HOWARD CO, MD ELECT. DIST. G  
 CONTRACT 24-1236D

SCALE AS SHOWN  
 SHEET 1 OF 2

AS BUILT January 24, 1985



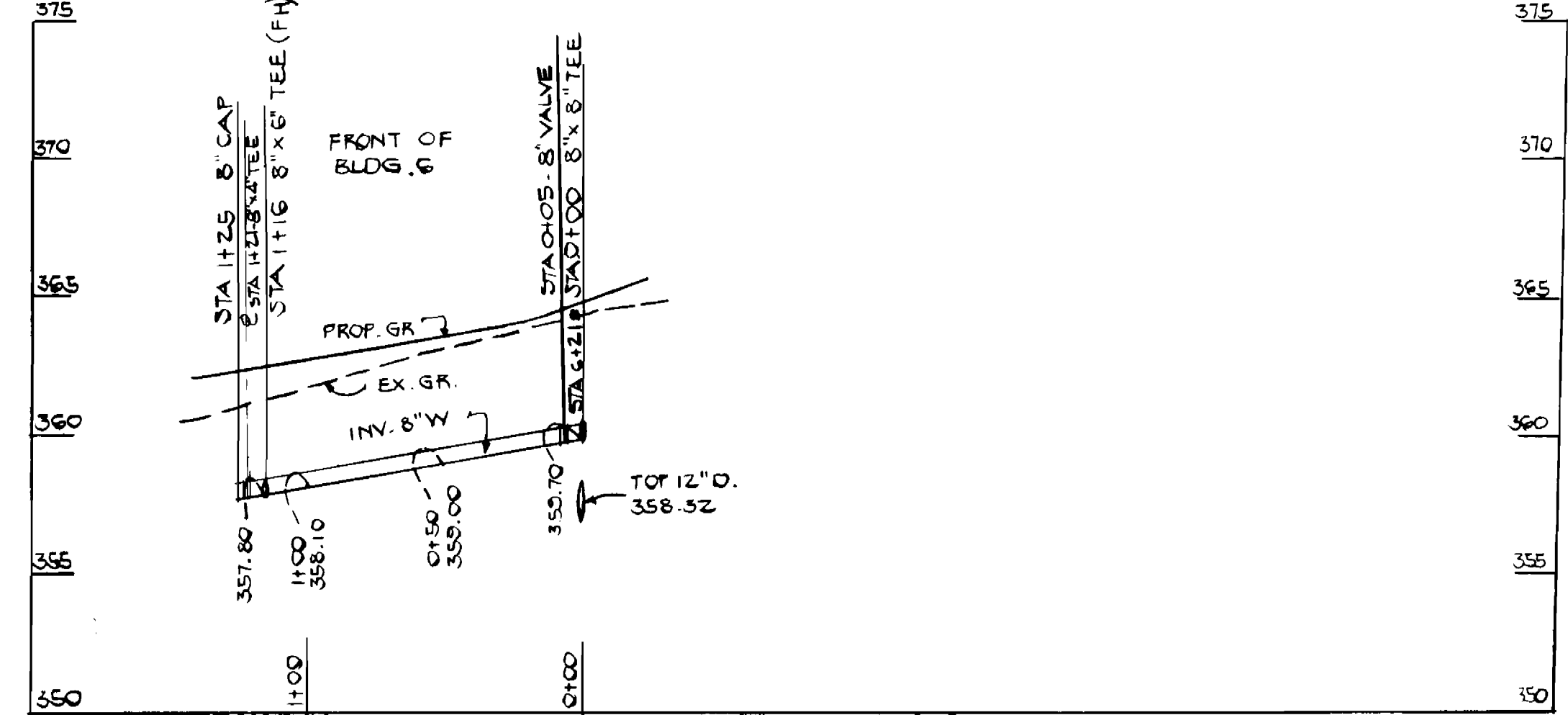
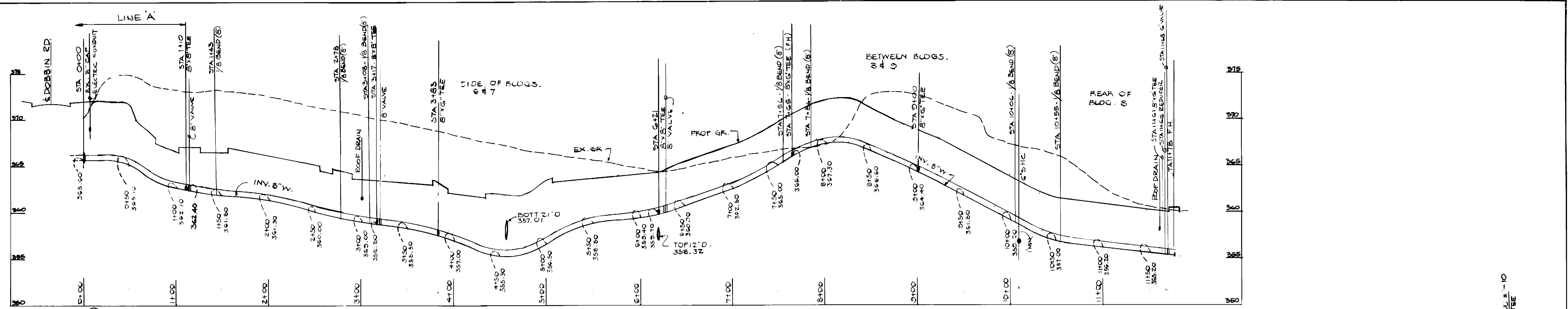

LINE C  
 PROFILES  
 SCALE: VERT. 1"=5'  
 HORZ. 1"=50'

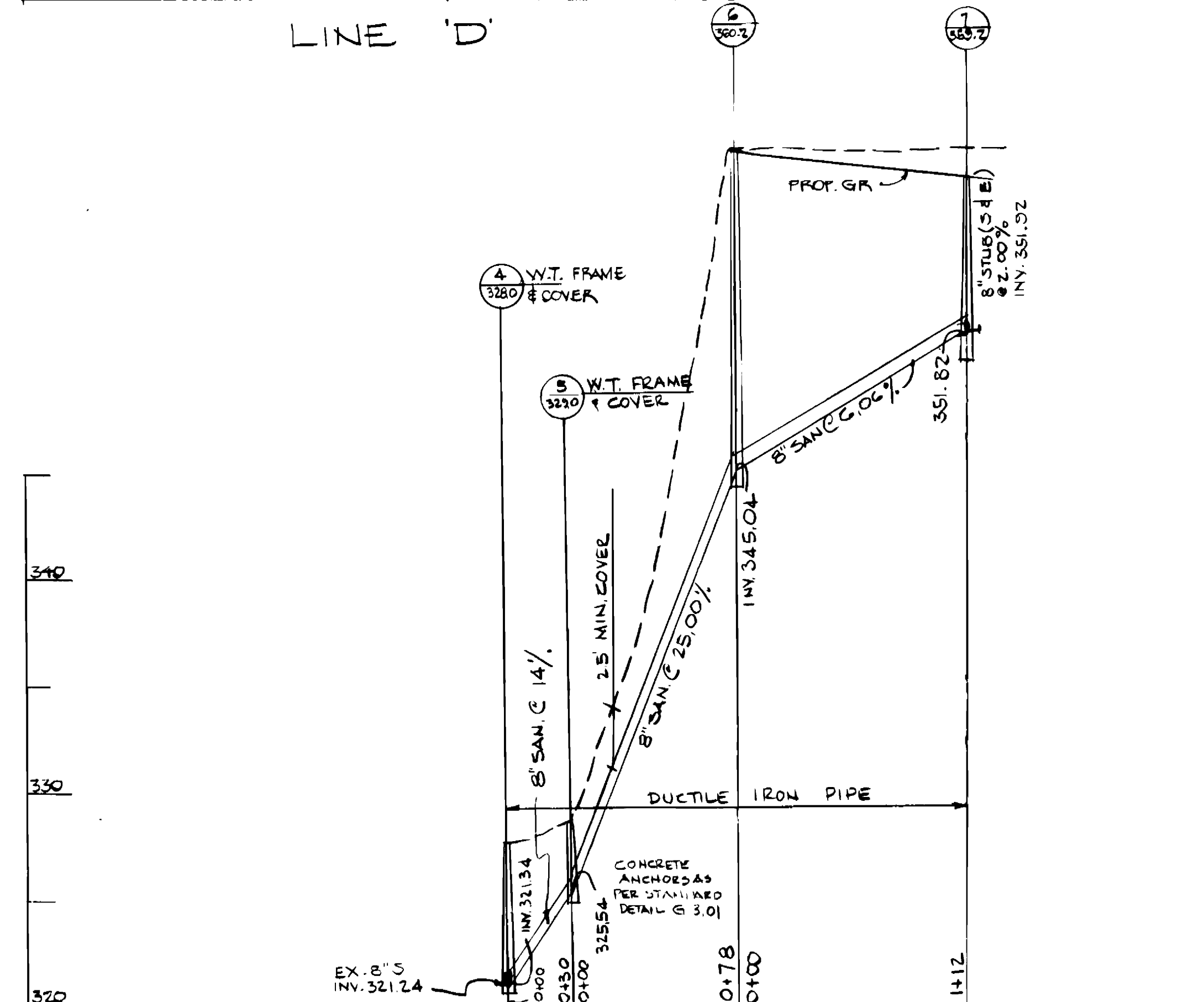
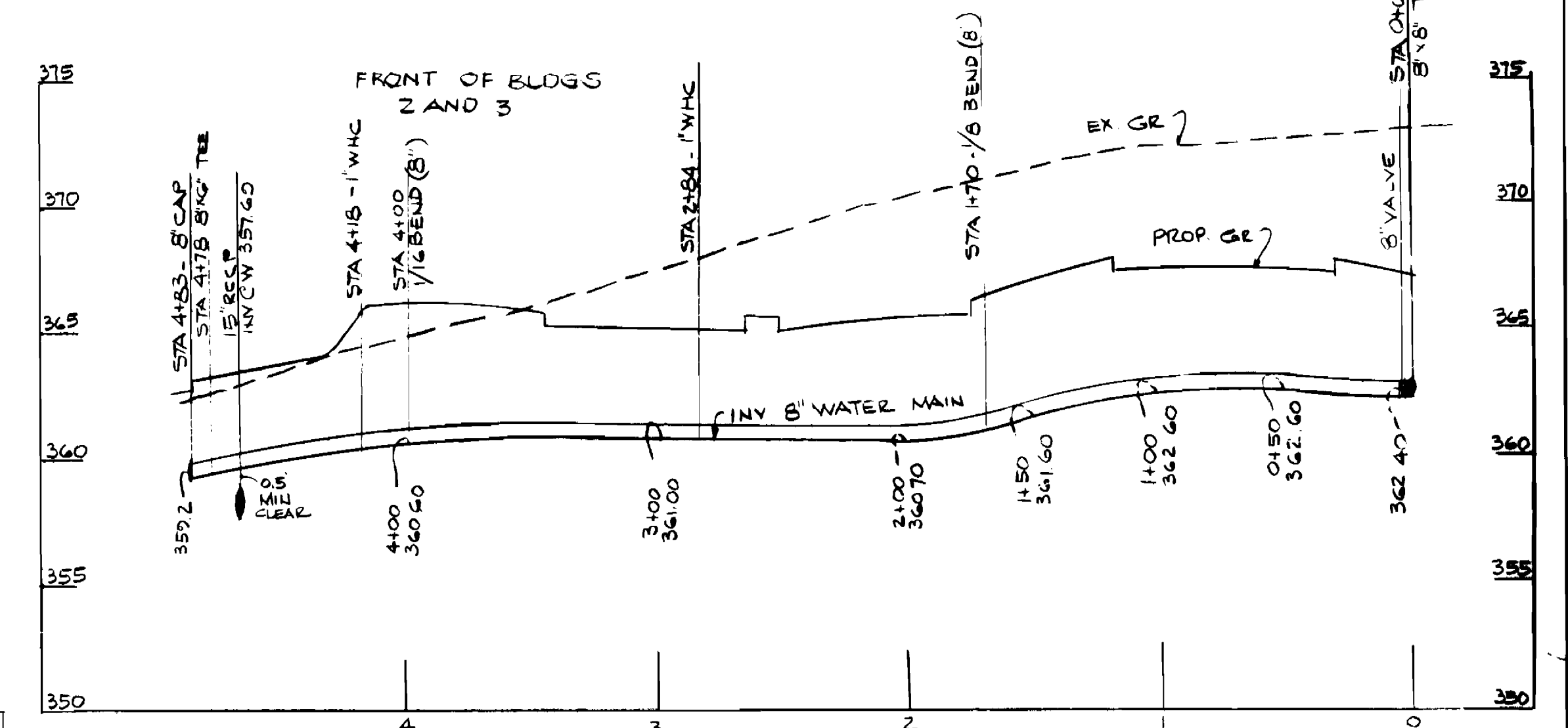

NOTE: SET M 1, 2 & 4  
 1'-0" ABOVE EX. GR. PER  
 STD. DET. G. 5.41

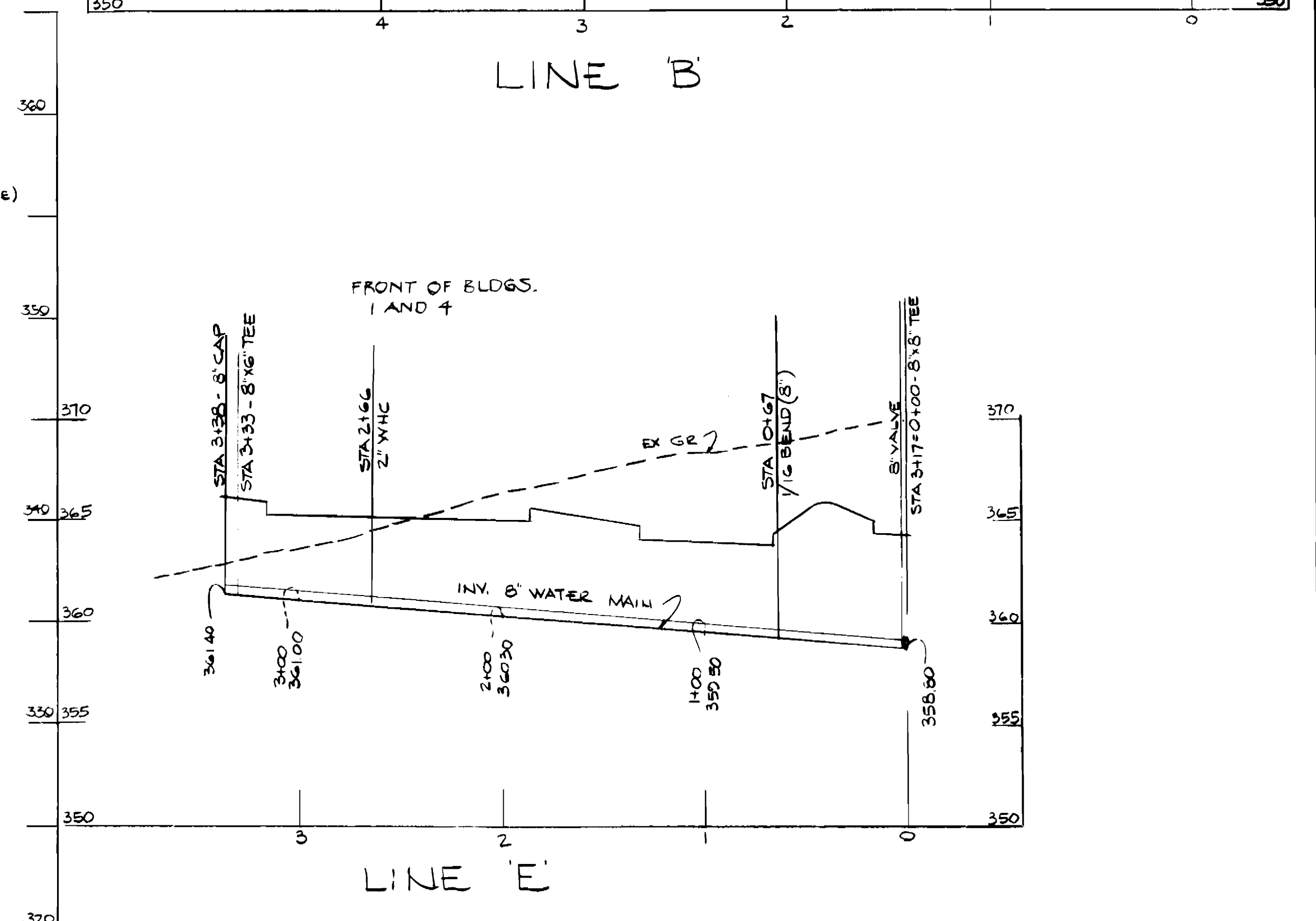
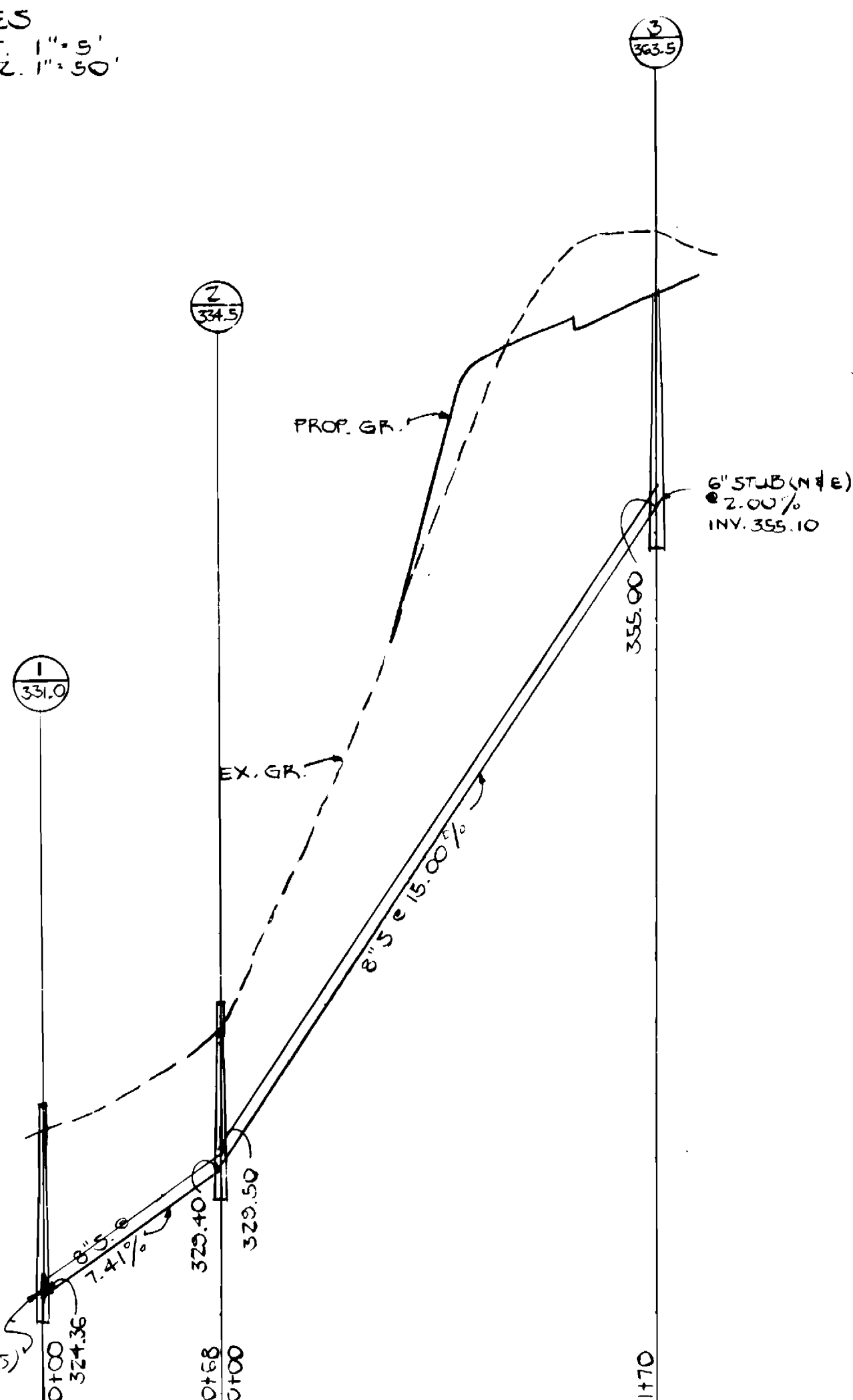

DEPARTMENT OF PUBLIC WORKS  
 HOWARD COUNTY, MARYLAND  
 Director of Public Works: *James N. ...* 8-1-84  
 Chief, Bureau of Engineering: *...*  
 Chief, Bureau of Utilities: *...* 7-2-84  
 Chief, Land Development Division: *...*

HUDKINS ASSOCIATES, INC.  
 101 SHELL BUILDING  
 200 EAST JOYEA ROAD  
 TOWSON, MARYLAND 21204  
 826-9060  
 Arthur Edwards 5/4/84

DES: DWB					
DRN: DWB					
CHK: AL	WB: 2	DELETE VALVE STA. 7+57			1/8/88
DATE:	EJM	AS PER REQUEST BY BUREAU OF ENGINEERING			10/30/84
BY NO.		REVISION			DATE

WATER AND SEWER  
 PLAN AND PROFILE

COLUMBIA BUSINESS CENTER,  
 PARCELS U-1, U-2, U-3, U-4 AND U-5  
 DOBBIN ROAD COMMERCIAL CENTER  
 SECTION 1 AREA 1  
 HOWARD CO., MD. ELECT. DIST. 6  
 CONTRACT 24-1236-D

SCALE  
 AS  
 SHOWN  
 SHEET  
 2 OF 3