

QUANTITIES			
ITEM	BID	AS-BUILT	MATERIAL/SUPPLIER
8" S(OIP) L.F.	360	349	U.S. PIPE & FOUNDRY CO.
8" Sewer L.F.	820	797	JAMES P. LAZZATI CO. INC.
Manholes Ea.	7	8	ATLANTIC PRECAST CONC.
6" SHC L.F.	350	361	JAMES P. LAZZATI CO. INC.

- GENERAL NOTES**
- APPROXIMATE LOCATION OF EXISTING MAINS ARE SHOWN. THE CONTRACTOR SHALL TAKE ALL NECESSARY PRECAUTIONS TO PROTECT EXISTING MAINS AND SERVICES AND MAINTAIN UNINTERRUPTED SUPPLY. ANY DAMAGE INCURRED SHALL BE REPAIRED IMMEDIATELY TO THE SATISFACTION OF THE ENGINEER, AT THE CONTRACTOR'S EXPENSE.
 - ALL HORIZONTAL CONTROLS ARE BASED ON MARYLAND STATE COORDINATES.
 - ALL VERTICAL CONTROLS ARE BASED ON U.S.G.S. DATUM.
 - ALL PIPE ELEVATIONS SHOWN ARE INVERT ELEVATIONS.
 - CLEAR ALL UTILITIES BY A MINIMUM OF 6". CLEAR ALL POLES BY 2'-0" MINIMUM OR TUNNEL AS REQUIRED. ANY COST INCURRED TO THE CONTRACTOR FOR TUNNELING OR BRACING AT POLES SHALL BE INCLUDED IN UNIT PRICES BID FOR CONSTRUCTION OF THE MAIN.
 - FOR DETAILS NOT SHOWN ON THE DRAWINGS USE HOWARD COUNTY STANDARD DETAILS.
 - FOR MATERIALS AND CONSTRUCTION METHODS USE HOWARD COUNTY STANDARD SPECIFICATIONS.
 - CONTRACTOR SHALL LOCATE EXISTING UTILITIES A MINIMUM OF TWO (2) WEEKS IN ADVANCE OF CONSTRUCTION OPERATIONS IN THE VICINITY OF PROPOSED UTILITIES AT HIS OWN EXPENSE.
 - CONTRACTOR SHALL NOTIFY THE FOLLOWING UTILITIES OR AGENCIES AT LEAST FIVE (5) WORKING DAYS BEFORE STARTING WORK SHOWN ON THESE PLANS:
 - STATE HIGHWAY ADMINISTRATION - 531-5533
 - BALTIMORE GAS & ELECTRIC COMPANY - UNDERGROUND ELECTRIC DISTRIBUTION CUSTOMER SERVICE - 685-0123.
 - BALTIMORE GAS & ELECTRIC COMPANY - UNDERGROUND GAS DISTRIBUTION CUSTOMER SERVICE - 685-0123.

CONSTRUCTION SEQUENCE
SEDIMENT CONTROL PROCEDURES

- OBTAIN SEDIMENT CONTROL PERMIT (ARTICLE 15.05-3).
- OBTAIN WATER RESOURCES ADMINISTRATION PERMIT (ARTICLE 40.25).
- CLEAR, GRUB AND STRIP AS REQUIRED FOR SEWER CONSTRUCTION -- PROTECT STREAMS FROM EROSION OF STORED TOPS 1L.
- CONSTRUCT DIKE AND SILT FENCE STRUCTURES IMMEDIATELY AFTER STRIPPING.
- CONSTRUCT SEWER PIPE LINES.
- RESTORE EROSION CONTROL STRUCTURES DISTURBED BY SEWER CONSTRUCTION.
- STABILIZE DISTURBED AREAS AS CONSTRUCTION PROGRESSES WITH TEMPORARY SEEDING AND MULCHING (OR PERMANENT RESTORATION).
- COMPLETE PERMANENT RESTORATION.
- REMOVE SEDIMENT STRUCTURES WHEN DIRECTED.

- "MISS UTILITY" - 1 - 559-0100
CHESAPEAKE & POTOMAC (C&P) TELEPHONE COMPANY - 595-3648
AMERICAN TELEPHONE AND TELEGRAPH - CABLE LOCATION DIVISION - 1-263-3805
COLONIAL PIPELINE COMPANY - 781-4641
BUREAU OF UTILITIES HOWARD COUNTY - 992-2366.
- TREES ARE TO BE PROTECTED FROM DAMAGE TO MAXIMUM EXTENT. TREES LOCATED WITHIN THE CONSTRUCTION STRIP ARE NOT TO BE REMOVED OR DAMAGED BY THE CONTRACTOR.
 - CONTRACTOR SHALL REMOVE TREES, STUMPS AND ROOTS ALONG LINE OF EXCAVATION AS DIRECTED BY THE ENGINEER. PAYMENT FOR SUCH REMOVAL SHALL BE INCLUDED IN THE UNIT PRICE BID FOR CONSTRUCTION OF THE MAIN.
 - PLACE REGULATION "MEN WORKING" AND WARNING SIGNS AS REQUIRED TO COMPLY WITH MARYLAND STATE HIGHWAY ADMINISTRATION MANUAL OF TRAFFIC CONTROL FOR HIGHWAY CONSTRUCTION AND MAINTENANCE OPERATIONS.
 - ALL WATER MAINS SHALL BE D.I.P. UNLESS OTHERWISE NOTED.
 - TOP OF ALL WATER MAINS SHALL HAVE A MINIMUM OF 3-1/2' COVER UNLESS OTHERWISE NOTED.
 - VALVES ADJACENT TO TEES SHALL BE STRAPPED TO TEES.
 - BLOCK ALL FITTINGS WITH CONCRETE.
 - BURY LINE ELEVATIONS ON FIRE HYDRANTS SHALL BE SET TO THE ELEVATIONS SHOWN ON THE DRAWINGS. ALL FIRE HYDRANTS SHALL BE STRAPPED AND BUTTRESSED WITH CONCRETE IN ACCORDANCE WITH STANDARD DETAILS. SOIL AROUND THE FIRE HYDRANT TO BE COMPACTED IN ACCORDANCE WITH SECTIONS 1003 AND 1008 OF THE STANDARD SPECIFICATIONS.
 - ALL WATER HOUSE CONNECTIONS SHALL BE FOR AN INSIDE METER SETTING.
 - THE CONTRACTOR SHALL NOT OPERATE ANY WATER MAIN VALVES ON THE EXISTING SYSTEM.
 - ALL SEWER MAINS SHALL BE C.S.P.X., R.C.S.P., V.C.P.X., A.C.P. CLASS 2400 OR PVC UNLESS OTHERWISE NOTED.
 - THE CONTRACTOR SHALL PROVIDE A JOINT IN ALL SEWER MAINS WITHIN 2'-0" OF EXTERIOR MANHOLE WALL.
 - ALL MANHOLES SHALL BE 4'-0" INSIDE DIAMETER, UNLESS OTHERWISE NOTED.
 - MANHOLES SHOWN WITH 12" AND 16" WALLS ARE FOR BRICK MANHOLES ONLY.
 - MANHOLES DESIGNATED M.T. IN PLAN AND PROFILE SHALL HAVE WATERTIGHT FRAME AND COVERS, STANDARD DETAIL G5.52.
 - ALL MANHOLE FRAME AND COVERS SHALL BE SET 0.5' ABOVE EXISTING GRADE WHERE SHOWN IN PROFILE. SEE DETAIL G 5.41.
 - ORIGINAL GROUND OVER SEWER WAS TAKEN FROM AERIAL PHOTOGRAPHY PREPARED BY MAPS AND INC., AND VERIFIED BY FIELD SURVEY IN AUGUST, 1983.

CONTRACT NO. 30-1209-D
VILLAGE OF HICKORY RIDGE
HOWARD COUNTY, MARYLAND
DEPARTMENT OF PUBLIC WORKS

REVIEWED FOR HOWARD SOIL CONSERVATION DISTRICT AND MEETS TECHNICAL REQUIREMENT

[Signature] 4-12-84
SIGNATURE DATE
U.S. SOIL CONSERVATION SERVICE

This Development Plan is approved for Soil Erosion and Sediment Control by the Howard County Conservation District.

APPROVED: *[Signature]* 4-12-84
HOWARD S.E.D. DATE

Sediment Control Measures for this Contract will be implemented in accordance with Article 15 of the Standard Specifications.

DEPARTMENT OF PUBLIC WORKS
HOWARD COUNTY, MARYLAND

[Signature] 4-12-84
DIRECTOR OF PUBLIC WORKS-DATE

[Signature] 4-12-84
CHIEF-BUREAU OF ENGINEERING-DATE

[Signature] 4-12-84
CHIEF-BUREAU OF UTILITIES-DATE

[Signature] 4-12-84
CHIEF-LAND DEVELOPMENT DIVISION-DATE

WHITMAN, REQUARDT AND ASSOCIATES ENGINEERS

2315 ST. PAUL ST.
BALTIMORE, MARYLAND

[Signature]

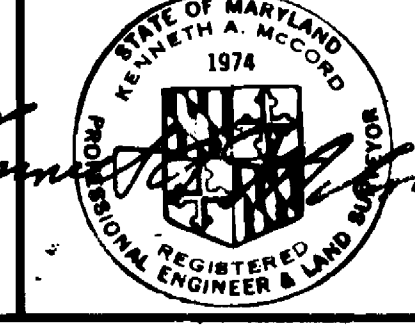

DES: S.J.				
DRN: J.R.K.				
CHK: A.B.N.				
DATE: 4/2/84				

VICINITY MAP AND GENERAL NOTES

600 SCALE MAP NO. 35 BLOCK NO. _____

COLUMBIA
VILLAGE OF HICKORY RIDGE
SECTION 3 AREA 6
ELECTION DISTRICT NO.5
CONTRACT NO.30-1209-D

SCALE: 1"=600'
SHEET 1 OF 2

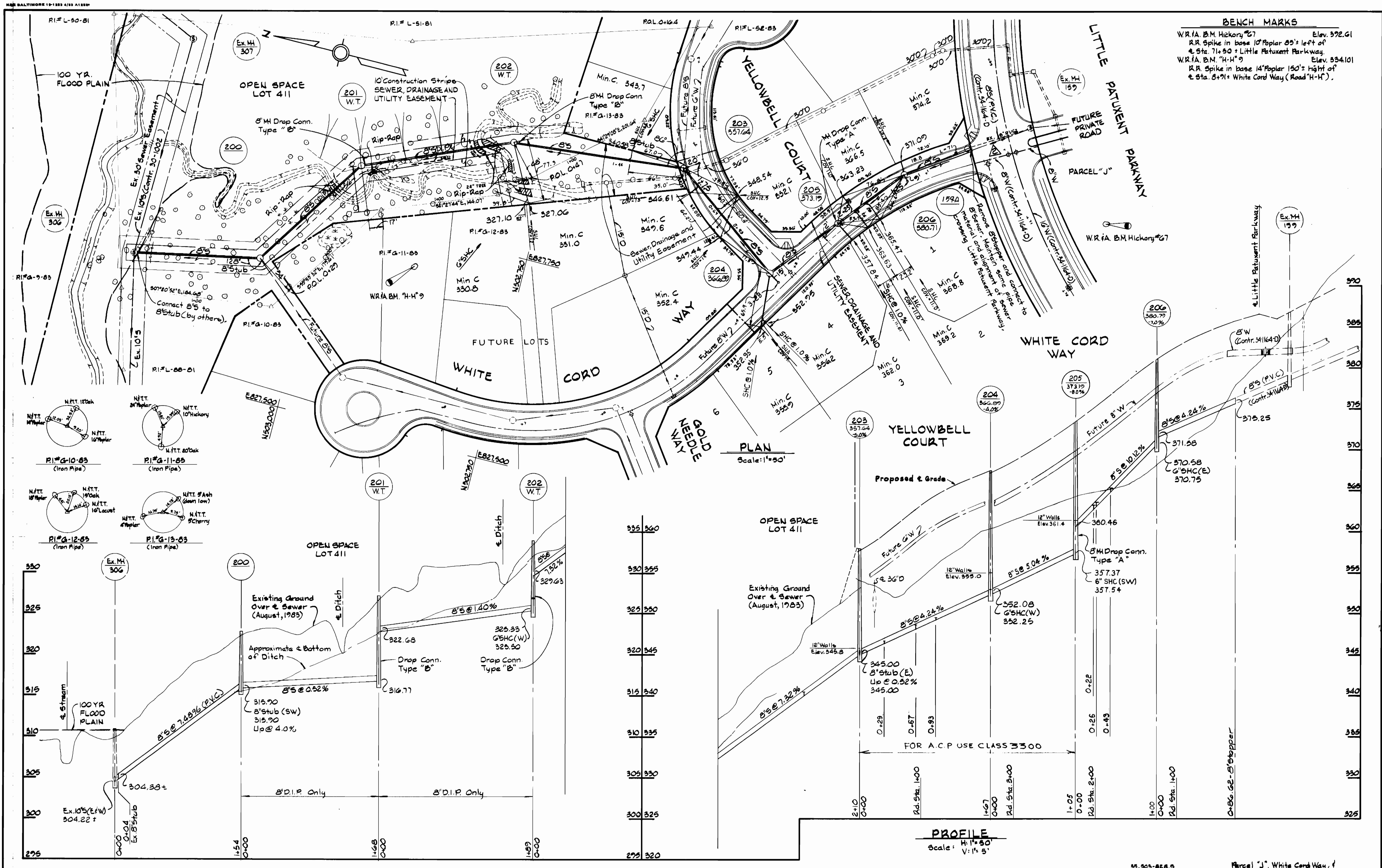

DEPARTMENT OF PUBLIC WORKS HOWARD COUNTY, MARYLAND Director of Public Works - DATE Chief - Bureau of Engineering - DATE Chief - Bureau of Utilities - DATE Chief - Land Development Division - DATE		WHITMAN, REQUARDT AND ASSOCIATES ENGINEERS 2315 ST. PAUL ST. BALTIMORE, MARYLAND		DES: S.J. DRN: J.R.K. CHK: R.B.N. DATE: 4/2/84		PLAN & PROFILE OF SEWER MAINS 600' SCALE MAP NO. 35 BLOCK NO.		COLUMBIA VILLAGE OF HICKORY RIDGE SECTION 3 AREA 6 ELECTION DISTRICT NO. 5 CONTRACT NO. 30-1209-D		SCALE AS SHOWN SHEET 2 OF 2
---	--	---	--	---	--	---	--	---	--	--------------------------------