

**BENCH MARKS**

B.M. #1	ELEV. 422.92
R.R. SPIKE SET IN C+P STATION G+P 014042, 150' WEST OF F.C.C. TRAVERSE STA. 'F.P.-2'	
B.M. #2	ELEV. 428.28
R.R. SPIKE SET IN C+P STATION G+P 021150, 8' SOUTHEAST OF F.C.C. TRAVERSE STA. 'F.P.-2'	

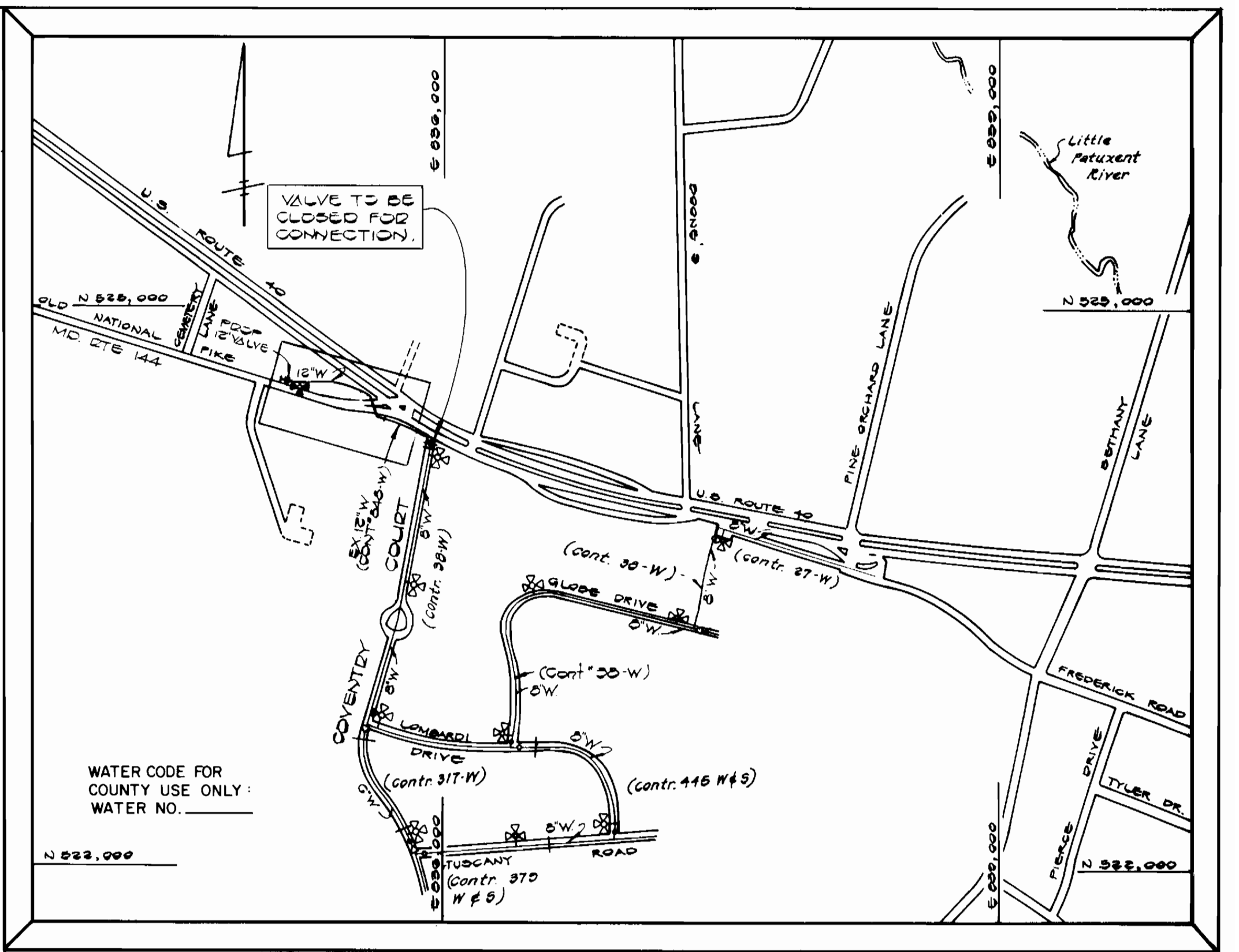

TYPE OF BUILDING: RESIDENTIAL  
 NUMBER OF PARCELS: 2  
 NO. OF WATER HOUSE CONNECTIONS: 5  
 DRAINAGE AREA: LITTLE PATUXENT

**VICINITY MAP**  
 SCALE: 1" = 600'

SEDIMENT CONTROL MEASURES FOR THIS CONTRACT WILL BE IMPLEMENTED IN ACCORDANCE WITH ARTICLE 16 OF THESE SPECIFICATIONS. THIS PLAN IS APPROVED FOR EROSION AND SEDIMENT CONTROL BY THE HOWARD SOIL CONSERVATION DISTRICT. APPROVED: [Signature] 12-1-83 HOWARD SOIL CONSERVATION DISTRICT DATE

REVIEWED FOR HOWARD SOIL CONSERVATION DISTRICT AND MEETS TECHNICAL REQUIREMENTS APPROVED: [Signature] 12-1-83 HOWARD SOIL CONSERVATION DISTRICT DATE

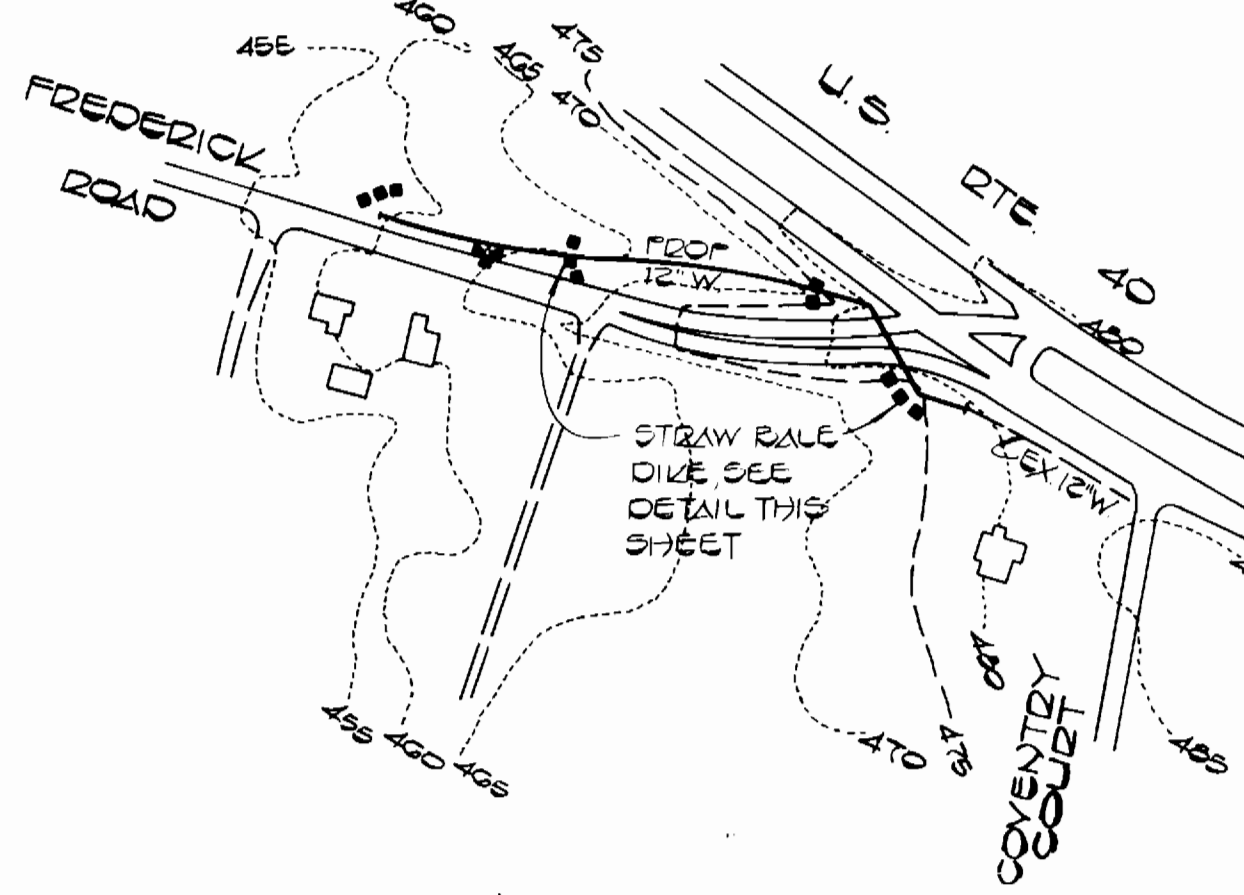

**DRAINAGE AREA MAP**  
 SCALE: 1" = 200'

**GENERAL NOTES**

- APPROXIMATE LOCATION OF EXISTING MAINS ARE SHOWN. THE CONTRACTOR SHALL TAKE ALL NECESSARY PRECAUTIONS TO PROTECT EXISTING MAINS AND SERVICES AND MAINTAIN UNINTERRUPTED SUPPLY. ANY DAMAGE INCURRED SHALL BE REPAIRED IMMEDIATELY TO THE SATISFACTION OF THE ENGINEER, AT THE CONTRACTOR'S EXPENSE.
- ALL HORIZONTAL CONTROLS ARE BASED ON MARYLAND STATE COORDINATES.
- ALL VERTICAL CONTROLS ARE BASED ON U.S. S. DATUM.
- ALL PIPE ELEVATIONS SHOWN ARE INVERT ELEVATIONS.
- CLEAR ALL UTILITIES BY A MINIMUM OF 6". CLEAR ALL POLES BY 2'-0" MINIMUM OR TUNNEL AS REQUIRED. ANY COST INCURRED TO THE CONTRACTOR FOR TUNNELING OR BRACING AT POLES SHALL BE INCLUDED IN UNIT PRICES BID FOR THE CONSTRUCTION OF THE MAIN.
- FOR DETAILS NOT SHOWN ON THE DRAWINGS USE HOWARD COUNTY STANDARD DETAILS.
- FOR MATERIALS AND CONSTRUCTION METHODS USE HOWARD COUNTY STANDARD SPECIFICATION.
- CONTRACTOR SHALL LOCATE EXISTING UTILITIES A MINIMUM OF TWO (2) WEEKS IN ADVANCE OF CONSTRUCTION OPERATIONS IN THE VICINITY OF PROPOSED UTILITIES AT HIS OWN EXPENSE.
- CONTRACTOR SHALL NOTIFY FOLLOWING UTILITIES OR AGENCIES AT LEAST FIVE (5) WORKING DAYS BEFORE STARTING WORK SHOWN ON THESE PLANS:
  - STATE HIGHWAY ADMINISTRATION - (531-5333)
  - BALTIMORE GAS AND ELECTRIC CO. - UNDERGROUND ELECTRIC DISTRIBUTION CUSTOMER SERVICE - (685-0123)
  - BALTIMORE GAS AND ELECTRIC CO. - UNDERGROUND GAS DISTRIBUTION CUSTOMER SERVICE - (685-0123)
  - ENGINEERING DAMAGE CONTROL - (234-5621)
  - MISS UTILITY - (1-559-0100)
  - CHESAPEAKE & POTOMAC TELEPHONE COMPANY - (725-9976)
  - BUREAU OF UTILITIES, HOWARD COUNTY - (992-2366)
- TREE ARE TO BE PROTECTED FROM DAMAGE TO MAXIMUM EXTENT. TREES LOCATED WITHIN THE CONSTRUCTION STRIP ARE NOT TO BE REMOVED OR DAMAGED BY THE CONTRACTOR.
- CONTRACTOR SHALL REMOVE TREES, STUMPS AND ROOTS ALONG LINE OF EXCAVATION AS DIRECTED BY THE ENGINEER. PAYMENT FOR SUCH REMOVAL SHALL BE INCLUDED IN THE UNIT PRICE BID FOR THE CONSTRUCTION OF THE MAIN.
- PLACE REGULATION "MEN WORKING" AND WARNING SIGNS AS REQUIRED TO COMPLY WITH MARYLAND STATE HIGHWAY ADMINISTRATION MANUAL OF TRAFFIC CONTROL FOR HIGHWAY CONSTRUCTION AND MAINTENANCE OPERATIONS.
- ALL WATER MAINS TO BE D.I.P. UNLESS OTHERWISE NOTED.
- VALVES ADJACENT TO TEES SHALL BE STRAPPED TO TEES.
- BLOCK ALL FITTINGS WITH CONCRETE.
- BURY LINE ELEVATIONS ON THE FIRE HYDRANTS SHALL BE SET TO THE ELEVATIONS SHOWN ON THE DRAWINGS. ALL FIRE HYDRANTS SHALL BE STRAPPED AND BUTTRESSED WITH CONCRETE IN ACCORDANCE WITH STANDARD DETAILS. SOIL AROUND THE FIRE HYDRANT IS TO BE COMPACTED IN ACCORDANCE WITH SECTION 37.01 AND 37.05 OF THE STANDARD SPECIFICATIONS.
- ALL WATER HOUSE CONNECTIONS SHALL BE FOR INSIDE METER SETTING.
- WATER MAIN AND WATER HOUSE CONNECTION LINES MUST BE PLACED SO AS TO HAVE AT LEAST ONE (1) FOOT SEPARATION FROM THE SEWER MAIN OR SEWER HOUSE CONNECTION AS THEY PASS ABOUT IT.
- TOP OF ALL WATER MAINS TO HAVE A MINIMUM OF 3'-6" COVER UNLESS OTHERWISE NOTED.
- THE CONTRACTOR SHALL NOT OPERATE ANY WATER MAIN VALVES ON THE EXISTING SYSTEM.

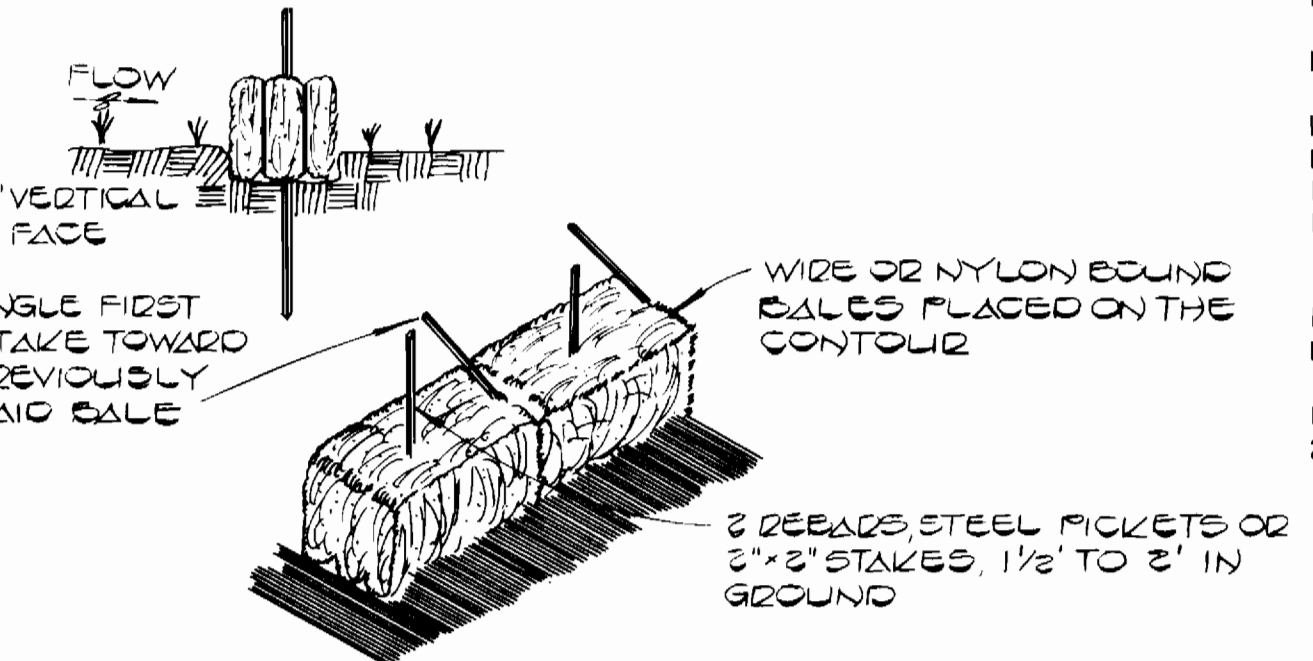

**STRAW BALE DIKE**  
 NO SCALE

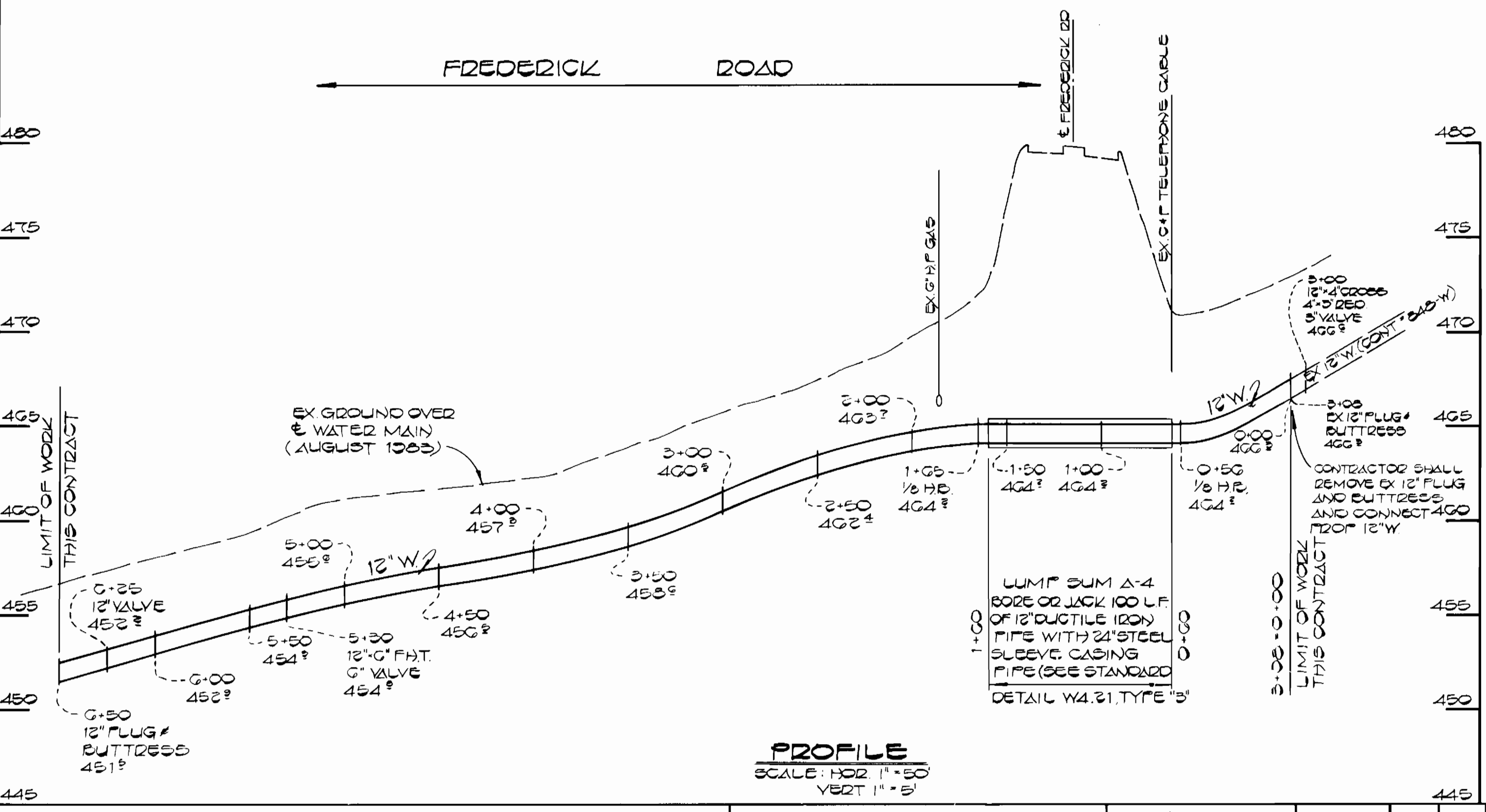

**PROFILE**  
 SCALE: HOR. 1" = 50'  
 VERT. 1" = 5'

**QUANTITIES**

ITEM	EST'D	AS-BUILT	SUPPLIER
12" WATER	550 LF	550 LF D.I.P.	A&P supply
6" WATER	12 LF	12 LF D.I.P.	"
1" W/C	140 LF	140 LF	"
3/4" W/C	10 LF	10 LF	"
60# OR JACK 12" W INCLUDING 24" STEEL ELEVATOR	100 LF	100 LF	C.C. & T. CONSTRUCTION
12" VALVE	1 EA.	1 - MUELLER	A&P supply
FIRE HYD.	1 EA.	1 - MUELLER	A&P supply

**DEPARTMENT OF PUBLIC WORKS**  
 HOWARD COUNTY, MARYLAND

DIRECTOR OF PUBLIC WORKS: [Signature] DATE: 1-13-84  
 CHIEF, BUREAU OF UTILITIES: [Signature] DATE: 1-13-84

CHIEF, BUREAU OF ENGINEERING: [Signature] DATE: 1-13-84  
 CHIEF, UTILITY DIVISION: [Signature] DATE: 1-13-84

**FISHER, COLLINS AND CARTER, INC.**  
 CONSULTING ENGINEERS AND LAND SURVEYORS

8388 COURT AVENUE  
 ELLICOTT CITY, MARYLAND 21043

TERRELL A. FISHER DATE: 8-26-83

DES: D.B.S.			
DRN: D.B.S.			
CHK: T.A.F.			
DATE: 8-26-83	BY: NO.	REVISION	DATE

**PLAN, PROFILE AND DETAILS**  
**WATER MAINS**

**FREDERICK ROAD WATER MAIN**  
 CAPITAL PROJECT NO. W-8684  
 CONTRACT NO. 44-1161  
 SECOND ELECTION DISTRICT  
 HOWARD COUNTY, MARYLAND

SCALE: AS SHOWN  
 SHEET 1 OF 1