

BENCH MARKS

B.M.#1	ELEV. 227.99
7' x 8' x 25" STONE FOUND 17' NORTHEAST OF STA. 58+2'	
B.M.#2	ELEV. 245.10
22" SPIKE IN C&P 21 G&E 014140	
30' NORTHEAST OF PI STA. 58+2A'	

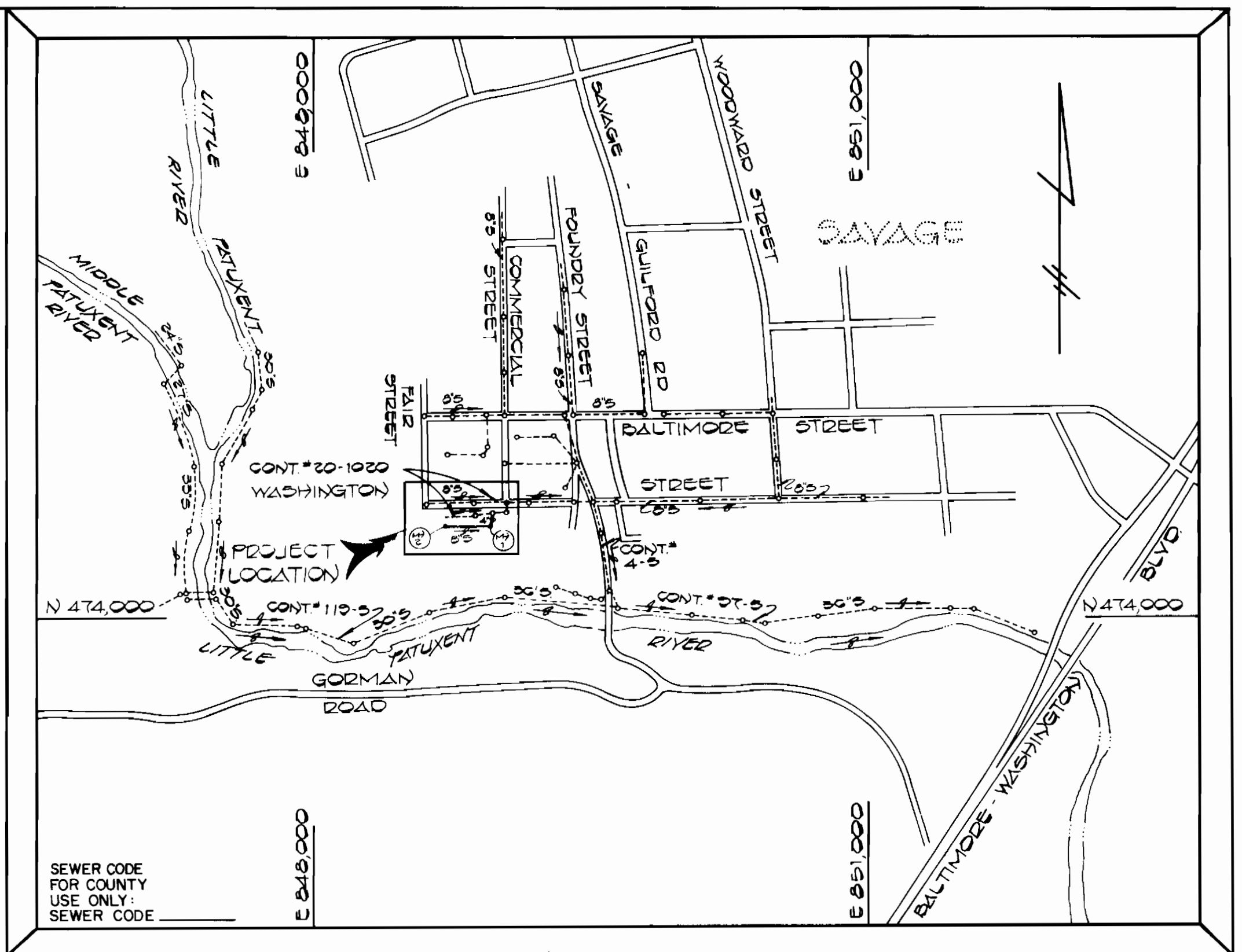

TYPE OF BUILDINGS:	RESIDENTIAL
NUMBER OF PARCELS:	5
NUMBER OF SEWER HOUSE CONNS.:	7
DRAINAGE AREA:	LITTLE PATUXENT

GENERAL NOTES

- APPROXIMATE LOCATION OF EXISTING MAINS ARE SHOWN. THE CONTRACTOR SHALL TAKE ALL NECESSARY PRECAUTIONS TO PROTECT EXISTING MAINS AND SERVICES AND MAINTAIN UNINTERRUPTED SUPPLY. ANY DAMAGE INCURRED SHALL BE REPAIRED IMMEDIATELY TO THE SATISFACTION OF THE ENGINEER AT THE CONTRACTOR'S EXPENSE.
- ALL HORIZONTAL CONTROLS ARE BASED ON MARYLAND STATE COORDINATES.
- ALL VERTICAL CONTROLS ARE BASED ON U.S.G.S. DATUM.
- ALL PIPE ELEVATIONS SHOWN ARE INVERT ELEVATIONS.
- CLEAR ALL UTILITIES BY A MINIMUM OF 6" CLEAR ALL POLES BY 2'-0" MINIMUM OR TUNNEL AS REQUIRED. ANY COST INCURRED TO THE CONTRACTOR FOR TUNNELING OR BRACING AT THE POLE SHALL BE INCLUDED IN UNIT PRICES BID FOR CONSTRUCTION OF THE MAIN.
- FOR DETAILS NOT SHOWN ON THE DRAWINGS USE HOWARD COUNTY STANDARDS DETAILS.
- FOR MATERIAL AND CONSTRUCTION METHODS USE HOWARD COUNTY STANDARD SPECIFICATIONS.
- CONTRACTOR SHALL LOCATE EXISTING UTILITIES A MINIMUM OF (2) WEEKS IN ADVANCE OF CONSTRUCTION OPERATIONS IN THE VICINITY OF PROPOSED UTILITIES AT HIS OWN EXPENSE.
- CONTRACTOR SHALL NOTIFY THE FOLLOWING UTILITIES OR AGENCIES AT LEAST FIVE (5) WORKING DAYS BEFORE STARTING WORK SHOWN ON THESE PLANS:
 - BALTIMORE GAS & ELECTRIC COMPANY - UNDERGROUND GAS DISTRIBUTION CUSTOMER SERVICE: 685-0123
 - BALTIMORE GAS & ELECTRIC COMPANY - UNDERGROUND ELECTRIC DISTRIBUTION CUSTOMER SERVICE: 685-0123
 - "MISS UTILITY": 1-559-0100
 - CHESAPEAKE & POTOMAC TELEPHONE COMPANY: 725-9976
 - BUREAU OF UTILITIES - HOWARD COUNTY: 992-2366
- TREES ARE TO BE PROTECTED FROM DAMAGE TO MAXIMUM EXTENT. TREES LOCATED WITHIN THE CONSTRUCTION STRIP ARE NOT TO BE REMOVED OR DAMAGED BY THE CONTRACTOR.
- CONTRACTOR SHALL REMOVE TREES, STUMPS AND ROOTS ALONG LINE OF EXCAVATION AS DIRECTED BY THE ENGINEER. PAYMENT FOR SUCH REMOVAL SHALL BE INCLUDED IN THE UNIT PRICE BID FOR CONSTRUCTION OF THE MAIN.
- PLACE REGULATION "MEN WORKING" AND WARNING SIGNS AS REQUIRED TO COMPLY WITH MARYLAND STATE HIGHWAYS ADMINISTRATION MANUAL OF TRAFFIC CONTROL FOR HIGHWAY CONSTRUCTION AND MAINTENANCE OPERATIONS.
- ALL SEWER MAINS SHALL BE HDPE, C.S.P., R.C.S.P., P.V.C., V.C.P.X. OR A.C.P. CLASS 2400 UNLESS OTHERWISE NOTED.
- CONTRACTOR SHALL PROVIDE A JOINT IN ALL SEWER MAINS WITHIN 2'-0" OF EXTERIOR MANHOLE WALLS.
- ALL MANHOLES SHALL BE 4'-0" INSIDE DIAMETER, UNLESS OTHERWISE NOTED.
- MANHOLES SHOWN WITH 12" AND 16" WALLS ARE BRICK MANHOLES ONLY.

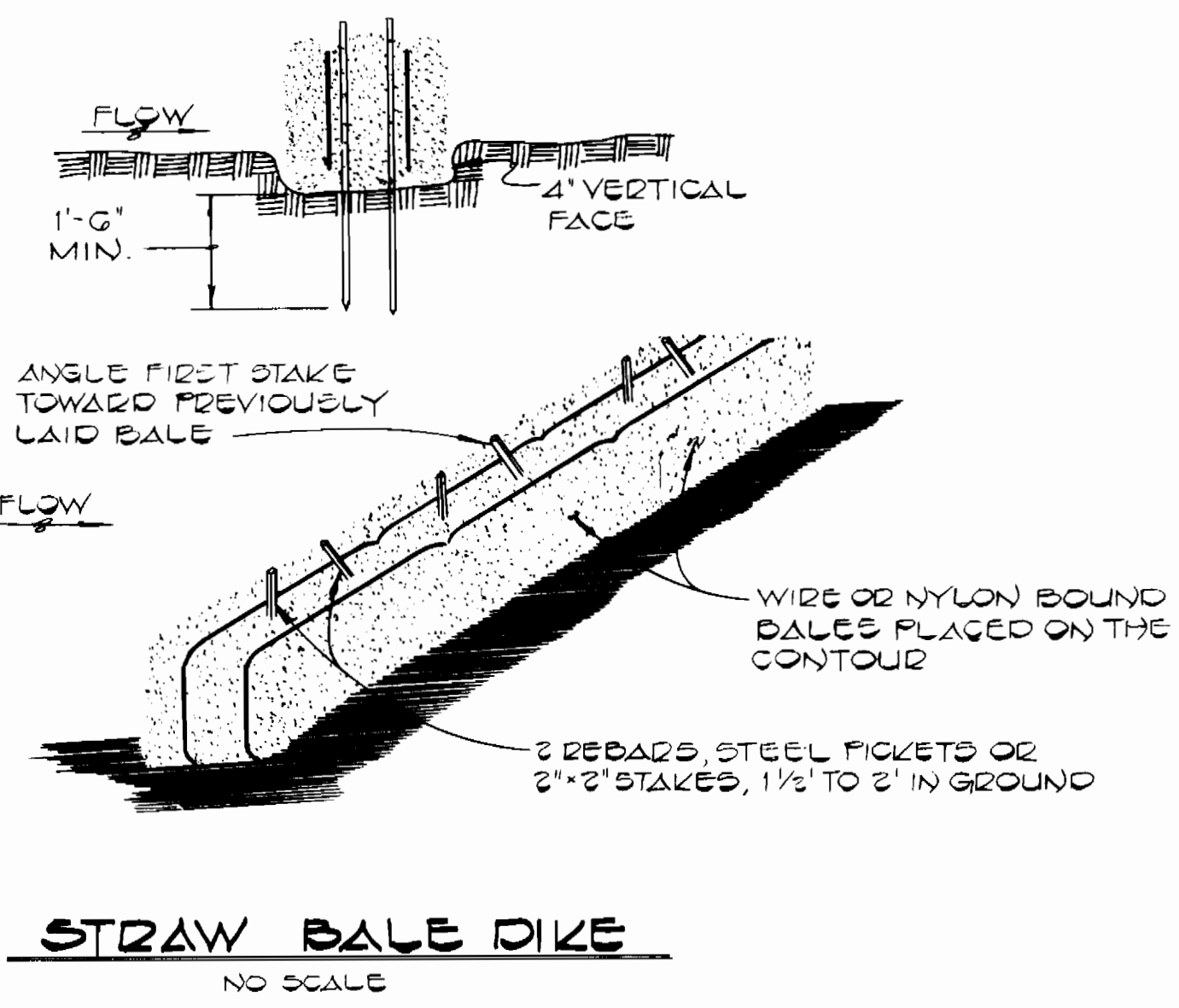
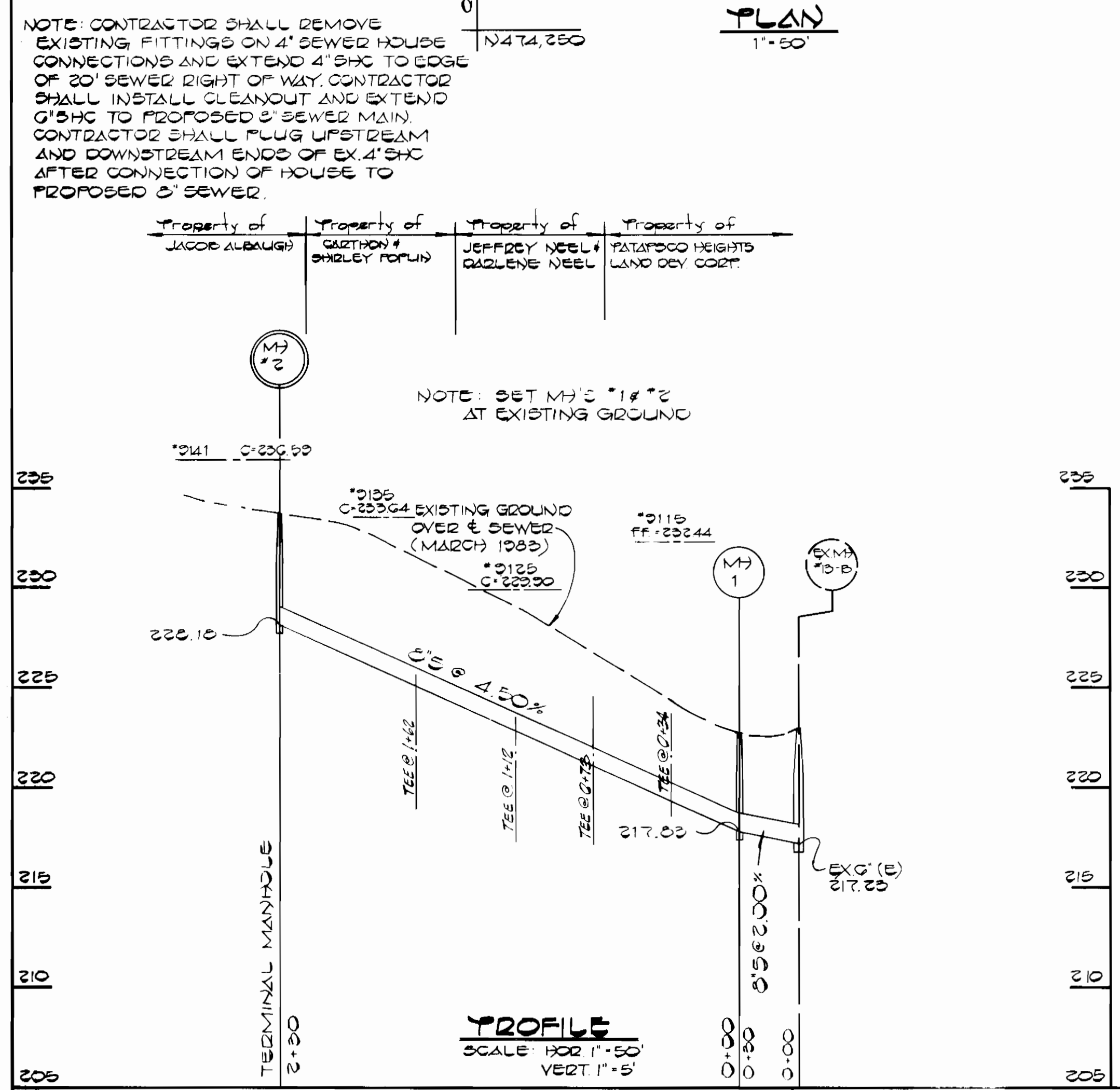

QUANTITIES

ITEM	EST'D	AS BUILT	SUPPLIER
2" SEWER	200 LF	220 LF PVC	A&P Supply
4" SEWER	50 LF	50 LF PVC	"
MANHOLES	2 EA	2	Atlantic Proseal
4" SEWER	60 LF	60 LF PVC	A&P Supply

DEPARTMENT OF PUBLIC WORKS
HOWARD COUNTY, MARYLAND

George F. Neumeier 1-6-84
DIRECTOR OF PUBLIC WORKS DATE

Robert M. Bevinger 1-5-84
CHIEF, BUREAU OF UTILITIES DATE

FISHER, COLLINS, AND CARTER, INC.
CONSULTING ENGINEERS AND LAND SURVEYORS

8388 COURT AVENUE
ELLCOTT CITY, MARYLAND 21043
461-2855

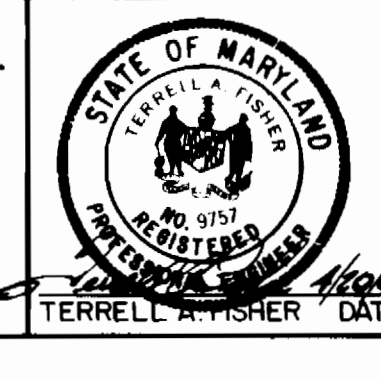

DES: T.A.F.				
DRN: D.B.S.				
CHK: T.A.F.				
M.V. 1	As Built info.			4-3-85
DATE: 4-15-83	BY NO.	REVISION		DATE

PLAN, PROFILE AND DETAILS

SEWER MAIN

WASHINGTON STREET SEWER MAIN

CAPITAL PROJECT NO. S-6112
CONTRACT NO. 30-1120
SIXTH ELECTION DISTRICT
HOWARD COUNTY, MARYLAND

SCALE AS SHOWN
SHEET 1 OF 1