

STRAW BALE DIKE
NO SCALE

REVIEWED FOR HOWARD COUNTY SOIL CONSERVATION DISTRICT AND MEETS TECHNICAL REQUIREMENTS.
James M. Helm 5-12-82
 U.S. SOIL CONSERVATION SERVICE DATE

THIS PLAN IS APPROVED FOR EROSION AND SEDIMENT CONTROL BY THE HOWARD SOIL CONSERVATION DISTRICT.
 APPROVED:
William T. Rame 5-11-82
 HOWARD SOIL CONSERVATION DISTRICT DATE

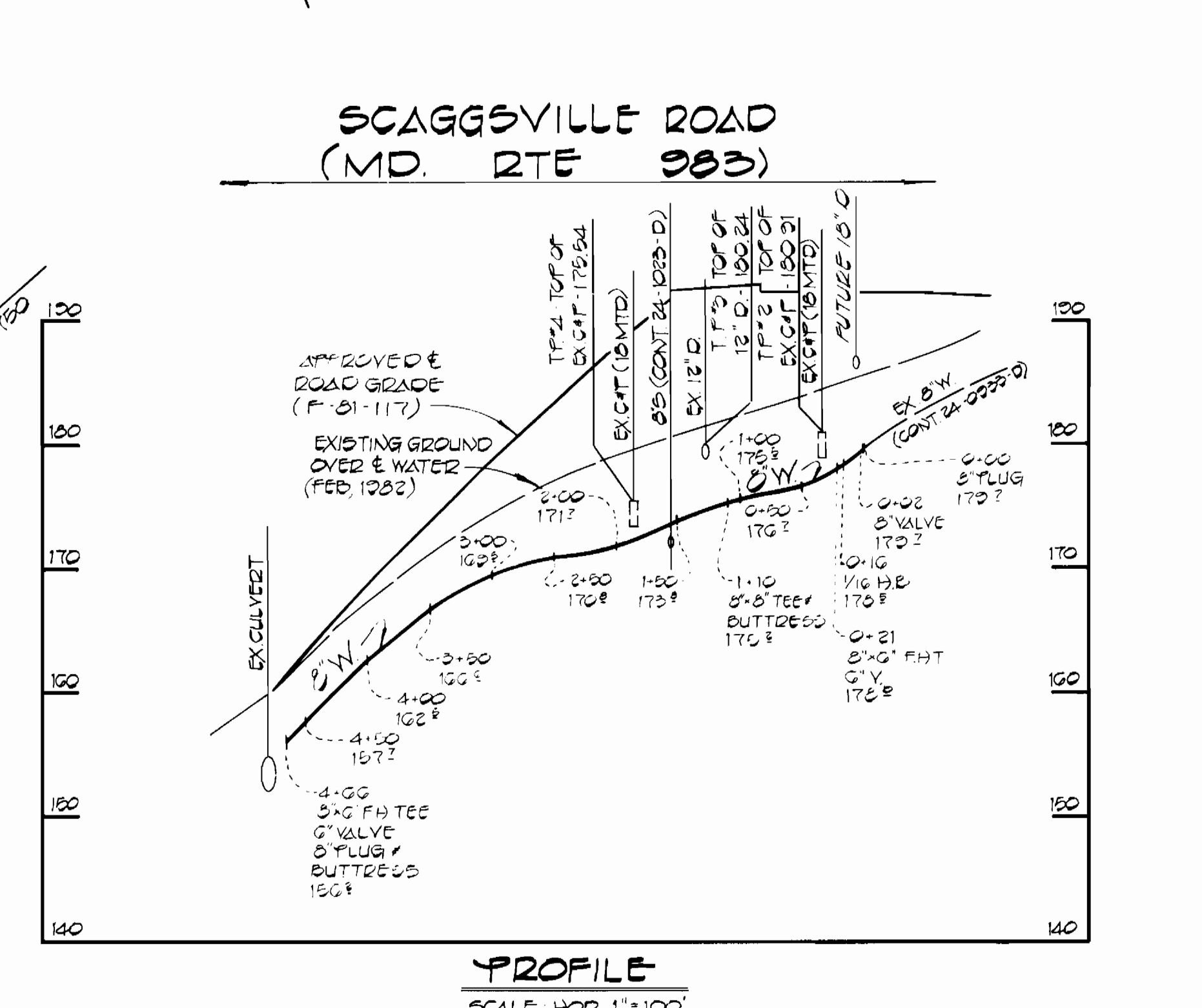

DEPARTMENT OF PUBLIC WORKS
 HOWARD COUNTY MARYLAND

William F. Nunnally 5-16-82
 DIRECTOR OF PUBLIC WORKS DATE

Robert M. Brown 5-6-82
 CHIEF, BUREAU OF UTILITIES DATE

William E. Co. 5/16/82
 CHIEF, BUREAU OF ENGINEERING DATE

Allen J. Brown 5/5/82
 CHIEF, UTILITY DIVISION DATE

FISHER, COLLINS AND CARTER, INC.
 CIVIL ENGINEERS AND LAND SURVEYORS
 8388 COURT AVENUE
 ELLICOTT CITY, MARYLAND 21043

CONTRACT NO. 44-1032
 CAPITAL PROJECT W-8/22

PLAN & PROFILE
WATER MAINS

OLD SCAGGSVILLE ROAD
WATER MAIN EXTENSION
6TH ELECTION DISTRICT
HOWARD COUNTY, MARYLAND

DRAWING NO. 1 OF 1
 SCALE AS SHOWN
 DES: DBS
 DRN: DBS
 CHK: T.A.F.

BENCH MARKS

B.M. #1	ELEV. 185.24
T.K. NAIL SET 10' SOUTHEAST OF EX. M3 GGG (F.C.C. TRAVERSE STA. 'K-G')	
B.M. #2	ELEV. 178.34
T.K. NAIL SET 22' SOUTHWEST OF C47 20 (F.C.C. TRAVERSE STA. 'K-B')	

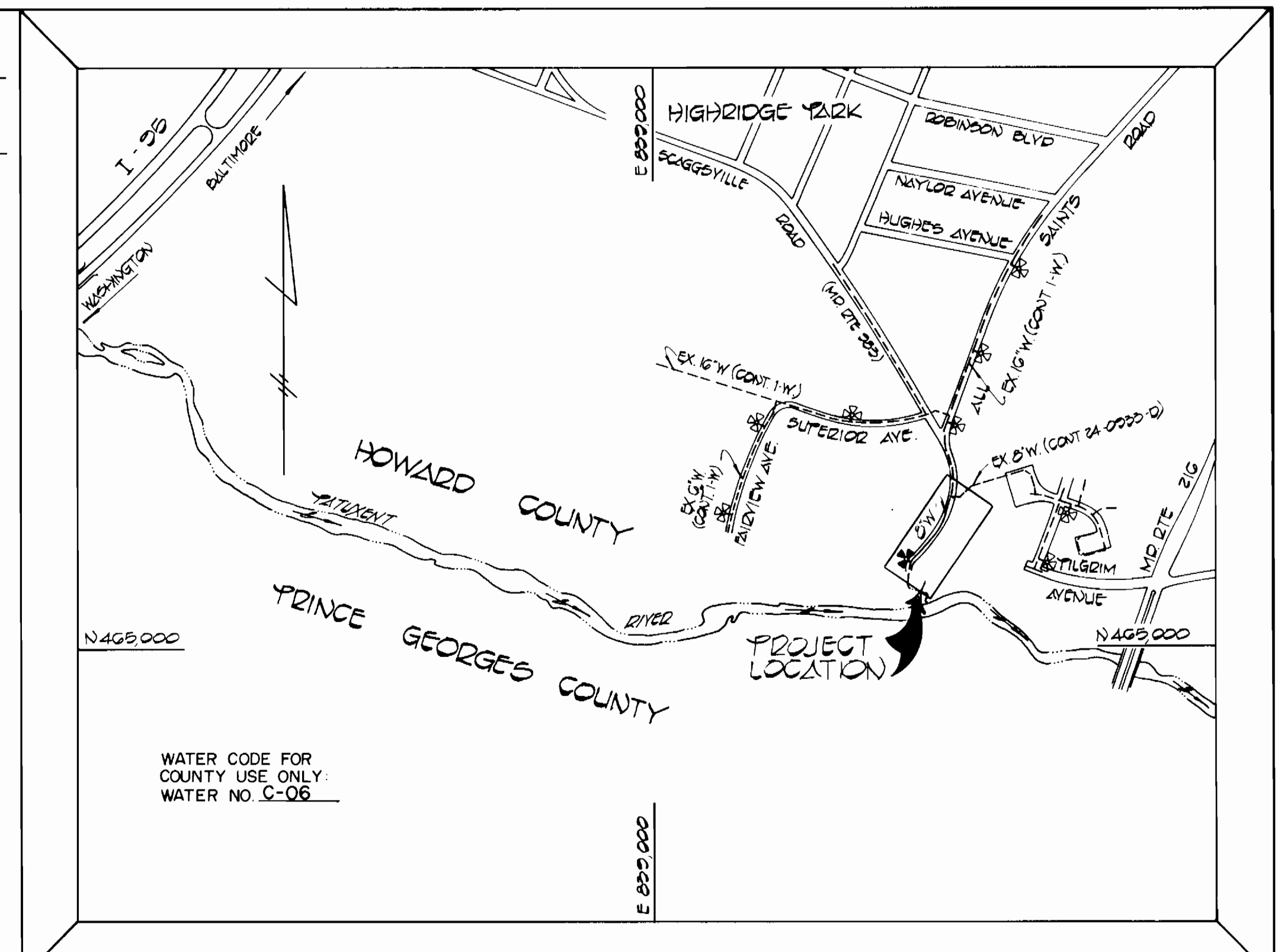

TYPE OF BUILDINGS: RESIDENTIAL
 NUMBER OF PARCELS: 5
 NUMBER OF WATER HOUSE CONNS.: 5
 DRAINAGE AREA: PATUXENT

VICINITY MAP
 SCALE: 1"=600'

- GENERAL NOTES**
- APPROXIMATE LOCATION OF EXISTING MAINS ARE SHOWN. THE CONTRACTOR SHALL TAKE ALL NECESSARY PRECAUTIONS TO PROTECT EXISTING MAINS AND SERVICES AND MAINTAIN UNINTERRUPTED SUPPLY. ANY DAMAGE INCURRED SHALL BE REPAIRED IMMEDIATELY TO THE SATISFACTION OF THE ENGINEER, AT THE CONTRACTOR'S EXPENSE.
 - ALL HORIZONTAL CONTROLS ARE BASED ON MARYLAND STATE COORDINATES.
 - ALL VERTICAL CONTROLS ARE BASED ON U.S.G.S. DATUM.
 - ALL PIPE ELEVATIONS SHOWN ARE INVERT ELEVATIONS.
 - CLEAR ALL UTILITIES BY A MINIMUM OF 6". CLEAR ALL POLES BY 2'-0" MINIMUM OR TUNNEL AS REQUIRED. ANY COST INCURRED TO THE CONTRACTOR FOR TUNNELING OR BRACING AT POLES SHALL BE INCLUDED IN UNIT PRICES BID FOR CONSTRUCTION OF THE MAIN.
 - FOR DETAILS NOT SHOWN ON THE DRAWINGS USE HOWARD COUNTY STANDARD DETAILS.
 - FOR MATERIALS AND CONSTRUCTION METHODS USE HOWARD COUNTY STANDARD SPECIFICATIONS.
 - CONTRACTOR SHALL LOCATE EXISTING UTILITIES A MINIMUM OF TWO (2) WEEKS IN ADVANCE OF CONSTRUCTION OPERATIONS IN THE VICINITY OF PROPOSED UTILITIES AT HIS OWN EXPENSE.
 - CONTRACTOR SHALL NOTIFY THE FOLLOWING UTILITIES OR AGENCIES AT LEAST FIVE (5) WORKING DAYS BEFORE STARTING WORK SHOWN ON THESE PLANS:
 - BALTIMORE GAS AND ELECTRIC CO. - UNDERGROUND ELECTRIC DISTRIBUTION CUSTOMER SERVICE - (685-0123)
 - BALTIMORE GAS AND ELECTRIC CO. - UNDERGROUND GAS DISTRIBUTION, CUSTOMER SERVICE (685-0123)
 - STATE HIGHWAY ADMINISTRATION - 531-5533
 - ENGINEERING - "DAMAGE CONTROL" - (234-5621)
 - "MISS UTILITY" - (1-559-0100)
 - CHESAPEAKE & POTOMAC (C&P) TELEPHONE COMPANY - (725-9976)
 - BUREAU OF UTILITIES, HOWARD COUNTY - (992-2366)
 - TREES ARE TO BE PROTECTED FROM DAMAGE TO MAXIMUM EXTENT. TREES LOCATED WITHIN THE CONSTRUCTION STRIP ARE NOT TO BE REMOVED OR DAMAGED BY THE CONTRACTOR.
 - CONTRACTOR SHALL REMOVE TREES, STUMPS AND ROOTS ALONG LINE OF EXCAVATION AS DIRECTED BY THE ENGINEER. PAYMENT FOR SUCH REMOVAL SHALL BE INCLUDED IN THE UNIT PRICE BID FOR CONSTRUCTION OF THE MAIN.
 - PLACE REGULATION "MEN WORKING" AND WARNING SIGNS AS REQUIRED TO COMPLY WITH MARYLAND STATE HIGHWAY ADMINISTRATION MANUAL OF TRAFFIC CONTROL FOR HIGHWAY CONSTRUCTION AND MAINTENANCE OPERATIONS.
 - ALL WATER MAINS TO BE C.I.P., C.I.P. OR P.C.C.P. UNLESS OTHERWISE NOTED.
 - TOP OF ALL WATER MAINS TO HAVE A MINIMUM OF 3'-6" COVER UNLESS OTHERWISE NOTED.
 - VALVES ADJACENT TO TEES SHALL BE STRAPPED TO TEES.
 - BLOCK ALL FITTINGS WITH CONCRETE.
 - BURY LINE ELEVATIONS ON FIRE HYDRANTS SHALL BE SET TO THE ELEVATIONS SHOWN ON THE DRAWINGS. ALL FIRE HYDRANTS SHALL BE STRAPPED AND BUTTRESSED WITH CONCRETE IN ACCORDANCE WITH STANDARD DETAILS. SOIL AROUND THE FIRE HYDRANT TO BE COMPACTED IN ACCORDANCE WITH SECTION 37.01 AND 37.05 OF THE STANDARD SPECIFICATIONS.
 - ALL WATER HOUSE CONNECTIONS SHALL BE FOR AN INSIDE METER SETTING.
 - THE CONTRACTOR SHALL NOT OPERATE ANY WATER MAIN VALVES ON THE EXISTING SYSTEM.
 - WATER MAIN AND WATER HOUSE CONNECTION LINES MUST BE PLACED SO AS TO HAVE AT LEAST ONE (1) FOOT SEPARATION FROM THE SEWER MAIN OR SEWER HOUSE CONNECTION AS THEY PASS ABOUT IT.

QUANTITIES

ITEM	EST'D	AS-BUILT	SUPPLIER
6" WATER	400 LF	461 LF	U.S. PIPE
8" WATER	25 LF	16 LF	U.S. PIPE
3/4" W.H.G.	70 LF	83 LF	"
FIRE HYD.	2 EA.	2 EA.	SMITH METRO.
6" VALVE	2 EA.	"	"
8" VALVE	1 EA.	"	"

CONTRACT NO. 44-1032
 CAPITAL PROJECT W-8/22
 OLD SCAGGSVILLE ROAD
 WATER MAIN EXTENSION
 HOWARD COUNTY, MD.