

- 19. All valves shall be strapped to tees, where applicable in accordance with standard details.
- 20. Buttress or anchor all water main fittings with concrete. See standard details bound in specifications.
- 21. Bury line elevations on fire hydrants shall be set to the elevations shown on the drawings. All fire hydrants shall be strapped and buttressed with concrete in accordance with standard details. Soil around the fire hydrant shall be compacted in accordance with standard specifications.

- ### GENERAL NOTES
1. Approximate location of existing mains are shown. The contractor shall take all necessary precautions to protect existing mains and services and maintain uninterrupted supply. Any damage incurred shall be repaired immediately.
 2. All horizontal controls are based on Maryland State Coordinates.
 3. All vertical controls are based on U.S.G.S. Datum.
 4. All pipe elevations shown are invert elevations.
 5. Clear all utilities by a minimum of 6'. Clear all poles 2'-0" minimum or tunnel as required.
 6. For all standard details see standards bound in specifications.
 7. Contractor shall locate existing utilities in advance of construction operations in the vicinity of proposed utilities.
 8. Contractor shall notify the following utilities or agencies at least (5) days before starting work shown on these plans.
 Baltimore Gas and Electric Company - Unground Electric Distribution Engineering - "Damage Control" - 234-5691.
 Baltimore Gas and Electric Company - Unground Gas Distribution Engineering - 559-0100.
 Chesapeake and Potomac Telephone Company - 725-7776
 American Telephone and Telegraph - Cable Location Division - 301-393-3533
 Colonial Pipeline Company - 781-4641
 9. Trees are to be protected from damage to maximum extent. Trees located within the construction strip are not to be removed or damaged by the contractor.
 10. Contractor shall remove trees, stumps and roots, if required, along line of excavation as directed by the Engineer. Payment for such removal shall be included in the unit price bid for excavation and backfill for sewer mains.
 11. Place regulation "Men Working" and warning signs as required to comply with Maryland State Highway Administration manual of Traffic Control for Highway Construction and Maintenance Operations.
 12. All sewer mains shall be C.S.P.X., V.C.P.X., D.I.P., or A.C.P. Class 2400 unless otherwise noted. Note: State approved P.V.C.
 13. The contractor shall provide a joint in all sewer mains within 2'-0" of exterior manhole wall.
 14. All manholes shall be 4'-0" inside diameter, unless otherwise noted.
 15. Proposed locations are referenced from existing structures and/or utility pole locations.
 16. Contractor shall remove and replace existing pavement, curb and gutter, where required, along line of excavation as directed by the Engineer.
 17. All water mains shall be D.I.P. Class 58 unless otherwise noted.
 18. Top of all water mains shall have a minimum of 3'-6" cover unless otherwise noted.

SEDIMENT CONTROL MEASURES FOR THIS CONTRACT WILL BE IMPLEMENTED IN ACCORDANCE WITH ARTICLE NO. 15 OF THE STANDARD SPECS.

REVIEWED FOR HOWARD SOIL CONSERVATION DISTRICT AND MEETS TECHNICAL REQUIREMENT

James M. ... 7/7/81
SIGNATURE DATE

U.S. SOIL CONSERVATION SERVICE

This Development Plan is approved for Soil Erosion and Sediment Control by the Howard Soil Conservation District

APPROVED:
William T. Rowe 7-7-81
Howard S.C.D. DATE

QUANTITIES				REVISIONS			
ITEM	ESTIMATED	AS-BUILT	MATERIAL/SUPPLIER	Nº	REVISION	BY	DATE
8" SEWER (LF)	689	719	PVC Belair Road Supply A.C.P. Johns Manville D.I.P. Use Pipe	1	EX. G' WATER & CROSSING W/ Prop. 8" SANITARY SEWER	GEH	9-2-81
MANHOLES (VF)	57.3	50.9	Precast Atlantic Precast	2	ENHANCEMENT ADDED FOR SANITARY SEWER, SANITARY SEWER	GEH	9-2-81
6" PUBLIC WATER (LF)	31	24	D.I.P. Griffin Pipe Co.	3	EX. WATER & EX. FIBER OPTIC CROSSING WITH Prop. 8" SANITARY SEWER (THRU)	GEH	9-2-81
8" PUBLIC WATER (LF)	406	418	D.I.P. Griffin Pipe Co.	4	TABULATION OF QUANTITIES ADDED	GEH	9-2-81
6" F.H. INCL. VALVE	2	2	M&H Flow Industries	5	RELOCATE M.H. ADD M.H.5 (Plan & Profile) REVISIONS	RTP	10-26-81
8" VALVE	1	1	M&H Flow Industries	6	RELOCATE F.H. 2 COURTHOUSE DR	G.E.H.	3-11-82
8" PRIVATE WATER (LF)	249	140	D.I.P. Griffin	7	DETAILS ADDED FOR REVISION 6	G.E.H.	3-11-82
				8	San. Sewer from M.H. 15 to M.H. 5	G.E.H.	3-11-82
				9	Quantities from Rev. G, 7, 8	G.E.H.	3-11-82

GREENHORNE AND O'MARA, INC.
ENGINEERS - ARCHITECTS - PLANNERS - SURVEYORS
622 HUNGERFORD DR. SUITE 20
ROCKVILLE, MARYLAND 20850 (301) 762-3340

DEPARTMENT OF PUBLIC WORKS
HOWARD COUNTY, MARYLAND

Francis M. ... 7/19/81
DIRECTOR OF PUBLIC WORKS DATE

William T. Rowe 7-9-81
CHIEF, BUREAU OF UTILITIES DATE

William T. Rowe 7-9-81
CHIEF, LAND DEVELOPMENT DIVISION DATE

CONTRACT NO. 14-0977-D

PLAN FOR SANITARY SEWER & WATER EXTENSIONS

DISTRICT COURT HOUSE MULTI-SERVICE CENTER

DRAWING NO. 1 OF 2

SCALE AS SHOWN

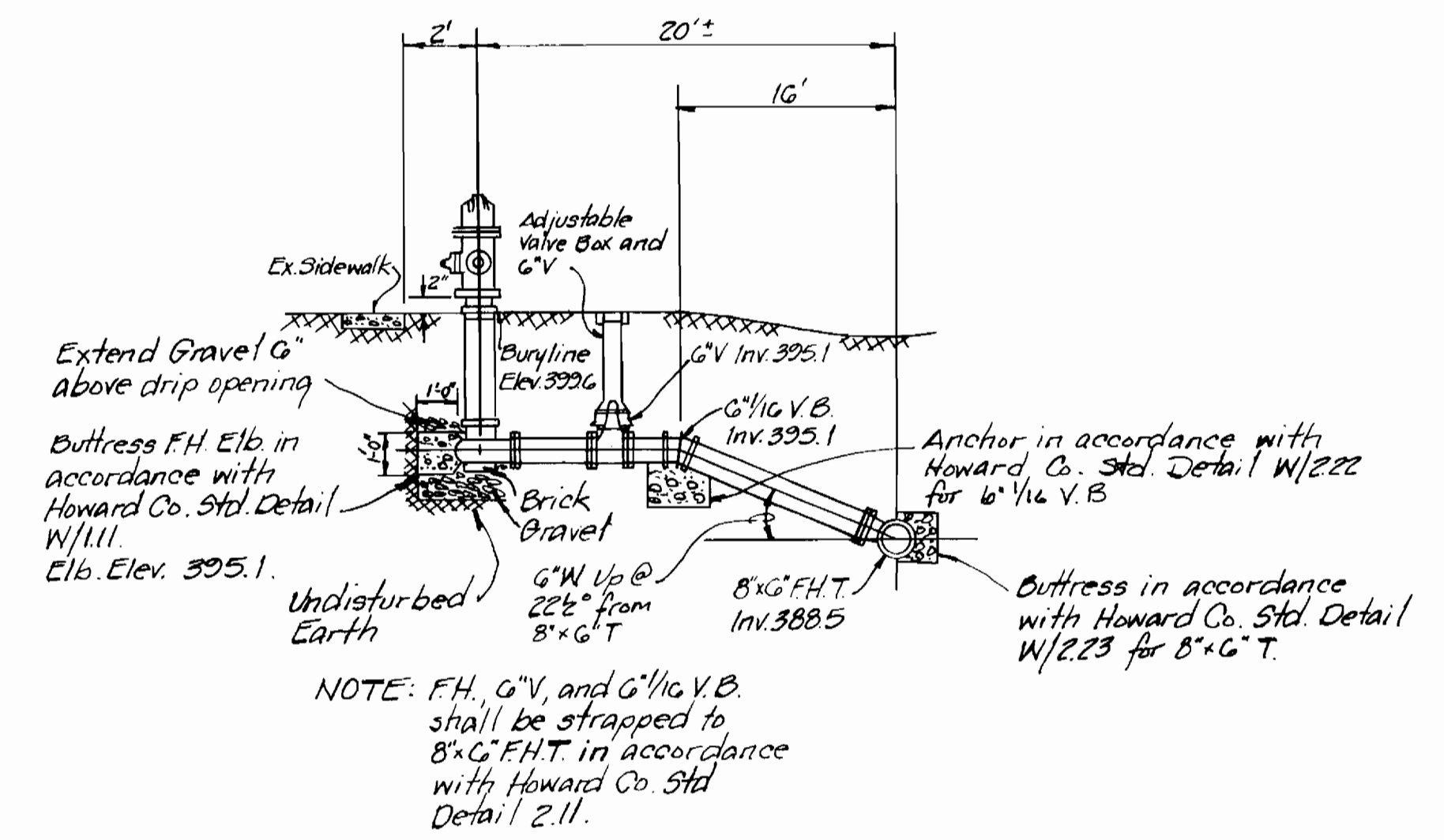
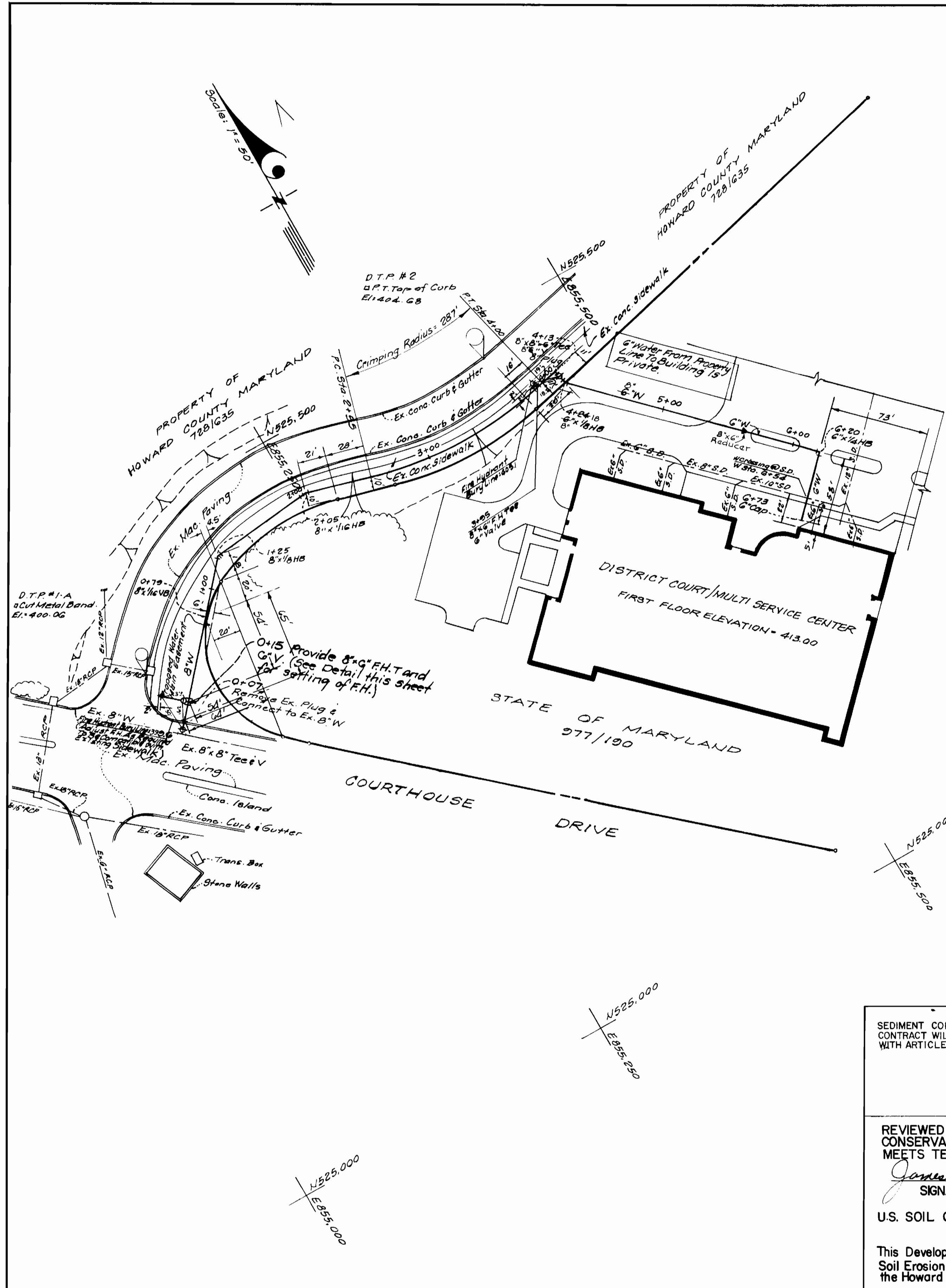

DETAIL FOR SETTING OF FIRE HYDRANT
AT Sta. 0+15
(No Scale)

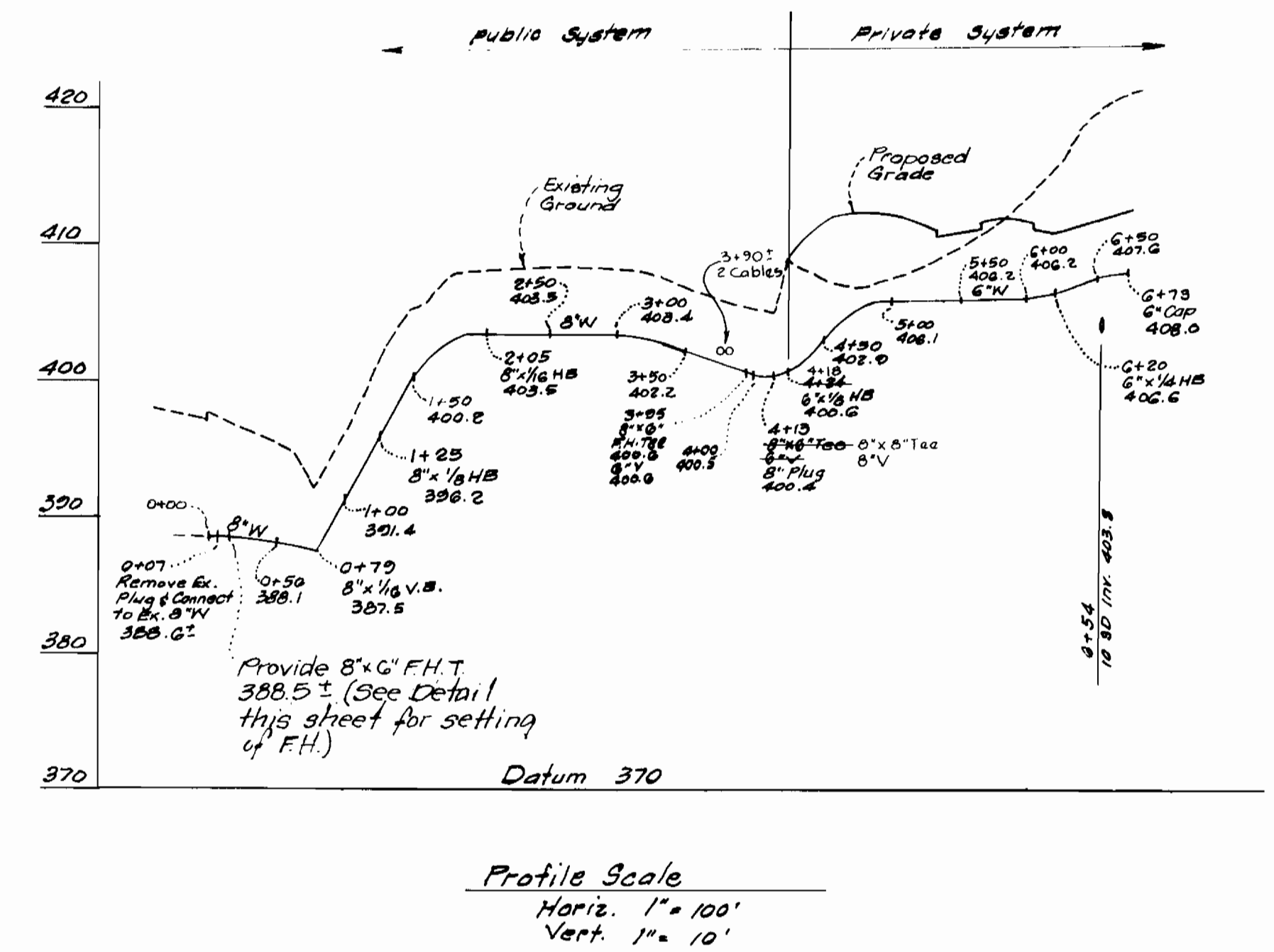

SEDIMENT CONTROL MEASURES FOR THIS CONTRACT WILL BE IMPLEMENTED IN ACCORDANCE WITH ARTICLE NO. 15 OF THE STANDARD SPEC'S.

REVIEWED FOR HOWARD SOIL CONSERVATION DISTRICT AND MEETS TECHNICAL REQUIREMENT
James M. Helmer 7/7/81
SIGNATURE DATE

U.S. SOIL CONSERVATION SERVICE

This Development Plan is approved for Soil Erosion and Sediment Control by the Howard Soil Conservation District.

APPROVED:
William J. Roman 7-7-81
Howard S.C.D. DATE

DEPARTMENT OF PUBLIC WORKS
HOWARD COUNTY, MARYLAND
Robert M. Brennan 7-9-81
DIRECTOR OF PUBLIC WORKS DATE
William J. Roman 7-7-81
CHIEF, BUREAU OF ENGINEERING DATE
William J. Roman 7-7-81
CHIEF, LAND DEVELOPMENT DIVISION DATE

GREENHORNE AND O'MARA, INC.
ENGINEERS - ARCHITECTS - PLANNERS - SURVEYORS
622 HUNGERFORD DR. SUITE 20
ROCKVILLE, MARYLAND 20850 (301) 762-5340

CONTRACT NO. 14-0977-D

PLAN FOR SANITARY SEWER & WATER EXTENSIONS

DISTRICT COURT HOUSE MULTI-SERVICE CENTER

DRAWING NO. 2 OF 2	SCALE AS SHOWN
--------------------	----------------