

- GENERAL NOTES
- APPROXIMATE LOCATION OF EXISTING MAINS ARE SHOWN. THE CONTRACTOR SHALL TAKE ALL NECESSARY PRECAUTIONS TO PROTECT EXISTING MAINS AND SERVICES AND NOT BE INTERRUPTED SUPPLY. ANY DAMAGE INCURRED SHALL BE REPAIRED IMMEDIATELY TO THE SATISFACTION OF THE ENGINEER, AT THE CONTRACTOR'S EXPENSE.
  - ALL VERTICAL CONTROL IS BASED ON U.S.C.S. DATUM.
  - ALL HORIZONTAL CONTROL IS BASED ON MARYLAND STATE COORDINATES.
  - CLEAR ALL UTILITIES BY A MINIMUM OF 6". CLEAR ALL POLES BY 2'-0" MINIMUM OR TUNNEL AS REQUIRED. ANY COST INCURRED TO THE CONTRACTOR FOR TUNNELING OR BRACING AT POLES SHALL BE INCLUDED IN UNIT PRICES BID FOR EXCAVATION AND BACKFILL.
  - FOR DETAILS NOT SHOWN ON THE DRAWINGS, USE HOWARD COUNTY STANDARD DETAILS.
  - FOR MATERIALS AND CONSTRUCTION METHODS, USE HOWARD COUNTY STANDARD SPECIFICATIONS.
  - CONTRACTOR SHALL LOCATE EXISTING UTILITIES A MINIMUM OF TWO (2) WEEKS IN ADVANCE OF CONSTRUCTION OPERATIONS IN THE VICINITY OF PROPOSED UTILITIES AT HIS OWN EXPENSE.
  - CONTRACTOR SHALL NOTIFY THE FOLLOWING UTILITIES OR AGENCIES AT LEAST FIVE (5) WORKING DAYS BEFORE STARTING WORK SHOWN ON THESE PLANS:
    - BALTIMORE GAS & ELECTRIC COMPANY - UNDERGROUND ELECTRIC DISTRIBUTION CUSTOMER SERVICE - 685-0123
    - BALTIMORE GAS & ELECTRIC COMPANY - UNDERGROUND GAS DISTRIBUTION CUSTOMER SERVICE - 685-0123
    - ENGINEERING - "DAMAC" CONTROL - 234-5621
    - "MESS" UTILITIES - 1-559-4100
    - DESSAUX & POIMAG (C&P) TELEPHONE COMPANY - 725-9976
    - BUREAU OF UTILITIES HOWARD COUNTY - 992-2366
  - TREES ARE TO BE PROTECTED FROM DAMAGE TO MAXIMUM EXTENT. TREES LOCATED WITHIN THE CONSTRUCTION STRIP ARE NOT TO BE REMOVED OR DAMAGED BY THE CONTRACTOR.
  - CONTRACTOR SHALL REMOVE TREES, STUMPS AND ROOTS ALONG LINE OF EXCAVATION AS DIRECTED BY THE ENGINEER. PAYMENT FOR SUCH REMOVAL SHALL BE INCLUDED IN THE UNIT PRICE BID FOR EXCAVATION AND BACKFILL.
  - PLACE REGULATION "MEN WORKING" AND WARNING SIGNS AS REQUIRED TO COMPLY WITH MARYLAND STATE HIGHWAY ADMINISTRATION MANUAL OF TRAFFIC CONTROL FOR HIGHWAY CONSTRUCTION AND MAINTENANCE OPERATIONS.
  - ALL WATER MAINS TO BE C.I.P. OR D.I.P. UNLESS OTHERWISE NOTED.
  - ALL WATER MAINS TO HAVE A MINIMUM OF 3'-6" COVER UNLESS OTHERWISE NOTED.
  - VALVES AND FITTINGS TO BE STRAPPED TO TEST.
  - WORK ALL FITTINGS WITH CONCRETE.
  - BURY LINE ELEVATIONS ON FIRE HYDRANTS SHALL BE SET TO THE ELEVATIONS SHOWN ON THE DRAWINGS. ALL FIRE HYDRANTS SHALL BE STRAPPED AND BUTRESSED WITH CONCRETE IN ACCORDANCE WITH STANDARD DETAILS. JETS AROUND THE FIRE HYDRANT TO BE COMPACTED IN ACCORDANCE WITH SECTION 5-15 OF THE STANDARD SPECIFICATIONS.
  - ALL WATER HOUSE CONNECTIONS SHALL BE FOR AN INSIDE METER SETTING.
  - THE CONTRACTOR SHALL NOT OPERATE ANY WATER MAIN VALVES ON THE EXISTING SYSTEM.
  - ALL SEWER MAINS SHALL BE C.I.P., V.C.P.X., OR A.C.P. CLASS 2-00 UNLESS OTHERWISE NOTED.
  - THE CONTRACTOR SHALL PROVIDE A JOINT IN ALL SEWER MAINS WITHIN 2'-0" OF EXTERIOR MANHOLE WALL.

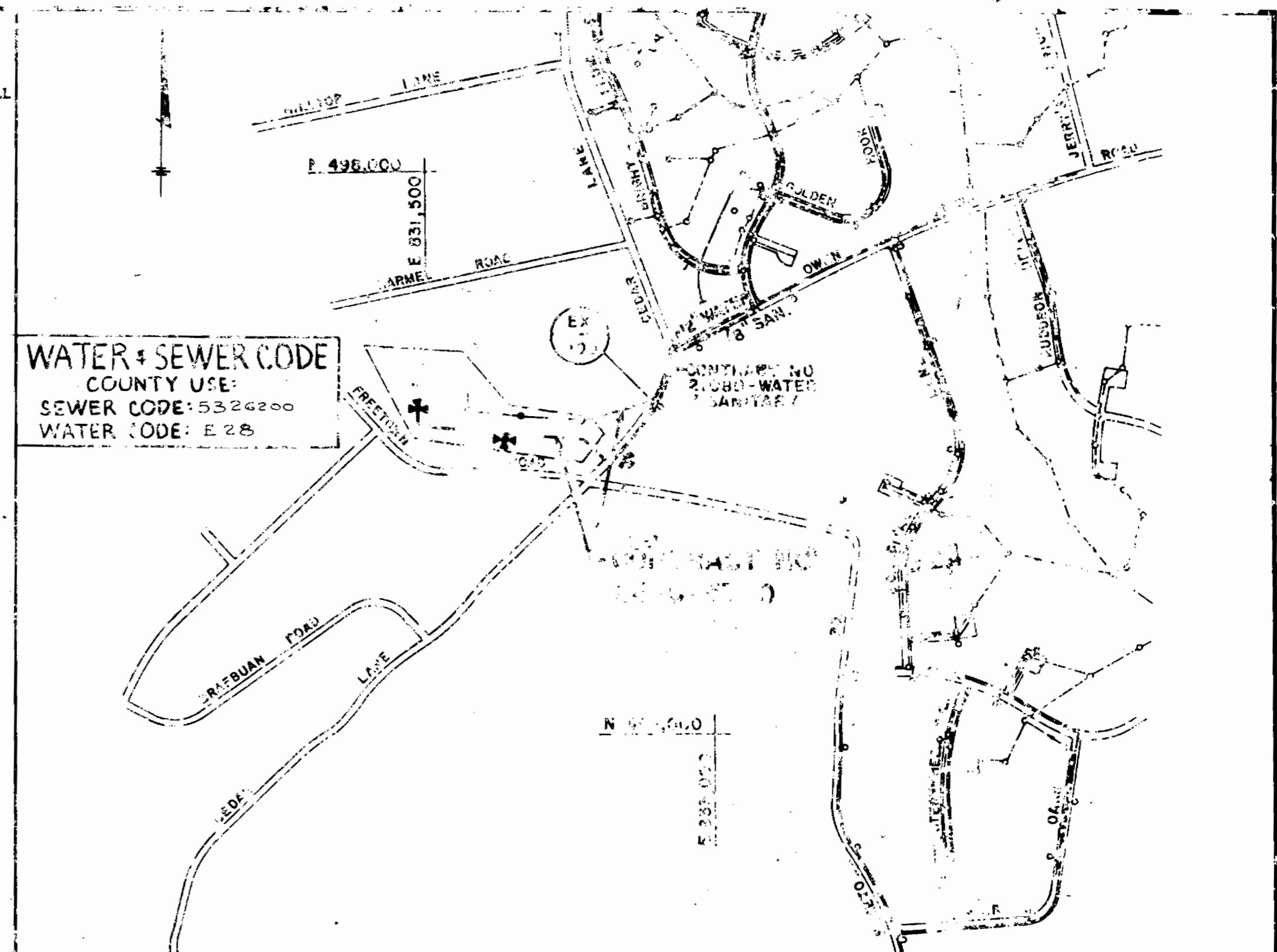

QUANTITIES

ITEM	BID	AS BUILT	MATERIAL/SUPPLIER
12" WATER	384 LF	384 LF	DIP GRIFFEN-AMSTED
8" WATER	296 LF	915 LF	"
6" WATER	52 LF	52 LF	"
FIRE HYDRANTS	3 EA	3 EA	US PIPE & FOUNDRY
12" VALVE	1 EA	1	DIP GRIFFEN-AMSTED
8" VALVE	1 EA	1	"
6" VALVE (EX.F.H. VALVES)	1 EA	2	DIP GRIFFEN-AMSTED
8" SAN. SEWER	65 LF	65 LF	ACP, LM-TRANSITE

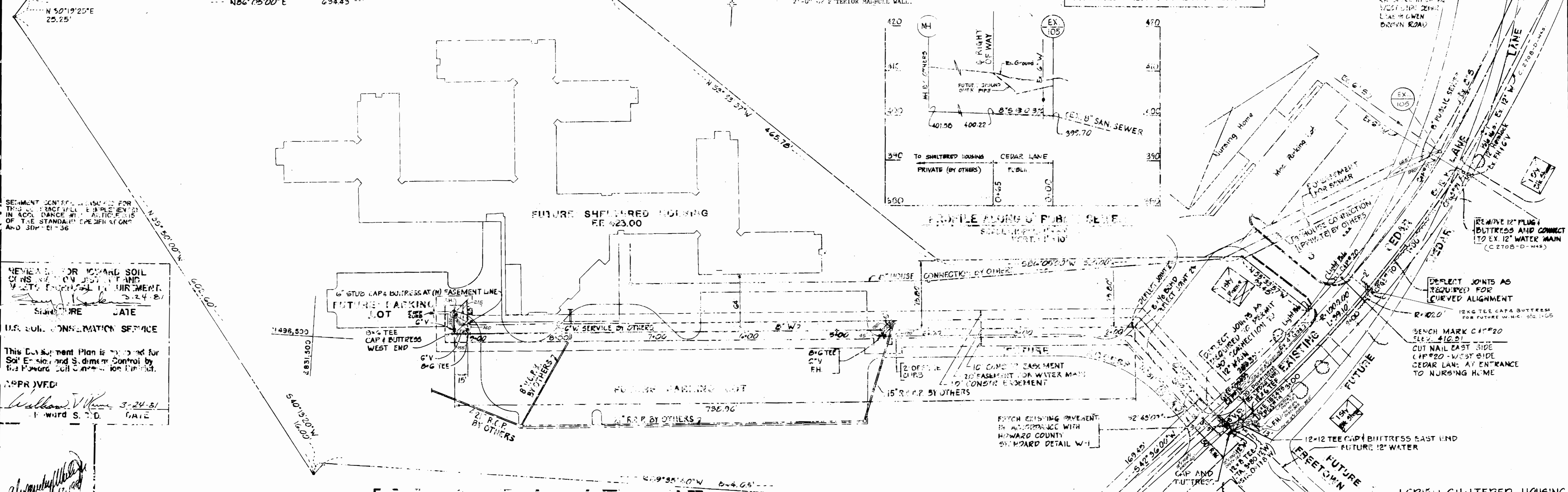
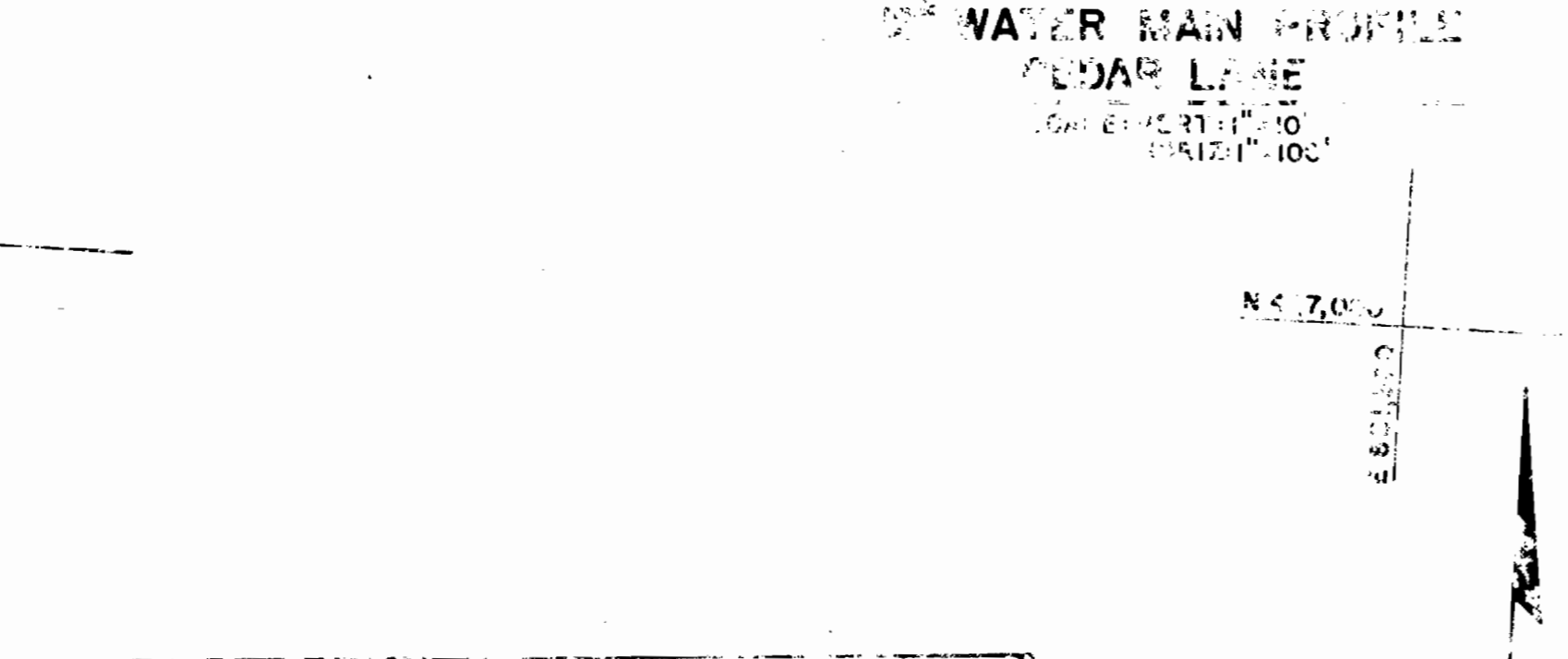

SEWER CONTRACTOR TO VERIFY FOR THIS CONTRACT WILL BE A PIPE ELEVATION IN ACCORDANCE WITH THE SPECIFICATIONS OF THE STANDARD SPECIFICATIONS AND 304-01-36

REVIEWED FOR HOWARD COUNTY ENGINEER ON 3-24-81  
 SIGNATURE DATE  
 U.S. SOIL CONSERVATION SERVICE

This Development Plan is required for Soil Erosion and Sediment Control by the Howard County Conservation District.  
 APPROVED:  
 Signature DATE  
 Howard S.D. DATE

Signature DATE  
 Signature DATE

DEPARTMENT OF PUBLIC WORKS  
 HOWARD COUNTY, MARYLAND  
 Signature DATE  
 Signature DATE  
 Signature DATE

CONTRACT NO. 24-0957-D  
 PLAN OF WATER MAIN EXTENSION  
 35 1981

LORIEN SHELTERED HOUSING  
 CONTRACT NO. 24-0957-D  
 DESIGNED BY: DR. J. J. K.  
 CHECKED BY: C. K. P. E. C.