

**BENCH MARKS**

B.M. "D" ELEV. 368.70  
 R.R. Spike found in pole on North Side of Frederick Road opposite C.F.P. No. 464  
 B.M. "F" ELEV. 378.62  
 Northwest corner of storm drain grate, East side of Plumtree Drive.

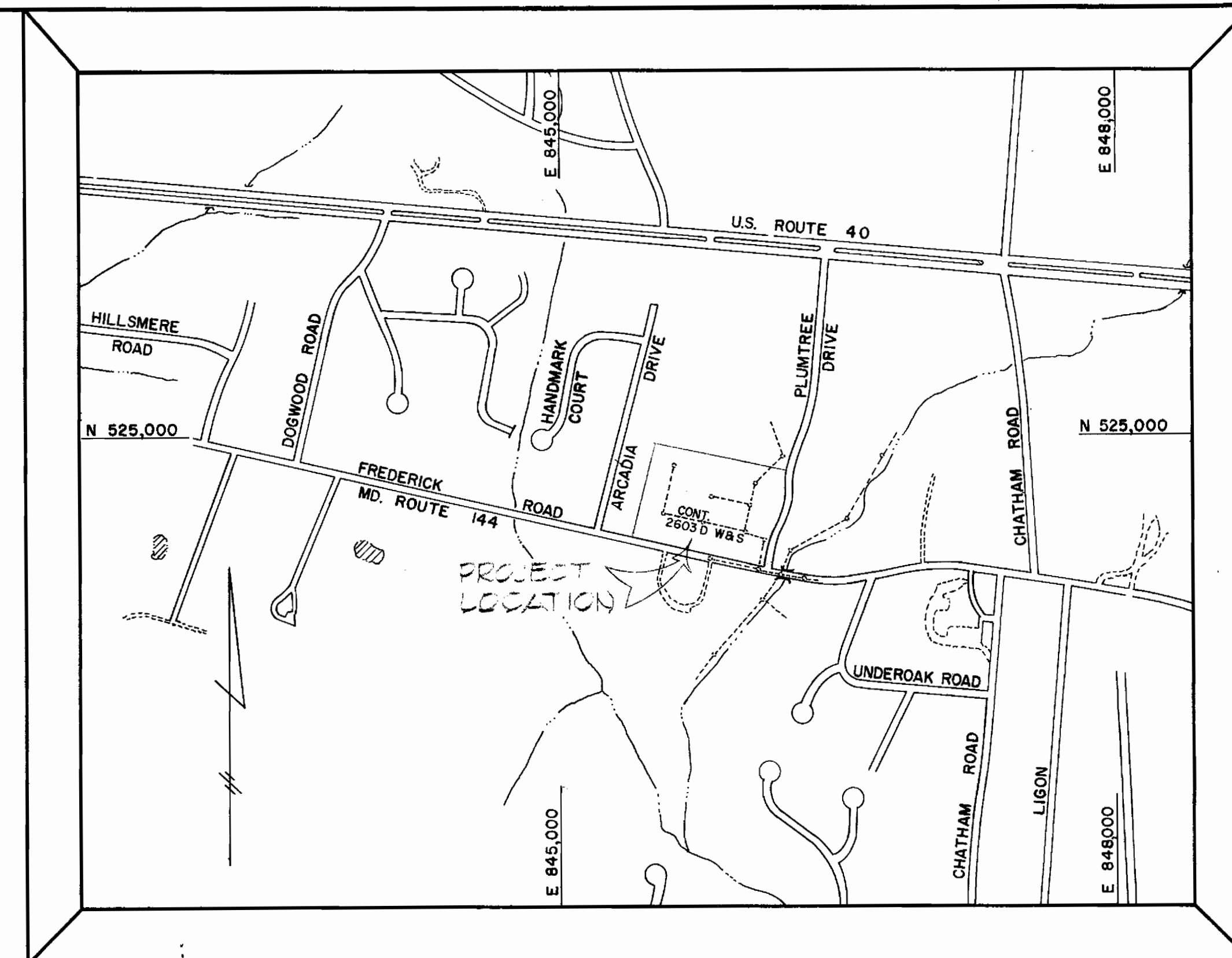

TYPE OF BUILDING	TOWNHOUSES
NUMBER OF LOTS	81
NUMBER OF WATER HOUSE CONNECTIONS	81
NUMBER OF SEWER HOUSE CONNECTIONS	81
DRAINAGE AREA	LITTLE PATUXENT

**VICINITY MAP**  
 SCALE: 1" = 600'

**GENERAL NOTES**

- APPROXIMATE LOCATION OF EXISTING MAINS ARE SHOWN. THE CONTRACTOR SHALL TAKE ALL NECESSARY PRECAUTIONS TO PROTECT EXISTING MAINS AND SERVICES AND MAINTAIN UNINTERRUPTED SUPPLY. ANY DAMAGE INCURRED DUE TO CONTRACTORS OPERATIONS SHALL BE REPAIRED IMMEDIATELY AT THE CONTRACTOR'S EXPENSE.
- ALL PIPE ELEVATIONS SHOWN ARE INVERT ELEVATIONS.
- CLEAR ALL UTILITIES BY A MINIMUM OF 6". CLEAR ALL POLES BY 2'-0" MINIMUM OR TUNNEL AS REQUIRED. ANY COST INCURRED TO THE CONTRACTOR FOR TUNNELING OR BRACING AT POLES SHALL BE INCLUDED IN UNIT PRICES BID FOR EXCAVATION.
- FOR ALL STANDARD DETAILS SEE STANDARDS BOUND IN THE SPECIFICATIONS.
- THE CONTRACTOR SHALL LOCATE EXISTING UTILITIES A MINIMUM OF TWO WEEKS IN ADVANCE OF CONSTRUCTION OPERATIONS IN THE VICINITY OF PROPOSED UTILITIES.
- THE CONTRACTOR SHALL NOTIFY THE FOLLOWING UTILITIES OR AGENCIES AT LEAST FIVE (5) DAYS BEFORE STARTING WORK ON THESE PLANS:  
 BALTIMORE GAS & ELECTRIC CO. - UNDERGROUND ELECTRIC - 234-5691  
 BALTIMORE GAS & ELECTRIC CO. - UNDERGROUND GAS - 559-0100  
 C & P TELEPHONE CO. - 725-9976  
 MISS UTILITY - 1-559-0100
- ALL WATER MAINS TO BE C.I.P. OR D.I.P. UNLESS OTHERWISE NOTED.
- TOP OF WATER MAINS TO HAVE A MINIMUM OF 3 1/2" OF COVER UNLESS OTHERWISE NOTED.
- ALL VALVES SHALL BE STRAPPED TO TEES, WHERE APPLICABLE, IN ACCORDANCE WITH STANDARD DETAILS.
- BUTTRESS OR ANCHOR ALL WATER MAIN FITTINGS IN CONCRETE IN ACCORDANCE WITH DETAILS IN SPECIFICATIONS.
- ALL SEWER MAINS SHALL BE C.S.P.X., V.C.P.X. OR A.C.P. CLASS 2400 UNLESS OTHERWISE NOTED.
- THE CONTRACTOR SHALL PROVIDE A JOINT IN ALL SEWER MAINS WITHIN 2'-0" OF EXTERIOR MANHOLE WALLS.
- ALL MANHOLES TO BE 4'-0" INSIDE DIA. UNLESS OTHERWISE NOTED.
- HORIZONTAL CONTROLS ARE BASED ON MARYLAND STATE COORDINATES. VERTICAL CONTROLS ARE BASED ON U.S.G.S. DATUM.
- ALL WATER HOUSE CONNECTIONS SHALL BE METER SETTING FOR INSIDE.
- FOR AS-BUILT LOCATIONS OF EX. W.H.C. & S.H.C., SEE CONTRACT 2603-D-W.B.S.

MH'S TO MH'S	LENGTH	MH'S TO MH'S	LENGTH	MH'S TO MH'S	LENGTH
0-42	51' LT.	0-51	39' RT.	0-05	38' LT.
0-45	51' LT.	0-47	39' RT.	0-00	38' LT.
0-65	50' RT.	0-25	35' RT.	0-34	36' LT.
0-80	50' RT.	0-20	35' RT.	0-23	37' LT.
0-84	52' RT.	0-00	55' RT.	0-75	36' LT.
0-32	37' LT.	0-04	35' RT.	0-40	37' LT.
0-30	37' LT.	0-35	38' RT.	1-14	39' LT.
1-19	50' RT.	0-56	35' RT.	1-18	37' LT.
1-22	50' RT.	0-75	39' RT.	1-30	35' LT.
1-20	38' LT.	0-73	38' RT.	1-35	35' LT.
1-35	38' LT.	1-11	38' RT.	1-37	37' LT.
1-57	51' RT.	1-16	38' RT.	1-22	35' LT.
1-53	50' RT.	1-03	45' LT.		
1-66	39' LT.	1-73	35' LT.		
1-70	36' LT.				
1-30	51' RT.				
1-33	51' RT.				
2-03	37' LT.				
2-18	36' LT.				
2-42	37' RT.				
2-47	36' RT.				

17. SEDIMENT CONTROL FOR THE CONSTRUCTION HEREON WILL BE IN ACCORDANCE WITH SEDIMENT CONTROL PLAN - PLUMTREE APARTMENTS - SECTION 2 (SDP 74-05).

QUANTITIES			
ITEM	EST'D	AS BUILT	SUPPLIER
6" Sewer	1430 L.F.	1031 L.F.	Certain-tyed
8" W.H.C.	813 L.F.	920 L.F.	-
1" W.H.C.	200 L.F.	743 L.F.	-

AS-BUILTS:  
 W.H.C'S  
 ALL DIMENSIONS + OR - 1"

AS-BUILTS: SHC + OR - 1"  
 ALL CONNECTIONS APPEAR SERVICEABLE

CONTRACT NO. 24-0913-D  
 PLUMTREE APARTMENTS  
 SECTION 2  
 WATER AND SEWER EXTENSION

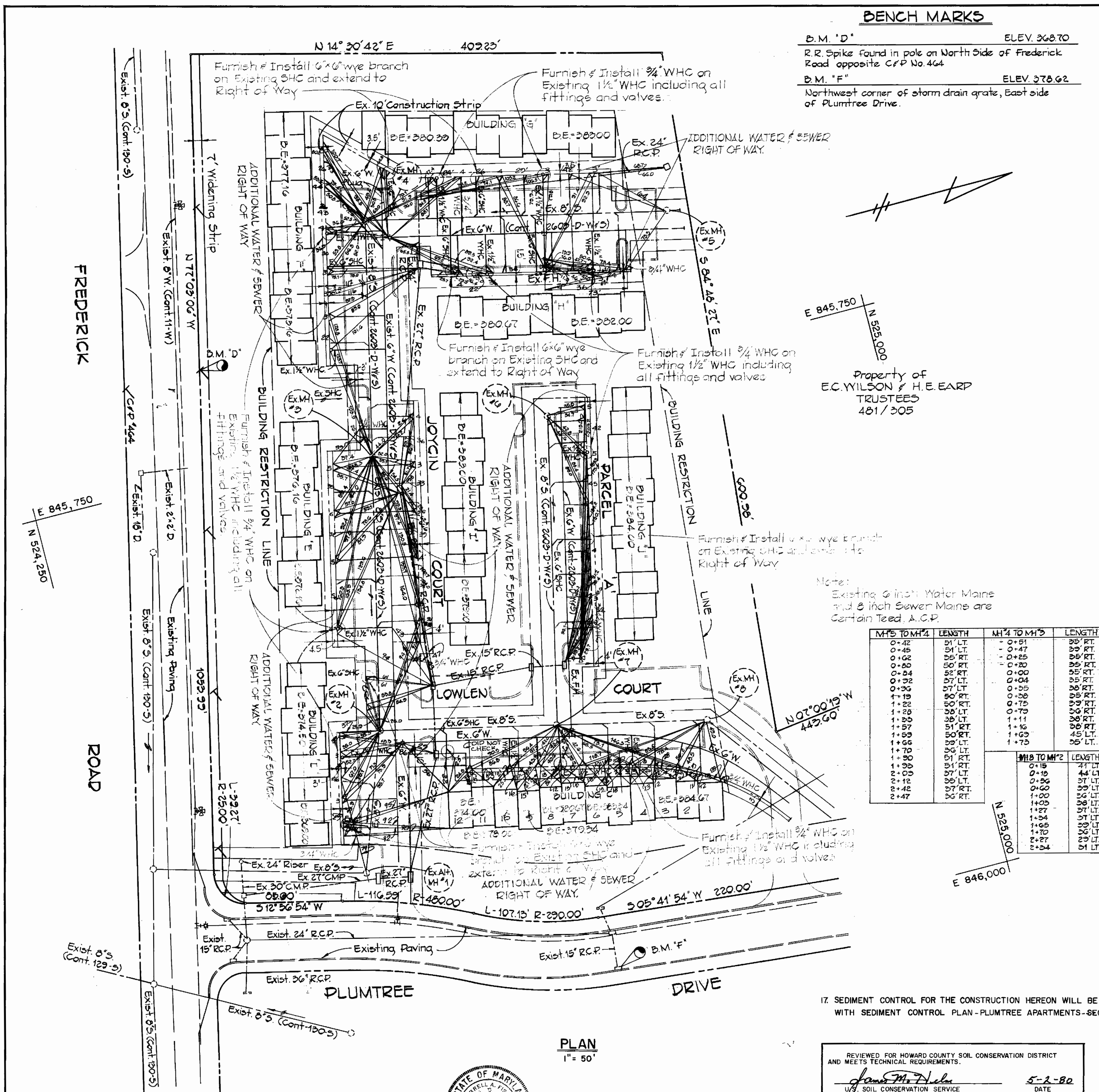

**PLAN**  
 1" = 50'

REVIEWED FOR HOWARD COUNTY SOIL CONSERVATION DISTRICT AND MEETS TECHNICAL REQUIREMENTS.  
 APPROVED: *James M. DeLoe* 5-2-80 DATE  
 U.S. SOIL CONSERVATION SERVICE  
 THIS DEVELOPMENT PLAN IS APPROVED FOR EROSION AND SEDIMENT CONTROL BY THE HOWARD COUNTY SOIL CONSERVATION DISTRICT.  
 APPROVED: *William F. Lane* 5/2/80 DATE  
 DISTRICT SUPERVISOR  
 HOWARD COUNTY SOIL CONSERVATION DISTRICT

DEPARTMENT OF PUBLIC WORKS  
 HOWARD COUNTY, MARYLAND  
 James L. Phipps, 5/6/80  
 CHIEF BUREAU OF UTILITIES DATE  
 Fisher, Collins and Carter, Inc.  
 CIVIL ENGINEERS AND LAND SURVEYORS  
 8388 COURT AVENUE  
 ELLICOTT CITY, MARYLAND 21043

STATE OF MARYLAND  
 TERRELL A. FISHER, P.E. 9757  
 DEPARTMENT OF PUBLIC WORKS  
 HOWARD COUNTY, MARYLAND  
 May F. Neimey  
 CHIEF LAND DEVELOPMENT DIVISION DATE  
 DIRECTOR OF PUBLIC WORKS

CONTRACT NO. 24-0913-D  
 PLAN  
 WATER AND SEWER MAINS

PLUMTREE APARTMENTS  
 SECTION NO. 2  
 ELECTION DISTRICT - ELLICOTT CITY NO. 2  
 DRAWING NO. 1 OF 1  
 SCALE AS SHOWN  
 DESIGNED: EDG  
 DRAFTED: DBS  
 CHECKED: TAF