

**BENCH MARKS**

WR&A B.M.# 20 Elev. 237.88  
 □ cut corner bridge west side 60' North of E Middle Patuxent River

WR&A B.M.# 21 Elev. 285.99  
 R.R. Spike in power pole # 308176 West side Old Murray Hill Road @ Inter. Volmerhausen Rd.

WR&A B.M.# 23 Elev. 274.26  
 R.R. Spike in power pole # 345134 East side Old Murray Hill Road 180'± inter. Md. Rt. 32

QUANTITIES			
ITEM	BID	AS-BUILT	MATERIAL / SUPPLIER
8" Water	1,010 LF		
6" Water	30 LF		
8" Valves	2		
Fire hydrants	2		

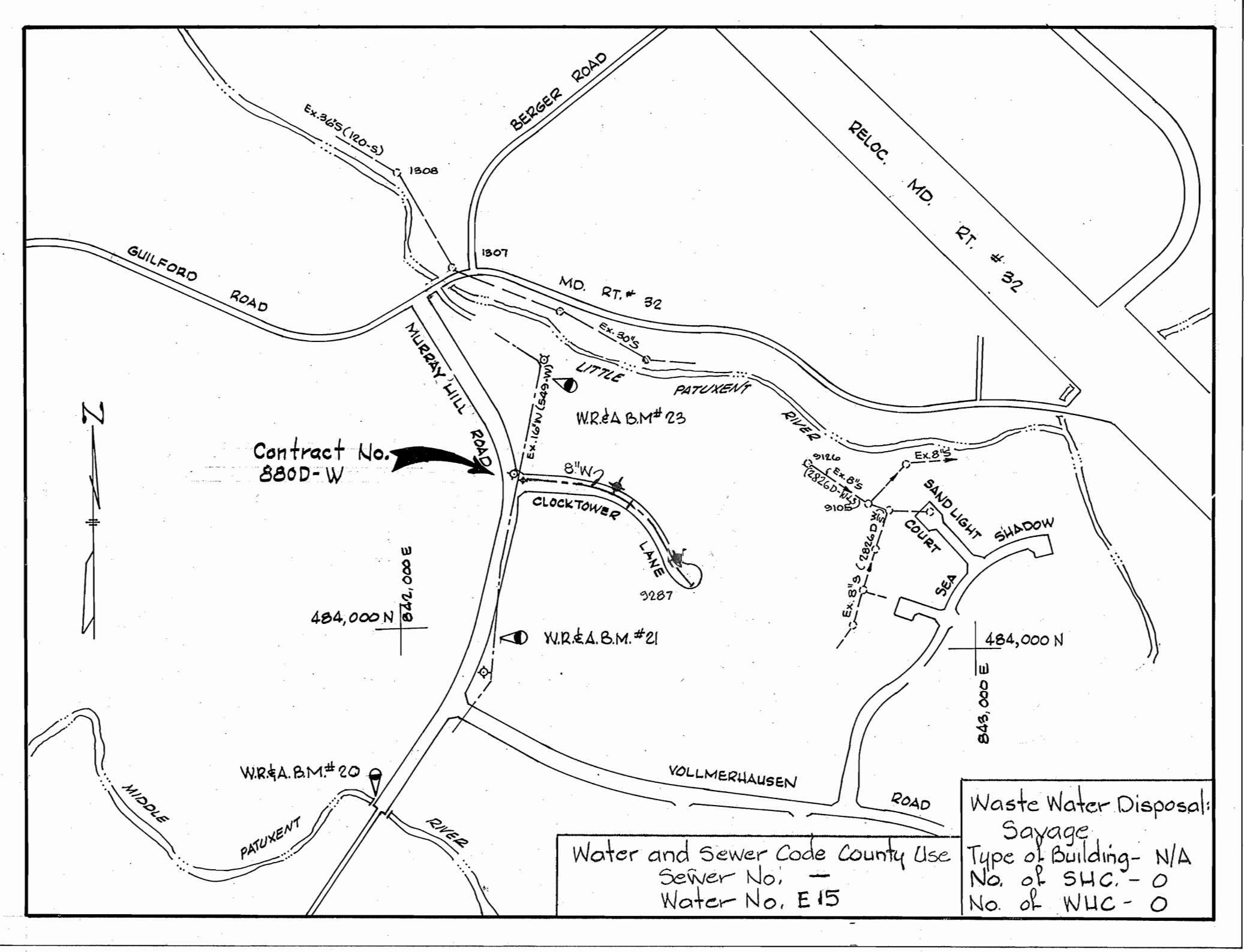

**LOCATION MAP**  
 Scale: 1"=600'

**GENERAL NOTES**

- APPROXIMATE LOCATION OF EXISTING MAINS ARE SHOWN. THE CONTRACTOR SHALL TAKE ALL NECESSARY PRECAUTIONS TO PROTECT EXISTING MAINS AND SERVICES AND MAINTAIN UNINTERRUPTED SUPPLY. ANY DAMAGE INCURRED SHALL BE REPLACED IMMEDIATELY.
- ALL PIPE ELEVATIONS SHOWN ARE INVERT ELEVATIONS.
- THE CONTRACTOR SHALL LOCATE EXISTING UTILITIES A MINIMUM OF TWO WEEKS IN ADVANCE OF CONSTRUCTION OPERATIONS IN VICINITY OF UTILITIES.
- THE CONTRACTOR SHALL NOTIFY THE FOLLOWING UTILITIES OR AGENCIES AT LEAST FIVE DAYS BEFORE STARTING WORK SHOWN ON THESE PLANS:
  - BALTIMORE GAS AND ELECTRIC COMPANY - UNDERGROUND ELECTRIC DISTRIBUTION ENGINEERING DAMAGE CONTROL 234-5691 UNDERGROUND GAS DISTRIBUTION ENGINEERING 234-5621
  - CHESAPEAKE AND POTOMAC TELEPHONE COMPANY 393-3648.
  - MISS UTILITY - 1 - 559-0100
- FOR ALL STANDARD DETAILS, SEE STANDARDS BOUND IN SPECIFICATIONS.
- ALL HORIZONTAL AND VERTICAL CONTROLS ARE BASED ON MARYLAND STATE DATUM.
- CLEAR ALL UTILITIES BY A MINIMUM OF 6".
- TREES ARE TO BE PROTECTED FROM DAMAGE TO MAXIMUM EXTENT. TREES LOCATED WITH THE CONSTRUCTION STRIP ARE NOT TO BE REMOVED OR DAMAGED BY THE CONTRACTOR.
- ALL SEWER MAINS SHALL BE C.S.P.X., V.C.P.X. OR A.C.P. CLASS 2400 UNLESS OTHERWISE NOTED.
- ALL MANHOLES SHALL BE 4'-0" INSIDE DIAMETER.
- THE CONTRACTOR SHALL PROVIDE A JOINT IN ALL SEWER MAINS WITHIN 2'-0" OR EXTERIOR MANHOLE WALLS.
- BLOCK ALL FITTINGS WITH CONCRETE, SEE STANDARDS BOUND IN SPECIFICATIONS.
- ALL WATER MAINS SHALL HAVE A MINIMUM OF 3 1/2" COVER.
- ALL WATER MAINS SHALL BE C.I.P. OR D.I.P. UNLESS OTHERWISE NOTED.
- ALL VALVES SHALL BE STRAPPED TO TEES WHERE APPLICABLE IN ACCORDANCE WITH THE STANDARD DETAILS.
- ALL FIRE HYDRANTS SHALL BE STRAPPED AND BUTTRESSED IN ACCORDANCE WITH THE STANDARD DETAILS. SOIL AROUND THE HYDRANTS SHALL BE COMPACTED IN ACCORDANCE WITH SECTION 5-15 OF THE STANDARD SPECIFICATIONS.
- PAYMENTS FOR STRAPPING FIRE HYDRANTS AND VALVES WILL BE INCLUDED IN UNIT PRICE BID FOR FURNISHING AND LAYING WATER MAINS.
- BURY LINE ELEVATIONS ON FIRE HYDRANTS SHALL BE SET TO THE ELEVATIONS SHOWN ON THE DRAWINGS.

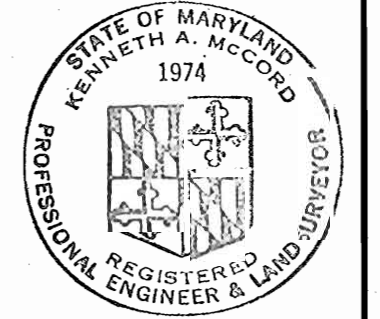

*Kenneth A. McCord*

Village of Kings Contrivance  
 Section 3, Area 1  
 Contract No. 880D-W

DEPARTMENT OF PUBLIC WORKS  
 HOWARD COUNTY, MARYLAND

*James L. Collins, 10/18/79*  
 CHIEF-BUREAU OF UTILITIES - DATE

*W. J. Baird, 10/18/79*  
 CHIEF-BUREAU OF ENGINEERING - DATE

**WHITMAN, REQUARDT & ASSOCIATES**  
 ENGINEERS  
 1304 ST. PAUL ST.  
 BALTIMORE, MARYLAND

DEPARTMENT OF PUBLIC WORKS  
 HOWARD COUNTY, MARYLAND

*George F. Neimeyer*  
 DIRECTOR OF PUBLIC WORKS

10-18-79  
 DATE

**CONTRACT NO. 880D-W**

**PLAN AND PROFILES OF WATER MAINS**

**COLUMBIA VILLAGE OF KINGS CONTRIVANCE ELECTION DISTRICT GUILFORD NO. 6**

**DRAWING NO. 1 OF 1**

**SCALE AS SHOWN**

484-4