

BENCH MARKS
 B.M. "I-C" Elev. 424.63
 2.2 spike in CFP pole #21 at intersection of Montgomery Road and Orchard Drive.
 B.M. #344 Elev. 424.13
 Roadside bonnet bolt on F.H. south side of Worthington Way.

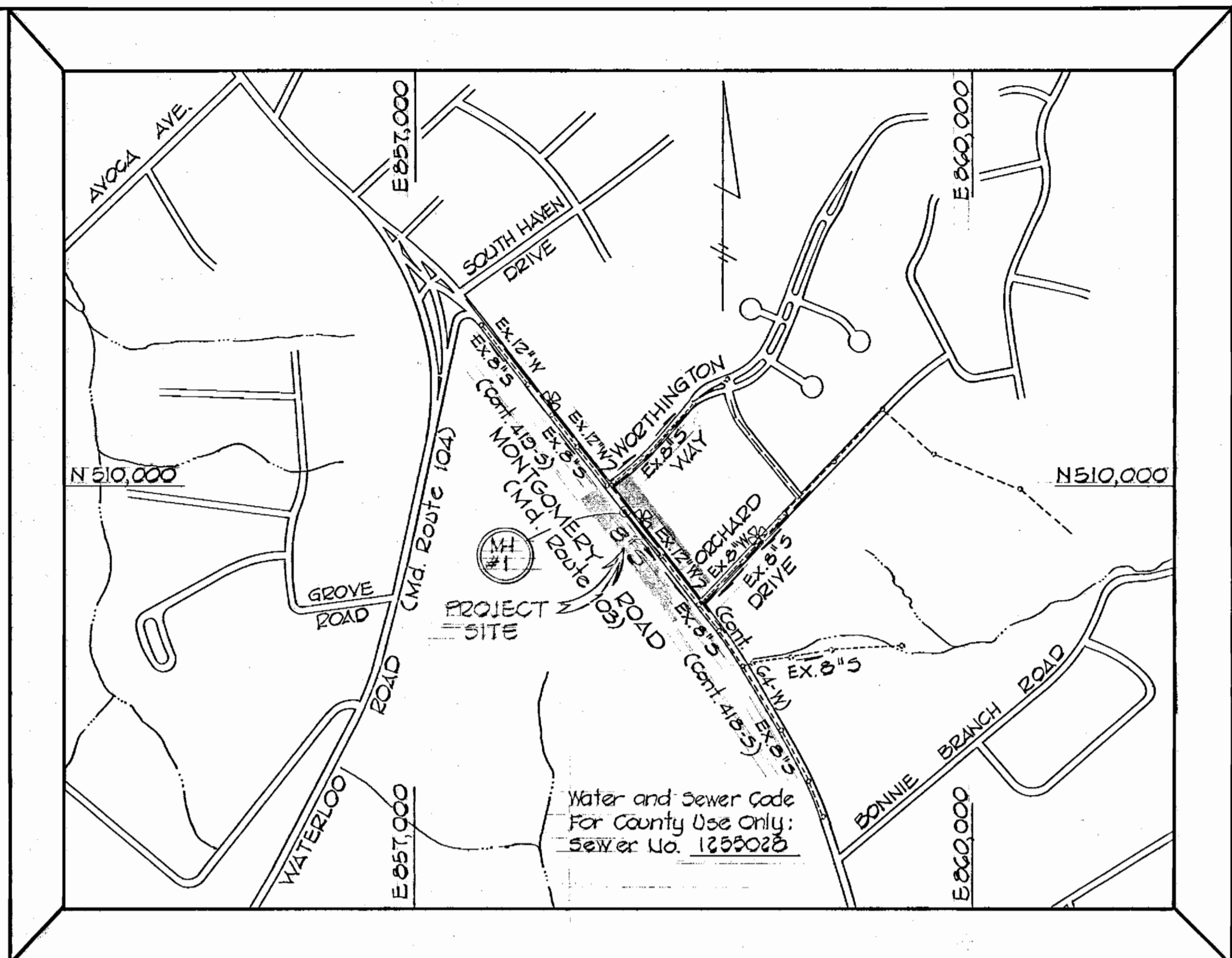

TYPE OF BUILDINGS - SINGLE FAMILY HOMES
 NUMBER OF LOTS - 2
 NUMBER OF SEWER HOUSE CONNECTIONS - 2
 DRAINAGE AREA - PATAPSCO RIVER
VICINITY MAP
 SCALE: 1"=600'

GENERAL NOTES

- APPROXIMATE LOCATIONS OF EXISTING MAINS ARE SHOWN. THE CONTRACTOR SHALL TAKE ALL NECESSARY PRECAUTIONS TO PROTECT EXISTING MAINS AND SERVICES AND MAINTAIN UNINTERRUPTED SUPPLY. ANY DAMAGE INCURRED SHALL BE REPAIRED IMMEDIATELY TO THE SATISFACTION OF THE ENGINEER, AT THE CONTRACTOR'S EXPENSE.
- ALL PIPE ELEVATIONS SHOWN ARE INVERT (I) ELEVATIONS.
- CLEAR ALL UTILITIES BY A MINIMUM OF 6" CLEAR ALL POLES BY 2'-0" MINIMUM OR TUNNEL AS REQUIRED. ANY COSTS INCURRED TO THE CONTRACTOR FOR TUNNELING OR BRACING AT POLES SHALL BE INCLUDED IN UNIT PRICES BID FOR CONSTRUCTION OF THE MAIN.
- FOR DETAILS NOT SHOWN ON DRAWING USE HOWARD COUNTY STANDARD DETAILS.
- THE CONTRACTOR SHALL LOCATE EXISTING UTILITIES A MINIMUM OF TWO (2) WEEKS IN ADVANCE OF CONSTRUCTION OPERATIONS IN THE VICINITY OF PROPOSED UTILITIES AT HIS OWN EXPENSE.
- THE CONTRACTOR SHALL NOTIFY THE FOLLOWING UTILITIES OR AGENCIES AT LEAST FIVE (5) DAYS BEFORE STARTING WORK SHOWN ON THESE PLANS:
 STATE HIGHWAY ADMINISTRATION - 531-5533
 BALTIMORE GAS & ELECTRIC CO. - UNDERGROUND ELECTRIC - 685-0123
 C & P TELEPHONE CO. - 725-9976
 BALTIMORE GAS & ELECTRIC CO. - UNDERGROUND GAS - 685-0123
 MISS UTILITY - 1-559-0100
 BUREAU OF UTILITIES HOWARD COUNTY - 992-2366
- PLACE REGULATION "MEN WORKING" AND WARNING SIGNS AS REQUIRED TO COMPLY WITH MARYLAND STATE HIGHWAY ADMINISTRATION MANUAL OF TRAFFIC CONTROL FOR HIGHWAY CONSTRUCTION AND MAINTENANCE OPERATIONS.
- ALL SEWER MAINS SHALL BE C.S.P.X., V.C.P.X., OR A.C.P. CLASS 2400 R.C.S.P. OR P.V.C., UNLESS OTHERWISE NOTED.
- THE CONTRACTOR SHALL PROVIDE A JOINT IN ALL SEWER MAINS WITHIN 2'-0" OF EXTERIOR MANHOLE WALLS.
- ALL MANHOLES TO BE 4'-0" INSIDE DIAMETER, UNLESS OTHERWISE NOTED.
- ALL HORIZONTAL CONTROLS ARE BASED ON MARYLAND STATE COORDINATES.
- ALL VERTICAL CONTROLS ARE BASED ON U.S.G.S. DATUM.
- TREES ARE TO BE PROTECTED FROM DAMAGE TO MAXIMUM EXTENT. TREES LOCATED WITHIN THE CONSTRUCTION STRIP ARE NOT TO BE REMOVED OR DAMAGED BY THE CONTRACTOR.
- CONTRACTOR SHALL REMOVE TREES, STUMPS AND ROOTS ALONG LINE OF EXCAVATION AS DIRECTED BY THE ENGINEER. PAYMENT FOR SUCH REMOVAL SHALL BE INCLUDED IN THE UNIT PRICE BID FOR CONSTRUCTION OF THE MAIN.
- MANHOLES SHOWN WITH 12" AND 16" WALLS ARE BRICK MANHOLES ONLY.

MONTGOMERY ROAD (MD. RTE 103)

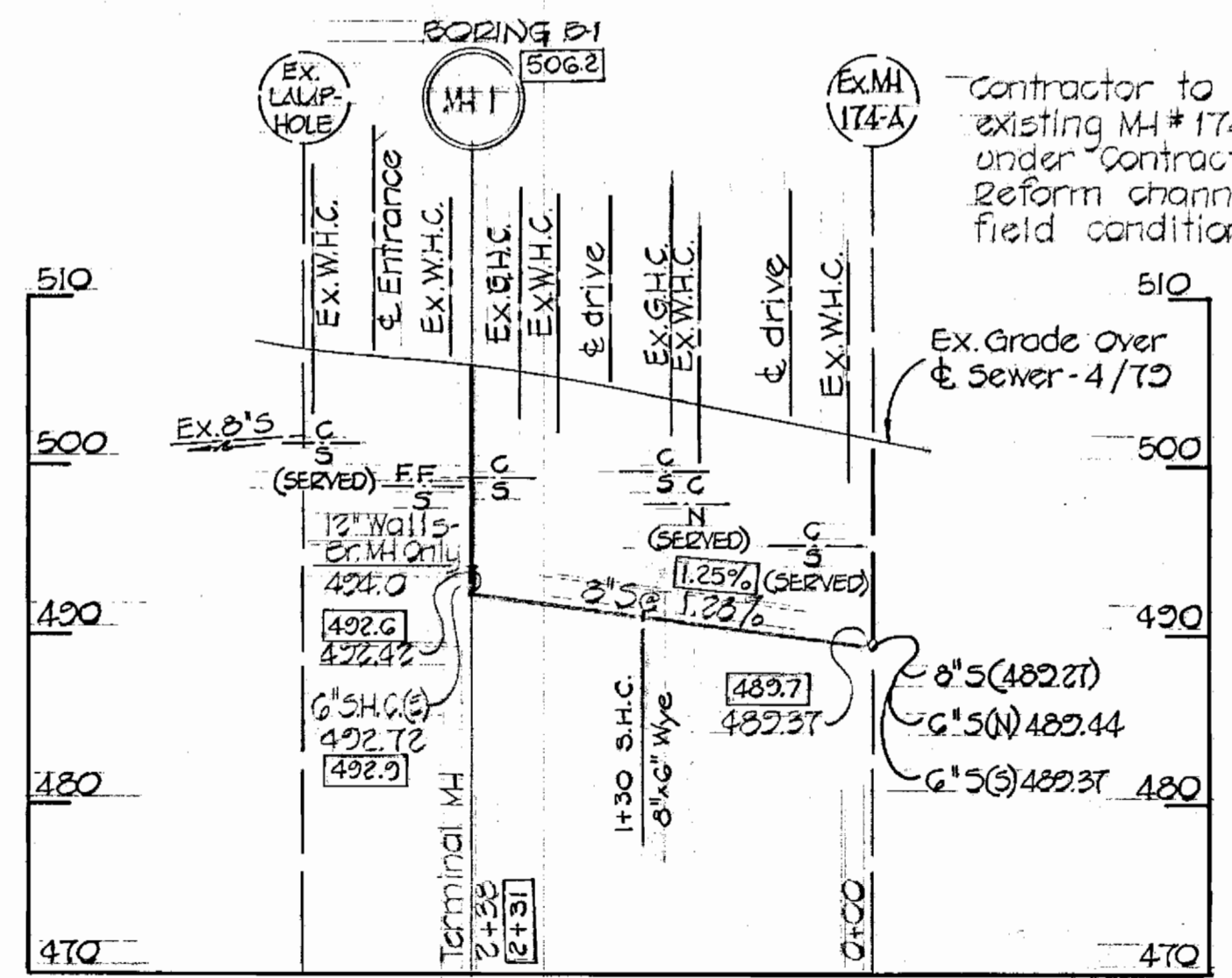

QUANTITIES

ITEM	EST'D	AS-BUILT	SUPPLIER
8" Sewer	233 L.F.	227 L.F.	V.C.P. BELAIR ROAD SUPPLY
Manholes	18.5 V.F.	13.3 V.F.	Precast Terra Hill
6" Sewer	12 L.F.	12 L.F.	V.C.P. BELAIR ROAD SUPPLY

PROFILES

Scale: Horiz. 1"=100'
 Vert. 1"=10'

SEDIMENT CONTROL MEASURES FOR THIS CONTRACT WILL BE IMPLEMENTED IN ACCORDANCE WITH ARTICLE 19 OF THESE SPECIFICATIONS.

THIS PLAN IS APPROVED FOR EROSION AND SEDIMENT CONTROL BY THE HOWARD SOIL CONSERVATION DISTRICT AND MEETS TECHNICAL REQUIREMENTS.

APPROVED: *William V. Rame* 5/28/82 *Jana M. Helmer* 5/28/82
 HOWARD SOIL CONSERVATION DISTRICT DATE U.S. SOIL CONSERVATION DISTRICT DATE

STATE OF MARYLAND
 TERRELL A. FISHER
 REGISTERED PROFESSIONAL ENGINEER
 No. 979
 TERRELL A. FISHER # 5757

FISHER, COLLINS AND CARTER, INC.
 CIVIL ENGINEERS AND LAND SURVEYORS
 8388 COURT AVENUE
 ELLICOTT CITY, MARYLAND 21043

DEPARTMENT OF PUBLIC WORKS
 HOWARD COUNTY, MARYLAND
Henry F. Newman 6-22-79 *W.O. Albert* 6-22-79
 DIRECTOR OF PUBLIC WORKS DATE CHIEF BUREAU OF ENGINEERING DATE

CONTRACT NO. 865-S
 CAPITAL PROJECT S-9-6103

PLAN AND PROFILES
 OF SEWER MAINS

MONTGOMERY ROAD SEWERS
 ELECTION DISTRICT NO. 1 & 2
 HOWARD COUNTY, MARYLAND

DRAWING NO. 1 OF 1
 SCALE AS SHOWN
 DES: R.D.B.
 DRN: D.B.S.
 CHK: T.A.F.

CONTRACT NO. 865-S
 MONTGOMERY ROAD
 SEWER EXTENSION
 CAPITAL PROJECT S-9-6103

As Built April 1982
 MARCH 9, 1982