

Water and Sewer Code	County Use
Sewer No.	N/A
Water No.	
Waste Water Disposal:	N/A
Type of Building:	SF
No. of S.I.C.:	N/A
No. of W.H.C.:	86

LOCATION MAP
Scale 1"=600'

PLAN
Scale: 1"=50'

GENERAL NOTES

- APPROXIMATE LOCATION OF EXISTING MAINS ARE SHOWN. THE CONTRACTOR SHALL TAKE ALL NECESSARY PRECAUTIONS TO PROTECT EXISTING MAINS AND SERVICES AND MAINTAIN UNINTERRUPTED SUPPLY. ANY DAMAGE INCURRED SHALL BE REPAIRED IMMEDIATELY.
- ALL PIPE ELEVATIONS SHOWN ARE INVERT ELEVATIONS.
- THE CONTRACTOR SHALL LOCATE EXISTING UTILITIES A MINIMUM OF TWO WEEKS IN ADVANCE OF CONSTRUCTION OPERATIONS IN VICINITY OF UTILITIES.
- THE CONTRACTOR SHALL NOTIFY THE FOLLOWING UTILITIES OR AGENCIES AT LEAST FIVE DAYS BEFORE STARTING WORK SHOWN ON THESE PLANS:
BALTIMORE GAS AND ELECTRIC COMPANY - UNDERGROUND ELECTRIC DISTRIBUTION ENGINEERING
DAMAGE CONTROL 234-5691
CHESAPEAKE AND POTOMAC TELEPHONE COMPANY 393-3648.
MISS UTILITY - 1 - 559-0100
- FOR ALL STANDARD DETAILS SEE STANDARDS BOUND IN SPECIFICATIONS.
- ALL HORIZONTAL AND VERTICAL CONTROLS ARE BASED ON MARYLAND STATE DATUM.
- CLEAR ALL UTILITIES BY A MINIMUM OF 6".
- BLOCK ALL FITTINGS WITH CONCRETE, SEE STANDARDS BOUND IN SPECIFICATIONS.
- ALL WATER MAINS SHALL HAVE A MINIMUM OF 3 1/2' COVER.
- ALL WATER MAINS SHALL BE C.I.P., D.I.P. UNLESS OTHERWISE NOTED.
- ALL VALVES SHALL BE STRAPPED TO TEES WHERE APPLICABLE IN ACCORDANCE WITH THE STANDARD DETAILS.
- ALL FIRE HYDRANTS SHALL BE STRAPPED AND BUTTRESSED IN ACCORDANCE WITH THE STANDARD DETAILS. SOIL AROUND THE HYDRANTS SHALL BE COMPACTED IN ACCORDANCE WITH SECTION 5-15 OF THE STANDARD SPECIFICATIONS.
- PAYMENT FOR STRAPPING FIRE HYDRANTS AND VALVES WILL BE INCLUDED IN UNIT PRICE BID FOR FURNISHING AND LAYING WATER MAINS.
- BURY LINE ELEVATIONS ON FIRE HYDRANTS SHALL BE SET TO EDGE OF PAVING OR AS DIRECTED BY THE ENGINEER IN THE FIELD.
- ALL W.H.C.'S SHALL BE 3/4" DIAMETER UNLESS OTHERWISE NOTED.
- WATER SERVICES SHALL BE FOR INSIDE METER SETTINGS.

As-Built
Diary # Stakeout FB# 6310

QUANTITIES			
ITEM	BID	AS-BUILT	MATERIAL / SUPPLIER
12" x 8" T.S. & V	1	1	A.P. Smith
8" Water	585 LF	585 LF	Ducile Iron / US Pipe
Fire Hydrant	1	1	Dresser / M&H

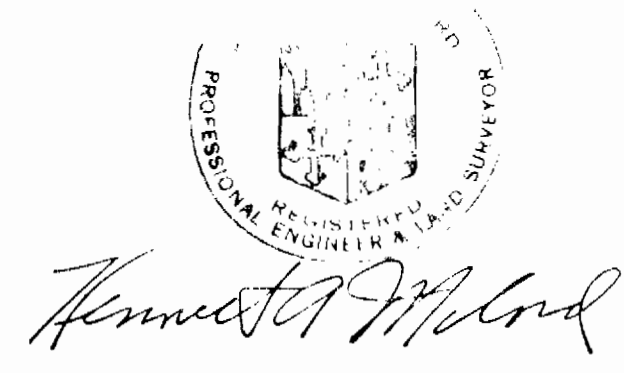

OLD LANDING ROAD
Project No. W-8-8102
Contract No. 864-W

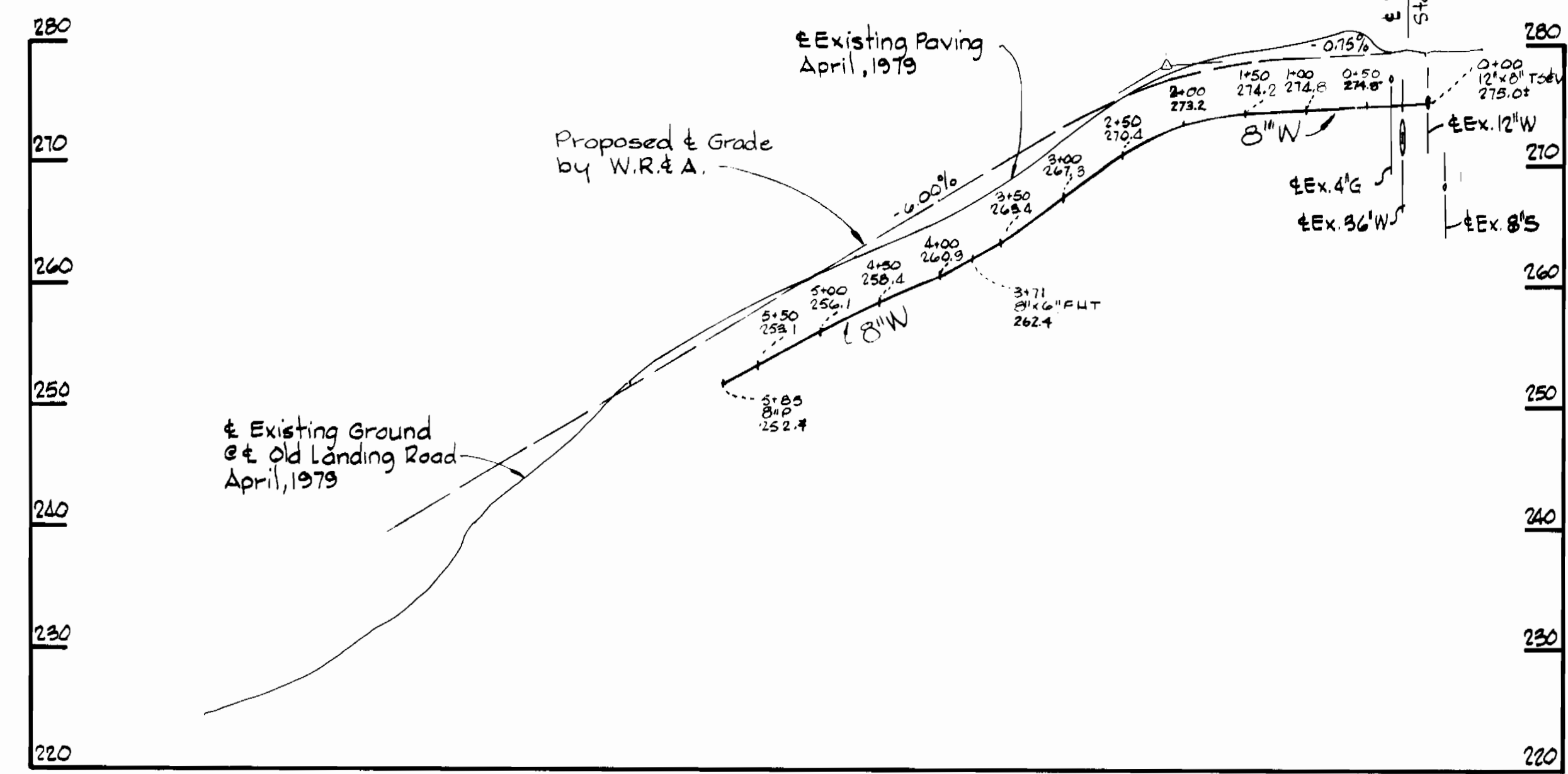

PROFILE
Scale: Horizontal: 1"=100'
Vertical: 1"=10'

DEPARTMENT OF PUBLIC WORKS
HOWARD COUNTY, MARYLAND
James L. Blair, 9/14/79
CHIEF - BUREAU OF UTILITIES - DATE

WHITMAN, REQUARDT & ASSOCIATES
ENGINEERS
1304 ST. PAUL ST.
BALTIMORE, MARYLAND

DEPARTMENT OF PUBLIC WORKS
HOWARD COUNTY, MARYLAND
James M. ... 9/14/79
DIRECTOR OF PUBLIC WORKS - DATE

CONTRACT NO. 864-W
PROJECT NO. W-8-8102

PLAN AND PROFILE
OF WATER MAINS

ELECTION DISTRICT
ELKRIDGE NO. 1

DRAWING NO. OF	SCALE	502-14
	AS SHOWN	502-498
		502-499
		FB# 2263