

VICINITY MAP
Scale: 1"=600'

GENERAL NOTES

1. Approximate location of existing mains are shown. The contractor shall take all necessary precautions to protect existing mains and services and maintain uninterrupted supply. Any damage incurred shall be repaired immediately.
2. All horizontal controls are based on Maryland State Coordinates.
3. All vertical controls are based on U.S.G.S. Datum.
4. All pipe elevations shown are invert elevations.
5. Clear all utilities by a minimum of 6". Clear all poles by 2'0" minimum or tunnel as required.
6. For all standard details, see standards bound in specifications.
7. The Contractor shall locate existing utilities in advance of construction operations in vicinity of proposed utilities.
8. Trees are to be protected from damage to maximum extent. Trees located within the construction strip are not to be removed or damaged by the contractor.
9. The contractor shall remove trees, stumps and roots along line of excavation as directed by the Engineer. Payment for such removal shall be included in the unit price bid for excavation and backfill for water and sewer mains.
10. Place regulation "Men Working" and warning signs as required to comply with Maryland State Highway Administration Manual of Traffic Control for Highway Construction and Maintenance Operations.
11. All water mains to be C.I.P., D.I.P. or A.C.P. unless otherwise noted.
12. Top of all water mains to have a minimum of 5/8" cover unless otherwise noted.
13. All valves shall be strapped to trees in accordance with standard details.
14. Block all fittings with concrete, see standards bound in specifications.
15. Bury Line elevations on fire hydrants shall be set to the elevations shown on the drawings. All fire hydrants shall be strapped and buttressed with concrete in accordance with standard details. Soil around the fire hydrant to be compacted in accordance with section 5-15 of the Standard Specifications.
16. All water house connections shall be meter setting for inside.
17. All sewer mains shall be C.S.P., V.C.P.X. or A.C.P. Class 2400 unless otherwise noted.
18. The contractor shall provide a joint in all sewer mains within 2'-0" of exterior manhole walls.
19. All manholes shall be 4'-0" inside diameter, unless otherwise noted.
20. Where sewer service connections enter manholes, inverts shall be channelized to accommodate flow.
21. Profile stations shall be adjusted as necessary to conform to plan dimensions.
22. Cost of strapping fire hydrants and valves to trees shall be included in the unit prices bid for furnishing and laying water mains.
23. The contractor shall notify the following utilities or agencies at least five days before starting work shown on the plans.

ITEM	QUANTITY		SUPPLIER
	BID	AS BUILT	
8" Sewer	1,745	1,712 LF	Certain-lead
G" Water	1,750	1,727 LF	U.S.P. Tylon D.I.P.
Fire Hydrants	2	2	A.P. Smith

DATE: 12-8-78
 STATE OF MARYLAND
 PROFESSIONAL ENGINEER
 JAMES H. JONES
 PROFESSIONAL ENGINEER NO. 9546

Re: B.M. "PLUM" EL. 394.38
 2 CUT NAILS IN G&E POLE # 331728
 (C&P #4) AT END OF PLUMTREE DRIVE.
 B.M. "F" EL. 378.62
 NORTHWEST CORNER OF STORM
 DRAIN GRATE, RIGHT OF STA. 3+70.1
 PLUMTREE DRIVE.

The cost for furnishing and
 replacing existing paving shall
 be included in the unit price bid
 for excavation and backfill

CENTURY ENGINEERING, INC. CONSULTING ENGINEERS - PLANNERS TOWSON, MARYLAND 21204	DEPARTMENT OF PUBLIC WORKS HOWARD COUNTY, MARYLAND J. F. Nimm 1/27/79 DIRECTOR OF PUBLIC WORKS DATE	CONTRACT NO. 2835-D-W65 WOP Wood 2-27-79 CHIEF - BUREAU OF ENGINEERING DATE	PLAN OF WATER AND SEWER MAINS	GOVERNORS LANDING WATER AND SEWER EXTENSIONS ELECTION DISTRICT - ELLICOTT CITY NO.2	DRAWING NO. 1 OF 2 SCALE AS SHOWN
--	--	---	----------------------------------	---	--------------------------------------

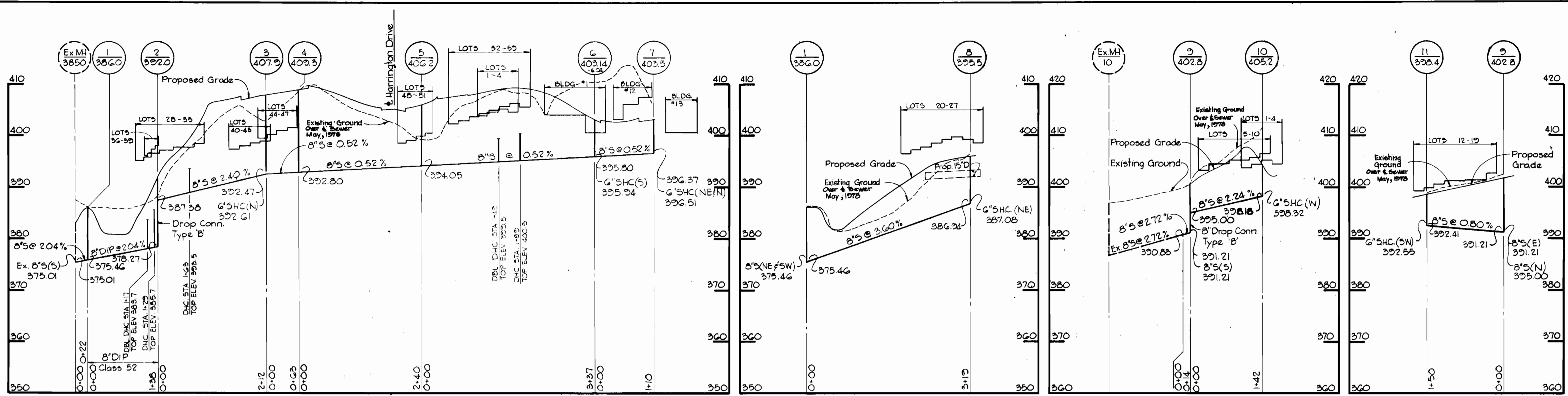

SPLIT RAIL LANE

HARRINGTON DRIVE

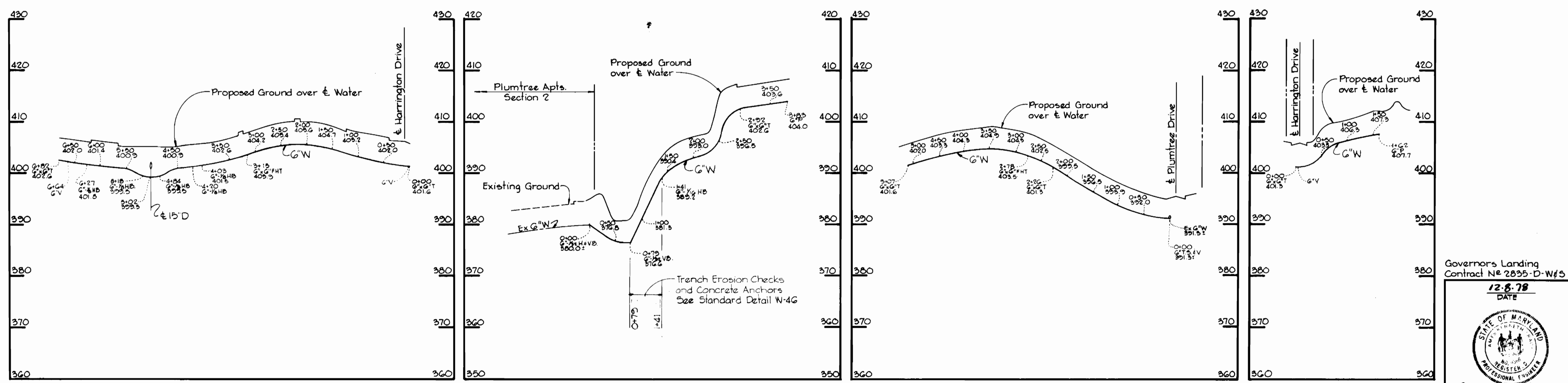

Governors Landing
Contract NE 2835-D-W#5
12-8-78
DATE



CENTURY ENGINEERING, INC. CONSULTING ENGINEERS - PLANNERS TOWSON, MARYLAND 21204	DEPARTMENT OF PUBLIC WORKS HOWARD COUNTY, MARYLAND Director: <i>Mark F. Nummy</i> 2-27-79 Chief: <i>W. O. Wood</i> 2-27-79	CONTRACT NO. 835-D-W#S	PROFILES OF WATER AND SEWER MAINS	GOVERNORS LANDING WATER AND SEWER EXTENSIONS ELECTION DISTRICT - ELLICOTT CITY NO.2	DRAWING NO. 2 OF 2 SCALE H:1"=100' V:1"=10'
--	---	------------------------	--------------------------------------	---	--