

- GENERAL NOTES**
1. Approximate locations of existing mains are shown. The contractor shall take all necessary precautions to protect existing services and maintain uninterrupted supply. Any damage incurred due to the contractor's operations shall be repaired immediately at the contractor's expense.
 2. All pipe elevations shown are \odot invert elevations.
 3. The contractor shall locate existing utilities a minimum of two weeks in advance of construction operations in the vicinity of proposed utilities.
 4. For standard details see standards bound in specifications.
 5. Clear all utilities by a minimum of 6". Clear all utility poles by 2'-0" minimum or tunnel as required. Any costs incurred to the contractor for tunneling or bracing at poles shall be included in unit price bid for excavation.
 6. Contractor shall notify the following utilities or agencies at least five (5) days before starting work shown on these plans:
 Baltimore Gas & Electric Company - Underground Gas Distribution Engineering - 558-0100
 Chesapeake and Potomac Telephone Company - 725-9976
 Miss Utility - 1-800-393-3648
 7. Top of all water mains to have a minimum of 3' - 6" cover unless otherwise noted.
 8. All valves shall be strapped to tees, where applicable, in accordance with standard details.
 9. Buttress or anchor all water main fittings with concrete, in accordance with details in the specifications.
 10. Bury line elevations on fire hydrants shall be set to the elevations shown on the drawings. All fire hydrants shall be strapped and buttressed with concrete in accordance with standard details. Soil around the fire hydrants to be compacted in accordance with Section 5-15 of the Standard Specifications.
 11. Cost of strapping fire hydrants and valves to be included in the unit price bid for furnishing and installing fire hydrants.
 12. All rights-of-way for fire hydrants are in accordance with Standard Detail W-47 unless otherwise noted.
 13. Horizontal control is based on the Maryland State Grid Coordinate System.
 14. All vertical controls are based on U.S.G.S. Datum.
 15. Trees are to be protected from damage to maximum extent. Trees located within the construction strip are not to be removed or damaged by the contractor.
 16. Contractor shall remove trees, stumps and roots along line of excavation as directed by the Engineer. Payment for such removal shall be included in the unit price bid for excavation and backfill for water mains.
 17. Place regulation "Men Working" and warning signs as required to comply with Maryland State Highway Administration Manual of Traffic Control for Highway Construction and Maintenance Operations.
 18. All waterhouse connection shall have inside meter settings.
 19. DIP shall be Class 52 for 8" and Class 53 for 6" diameters.

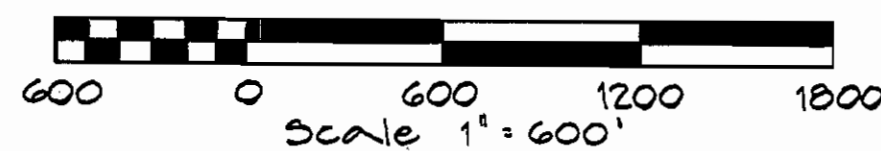

WATER ZONE AOI

CAPITAL PROJECT W-8-8100
CONTRACT NO. 819-W
RACE ROAD WATER MAIN EXTENSION
HOWARD COUNTY MARYLAND
DEPARTMENT OF PUBLIC WORKS

QUANTITIES			
ITEM	ESTIMATED	"AS-BUILT"	SUPPLIER
8"W	1540 LF.		
6"W	55 LF.		
FIRE HYDRANT	3 Each		
W.H.C.	100 LF.		

CONTRACT NO. 819-W
 RACE ROAD WATER MAIN EXTENSION
 HOWARD COUNTY CAPITAL PROJECT NO. W-8-8100

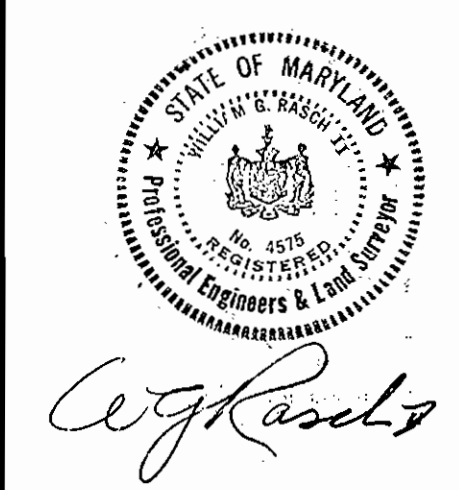

PURDUM & JESCHKE ENGINEERS 1023 N. CALVERT ST. BALTIMORE, MARYLAND	DEPARTMENT OF PUBLIC WORKS HOWARD COUNTY, MARYLAND Director of Public Works DATE 5-4-79 Chief-Bureau of Engineering DATE 5-3-79	CONTRACT NO. 819-W CAPITAL PROJECT NO. W-8-8100	VICINITY MAP	RACE ROAD - WATER MAIN EXTENSIONS FIRST ELECTION DISTRICT HOWARD COUNTY, MARYLAND	DRAWING NO. 1 OF 3	SCALE AS SHOWN	Designed P.W.R. Drafted P.W.R. Checked R.H.B.
					W.O.	9/13/78	As Built Sept. 12, 1980

WS 819-W 11

W.O.

WS 819 - W/2

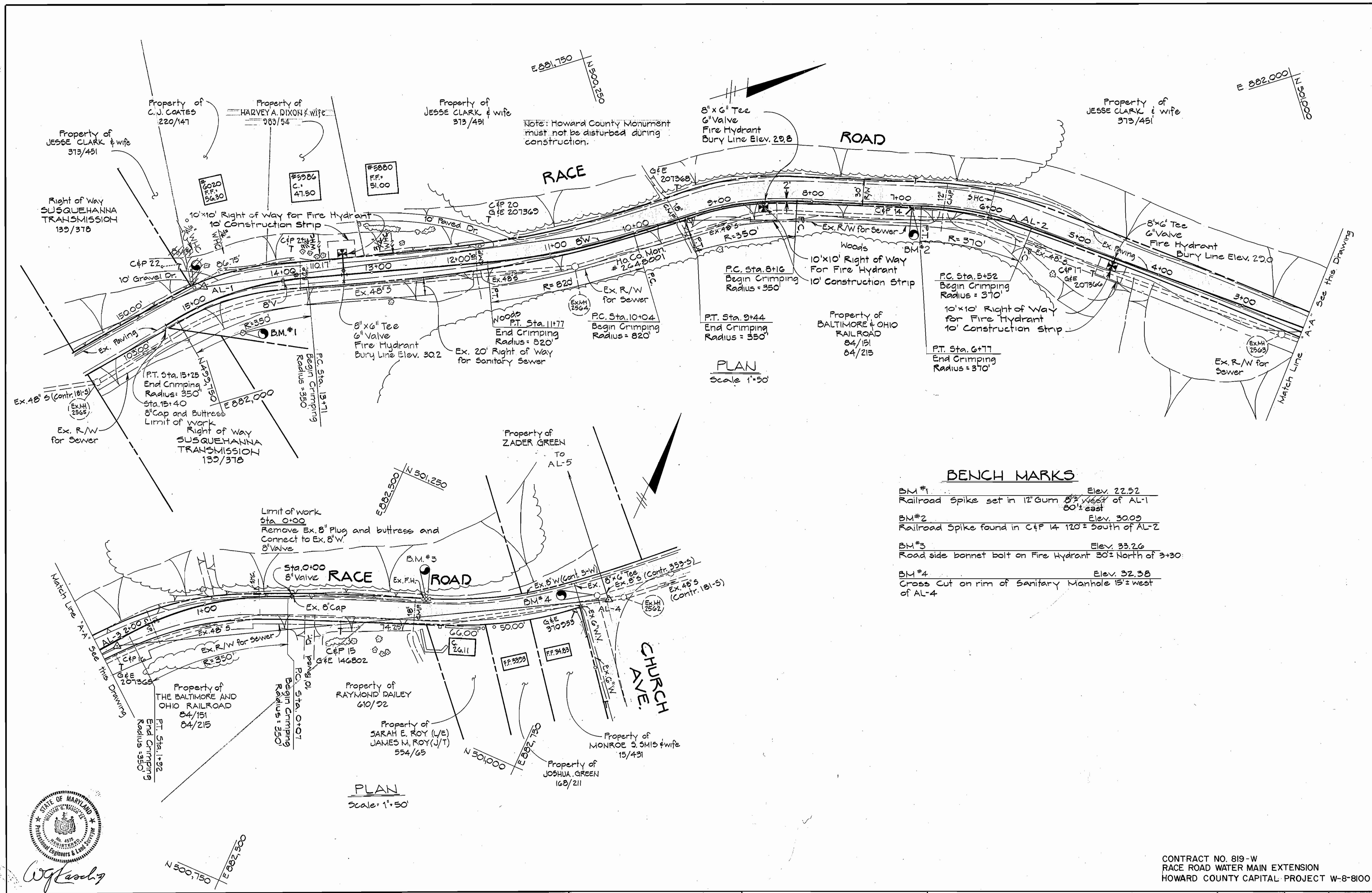

Note: Howard County Monument must not be disturbed during construction.

PLAN
Scale 1"=50'

BENCH MARKS

- BM #1 Elev. 22.52
Railroad Spike set in 12" Gum 8' West of AL-1 80' east
- BM #2 Elev. 30.09
Railroad Spike found in C&P 14- 120' South of AL-2
- BM #3 Elev. 33.26
Road side bonnet bolt on Fire Hydrant 30' North of 3+30
- BM #4 Elev. 32.38
Cross Cut on rim of Sanitary Manhole 15' West of AL-4

PLAN
Scale: 1"=50'



PURDUM & JESCHKE
ENGINEERS
1023 N. CALVERT ST.
BALTIMORE, MARYLAND

DEPARTMENT OF PUBLIC WORKS
HOWARD COUNTY, MARYLAND
5-4-79
DIRECTOR OF PUBLIC WORKS DATE

CONTRACT NO. 819-W
CAPITAL PROJECT NO. W-8-8100

PLAN

RACE ROAD-WATER MAIN EXTENSION
FIRST ELECTION DISTRICT
HOWARD COUNTY, MARYLAND

DRAWING NO. 2 OF 3	SCALE AS SHOWN	Designed PWR Drafted PWR Checked RHB Date: 9-13-78
---------------------------	-----------------------	---

CONTRACT NO. 819-W
RACE ROAD WATER MAIN EXTENSION
HOWARD COUNTY CAPITAL PROJECT W-8-8100

WS 819 W/3

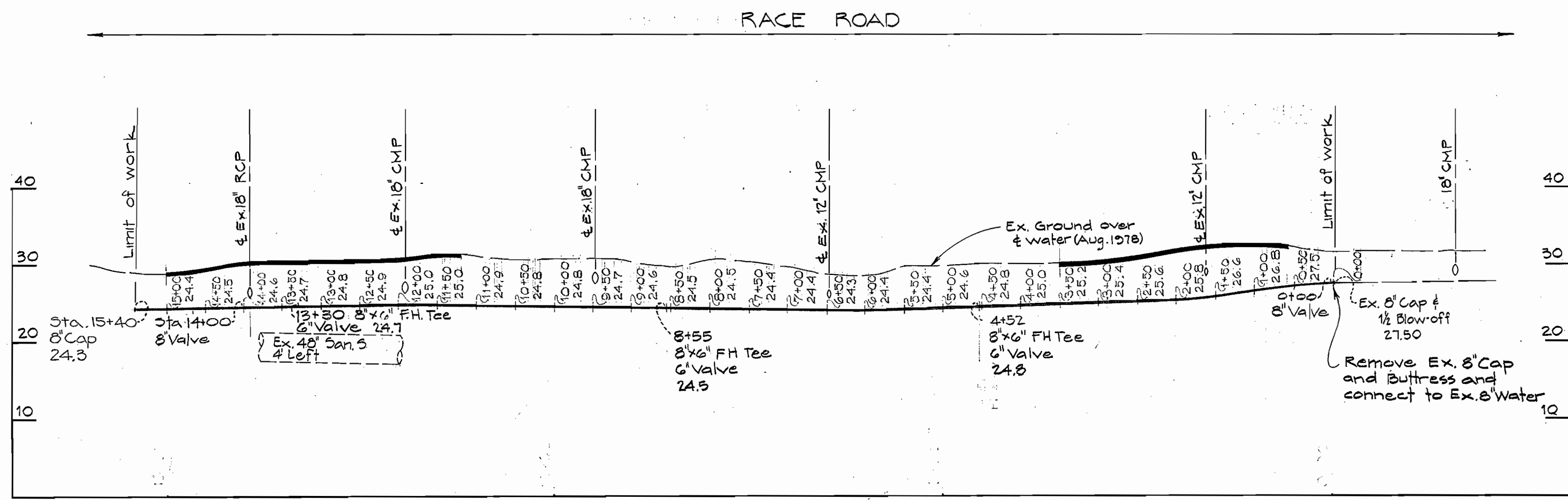

PROFILE
 HORIZ. 1" = 100'
 VERT. 1" = 10'

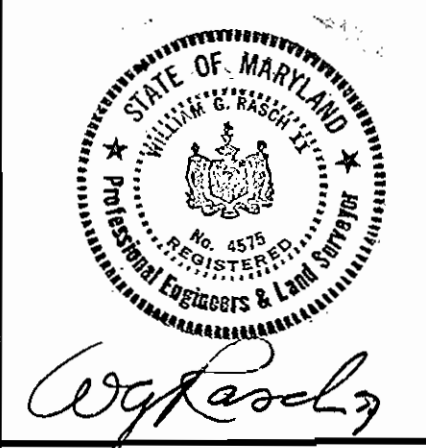

PURDUM & JESCHKE
 ENGINEERS
 1023 N. CALVERT ST.
 BALTIMORE, MARYLAND

DEPARTMENT OF PUBLIC WORKS
 HOWARD COUNTY, MARYLAND
 Director: F. N. [Signature] 5-4-79
 Chief-Bureau of Engineering: [Signature] 5-3-79

CONTRACT NO. 819-W
 CAPITAL PROJECT NO. W8-8100

PROFILE

RACE ROAD - WATER MAIN EXTENSION
 FIRST ELECTION DISTRICT
 HOWARD COUNTY, MARYLAND

DRAWING NO. 3 OF 3	SCALE AS SHOWN	DESIGNED: PWR DRAFTED: PWR CHECKED: RHB 7-13-78
--------------------	----------------	--

CONTRACT NO. 819-W
 RACE ROAD WATER MAIN EXTENSION
 HOWARD COUNTY CAPITAL PROJECT NO. W-8-8100