

VICINITY MAP
SCALE: 1" = 600'

WATER & SEWER CODE
(COUNTY USE)
SEWER ZONE - 7450000
WATER ZONE - E 18

GENERAL NOTES

- APPROXIMATE LOCATIONS OF EXISTING MAINS ARE SHOWN. THE CONTRACTOR SHALL TAKE ALL NECESSARY PRECAUTIONS TO PROTECT THE EXISTING MAINS AND SERVICES AND MAINTAIN UNINTERRUPTED SERVICE. ANY DAMAGE INCURRED SHALL BE REPAIRED IMMEDIATELY.
- ALL PIPE ELEVATIONS SHOWN ARE INVERT ELEVATIONS.
- THE CONTRACTOR SHALL LOCATE EXISTING UTILITIES A MINIMUM OF TWO WEEKS IN ADVANCE OF CONSTRUCTION OPERATIONS IN VICINITY OF UTILITIES.
- FOR ALL STANDARD DETAILS, SEE STANDARDS BOUND IN SPECIFICATIONS.
- ALL SEWER PIPE SHALL BE V.C.P.X., C.S.P.X., OR ASBESTOS CEMENT CLASS 2400 UNLESS OTHERWISE NOTED.
- ALL MANHOLES SHALL BE 4'-0" INSIDE DIAMETER.
- MANHOLE SHOWN WITH 12" WALLS IS FOR BRICK MANHOLE ONLY.
- HOUSE CONNECTIONS SHALL BE CONSTRUCTED ONLY WHERE AND IF DIRECTED BY THE ENGINEER IN THE FIELD.
- ALL WATER MAINS TO BE C.I.P., D.I.P. OR ASBESTOS CEMENT AND HAVE A MINIMUM OF 3'-5" OF COVER.
- BLOCK ALL FITTINGS WITH CONCRETE, SEE STANDARD DETAILS BOUND IN SPECIFICATIONS.
- BURY LINE ELEVATIONS ON FIRE HYDRANTS SHALL BE SET TO ELEVATIONS SHOWN ON DRAWING.
- ALL FIRE HYDRANTS SHALL BE STRAPPED AND BUTTRESSED IN ACCORDANCE WITH STANDARD DETAILS. SOIL AROUND THE FIRE HYDRANTS SHALL BE COMPACTED IN ACCORDANCE WITH SECTION 5-15 OF THE STANDARD SPECIFICATIONS.
- CLEAR ALL UTILITIES BY A MINIMUM OF 6". CLEAR ALL POLES BY 2'-0" MINIMUM OR TUNNEL AS REQUIRED.
- THE CONTRACTOR SHALL PROVIDE A JOINT IN ALL SEWER MAINS WITHIN 2'-0" OF EXTERIOR MANHOLE WALLS.
- COST OF STRAPPING FIRE HYDRANTS AND VALVES TO TEES TO BE INCLUDED IN THE UNIT PRICE BID FOR FURNISHING AND LAYING OF WATER MAINS.
- ELEVATIONS ARE BASED UPON MARYLAND STATE DATUM. COORDINATE VALUES SHOWN ON DRAWINGS ARE IN THE MARYLAND STATE GRID SYSTEM.
- ALL VALVES SHALL BE STRAPPED TO TEES WHERE APPLICABLE IN ACCORDANCE WITH THE STANDARD DETAILS.
- WATER SERVICES SHALL BE FOR INSIDE METER SETTING.
- MINIMUM CELLAR ELEVATIONS SHOWN ARE THE MINIMUM ELEVATIONS WHICH CAN BE SERVED BY SEWER MAINS.
- THE CONTRACTOR SHALL NOTIFY THE FOLLOWING UTILITIES OR AGENCIES AT LEAST FIVE (5) DAYS BEFORE STARTING WORK SHOWN ON THESE PLANS:
BALTIMORE GAS AND ELECTRIC COMPANY, 234-5691
UNDERGROUND ELECTRIC, 550-0100
UNDERGROUND GAS, 727-2976
C & P TELEPHONE COMPANY, 393-3648
MISS UTILITY

PLAN
SCALE: 1" = 50'

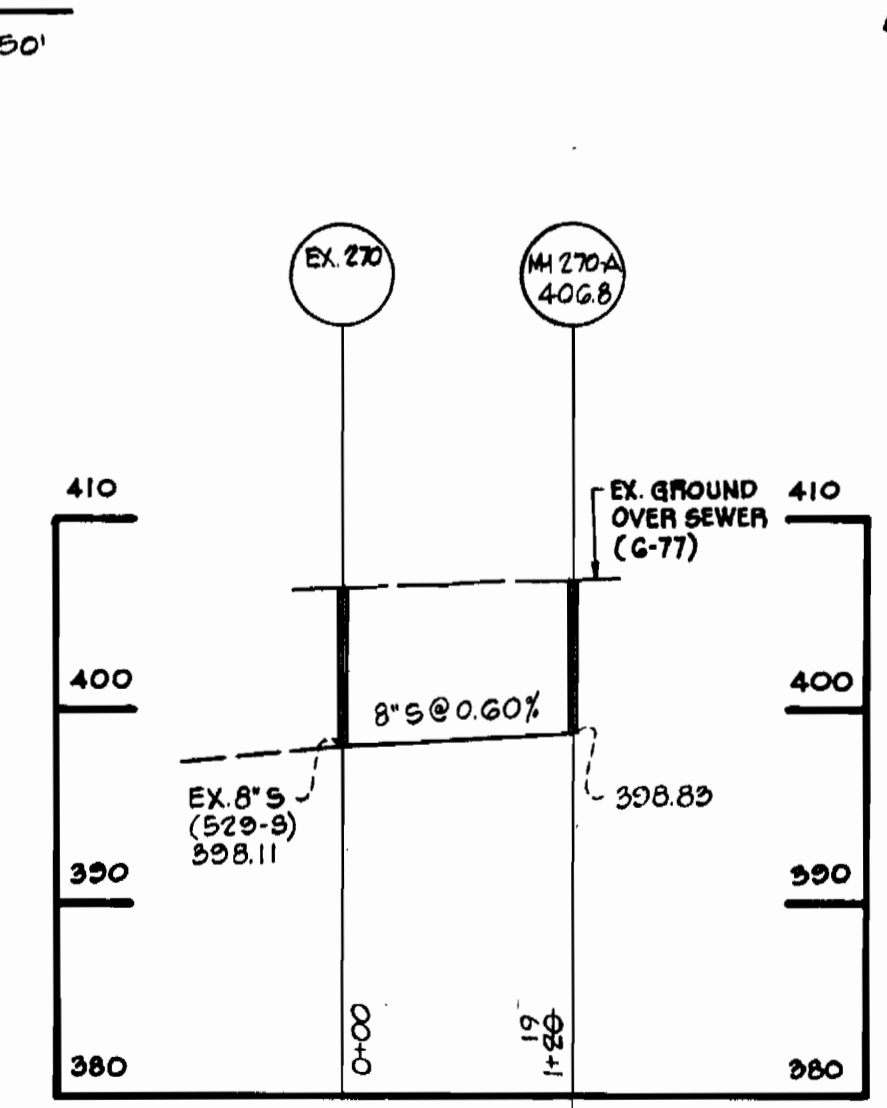
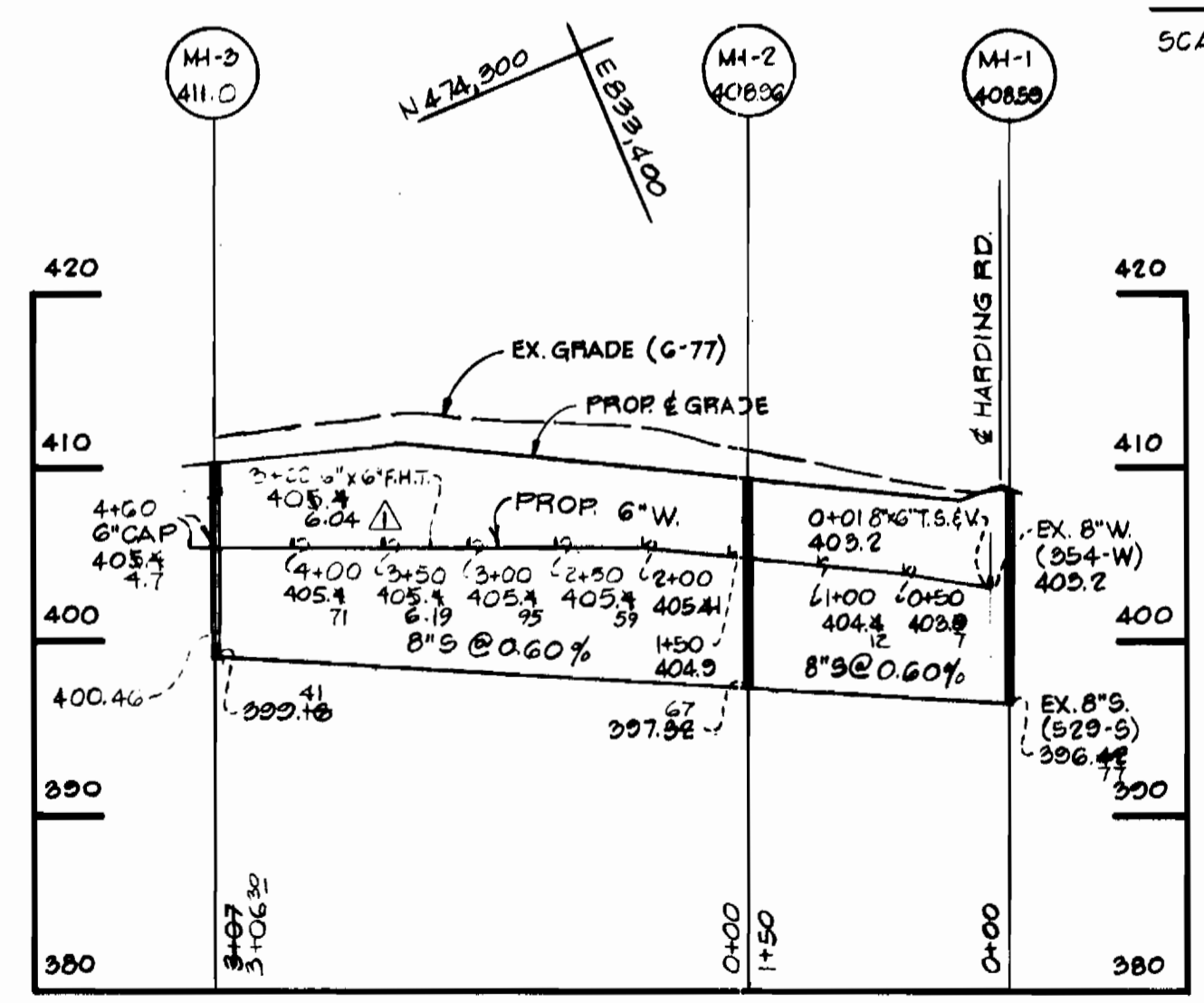

BENCH MARKS

B.M. #12 ELEV. 407.89
R.R. SPIKE IN POLE #289818
AT CORNER OF HARDING RD. & MD. RTE. 216
B.M. #2 ELEV. 412.77
BENT IRON PIPE - SOUTHWEST PROPERTY CORNER
AT EDGE OF EXISTING 10' GRAVEL ROAD

QUANTITIES			AS BUILT	MATERIAL/SUPPLIER
ITEM	SIZE	QUANTITY		
SEWER	6"	577 L.F.	563	A.C.P. J.M.
WATER	6"	450 L.F.	471	D.I.P. GRIFFIN

SCALE: HORIZ. 1" = 100'
VERT. 1" = 10'

SCALE: HORIZ. 1" = 100'
VERT. 1" = 10'

1	4-19-78	Rev. 6" W Profile - Sta. 2+00 to Sta. 4+60
Nº	Datz	Revision

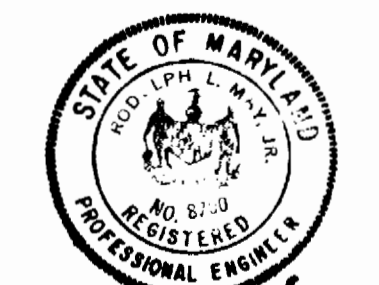

Rodolph May Jr.
8-21-77

BOENDER ASSOCIATES, INC. ENGINEERING, PLANNING, SURVEYING BALTIMORE, MD. SALISBURY, MD. 465-7777 749-1286	DEPARTMENT OF PUBLIC WORKS 10-16-77 DIRECTOR OF PUBLIC WORKS DATE	WOLBERT 10-26-77 CHIEF, BUREAU OF ENGINEERING - DATE	CONTRACT NO. 2749-D-W&S	PLAN AND PROFILE	ELECTION DISTRICT GUILFORD NO. 6	DRAWING NO. 1 OF 1	SCALE AS SHOWN