

- GENERAL NOTES**
1. Approximate location of existing mains are shown. The contractor shall take all necessary precautions to protect existing mains and services and maintain uninterrupted supply. All damage incurred shall be repaired immediately.
 2. All horizontal controls are based on Maryland State Coordinates.
 3. All vertical controls are based on U.S.G.S. Datum.
 4. All pipe elevations shown are invert elevations.
 5. Clear all utilities by a minimum of 6". Clear all poles by 2'-0" minimum or tunnel as required.
 6. For all standard details, see standards bound in specifications.
 7. Contractor shall locate existing utilities in advance of construction operations in the vicinity of proposed utilities.
 8. The contractor shall notify the Baltimore Gas and Electric Company of least five (5) days prior to any construction in the vicinity of any gas and electric facilities by calling 796-8900. The contractor shall notify the C & P Telephone Company five (5) days prior to any construction in the vicinity of any Telephone Company facilities by calling collect 539-8000 in Baltimore.
 9. Trees are to be protected from damage to maximum extent. All trees located within the construction strip are not to be removed or damaged by the contractor.
 10. All water mains to be C.I.P., D.I.P. or A.C.P. unless otherwise noted.
 11. Top of all water mains to have minimum of 3' cover unless otherwise noted.
 12. All valves shall be strapped to trees in accordance with standard details.
 13. Block all fittings with concrete. See standards bound in specifications.
 14. Burialline elevations on fire hydrants shall be set to the elevations shown on the drawings. All fire hydrants shall be strapped and buttressed with concrete in accordance with standard details.
 15. All water meters shall be located inside building unless noted on the plans.
 16. All sewer mains shall be C.S.P.X., V.C.P.X. or A.C.P. Class 2400 unless otherwise noted.
 17. The contractor shall provide a joint in all sewer mains within 2'-0" of exterior manhole.
 18. All manholes shall be 4'-0" inside diameter unless otherwise noted.
 19. Cost of poly filter X and rip rap to be included in the unit price bid for furnishing and laying of sewer mains.

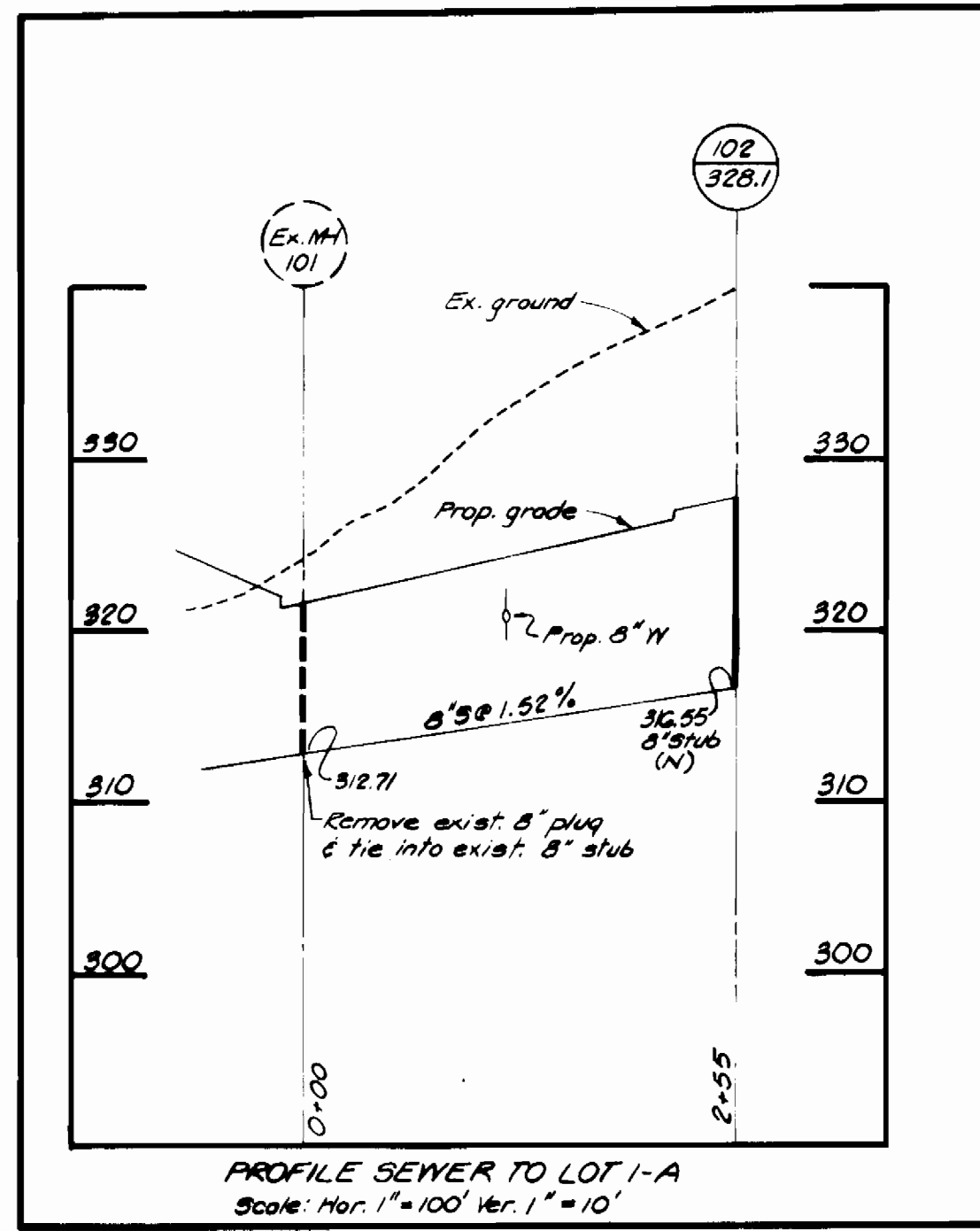
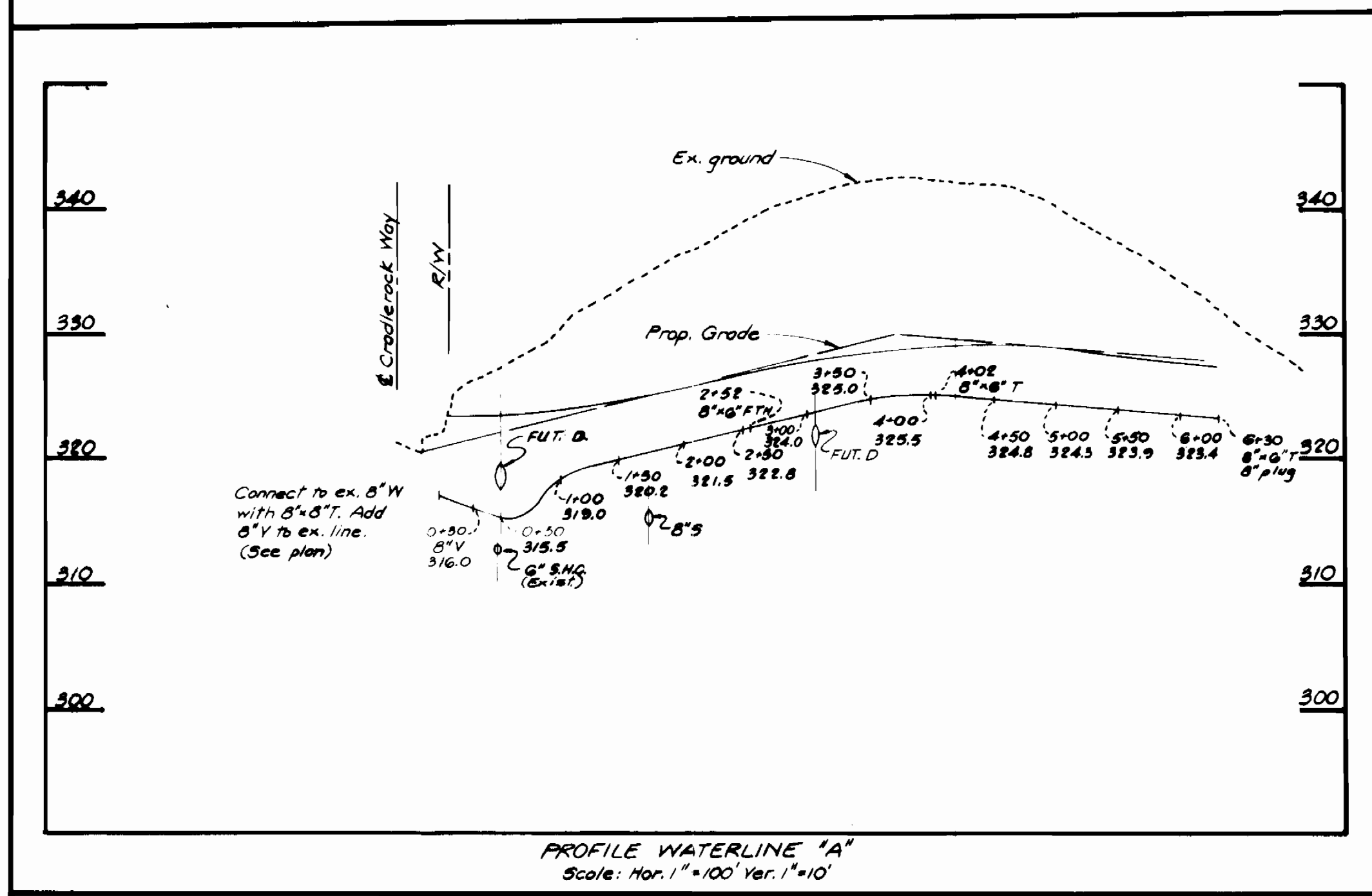

VILLAGE OF OWEN BROWN
SECTION I, AREA 3
HOWARD COUNTY, MARYLAND
DEPARTMENT OF PUBLIC WORKS

ESTIMATE OF QUANTITIES		QUANTITY-PHASE II	"AS-BUILT"	MATERIAL SUPPLIER
8" Sewer main	255 L.F.	255		
6" Water main	690 L.F.	690		
6" Water main	79 L.F.	79		
Fire hydrants	2			

Barry P. Rhoads
MAY 12, 1977 VILLAGE OF OWEN BROWN
SECTION I, AREA 3
CONTRACT NO. 2735 D W&S
PHASE II

STOTTLER STAGG & ASSOCIATES / BREVARD ENGINEERING CO. ENGINEERS ARCHITECTS PLANNERS 5809 ANNAPOLIS RD. HYATTSVILLE, MARYLAND	DEPARTMENT OF PUBLIC WORKS HOWARD COUNTY, MARYLAND 6-10-77 DIRECTOR OF PUBLIC WORKS - DATE	CONTRACT NO. 2735 D W&S PHASE II WATER AND SEWER MAINS	COLUMBIA VILLAGE OF OWEN BROWN ELECTION DISTRICT GUILFORD NO. 6	DRAWING NO. 1 OF 1 SCALE AS SHOWN
--	---	--	---	--------------------------------------